

STEWARDSHIP AGREEMENT HOLDER
PERFORMANCE EVALUATION AND RATING SHEET

REGION : MIMANOPA
 PENRO : PALAWAN
 CENRO : CONON
 Name of CS Holder : DIMAS CRUY CS No.: 42301437
 Location :
 Barangay : BUALACAD
 Municipality : CONON
 Province : PALAWAN
 Area Granted : 3.11 HAS.
 Date Granted : SEPT. 29, 1988
 Status of the Area : EXPIRED

I. AREA DEVELOPMENT

1. Farm Area Development And Management

Farming Practices/Technologies (please indicate location on the attached sketch map of the farmland the development/improvements made)

| Farming Practices/Technologies | Percentage Of Farm Area Covered | Crops Planted | Generated Benefits (good, fair, poor) |
|------------------------------------|---------------------------------|------------------------------|---------------------------------------|
| A. Agroforestry Farm Establishment | 30% | Bamboo, few Mangrove Coconut | Good |
| B. Orchard and Tree Plantation | 20% | Cashew plantation | Good |
| C. Agri crops | 10% | Cassava | Fair |

2. Farm Protection, Care And Maintenance

| Activities | Good | Fair | Poor |
|---------------------------|------|------|------|
| a. Forest Protection | ✓ | | |
| b. Fertilizer Application | | ✓ | |
| c. Pesticide Application | | | ✓ |

3. Other Improvements

| Other Improvements | Good | Fair | Poor |
|---------------------------------|------|------|------|
| a. Monument in each Farm Corner | ✓ | | |
| b. Fertilizer Application | | ✓ | |
| c. Pesticide Application | | | ✓ |

II. CONSERVATION OF FOREST RESOURCES

| Activities | Good | Fair | Poor |
|--|------|------|------|
| a. Protection of naturally growing trees | ✓ | | |
| b. Soil and Water Conservation/Soil Erosion Control Measures | | ✓ | |

| | | | |
|--|--|---|--|
| c. Protection of vegetation along waterlines, rivers and streams | | ✓ | |
| d. Compliance to existing forestry laws, rules and regulations | | ✓ | |

REMARKS _____

III. INVOLVEMENT ON THE ORGANIZATIONAL ACTIVITIES

1. Is the grantee a member of Stewardship Association/CBFM Peoples Organization?
 [] Yes [] No
 If yes, please specify position in the organization.

2. As officer/member, what organizational activities had you participated?

| Activities | Always | Sometimes | Never |
|------------------------------|--------|-----------|-------|
| a. Meetings | | | |
| b. Planning/Decision Making | | | |
| c. Implementation/Monitoring | | | |
| d. Pahina/Collective Labor | | | |

IV. STATUS OF OCCUPANCY:

() Actual CS Holder () Leased/Mortgaged () Sold by CS Holder

REMARKS:

The CS holder complied the terms & conditions specified in their Stewardship Agreement the CSE area got 73 points (Satisfactory); recommended for renewal of CS contract.

EVALUATORS:

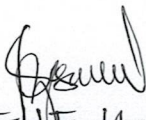

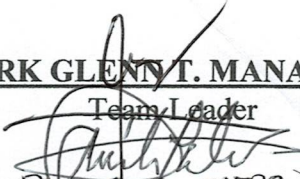
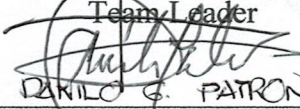
ANGELIE U. PASCUA
 Member

MARK GLENN T. MANAGDAG
 Team Leader

DARILO G. PATRON
 Member

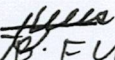

MARK ANGELA FACUNAN
 Member

 Member

 Member

SABINDA B. FLORES
 Barangay Official

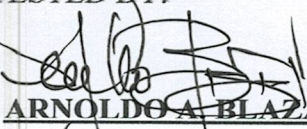
ATTESTED BY:

ARNOLDO A. BLAZA, JR.
 CENR Officer

 Date

Republic of the Philippines
Department of Environment and Natural Resources
Visayas Avenue, Diliman, Quezon City

DENR Form No. _____

APPLICATION FOR RENEWAL
OF CERTIFICATE OF STEWARDSHIP

1. Name: CRUX DIMAS L.
(Last Name) (First Name) (Middle Initial)
2. Birthdate: June 7, 1969
3. Address:
Sitio: PANDAN
Barangay: BWALACAO
Municipality: COCON
Province: PALAWAN
4. Educational
Attainment: ELEM. LEVEL
5. Occupation: Fisherman
6. Civil Status:
☐ Single ☒ Widow
☐ Married ☐ Others
7. Name of Spouse: N/A
(If husband is applicant, indicate the maiden name of wife)

8. Names of Household Members

| Names (pls indicate if holder of CS) | Age | Relationship | Educational Attainment | Occupation |
|--------------------------------------|-----|--------------|------------------------|------------|
| Jerich Calif | 22 | Son | Grade 4 | fisherman |
| Gerrilyn | 20 | daughter | Grade 5 | Housewife |
| | | | | |
| | | | | |
| | | | | |
| | | | | |
| | | | | |
| | | | | |
| | | | | |
| | | | | |

(Note: Use additional sheet if necessary)

Need to be translated into the local dialect

9. Estimated Annual Income of Family:

| Name of Family Member | Source of Income (include on-farm and off-farm activities) | Amount of Income |
|-----------------------|--|------------------|
| | | |
| | | |
| | | |

10. Area covered by Existing CS (ha): 3.11 HRS.

Location: So. Panpan, Bgy. Dulacado Coron, Palawan

CS No. 42301437 Date Issued: 29/09/1988

(day/month/year)

Expiry Date: 30/09/2013

(day/month/year)

11. Place of Residence: ☐ Inside Area Occupied ☐ Outside Area Occupied

12. Are you a member of an organization? ☐ Yes ☐ No

If yes, name of the organization: _____

Position in the organization: _____

I HEREBY CERTIFY that the answers given above are true and correct to the best of my knowledge and belief and I understand that any information I have stated in this application which are contrary to facts shall factor cause the rejection of the application or cancellation of the stewardship agreement that may be granted as a result.

DIMAS CALIX
(Signature of Applicant)

THIS IS TO CERTIFY that _____ is the holder of Certificate of Stewardship No. _____ and actually tilling the area subject of this application for renewal.

SABINO B. FLORES
Barangay Official

MARK GLENN D. MANAGDAG
CBFM Coordinator

SUBSCRIBED AND SWORN to me this _____ day of _____, applicant exhibiting his residence certificate number _____ issued on _____ at _____.

ARNOLDO A. BLAZA, JR.
CENR Officer

Certificate of Stewardship

To All To Whom These Presents May Come, Greetings:

THAT this CERTIFICATE is hereby awarded to:

DIMAS CALIX

of legal age, Filipino, married/single/head of family, with residence/postal address at Palapan
Bulalacao, Coron, Palawan to develop and manage a SOCIAL FORESTRY AREA in accordance
with the attached AGREEMENT, on a portion of forest land situated in Sitio Palapan,
Barangay Bulalacao, Municipality of Coron, Province of Palawan,
containing an area of 3.11 hectares, more or less, bounded and described as follows:

Bounded by :

North - Forest Zone
East - Lot 164-D (Ignacio Bacoled)
South - Lot 164-A (Pedro Bacoled)
West - Lot 162 (Aquino Langoyed)

and is registered with the DEPARTMENT OF NATURAL RESOURCES in accordance
with existing rules and regulations.

As a forest land steward, Dimas Calix shall have the right to
peaceful possession, cultivation and enjoyment of his forest landholding and the fruits thereof, the
right to manage and work on the forest landholding in accordance with appropriate forest and farm
methods and practices, and such other rights as may be granted or provided by law, decrees, letters of
instructions, orders, rules and regulations.

He shall also faithfully comply with all his obligations under the Stewardship Agreement
hereto attached.

IN TESTIMONY WHEREOF, and by authority
vested upon me by law, I **CORAZON G. AQUINO**, President of the Philippines, have caused
this CERTIFICATE to be issued and the seal of
the Republic of the Philippines to be hereunto
affixed.

Given under my hand at Quezon City on
this 22th day of September in the
Year of Our Lord One Thousand Nine Hundred
and 88.

ATTESTED:

FILGENCIO S. FACTORAN JR.
Secretary
Department of Natural Resources

CORAZON G. AQUINO
President of the Philippines

By:

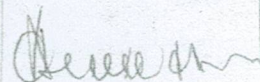
EDWIN L. CACHO
Chief, Social Forestry Unit

By:

ERNESTO V. SEGURITAN
OIC, District Forester

Entered in the Registration Book of the
Department of Natural Resources, this 22th
day of September, 1988, under Registry
Book No. 23, Page No. 04.

163437

GEOTAGGED PHOTOS

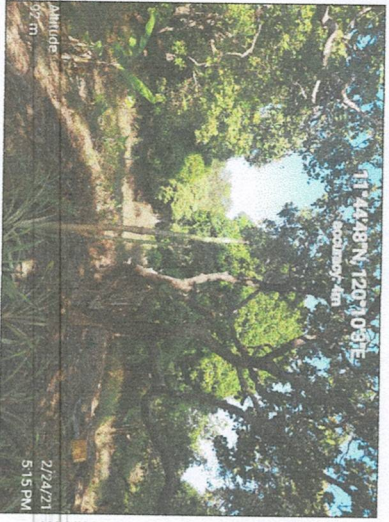
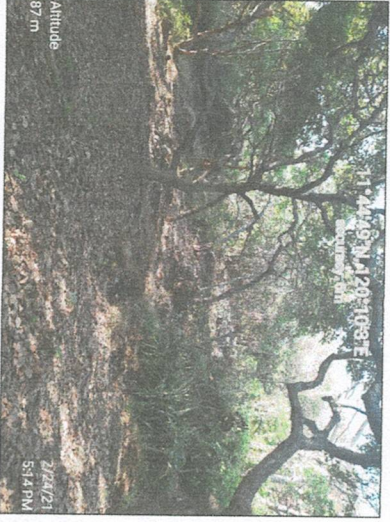
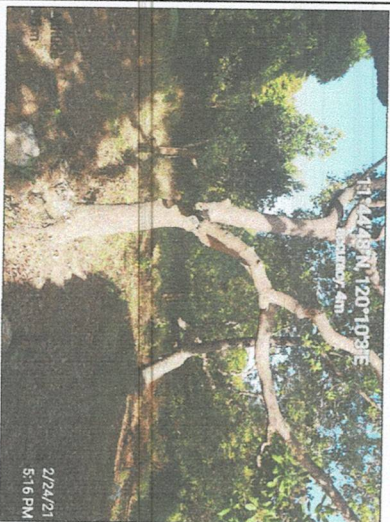

TECHNICAL DESCRIPTION
(Geographic Coordinate System)

| CORNER | LATITUDE | LONGITUDE |
|--------|---------------|----------------|
| 1 | 11°44'44.20\" | 120°10'03.10\" |
| 2 | 11°44'49.72\" | 120°10'06.80\" |
| 3 | 11°44'48.40\" | 120°10'09.62\" |
| 4 | 11°44'45.30\" | 120°10'08.83\" |
| 5 | 11°44'39.50\" | 120°10'05.19\" |

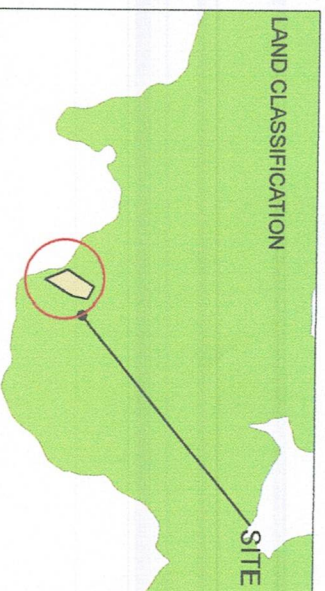

Legend

DIMAS CALIX

LAND CLASSIFICATION

A&D

Forestland

UPE

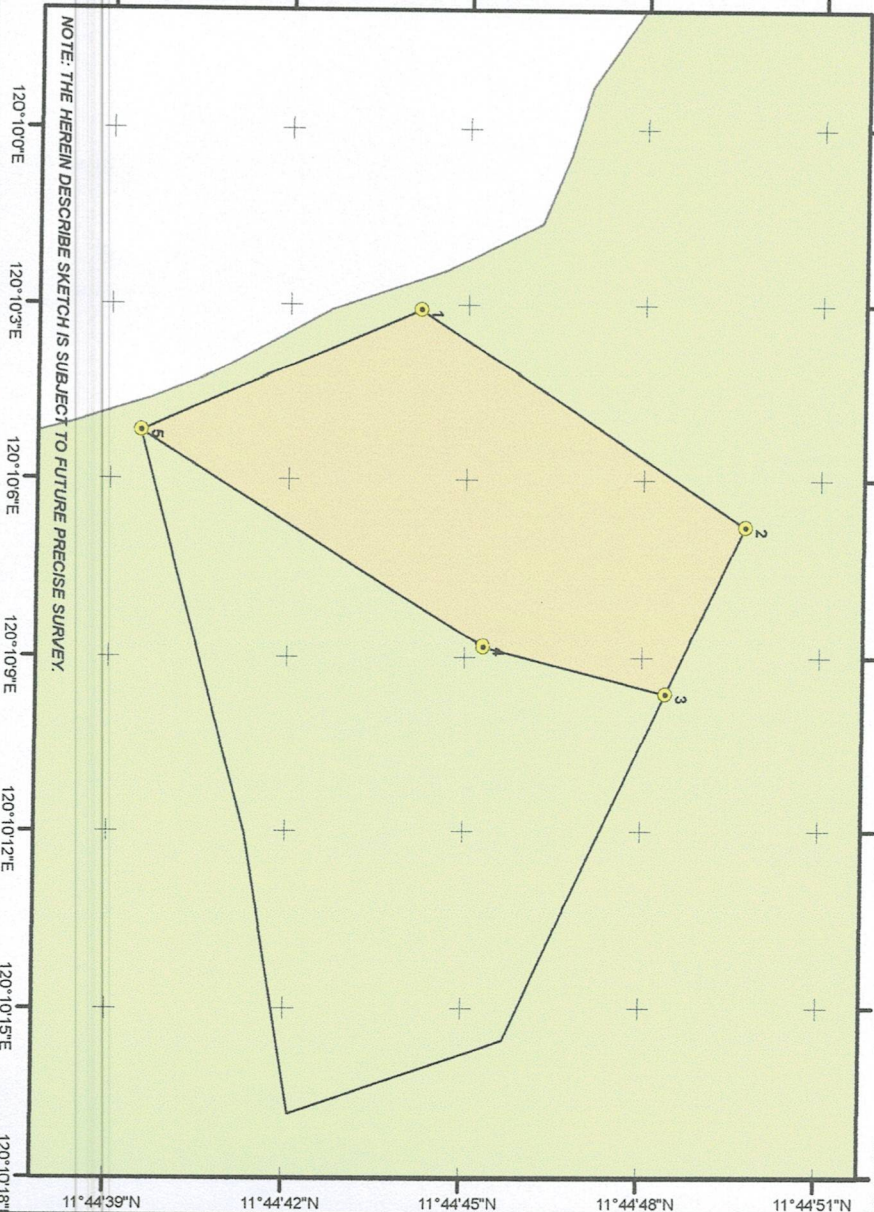

NOTE: THE HEREIN DESCRIBE SKETCH IS SUBJECT TO FUTURE PRECISE SURVEY.

EVALUATED/ASSESSED BY:

MARK GLENN MANAGDAG
ECOMS IICBFM DESK OFFICER

ANGELIE PASCUAL
LMI

LENY JAGMIS
FT.I

RENIEL OLIVER FUENTES
FT.I

MARK ANGELO PACTUAR
Forest Ranger

SKETCH MAP

Showing the area covered by

CERTIFICATE OF STEWARDSHIP
NO. :042301437

For: SOCIAL FORESTRY AREA

of

DIMAS CALIX

AWARDED AREA : 3.11 HAS

LOCATED AT:
SITIO :
BARANGAY :
MUNICIPALITY :
PROVINCE :

LEGEND

CORNER

DIMAS_CALIX

IGNACIO BACOLOD

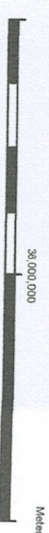

SCALE 1:4000

PROJECTION : WGS 84 WORLD MERCATOR



CHECKED BY:

FERDINAND D. GATCHALIAN
Forester III/Chief CDS

ATTESTED BY:

ARNOLDO BLAZA JR.
OIC-CENRO