

**STEWARDSHIP AGREEMENT HOLDER
PERFORMANCE EVALUATION AND RATING SHEET**

REGION : MIMAROPA
 PENRO : PALAWAN
 CENRO : CORON
 Name of CS Holder : ESTRELLA COMEDIA CS No.: 42301445
 Location :
 Barangay : BULALACAO
 Municipality : CORON
 Province : PALAWAN
 Area Granted : 3.11 HECTARES
 Date Granted : 29 SEPTEMBER 1988
 Status of the Area : EXPIRED

I. AREA DEVELOPMENT

1. Farm Area Development And Management

Farming Practices/Technologies (please indicate location on the attached sketch map of the farmland the development/improvements made)

Farming Practices/Technologies	Percentage Of Farm Area Covered	Crops Planted	Generated Benefits (good, fair, poor)
A. Agroforestry Farm Establishment	10%	MANGO, JACKFRUIT	FAIR
B. Orchard and Tree Plantation	10%	CASHEW, COCONUT	FAIR
C. Agricrops			

2. Farm Protection, Care And Maintenance

Activities	Good	Fair	Poor
a. Forest Protection		✓	
b. Fertilizer Application		✓	
c. Pesticide Application		✓	

3. Other Improvements

Other Improvements	Good	Fair	Poor
a. Monument in each Farm Corner		✓	
b. Fertilizer Application			✓
c. Pesticide Application			

II. CONSERVATION OF FOREST RESOURCES

Activities	Good	Fair	Poor
a. Protection of naturally growing trees	✓		
b. Soil and Water Conservation/Soil Erosion Control Measures		✓	

c. Protection of vegetation along waterlines, rivers and streams		✓	
d. Compliance to existing forestry laws, rules and regulations		✓	

REMARKS _____

III. INVOLVEMENT ON THE ORGANIZATIONAL ACTIVITIES

1. Is the grantee a member of Stewardship Association/CBFM Peoples Organization?
[] Yes [x] No
If yes, please specify position in the organization.

2. As officer/member, what organizational activities had you participated?

Activities	Always	Sometimes	Never
a. Meetings			✓
b. Planning/Decision Making			✓
c. Implementation/Monitoring			✓
d. Pahina/Collective Labor			✓

IV. STATUS OF OCCUPANCY:

(x) Actual CS Holder () Leased/Mortgaged () Sold by CS Holder

REMARKS:

THOUGH THERE ARE INTRODUCED IMPROVEMENTS IN THE AREA, IT ONLY GOT 60 POINTS EQUIVALENT TO FAILED RATING UPON EVALUATION. THE TEAM RECOMMEND FOR THE ISSUANCE OF NOTICE OF NEGLECT TO THE GRANTEE AND THE AREA WILL BE RE-EVALUATED AFTER ONE (1) YEAR.

EVALUATORS:

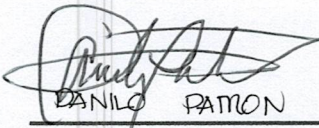

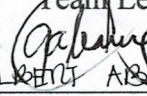
DANILO PATON
Member

MARK GLENN T. MANAGDAG
Team Leader

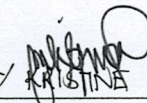
ALBERT ABANLING
Member

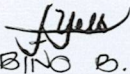

LEN J. LAMAS
Member

MARY KRISTINE BUONES
Member

Member

SABINO B. FLORES
Barangay Official

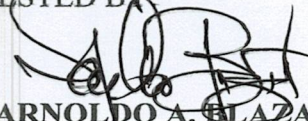
ATTESTED BY:

ARNOLDO A. BLAZA, JR.
CENR Officer

Date

Certificate of Stewardship

To All To Whom These Presents May Come, Greetings:

THAT this CERTIFICATE is hereby awarded to:

ESTRELLA COMEDIA

of legal age, Filipino, married/single/head of family, with residence/postal address at Abulung,
Bulalacao, Coron, Pal. to develop and manage a SOCIAL FORESTRY AREA in accordance
with the attached AGREEMENT, on a portion of forest land situated in Sitio Abulung,
Barangay Bulalacao, Municipality of Coron, Province of Palawan,
containing an area of 2.44 hectares, more or less, bounded and described as follows:

Bounded By :

North - Forest Zone
East - Lot 195-B (Crisanta Salva)
South - Public Land
West - Lot 196-A (Rosario Salva)

and is registered with the DEPARTMENT OF NATURAL RESOURCES in accordance
with existing rules and regulations.

As a forest land steward, Estrella Comedia shall have the right to
peaceful possession, cultivation and enjoyment of his forest landholding and the fruits thereof, the
right to manage and work on the forest landholding in accordance with appropriate forest and farm
methods and practices, and such other rights as may be granted or provided by law, decrees, letters of
instructions, orders, rules and regulations.

He shall also faithfully comply with all his obligations under the Stewardship Agreement
hereto attached.

IN TESTIMONY WHEREOF, and by authority
vested upon me by law, I CORAZON C.
AQUINO, President of the Philippines, have caused
this CERTIFICATE to be issued and the seal of
the Republic of the Philippines to be hereunto
affixed.

Given under my hand at Quezon City on
this 29th day of September in the
Year of Our Lord One Thousand Nine Hundred
and 88.

ATTESTED:

FULGENCIO S. FACTORAN JR.
Secretary
Department of Natural Resources

CORAZON C. AQUINO
President of the Philippines

By:

Edwin I. CAC
Chief, Social Forestry Unit

By:

Ernesto V. SEGURITAN
OIC, District Forester

Entered in the Registration Book of the
Department of Natural Resources, this 29th
day of September, 1988, under Registry
Book No. 23, Page No. 05.

163444

GEOTAGGED PHOTOS

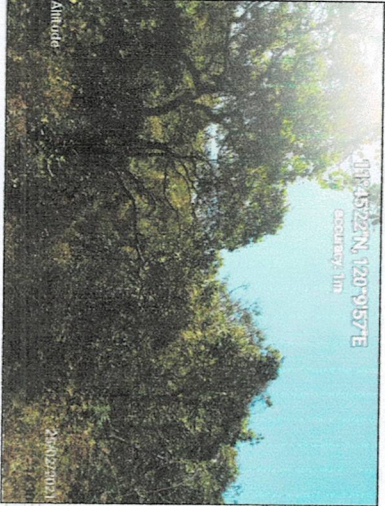
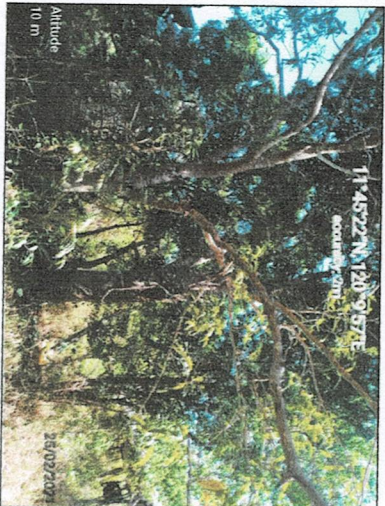
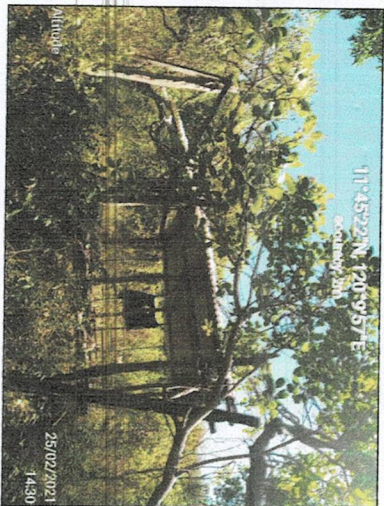

TECHNICAL DESCRIPTION

CORNER	LATITUDE	LONGITUDE
1	11°45'25.91"	120°09'59.57"
2	11°45'22.59"	120°10'04.69"
3	11°45'18.24"	120°10'00.63"
4	11°45'21.61"	120°09'54.85"

LAND CLASSIFICATION

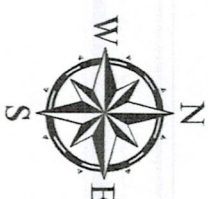
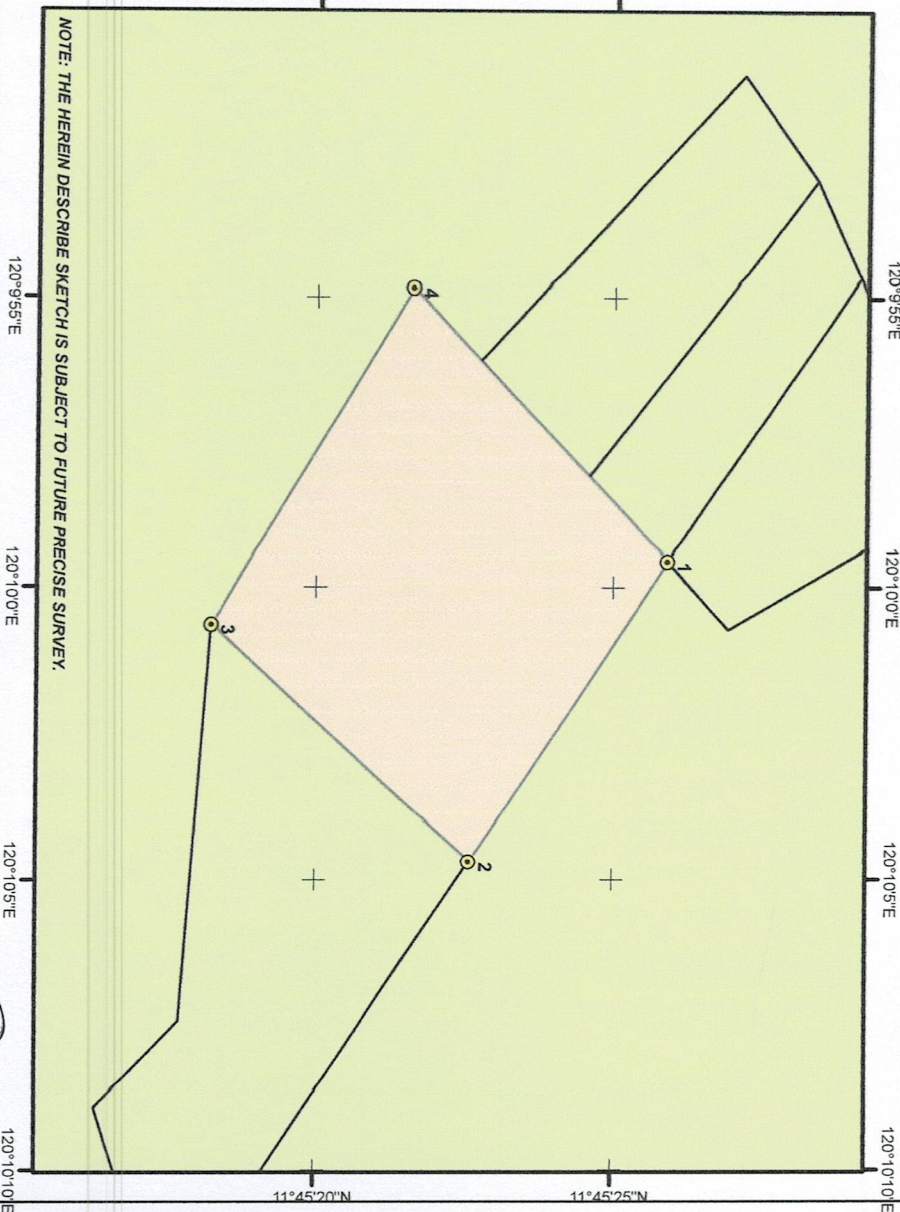
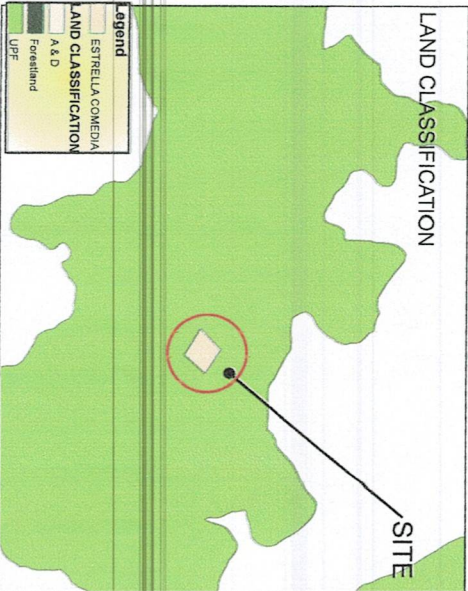

SKETCH MAP

showing the area covered by

CERTIFICATE OF STEWARDSHIP
NO.:042301445

For: SOCIAL FORESTRY AREA

of

ESTRELLA COMEDIA

AWARDED AREA : 3.44 HAS

LOCATED AT:
SITIO :
BARANGAY :
MUNICIPALITY :
PROVINCE :



SCALE 1 : 5000

PROJECTION : WGS 84 WORLD MERGATOR

EVALUATED/ASSESSER BY:

MARK GLENN T. MANAGDAG
ECOMS I/ICBFM DESK OFFICER

MARY KRISTINE BRIONES
LMI

LENY JACIMIS
FT.I

DANILO PATRON
PMF

ALBERT ADARANG
Forest Ranger

CHECKED BY:

FERDINAND D. GATCHALIAN
Forester I/IC Chief CDS

ATTESTED BY:

ARTURO A. BLAZA JR.
OIC-CENRO