



Republic of the Philippines
Department of Environment and Natural Resources

Region IV- MIMAROPA

COMMUNITY ENVIRONMENT AND NATURAL RESOURCES OFFICE

Barangay III (Poblacion), Roxas, Palawan

Contact No. 09171606578 / 09175028647

Email address: cenroroxaspalawan@denr.gov.ph

MEMORANDUM

FOR : The Provincial Environment and
Natural Resources Officer

FROM : The CENR Officer

SUBJECT : **PUBLIC LAND APPLICATION COVERING LOT NO. 7189, CAD.
862-D IN BARANGAY ABAROAN, ROXAS, PALAWAN.**

DATE : 27 August 2021

Herewith for clearance confirming LC findings as required in the processing and issuance of patent pursuant to DMC 2019-10, is land classification certification applied of Lot No. 7189, Cad. 862-D, which is found to be within the agricultural (alienable /disposable) land.

Attached in support hereof as required by the Surveys and Mapping Division (SMD) are the technical description thereof and a print of the corresponding projection map recently provided this Office also by the SMD.

Thank you for considering the matter soonest.

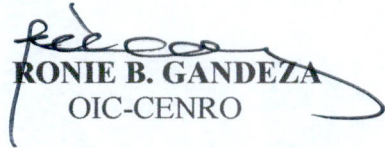
RONIE B. GANDEZA
OIC-CENRO

Copy: The RED
File

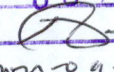
DENR-CENRO ROXAS
RELEASED
DATE. SEP 06 2021
BY: 
DOC. NO. mn-04-1101



Republic of the Philippines
Department of Environment and Natural Resources

Region IV- MIMAROPA

COMMUNITY ENVIRONMENT AND NATURAL RESOURCES OFFICE

Barangay III (Poblacion), Roxas, Palawan
Contact No. 09171606578 / 09175028647
Email address: cenroroxaspalawan@denr.gov.ph

CERTIFICATION

TO WHOM IT MAY CONCERN:

THIS IS TO CERTIFY that based on available records in our office, the tracts of land in Barangay **Abaroan**, Municipality of **Roxas** Province of **Palawan**, containing an area of **Six Hundred Sixty Four** (664) identified as Lot no. **7189, Cad. 862-D** as applied for by **ELSA C. CERVANCIA** was verified to be within **AGRICULTURAL (Alienable or Disposable)** per L.C. Map No. 3309, F.A.O. No. 4-1966 Project No. 14-D certified on JUNE 29, 1987.

Issued this 18th day of **August 2021** at CENRO, Roxas, Palawan.

Checked by:

RONNIE P. LILANG
LMO III/Chief, RPS

Approved:

RONIE B. GANDEZA
OIC-CENRO



Republic of the Philippines
Department of Environment and Natural Resources
Region IV
COMMUNITY ENVIRONMENT AND NATURAL RESOURCES OFFICE
Roxas, Palawan

REPA No. 045318-976 Applicant: ESA C. CERVANCIA
Lot No. 7189, CAD. 862-D Ident. To Lot No. -
Portion of Lot No. - Surveyed for: RICO PATINIO
Date of Original Survey: JAN. - JUNE 1987 Surveyed by: NESTOR L. PASCOTELO
Area (sq. m.) 664 Date of Survey: JANUARY - JUNE 1987
Location: BGY. ABARUAN, ROXAS, PALAWAN Date Approved: OCTOBER 30, 1988

TECHNICAL DESCRIPTION

TIE LINE: N. 75° 35' W. 10264.81 m. from BLM # 1, CAD. 862-D, ROXAS CADASTRE

LINE	BEARINGS	DISTANCE	LINE	BEARINGS	DISTANCE
1-2	N 63° 08' W	10.36 m.		4.682	-9.242
2-3	N 15° 11' W	10.65 m.		10.278	-2.789
3-4	N 37° 37' E	27.65 m.		21.902	16.877
4-5	S 44° 08' E	25.00 m.		-17.947	17.408
5-1	S 49° 38' W	29.21 m.		-18.919	-22.256
				X	-0.002
NOTE: All corners marked on the ground are "PS" cyl. conc. mons.					

SKETCH

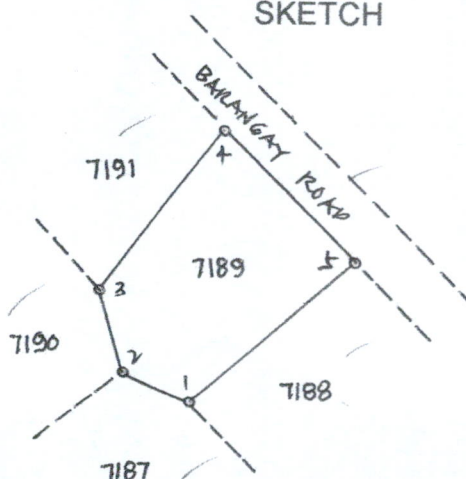

Boundaries are all w/in
Cad-862-D of Roxas cadastre



SCALE 1:1000
Bearings: Grid

Signature



CM = 10°20'N. 119°15'E. Scale 1:4000

582141, 264

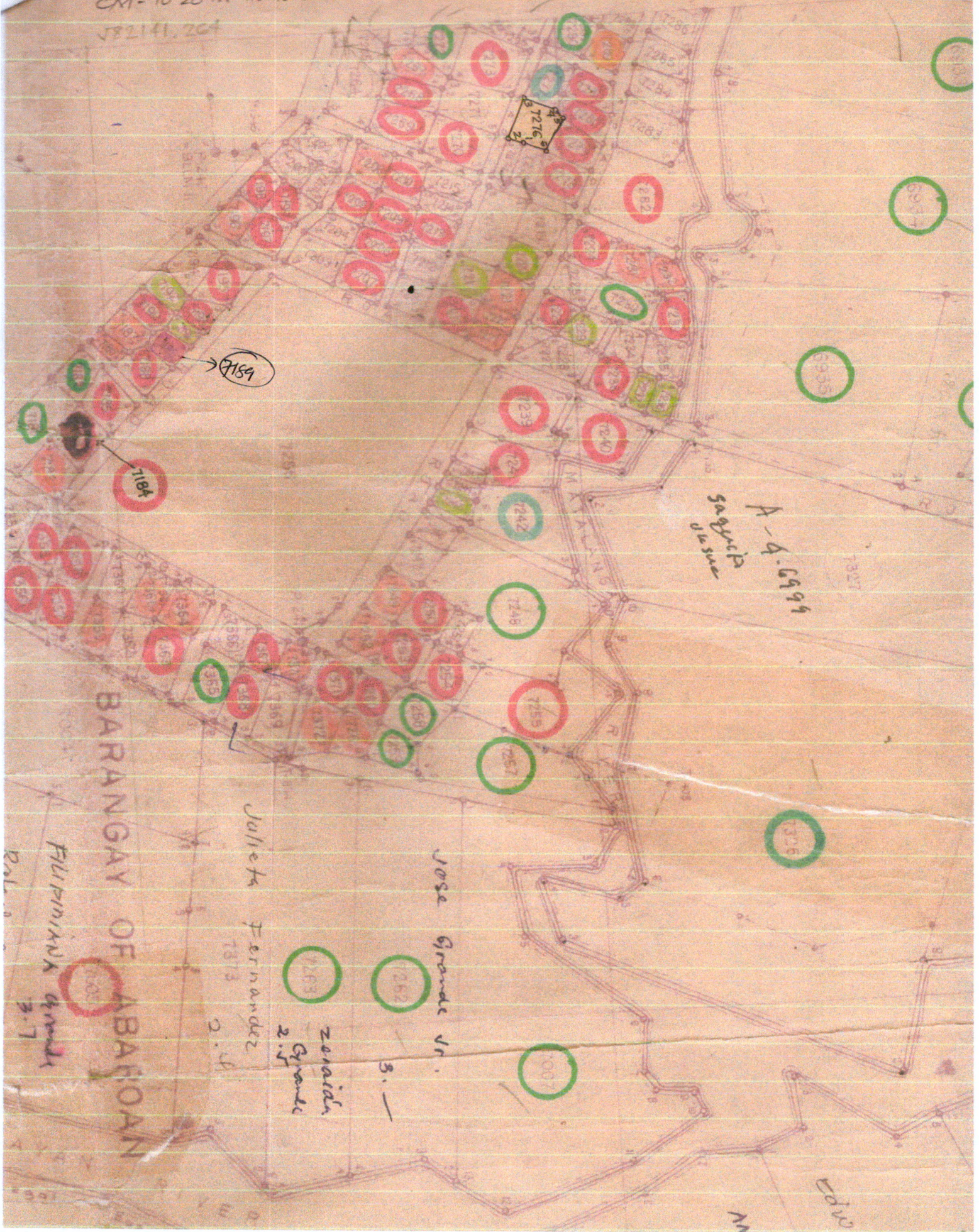

PROJ. NO. 14-D
BLOCK - IV



ALIEN OR DISP.

LC-3309

June 29, 1987

HAS.

1355

LOT 121, Csd. 045318-012120
THIS SITE

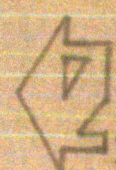

SCALE 1:20000
Ref LC-3309