



SILENT-RESORTS

# LONG BEACH PALAWAN

Imuruan Bay - Philippines

The World's First 100% Solar Private Island  
Residence and Yacht Equity Club

Updated Master Plan Presentation

December, 2021

## Silent Resorts Long Beach Palawan

A stunning 26-acre island sanctuary in the Philippines

### Executive Summary:

- 100% Solar Powered Silent Resort and Private Residences located on Long Beach, Palawan Island – the longest white sand beach in the Philippines
- Luxurious beachfront, marina, and coconut grove solar-powered residences and a fleet of sleek solar-powered yachts, and beach bar/restaurant, clubhouse, and health & wellness center
- Phase 1 Marina, Beach Club, Silent Catch Support Center, 28 individual Solar Suites, and a 62-foot solar powered luxury Silent Yacht
- Phase 2: Clubhouse, Spa, Health & Wellness Center, 28 two, four, and six-bedroom Silent Residences and Silent Yachts
- Long term funding of the Silent Catch Center to support the electrification of the local artisanal fishing fleets and local fishing communities and support responsible diving.



## Silent Resorts Has Revolutionized the Island Residence and Luxury Yacht Experience with 100% Solar Powered, Sustainable, Self-Sufficient, Private, and Secure Luxury Island Properties and Yachts for You, Family, and Friends.

Silent Resorts is a true innovator in luxury island Residences and Yachting. Silent Resorts has created the world's first integrated land/sea, ultra-sustainable, private, exclusive, and secure, 100% solar-powered, luxury ownership club. Our proprietary relationship with Silent-Yachts and our integration of the world's first fully solar yachts with our pre-engineered, modular, low-impact, land-based infrastructure, allows our owners to enjoy the planet's most pristine and undiscovered destinations without harming the environment.

Our philosophy is to employ the natural environment as the chief design director; we work for her. Each island is unique. Silent Resorts is a global brand. With the infinite cruising range of the luxurious, solar-powered, transoceanic Silent-Yachts, no location is beyond your reach. Silent Resorts offers its member/owners and guests true “ocean Independence”.

All Silent Resorts destinations will provide owners and guests the opportunity to:

"Live Fully" - in the world's most pristine places blessed by the most dazzling aquatic experiences.

"Tread Lightly" - to do no harm to the environment and leave the surroundings the way we found them.

"Stay Silently" - to experience nature undisturbed by the sounds of fossil fuel engines and unpolluted by their exhaust for the benefit of humans, flora and fauna.





## Silent Resorts Long Beach Palawan

**Your equity interest in exclusive diversified ownership of our Private Island Resort, Silent Residences, and Silent Yachts**

Silent Resorts ownership offers the security of whole and shared ownership interest in a private island resort, fully managed private residences, and care-free luxury solar yacht ownership. Your lifetime ownership includes a private beach club, spa, health & wellness center, marina, and global exchange benefits. You will also be part of Silent Resorts global initiative "SILENT-CATCH" to support the electrification and sustainable growth of local artisanal fishing fleets and communities.



Live Fully | Tread Lightly | Stay Silently



# A New Development Model



## Energy Self-Sufficient, Cost-Effective, Fully Sustainable

- Silent Yachts are completely self-contained, 100% Solar, with near zero maintenance and operating costs, and a have life-time warranty on the electric drive system.
- Island power & water systems and residences use the same technology as the yachts for efficiency and redundancy.
- Silent Residences and the Yachts when docked at the island “talk” to each other in a proprietary power sharing system.
- All construction components are pre-engineered, modular, and are delivered ready to assemble and plug into the island “Silent Solar Grid”
- On-site Residence construction is near zero waste and does not require extensive labor nor the environmental disruption caused by traditional onsite-building methods.
- Residence construction can be completed in 9 to 12 months, less than half the time of traditional methods.
- Residences are made from sustainably harvested and recycled hardwood timber, recyclable steel, aluminum, and glass, and natural fiber upholstery and wood furnishings.



# Long Beach – Palawan Island

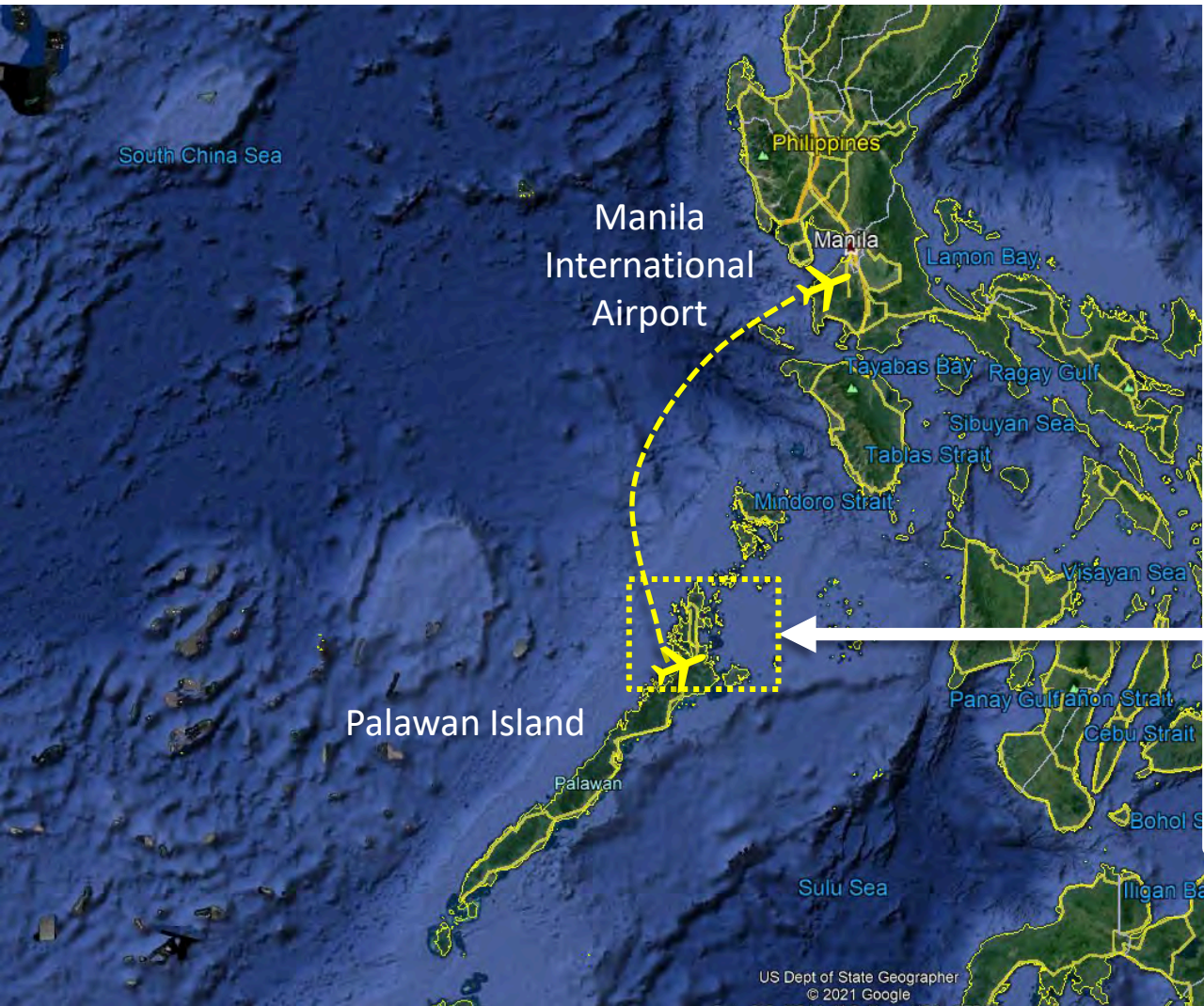

San Vicente Airport is served by direct flights from multiple major Philippines International Airports.



# Long Beach – Palawan Island

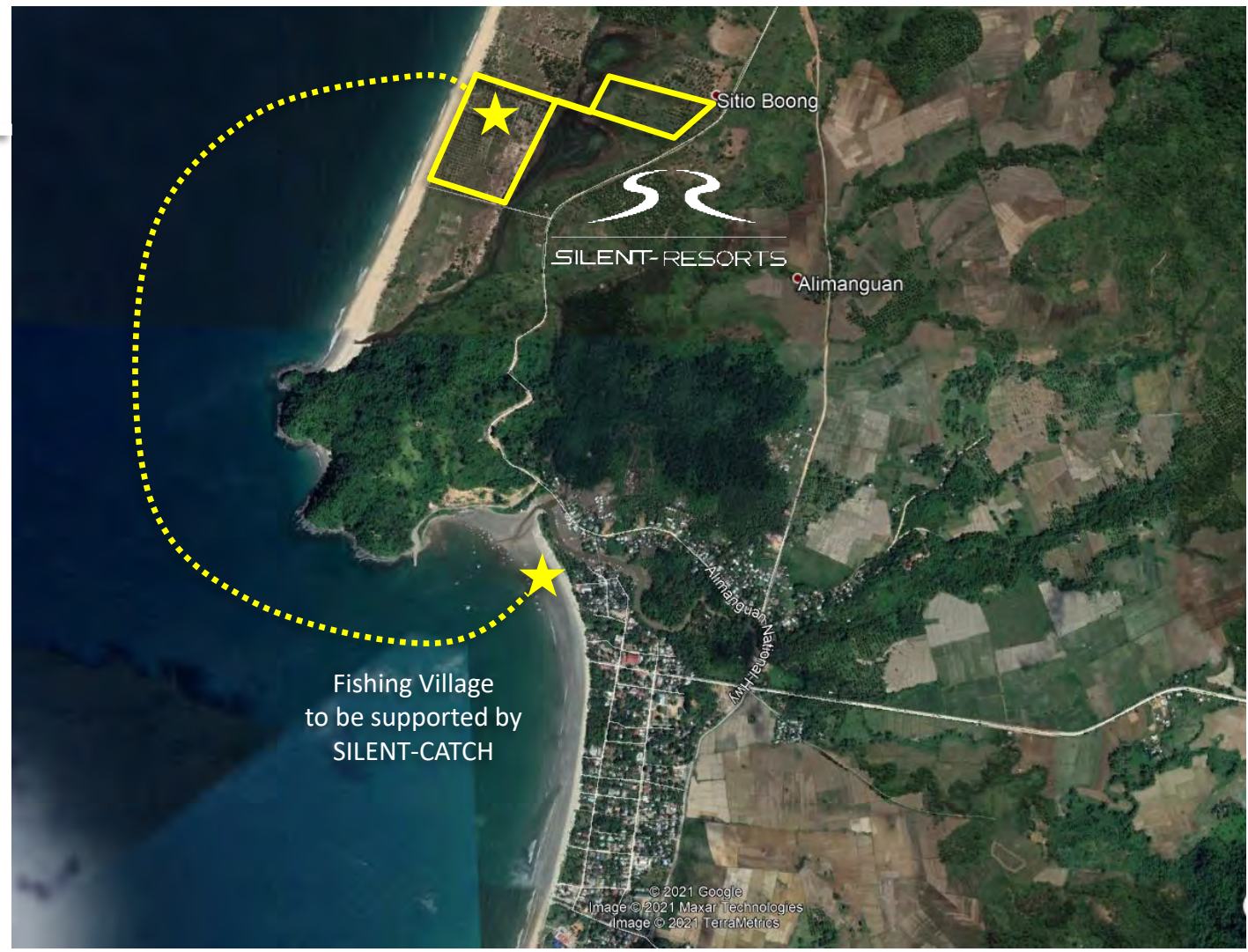



Imuruan Bay

Boong River

**A**

**B**

**C**

NEW 60FT WIDE CANAL

BOONG RIVER  
HIGH WATER  
LEVEL (DRAINS  
INTO CANAL)

BOONG RIVER  
LOW WATER  
LEVEL (REMAINS  
AT THE CURRENT  
WATER TABLE  
LEVEL)

## Proposed Boong River Silent Marina Basin and Access Canal

**A** – Entrance to Boong River is at the natural exit of the river across the beach. Breakwater and stone jetty will be built as per approved plans

**B** – 60-foot-wide access channel will be dredged to an average depth of 8 feet within the boundaries of the existing river basin

**C** – Proposed marina construction creates an isolated marina basin and canal where the ocean water is at sea level. Canal walls are set to the high-water level of the Boong river, allowing for the river to remain at its current natural levels during dry season, and to spill into the sea during rainy season as it does now.





## Preliminary Master Plan

**A** – Silent Resort – (28) Solar Suites, Clubhouse, Beach and Small Boat Dock

**B** – Silent Marina – Solar Powered 60- and 80-foot Silent Yachts

**C** – Silent Catch Support Center, Dive Shop, & Dock

**D** – (8) Silent Townhomes: 2-Bed Townhomes

**E** – (21) Silent Residences: 4 and 6-Bed Residences

**F** – Sunset Beach Club, Spa & Wellness Center, Restaurant & Bar

**G** – Future Public Market and Commercial Mixed-Use Development



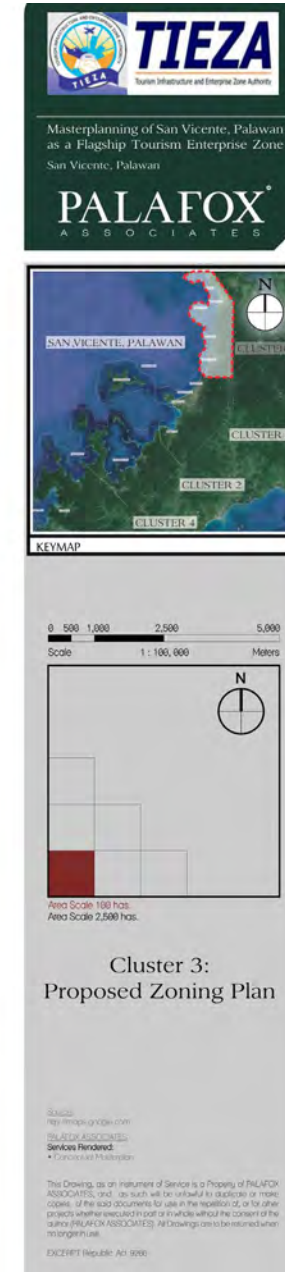

Site is Within Cluster 3 of the  
TEZ Development Zone

**A** – Site is in the Special Zone and complies with the master plan use for Resort and Tourist Facilities



## How Silent Resorts Supports the TIEZA Plan Goals

### Master Plan Conforms to the Cluster 3 Proposed Facilities Plan

**A** – The Master Plan provides for a Public Market and Commercial Development on the main Alimanguan National Highway as per the TIEZA Plan

**B** – The Master Plan provides for a Marina and Port to foster tourism development

**C** – The proposed Silent Catch Center at the Silent Marina will partner with the Lampingian Island Fish Sanctuary and the Alimanguan Fishing Village to support preservation and sustainable artisanal fishing and increase community income

**D** – Because all Silent Yachts are 100% solar electric, they can operate safely in sensitive sanctuaries and nature reserves. Silent Resorts will support the creation of Outposts in these area as envisioned in the TIEZA Plan.

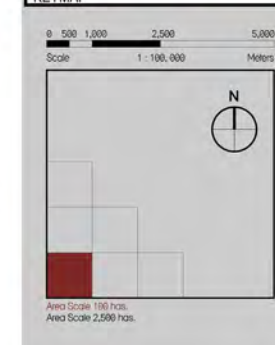
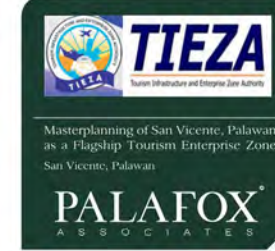
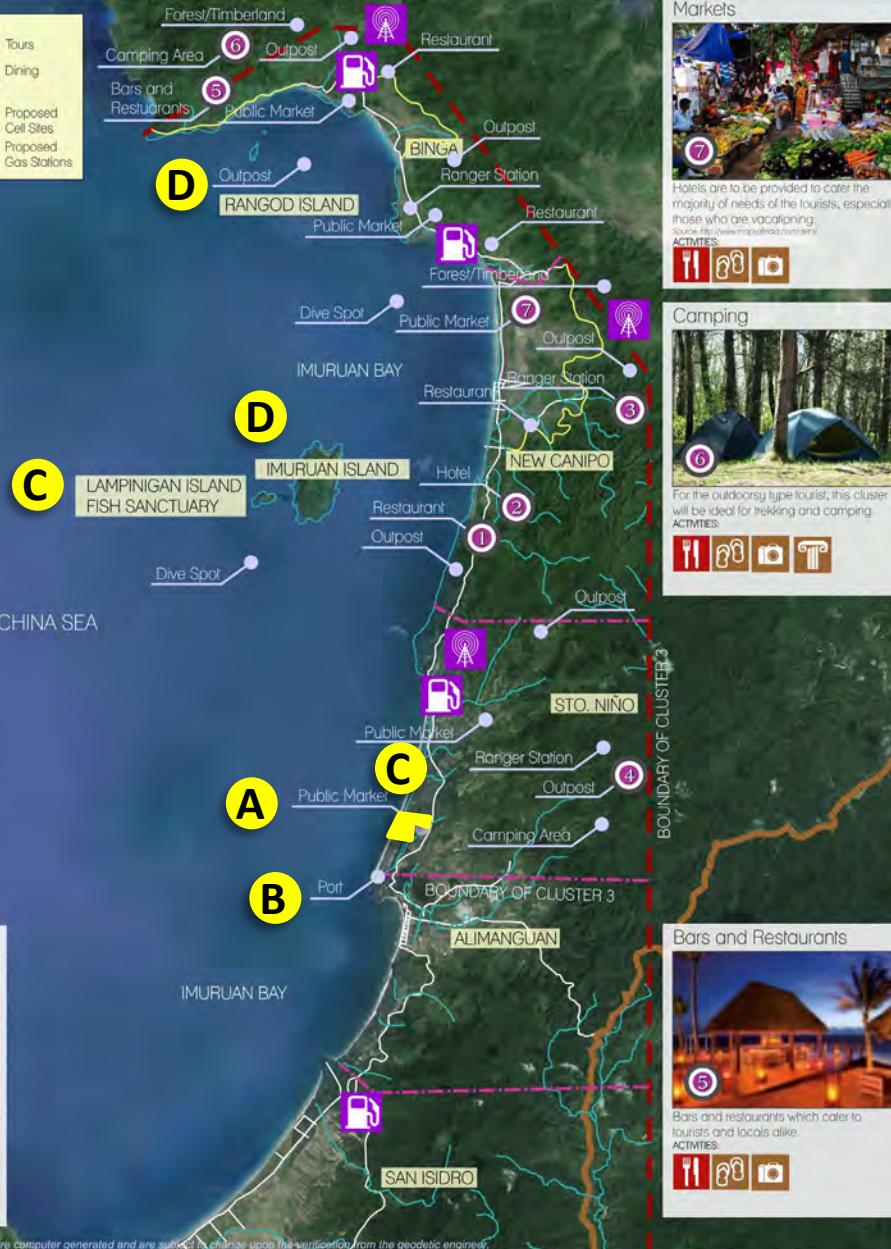



# Master Plan Attractions & Activities

## How Silent Resorts Supports the TIEZA Plan Goals

### Master Plan Supports the Cluster 3 Proposed Attractions and Activity Plan

**A** – The Silent Marina will provide for 100% electric yachts and tourist boat facilities to promote sustainable Island Hopping

**B** – The proposed Silent Catch Support Center also has a Dive Shop and professionals to operate responsible diving in the most sensitive areas.

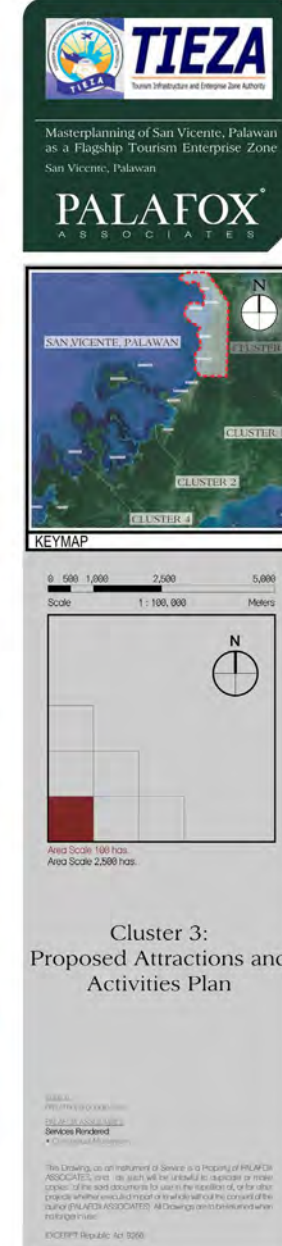
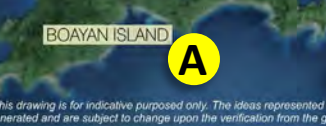

\*This drawing is for indicative purposes only. The ideas represented are subject to further study and change. All areas are computer generated and are subject to change upon the verification from the geodetic engineer.



# A NEW DEVELOPMENT MODEL – HIGH VALUE CREATION – ULTRA LOW ENVIRONMENTAL IMPACT

## BUSINESS PLAN

Silent Resorts' Residences, and Yachts are uniquely designed, constructed, and integrated within a self-sufficient ultra low-impact development and operations model will create a premium development that attracts a global clientele. Our project addresses the key metrics for measuring the sustainability and carbon footprint of a new development.

### Carbon Negative Construction

**Silent Resorts residences and other structures are built using our unique pre-engineered modular system:**

- Proven system utilizing sustainable harvest hardwood timber
- Near zero construction waste on site
- Controlled cost and build schedule
- On-site labor reduced to a minimum
- Our 4,000 square foot structural timber Silent Residences store over 264,000 pounds (132 tons) of carbon each, the equivalent of what would be released by burning 46,200 litres of diesel.
- A completed Silent Resort can potentially sequester over 5,000,000 pounds of carbon, the equivalent of 875,000 litres of diesel.

**SEQUESTER 2,500 Tons of Carbon**

### Zero Emissions Resort Operations

**Silent Resorts Islands operate on 100% solar energy:**

- Conventional island resorts depend on diesel fueled generators for power
- Silent Resorts uses a proprietary "Silent Solar Grid" that integrates the solar systems on the island with the solar systems on the yachts.
- This yacht/island power-sharing and balancing eliminates the need for back-up diesel generators
- Fuel Cell back-up power
- A diesel generator emits 2.5 pounds of carbon per kWh
- A Silent Resort will use an average of 750,000kWh of power per year, saving over 1,875,000 pounds of carbon, the equivalent to 330,000 litres of diesel.

**ELIMINATE 930 Tons of Carbon Emissions per Year**

### Ultra-Low Emissions Yachting

**Silent Resorts Yachts are 100% solar powered:**

- Silent Resorts yacht fleet is 100% solar/electric
- The yachts carry an emergency diesel generator to charge the batteries while at sea in the event of an extended period of low sun conditions or the need for extended high-speed cruising
- A 60 to 80-foot motor yacht running an average of 1,000 hours per year can burn 100,000 litres of diesel.
- Assuming a 95% diesel savings per yacht, a Silent Resort average fleet of 8 yachts can save up to 720,000 litres of diesel per year, or the equivalent to 4,000,000 pounds of carbon.

**SAVE 2,000 Tons of Carbon Emissions per Year**

## ECONOMIC IMPACT – FIRST LOCATION IN THE PHILIPPINES

Beyond the economic contributions over the next 5 years, the Silent Resorts Palawan location will attract global attention as the first in the world, opening the way for positioning the Philippines as a leading destination for future like-minded development, which we believe is going to be where the future investment in the hospitality and island development will be focused. In addition, the new technologies, capacity building, training methods, and global partnerships that Silent Resorts will bring to the Philippine people will, with no doubt, encourage spin-off businesses. Finally, we believe that Silent Catch will create another opportunity for Palawan to be on the forefront of global fishing sustainability and sensitive ocean environments protection.







# SILENT RESIDENCES

## RESIDENCE DESIGN

Silent Residences will range from 3 to 6 bedrooms. The design incorporates the following key features:

- To better respect the island topology, our residence designs are linear to allow the construction to follow the natural contours of the sloping land.
- The residences are one-story, and the ceiling heights are 10 to 12 feet to provide for enhanced ventilation and light
- All bedrooms are en-suite with private work desks and ample closets for long term stays
- Utilities and storage will be in 20-foot shipping containers that will be located below the residence and not visible. These steel containers provide secure storage and shelter during any storm event.
- The structural timber frame and opening protection will be designed to withstand a CAT 4 hurricane, and heavy timber is naturally insect and fire resistant.
- Solar panels will be located on the flat roof areas and shielded from view.
- Roof areas that do not have solar panels will be fitted with a “living roof” system
- All lighting is controlled by a Silent Residence Smart House App. Only warm white color LED lighting is used. Exterior lighting will be “Dark Sky” compliant.

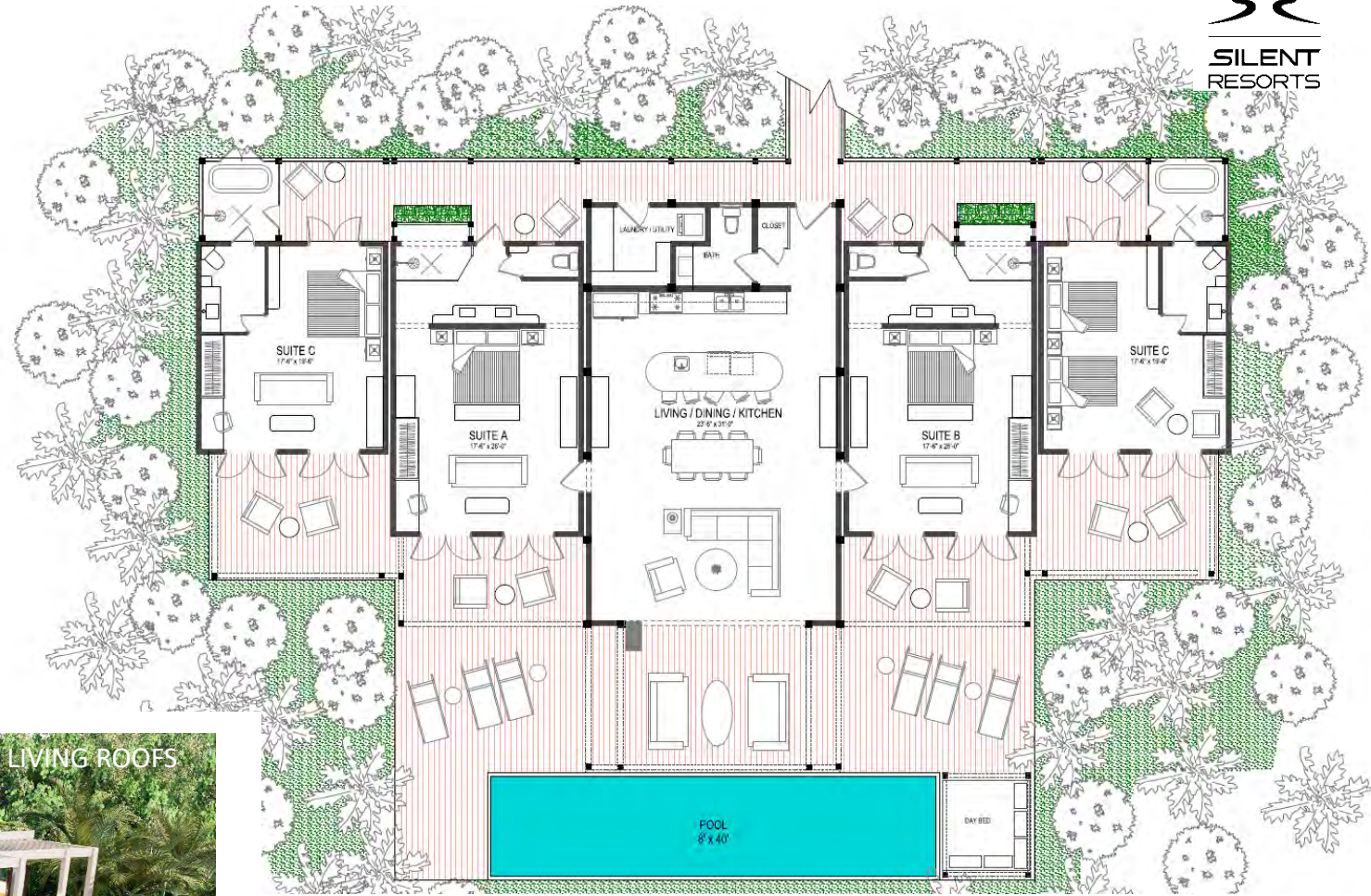



# SILENT RESIDENCES

## INTERIOR DESIGN

Silent Residence interiors are handcrafted from all natural materials, including cotton fabrics and reclaimed wood.

- Island inspired tropical designs from Bali and the Caribbean
- Solid wood cabinetry uses no artificial materials or fiberboard
- Durable stainless-steel appliances
- Energy efficient induction cooktops are standard
- Silent Residences will have Smart Kitchens





# CONSTRUCTION & INFRASTRUCTURE

## SUSTAINABLE HARVEST TROPICAL HARDWOOD HEAVY TIMBER CONSTRUCTION

Silent Resorts’ residences and other structures are built using our unique pre-engineered modular system:

- Proven system utilizing sustainable harvest hardwood timber
- Near zero construction waste on site
- Controlled cost and build schedule
- Efficient use of skilled on-site labor
- Our 4,000 square foot structural timber Silent Residences store over 264,000 pounds (132 tons) of carbon each, the equivalent of what would be released by burning 46,200 litres of diesel.
- The completed Silent Resort can sequester over 10,000,000 pounds of carbon, the equivalent of 1,750,000 litres of diesel.

## QUALITY EMPLOYMENT, NEW SKILLS, AND NEW OPPORTUNITIES

Silent Resorts is committed to building in the most ecologically sensitive and efficient way possible. During the construction of the resort, Silent Resorts and our building technology partners will be looking to create long term relationships with local Bahamian companies and entrepreneurs to bring these technologies and methods to the greater Bahamas market.

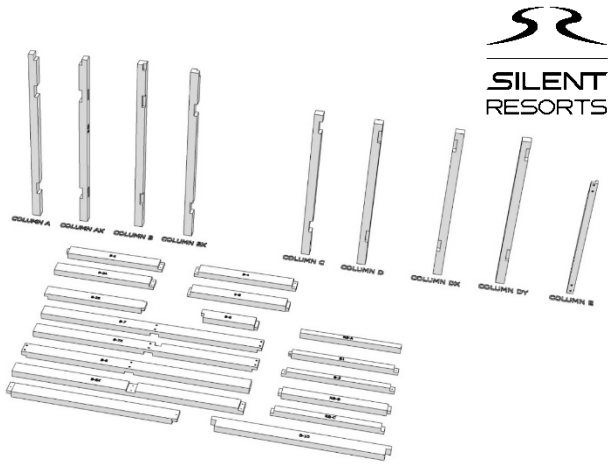
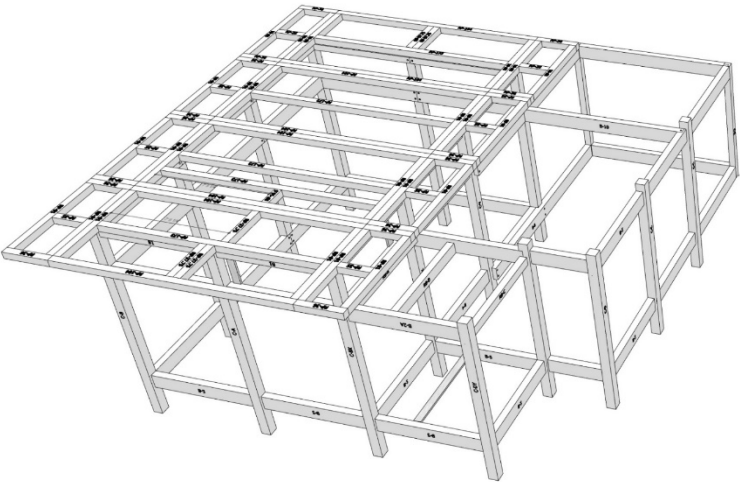

## CARBON NEGATIVE CONSTRUCTION

As opposed to concrete, steel, and aluminum, which are all extremely energy intensive and are among the biggest contributors to greenhouse gas emissions and global warming, heavy timber is actually “carbon negative”. Trees removes carbon dioxide from the air and for as long as those trees are not burned or decay on the forest floor, they hold that carbon forever. As the numbers above to the left, our sustainably harvested timber takes that carbon out of the air and allows for new trees to grow and absorb more carbon, reducing atmospheric CO2.





# CONSTRUCTION & INFRASTRUCTURE

## TREAD LIGHTLY AMENITY DESIGN

The resort Beach Club, Spa, and Restaurant amenities will be uniquely construction in our signature *"Tent & Timber"* buildings.

Made of the highest quality natural fabrics, bamboo, and timber, these structures are very light in their impact to the environment yet engineered to withstand the tropical environment.

Built to withstand tropical storm winds, and with a 20-year canvas guarantee, in the event of a hurricane, fabrics and furnishings can be removed, and the steel frame structure is designed to withstand all but the strongest of gales.





# CONSTRUCTION & INFRASTRUCTURE

## MINIMIZING THE USE OF CONCRETE

The traditional construction of pools use lots of concrete, needs extensive foundations and excavation, steel reinforcement, and produce lots of construction waste.

Silent Resorts pools are made from recycled shipping containers and are completely self-contained with all pumps, filtration, and electronics. The pool is set on piers just like the residences and integrated into the topology and landscape with no excavation or fill.



TRADITIONAL POOL CONSTRUCTION



MODULAR POOL INSTALLATION





# CONSTRUCTION & INFRASTRUCTURE

## INTEGRATED HIGH OUTPUT SOLAR ELECTRIC SYSTEMS

Silent Resorts residences, marina, and island infrastructure is fully powered by the same technology used on its fleet of Silent Yachts.

All residences and yachts will be connected to the Silent Island Grid, and yachts will share power with the island and visa versa as needed.

## THE FIRST RESIDENTIAL HYDROGEN BATTERY BACK-UP SYSTEM

Silent Resorts has partnered with LAVO Systems, a patented safe, clean, hydrogen battery backup system, eliminating the need for any fossil fuel powered back-up generators.

LAVO converts the energy from the solar panels into hydrogen, and stores it in a revolutionary low-pressure system, which safely & reliably produces 40kWh of back up power if needed,



### The LAVO™ Energy Storage System

Developed in partnership with UNSW and Design + Industry, LAVO™ is a hydrogen hybrid battery that stores over 40KWh of electricity – enough to power the average Australian home for 2 days. Integrating with standard rooftop solar, LAVO™ generates green hydrogen for renewable power when you need it.

### The Hydrogen Hydride

The LAVO™ uses innovative, patented metal hydride to produce batteries that last three times longer than lithium batteries at a similar price. This unique hydride is energy efficient, carbon neutral, safe, non-flammable, and designed for all components to be recycled.

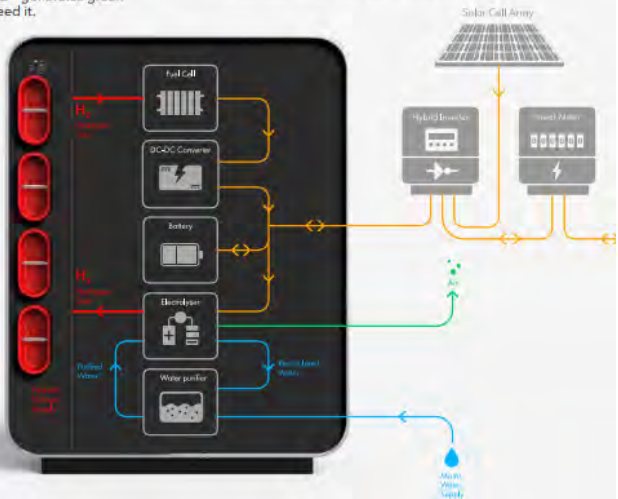

The LAVO™ patented hydride absorbs hydrogen in metal alloy to enable safe, long term storage within a secure vessel. Sustainable energy for you home and business.





# CONSTRUCTION & INFRASTRUCTURE

## MANAGED HIGH EFFICIENCY WATER PURIFICATION

The is no surface water on the proposed site. The resort water supply will be obtained by carefully managing both fresh ground water extraction and reverse osmosis of brackish water resources.

A full island water resources study and test wells will be commissioned to assess the available supply and to assure that any freshwater extraction is balanced with annual natural aquifer recharging and will not cause any salinization of the fresh water “lens” under the island.

Groundwater resources on islands subject to possible contamination during storm surge events. Our water system will be able to produce water directly from sea water if ever required.

Water desalination and purification will be by very high efficiency marine grade equipment that has been proven to be robust and energy efficient. All water processing systems and pumps will be powered by solar electric.

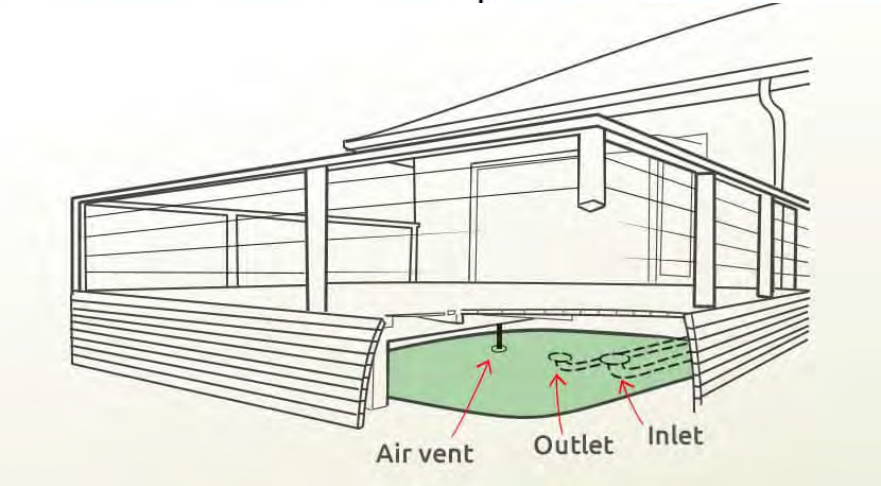
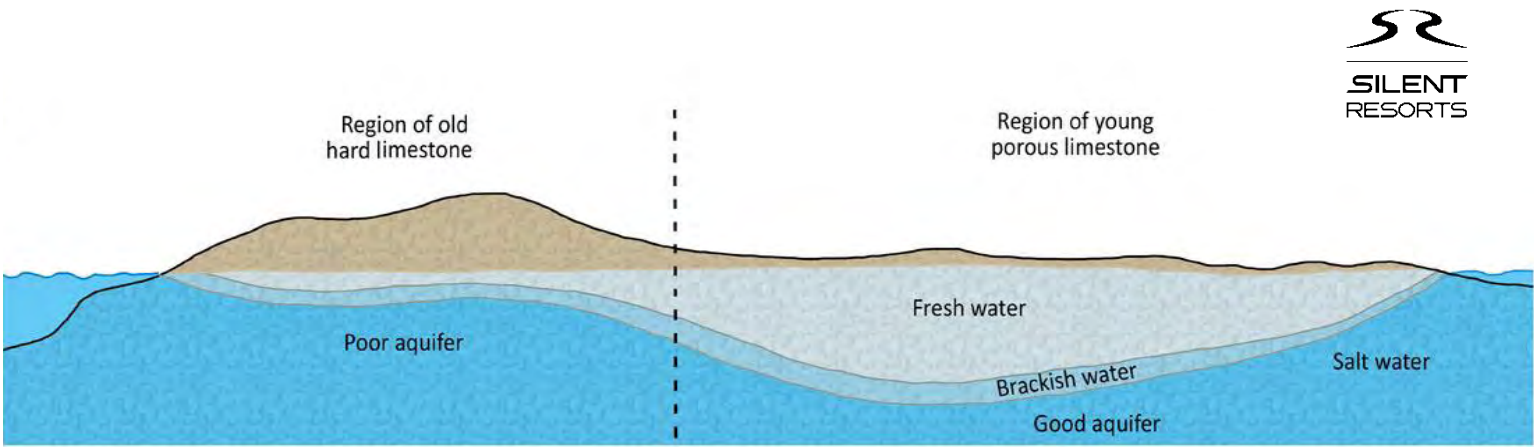

## NON-INVASIVE WATER STORAGE

Water storage will be in “bladder tanks”, which as far more efficient and less destructive to the exiting topology than traditional subsurface concrete water tanks.

Each residence and other buildings will have its own water storage under covered decks, as not to be visible or exposed to the elements.

Bladder tanks have a lifespan of 30+ years and can be recycled.



Home | Yacht Series | Marine Systems | Land Based Systems | Dealers | Contact Us | Boat Shows

## On-shore Desalination / Land Based Systems



Vertical Mount System  
7000-BHL-4

The BHL Series has been especially designed for small Hotels, Marinas and Waterfront Homes with access to salt or brackish water and where supplying clean water can be logistically complex and expensive.

The high power efficiency, ultimate reliability and low maintenance cost of these desalination systems makes high quality fresh water in many cases more economical than municipal water where available.

The newly engineered marine aluminum frame provides tidy appearance while allowing easy access to the systems components for maintenance.

The modular wall mount systems or the self-contained vertical framed systems are space saving and almost turnkey so that people without engineering backgrounds can install them.

For freshwater capacities of a multiple of 7,000 GPD / 26,495 Liters, the installation of any number of redundant operative BHL desalination modules can produce unlimited output.



# CONSTRUCTION & INFRASTRUCTURE

## ZERO POWER ADVANCED WASTEWATER TREATMENT SYSTEM

The BIOROCK system used throughout our development is totally silent, odorless, calls for minimal annual maintenance, and is barely visible. The resulting water is 100% recycled for irrigation of landscape and organic gardens.

Again, in keeping with our methodology of no excavation or filling on the island, the wastewater treatment systems will be located under the raised structures. There are no in-ground septic systems that can leak into and pollute ground water.

Like our solar electric and water purification systems, the wastewater treatment is modular and fully redundant, while fully scalable to provide service for the entire resort as it is fully built out.

As indicated in the chart below, BIOROCK has the smallest footprint, and highest treatment efficiency of any sewerage treatment system.

**BIOROCK has the lowest footprint requirement in M<sup>2</sup>/PE in its category**

Source : Irstea (French National Institute of Research in Science and Technologies)



**BIOROCK has the highest treatment efficiency for BOD5 reduction**

Source : Irstea (French National Institute of Research in Science and Technologies)

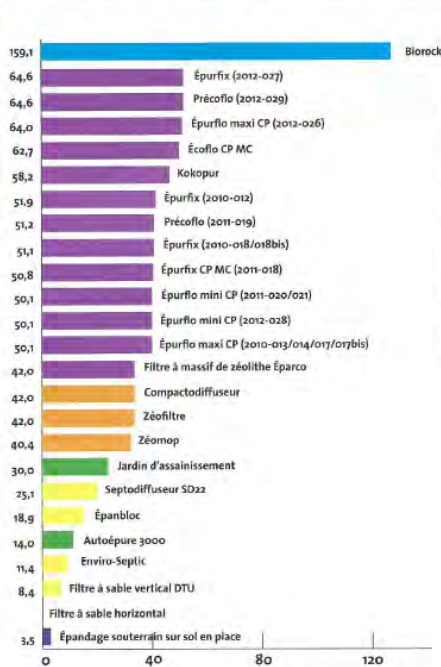

## THE COST SAVING WASTEWATER TREATMENT SOLUTIONS

BIOROCK offers a unique, innovative solution to eco-friendly water treatment. With the industry's lowest operational costs and longest emptying intervals, BIOROCK is a valuable, worthwhile investment for your home or establishment.



## ECOROCK, A Non-Electric Two Stages Wastewater Treatment Plant

The ECOROCK unit is a small-sized wastewater treatment plant that caters from 6 to 30 persons application. The ECOROCK-system functions as a **two-stages treatment plant**. The raw sewage first enters a Primary tank to provide pre-separation and initial breakdown of organic solids. The wastewater then passes through an effluent filter before discharging into the BIOROCK unit itself which incorporates the aerobic filtration process.

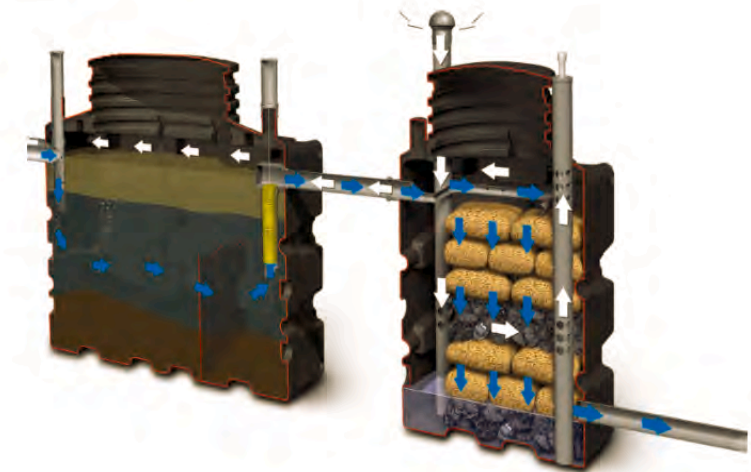



ZERO EMISSIONS LUXURY YACHTING

Silent Resorts is the first in the world to utilize an all-electric fleet of luxury yachts, water taxis, and day boats. Silent Resorts has partnered with the worlds only proven and production solar yacht builder to bring the very first of the next-generation 100% solar-electric Tri-Deck super yachts to the Bahamas.

Silent Resorts guests will be able to explore the island’s surrounding waters, coves, secluded, and pristine beaches in silence, luxury, and completely fossil fuel free.

Silent Resorts will have an international fleet of 8 to 10 Silent Yachts, both 60- and 80-foot models for charter use in the Bahamas.

A new Silent 100-foot super yacht is in design development and the first unit will be launched in 2024.

### SILENT ADVANTAGES



UNLIMITED  
RANGE



SAFEST MARINE  
PROPULSION  
SYSTEM



ZERO  
EMISSION



VIRTUALLY NO  
MAINTENANCE



NOISELESS  
CRUISING

### SILENT ASSURANCES

8

Battery banks  
8 years warranty

25

Solar panels  
25 years warranty

Lifetime

Electric motors  
lifetime warranty

CE-A

CE-A  
certification

Trans-ocean

Ocean crossing  
capabilities



# SOLAR YACHTS AND ELECTRIC BOATS

THE SILENT 60 LUXURY SOLAR CRUISER

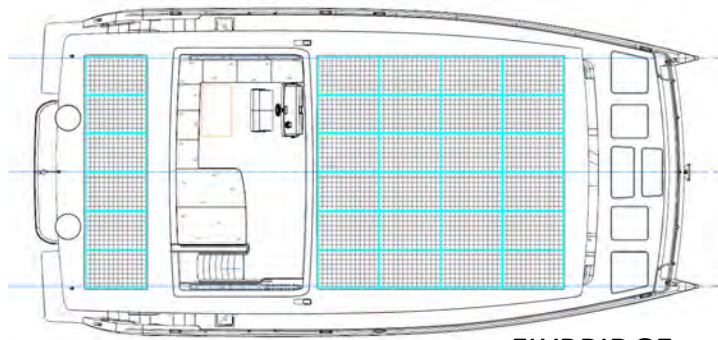

FLYBRIDGE

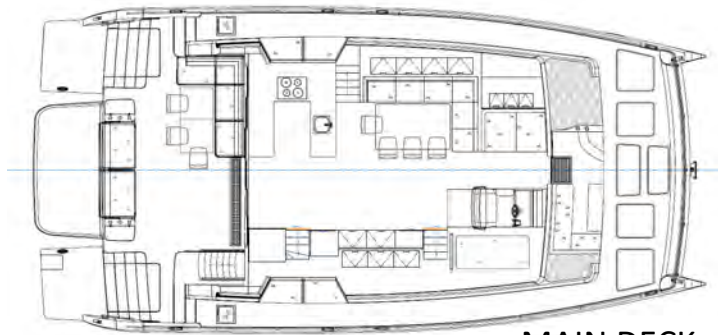

MAIN DECK



LOWER DECK



SILENT RESORTS 60 – Tri-Deck





# SOLAR YACHTS AND ELECTRIC BOATS

THE SILENT 80 SUPER YACHT SOLAR CRUISER



FLYBRIDGE

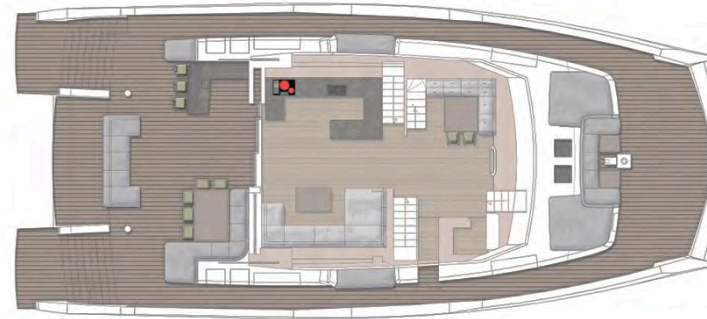

MAIN DECK



LOWER DECK



SILENT RESORTS 80 – Tri-Deck





# SOLAR YACHTS AND ELECTRIC BOATS

## THE XSHORE ALL-ELECTRIC DAYBOAT

Our first XShore is scheduled to arrive in the Bahamas in February. From its 100% electric motor to the low impact materials it's built with, the XShore embodies the start of a more sustainable maritime tradition. With electric power, toxic fumes and disruptive noises vanish, and it produces no carbon footprint compared to fossil fuel engines, which helps combat climate change. In keeping with Silent Resorts low impact approach, the hull is made from flax fiber, recycled materials, and the deck covered in cork that is superior in function and sustainability.

As part of our commitment and contribution to ocean health and sustainability, the Silent Resorts XShore fleet will be fitted with a built-in Sea Lab, collecting environmental data from the waters we cruise in, such as the PH, salinity, and oxygen levels and sending it to our environmental partners in real-time.

All guests and hospitality staff will be shuttled to the resort and back from George Town in our electric boats.

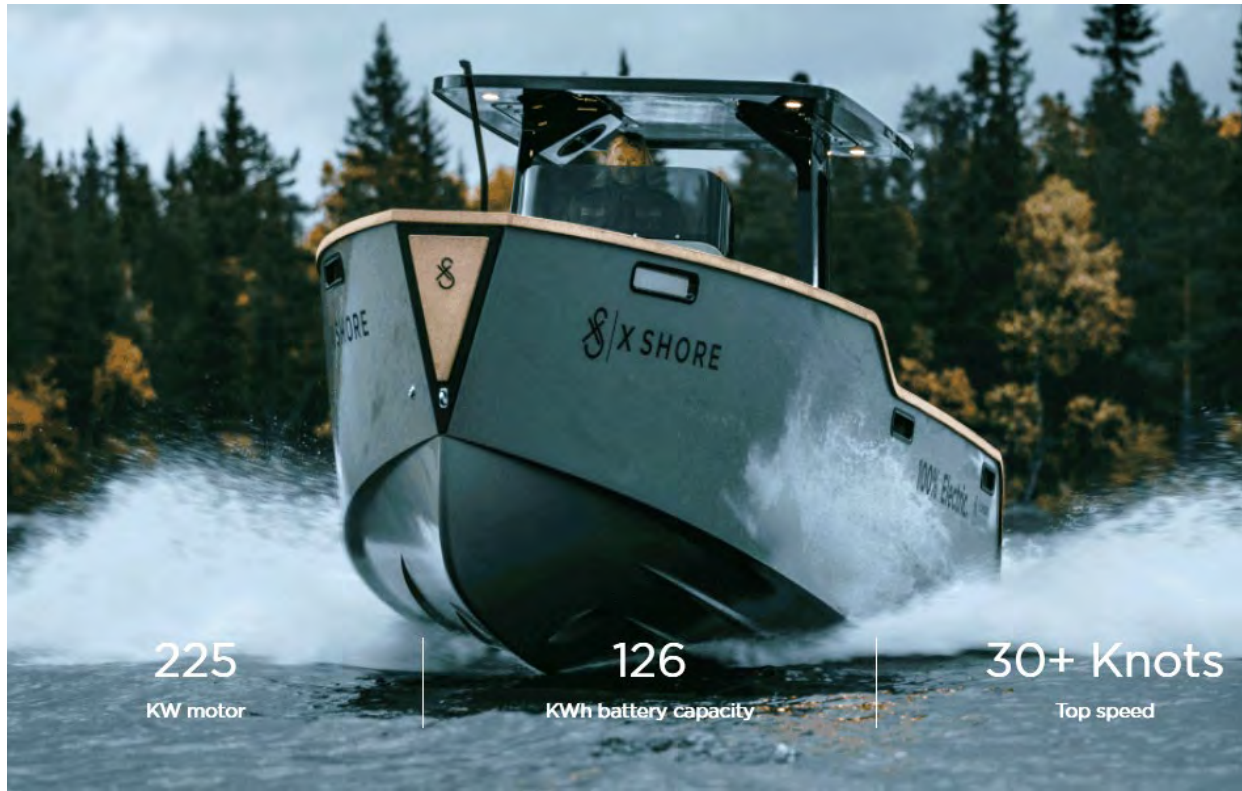



## ENVIRONMENTAL IMPACT, MITIGATION, & SUPPORT

As indicated in the previous sections, the environmental impact to the local flora, fauna, and surrounding waters is extremely low. Key points that would normally need to be mitigated and studied as to the effect on the environment for typical development projects are addressed as follows:

- **Removal, cutting, and clearing of native vegetation that affect wildlife habitats**
  - All structures will be built on point-load piers which will be anchored to the natural rock of the island with minimal excavation for setting of piers
  - The trees and plants under the new structures will be trimmed down and left in place. Only selected areas for the installation of water storage and utilities under the structure will be leveled and covered. This coverage amount to just over 9% of the total site land area.
- **Excavation and filling that will alter the current run-off and stormwater drainage**
  - No change the island topography is required. All new construction will be elevated, and the current drainage and runoff characteristics will not be materially changed.
- **Roadwork that will create impervious surfaces, increased run off**
  - All new access roads will be private and limited to 12 feet in width. Material will be the local stone for and shaping and contouring required and covered with a permeable local sand/gravel mix. No concrete or asphalt will be used.
- **Retaining walls, large foundations structures, and raised roadways that will impede the free movement of ground dwelling animals**
  - No area of the island will be blocked or made impassable to the native ground dwelling animals on the island.
- **Overwater docks and structures that will shade and disturb the seabed**
  - No new overwater docks, piers, or pilings will be constructed.
- **Clearing of mangroves**
  - No clearing of mangroves will be conducted. All existing mangrove areas will be preserved as nature habitat.
- **Reshaping beaches or the construction of rock jetties and breakwaters**
  - No construction activity of any kind, temporary or permanent will be conducted on any beaches. No breakwaters, jetties, or rock abutments will be constructed into the surrounding waters
- **Insensitive multi-story construction that will be visually intrusive**
  - All construction will be limited to 1 story and placed within the landscape and topology to respect the views to and from the island.
- **Construction on top of dunes, hilltops, or in wetlands**
  - No construction will take place on dunes, or over wetlands. All buildings will be located below the highest elevations on the island as to not break the natural top ridge of the island. An existing observation tower/platform will be repaired and will not exceed a size of 20ft x 20ft nor a height of 20ft above the island's highest natural elevation.
- **Protected and invasive plant species**
  - A full island inventory of the existing trees and plants will be conducted, and the masterplan adjusted as required. Initial surveys have found Buttonwood groves on the island, and these will be preserved as indicated on the master plan. Invasive species will be dealt with in the manner recommended by the Forestry Department.
  - An extensive area of the island has been designated as permanent reserve and will be used as to relocate any protected species if it is needed.



## A FRESH APPROACH TO SUPPORT THE WORLD'S OCEANS

Silent Resorts will contribute 1% of all sales revenues, plus a annual on-going contribution from resort operations to a newly formed local division for Silent Catch, the global non-profit initiative of Silent Resorts. The Silent Catch mission is to deliver innovative, scalable solutions with environmental, economic, and equitable impact in the world's fishing communities. The 5-year sales projection for the project would indicate a contribution of over \$1,000,000, plus additional donations and funding from partners and international organizations.

Silent Catch will establish its first dockside facility at George Town, Exuma, with the goal of supporting the following activities:

- **Mangrove Preservation & Education** - Protect the mangroves of the Exumas and educate the public and developers of the importance of protecting existing mangroves, and the benefits of enhancing their presence.
- **Reef Protection and Restoration** - Partner with organizations and government agencies dedicated to preserving Bahamas endangered reefs, and to fund the creation of new artificial reefs using the latest technology and techniques. To this end, Silent Resorts as already funded a study of the reef, seabed, and water conditions around Elisabeth Island. A copy of which is submitted with this proposal.
- **Local Fishing Fleet Electrification** – The number one cost of going out to catch local fish is fuel and followed then only by the cost of maintaining gas and diesel engine in the harsh seaside environment. Silent Catch technology and infrastructure will support the electrification of the local and artisanal fishing fleet, for healthier, more sustainable, and more profitable fishing, and create a global example of excellence.
- **Silent Caught Premium Fish Marketing** – Silent Catch will encourage the local fishing community and entrepreneurs to develop a local and international market for fish caught and processed using the all-electric artisanal fleet, and create a premium brand, “*Silent Caught Bahamas*” that will provide enhanced income for the local community.

The Silent Catch is designed to fund the employment of the local team to manage the above services and provide free solar powered charging of the electrified fleet, and refrigeration to keep the catch fresh.



# Silent Resorts Growth Plan

6 YEARS

12 ISLANDS

192 RESIDENCES

96 YACHTS

2,880 OWNERS  
INVESTING IN  
EXPERIENCE

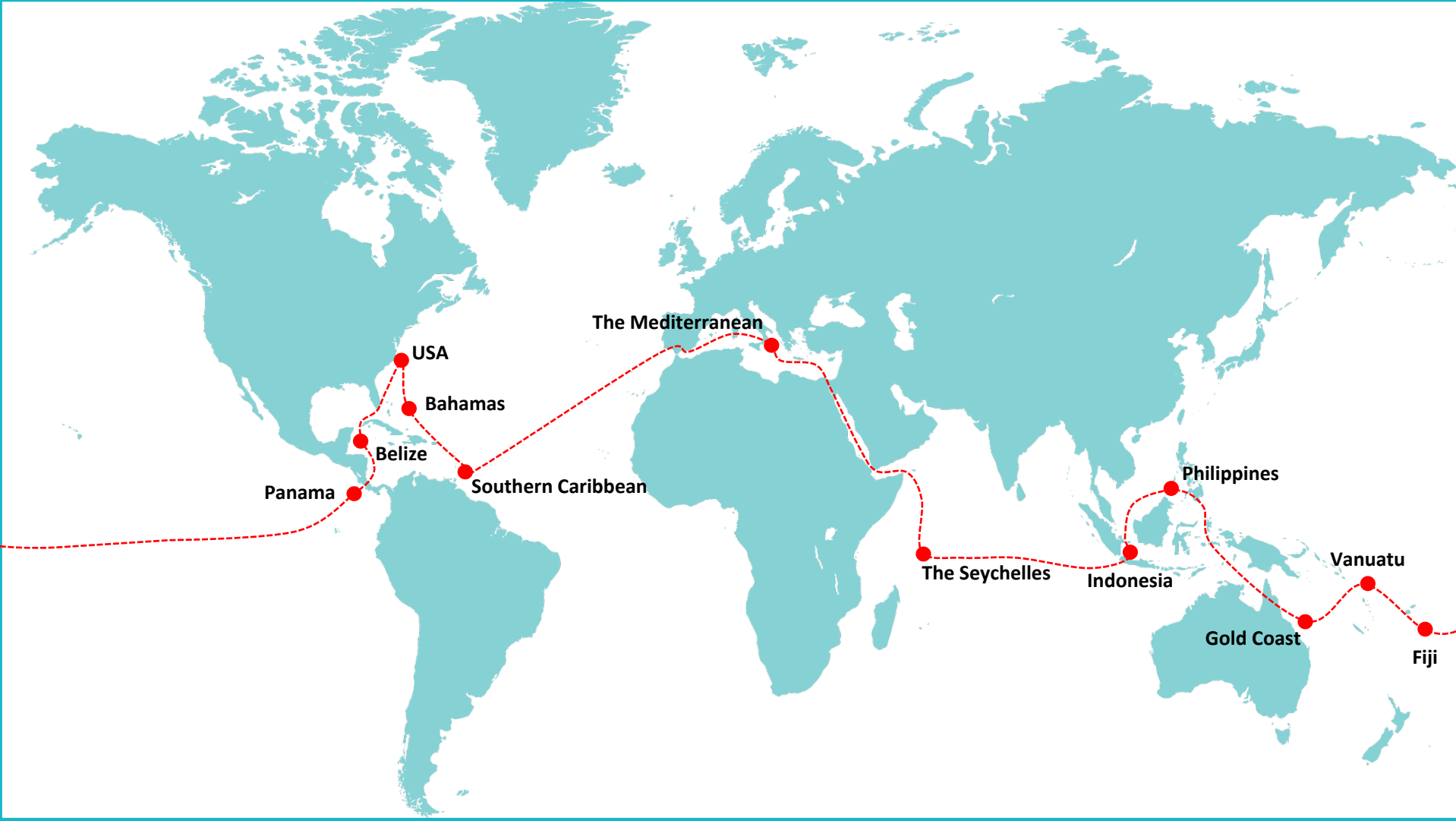

Live Fully | Tread Lightly | Stay Silently





# SILENT RESORTS TAKES FIRST STEPS

*Building on the solar technology developed for Silent-Yachts catamarans, Silent Resorts is launching its first yacht-and-Residence retreat in the Caribbean, while Asia is in the plans as the new company looks to grow a global network of exclusive, eco-friendly holiday destinations.*

WORDS NICK HUNG PHOTOS SILENT RESORTS



SILENT-RESORTS

# IN THE NEWS





*Silent Resorts developments feature beachfront Residences, common facilities like a clubhouse, pool and spa, a docking system and Silent-Yachts solar-electric catamarans*

As the world leader in solar-electric luxury catamarans, Silent-Yachts has displayed a particularly global vision. The brand's Silent 55 is built in China. Its new Silent 60 is being built in Thailand. And several units of its future flagship 80 are under construction in Italy, where more 60s are being built to cope with demand for what's already the brand's best-selling model.

Yet before hull one of either the 60 or 80 have touched water, Austrian Michael Kohler, the company's founder and CEO, has joined forces with American architect Victor Barrett to create Silent Resorts. Their mission? To develop solar-powered beachfront resorts featuring Silent catamarans as floating Residences.

Designed to be sustainable, eco-friendly and built with a 'light touch', these resorts are more than just a cute concept. They're happening, starting in the Bahamas with the 30-acre Silent Island located in the district of North Eleuthera, which has its own airport and is a 55-minute flight east of Miami.

Barrett, CEO of Silent Resorts, says Silent Island will accommodate eight catamarans at sea and 16 Residences on land, with the first few units scheduled to be ready by late 2021.

The forward-thinking property will include a clubhouse, spa, pool and water toys, all eco-friendly as per the company's tagline: 'Live Fully, Tread Lightly, Stay Silently'.

Silent-Yachts' luxurious 60 and 80 catamarans, measuring 18m and 24m respectively, each have four guest cabins with ensuite bathrooms, a large saloon, dining area and galley, as well as outdoor

social areas in the aft cockpit and on the foredeck and flybridge. At any time, guests staying on the catamarans are free to set off on a cruise and start exploring the surrounding region, whether for a few hours, few days or few weeks.

Along with its catamarans, Silent-Yachts is supplying the solar-electric technology that will power the Residences, communal facilities and infrastructure for a fully integrated, carbon-free property.



"You can start your vacation on the yacht and finish in a Residence, if you want, or the other way around," Barrett says. "The power systems on the Residences and yachts are matched, so they can balance themselves. When a yacht pulls up to the resort, they can plug in for power or transfer excess power to the island. It's a very symbiotic and balanced system."

In fact, the designs of the catamarans have even influenced the new Residence concepts, according to Barrett.

"We're designing the one-storey Residences to mirror the catamaran layout, with suites on either side of a big, open living room and kitchen in the middle. You can also have a staircase to the sunset deck or 'flybridge' on top, very similar to the way the catamarans are laid out," he says.

#### MEETING OF MINDS

Like Kohler, Barrett has a very global outlook and his recent bases have included landlocked Austria and the African island nation of Mauritius, where he founded his company TrueDesign.

The globetrotting American has worked on projects in North



*Michael Kohler (left), founder and CEO of Silent-Yachts and co-founder of Silent Resorts; Victor Barrett (middle), co-founder and CEO of Silent Resorts; 'Silent Island' (right) in the Bahamas*

and Central America, the Caribbean, Middle East, Africa and Asia, including in Indonesia and China, where he spent two years as a Senior Architectural Designer for Atkins a decade ago.

Having helped develop high-end resorts for the likes of Six Senses, Como and Aman, he was recently working for the TradeWinds yacht charter company, building a beach club in the southern Caribbean until Covid-19 halted its development early this year.

It was then he returned to Austria and pitched his idea for Silent Resorts to Kohler, having become aware of Silent-Yachts while the pioneering yacht builder was exhibiting at a boat show in Miami.

"I was thinking of better ways to build resorts on islands," Barrett said. "That's when I called Michael and proposed we use his yachts as Residences for these beautiful, remote locations, so we don't really damage the islands."

Kohler was receptive to the concept, having previously approached multiple luxury resorts with the idea of buying Silent catamarans to use as an added attraction for guests and extra rooms when required.

"When Victor told me more about his idea, I was very happy because it was a better version of what we were previously trying to do with resorts," Kohler said. "This time, it's not working with an existing facility that has already had a negative environmental impact on the island, as you see so often."

Silent Resorts offers a flexible build solution that includes pre-engineered Residences and other structures, while even the Residence pools are modular, made in Canada. Land-based infrastructure, such as

water purification, wastewater processing and solar-power systems, is containerised.

The Residences at the first resort in the Caribbean will be built from sustainable hardwood and prepared in Belize – another country Barrett has worked in – while there will also be components from Indonesia for interiors and furniture.

The floating docking system is also modular, while the Silent catamarans can be shipped in or make their own way, depending on where they're coming from, before serving as sustainable floating Residences.

"With Silent Resorts, we have a green approach from the start," Kohler says. "All the components of one Residence are in one container. We put it together and there's no waste material, nothing to contaminate the island or bay. We can take it away at any time, which is what we mean when we describe the resorts as 'reversible'."

"It's a much more flexible system, with almost no negative impact on the environment. Whatever we bring, we can remove. Victor's idea was very, very smart and is a perfect match for our Silent catamarans."

#### GLOBAL MEMBERSHIP

Silent Resorts is based on a membership model, so each member has access to the resort and future sister facilities for six weeks a year, and is effectively a part-owner of the property, including the catamarans.

Joining fees will range from about US\$300,000 to US\$500,000,

*Silent Resorts uses the same solar-electric technology used by Silent-Yachts, with catamarans and Residences drawing from the power grid and also*

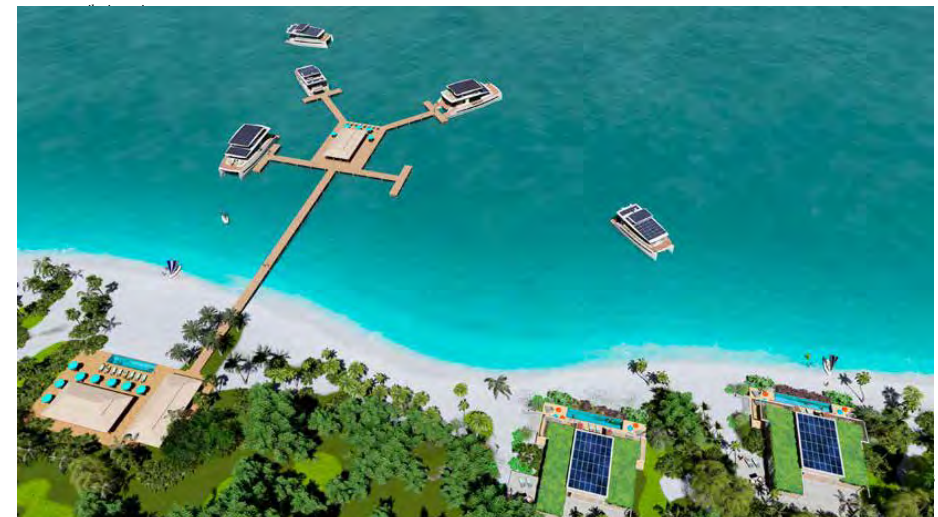





Starting in the Caribbean, Silent Resorts is looking to grow its network of beachfront yacht-and-Residence resorts across the globe, including in Asia.

with annual fees on top, although Barrett says they will be minimal compared to other properties due to the low-maintenance nature of both the resort and the catamarans.

"A member can say, I'm coming for 10 days and I want to spend five days in the Residence and five on a yacht. That yacht can move around, stay in a cove overnight, go where you want in the region," he says.

"From Silent Island, there are thousands of islands nearby like the Exumas and you can choose your itinerary each day. The guest experience at Silent Resorts will be unique."

Conceived during the Covid-19 era, the Silent Resorts model also fits with what Barrett believes will be a growing emphasis on quality, experience and duration for luxury travel.

"We believe people will take fewer vacations, but that holidays will be longer and of a higher quality. It won't be unusual for people to travel for two or three weeks," he says.



As well as a place for catamarans to berth, the docking system has the potential to provide on-water facilities.

"Due to Covid, I think the growth areas in luxury tourism are going to be yachts, private islands, private Residences and private aircraft, rather than the traditional hotels and resorts."

Along with getting the first resort up and running by next year, Silent Resorts is also looking to build its network across the globe and is scouting for suitable sites at idyllic beachfront and island locations. The company states that a turnkey resort can be operational in 18 months or less in any location worldwide.

"The plan is to have five more resorts around the globe within five years and when you become a member of one location, you can use any of the locations," Barrett says.

"For the Bahamas resort, the US is an obvious target market for members, but we're getting interest from all over the world. Europe is the next big market for such members, so we're also looking for a site in the Mediterranean and maybe the Middle East.

"We then want to circumnavigate the globe, so we're considering Asia – especially Indonesia – as well as Australia, New Zealand, Fiji and the South Pacific."

Only a few years ago, Silent-Yachts' proposition of 100 per cent solar-powered catamarans seemed admirable but ambitious, too niche to sustain mass production. However, the company's huge increase in sales over the past year or so have shown that such technology is becoming increasingly sought after by conscientious owners.

Barrett is similarly confident that Silent Resorts will lead the way in sustainable beachfront destinations and says the initial feedback has been encouraging.

"The appeal of 100 per cent solar-powered, green resorts in beautiful destinations, responsibly developed and managed, connecting the worlds of luxury yachting and luxury Residences, is very powerful," he says.

"And in terms of what we're doing, there's zero competition. We're the first."

[www.silent-resorts.com](http://www.silent-resorts.com)

[www.silent-yachts.com](http://www.silent-yachts.com)



Imagine, instead of a beachside Residence on a private island, having a floating catamaran as your abode. Not only can you sleep peacefully with the water lapping against the hulls—cats are known for their stability—but you can take the yacht off the dock during the day to visit empty coves or nearby islands. That fantasy could soon become reality if the concept proposed by Silent-Yachts comes to fruition. The Austrian builder of solar-powered luxury catamarans has a plan to position its 60- and 80-footers on different ends of a floating dock, with a hospitality center as its axis point. The setup would provide a measure of privacy (ideal in these Covid-19 times) but also access to the water and any landside facilities.

The concept is to use the catamarans—with their large staterooms, chef's kitchen, terrace and sundeck—as mobile Residences. Because the interiors are high end and solar-powered, the Residences are sustainable, but guests will enjoy paradise without compromising on luxury or the environment.

"The new project is aligned with our strategy to deliver a sustainable, completely silent, fossil-free leisure experience to clients," said Michael Köhler, founder and CEO of Silent-Yachts. "We provide a floating luxury adventure resort, an experience like no other."

As with the yachts, the "land and sea" resorts will run on solar power, with amenities such as a restaurant, pool, clubhouse, gym and spa, as well as hardwood timber suites on the beach. The resorts can be operational in 18 months anywhere in the world.

The real beauty for boaters is that they can leave the docks at any point during their stay and do a cruise of local waters or drop anchor in pristine coves. They can also visit neighboring islands for a truly mobile luxury vacation. "The beauty of this idea is that their room travels with them during their stay," says Köhler.



An aerial view of a tropical resort. A long wooden pier extends from a sandy beach into the turquoise ocean. Several large white yachts are docked at the pier, and a small sailboat is nearby. The beach is lined with palm trees and lush greenery. In the foreground, there are two large white buildings with thatched roofs, a swimming pool, and lounge chairs with blue umbrellas.

Invest in Experience



**SILENT-RESORTS**

[www.silent-resorts.com](http://www.silent-resorts.com)