



Republic of the Philippines
Department of Environment and Natural Resources
MINES AND GEOSCIENCES BUREAU
MIMAROPA Region

7/F DENR Building, 1515 Roxas Boulevard, Ermita, Manila
Telefax No. (+632) 536-0215 / (+632) 310-1369
Email: region4b@mgb.gov.ph



06 January 2022

MEMORANDUM

FOR : **The Regional Executive Director**
Department of Environment and Natural Resources Office
MIMAROPA Region

ATTENTION : **The PENR Officer**
Provincial Environment and Natural Resources Office
Province of Palawan

The CENR Officer
CENRO - Puerto Princesa City
Province of Palawan

The CENR Officer
CENRO - Brooke's Point
Province of Palawan

FROM : **The Regional Director**
This Office

SUBJECT : **Request for Technical Conference Concerning the Land Dispute Between Mr. Antonio L. Baguinsa and the Mineral Production Sharing Agreement No. 213-2005-IVB**

This has reference to the above-cited subject involving the encroachment of the mining contract area under Mineral Production Sharing Agreement (MPSA) No. 213-2005-IVB granted to Rio Tuba Nickel Mining Corp. at the alleged lots claimed by Mr. A. L. Baguinsa situated in Brgy. Sandoval, Bataraza, Palawan.

This Office respectfully request for a virtual technical conference via Google Meeting on 12 January 2022 to discuss the result of the investigation report of Engr. Jonathan F. Gellez and this Office's plotting of the concerned areas (see map attached).

The invitation link/details of the virtual technical conference will be sent to your designated electronic mail addresses.

Thank you.

GLENN MARCELO C. NOBLE

Enc' : As Stated

**"MINING SHALL BE PRO-PEOPLE AND PRO-ENVIRONMENT
IN SUSTAINING WEALTH CREATION AND IMPROVED QUALITY OF LIFE."**

011122-R04B-0088



Memorandum
1/11/2022



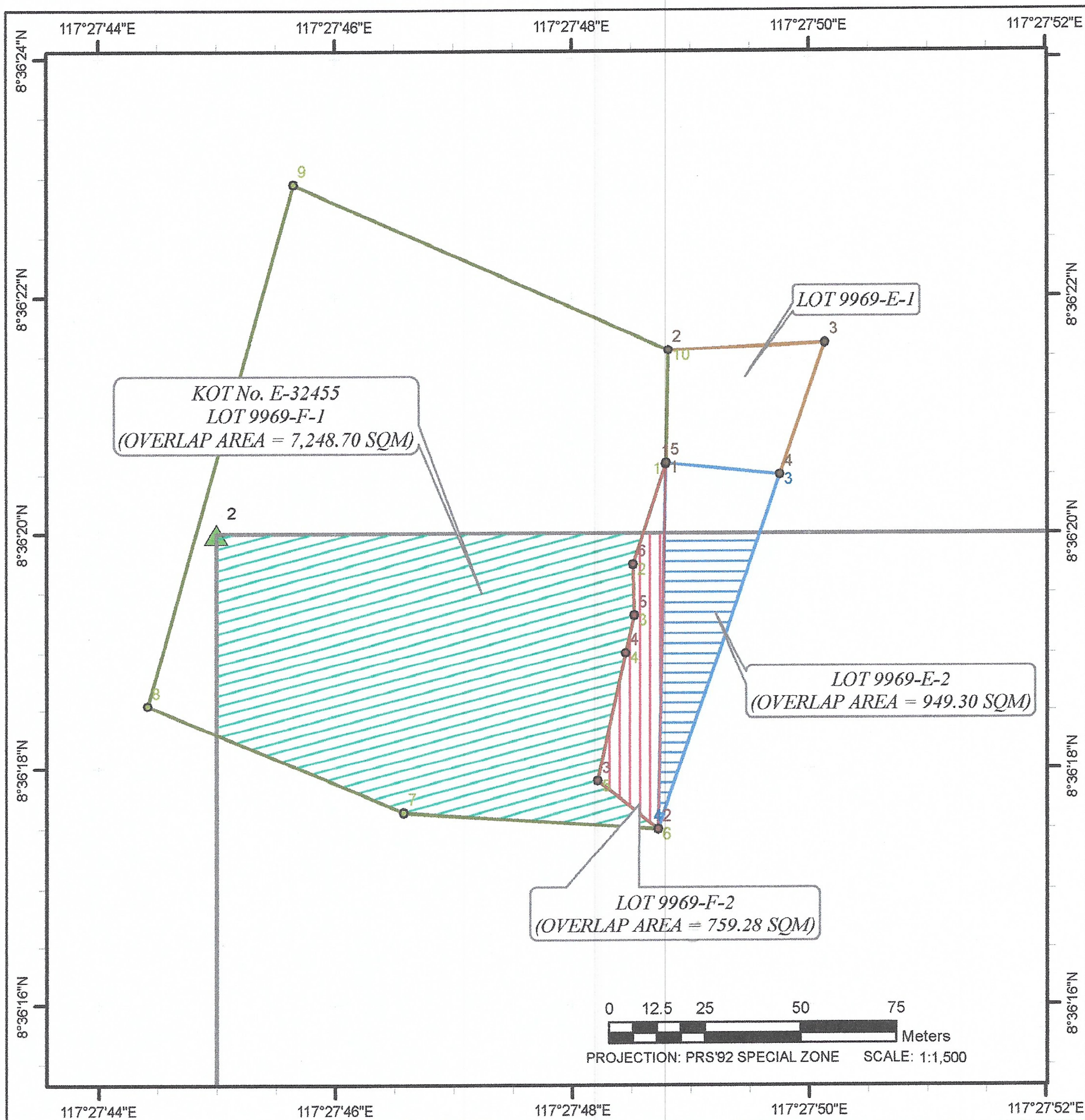

Republic of the Philippines
Department of Environment and Natural Resources
MINES AND GEOSCIENCES BUREAU
MIMAROPA Region

LOCATION MAP

RELATIVE POSITION OF THE APPROVED CONTRACT
AREA UNDER MPSA NO. 213-2005-IVB GRANTED TO
RIO TUBA NICKEL MINING CORP. AND LOT NUMBERS
9969-E & 9969-F, CSD-04-026475-D SITUATED IN
BRGY. SANDOVAL, BATARAZA, PALAWAN.

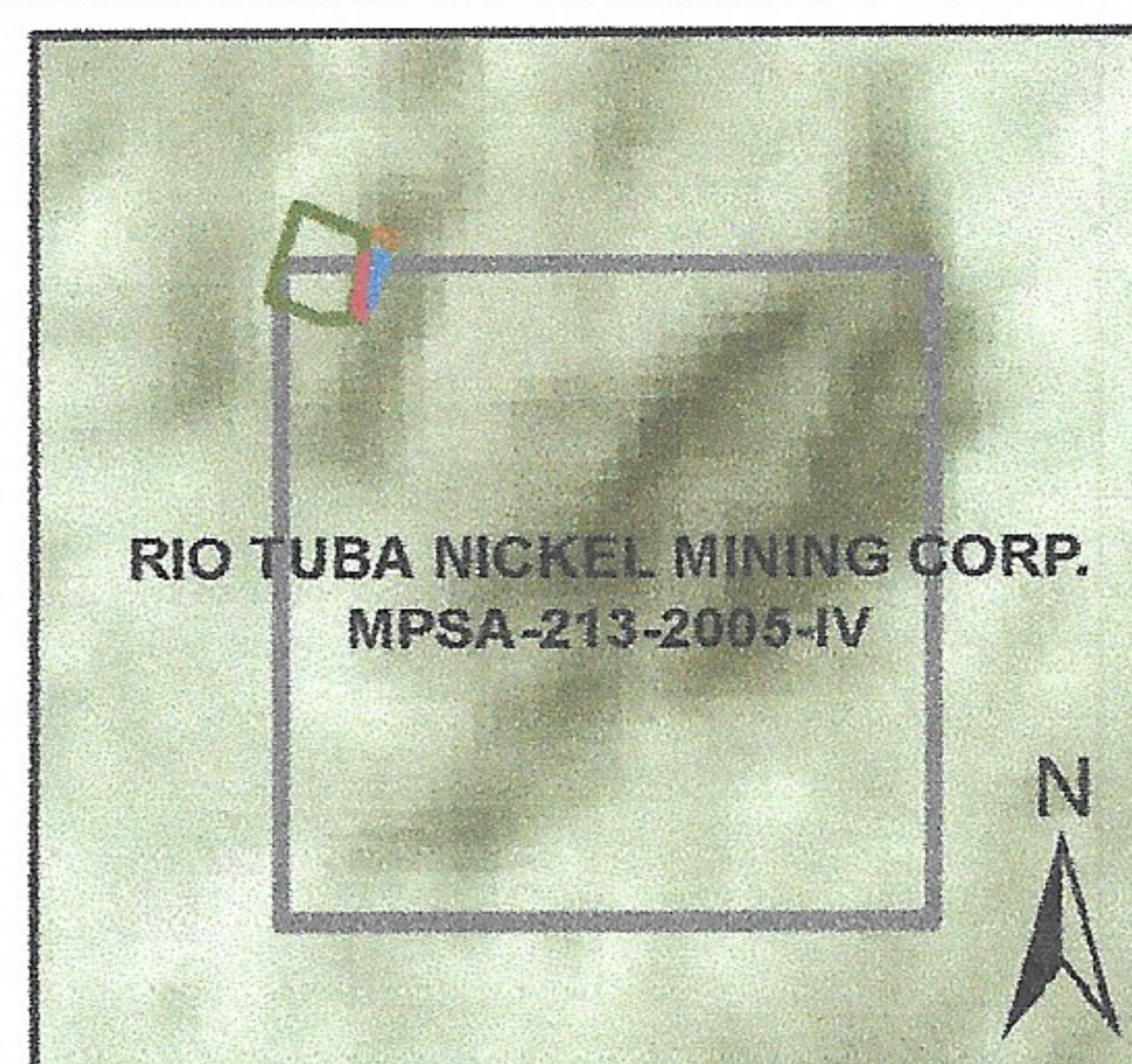

Legend

- Lot 9969 Boundary Corners
- Lot 9969-E-1
- Lot 9969-E-2
- Lot 9969-F-1
- Lot 9969-F-2
- ▲ MPSA No. 213-2005-IVB Approved Boundary Corners
- MPSA No. 213-2005-IVB Approved Boundary

PLOTTED BY:

ENGR. KENNETH A. SOLIDUM
GEODETIC ENGINEER

CHECKED BY:

ENGR. ALVIN S. REQUIMIN
CHIEF
MINERAL LANDS SURVEY SECTION

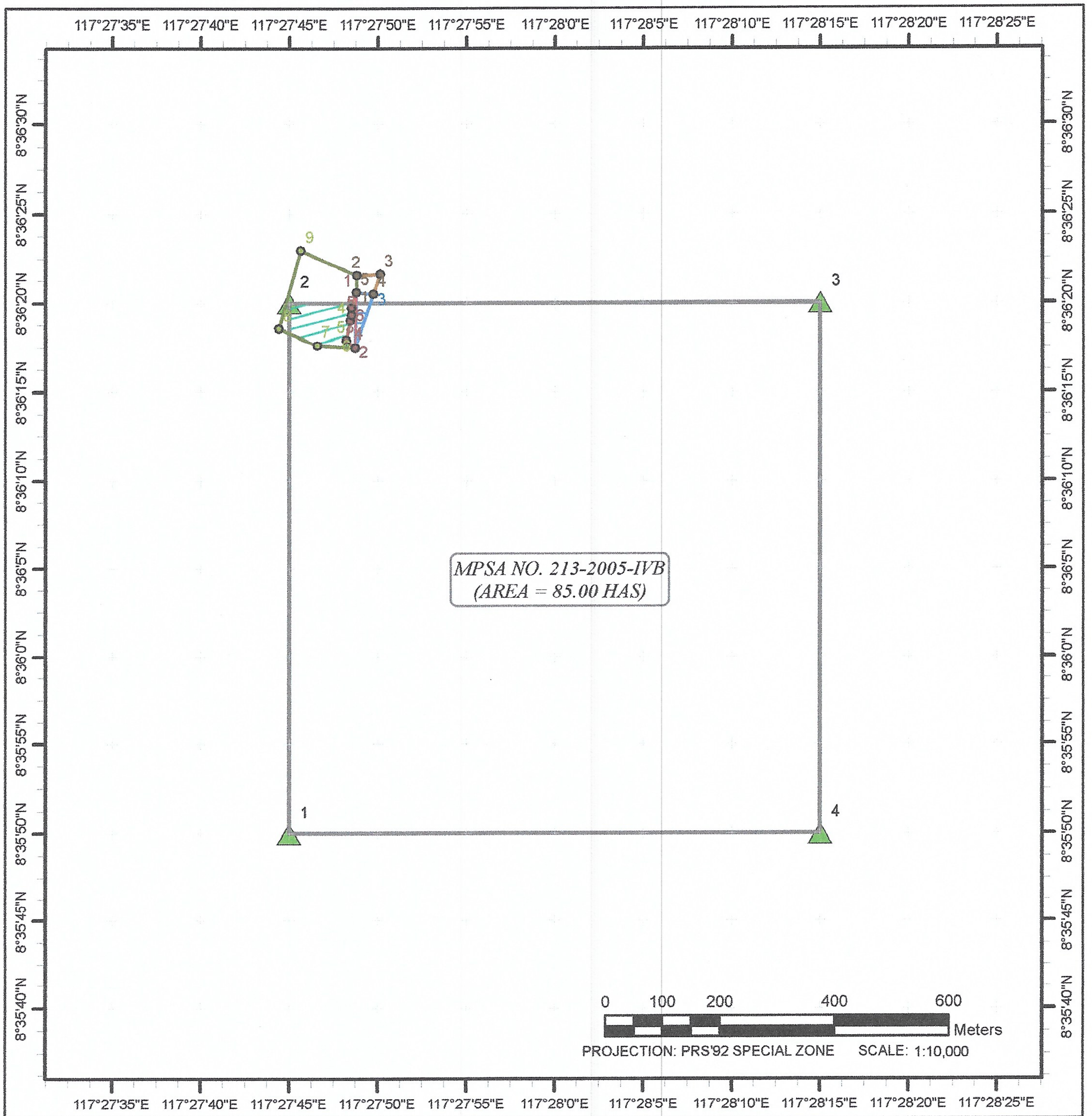

Republic of the Philippines
Department of Environment and Natural Resources
MINES AND GEOSCIENCES BUREAU
MIMAROPA Region

LOCATION MAP

RELATIVE POSITION OF THE APPROVED CONTRACT
AREA UNDER MPSA NO. 213-2005-IVB GRANTED TO
RIO TUBA NICKEL MINING CORP. AND LOT NUMBERS
9969-E & 9969-F, CSD-04-026475-D SITUATED IN
BRGY. SANDOVAL, BATARAZA, PALAWAN.

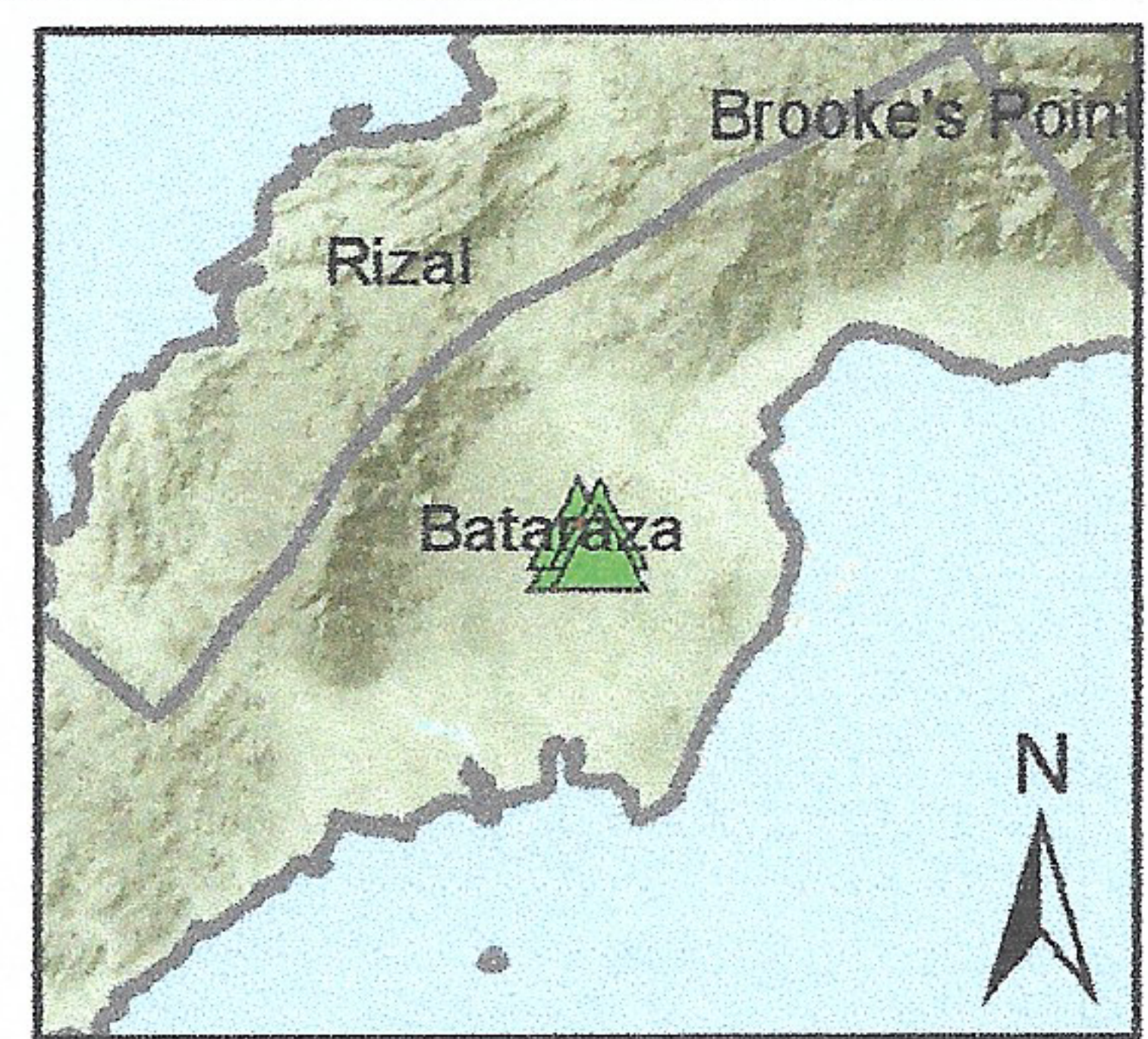

Legend

- Lot 9969 Boundary Corners
- Lot 9969-E-1
- Lot 9969-E-2
- Lot 9969-F-1
- Lot 9969-F-2
- ▲ MPSA No. 213-2005-IVB Approved Boundary Corners
- MPSA No. 213-2005-IVB Approved Boundary

PLOTTED BY:

ENGR. KENNETH A. SOLIDUM
GEODETIC ENGINEER

CHECKED BY:

ENGR. ALVIN S. REQUIMIN
CHIEF
MINERAL LANDS SURVEY SECTION