



Republic of the Philippines
Department of Environment and Natural Resources
Region IV- MIMAROPA
COMMUNITY ENVIRONMENT AND NATURAL RESOURCES OFFICE
Barangay III (Poblacion), Roxas, Palawan
Contact No. 09171606578 / 09175028647
Email address: cenroroxaspalawan@denr.gov.ph

17 January 2022

MEMORANDUM

FOR : The PENR Officer

FROM : The CENR Officer

SUBJECT : **REQUEST FOR LC CONFIRMATION OF A PUBLIC LAND
DULY VERIFIED BOUNDING SOUTHWEST OF LOT 184 OF
PLS 606-D IN BGY. TARADUNGAN, ROXAS, PALAWAN**

Then transmitted providing by tie line the geographic position of one of its corners duly presented in a rough sketch, the request subject hereof was recently returned requiring technical description of the lot.

Yet unsurveyed however, we have prepared and hereby submit for ready reference, a duly accomplished BL Form No. V-37 of the lot to which the public land subject hereof immediately abuts, along the set of documents originally endorsed.

For consideration and further instruction.

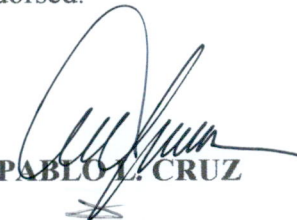
PABLO L. CRUZ

CEMR-CENRO ROXAS
RELEASED
DATE: 01/25/2022
BY: [Signature]
DOC. NO. 2022-01-0070

Copy: The RED, C/O The SMD
file





Republic of the Philippines
Department of Environment and Natural Resources
Region IV
COMMUNITY ENVIRONMENT AND NATURAL RESOURCES OFFICE
Roxas, Palawan

No. 184 PLS 606D Applicant: Chestita S. Valdestamon
Lot No. 184 PLS 606D Ident. to Lot No.
Portion of Lot No. Surveyed for: Pablo Soledad
Date of Original Survey: Surveyed by: Balangas SURV. CO
Area (sq. m.) 64537.54 Date of Survey:
Location: Bay Taradungan Roxas, Pal Date Approved: November 29, 1971

TECHNICAL DESCRIPTION

TIE LINE: S 76° 30 E 5798.14 M From BLLM # 1 PLS 606 D

LINE	BEARINGS	DISTANCE	LINE	BEARINGS	DISTANCE
1-2	N 55° 49 E	264.80 M		+148.9760	4219.0542
2-3	S 21° 40 E	264.94 M		-246.2213	+97.8174
3-4	S 54° 11 W	229.14 M		-134.0912	-185.8082
4-1	N 29° 31 W	266.00 M		+231.4765	131.0520
				+380.2525	316.8716
				-380.3125	316.8602
				D=06	D.0114

SKETCH

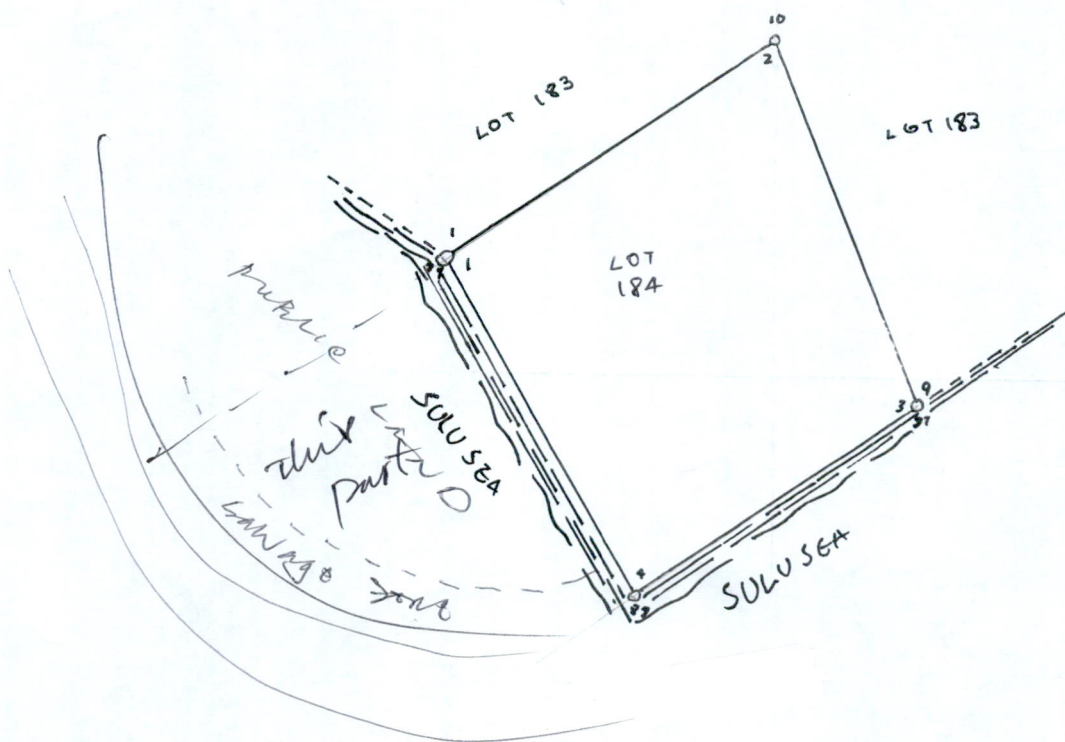

T. D. Researched by: Date: 01/19/22
T.D. Sketched by: Date:
T. D. Checked by: Date:

BUREAU OF LANDS

LOT DATA COMPUTATION

14460

ET PABLO	BATANGAS SURV CO	MO.	DAY	YR.	194	SHEET NO.	1
NAME OF CLAIMANT	NAME OF SURVEYOR	DATE SURVEYED			LOT NO.		
RDONG ROXAS PALAWAN	PLS 0060 C1	CM 1031			N 11930 E		
ADDRESS OF CLAIMANT	SURVEY NUMBER	QUADRANGLE			L.R.C. NO.		

TRAVERSE STATION COORDINATES			SIDE SHOT		CORNER NO.	LOT CORNER COORDINATES		LOT BOUNDARY LINE	
NORTHING	EASTING	DISTANCE	BEARING			NORTHING	EASTING	DISTANCE	BEARING
1	PL	S606			TP	20000000	20000000	579814	S7630E
		1 OF	183			11864313	25537935	26475	N5549E
		10 OF	183			21279489	2555691	26495	S2140E
		9 OF	183			31854966	2593472	22912	S5411W
18414602570002		50000M				41841460	2573892	26605	N2931W
AREA IN SQ M						6453754			



Republic of the Philippines
Department of Environment and Natural Resources
MIMAROPA Region
COMMUNITY ENVIRONMENT AND NATURAL RESOURCES OFFICE
Bgy. III, Poblacion, Roxas, Palawan
Contact No. 09171606578
Email Address: cenroroxaspalawan@denr.gov.ph

DOCUMENT ACTION INFORMATION FORM

Doc. Ref. No.: 2022-0095

Date and Time received:

01/12/2022 11:02:51 AM

From: ERIBERTO B. SAÑOS

Document Type: Memorandums

PENRO PALAWAN

Subject: TRANSMITTAL OF REPORT (LOT NO. 184, PLS 606-D, BGY. TARADUNGAN, ROXAS, PAL.)

Attachment(s): No attachment(s)

Earmarked As:

Date:	From: <i>AG-NURO</i>	To: <i>Chief, PPS</i>
Action Recommended/Required: <input type="checkbox"/> For Action <input type="checkbox"/> For Approval <input type="checkbox"/> For Disbursement/ Payment <input type="checkbox"/> For Official Release <input type="checkbox"/> For Signature <input type="checkbox"/> For Review/ Recommendation <input type="checkbox"/> For Information, Record and File <input type="checkbox"/> For Indorsement to concerned Party(ies) <input type="checkbox"/> Return to Payee/Sender		Processing Time: <input type="checkbox"/> Urgent (w/in the day) <input type="checkbox"/> Priority (w/in 3 days) <input type="checkbox"/> Complex w/in 7 days w/in 20 days or shorter W/in ____ days or shorter
		Other Instruction(s): <i>For compliance of hereto mentioned requirement. 1/12/22</i>
Date:	From: <i>PPS</i>	To: <i>Lml Jhen</i>
Action Recommended/Required: <input checked="" type="checkbox"/> For Action <input type="checkbox"/> For Approval <input type="checkbox"/> For Disbursement/ Payment <input type="checkbox"/> For Official Release <input type="checkbox"/> For Signature <input type="checkbox"/> For Review/ Recommendation <input type="checkbox"/> For Information, Record and File <input type="checkbox"/> For Indorsement to concerned Party(ies) <input type="checkbox"/> Return to Payee/Sender		Processing Time: <input type="checkbox"/> Urgent (w/in the day) <input type="checkbox"/> Priority (w/in 3 days) <input type="checkbox"/> Complex w/in 7 days w/in 20 days or shorter W/in ____ days or shorter
		Other Instruction(s): <i>attach V-37 at lot 184, PL 606-D</i>
Date:	From:	To:
Action Recommended/Required: <input type="checkbox"/> For Action <input type="checkbox"/> For Approval <input type="checkbox"/> For Disbursement/ Payment <input type="checkbox"/> For Official Release <input type="checkbox"/> For Signature <input type="checkbox"/> For Review/ Recommendation <input type="checkbox"/> For Information, Record and File <input type="checkbox"/> For Indorsement to concerned Party(ies) <input type="checkbox"/> Return to Payee/Sender		Processing Time: <input type="checkbox"/> Urgent (w/in the day) <input type="checkbox"/> Priority (w/in 3 days) <input type="checkbox"/> Complex w/in 7 days w/in 20 days or shorter W/in ____ days or shorter
		Other Instruction(s):
Date:	From:	To:
Action Recommended/Required: <input type="checkbox"/> For Action <input type="checkbox"/> For Approval <input type="checkbox"/> For Disbursement/ Payment <input type="checkbox"/> For Official Release <input type="checkbox"/> For Signature <input type="checkbox"/> For Review/ Recommendation <input type="checkbox"/> For Information, Record and File <input type="checkbox"/> For Indorsement to concerned Party(ies) <input type="checkbox"/> Return to Payee/Sender		Processing Time: <input type="checkbox"/> Urgent (w/in the day) <input type="checkbox"/> Priority (w/in 3 days) <input type="checkbox"/> Complex w/in 7 days w/in 20 days or shorter W/in ____ days or shorter
		Other Instruction(s):

Printed on 01/12/2022 12:01:32PM Received at: INFORMATION DESK/R Received by: BALTAR, APRIL



Department of the Interior
Bureau of Land Management
National System of Public Lands
Inventory and Management Planning
Inventory Worksheet

DOCUMENTATION INFORMATION SHEET

Worksheet No. _____ Date _____

Location: _____
Scale: _____
Map: _____

Feature	Description	Inventory		Remarks
		Present	Former	
Vegetation	Forest	<input type="checkbox"/>	<input type="checkbox"/>	
	Shrubland	<input type="checkbox"/>	<input type="checkbox"/>	
	Grassland	<input type="checkbox"/>	<input type="checkbox"/>	
	Barren	<input type="checkbox"/>	<input type="checkbox"/>	
Water	Stream	<input type="checkbox"/>	<input type="checkbox"/>	
	Lake	<input type="checkbox"/>	<input type="checkbox"/>	
	Wetland	<input type="checkbox"/>	<input type="checkbox"/>	
	Other	<input type="checkbox"/>	<input type="checkbox"/>	
Geology	Mountain	<input type="checkbox"/>	<input type="checkbox"/>	
	Hill	<input type="checkbox"/>	<input type="checkbox"/>	
	Valley	<input type="checkbox"/>	<input type="checkbox"/>	
	Other	<input type="checkbox"/>	<input type="checkbox"/>	
Soils	Forest	<input type="checkbox"/>	<input type="checkbox"/>	
	Shrubland	<input type="checkbox"/>	<input type="checkbox"/>	
	Grassland	<input type="checkbox"/>	<input type="checkbox"/>	
	Barren	<input type="checkbox"/>	<input type="checkbox"/>	
Wildlife	Forest	<input type="checkbox"/>	<input type="checkbox"/>	
	Shrubland	<input type="checkbox"/>	<input type="checkbox"/>	
	Grassland	<input type="checkbox"/>	<input type="checkbox"/>	
	Barren	<input type="checkbox"/>	<input type="checkbox"/>	
Cultural	Archaeological	<input type="checkbox"/>	<input type="checkbox"/>	
	Historic	<input type="checkbox"/>	<input type="checkbox"/>	
	Other	<input type="checkbox"/>	<input type="checkbox"/>	
	Other	<input type="checkbox"/>	<input type="checkbox"/>	

Prepared by: _____ Date: _____



Republic of the Philippines
Department of Environment and Natural Resources
MIMAROPA Region
PROVINCIAL ENVIRONMENT AND NATURAL RESOURCES OFFICE
Bgy. Sta. Monica, Puerto Princesa City, **PALAWAN**
Telfax No. (048) 434-8791
Email Add: penropalawan@denr.gov.ph

December 13, 2021

MEMORANDUM

TO : The Community Environment and
Natural Resources Officer
Roxas, Palawan

FROM : The Provincial Environment and
Natural Resources Officer

SUBJECT : **TRANSMITTAL OF REPORT (LOT NO. 184, PLS-606-D,
BGY. TARADUNGAN, ROXAS, PALAWAN)**

**Documents
Attached** : Your memorandum
dated September 10, 2021

Actions Desired:

- ☐ For information and record
- ☐ For investigation, comment and recommendation
- ☐ For immediate action and report of compliance
- ☒ Lacking requirements / Special instructions

Returned is your Memorandum dated September 10, 2021. Please submit the technical description of the subject lot and return the same with complete requirements as required for the issuance of Survey Authority pursuant to the provisions of DMC 2019-10 dated December 11, 2019 and Technical Bulletin 2020-01 dated September 10, 2020.

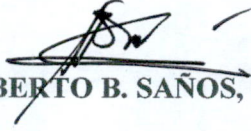
ERIBERTO B. SAÑOS, CESE

Doc. Ref. No.: 2021-10092
/ldm121321

**DENR PENRO
PALAWAN RECORDS
RELEASED**

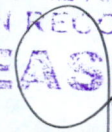
BY: 
DATE: DEC 15 2021 ON 21-10092



Republic of the Philippines
Department of Environment and Natural Resources
Region IV- MIMAROPA

COMMUNITY ENVIRONMENT AND NATURAL RESOURCES OFFICE

Barangay III (Poblacion), Roxas, Palawan

Contact No. 09171606578 / 09175028647

Email address: cenroroxaspalawan@denr.gov.ph

MEMORANDUM

FOR : The PENR Officer
FROM : The CENR Officer
SUBJECT : TRANSMITTAL OF REPORT
DATE : 10 September 2021

**DENR PENRO
PALAWAN RECORDS
RECEIVED**

BY: *[Signature]*
DATE: 10-08-2021 CN 21-10092

I am submitting the investigation report conducted on the request for survey authority involving a public land immediately bounding southwest of Lot 184 of PLS 606-D in Bgy. Taradungan, Roxas, Palawan.

Evaluating the same, I found out that:

- a. The land subject hereof is within the agricultural (alienable/disposable) lands; and
- b. The same appears peacefully occupied/possessed by Pedro Crestita Scalet and Orlando Rodriguez, the actual occupants and possessors thereof to the exclusion of adverse others.

Hence, I recommend confirmation of the LC findings arrived at. Attached are geo-photographs of the site.

[Signature]
RONIE B. GANDEZA
OIC-CENRO

Copy: The ARD, Technical Services
C/O the SMD at surveys_mimaropa@yahoo.com

The Claimant

file

**DENR-CENRO PALAWAN
RELEASED**
DATE: OCT 07 2021
BY: *[Signature]*
DOC. NO. 2021-10-1257



Republic of the Philippines
Department of Environment and Natural Resources
Region IV- MIMAROPA
COMMUNITY ENVIRONMENT AND NATURAL RESOURCES OFFICE
Barangay III (Poblacion), Roxas, Palawan
Contact No. 09171606578 / 09175028647
Email address: cenroroxaspalawan@denr.gov.ph

CERTIFICATION

This is to certify that part of a public land immediately bounding southwest of Lot 184 of PLS 606-D, corner 1 of which lies at S.76-30E., 5798.14m. from BLLM No. 1 of PLS 606-D is within the agricultural (alienable/disposable) lands per LC Map No. 2182, Project No. 14-B dated 21 March 1958, under FAO No. 4-700.

Said land remains not surveyed.

Issued on the 09th day of September 2021.

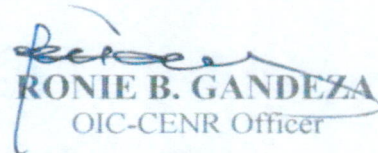
RONIE B. GANDEZA
OIC-CENR Officer

Copy: file

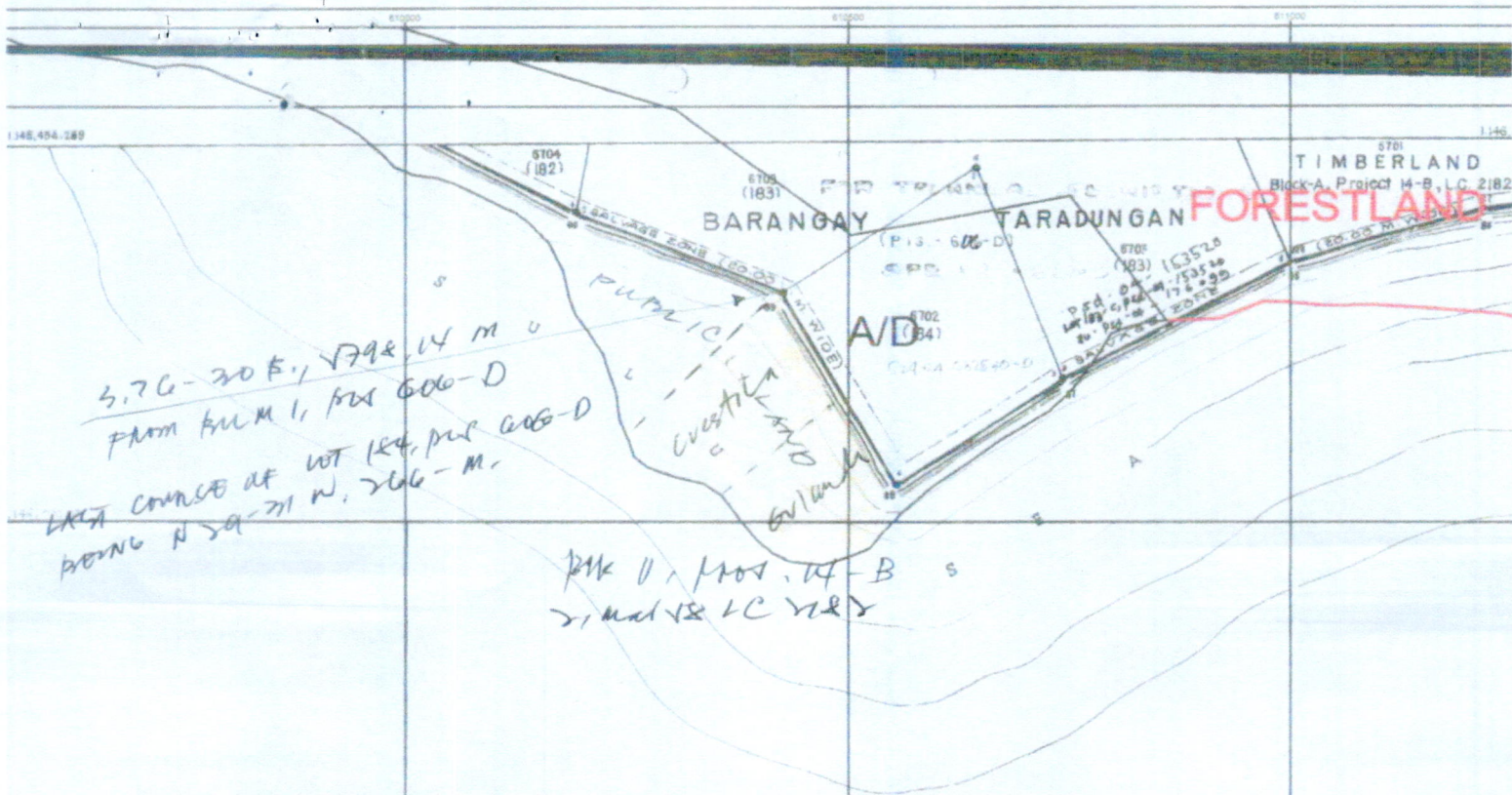

APPROVED: DECEMBER 28, 1968.

[Signature]
 PEDRO N. CALIM IIM
 Regional Technical Director

CM. 10° 22' N. 119° 29' E.	CM. 10° 22' N. 119° 30' E.	CM. 10° 22' N. 119° 31' E.
SULU SEA	SULU SEA	SULU SEA
SULU SEA	CM. 10° 21' N. 119° 30' E.	SULU SEA
SULU SEA	SULU SEA	SULU SEA

ROXAS CADASTRE
 Cod. 862-D, Case-23
 CM. 10° 21' N. 119° 30' E.
 SCALE 1:4000



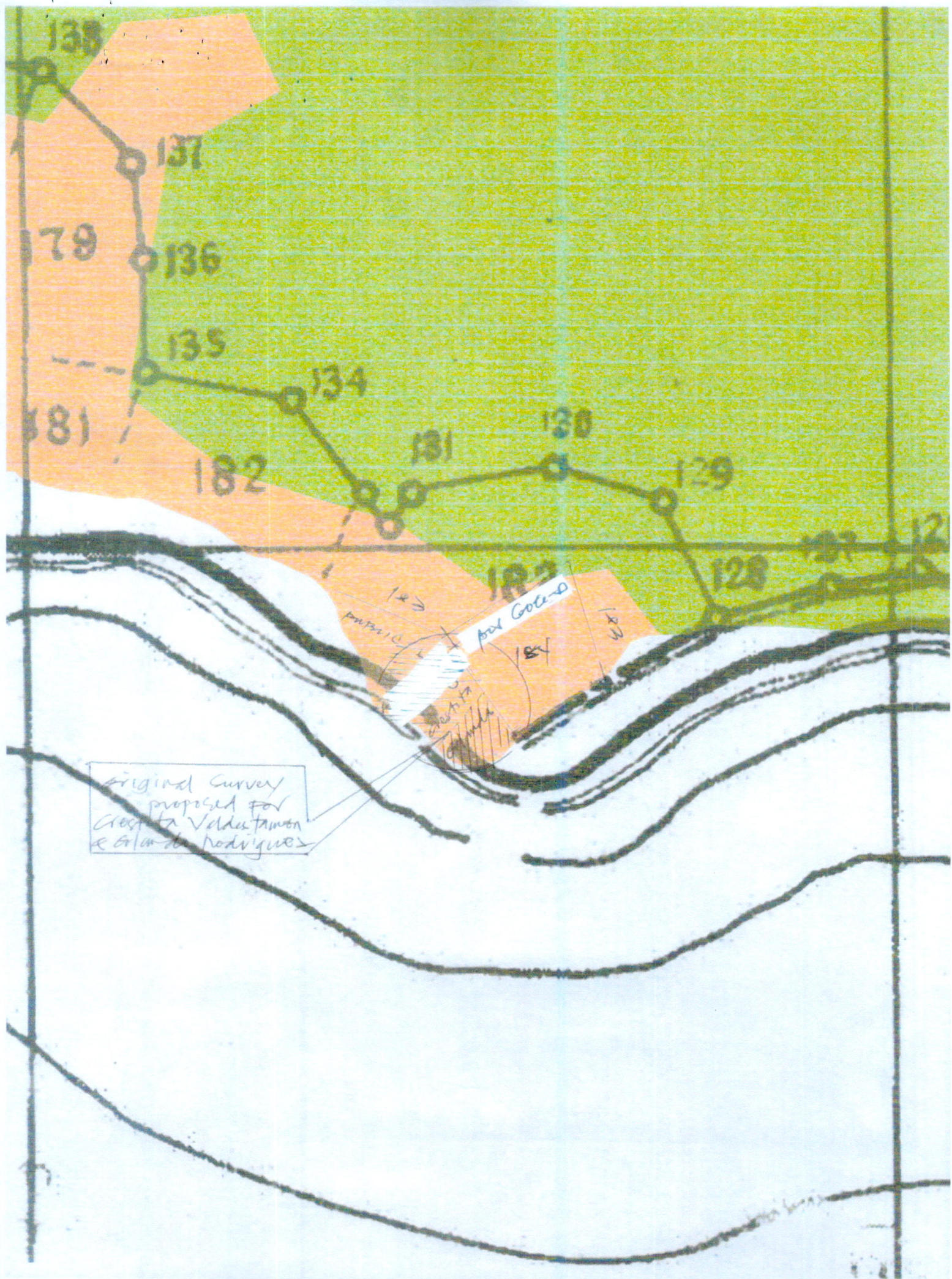

Original survey
proposed for
Cristóbal Valdez Tamón
& Gloria Rodríguez

proposed for

proposed for

proposed for



Republic of the Philippines
Department of Environment and Natural Resources
Region IV- MIMAROPA
COMMUNITY ENVIRONMENT AND NATURAL RESOURCES OFFICE
Barangay III (Poblacion), Roxas, Palawan
Contact No. 09171606578 / 09175028647
Email address: cenroroxaspalawan@denr.gov.ph

MEMORANDUM

For : The CENR Officer
From : The Investigating Officer
SUBJECT : INVESTIGATION REPORT
Date : 07 SEPTEMBER 2021

I am submitting this report in compliance with your instruction to conduct investigation on the attached request for Survey Authority.

SUBJECT LAND

The land subject of this investigation is Agricultural land bounding southwest of lot 184 PLS 606-D in Bgy. Taradungan, Roxas Palawan.

CLAIMANT

The claimant is Crestita Valdestamon and Orlando Rodriguez both claimant and the actual occupant of land subject hereof.

ACTIVITIES UNDERTAKEN

Upon receipt of the instruction, I immediately conducted the investigation. The following were undertake:

1. First gathered geographic reading and caused verification thereof by the Cartographer on the cadastral map over which the Surveys and Mapping Division(SMD) has overlaid the LC Maps, by the Records officer of the disposition status thereof, and prepared the LC Certification based on the findings.
2. The joint affidavit executed in support thereof by two disinterested persons, was validated on site as evidenced by the attached photographs apt for geo-tagging.

FINDINGS AND RECOMMENDATION

Verification disclosed the following:

1. The lots involved are within the agricultural (alienable/disposable) lands. Attached for further evaluation by the PENR Officer and confirmation by the ARD for technical is a certification prepared to that effect following Annex B of DMC 2019-10.
2. The claimant's stay in the land is peaceful and exclusive.

RENEN REY A. ABOROT
Land Management Inspector

Geo-Photos of a lot bountting southwest of lot 184 PLS 606-D subject for issuance of Survey Authority at Barangay Taradungan, Roxas, Palawan



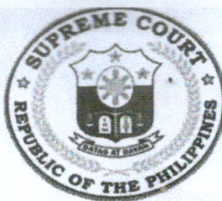

MUNICIPAL CIRCUIT TRIAL COURT FOR ROXAS
AND CAGAYANCILLO
Barangay 2, Roxas, Palawan

CERTIFICATION

TO WHOM IT MAY CONCERN:

THIS IS TO CERTIFY that according to the records now available at this Court Public Land bounding southwest of Lot 184, PLS 606-D located at Barangay Taradungan, Roxas, Palawan has no pending case or is not a subject of any registration case filed before this Court.

This Certification is issued upon the request of subject claimants/applicants Crestita Valdestamon and Orlando Rodriguez both residents of Barangay Taradungan for their application for Survey Authority.

This 1st day of September 2021 at Roxas, Palawan, Philippines.

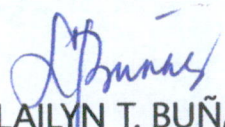
LAILYN T. BUÑAG
Officer-in-charge

Comm. Tax Cert: 25982360/25982361
Issued on: 09/01/2021
Issued at Roxas, Palawan
O.R. (local): 6188298
Issued on: 9/01/2021
O.R. (JDF/SAJ)/LRF: 5128986/5030094/2314723
Issued on: 9/01/2021
Issued at: Roxas, Palawan



Republic of the Philippines
Department of Environment and Natural Resources
Region IV
COMMUNITY ENVIRONMENT AND NATURAL RESOURCES OFFICE
Roxas, Palawan

REPUBLIC OF THE PHILIPPINES)
PROVINCE OF PALAWAN : S.S.
MUNICIPALITY OF ROXAS)

JOINT AFFIDAVIT

We, Rafael Laderas and Reynaldo Nangit; both married residents of Bgy. Taradungan, Roxas, Palawan after having been sworn, hereby depose and state:

1. That we personally know Crestita Valdestamon and Orlando Rodriguez, who desire survey of Public Land bounding southwest of Lot 184 of PLS 606-D in Bgy. Taradungan, Roxas, Palawan.
2. That we are actual residents of the Barangay of Taradungan in the Municipality of Roxas, Palawan;
3. That we are aware of the fact that Ms. Crestita Valdestamon and Orlando Rodriguez are the actual occupants and or possessors of the subject public land;
4. That we are not related to the claimant/representative either by consanguinity or affinity and not, in any way, interested in the land; and
5. That to the best of our knowledge, belief and information, the land is not claimed by adverse others.

IN WITNESS WHEREOF, we have hereunto set our hands this _____ day of _____ 2021 in the place above first written.

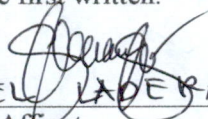

RAFAEL LADERAS
Affiant
TIN CTC No. 773 720 748
Issued on _____
Issued at Roxas, Palawan

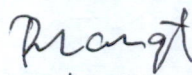

REYNALDO NANGIT
Affiant
CTC No. 25940480
Issued on 7-22-21
Issued at Roxas, Palawan

SUBSCRIBED AND SWORN to be fore me on the date and place stated above.

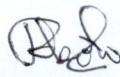

Officer Authorized to Administer Oath
L M I

(Position/Designation)



Republic of the Philippines
Department of Environment and Natural Resources

Region IV- MIMAROPA

COMMUNITY ENVIRONMENT AND NATURAL RESOURCES OFFICE

Barangay III (Poblacion), Roxas, Palawan

Contact No. 09171606578 / 09175028647

Email address: cenroroxaspalawan@denr.gov.ph

CERTIFICATION

I hereby certify that Ms. Crestita S. Valdestamon, of legal age, is a resident of Bgy. Taradungan, Roxas, Palawan; who occupies par of the public land bounding southwest of Lot 184, PLS 606-D.

This is issued to Ms. Crestita S. Valdestamon this 01st day of September 2021 pursuant to DENR Memorandum Circular No. 2019-10 in support of his/her desire for survey/patent of the tracts of land first above-described.



Hon. MIGUEL C. CABATE
Chair, Bgy. Taradungan, Roxas, Palawan

Subscribed and Sworn to before me this _____ in Roxas,
Palawan. Affiant exhibited CTC No. _____ issued on _____ in Roxas,
Palawan.

(Doc. Stamp)

RENEN REY A. ABOROT
(Officer Authorized to Administer Oath)
Land Management Inspector
Position/Designation

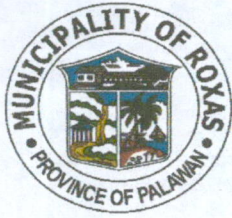
copy: The Regional Executive Director
The PENR Officer
File



Republic of the Philippines
Province of Palawan
Municipality of Roxas
Barangay Taradungan
OFFICE OF THE PUNONG BARANGAY



TO WHOM IT MAY CONCERN;

THIS IS TO CERTIFY THAT CRESTITA S. VALDESTAMON, Legal age, a resident and with a postal address at Purok-I, Barangay Taradungan, Roxas, Palawan, with TAX DEC. NUM. 029- 0267-A, with an estimated area of 1.5 hectares, located at So. Legawen, Barangay Taradungan, Roxas, Palawan, the said area was planted such as:

- 40 pcs. – Coconut trees (Bearing)
- 5 pcs. – Coconut trees (Non Bearing)
- 30 pcs. – Cashew trees (Bearing)
- 22 pcs. – Cashew trees (Non Bearing)
- 24 pcs. – Banana trees
- 1 pc. – Mango tree

This certification is issued upon the request of the name mentioned above for whatever purposes that may serve best.

Given this 18th day of August, in the year of our Lord 2021, at Barangay Taradungan, Roxas, Palawan

Truly yours,

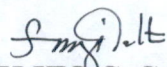

MIGUELITO C. CABATE
Punong Barangay

CERT. FEE: 50.00

O.R. NO. NO OR. AVAILABLE

ISSUED ON. AUGUST 18, 2021

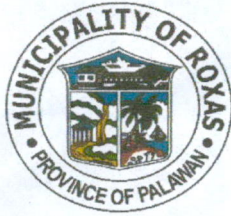
ISSUED AT BGT. TARADUNGAN, ROXAS, PALAWAN



Republic of the Philippines
Province of Palawan
Municipality of Roxas
Barangay Taradungan
OFFICE OF THE PUNONG BARANGAY



TO WHOM IT MAY CONCERN;

THIS IS TO CERTIFY THAT MR. ORLANDO S. RODRIGUEZ, Legal age, a resident and with a postal address at Purok-I, Barangay Taradungan, Roxas, Palawan, with TAX DEC. NUM. 18- 20- 029- 123, with estimated area of 1.5 Hectare, located at So. Legawen, Barangay Taradungan, Roxas, Palawan, the said area was planted such as:

- 50 pcs. – Cashew
- 20 pcs. – Banana
- 20 pcs. - Coconut trees/ Bearing
- 30 pcs. – Coconut trees/ Non Bearing

This certification is issued upon the request of the name mentioned above for whatever purposes that may serve best.

Given this 18th day of August, in the year of our Lord 2021, at Barangay Taradungan, Roxas, Palawan

Truly yours,

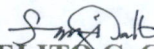
MIGUELITO C. CABATE
Punong Barangay

Cert fee: P 50.00
O.R No.: 6183521-4
Issued on: 8-20-21
Issued at: Barangay Taradungan, Roxas, Palawan

DECLARATION OF REAL PROPERTY

(FILED UNDER REPUBLIC ACT NO. 7160)

Owner CRISTITA S. VALDEZTAMON Address Taradungan, Roxas, Palawan

Administrator _____ Address _____

DESCRIPTION AND OTHER PARTICULARS OF PROPERTY

Location of Property	(Number & Street)	(Barangay/District)	(Municipality/City/Province)
		TARADUNGAN	Roxas, Palawan

Certificate of Title No. _____ Cadastral Lot No. _____ Assessor's Lot No. _____

Boundaries: Improvements situated within the public land with PIN-04-023 located at Bgy.

North: Taradungan, Roxas, Palawan South: _____
 East: _____ West: _____

(State streets, lots, or streams by which bounded, or names of owners of adjoining lands)

I (a) LAND (AGRICULTURAL/MINERAL)

[illegible]

I (b) PLANTS & TREES

OWNER'S DECLARATION			ASSESSOR'S FINDINGS					
Kind	No./Area	Value	Market Value	100%	Kind	No./Area	Unit Value	Market Value
Coconut	40-B	50,000			Coconut	40	1,250.00	50,000.00
Coconut	5-NB	5yrs.	Adjustments		Coconut	5NB	24.00	(120.00)
Banana	24-B		(a) Along or no		Gasoy	30	100.00	3,000.00
Mango	1-B		rd frontage	-12%	Gasoy	22NB	20.00	(440.00)
			(b) kms. to	0%	Banana	24	80.00	1,920.00
			all weather rd	0%	Mango	1	600.00	600.00
			(c) kms to					
			market (pob)	-12%				
			Total Adjustments	-24%				
			Adjusted Market Value	76%				
			Total					10,320.00
			Total for land, plant and tress					10,420.00
			Adjusted value for land, plants and trees					7,843.20

II LAND (RESIDENTIAL, COMMERCIAL, INDUSTRIAL, SPECIAL)

OWNER'S DECLARATION			ASSESSOR'S FINDINGS				
Kind	Area	Value	Kind	Area	Unit Values	Adjustments	Market Value
Total		P=	Total				P=

IMPORTANT: Issued for taxation purposes only and should not be considered as title to the property

OWNER'S COPY TAX DECLARATION OF REAL PROPERTY

TC : GR

TD No. **18-20-029-0123**Property Identification No. **066-20-029-04-023-(4001)**Owner: **ORLANDO S. RODRIGUEZ**

TIN: _____

Address: **TARADUNGAN, ROXAS, PALAWAN**

Telephone No. _____

Administrator/Beneficial User **AUTHO. REP. CRISTITA VALDEZTAMON**

TIN: _____

Address: **TARADUNGAN, ROXAS, PALAWAN**

Telephone No. _____

Location of Property:

TARADUNGAN
(Number and Street) (Barangay/District)**ROXAS, PALAWAN**
(Municipality & Province)

OCT/TCT/CLOA No. _____

Survey No. _____

CCT: _____

Lot No. _____

Date: _____

Blk. No. _____

Boundaries:

North: **PLANTS/TREES SITUATED IN LOT OWNED BY**
REPUBLIC OF THE PHILIPPINES

South: _____

East: _____

West: _____

KIND OF PROPERTY ASSESSED:☒ **LAND**☐ **MACHINERY**☐ **BUILDING**

Brief Description: _____

No. of Storeys: _____

☐ **Others:**

Specify: _____

Brief Description: _____

Classification	Area	Unit Value	Market Value	Actual Use	Assessment Level	Assessed Value	Taxability
AGRICULTURAL		Php	14,136.00	AGRICULTURAL (Plants/Trees)	16 %	Php 2,260.00	TAXABLE
Total	0.00 sq.m.	Php	14,136.00			Php 2,260.00	

Total Assessed Value **TWO THOUSAND TWO HUNDRED SIXTY PESOS**

(Amount in Words)

Taxable ☒Exempt ☐

Effectivity of Assessment/Reassessment:

2019
Year

Approved by: By Authority of the Provincial Assessor:

ELPIDIO D. BATUL, JR., REA
MUNICIPAL ASSESSOR**8/10/2018**
DateThis declaration cancels TD No. **20-029-0122**Previous A.V. Php **1,510.00**Previous PIN **066-20-029-04-023-(P1)**Previous Owner: **ORLANDO S. RODRIGUEZ ; Prev. Admin: AUTHO. REP. CRISTITA VALDEZTAMON**Previous Area: **0 sq.m.****Memoranda:****REVISED PURSUANT TO SECTION 219 OF R.A. 7160 AND SECTION 24 OF PROVINCIAL ORDINANCE NO. 1914-2018 SERIES OF 2018.**

Note: This declaration is for real property taxation purposes only and the valuation indicated herein are based on the schedule of unit market values prepared for the purpose and duly enacted into an Ordinance by the Sangguniang Panlalawigan under Ordinance No. 1914-2018 dated March 26, 2018. It does not and cannot by itself alone confer any ownership or legal title to the property.

SWORN STATEMENT No.:

SWORN STATEMENT Date:

ble 10/10/10

Date

The Community Environment and
Natural Resources Officer
Roxas, Palawan

Sir/Ma'am:

May I have the honor to request the following:

- () Ocular inspection/investigation
- () GPS Reading

Lot No.:

Location

- () Certified photo copy/ copies

- () Technical Description/Cad Map/Sketch Plan

Lot No.:

Location:

() Certification

- () Land classification Status
- () Land disposition status

Lot No.

Location

- () Others (Please specify)

Purpose:

Very truly yours,

Signature over Printed Name

Contact No.:

Address:

<input checked="" type="checkbox"/>
<input checked="" type="checkbox"/>
<input checked="" type="checkbox"/>
<input checked="" type="checkbox"/>

Requirements/Attachments

Barangay Certification

Waiver of Rights/Deed of Sale/Donation

Tax Declaration

SPA/Authorization Letter

Others



Signature of the Officer

 Republic of the Philippines
 Office for Senior Citizen Affairs (OSCA)
 Municipality of Roxas

ID No. **060539**

Name: **ORLANDO SACLET RODRIGUEZ**
 Sex: **Male** Age: **62**
 Date of Birth: **September 1, 1958**
 Address: **Bgy. Taradungan, Roxas, Palawan**
 Date Issued: **September 14, 2020**
 Place of Issued: **Roxas, Palawan**



 Signature

This Card is non-transferable & valid
 anywhere in the country

Benefits and Privileges under RA 9994

- Free Medical/dental, diagnostic & laboratory service in all government facilities
- 20% discount for medicines
- 20% discount in hotels, restaurants, recreation centers
- 20% discount in theaters, cinema houses & concert halls
- 20% discount in medical/dental, diagnostic & laboratory fees in private facilities
- 20% discount in fare for domestic air, sea travel & public land transportation
- 5% discount in basic necessities & prime commodities
- 12% VAT-exemption on the purchase of goods & services which are entitled
- 5% discount for the monthly utilization of water & electricity, provided that the water and electricity meter bears the name of the senior citizen

Persons and Corporations Violating R.A. 9994 shall be penalized. Only for the
 exclusive use of Senior Citizens; abuse of privileges is punishable by law.

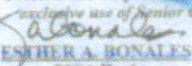

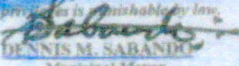
ESTHER A. BONALES
 OSCA Head



DENNIS M. SABANDO
 Municipal Mayor

 Republic of the Philippines
 Office for Senior Citizen Affairs (OSCA)
 Municipality of Roxas

ID No. 057970

Name: CRESTITA SACLET VALDESTAMON
 Sex: Female Age: 67
 Date of Birth: November 17, 1952
 Address: Bgy. Taradungan, Roxas, Palawan
 Date Issued: October 21, 2020
 Place of Issued: Roxas, Palawan



 Signature
 This Card is non-transferable & valid
 anywhere in the country



Benefits and Privileges under RA 9994

- Free Medical/dental, diagnostic & laboratory service in all government facilities
- 20% discount for medicines
- 40% discount in hotels, restaurants, recreation centers
- 20% discount in recreation, senior centers, municipal halls
- 20% discount in medical/dental, diagnostic & laboratory fees in private facilities
- 20% discount in fare for domestic air, sea travel & public land transportation
- 5% discount in basic necessities & prime commodities
- 12% VAT exemption on the purchase of goods & services which are entitled
- 5% discount for the monthly utilization of water & electricity, provided that the water and electricity meter bases are under the name of the senior citizen

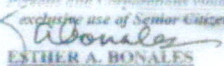
Persons and Corporations violating RA 9994 shall be penalized. Only for the
 exclusive use of Senior Citizens; abuse of privileges is punishable by law.

ESTHER A. BONALES
 OSCA Head

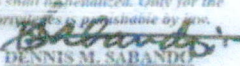
DENNIS M. SABANDO
 Municipal Mayor