

Republic of the Philippines
Department of Environment and Natural Resources
Visayas Avenue, Diliman, Quezon City

DENR Form No. _____

APPLICATION FOR RENEWAL
OF CERTIFICATE OF STEWARDSHIP

1. Name: MONTE LEDO ABELA
(Last Name) (First Name) (Middle Initial)
2. Birthdate: OCTOBER 24 1970
3. Address:
Sitio: BALETE
Barangay: SAN MIGUEL
Municipality: LIMPANUN
Province: PALAWAN
4. Educational Attainment: College Graduate
5. Occupation: _____
6. Civil Status:
☒ Single ☐ Widow
☐ Married ☐ Others
7. Name of Spouse: _____
(If husband is applicant, indicate the maiden name of wife)

8. Names of Household Members

Names (pls indicate if holder of CS)	Age	Relationship	Educational Attainment	Occupation

(Note: Use additional sheet if necessary)

Need to be translated into the local dialect

9. Estimated Annual Income of Family:

Name of Family Member	Source of Income (include on-farm and off-farm activities)	Amount of Income

10. Area covered by Existing CS (ha): 1.243 HAs.

Location: SO. DALUTE, BRGY. SAN MIGUEL, LINAPATAN, PARANG

CS No. 4230 2005

Date Issued: 2/10/1996
(day/month/year)

Expiry Date: 3/10/2021
(day/month/year)

11. Place of Residence: ☐ Inside Area Occupied ☐ Outside Area Occupied

12. Are you a member of an organization? ☐ Yes ☐ No

If yes, name of the organization: _____

Position in the organization: _____

I HEREBY CERTIFY that the answers given above are true and correct to the best of my knowledge and belief and I understand that any information I have stated in this application which are contrary to facts shall factor cause the rejection of the application or cancellation of the stewardship agreement that may be granted as a result.

Leo A. Montes
(Signature of Applicant)

THIS IS TO CERTIFY that _____ is the holder of Certificate of Stewardship No. _____ and actually tilling the area subject of this application for renewal.

WILSON T. PRUDENTE
Barangay Official

MARK GLENN T. MANAGDAG
CBFM Coordinator

SUBSCRIBED AND SWORN to me this _____ day of _____, applicant exhibiting his residence certificate number _____ issued on _____ at _____.

WILSON T. PRUDENTE
CENR Officer
6/27/22

703

**STEWARDSHIP AGREEMENT HOLDER
PERFORMANCE EVALUATION AND RATING SHEET**

REGION : MIMAROPA
 PENRO : PARANAN
 CENRO : ORON
 Name of CS Holder : LEO MONTES CS No.: 42302005
 Location :
 Barangay : San Miguel
 Municipality : Linaoagan
 Province : PARANAN
 Area Granted : 1.243 HAs
 Date Granted : OCTOBER 2, 1996
 Status of the Area : EXPINED

I. AREA DEVELOPMENT

1. Farm Area Development And Management

Farming Practices/Technologies (please indicate location on the attached sketch map of the farmlot the development/improvements made)

Farming Practices/Technologies	Percentage Of Farm Area Covered	Crops Planted	Generated Benefits (good, fair, poor)
A. Agroforestry Farm Establishment	20%	Coconut, Banana, Naranja	Fair
B. Orchard and Tree Plantation	20%	Cashew plantation	Good
C. Agricrops	8%	Cabi, Cassava, Pinipig	Fair

2. Farm Protection, Care And Maintenance

Activities	Good	Fair	Poor
a. Forest Protection	✓		
b. Fertilizer Application		✓	
c. Pesticide Application			✓

3. Other Improvements

Other Improvements	Good	Fair	Poor
a. Monument in each Farm Corner	✓		
b. Fertilizer Application		✓	
c. Pesticide Application			✓

II. CONSERVATION OF FOREST RESOURCES

Activities	Good	Fair	Poor
a. Protection of naturally growing trees	✓		
b. Soil and Water Conservation/Soil Erosion Control Measures		✓	

Control Measures			
c. Protection of vegetation along waterlines, rivers and streams		/	
d. Compliance to existing forestry laws, rules and regulations		/	

REMARKS

III. INVOLVEMENT ON THE ORGANIZATIONAL ACTIVITIES

1. Is the grantee a member of Stewardship Association/CBFM Peoples Organization?
☐ Yes ☐ No
 If yes, please specify position in the organization.

2. As officer/member, what organizational activities had you participated?

Activities	Always	Sometimes	Never
a. Meetings			
b. Planning/Decision Making			
c. Implementation/Monitoring			
d. Pahina/Collective Labor			

IV. STATUS OF OCCUPANCY:

() Actual CS Holder () Leased/Mortgaged () Sold by CS Holder

REMARKS:

The CSC Area has development, planted with trees and fruit bearing trees and other agri-crops therein, and in CSC area got 70 points equivalent to satisfactory rating, it is recommended for the renewal of Stewardship Contract.

EVALUATORS:

MARK GLENN T. MANAGDAG

Team Leader

[Signature]
 ANGELO U. ASCURIO
 Member

[Signature] *[Signature]*
 ARROJO R. REXMONTE DENNIS T. JACMIS
 Member Member

[Signature]
 FELIX R. SKELTON
 Member

[Signature]
 WILSON T. PRUDENTE
 Barangay Official

[Signature]
 ALBERT ABARING

ATTESTED BY:

[Signature]
 ROSEMARY G. VERLAIN
 CENR Officer

[Signature]
 6/27/22
 Date

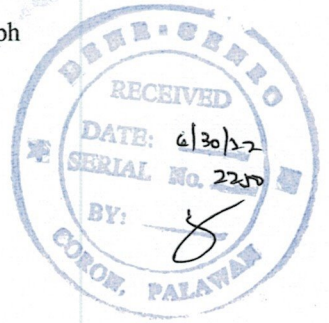

MEMORANDUM

FOR : THE COMMUNITY ENVIRONMENT &
NATURAL RESOURCES OFFICER

FROM : The CSC Evaluation & Assessment Team

SUBJECT : **EVALUATION AND ASSESSEMENT REPORT ON CSC's
ISSUED LOCATED AT SITIO BALETE, BARANGAY
SAN MIGUEL, LINAPACAN, PALAWAN**

DATE : June 10, 2022

Please be informed that on June 10, 2022 the undersigned personnel of this office conducted evaluation and assessment of CSC issued to **Mr. Leo Montes** bearing **CSC No. 42302005** with a total area of **1.243** hectares located at So. Balete, Barangay San Miguel, Linapacan, Palawan.

Hereunder are results of the Inspection/evaluation, to wit:

1. Mr. Jose Montes was awarded a Certificate of Stewardship Contract(CSC) on October 2, 1996 and expired on October 3, 2021.
2. The CS area is well developed fully planted with forest tress, fruit bearing tress, and agricultural crops.
3. The CS area got 70 points equivalent to "Satisfactory rating" The CS holder complied with the terms and conditions stipulated in the Stewardship Contract.

In view of the above facts and findings of the assessment and evaluation team, the aforementioned CSC is recommend for renewal of Stewardship Contract to Mr. Leo A. Montes

Attached is duly accomplished CSC Evaluation and Assessment Form together with sketch map, and geotagged pictures taken during the conduct of assessment.

For information, record and further instruction/s.



MARK GLENN T. MANAGDAG
ECOMS-II/CBFM Desk Officer

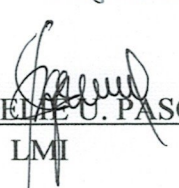

DANILO G. PATRON
Park Maintenance

ROMULO M. VENTURA
Park Maintenance



ARGIE BILLIONES
Forester

ANGELA U. PASCUAL
LMI

MA. LANI T. VENTURA
Forest Ranger

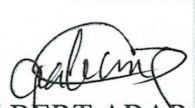

ELIZALDE SEGUNDO
Forest Technician II

DENNIS JAGMIS
Forest Technician II

ALBERT ABARAING
Forest Ranger

CORNER	LATITUDE	LONGITUDE
1	11°29'56.50"N	119°52'09.90"E
2	11°29'58.20"N	119°52'12.00"E
3	11°29'47.94"N	119°52'14.39"E
4	11°29'47.79"N	119°52'13.44"E
5	11°29'53.82"N	119°52'12.34"E

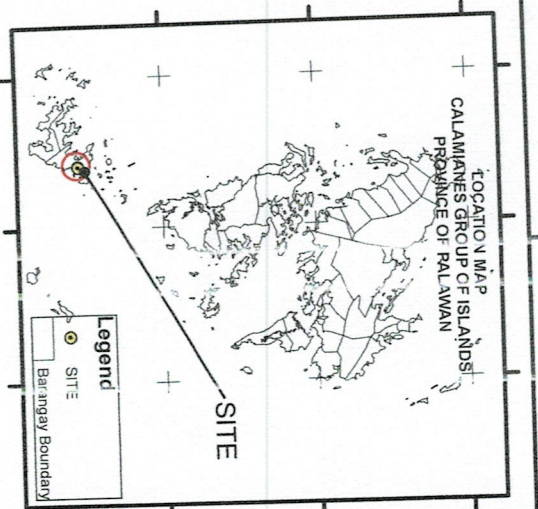
GEOGRAPHIC COORDINATES



BAY

NOTE: THE HEREIN DESCRIBE SKETCH IS SUBJECT TO FUTURE PRECISE SURVEY.

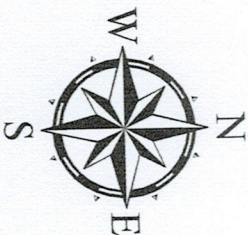

SKETCH MAP

showing the area covered by

CERTIFICATE OF STEWARDSHIP
NO: 42302005

For: Social Forestry Area

awarded to

LEO MONTES

LOCATED AT:

SITIO : BALETE
BARANGAY : SAN MIGUEL
MUNICIPALITY : LINAPACAN
PALAWAN : PALAWAN

APPROXIMATE AREA: 1.243 HAS.

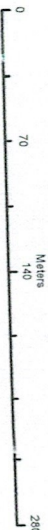

SCALE : 1:4000

PROJECTION : WORLD GEODETIC SYSTEM (WGS84)

Legend

- CORNER
- CSC_LOTS
- LEO MONTES
- COASTLINE

PREPARED BY:

MARK GLENN DOMAGDAG
ECOMS III/BFM DO

CHECKED BY:

FERDINAND GATCHALIAN
Forester III/Chief CDS

ATTESTED BY:

RODNEY G. ARIAN
Off. - CENRO

PHOTO DOCUMENTATION DURING THE CONDUCT OF CSC EVALUATION
AND ASSESSMENT AWARDED TO LEO MONTES IN SITIO BALETE, BRGY.
SAN MIGUEL, LINAPACAN, PALAWAN

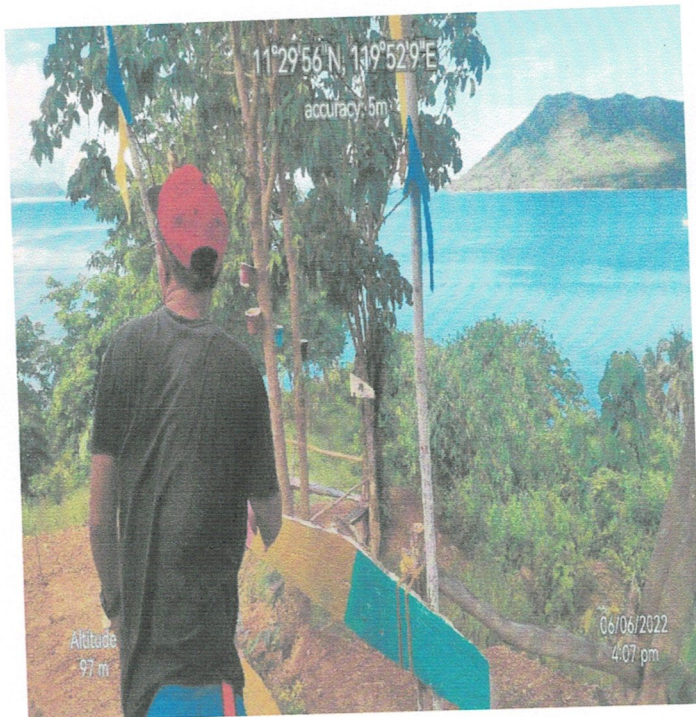
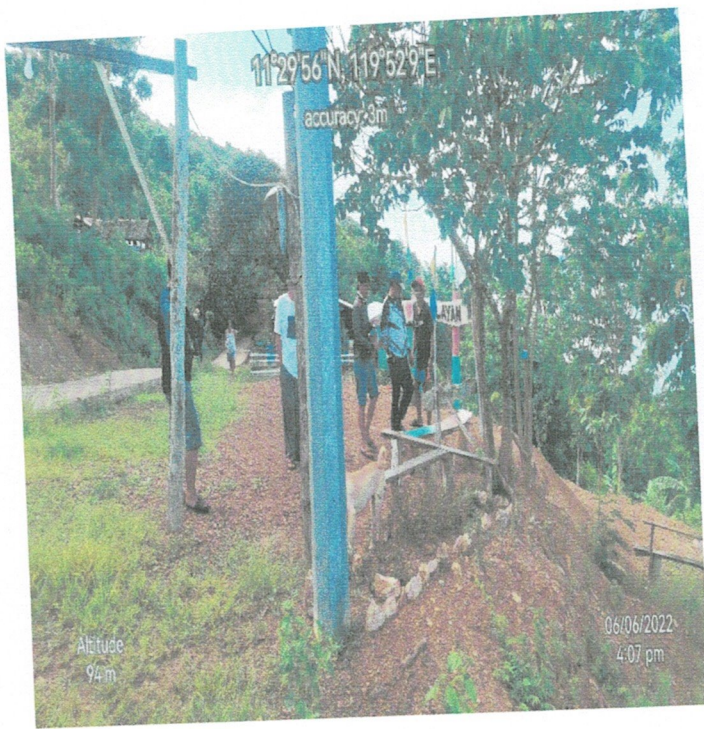

Republic of the Philippines
DEPARTMENT OF ENVIRONMENT AND NATURAL RESOURCES

CERTIFICATE OF STEWARDSHIP

To All Whom These Presents May Come, Greetings:

THAT this CERTIFICATE OF STEWARDSHIP is being awarded to:

LEO A. MONTES

of legal age, Filipino, who is (are) the actual tiller(s) of the land specified in this contract, and who commits himself/herself/themselves to the responsibilities of stewardship, with residence at Bgy. San Miguel, Linapacan, Palawan to develop and manage a SOCIAL FORESTRY AREA in accordance with the attached AGREEMENT, on a portion of forest land situated in Sitio Balete, Barangay San Miguel, Municipality of Linapacan, Province of Palawan, containing an area of 1,2430 hectares, more or less, bounded and described as follows:

**Bounded on the North by Sea Shore; on the East by Lot No. 56;
on the South by Road and Lot Nos. 57 & 58; and on the West by Lot
No. 60.**

and registered with the DEPARTMENT OF ENVIRONMENT AND NATURAL RESOURCES in accordance with existing rules and regulations.

As (a) forest land steward(s), LEO A. MONTES commit(s) himself/herself/themselves to protecting and enhancing the ecology of the land specified in this contract and to joining with other stewards in the area in protecting and enhancing their natural resource base. In exchange for such a commitment, the steward(s) shall have the right to peaceful possession, cultivation and enjoyment of his/her/their forest landholding and the fruits thereof, the right to manage and work on the forest landholdings in accordance with appropriate forest land and farm methods and practices, and such other rights as may be granted or provided by laws, orders, letters of instruction, rules and regulations.

The steward(s) shall also faithfully comply with the obligations specified under the Stewardship Agreement hereto attached.

IN TESTIMONY WHEREOF, and by the authority vested in me by law, I, VICTOR O. RAMOS, Secretary of the Department of Environment and Natural Resources, have caused this CERTIFICATE to be issued and the seal of the Department of Environment and Natural Resources to be hereunto affixed.

Given under my hand at Quezon City on this 2nd day of October in the year of our Lord One Thousand Nine Hundred and Ninety Six.

ATTESTED:

ANTONIO G. PRINCIPE

Regional Executive Director

By: INOCENCIO JESUS S. RAMOS
Social Forestry Desk Officer

VICTOR O. RAMOS

Secretary

By: DIOSDADO L. OCAMPO
CENTRO

Entered in the Registration Book of the
Department of Environment and Natural
Resources this day of _____, 19____,
under Registry Book No. _____, Page No. _____.

STATION	BEARING	DISTANCE	REMARKS
1	S. 10° E.	25 M.	STAKE
2	S. 64° W.	198 "	"
3	N. 50° W.	54 "	"
4	N. 65° W.	80 "	"
5	S. 07° W.	10 "	"
6	N. 59° W.	98 "	"
7	N. 64° E.	348 "	"

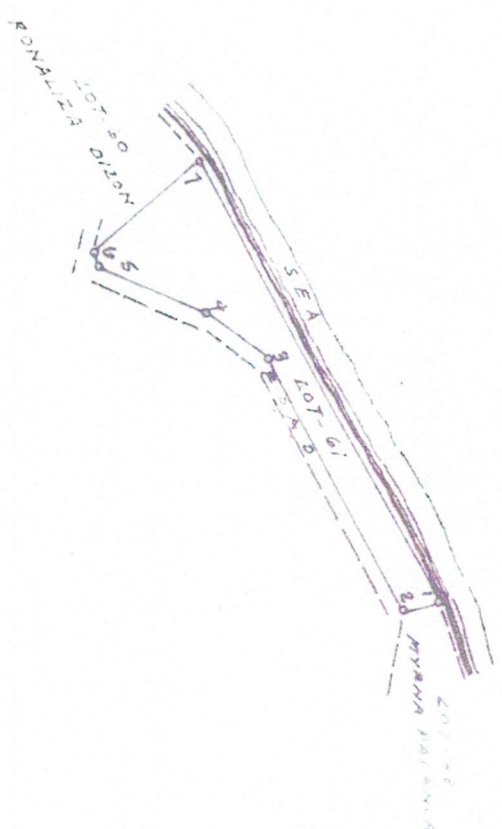

Surveyed By	DENR CENRO TEAM	Name		Position		Date	
Prepared By	JAIME C. LAMAJA						
Checked By	BERNARDO F. CASTILLO						
Verified By	DIOSDADO L. OCAMPO						

NOTE
The here in described area is subject to future precise survey.

MAP

CERTIFICATE OF STEWARDSHIP

OF AREA COVERED BY
NO. 042302005
FOR: SOCIAL FORESTRY AREA

OF

LEO MONTES

LOCATED AT

BALETE
SAN MIGUEL

SITIO
BARANGAY
MUNICIPALITY
PROVINCE

LINAPACAN
PALAWAN

APPROXIMATE AREA = 1.2430 HECTARES

SCALE 1:4,000

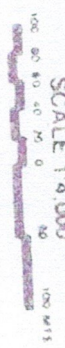

Republic of the Philippines
Department of Environment and Natural Resources
Region 4

We hereby certify that this is the correct map of the area under Stewardship Contract No. _____ of _____ as described herein for _____ SOCIAL FORESTRY AREA. This map was prepared based from the submitted compilation sketch and other references available in this Office.

INOCENCIO JESUS S. RAMOS
SOCIAL FORESTRY DESK OFFICER

RENATO BALANCA
BARANGAY CAPTAIN

APPROVED

[Signature]
DIOSDADO L. OCAMPO
CENRO