

758

STEWARDSHIP AGREEMENT HOLDER PERFORMANCE EVALUATION AND RATING SHEET

REGION : MIMAROPA
 PENRO : PALAWAN
 CENRO : Coron
 Name of CS Holder : LUCIO KRAMTA CS No.: 42001974
 Location :
 Barangay : SAN MIGUEL
 Municipality : LINAPATAN
 Province : PALAWAN
 Area Granted : 3.3263 HAS.
 Date Granted : August 21, 1996
 Status of the Area : EXPIRED

I. AREA DEVELOPMENT

1. Farm Area Development And Management

Farming Practices/Technologies (please indicate location on the attached sketch map of the farmland the development/improvements made)

Farming Practices/Technologies	Percentage Of Farm Area Covered	Crops Planted	Generated Benefits (good, fair, poor)
a. Agroforestry Farm Establishment	20%	few Narra, Ipil tree	Fair
b. Orchard and Tree Plantation	20%	Cashew plantation	Good
c. Agricrops	10%	few Casava	Fair

2. Farm Protection, Care And Maintenance

Activities	Good	Fair	Poor
a. Forest Protection	✓		
b. Fertilizer Application		✓	
c. Pesticide Application			✓

3. Other Improvements

Other Improvements	Good	Fair	Poor
a. Monument in each Farm Corner	✓		
b. Fertilizer Application		✓	
c. Pesticide Application			✓

II. CONSERVATION OF FOREST RESOURCES

Activities	Good	Fair	Poor
a. Protection of naturally growing trees	—		
b. Soil and Water Conservation/Soil Erosion		✓	

Control Measures			
c. Protection of vegetation along waterlines, rivers and streams		✓	
d. Compliance to existing forestry laws, rules and regulations		✓	

REMARKS

III. INVOLVEMENT ON THE ORGANIZATIONAL ACTIVITIES

1. Is the grantee a member of Stewardship Association/CBFM Peoples Organization?
☐ Yes ☐ No
 If yes, please specify position in the organization.

2. As officer/member, what organizational activities had you participated?

Activities	Always	Sometimes	Never
a. Meetings			
b. Planning/Decision Making			
c. Implementation/Monitoring			
d. Pahina/Collective Labor			

IV. STATUS OF OCCUPANCY:

() Actual CS Holder () Leased/Mortgaged () Sold by CS Holder

REMARKS:

The Area is fully planted of Cashew tree, the CS holder complied with the terms and conditions stated in their CS contract, and in the CS Area got 16 points equivalent to satisfactory. The team recommend for the Renewal of Stewardship Contract.

EVALUATORS:

MARK GLENN T. MANAGDAG

Team Leader

RODNEY D. VERMAY

Member

DENNIS T. JACOBIS

Member

ELIZABETH STEVENSON

Member

ALBERT ABARING

MANUELA M. PASCUA
 Member
DANIEL C. PATRON
 Member
hyndent

Barangay Official

ATTESTED BY:

RODNEY G. VERMAY
 CENR Officer

Date

Republic of the Philippines
Department of Environment and Natural Resources
Visayas Avenue, Diliman, Quezon City

DENR Form No. _____

APPLICATION FOR RENEWAL
OF CERTIFICATE OF STEWARDSHIP

1. Name: ALANTA LUCIO D.
(Last Name) (First Name) (Middle Initial)
2. Birthdate: MARCH
3. Address:
Sitio: PALETE
Barangay: SAN MIGUEL
Municipality: UNAPATAN
Province: PANAYAN
4. Educational Attainment: _____
5. Occupation: _____
6. Civil Status:
☐ Single ☒ Widow
☐ Married ☐ Others
7. Name of Spouse: _____
(If husband is applicant, indicate the maiden name of wife)

8. Names of Household Members

Names (pls indicate if holder of CS)	Age	Relationship	Educational Attainment	Occupation
THELMA DIZON	64	daughter	High School Graduate	HOUSE WIFE
CHARLO ALANTA	62	son	College Graduate	CIVIL
ARMANDO ALANTA	59	son	High School Graduate	SELF EMPLOYED
ORLANDO ALANTA	54	son	High School Graduate	BUSINESS
RUEL ALANTA	49	son	High School Graduate	SELF EMPLOYED
RODOLFO ALANTA	47	daughter	College Graduate	TECH

(Note: Use additional sheet if necessary)

Need to be translated into the local dialect

9. Estimated Annual Income of Family:

Name of Family Member	Source of Income (include on-farm and off-farm activities)	Amount of Income

10. Area covered by Existing CS (ha): 3.3263 HAS

Location: So. DAUTE, Brgy. SAN MIGUEL, LINAPARAN, PALAUAN

CS No. 42301974

Date Issued: 21/08/1996

(day/month/year)

Expiry Date: 22/08/2022

(day/month/year)

11. Place of Residence: ☐ Inside Area Occupied ☐ Outside Area Occupied

12. Are you a member of an organization? ☐ Yes ☐ No

If yes, name of the organization: _____

Position in the organization: _____

I HEREBY CERTIFY that the answers given above are true and correct to the best of my knowledge and belief and I understand that any information I have stated in this application which are contrary to facts shall factor cause the rejection of the application or cancellation of the stewardship agreement that may be granted as a result.

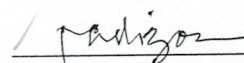

(Signature of Applicant)

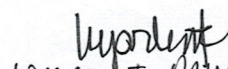
THIS IS TO CERTIFY that _____ is the holder of Certificate of Stewardship No. _____ and actually tilling the area subject of this application for renewal.

WILSON T. PRUDENTE
Barangay Official

MARK GLENN T. MANAGDAG
CBFM Coordinator

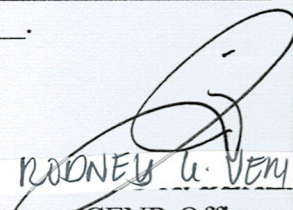
SUBSCRIBED AND SWORN to me this _____ day of _____, applicant exhibiting his residence certificate number _____ issued on _____ at _____.

RODNEY G. VERJAN
CENR Officer
6/29/22



MEMORANDUM

FOR : THE COMMUNITY ENVIRONMENT & NATURAL RESOURCES OFFICER

FROM : The CSC Evaluation & Assessment Team

SUBJECT : **EVALUATION AND ASSESSEMENT REPORT ON CSC's ISSUED LOCATED AT SITIO BALETE, BARANGAY SAN MIGUEL, LINAPACAN, PALAWAN**

DATE : June 10, 2022

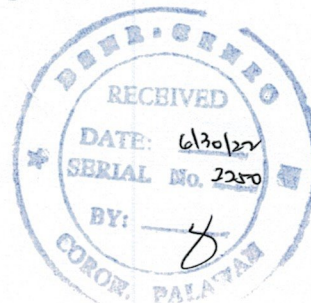

Please be informed that on June 10, 2022 the undersigned personnel of this office conducted evaluation and assessment of CSC issued to **Lucio Aganta** bearing **CSC No. 42301974** with a total area of 3.3263 hectares located at So. Balete, Barangay San Miguel, Linapacan, Palawan.

Hereunder are results of the Inspection/evaluation, to wit:

1. Mr. Lucio O. Aganta was awarded a Certificate of Stewardship Contract(CSC) on August 21, 1996 and expired on August 22, 2021.
2. The CS area is well developed fully planted with forest tress, fruit bearing tress, and agricultural crops.
3. The CS area got 75 points equivalent to "Satisfactory rating" The CS holder complied with the terms and conditions stipulated in the Stewardship Contract.

In view of the above facts and findings of the assessment and evaluation team, the aforementioned CSC is recommend for renewal of Stewardship Contract to Mr. Lucio Aganta.

Attached is duly accomplished CSC Evaluation and Assessment Form together with sketch map, and geotagged pictures taken during the conduct of assessment.

For information, record and further instruction/s.

MARK GLENN T. MANAGDAG
ECOMS-II/CBFM Desk Officer

DANILO G. PATRON
Park Maintenance

ROMULO M. VENTURA
Park Maintenance

ARGIE BILLIONES
Forester

ANGELIE U. PASCUAL
LMI

MA. LANI T. VENTURA
Forest Ranger

ELIZALDE SEGUNDO
Forest Technician II

DENNIS JAGMIS
Forest Technician II

ALBERT ABARAING
Forest Ranger

GEOGRAPHIC COORDINATES			
CORNER	LATITUDE	LONGITUDE	
1	11°29'47.90"	119°52'11.20"	
2	11°29'47.20"	119°52'01.63"	
3	11°29'49.66"	119°52'01.64"	
4	11°29'52.62"	119°52'10.61"	

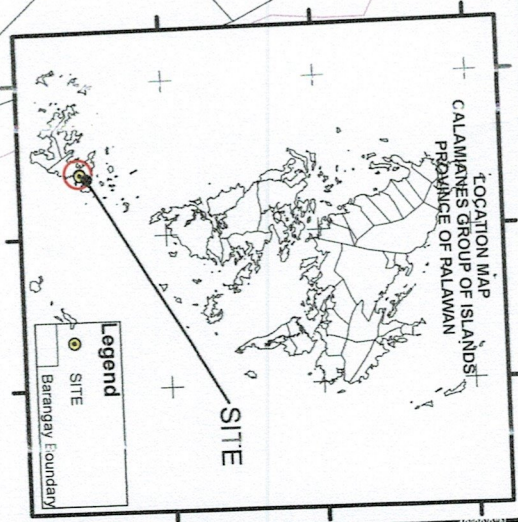

NOTE: THE HEREIN DESCRIBE SKETCH IS SUBJECT TO FUTURE PRECISE SURVEY.

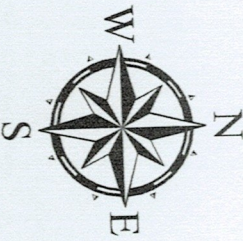
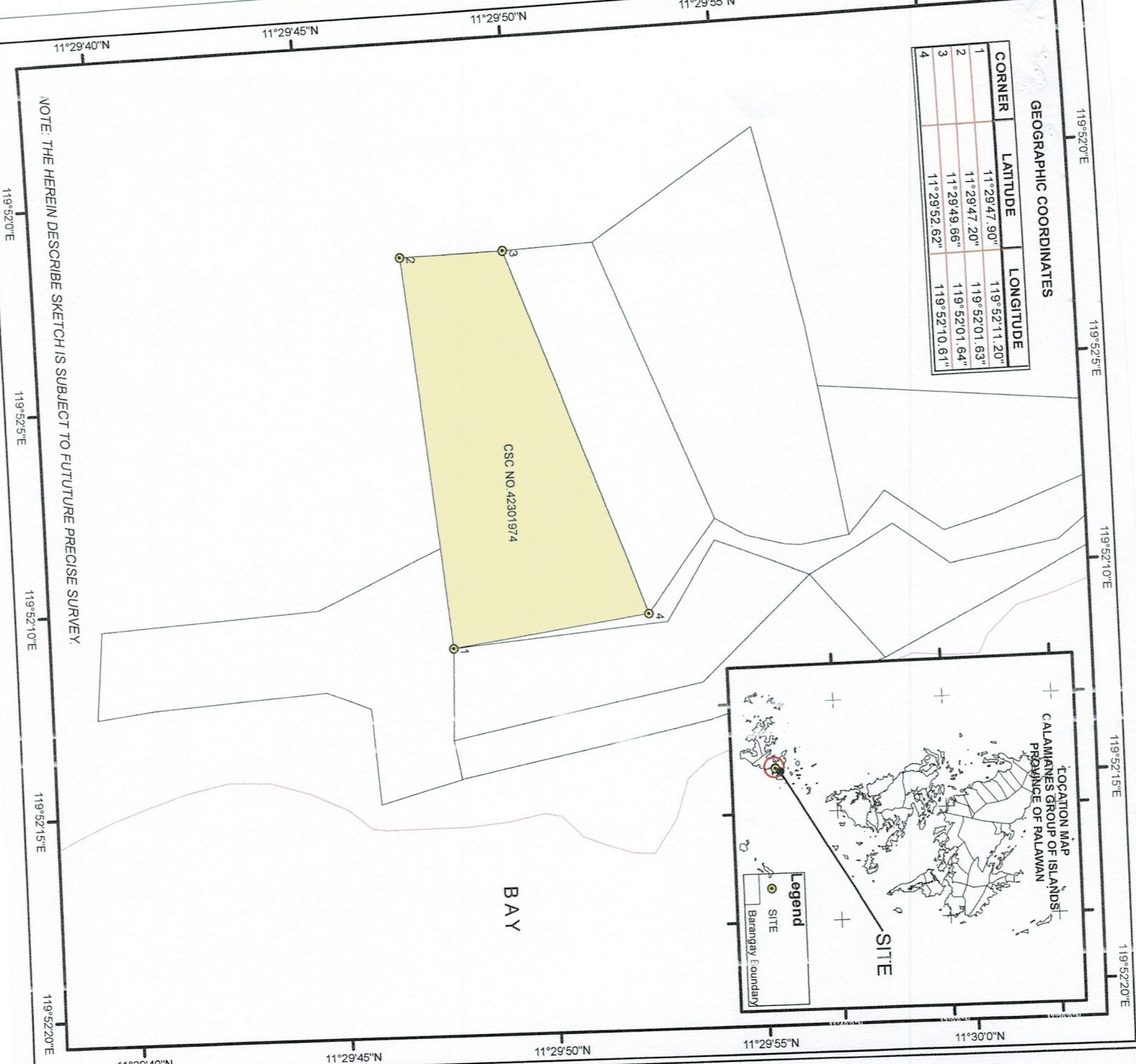

SKETCH MAP

Showing the area covered by

CERTIFICATE OF STEWARDSHIP
NO: 42301974

For: Social Forestry Area
awarded to

LUCIO AGANTA

LOCATED AT:

SITIO : BALETE
BARANGAY : SAN MIGUEL
MUNICIPALITY : LINAPACAN
PALAWAN : PALAWAN

APPROXIMATE AREA: 3.3263 H.A.S.



SCALE : 1:4000

PROJECTION : WORLD GEODETIC SYSTEM (WGS84)

- Legend
- CORNER
 - CSC_LOTS
 - LUCIO AGANTA
 - COASTLINE

PREPERED BY:

MARK GLENN D. MANAGDAG
ECOMS IICIFM DO

CHECKED BY:

FERDINAND GATCHALLIAN
Forester / Chief CDS

ATTESTED BY:

RODNEY G. VERIAN
OIC - CENRO

PHOTO DOCUMENTATION DURING THE CONDUCT OF CSC EVALUATION
AND ASSESSMENT AWARDED TO LUCIO O. AGANTA, IN SITIO BALETE,
BARANGAY. SAN MIGUEL, LINAPACAN, PALAWAN

