

TECHNICAL DESCRIPTION

TIE POINT: Beginning at a point marked "1" on the plan being identical to 117° 38' 56.9" E, 9° 00' 32.4" N.

Line	Bearing	Distance (m)
1-2	N 71° 21' 45" E	38.64
2-3	S 16° 16' 19" E	153.49
3-4	S 70° 21' 10" W	55.08
4-5	N 14° 03' 33" W	75.95
5-6	N 15° 57' 31" W	22.35
6-7	N 26° 19' 46" E	20.58
7-1	N 17° 06' 37" W	41.75

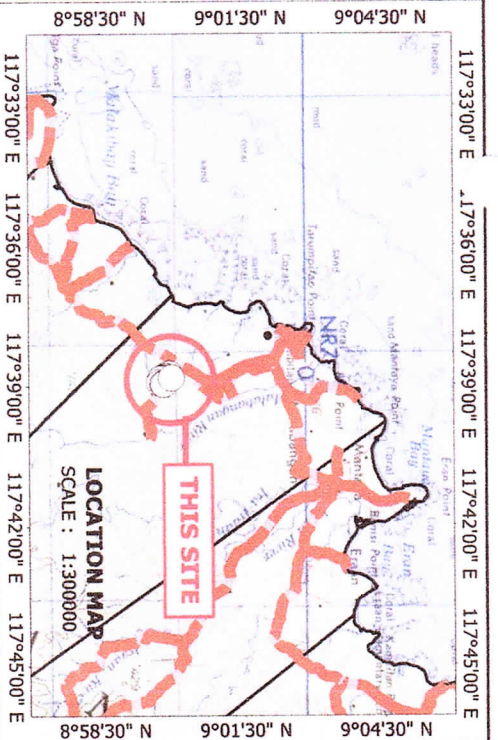

117°38'53" E

117°39'02" E

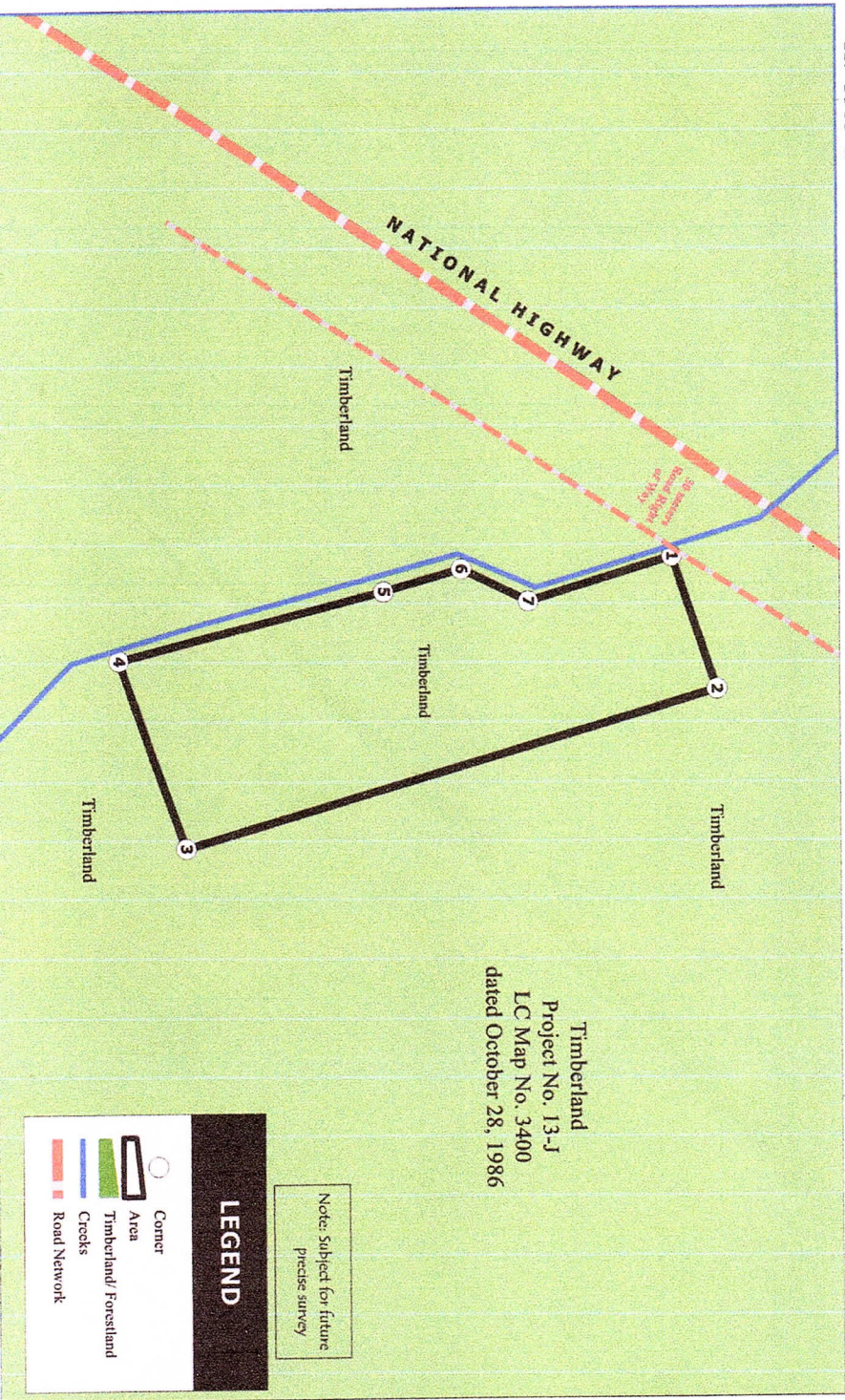

117°38'53" E

117°39'02" E



MAP

showing the
Area applied for
Presidential Proclamation as
DENR Rizal Station Site
located at
Bgy. Punta Baja, Rizal, Palawan

TOTAL AREA : 7,445 square meters

SCALE : 1:2000

Projection: Universal Transverse Mercator - Zone 50 (N)
Datum : World Geodetic 1984 (WGS84)



Republic of the Philippines
DEPARTMENT OF ENVIRONMENT AND NATURAL RESOURCES
PALAWAN REGION
COMMUNITY ENVIRONMENT AND NATURAL RESOURCES OFFICE
Quzon, Palawan

CERTIFICATION

This is to certify that this is the true and correct map of the proposed area applied for Presidential Proclamation as DENR Rizal Station Site as described in the subject area was properly verified and found to be Timberland Classification under Project No. 13-J, L.C. Map No. 3400 certified on October 28, 1986. This map was prepared based on the actual survey of the using GPS and plotted using other references available in the Office.

Digitized by:

[Signature]

KEITH R. CASTILLO

Forest Technician I

Surveyed and Verified by:

[Signature]

MICHAEL V. JOVEN

ECOMS II/ IN-CHARGE, DENR RIZAL STATION

Attested by:

[Signature]
LEONARDO CALUYA
CENRO