



Republic of the Philippines
Department of Environment and Natural Resources
MIMAROPA Region
COMMUNITY ENVIRONMENT AND NATURAL RESOURCES OFFICE
PUERTO PRINCESA CITY
South National Highway, Bgy. Sta. Monica Puerto Princesa City
Email Address: cenropuertoprincesa@denr.gov.ph
Tel. Fax No.: (048) 717-0702

October 24, 2022

MEMORANDUM

FOR : The Regional Executive Director
DENR MIMAROPA Region
1515 L & S Building, Roxas Boulevard, Ermita, Manila

ATTENTION: Surveys and Mapping Division

THRU : PENRO Palawan
Sta. Monica, Puerto Princesa City

FROM : The OIC-CENRO Puerto Princesa
Sta. Monica, Puerto Princesa City

SUBJECT : **ERROR ON THE TECHNICAL DESCRIPTION OF LOT NO. 7137, CAD. 800-D LOCATED IN BGY. IRAWAN, PUERTO PRINCESA CITY SUBJECT FOR SPECIAL PATENT APPLICATION OF CITY GOVERNMENT OF PUERTO PRINCESA FOR IRAWAN BGY. SITE**

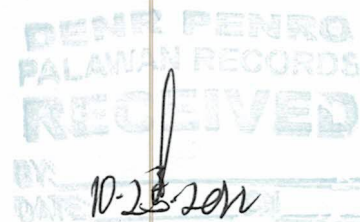

Respectfully forwarding herewith is the supplementary report dated October 21, 2022 along with the preliminary investigation report dated October 20, 2022 rendered by a representative from this Office regarding the Special Patent Application of the City Government of Puerto Princesa for Irawan Bgy. Site over Lot No. 7137, Cad. 800-D located in Bgy. Irawan, Puerto Princesa City.

Please be informed that upon checking and verification of the V-37 of Lot No. 7137, Cad. 800-D, it was found out that there is an Error of Closure (EC) of 4.16 meters on the technical description of the said lot. Attached herewith is the V-37, TD and map of the said lot.

Therefore, this Office is hereby requesting the Surveys and Mapping Division for an immediate correction and/or amendment of the said erroneous/defective technical description in order to proceed with the processing of the special patent application of the City Government of Puerto Princesa for Irawan Bgy. Site which was set as a potential target in titling of government sites this year.

For record, information and consideration.

Copy furnished:

CENRO File
DRN 2022/RPS/*cpbm

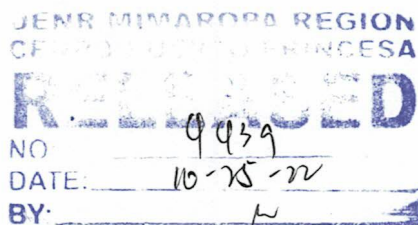

PEDRO A. VELASCO
DMO IV/OIC-CENRO



Republic of the Philippines
Department of Environment and Natural Resources
MIMAROPA Region
COMMUNITY ENVIRONMENT AND NATURAL RESOURCES OFFICE
PUERTO PRINCESA CITY
South National Highway, Bgy. Sta. Monica Puerto Princesa City
Email Address: cenropuertoprincesa@denr.gov.ph
Tel. Fax No.: (048) 433-0660

October 20, 2022

MEMORANDUM

FOR : The OIC-CENRO Puerto Princesa
Sta. Monica, Puerto Princesa City

THRU : LMO II/RPS Chief Mildred A. Pascual

FROM : SI I Christyl Pops B. Maningas

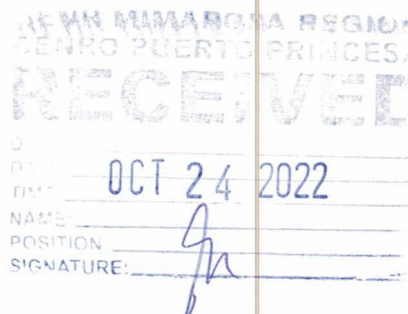

SUBJECT : **SUPPLEMENTARY REPORT RE: ERROR ON THE TECHNICAL DESCRIPTION OF LOT NO. 7137, CAD. 800-D LOCATED IN BGY. IRAWAN, PUERTO PRINCESA CITY SUBJECT FOR SPECIAL PATENT APPLICATION OF CITY GOVERNMENT OF PUERTO PRINCESA FOR IRAWAN BGY. SITE**

This report is in support to the preliminary report dated October 5, 2022 rendered by the undersigned (copy is hereto attached) regarding conducted ocular inspection and/or investigation relative to the Special Patent Application of City Government of Puerto Princesa for Irawan Bgy. Site over Lot No. 7137, Cad. 800-D located in Bgy. Irawan, Puerto Princesa City, which contains the following findings, to wit:

1. That the subject land is identified as Lot No. 7137, Cad. 800-D with an area of 4,706 square meters located in Bgy. Sta. Irawan, Puerto Princesa City bounded as:

North : Lot Nos. 7192, 7193 and 7136, all of Cad. 800-D and Road
East : Lot No. 7136, Cad. 800-D
South : Lot Nos. 7139, 7138 and 7136, all of Cad. 800-D and Road
West : Barangay Road

2. That below is the technical description of the subject lot:

Tie Line: N. 41-41 W., 9,369.35 M. from BLLM No. 1 Cad. 800-D, Puerto Princesa Cadastre.

Line	Bearing	Distance (M)
1-2	S 86-30 E	30.10
2-3	S 86-34 E	30.20
3-4	S 86-15 E	9.80
4-5	S 86-34 E	8.37
5-6	S 4-14 E	55.74
6-7	S 83-56 W	5.56
7-8	S 83-56 W	9.94
8-9	S 83-56 W	30.00
9-10	S 83-56 W	30.00
10-1	N 6-23 W	64.60

All corners are marked on the ground by P.S. cyl. conc. mons. 15 x 60 cms.;

3. That per V-37 of Lot No. 7137, Cad. 800-D it was found out that there is an error of

4. That in order for this Office to continue the processing of the Special Patent Application of the City Government of Puerto Princesa for Irawan Bgy. Site over the subject lot, it is requested for the Regional Office thru the Surveys and Mapping Division (SMD) to correct and/or amend the said error of closure;
5. That attached herewith are the B.L. Form V-37 and technical description of Lot No. 7137, Cad. 800-D which were used as reference;
6. Therefore, in view of the aforementioned findings, it is hereby recommended that the matter be forwarded to the Surveys and Mapping Division of the DENR MIMAROPA Regional Office subject for correction and/or amendment of the erroneous/defective technical description of Lot No. 7137, Cad. 800-D located in Bgy. Irawan, Puerto Princesa City in order for this Office to proceed with the titling of its special patent application.

I solemnly swear under the penalty of perjury that the above-mentioned findings are true and correct to the best of our knowledge and information.

Very truly yours,

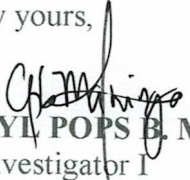
CHRISTYL POBS B. MANINGAS
Special Investigator I

SUBSCRIBED AND SWORN to before me on the above-stated date at DENR-CENRO Puerto Princesa City, Palawan.

MILDRED A. PASCUAL
LMO II/Chief, RPS

Republic of the Philippines
Department of Environment and Natural Resources
Region IV- B, MIMAROPA
COMMUNITY ENVIRONMENT AND NATURAL RESOURCES OFFICE
South National Highway, Bgy. Sta. Monica Puerto Princesa City

Application No. _____

Applicant _____

Surveyed for CITY GOVT

Surveyed by H. L. VILLA MAYOR

Date of Survey Sept 1 - Oct 31, 1984

Date Approved Jan. 8, 1985

Lot No. 7137 Survey No. CAO-808-D

Identical Lot No. _____

Portion of Lot No. _____

Area: 4.706 square meters

Location Bgy. Irawan, Pta. Princesa City

Date of Original Survey : _____

TECHNICAL DESCRIPTION

TIE LINE N 41-41W 9369.25 M. from PLLM #1 CAO-808-D
Pta. Princesa Cadastre

LINE	BEARINGS	DISTANCE	LINE	BEARINGS	DISTANCE
1-2	S 86-30 E	30.18			
2-3	S 86-34 E	30.20			
3-4	S 86-15 E	9.88			
4-5	S 86-34 E	8.37			
5-6	S 4-14 E	55.74			
6-7	S 83-56 W	5.56			
7-8	S 83-56 W	9.94			
8-9	S 83-56 W	30.08			
9-10	S 83-56 W	30.08			
10-1	N 6-23 W	64.60			

SKETCH

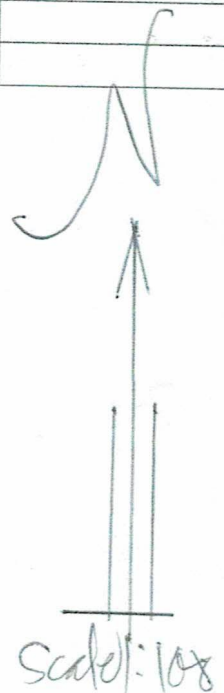
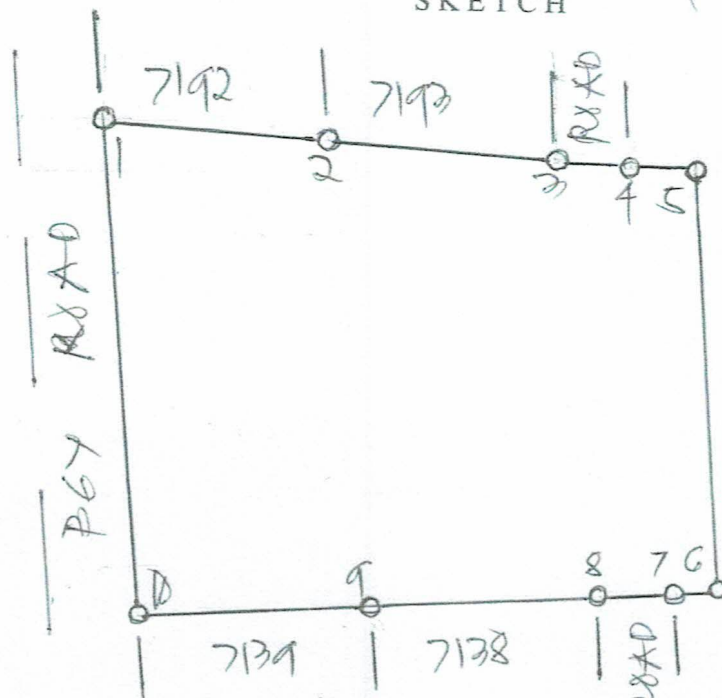

T. D. Research by J. ad.

T. D. Sketch by: H. L. VILLA MAYOR

T. D. Checked by: H. L. VILLA MAYOR

Date: _____

Date: 10-11-22

LOT DESCRIPTIONS

Survey No. Ced 800-D Case No. 33 Mun. of PTD. PRINCESA CITY Prov. of PALAWAN

Lot No.	BEARINGS AND DISTANCES						Area In Sq. Meters
	Claimant	BLIM 1 to Corner 1	Line 1-2	Line 2-3	Line 3-4	Line 4-5	
7133	Cont'd		S. 14° 13' W 5.54				9,525
7134	BACALTOS	N 39.47 W 3052.36	S 45.37 104.75	S 40.57 W 77.44	N 46.19 W 40.17	N 44.57 E 78.64	8,379
7135	ALFONCIO MACASAET	N 40.44 W 3039.94	S 44.57 W 22.27	N 00.0 W 207.04	N 00.06 W 208.57	N 56.44 E 22.62	100.86
			N 4.25 W 232.55	S 01.56 E 82.91	S 02.46 E 240.52	S 08.33 E 150.52	N 59.23 E 44.45
			S 45.30 E 38.55	S 69.38 W 267.73	S 65.44 W 224.90	S 28.41 E 77.16	S 76.25 E 49.10
			S 59.42 E 43.53	S 31.31 E 45.30	S 6.10 W 168.05	N 78.18 W 38.61	N 00.28 W 38.65
			N 79.13 W 31.44	S 82.17 W 80.80	S 44.18 E 25.37	S 44.57 W 78.64	S 44.57 W 70.53
7136	ANGELITA MACASAET	N 40.52 W 3038.26	S 45.47 W 40.00	N 74.18 W 109.32	N 49 W 18.16	N 80.53 W 80.35	N 5.55 W 87.38
			N 83.56 E 5.56	N 4.14 W 55.74	N 86.34 W 8.37	N 3.00 W 20.70	N 84.30 E 248.32
			S 0.04 E 207.04				
7137	CITY GOVT	N 41.41 W 3263.35	S 86.30 E 30.10	S 86.34 E 30.20	S 86.15 E 9.80	S 86.34 E 8.52	S 4.14 E 55.74
			S 83.56 W 5.56	S 83.56 W 5.94	S 83.56 W 30.00	S 83.56 W 30.00	N 8.23 W 64.60
7138		N 41.49 W 3287.00	N 5.55 W 15.00	N 83.56 E 30.00	S 5.55 E 15.00	N 83.56 E 30.00	450
7139		N 41.49 W 3287.00	S 83.56 W 30.00	N 5.55 W 15.00	N 83.56 E 30.00	S 5.55 E 15.00	450
7140		N 41.49 W 3287.00	N 83.56 E 30.00	S 5.55 E 15.00	S 83.56 W 30.00	N 5.55 W 15.00	450
7141		N 41.49 W 3287.00	S 5.55 E 15.00	S 83.56 W 30.00	N 5.55 W 15.00	N 83.56 E 30.00	450
7142		N 41.58 W 3253.97	N 5.55 W 15.00	N 83.56 E 30.00	S 5.55 E 15.00	S 83.56 W 30.00	450
7143		N 41.55 W 3262.71	S 83.56 W 30.00	N 5.55 W 15.00	N 83.56 E 30.00	S 5.55 E 15.00	450
7144		N 41.58 W 3253.97	N 83.56 E 30.00	S 5.55 E 15.00	S 83.56 W 30.00	N 5.55 W 15.00	450
7145		N 41.55 W 3262.71	S 5.55 E 15.00	S 83.56 W 30.00	N 5.55 W 15.00	N 83.56 E 30.00	450

CERTIFIED CORRECT:

January 8, 1985

Copied by [Signature], 19

Surveyed Sept. 1 - Oct. 31, 198

Checked by [Signature], 19

ELEUTERIO R. PAZ

Chief, Survey Division, Region

Checked by [Signature], 19

H. L. VILLAMAYOR

Geodetic Engineer



Republic of the Philippines
Department of Environment and Natural Resources
MIMAROPA Region
COMMUNITY ENVIRONMENT AND NATURAL RESOURCES OFFICE
PUERTO PRINCESA CITY
South National Highway, Bgy. Sta. Monica Puerto Princesa City
Email Address: cenropuertoprincesa@denr.gov.ph
Tel. Fax No.: (048) 433-0660

October 5, 2022

MEMORANDUM

FOR : The OIC-Community Environment and Natural Resources Officer
Sta. Monica, Puerto Princesa City

THRU : Mildred A. Pascual
LMO II/Chief, Regulation and Permitting Section

FROM : Christyl Pops B. Maningas
Special Investigator I

SUBJECT : **PRELIMINARY REPORT ON THE CONDUCTED OCULAR INSPECTION/INVESTIGATION RE: THE REQUEST FOR ISSUANCE OF SPECIAL PATENT OF CITY GOVERNMENT OF PUERTO PRINCESA – IRAWAN BARANGAY SITE OVER LOT NO. 7137, CAD. 800-D LOCATED IN BGY. IRAWAN, PUERTO PRINCESA CITY**



Please be informed that on October 4, 2022, the undersigned together with LMO II Eliza B. Aborot and MA I Reynaldo V. Macola of this Office conducted an ocular inspection and/or ground verification relative to the request of the City Government of Puerto Princesa – Irawan Barangay Site for issuance of Special Patent over Lot No. 7137, Cad. 800-D located in Bgy. Irawan, Puerto Princesa City in which the following were ascertained, to wit:

1. That the subject land is identified as Lot No. 7137, Cad. 800-D with an area of 4,706 square meters located in Bgy. Irawan, Puerto Princesa City bounded on the ff:
North : Lot No. 7192, Cad. 800-D
East : Lot No. 7136, Cad. 800-D
South : Lot Nos. 7138 and 7139, Cad. 800-D and Road (10.00 M. Wide)
West : Barangay Road (10.00 M. Wide)
2. That per Certification dated October 3, 2022, records show that Lot No. 7137, Cad. 800-D with an area of 4,706 sq. m. located in Bgy. Irawan, Puerto Princesa City is listed in the name of City Government of Puerto Princesa and is covered by Miscellaneous Sales Application No. 045316-3587 of Barangay Irawan represented by Noel B. Resuma which was filed on December 13, 2019;
3. That per Certification dated April 25, 2022, Lot No. 7137, Cad. 800-D with an area of 4,706 sq. m. located in Bgy. Irawan, Puerto Princesa City has been verified to be within Alienable and Disposable Land as per approved Land Classification Map No. 203, Project No. 1, Block A, certified on December 29, 1923;
4. That the City Government of Puerto Princesa represented by City Mayor Lucilo R. Bayron filed a Request for Issuance of Special Patent for Local or National Government Institutions dated October 4, 2022 for Irawan Bgy. Site over Lot No. 7137, Cad. 800-D which was subscribed and sworn to before Atty. Kerwin Arnold Mawie C. Palatino under Doc. No. 500; Page No. 101; Book No. 78; Series of 2022;

5. That on October 4, 2022, the team proceeded to the subject area and conducted ocular inspection and geo-tagged photos and likewise had a meeting/conversation together with Hon. Noel B. Resuma (please see attendance sheet) and representatives from the City Assessor's Office informing them of the documentary requirements in the issuance of Special Patent pursuant to DAO 2016-21 subject for compliance;
6. That upon ocular inspection, the subject lot is actually occupied, used, and possessed by Irawan Bgy. ~~Site~~ with introduced improvements thereon made of concrete and permanent materials such as old and new barangay hall, covered gym, day care center, San Isidro Labrador – Irawan Chapel, shed and others;
7. That the subject area is fenced with cyclone wires with concrete posts and buho;
8. That the parcel of land occupied by the Irawan Barangay Site subject of the request of the City Government of Puerto Princesa City for issuance of Special patent is suitable for the purpose it is devoted for under Section 7.3 of DAO 2016-21 dated June 30, 2016;
9. That shown herewith are the geo-tagged photographs taken during the conduct of ocular inspection over the subject area on October 4, 2022 located in Bgy. Irawan, Puerto Princesa City.

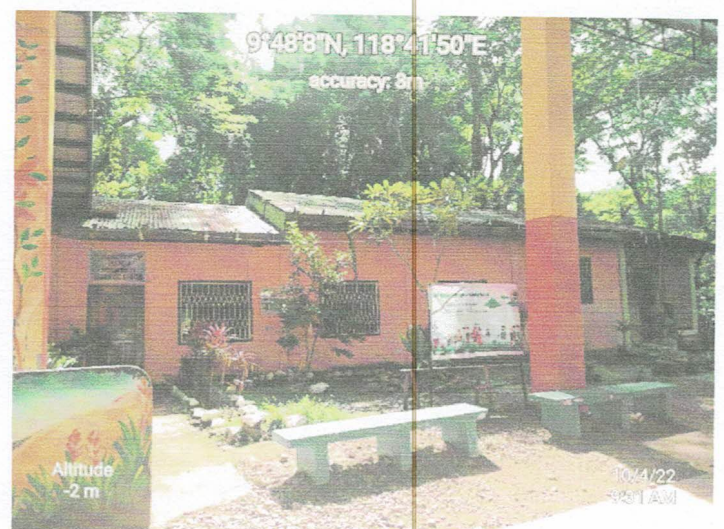

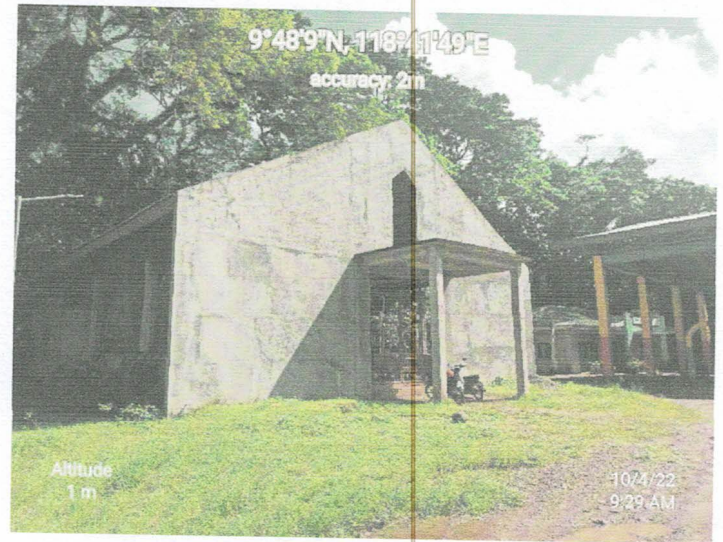

In view of the following findings, it is hereby recommended that the M.S.A. No. 045316-3587 of Barangay Irawan rep. by Noel B. Resuma filed on December 13, 2019 be ordered rejected. Conformably herewith, the Request for Issuance of Special Patent for Local or National Government Institutions of the City Government of Puerto Princesa rep. by City Mayor Lucilo R. Bayron dated October 4, 2022 for Irawan Bgy. Site covering Lot No. 7137, Cad. 800-D located in Bgy. Irawan, Puerto Princesa City be accepted and given due course pursuant to the provisions of DAO 2016-21 upon further review and evaluation.

I solemnly swear under the penalty of perjury that the above-mentioned findings are true and correct to the best of our knowledge and information.

Very truly yours,

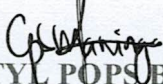
CHRISTYL POPSB. MANINGAS
 Special Investigator I

SUBSCRIBED AND SWORN to before me on the above-stated date at Puerto Princesa City, Palawan.

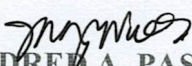
MILDRED A. PASCUAL
 Land Management Officer II/Chief, RPS

