

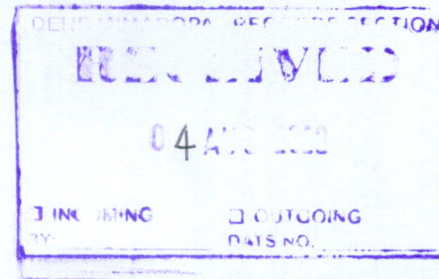

Republic of the Philippines
Department of Environment and Natural Resources
MIMAROPA REGION

PROVINCIAL ENVIRONMENT AND NATURAL RESOURCES OFFICE
Bgy. Sta. Monica, Puerto Princesa City, Palawan
Telfax No. (048) 434-8791
Email Add: penropalawan@denr.gov.ph

July 21, 2022



MEMORANDUM

FOR : The Regional Executive Director
Denr-Mimaropa, 1515 L & S Bldg.
Roxas Blvd., Ermita, Manila

ATTENTION : The OIC-Assistant Regional Director for Technical Services
The Chief, Surveys and Mapping Division

FROM : The Provincial Environment and
Natural Resources Officer

SUBJECT : **PUBLIC LAND APPLICATION COVERING
RESULTANT LOTS IN THE MUNICIPALITY OF
ROXAS, PALAWAN**

Forwarded is the Memorandum of CENRO Roxas, Palawan dated April 29, 2022 requesting for confirmation of land classification status for the issuance of patent.

Further, this Office evaluated the findings of the CENRO as to its land classification status aided with sketch map covering eleven (11) lots in compliance to DMC No. 2019-10 dated December 11, 2019.

For information, record and consideration.

For the PENRO:

JOHNNY P. LILANG
Chief TSD/Officer In-Charge

Reference No: 2022-3892
Surveys Does

DENR-PALAWAN
PENRO-RECORDS
RELEASED
By 27 JUL 2022 CN 22-1865
Date: 27 JUL 2022



R4B PENRO Palawan <penropalawan@denr.gov.ph>

PLA COVERING RESULTANT LOTS IN ROXAS, PALAWAN ROGELIO CARILLO, ET.AL

1 message

R4B CENRO Roxas Palawan <cenroroxaspalawan@denr.gov.ph>
To: R4B PENRO Palawan <penropalawan@denr.gov.ph>
Cc: Donna Belle Luengo <surveysandmappingunit@gmail.com>

Thu, May 5, 2022 at 1:44 PM

PLA COVERING RESULTANT LOTS IN ROXAS, PALA...

Good day,

Please see attached file.

Thank you and God bless

—
PABLO L. CRUZ
CENRO

.....
DENR-CENRO Roxas, Palawan
Sandoval Street, Bgy. III,
Roxas, Palawan 5308
PHILIPPINES

Email: cenroroxaspalawan@denr.gov.ph

Contact Number:
Telephone: 048-717-0892

**DENR PENRO
PALAWAN RECORDS
RECEIVED**

BY: _____
DATE 05-06-2022 22:38

Virus-free. www.avast.com



Republic of the Philippines
Department of Environment and Natural Resources
Region IV- MIMAROPA
COMMUNITY ENVIRONMENT AND NATURAL RESOURCES OFFICE
Barangay III (Poblacion), Roxas, Palawan
Contact No. 09171606578 / 09175028647
Email address: cenroxaspalawan@denr.gov.ph

MEMORANDUM

FOR : The Provincial Environment and Natural Resources Officer

FROM : The CENR Officer

SUBJECT : **PUBLIC LAND APPLICATIONS COVERING RESULTANT LOTS IN THE MUNICIPALITY OF ROXAS, PALAWAN.**

DATE : 29 April 2022

Herewith for clearance confirming LC findings as required in the processing and issuance of patent pursuant to DMC 2019-10, are land classification certifications of the resultant lots, which are found to be within the agricultural (alienable /disposable) lands.

	NAME	LOT NO.	AREA/S Q.M.	LOCATION
1.	ROGELIO M. CARILLO	1382-H, CSD-04-020876-D	5,162	BARANGAY SAN JOSE, ROXAS, PALAWAN
2.	AMELITA D. DELA TORRE	18, CSD-045318-012975	598	BARANGAY STO TOMAS, ROXAS, PALAWAN
3.	ALMERA M. RODRIGUEZ	24, CSD-045318-012975	598	BARANGAY STO TOMAS, ROXAS, PALAWAN
4.	VERGINITA R. SALDUA	22, CSD-045318-012975	600	BARANGAY STO TOMAS, ROXAS, PALAWAN
5.	RODEL A. MACAYA	76, CSD-045318-012976	600	BARANGAY STO TOMAS, ROXAS, PALAWAN
6.	ANNALIZA V. ABAD	56, CSD-045318-012975	40,507	BARANGAY STO TOMAS, ROXAS, PALAWAN
7.	ERIC JOHN M. GATCHALIAN	18, CSD-045318-012976	596	BARANGAY STO TOMAS, ROXAS, PALAWAN
8.	ESTRELITA R. LABUTOY	65, CSD-045318-012976	65	BARANGAY STO TOMAS, ROXAS, PALAWAN
9.	MANILYN G. FELIZARTE	61, CSD-045318-012976	599	BARANGAY STO TOMAS, ROXAS, PALAWAN
10	ZENAIDA P. NAVARRO	10, CSD-045318-012976	600	BARANGAY STO TOMAS, ROXAS, PALAWAN
11	ELENITA E. VUELBA	62, CSD-045318-012975	638	BARANGAY STO TOMAS, ROXAS, PALAWAN

Attached in support hereof as required by the Surveys and Mapping Division (SMD) are the technical description thereof and a print of the corresponding projection map recently provided this Office also by the SMD.

Thank you for considering the matter soonest.

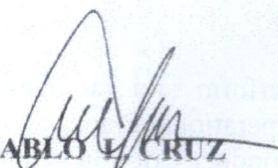
PABLO L. CRUZ

Copy: The PENRO
File

DENR-CENRO ROXAS
RELEASED
DATE: 05/05/2022
BY: [Signature]
DOC/NO. 2022-05-0656

[illegible]

LOCATION MAP SCALE 1:700,000



MAP SHOWING

THE RELATIVE LOCATION OF LOT 1382-H
FOR LC CERTIFICATION APPLIED BY
ROGELIO CARILLO

Located at Brgy. San Jose

Municipality of Roxas
Province of Palawan

Coordinate System: Luzon 1911 UTM Zone 50N

Projection: Transverse Mercator

Datum: Luzon 1911

SCALE 1:1000

LEGEND

- | | | |
|--|------------------------|----------------|
| | LOT 1382-H | |
| | CADT_CADC | |
| | Alienable & Disposable | 18,077.90 Hrs. |
| | Forestland | 8,180.96 Hrs. |
| | UPF | 62,390.16 Hrs. |
| | No Data | 9.84 Hrs. |
| | PA_MIMAROPA_UTMZN50 | |

Prepared by:

DAVEN. BALMORES
For III

DONNA BELLE LUENGO
Engr. II



Republic of the Philippines
Department of Environment and Natural Resources
MIMAROPA REGION
PROVINCIAL ENVIRONMENT AND NATURAL RESOURCES OFFICE
Bgy. Sta. Monica, Puerto Princesa City, Palawan
Telfax No. (048) 434-8791
Email Add: pcnropalawan@denr.gov.ph

(ANNEX I)

CERTIFICATION

TO WHOM IT MAY CONCERN:

THIS IS TO CERTIFY that based on available records, the tract of land in Barangay San Jose, Roxas, Palawan, containing an area of *FIVE THOUSAND ONE HUNDRED SIXTY TWO* (5,162) square meters, identified as **Lot No. 1382-H, CSD-04-020876-D** subject of application of Mr. ROGELIO M. CARILLO, Free Patent Application No. _____ was verified to be within **Alienable and Disposable Land** per LC Map No. 2419, Project No. 14-C, Block I, certified on December 22, 1960.

Issued this 20th day of July 2022, at DENR Office, Sta. Monica, Puerto Princesa City.

Checked/Verified by:

Engr. Donna Belle E. Luengo
Engineer II
Unit Head, Surveys and Mapping Unit

CONCURRED:

For the PENRO

JOHNNY P. LILANG
Chief TSD/Officer In-Charge

Note:
Reference used was based on the rectified LC map
provided and projected by the Regional Office

DENR-PALAWAN
PENRO-RECORDS
RELEASED
By _____
Date 27 JUL 2022



Republic of the Philippines
Department of Environment and Natural Resources

Region IV- MIMAROPA
COMMUNITY ENVIRONMENT AND NATURAL RESOURCES OFFICE

Barangay III (Poblacion), Roxas, Palawan
Contact No. 09171606578 / 09175028647
Email address: cenroroxaspalawan@denr.gov.ph

CERTIFICATION

TO WHOM IT MAY CONCERN:

THIS IS TO CERTIFY that based on available records in our office, the tract of land in Barangay **San Jose**, Municipality of **Roxas** Province of **Palawan**, containing an area of **Five Thousand One Hundred Sixty Two (5,162)** square meters, identified as Lot No. **1382-H, Csd-04-020876-D** as listed claimant for by **MR. ROGELIO M. CARILLO** was verified to be within **AGRICULTURAL (Alienable or Disposable)** per L.C. Map No. **2419**, F.A.O. No. **4-937**, Project No. **14-C** certified on **December 22, 1960**.

Issued this **22th** day of **April 2022** at **CENRO, Roxas, Palawan**.

Checked by:

RONNIE P. ILANG
LMO III/Chief, RPS

Approved:

PABLO I. CRUZ
CENRO



FPA -No. 045318- 2498

Applicant : ROGELIO M. CARILLO

Lot No. 1382-H, Csd-04-020876-D

Ident. To Lot No. 10285, Cad. 862-D

Portion of Lot No. 852, Pls-798 Surveyed for: Tiburcio Dangan, et. al

Date of Original Survey : _____ Surveyed by : _____

Area (sq. m.) 5,162 Date of Survey: _____

Location : Bgy. San Jose, Roxas, Palawan Date Approved: _____

TECHNICAL DESCRIPTION

THE LINE :

N. 01° 18' W. 8654.41 m. from BLLM #1, PLS-798

LINE	BEARINGS	DISTANCE	LINE	BEARINGS	DISTANCE
1-2	N 43 11 E	24.08 m.		171.558	16.479
2-3	S 51 22 E	64.10 m.		-40.070	50.072
3-4	S 39 18 W	77.40 m.		-59.895	49.024
4-5	N 51 22 W	69.33 m.		43.285	54.118
5-1	N 43 11 E	53.54 m.		39.640	36.639
				0.03	0.008

SKETCH

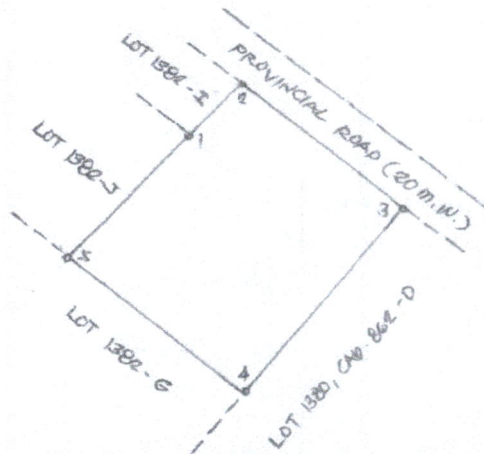

12671.00

ON)

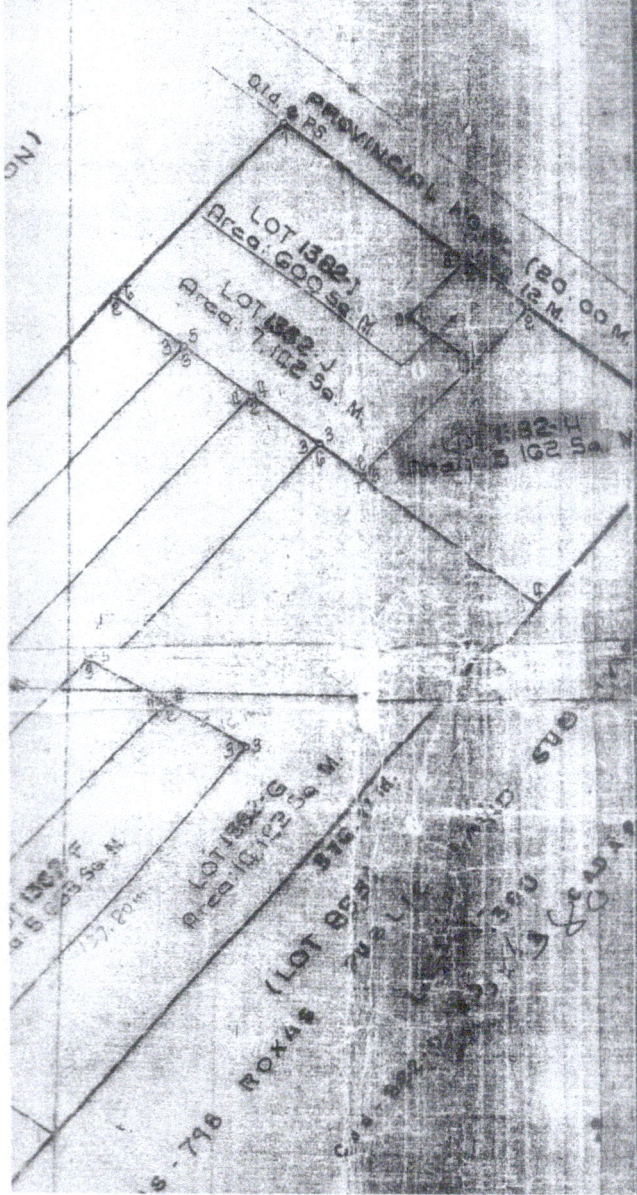



Republic of the Philippines
Department of Environment and Natural Resources
Region IV
COMMUNITY ENVIRONMENT AND NATURAL RESOURCES OFFICE
Roxas, Palawan

No. _____ Applicant: AMELITA D. DELA TORRE
Lot No. 18, Csd-045318-012975 Ident. To Lot No. 1967 CAD. 802-D
Portion of Lot No. 7742 CAD. 802-D Surveyed for: REPUBLIC OF THE PHILIPPINES
Date of Original Survey: JAN - JUNE 1987 Surveyed by: JESUS C. PENILLA
Area (sq. m.) 598 Date of Survey: MAY 5-31, 1993
Location: STO. TOMAS (KAAAN) ROXAS, PAL. Date Approved: AUGUST 5, 1994

TECHNICAL DESCRIPTION

TIE LINE: N 05° 51' E 13,245.25 m fr. BLM#1, CAD. 802-D, ROXAS CADASTAL

LINE	BEARINGS	DISTANCE	LINE	BEARINGS	DISTANCE
1-2	N 18° 25' E	30.00 m.			
2-3	S 71° 35' E	17.88 m.			
3-4	S 26° 35' E	3.00 m.			
4-5	S 18° 25' W	27.88 m.			
5-1	N 71° 35' W	20.00 m.			

SKETCH



PROJ. NO. 14-C, BLK-XII
LC 2380, DATED OCT. 13, 1981

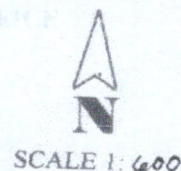



Republic of the Philippines
Département of Environment and Natural Resources
MIMAROPA REGION
PROVINCIAL ENVIRONMENT AND NATURAL RESOURCES OFFICE
Bgy. Sta. Monica, Puerto Princesa City, Palawan
Telfax No. (048) 434-8791
Email Add: penropalawan@denr.gov.ph

(ANNEX I)

CERTIFICATION

TO WHOM IT MAY CONCERN:

THIS IS TO CERTIFY that based on available records, the tract of land in Barangay Sto. Tomas, Roxas, Palawan, containing an area of *FIVE HUNDRED NINETY EIGHT* (598) square meters, identified as **Lot No. 18, CSD-045318-012975** subject of application of Ms. AMELITA D. DELA TORRE, Free Patent Application No. _____ was verified to be within **Alienable and Disposable Land** per LC Map No. 2880, Project No. 14-C, Block XII, certified on October 13, 1981.

Issued this 20th day of July 2022, at DENR Office, Sta. Monica, Puerto Princesa City.

Checked/Verified by:



Engr. Donna Belle E. Luengo
Engineer II
Unit Head, Surveys and Mapping Unit

CONCURRED:

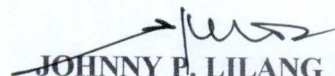
For the PENRO

JOHNNY P. LILANG
Chief TSD/Officer In-Charge

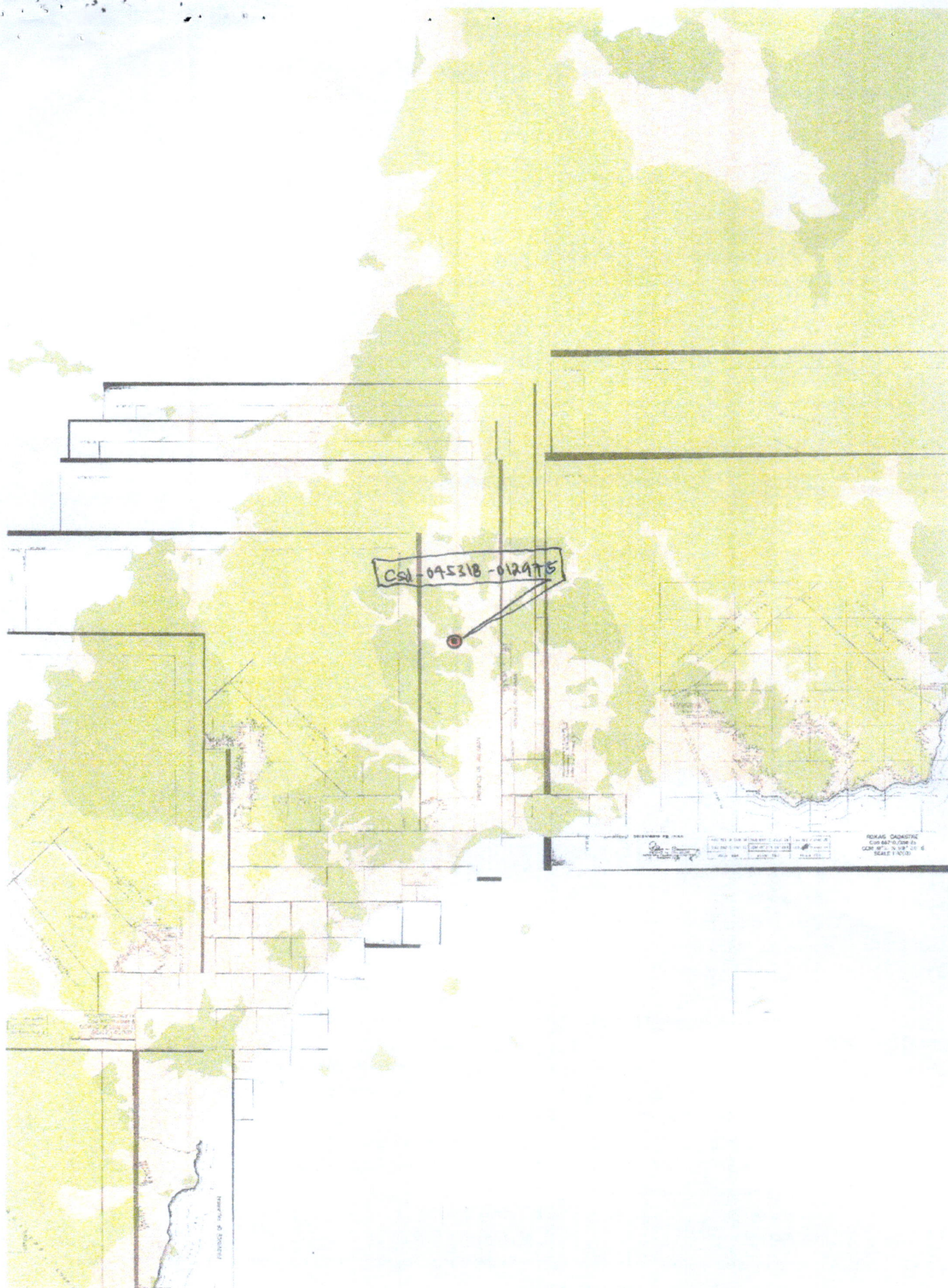
Note:
Reference used was based on the rectified LC map
provided and projected by the Regional Office





Republic of the Philippines
Department of Environment and Natural Resources
MIMAROPA REGION
PROVINCIAL ENVIRONMENT AND NATURAL RESOURCES OFFICE
Bgy. Sta. Monica, Puerto Princesa City, Palawan
Telfax No. (048) 434-8791
Email Add: penropalawan@denr.gov.ph

(ANNEX I)

CERTIFICATION

TO WHOM IT MAY CONCERN:

THIS IS TO CERTIFY that based on available records, the tract of land in Barangay Sto. Tomas, Roxas, Palawan, containing an area of *FIVE HUNDRED NINETY EIGHT* (598) square meters, identified as **Lot No. 24, CSD-045318-012975** subject of application of Ms. ALMERA M. RODRIGUEZ, Free Patent Application No. _____ was verified to be within **Alienable and Disposable Land** per LC Map No. 2880, Project No. 14-C, Block XII, certified on October 13, 1981.

Issued this 20th day of July 2022, at DENR Office, Sta. Monica, Puerto Princesa City.

Checked/Verified by:

Engr. Donna Belle B. Luengo
Engineer II
Unit Head, Surveys and Mapping Unit

CONCURRED:

For the PENRO

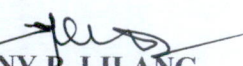
JOHNNY P. LILANG
Chief TSD/Officer In-Charge

Note:

Reference used was based on the rectified LC map provided and projected by the Regional Office

DENR-PALAWAN
PENRO-RECORDS
RELEASED
By: 
Date: 27 JUL 2022 CN: _____



Republic of the Philippines
Department of Environment and Natural Resources

Region IV- MIMAROPA
COMMUNITY ENVIRONMENT AND NATURAL RESOURCES OFFICE

Barangay III (Poblacion), Roxas, Palawan
Contact No. 09171606578 / 09175028647
Email address: cenroxaspalawan@denr.gov.ph

CERTIFICATION

TO WHOM IT MAY CONCERN:

THIS IS TO CERTIFY that based on available records in our office, the tract of land in Barangay Sto. Tomas, Municipality of Roxas, Province of Palawan, containing an area of **five hundred ninety eight (598)** square meters, identified as **Lot No. 24, Csd.-045318-012975**, as applied for by **Almera M. Rodriguez** was verified to be within Agricultural lands (alienable or disposable) per L.C. Map No. 2880, F.A.O. No. _____, Project No. 14-C certified on October 13, 1981.

Issued this 28th day of March 2022 at CENRO, Roxas, Palawan.

Checked by:

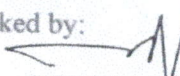
RONNIE P. LILANG
LMO III/ Chief, RPS

Approved:

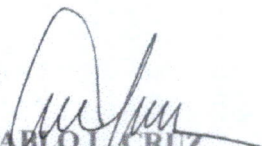
PABLO L. CRUZ
CENR Officer



Republic of the Philippines
Department of Environment and Natural Resources
Region IV
COMMUNITY ENVIRONMENT AND NATURAL RESOURCES OFFICE
Roxas, Palawan

No. _____ Applicant ALMENA M. RODRIGUEZ
Lot No. 24, Csd-095318-012975 Ident. To Lot No. 1975 CAD. 862-D
Portion of Lot No. 7742 CAD. 862-D Surveyed for: REPUBLIC OF THE PHIL.
Date of Original Survey: JAN-JUNE 1987 Surveyed by: _____
Area (sq. m.) 598 Date of Survey: MAY 5-31, 1993
Location: STO. TOMAS, ROXAS, PAL. Date Approved: AUGUST 5, 1994

TECHNICAL DESCRIPTION

TIE LINE: N 65° 51' E 13,245.25 m ft BLM #1, CAD 862-D, ROXAS CADASTLE

LINE	BEARINGS	DISTANCE	LINE	BEARINGS	DISTANCE
1-2	S 71-35 E	20.00 m.			
2-3	S 18-25 W	27.88 m.			
3-4	S 63-25 W	3.00 m.			
4-5	N 71-35 W	17.88 m.			
5-1	N 18-25 E	30.00 m.			

SKETCH

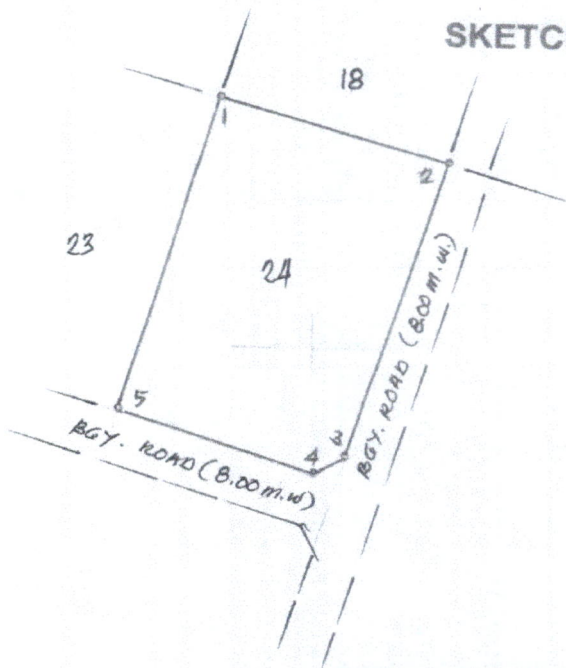

PROJ. NO. 14-C, BLK-XII
LC 2880, DATED OCT. 13, 1981

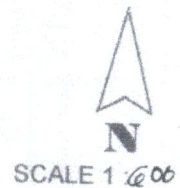

T.D. Researched by: _____

Date: _____

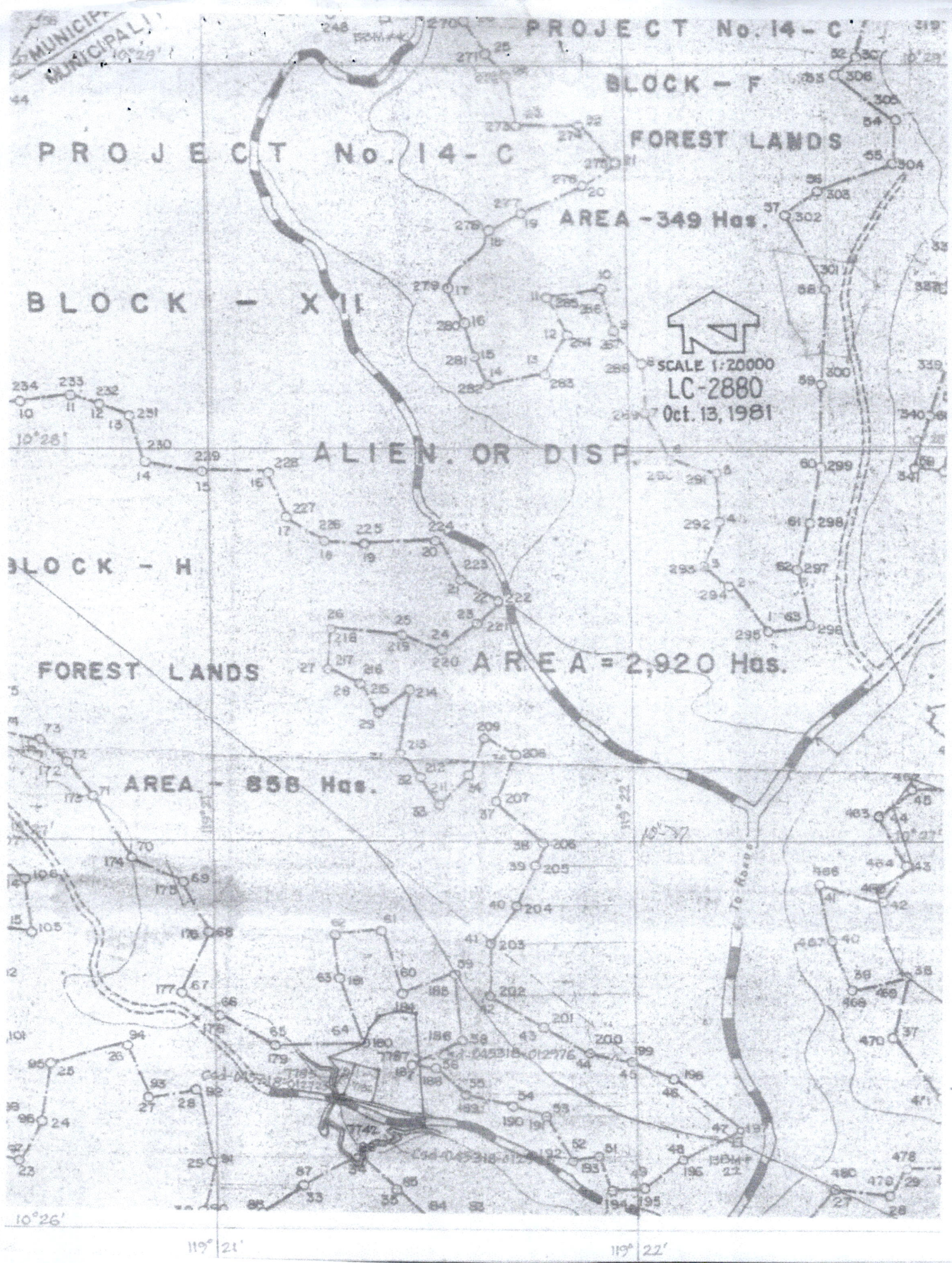



ALIENABLE AND DISPOSABLE LAND
PROJECT NO. 14-C
BLOCK XII
LC 2880

LOT 22, VERGINITA SALDUA, ROXAS

LOT 24, ALMERA RODRIGUEZ, ROXAS

LOT 18, AMELITA DELA TORRE, ROXAS

Roxas

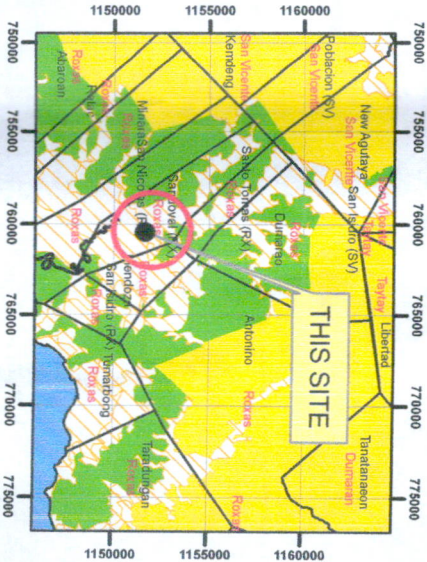

LOCATION MAP

SCALE 1:700,000

MAP SHOWING

THE RELATIVE LOCATION OF LOT 22
FOR LC CERTIFICATION APPLIED BY
VERGINITA SALDUA

Located at Brgy. Sto. Thomas
Municipality of Roxas
Province of Palawan
Coordinate System: Luzon 1911 UTM Zone 50N
Projection: Transverse Mercator
Datum: Luzon 1911

SCALE 1:1000

- LEGEND**
- LOT 22
 - CADT_CADC
 - Alienable & Disposable 18,077.90 Has.
 - Forestland 8,180.96 Has.
 - UPF 62,390.16 Has.
 - No Data 9.84 Has.
 - PA_MIMAROPA_UTMZN50

Prepared by:

DAVE N. BALMORES
For III

DONNA-BELLE LUENGO
Engr. II



Republic of the Philippines
Department of Environment and Natural Resources
MIMAROPA REGION
PROVINCIAL ENVIRONMENT AND NATURAL RESOURCES OFFICE
Bgy. Sta. Monica, Puerto Princesa City, Palawan
Telfax No. (048) 434-8791
Email Add: penropalawan@denr.gov.ph

(ANNEX I)

CERTIFICATION

TO WHOM IT MAY CONCERN:

THIS IS TO CERTIFY that based on available records, the tract of land in Barangay Sto. Tomas, Roxas, Palawan, containing an area of *SIX HUNDRED* (600) square meters, identified as **Lot No. 22, CSD-045318-012975** subject of application of Ms. VERGINITA R. SALDUA, Free Patent Application No. _____ was verified to be within **Alienable and Disposable Land** per LC Map No. 2880, Project No. 14-C, Block XII, certified on October 13, 1981.

Issued this 20th day of July 2022, at DENR Office, Sta. Monica, Puerto Princesa City.

Checked/Verified by:

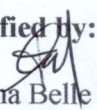
Engr. Donna Belle E. Luengo
Engineer II
Unit Head, Surveys and Mapping Unit

CONCURRED:

For the PENRO

JOHNNY P. LILANG
Chief TSD/Officer In-Charge

Note:
Reference used was based on the rectified LC map
provided and projected by the Regional Office

DENR-PALAWAN
PENRO-RECORDS
RELEASED
By 27 JUL 2022
Date: 27 JUL 2022
CN:



Republic of the Philippines
Department of Environment and Natural Resources
Region IV- MIMAROPA

COMMUNITY ENVIRONMENT AND NATURAL RESOURCES OFFICE

Barangay III (Poblacion), Roxas, Palawan
Contact No. 09171606578 / 09175028647
Email address: cenroroxaspalawan@denr.gov.ph

CERTIFICATION

TO WHOM IT MAY CONCERN:

THIS IS TO CERTIFY that based on available records in our office, the tract of land in Barangay Sto. Tomas, Municipality of Roxas, Province of Palawan, containing an area of **six hundred (600)** square meters, identified as **Lot No. 22, Csd.-045318-012975**, as applied for by **Verginita R. Saldua** was verified to be within Agricultural lands (alienable or disposable) per L.C. Map No. 2880, F.A.O. No. _____, Project No. 14-C certified on October 13, 1981.

Issued this 28th day of March 2022 at CENRO, Roxas, Palawan.

Checked by:

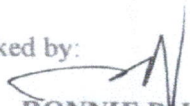
RONNIE P. LILANG
LMO III/ Chief, RPS

Approved:

PABLO CRUZ
CENR Officer



Republic of the Philippines
Department of Environment and Natural Resources
Region IV
COMMUNITY ENVIRONMENT AND NATURAL RESOURCES OFFICE
Roxas, Palawan

No. _____ Applicant VERGINITA R. SALDUA
Lot No. 22, CSD-045318-012975 Ident. To Lot No. 9273 OAD. 862-D
Portion of Lot No. 7742 OAD. 862-D Surveyed for: REP. OF THE PHILIPPINES
Date of Original Survey: JAN-JUNE 1987 Surveyed by: _____
Area (sq. m.) 600 Date of Survey: MAY 5-31, 1993
Location: STO. TOMAS, ROXAS, PAL. Date Approved: AUGUST 5, 1994

TECHNICAL DESCRIPTION

TIE LINE: N 05-41 E 13,254.00 m ft BLM 1, OAD 862-D, ROXAS CADASTRE

LINE	BEARINGS	DISTANCE	LINE	BEARINGS	DISTANCE
1-2	S 71-35 E	20.00 m.			
2-3	S 18-25 W	20.00 m.			
3-4	N 71-35 W	20.00 m.			
4-1	N 18-25 E	20.00 m.			

SKETCH

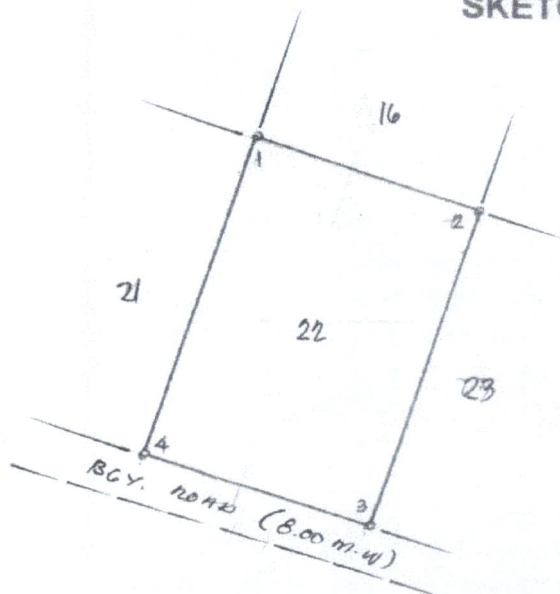

PROJ. NO. 14-C, BLK-XII
LC 2880 DATED OCT. 13, 1981

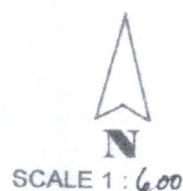

AREA - 858 Nos.

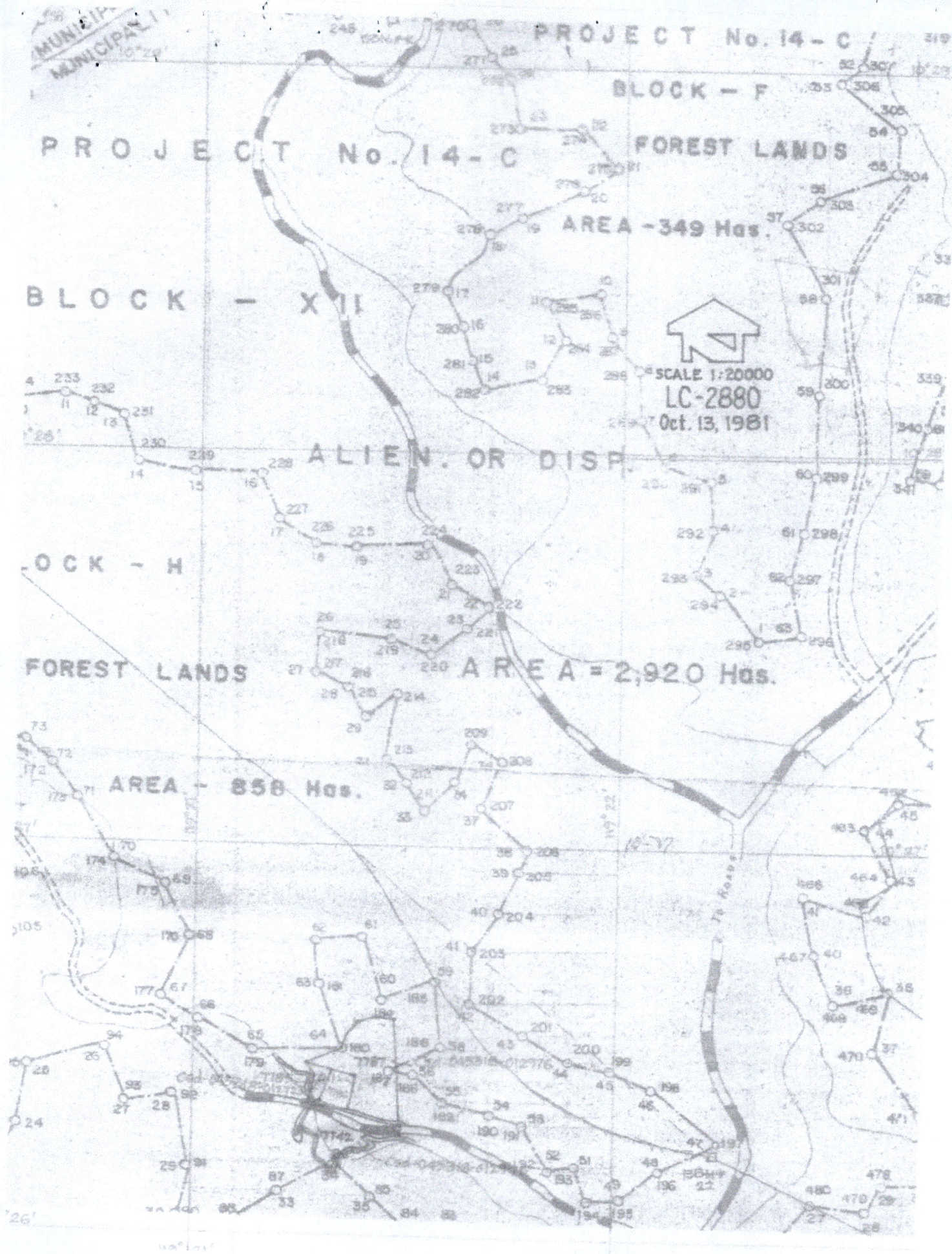

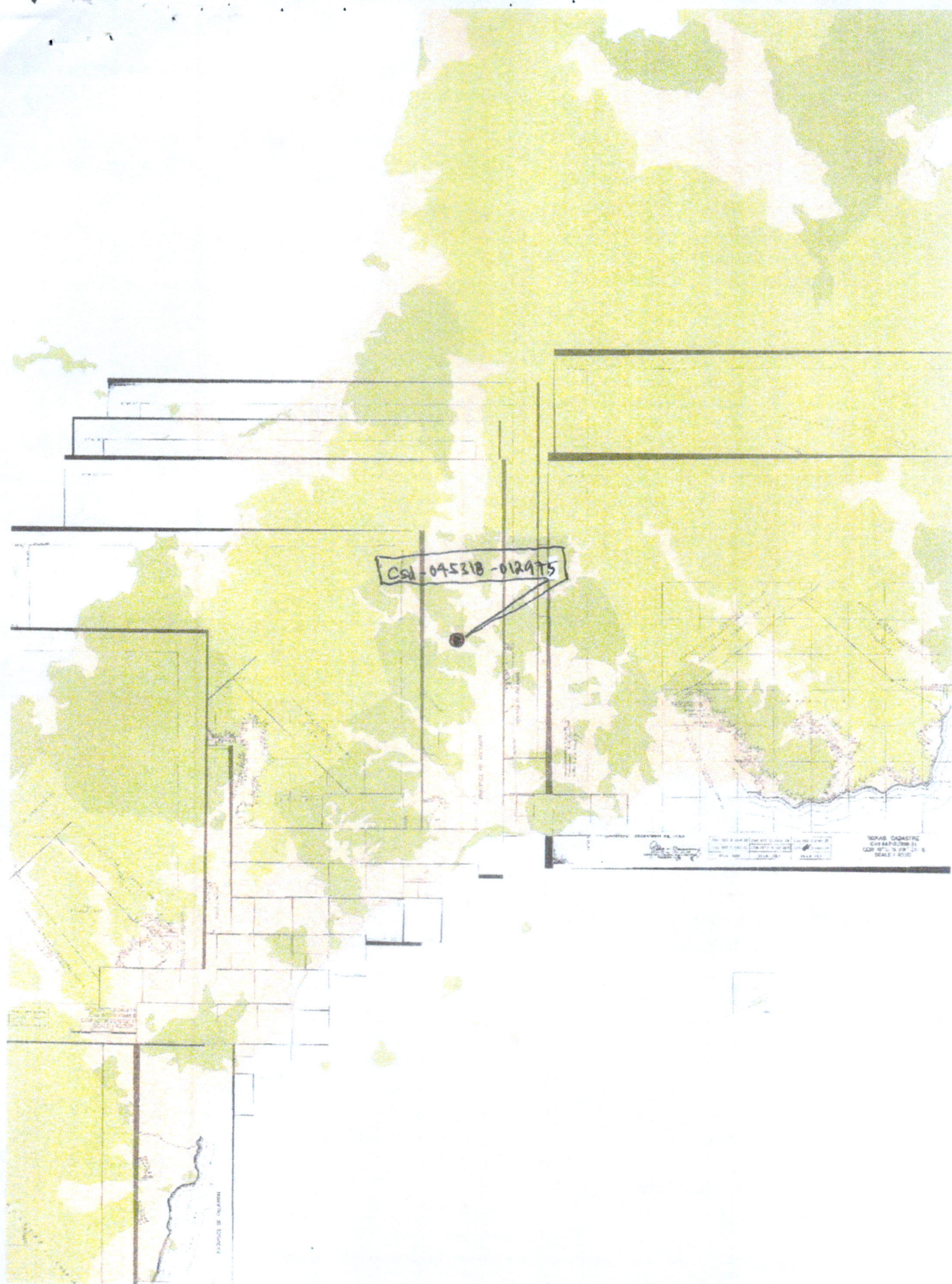

PROJECT NO. 14-C
BLOCK XII
LC 2880

Roxas

LOT 76, RODEL MACAYA, ROXAS

NGP AREA

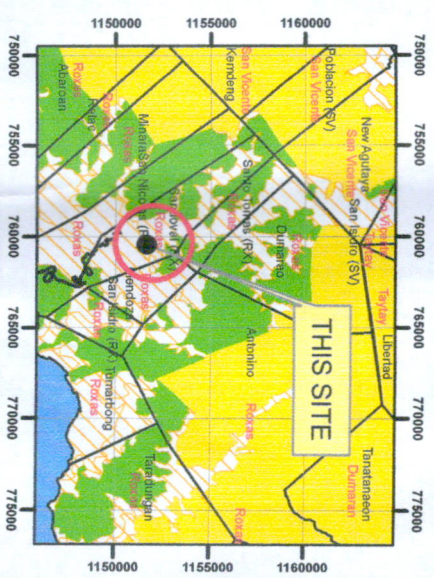

LOCATION MAP **SCALE 1:700,000**

MAP SHOWING

THE RELATIVE LOCATION OF LOT 76
FOR LC CERTIFICATION APPLIED BY
RODEL MACAYA

Located at Brgy. Sto. Thomas
Municipality of Roxas
Province of Palawan

Coordinate System: Luzon 1911 UTM Zone 50N

Projection: Transverse Mercator

Datum: Luzon 1911

SCALE 1:1000

LEGEND

— LOT 7

 CADT_CADC

Alienable & Disposable 18,077.90 Has.

Forestland 8,180.96 Has.

UPF 62,390.16 Has.

Category	Value
No Data	9.84 Has.

PA_MIMAROPA_UTMZN50

Prepared by:

DAVE N. BALMORES

For III

DONNA BELLE LUENGO

Engr. II



Republic of the Philippines
Department of Environment and Natural Resources
MIMAROPA REGION
PROVINCIAL ENVIRONMENT AND NATURAL RESOURCES OFFICE
Bgy. Sta. Monica, Puerto Princesa City, Palawan
Telfax No. (048) 434-8791
Email Add: penropalawan@denr.gov.ph

(ANNEX I)

CERTIFICATION

TO WHOM IT MAY CONCERN:

THIS IS TO CERTIFY that based on available records, the tract of land in Barangay Sto. Tomas, Roxas, Palawan, containing an area of *SIX HUNDRED* (600) square meters, identified as **Lot No. 76, CSD-045318-012976** subject of application of Ms. RODEL A. MACAYA, Free Patent Application No. _____ was verified to be within **Alienable and Disposable Land** per LC Map No. 2880, Project No. 14-C, Block XII, certified on October 13, 1981.

Issued this 20th day of July 2022, at DENR Office, Sta. Monica, Puerto Princesa City.

Checked/Verified by:

Engr. Donna Belle E. Luengo
Engineer II
Unit Head, Surveys and Mapping Unit

CONCURRED:

For the PENRO

JOHNNY P. LILANG
Chief TSD/Officer In-Charge

Note:
Reference used was based on the rectified LC map
provided and projected by the Regional Office

DENR-PALAWAN
PENRO-RECORDS
RELEASED
By AS
Date 27 JUL 2022 CN AS



Republic of the Philippines
Department of Environment and Natural Resources

Region IV- MIMAROPA
COMMUNITY ENVIRONMENT AND NATURAL RESOURCES OFFICE

Barangay III (Poblacion), Roxas, Palawan
Contact No. 09171606578 / 09175028647
Email address: cenroroxaspalawan@denr.gov.ph

CERTIFICATION

TO WHOM IT MAY CONCERN:

THIS IS TO CERTIFY that based on available records in our office, the tract of land in Barangay Sto. Tomas, Municipality of Roxas, Province of Palawan, containing an area of **six hundred (600)** square meters, identified as **Lot No. 76, Csd.-045318-012976**, as applied for by **Rodel A. Macaya** was verified to be within Agricultural lands (alienable or disposable) per L.C. Map No. 2880, F.A.O. No. _____, Project No. 14-C certified on October 13, 1981.

Issued this 28th day of March 2022 at CENRO, Roxas, Palawan.

Checked by:

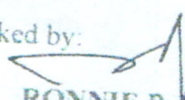
RONNIE P. LILANG
LMO III/ Chief, RPS

Approved:

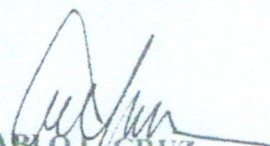
PABLO L. CRUZ
CENR Officer



Republic of the Philippines
Department of Environment and Natural Resources
Region IV
COMMUNITY ENVIRONMENT AND NATURAL RESOURCES OFFICE
Roxas, Palawan

No. _____ Applicant RODEL A. MACAYA
Lot No. 76, Csd-045318-012976 Ident. To Lot No. 9169 CAD. 862-D
Portion of Lot No. 7781 CAD. 862-D Surveyed for: REP. OF THE PHILIPPINES
Date of Original Survey: Jan-June 1987 Surveyed by: _____
Area (sq. m.) 600 Date of Survey: MAY 5-31, 1993
Location: STO. TOMAS, ROXAS, PAL. Date Approved: AUGUST 5, 1994

TECHNICAL DESCRIPTION

TIE LINE: N 05-57 E 13,626.4 m ft BLM 1, CAD. 862-D, ROXAS CADASTRO

LINE	BEARINGS	DISTANCE	LINE	BEARINGS	DISTANCE
1-2	N 72-34 W	20.00 m.			
2-3	N 19-47 E	30.00 m.			
3-4	S 72-34 E	20.00 m.			
4-1	S 19-47 N	30.00 m.			

SKETCH

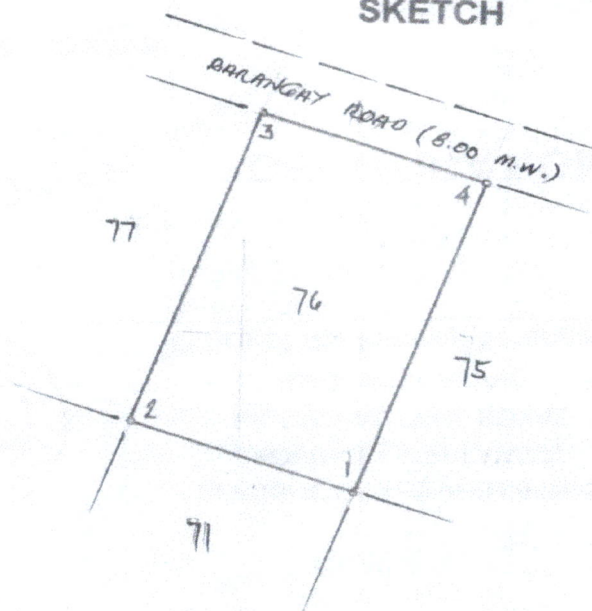

PROJ. NO. 14-C, BLK-XII
LL 2880
DATED: OCT 13, 1981

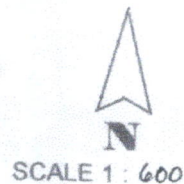

MUNICIPAL
MUNICIPAL

PROJECT No. 14-C

BLOCK - F

PROJECT No. 14-C

FOREST LANDS

AREA - 349 Hqs.

BLOCK - XII

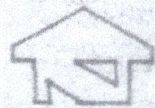

SCALE 1:20000

LC-2880

Oct. 13, 1981

ALIEN. OR DISP.

BLOCK - H

FOREST LANDS

AREA = 2,920 Hqs.

AREA - 858 Hqs.

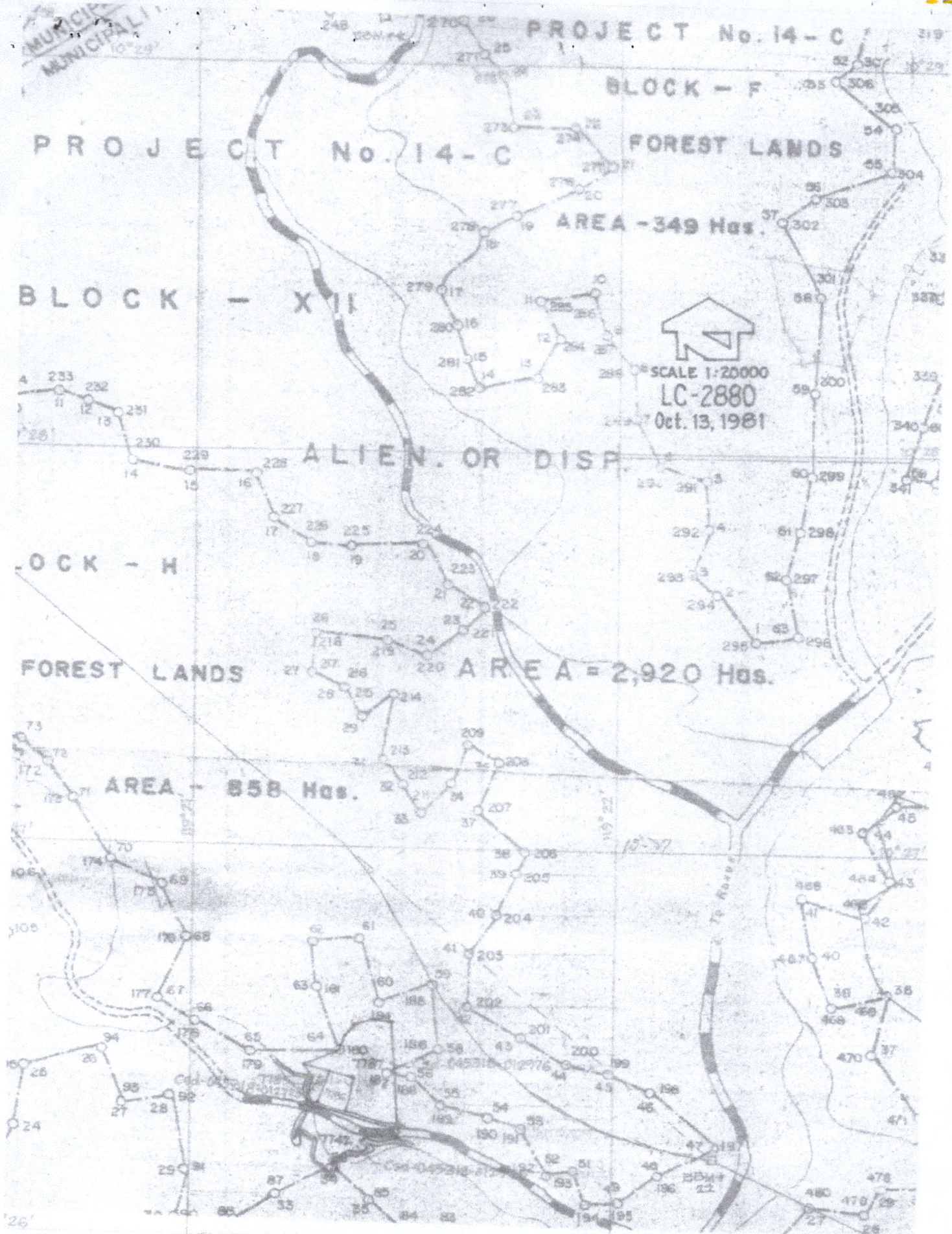

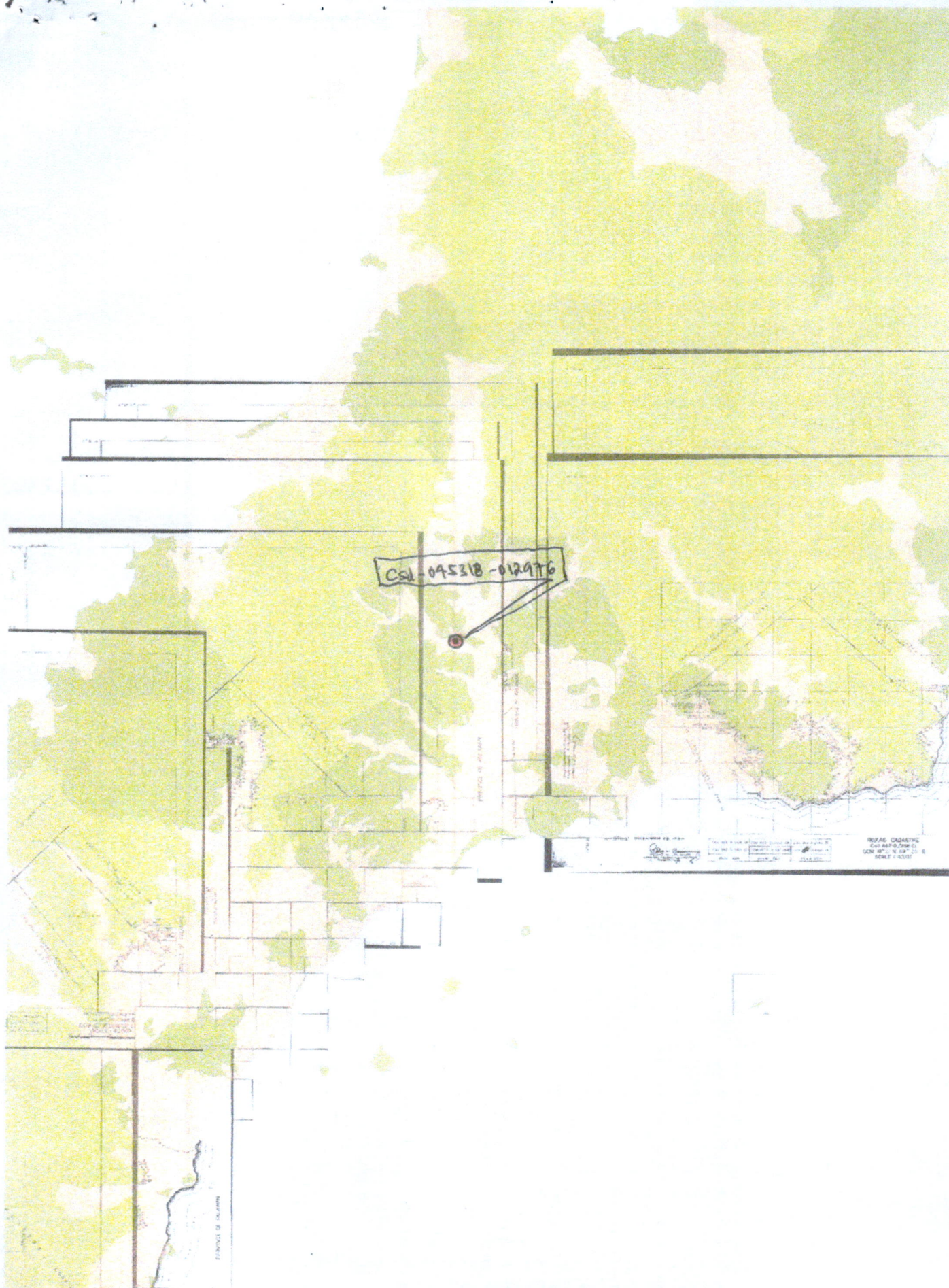

ALIENABLE AND DISPOSABLE LAND
PROJECT NO. 14-C
BLOCK XII
LC 2880

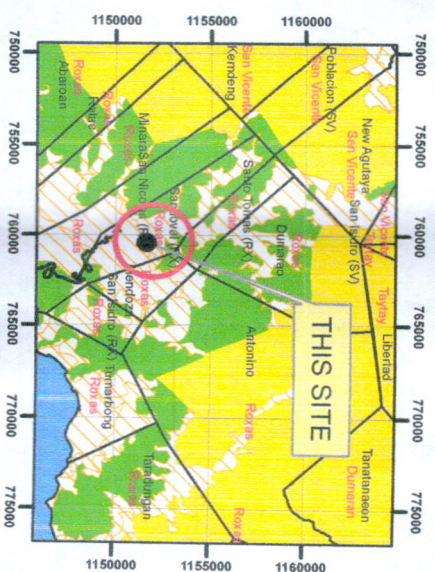
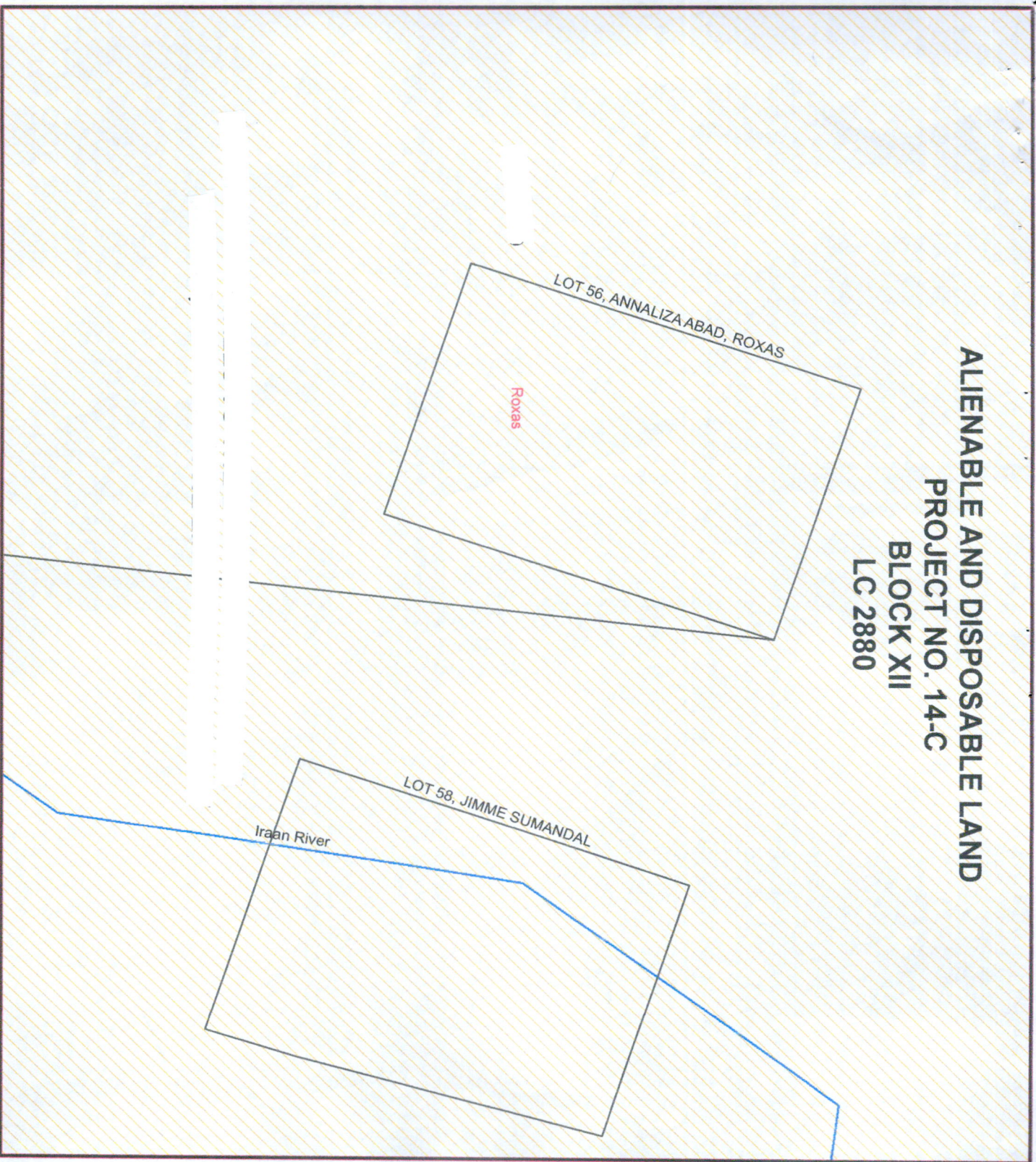

MAP SHOWING

THE RELATIVE LOCATION OF LOT 56
FOR LC CERTIFICATION APPLIED BY
ANNALIZA ABAD

Located at Brgy. Sto. Thomas
Municipality of Roxas
Province of Palawan
Coordinate System: Luzon 1911 UTM Zone 50N
Projection: Transverse Mercator
Datum: Luzon 1911

SCALE 1:1000

- LEGEND**
- LOT 56
 - CADT_CADC
 - Alienable & Disposable 18,077.90 Has.
 - Forestland 8,180.96 Has.
 - UPF 62,390.16 Has.
 - No Data 9.84 Has.
 - PA_MIMAROPA_UTMZN50

Prepared by:

DAVE N. BALMORES
Engr. III

DONNA BELLE LUENGO
Engr. II



Republic of the Philippines
Department of Environment and Natural Resources
MIMAROPA REGION
PROVINCIAL ENVIRONMENT AND NATURAL RESOURCES OFFICE
Bgy. Sta. Monica, Puerto Princesa City, Palawan
Telfax No. (048) 434-8791
Email Add: penropalawan@denr.gov.ph

(ANNEX I)

CERTIFICATION

TO WHOM IT MAY CONCERN:

THIS IS TO CERTIFY that based on available records, the tract of land in Barangay Sto. Tomas, Roxas, Palawan, containing an area of *SIX HUNDRED* (600) square meters, identified as **Lot No. 56, CSD-045318-012975** subject of application of Ms. ANNALIZA V. ABAD, Free Patent Application No. _____ was verified to be within **Alienable and Disposable Land** per LC Map No. 2880, Project No. 14-C, Block XII, certified on October 13, 1981.

Issued this 20th day of July 2022, at DENR Office, Sta. Monica, Puerto Princesa City.

Checked/Verified by:

Engr. Donna Belle E. Luengo
Engineer II
Unit Head, Surveys and Mapping Unit

CONCURRED:

For the PENRO

JOHNNY P. LILANG
Chief TSD/Officer In-Charge

Note:
Reference used was based on the rectified LC map
provided and projected by the Regional Office

DENR-PALAWAN
PENRO-RECORDS
RELEASED
By _____
Date 27 JUL 2022 CN _____



Republic of the Philippines
Department of Environment and Natural Resources
Region IV- MIMAROPA

COMMUNITY ENVIRONMENT AND NATURAL RESOURCES OFFICE

Barangay III (Poblacion), Roxas, Palawan
Contact No. 09171606578 / 09175028647
Email address: cenroroxaspalawan@denr.gov.ph

CERTIFICATION

TO WHOM IT MAY CONCERN:

THIS IS TO CERTIFY that based on available records in our office, the tract of land in Barangay Sto. Tomas, Municipality of Roxas, Province of Palawan, containing an area of **six hundred (600)** square meters, identified as **Lot No. 56, Csd.-045318-012975**, as applied for by **Annaliza V. Abad** was verified to be within Agricultural lands (alienable or disposable) per L.C. Map No. 2880, F.A.O. No. _____, Project No. 14-C certified on October 13, 1981.

Issued this 28th day of March 2022 at CENRO, Roxas, Palawan.

Checked by:

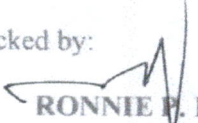
RONNIE P. LILANG
LMO III/ Chief, RPS

Approved:

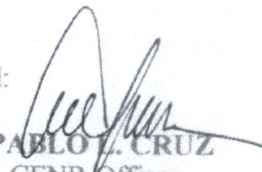
PABLO L. CRUZ
CENR Officer



Republic of the Philippines
Department of Environment and Natural Resources
Region IV
COMMUNITY ENVIRONMENT AND NATURAL RESOURCES OFFICE
Roxas, Palawan

No. _____ Applicant ANNALIZA V. ASAD
Lot No. 56, C&A-045318-012975 Ident. To Lot No. 9307 CAD. 860-D
Portion of Lot No. 7742 CAD. 862-D Surveyed for: REP. OF THE PHILIPPINES
Date of Original Survey: JAN-JUNE 1987 Surveyed by: _____
Area (sq. m.) 600 Date of Survey: MAY 5-31, 1993
Location: STO TOMAS, ROXAS, PAL. Date Approved: AUGUST 5, 1994

TECHNICAL DESCRIPTION

TIE LINE: N 06-13 E 13,292.87 M fr BLM 1, CAD. 862-D, ROXAS CADASTRE

LINE	BEARINGS	DISTANCE	LINE	BEARINGS	DISTANCE
1-2	S 18-25 W	30.00 m.			
2-3	N 71-35 W	20.00 m.			
3-4	N 18-25 E	30.00 m.			
4-1	S 71-35 E	20.00 m.			

PROJ. NO. 14-C, BLK-XII
LC 2880 DATED OCT. 13, 1981

SKETCH

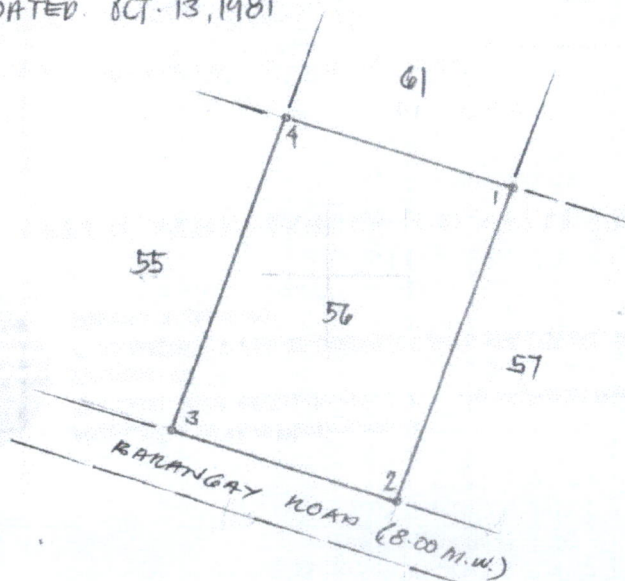

MUNICIPAL

PROJECT No. 14-C

BLOCK - F

PROJECT No. 14-C

FOREST LANDS

AREA - 349 Has.

BLOCK - XII

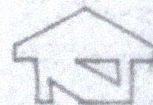

SCALE 1:20000

LC-2880

Oct. 13, 1981

ALIEN. OR DISP.

BLOCK - H

FOREST LANDS

AREA = 2,920 Has.

AREA - 858 Has.

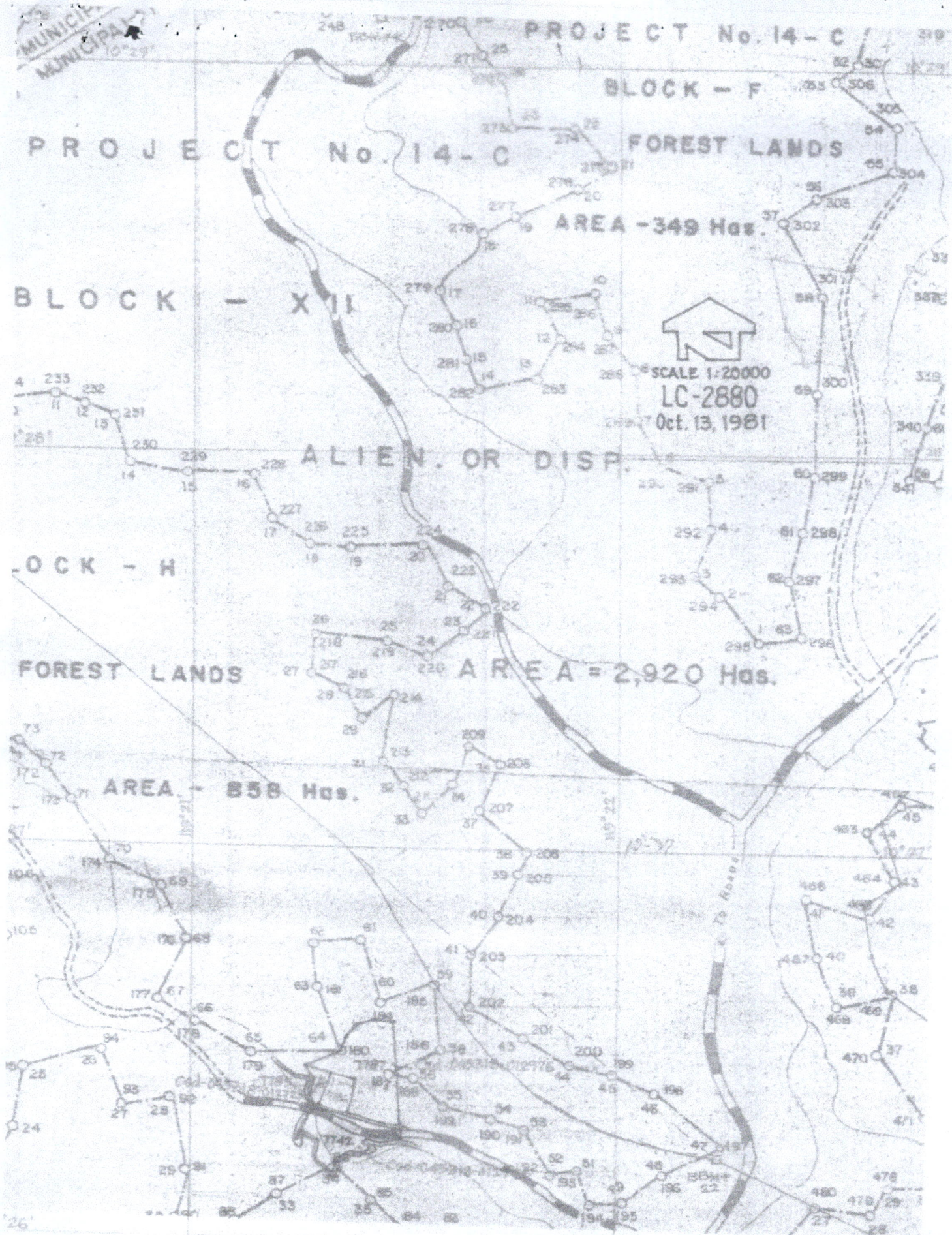

CSU-095318-012975



PROPERTY OF THE STATE

PROPERTY OF THE STATE

PROPERTY OF THE STATE

PROPERTY OF THE STATE

PROPERTY OF THE STATE

PROPERTY OF THE STATE

PROPERTY OF THE STATE

PROPERTY OF THE STATE

PROPERTY OF THE STATE

PROPERTY OF THE STATE

PROPERTY OF THE STATE

PROPERTY OF THE STATE

PROPERTY OF THE STATE

PROPERTY OF THE STATE

PROPERTY OF THE STATE

PROPERTY OF THE STATE

PROPERTY OF THE STATE

PROPERTY OF THE STATE

PROPERTY OF THE STATE

PROPERTY OF THE STATE

PROPERTY OF THE STATE

PROPERTY OF THE STATE

PROPERTY OF THE STATE

PROPERTY OF THE STATE

PROPERTY OF THE STATE

DATE	10/1/75
BY	CSU-095318-012975
FOR	PROPERTY OF THE STATE
REMARKS	PROPERTY OF THE STATE

PROPERTY OF THE STATE
SCALE 1:1000

ALIENABLE AND DISPOSABLE LAND
PROJECT NO. 14-C
BLOCK XII
LC 2880

LOT 18, ERIC JOHN GATCHALIAN, ROXAS

Santo Tomas

LOT 64, ANDREA GETUBIG, ROXAS

Roxas

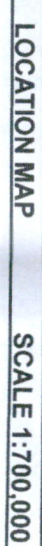







Located at Bryg. Sto. Thomas

Coordinate System: Luzon 1911 UTM Zone 50N
Projection: Transverse Mercator

Datum: Luzon 1911

SCALE 1:1000

LOT 18

- | | | |
|---|-------------------------|----------------|
|  | CADT_CADC | |
|  | Alternable & Disposable | 18,077 90 Has. |
|  | Forstand | 8,180 96 Has. |
|  | UPF | 62,390 16 Has. |
|  | No Data | 9 84 Has. |
|  | PA_MIMAROPA_UTMZN50 | |

Prepared by:

DAVE N. BALMORES
For III

DONNA BELLE LUENGO
Engr. II



Republic of the Philippines
Department of Environment and Natural Resources
MIMAROPA REGION
PROVINCIAL ENVIRONMENT AND NATURAL RESOURCES OFFICE
Bgy. Sta. Monica, Puerto Princesa City, Palawan
Telfax No. (048) 434-8791
Email Add: penropalawan@denr.gov.ph

(ANNEX I)

CERTIFICATION

TO WHOM IT MAY CONCERN:

THIS IS TO CERTIFY that based on available records, the tract of land in Barangay Sto. Tomas, Roxas, Palawan, containing an area of *FIVE HUNDRED NINETY SIX* (596) square meters, identified as **Lot No. 18, CSD-045318-012976** subject of application of Ms. ERIC JOHN GATCHALIAN, Free Patent Application No. _____ was verified to be within **Alienable and Disposable Land** per LC Map No. 2880, Project No. 14-C, Block XII, certified on October 13, 1981.

Issued this 20th day of July 2022, at DENR Office, Sta. Monica, Puerto Princesa City.

Checked/Verified by:

Engr. Donna Belle E. Luengo
Engineer II
Unit Head, Surveys and Mapping Unit

CONCURRED:

For the PENRO

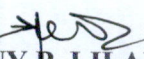
JOHNNY P. LILANG
Chief TSD/Officer In-Charge

Note:
Reference used was based on the rectified LC map
provided and projected by the Regional Office

DENR-PALAWAN
PENRO-RECORDS
RELEASED
By _____
Date: 7 JUL 2022 CN _____



Republic of the Philippines
Department of Environment and Natural Resources
Region IV- MIMAROPA

COMMUNITY ENVIRONMENT AND NATURAL RESOURCES OFFICE

Barangay III (Poblacion), Roxas, Palawan
Contact No. 09171606578 / 09175028647
Email address: cenroxaspalawan@denr.gov.ph

CERTIFICATION

TO WHOM IT MAY CONCERN:

THIS IS TO CERTIFY that based on available records in our office, the tract of land in Barangay Sto. Tomas, Municipality of Roxas, Province of Palawan, containing an area of **five hundred ninety six (596)** square meters, identified as **Lot No. 18, Csd.-045318-012976**, as applied for by **Eric John M. Gatchalian** was verified to be within Agricultural lands (alienable or disposable) per L.C. Map No. 2880, F.A.O. No. _____, Project No. 14-C certified on October 13, 1981.

Issued this 28th day of March 2022 at CENRO, Roxas, Palawan.

Checked by:

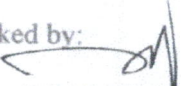
RONNIE P. LILANG
LMO III/ Chief, RPS

Approved:

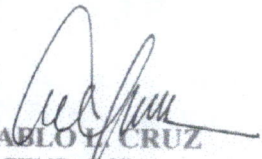
PABLO CRUZ
CENR Officer



Republic of the Philippines
Department of Environment and Natural Resources
Region IV
COMMUNITY ENVIRONMENT AND NATURAL RESOURCES OFFICE
Roxas, Palawan

No. _____ Applicant ERIC JOHN M. GATCHALIAN
Lot No. 18, Csd - 045318 - 012976 Ident. To Lot No. 9111 CAD. BG2 - D
Portion of Lot No. 7787 CAD. BG2 - D Surveyed for: REP. OF THE PHILIPPINES
Date of Original Survey: JAN-JUNE 1987 Surveyed by: _____
Area (sq. m.) 596 Date of Survey: MAY 5-31, 1993
Location: STO. TOMAS, ROXAS, PAL. Date Approved: AUGUST 5, 1994

TECHNICAL DESCRIPTION

TIE LINE: N 06-15 E 13,543.03 m fr BLM 1, CAD. BG2 - D, ROXAS CADASTRE

LINE	BEARINGS	DISTANCE	LINE	BEARINGS	DISTANCE
1-2	N 72-34 W	20.00 m.			
2-3	N 19-47 E	27.22 m.			
3-4	N 63-34 E	4.00 m.			
4-5	S 72-34 E	17.23 m.			
5-1	S 19-47 W	30.00 m.			

SKETCH



PROJ. NO. 14-C, BLK-XII
LC 2880 DATED OCT. 13, 1981



MUNICIPALITY

PROJECT No. 14-C

BLOCK - F

PROJECT No. 14-C

FOREST LANDS

AREA - 349 Hqs.

BLOCK - XII

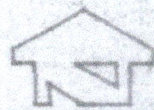

SCALE 1:20000
LC-2880
Oct. 13, 1981

ALIEN. OR DISP.

BLOCK - H

FOREST LANDS

AREA = 2,920 Hqs.

AREA - 858 Hqs.

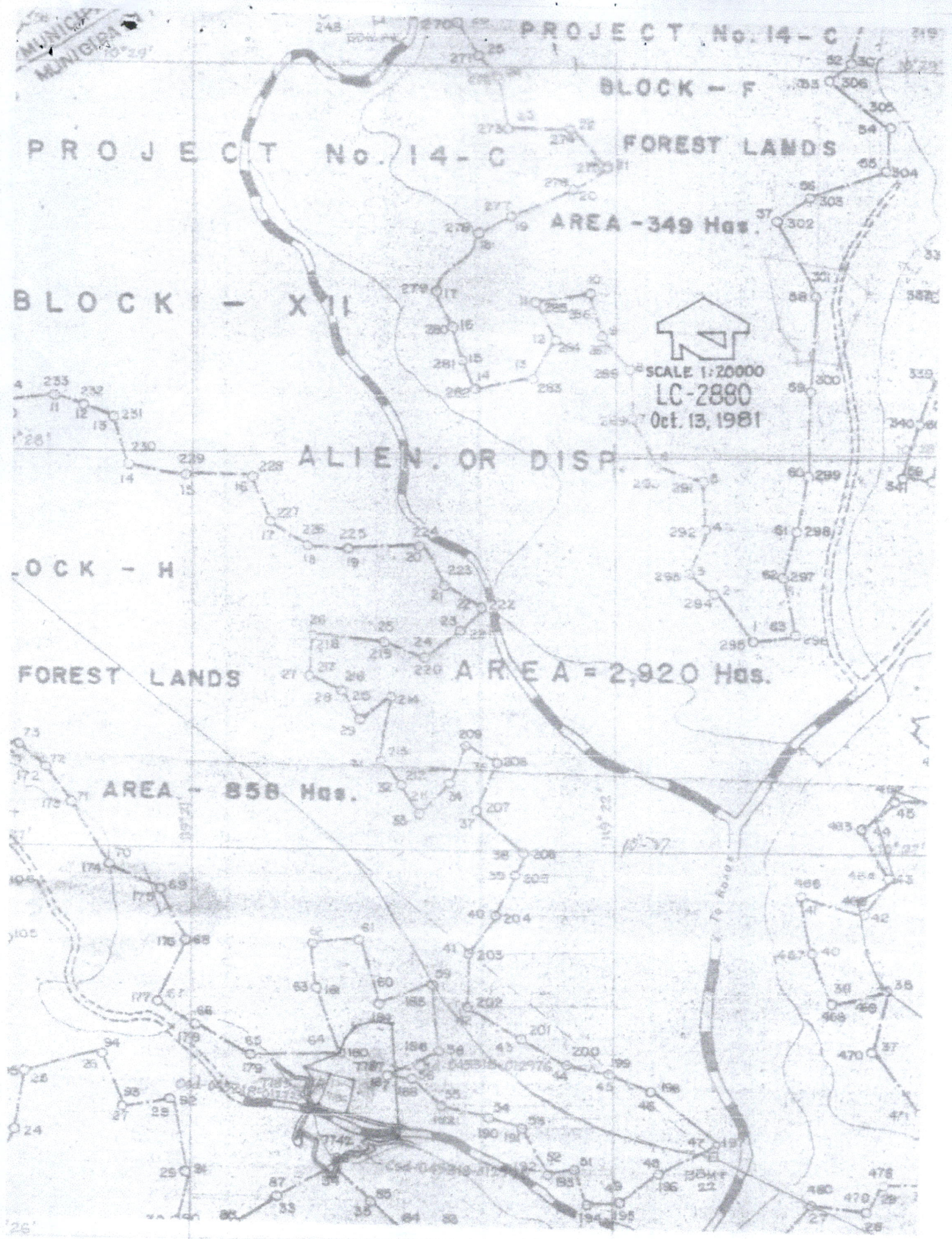

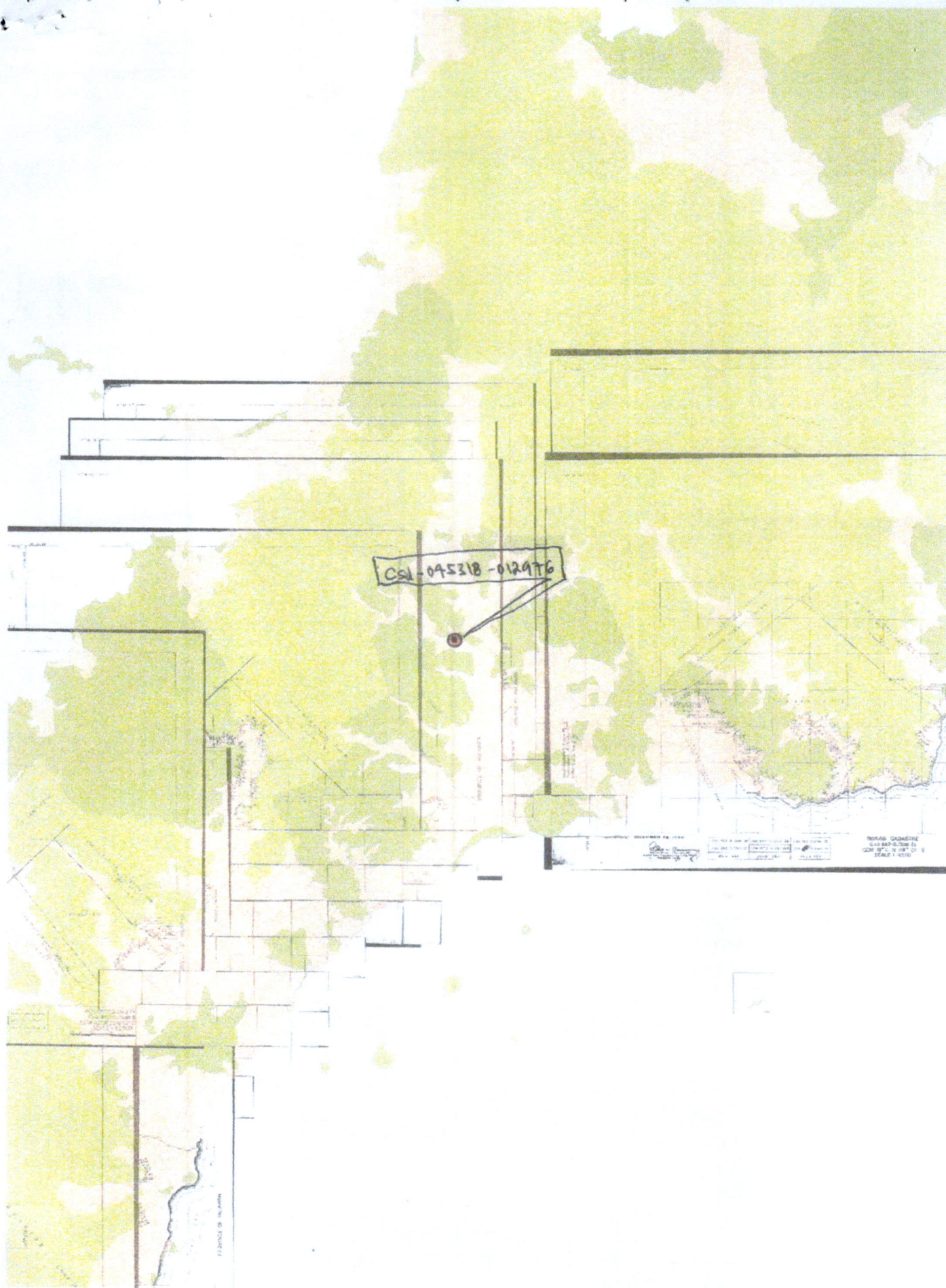

[illegible]

THE RELATIVE LOCATION OF LOT 65
FOR LC CERTIFICATION APPLIED BY
ESTRELITA LABUTOY

Municipality of Roxas
Province of Palawan

Projection: Transverse Mercator
Datum: Luzon 1911

LEGEND
— LOT 6

— LOT 65

CADT_CADC

Alienable & Disposable 18,077.90 Has.

Forestland

Forestland 8,180.96 Has.

UPF

UPF 62,390.16 Has.

No Data

[illegible]

PA MIMAROPA UTMZN50

DAVE N. BALMORES

DONNA BELLE LUENGO

Engr. II



Republic of the Philippines
Department of Environment and Natural Resources
MIMAROPA REGION
PROVINCIAL ENVIRONMENT AND NATURAL RESOURCES OFFICE
Bgy. Sta. Monica, Puerto Princesa City, Palawan
Telfax No. (048) 434-8791
Email Add: penropalawan@denr.gov.ph

(ANNEX I)

CERTIFICATION

TO WHOM IT MAY CONCERN:

THIS IS TO CERTIFY that based on available records, the tract of land in Barangay Sto. Tomas, Roxas, Palawan, containing an area of *SIX HUNDRED* (600) square meters, identified as **Lot No. 65, CSD-045318-012976** subject of application of Ms./Mr. ESTRELITA R. LABUTOY, Free Patent Application No. _____ was verified to be within **Alienable and Disposable Land** per LC Map No. 2880, Project No. 14-C, Block XII, certified on October 13, 1981.

Issued this 20th day of July 2022, at DENR Office, Sta. Monica, Puerto Princesa City.

Checked/Verified by:

Engr. Donna Belle E. Luengo
Engineer II
Unit Head, Surveys and Mapping Unit

CONCURRED:

For the PENRO

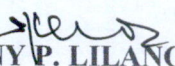
JOHNNY P. LILANG
Chief TSD/Officer In-Charge

Note:
Reference used was based on the rectified LC map
provided and projected by the Regional Office

DENR-PALAWAN
PENRO-RECORDS
RELEASED
By 27 JUL 2022
Date: 27 JUL 2022 CN



Republic of the Philippines
Department of Environment and Natural Resources
Region IV- MIMAROPA

COMMUNITY ENVIRONMENT AND NATURAL RESOURCES OFFICE

Barangay III (Poblacion), Roxas, Palawan
Contact No. 09171606578 / 09175028647
Email address: cenroxaspalawan@denr.gov.ph

CERTIFICATION

TO WHOM IT MAY CONCERN:

THIS IS TO CERTIFY that based on available records in our office, the tract of land in Barangay Sto. Tomas, Municipality of Roxas, Province of Palawan, containing an area of **six hundred (600)** square meters, identified as **Lot No. 65, Csd.-045318-012976**, as applied for by **Estrelita R. Labutoy** was verified to be within Agricultural lands (alienable or disposable) per L.C. Map No. 2880, F.A.O. No. _____, Project No. 14-C certified on October 13, 1981.

Issued this 28th day of March 2022 at CENRO, Roxas, Palawan.

Checked by:

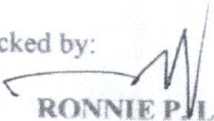
RONNIE P. LILANG
LMO III/ Chief, RPS

Approved:

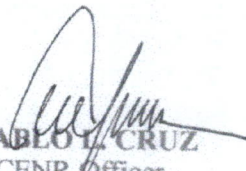
PABLO A. CRUZ
CENR Officer

MUNICIPAL
MUNICIPAL

PROJECT No. 14-C

BLOCK - F

PROJECT No. 14-C

FOREST LANDS

AREA - 349 Has.

BLOCK - XII

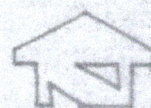

SCALE 1:20000
LC-2880
Oct. 13, 1981

ALIEN. OR DISP.

BLOCK - H

FOREST LANDS

AREA = 2,920 Has.

AREA - 858 Has.

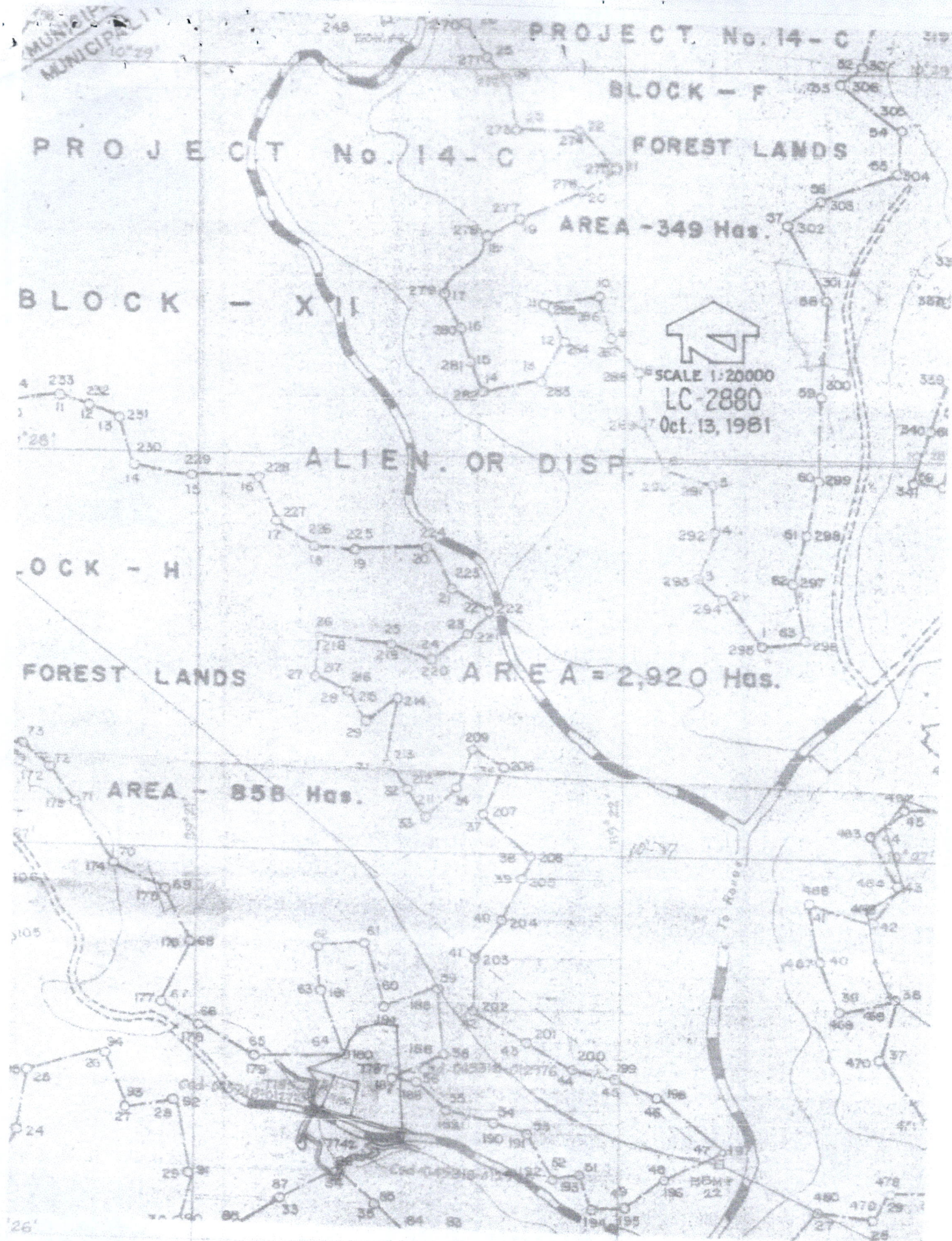



Republic of the Philippines
Department of Environment and Natural Resources
Region IV
COMMUNITY ENVIRONMENT AND NATURAL RESOURCES OFFICE
Roxas, Palawan

No. _____ Applicant ESTRELLITA R. LABUTOY
Lot No. 65, CSD-045318-02976 Ident. To Lot No. 9158 CAD. 862-D
Portion of Lot No. 7787 CAD. 862-D Surveyed for: REPUBLIC OF THE PHIL.
Date of Original Survey: JUN-JUNE 1987 Surveyed by: _____
Area (sq. m.) 600 Date of Survey: MAY 5-31, 1993
Location: STO. TOMAS, ROXAS, PAL. Date Approved: AUGUST 5, 1994

TECHNICAL DESCRIPTION

TIE LINE: N 05-53 E 13560.38 m. ft BLUM #1, CAD. 862-D, ROXAS CADASTRE

LINE	BEARINGS	DISTANCE	LINE	BEARINGS	DISTANCE
1-2	N 19-47 E	30.00 m.			
2-3	S 72-34 E	20.00 m.			
3-4	S 19-47 W	30.00 m.			
4-1	N 72-34 W	20.00 m.			

SKETCH

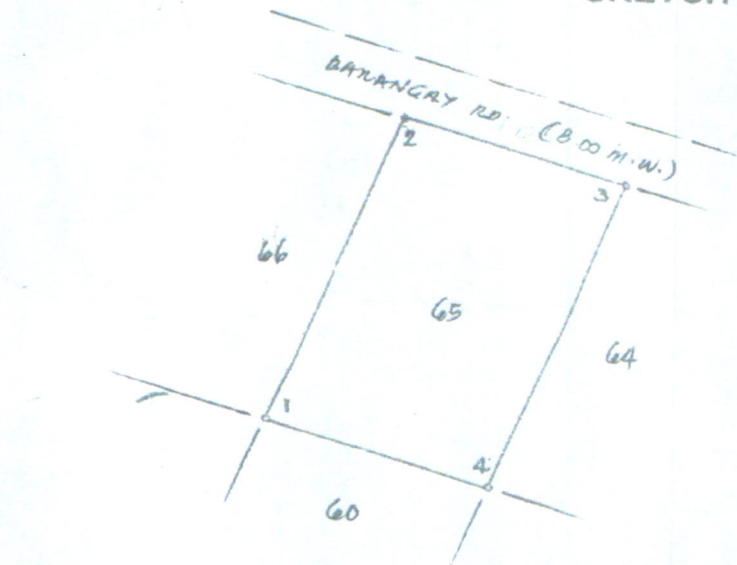

PROJ. NO. 14-C, BLK-XII
LC 2880, DATED OCT. 13, 1981



10° 26' N 119° 21' E

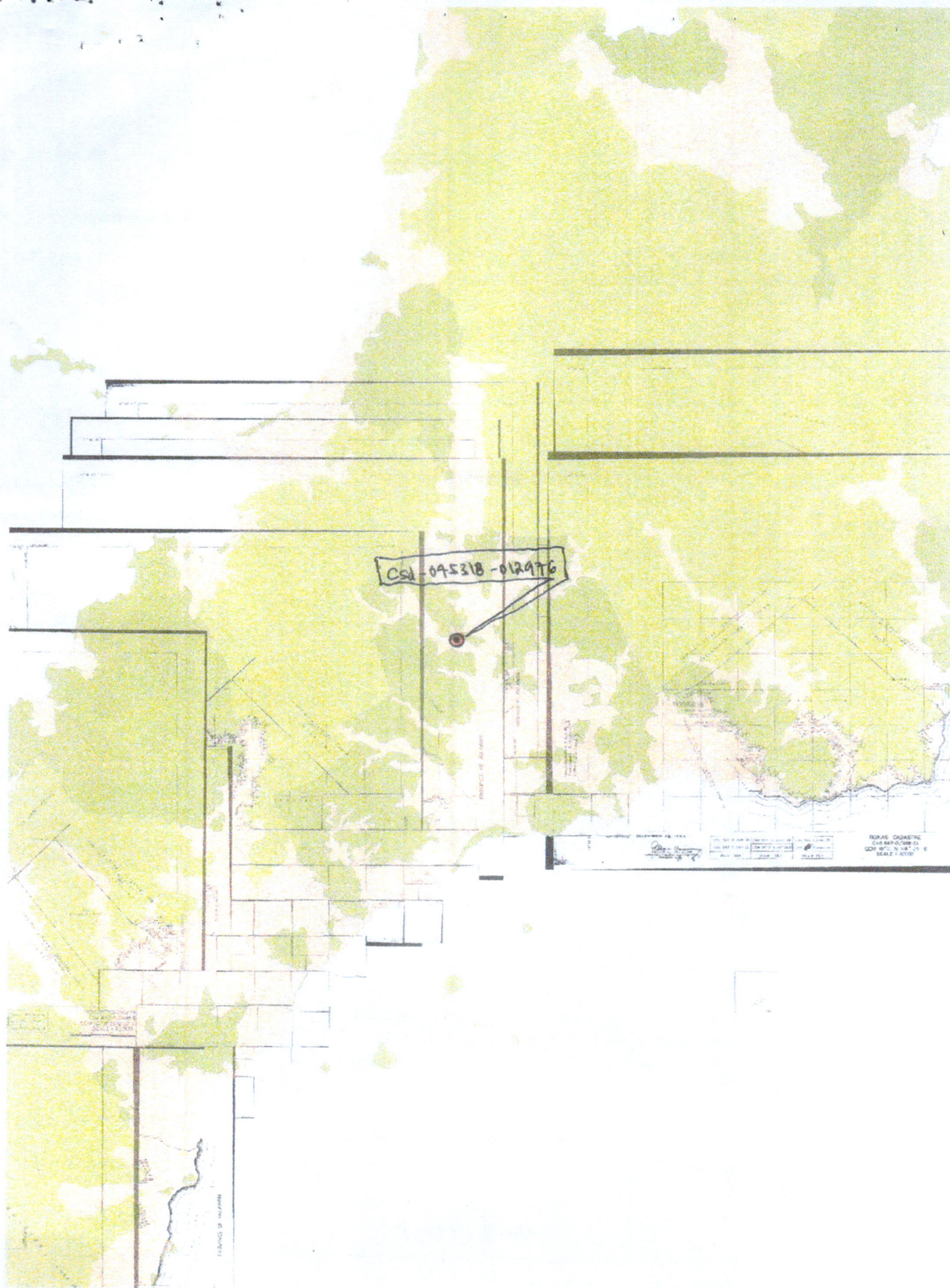

ALIENABLE AND DISPOSABLE LAND
PROJECT NO. 14-C
BLOCK XII
LC 2880

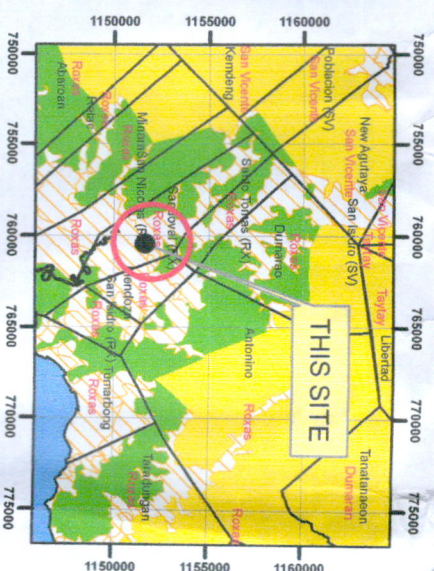

SCALE 1:700,000

THE RELATIVE LOCATION OF LOT 61
FOR LC CERTIFICATION APPLIED BY
MANILYN FELIZARTE

Located at Brgy. Sto. Thomas
Municipality of Roxas
Province of Palawan
Coordinate System: Luzon 1911 UTM Zone 50N
Projection: Transverse Mercator
Datum: Luzon 1911

SCALE 1:1000

	PA_MIMAROPA_UTMIZN50
CADT_CADC	
Alternable & Disposable	18,077.90 Has.
Forestland	8,180.96 Has.
UPF	62,390.16 Has.
No Data	9.84 Has.

Prepared by:

DAVEN, BALMORES
For III

DONNA BELLE LUENGO
Engr. II



Republic of the Philippines
Department of Environment and Natural Resources
MIMAROPA REGION
PROVINCIAL ENVIRONMENT AND NATURAL RESOURCES OFFICE
Bgy. Sta. Monica, Puerto Princesa City, Palawan
Telfax No. (048) 434-8791
Email Add: penropalawan@denr.gov.ph

(ANNEX I)

CERTIFICATION

TO WHOM IT MAY CONCERN:

THIS IS TO CERTIFY that based on available records, the tract of land in Barangay Sto. Tomas, Roxas, Palawan, containing an area of *FIVE HUNDRED NINETY NINE* (599) square meters, identified as **Lot No. 61, CSD-045318-012976** subject of application of Ms./Mr. MANILYN G. FELIZARTE, Free Patent Application No. _____ was verified to be within **Alienable and Disposable Land** per LC Map No. 2880, Project No. 14-C, Block XII, certified on October 13, 1981.

Issued this 20th day of July 2022, at DENR Office, Sta. Monica, Puerto Princesa City.

Checked/Verified by:

Engr. Donna Belle E. Luengo
Engineer II
Unit Head, Surveys and Mapping Unit

CONCURRED:

For the PENRO

JOHNNY P. LILANG
Chief TSD/Officer In-Charge

Note:
Reference used was based on the rectified LC map
provided and projected by the Regional Office

DENR-PALAWAN
PENRO-RECORDS
RELEASED
By 
Date 27 JUL 2022 CN



Republic of the Philippines
Department of Environment and Natural Resources
Region IV- MIMAROPA

COMMUNITY ENVIRONMENT AND NATURAL RESOURCES OFFICE

Barangay III (Poblacion), Roxas, Palawan
Contact No. 09171606578 / 09175028647
Email address: cenroroxaspalawan@denr.gov.ph

CERTIFICATION

TO WHOM IT MAY CONCERN:

THIS IS TO CERTIFY that based on available records in our office, the tract of land in Barangay Sto. Tomas, Municipality of Roxas, Province of Palawan, containing an area of **five hundred ninety nine (599)** square meters, identified as **Lot No. 61, Csd.-045318-012976**, as applied for by **Manilyn G. Felizarte** was verified to be within Agricultural lands (alienable or disposable) per L.C. Map No. 2880, F.A.O. No. _____, Project No. 14-C certified on October 13, 1981.

Issued this 28th day of March 2022 at CENRO, Roxas, Palawan.

Checked by:

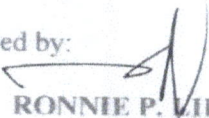
RONNIE P. VILANG
LMO III/ Chief, RPS

Approved:

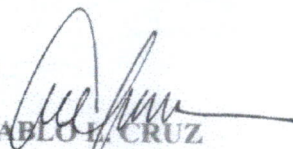
PABLO I. CRUZ
CENR Officer

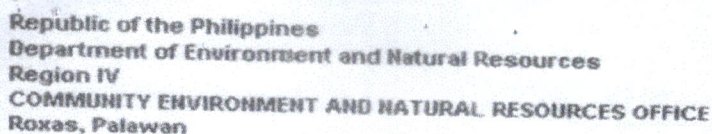

616

_____ No. _____ Applicant : MANILYN G. FELIZARTE
Lot No. 61, CAD-045318 - 012976 ✓ Ident. To Lot No. 9154, CAD-862 - D ✓
Portion of Lot No. 7787, CAD-862 - D ✓ Surveyed for: REPUBLIC OF THE PHIL. ✓
Date of Original Survey : JAN - JUNE 1987 ✓ Surveyed by : ENGR. JESUS C. PETULLA ✓
Area (sq. m.) 599 ✓ Date of Survey: MAY 9 - 31, 1993 ✓
Location : BGY. SDO. TIGAS, ROXAS, PAL. ✓ Date Approved: APR. 5, 1994 ✓

TIE LINE: N. 05-53 E. 13,520.33 m. from BLUM #1, CRD. 362-D, ROXAS CAPATINE

[illegible]

PILOT. NO. 14-C, BLK-XII
LC 2880 DATED OCT. 13, 1981

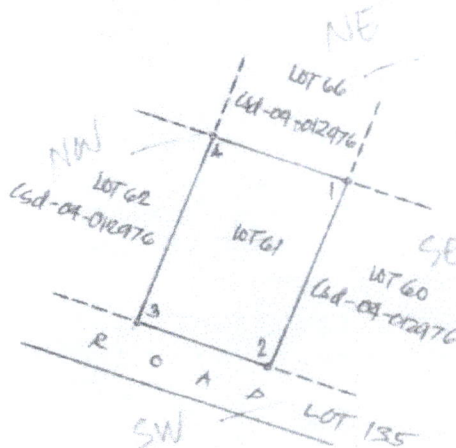
A
N

SCALE 1:1000

Bearings: GRN

CM $10^{\circ}26'N$ $119^{\circ}21'E$

MUNICIPALITY

PROJECT No. 14-C

BLOCK - F

PROJECT No. 14-C

FOREST LANDS

AREA - 349 Hqs.

BLOCK - XII

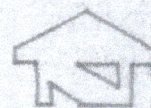

SCALE 1:20000

LC-2880

Oct. 13, 1981

ALIEN. OR DISP.

BLOCK - H

FOREST LANDS

AREA A = 2,920 Hqs.

AREA - 858 Hqs.

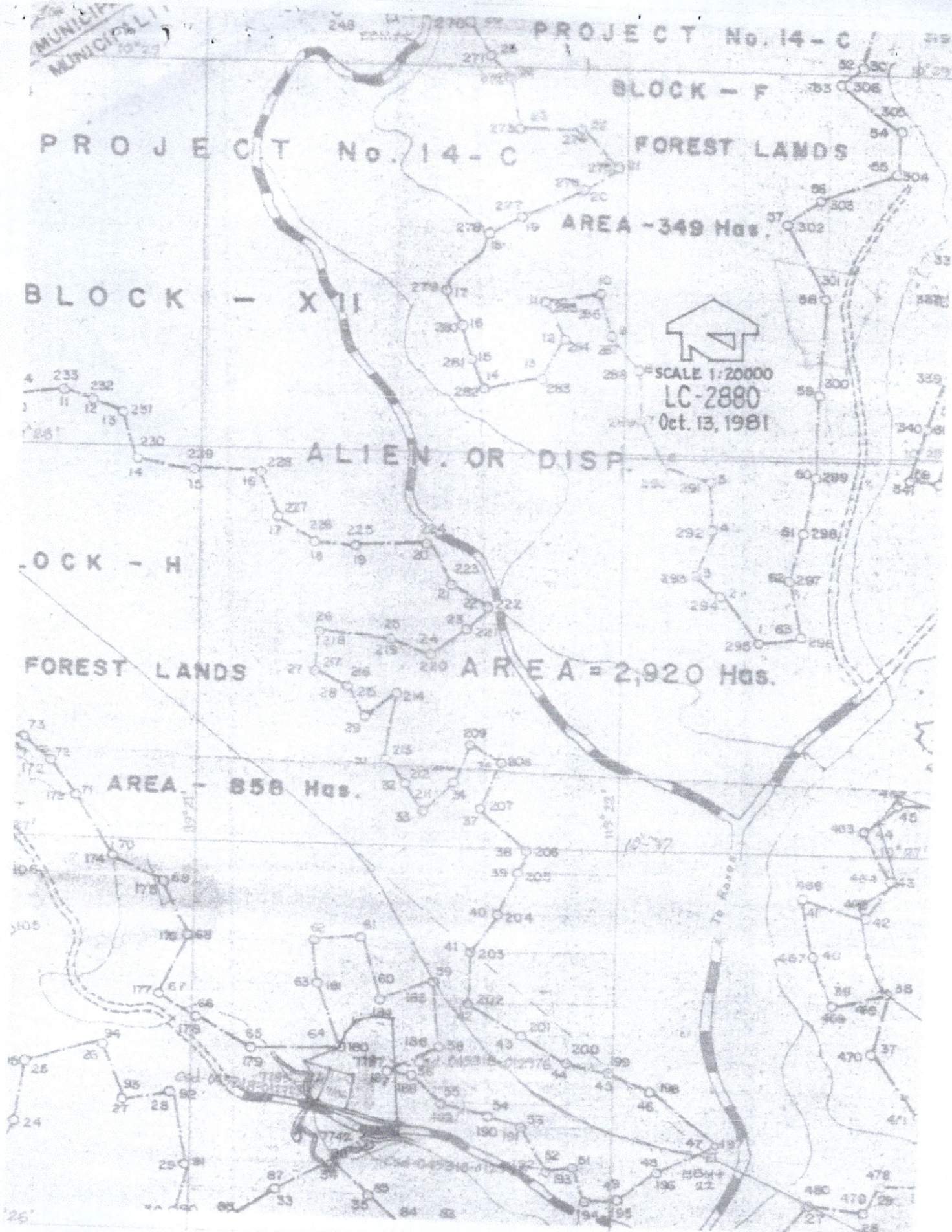

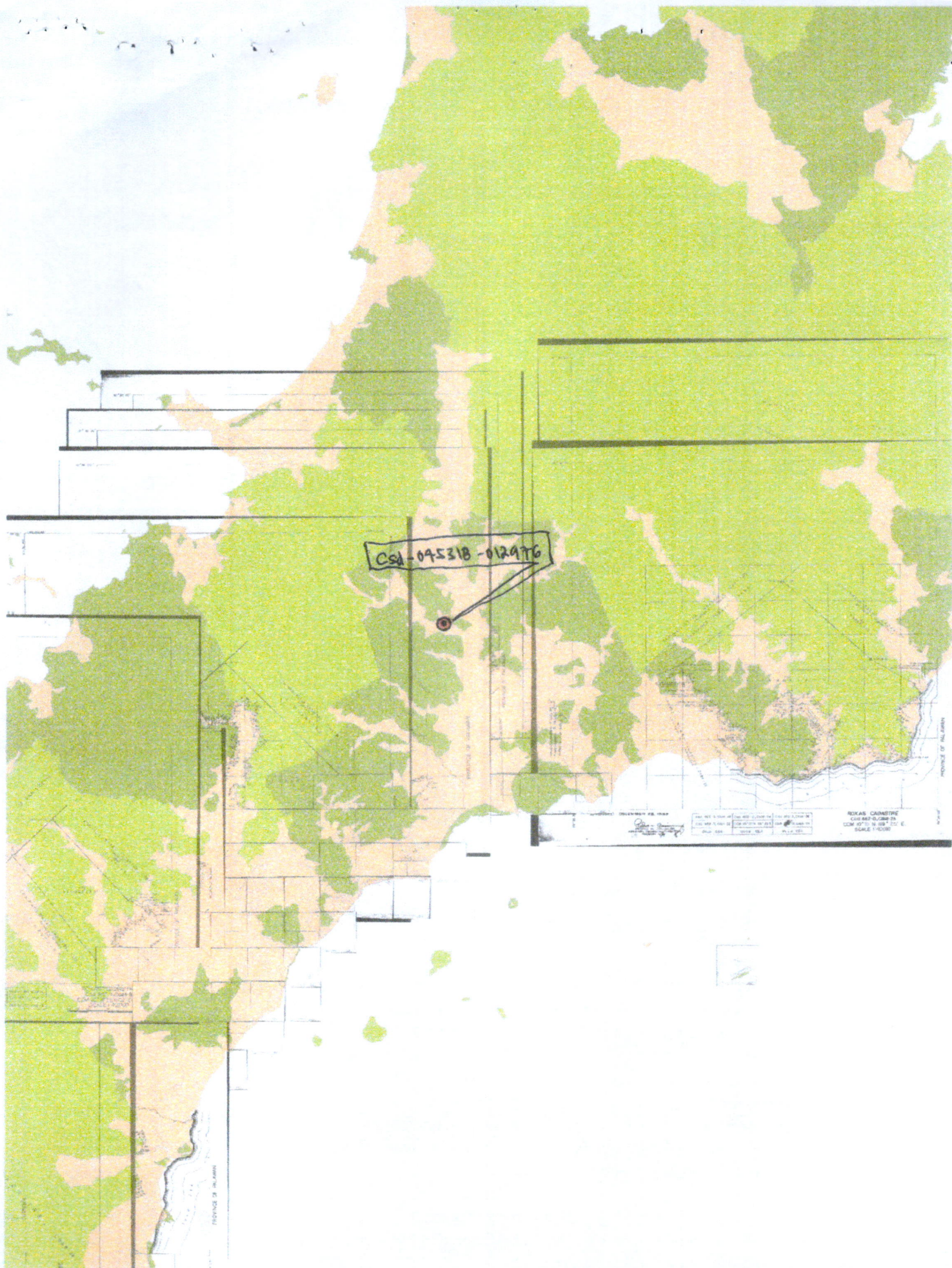

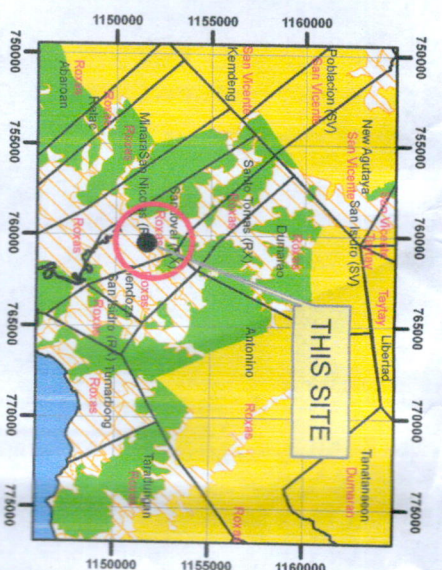
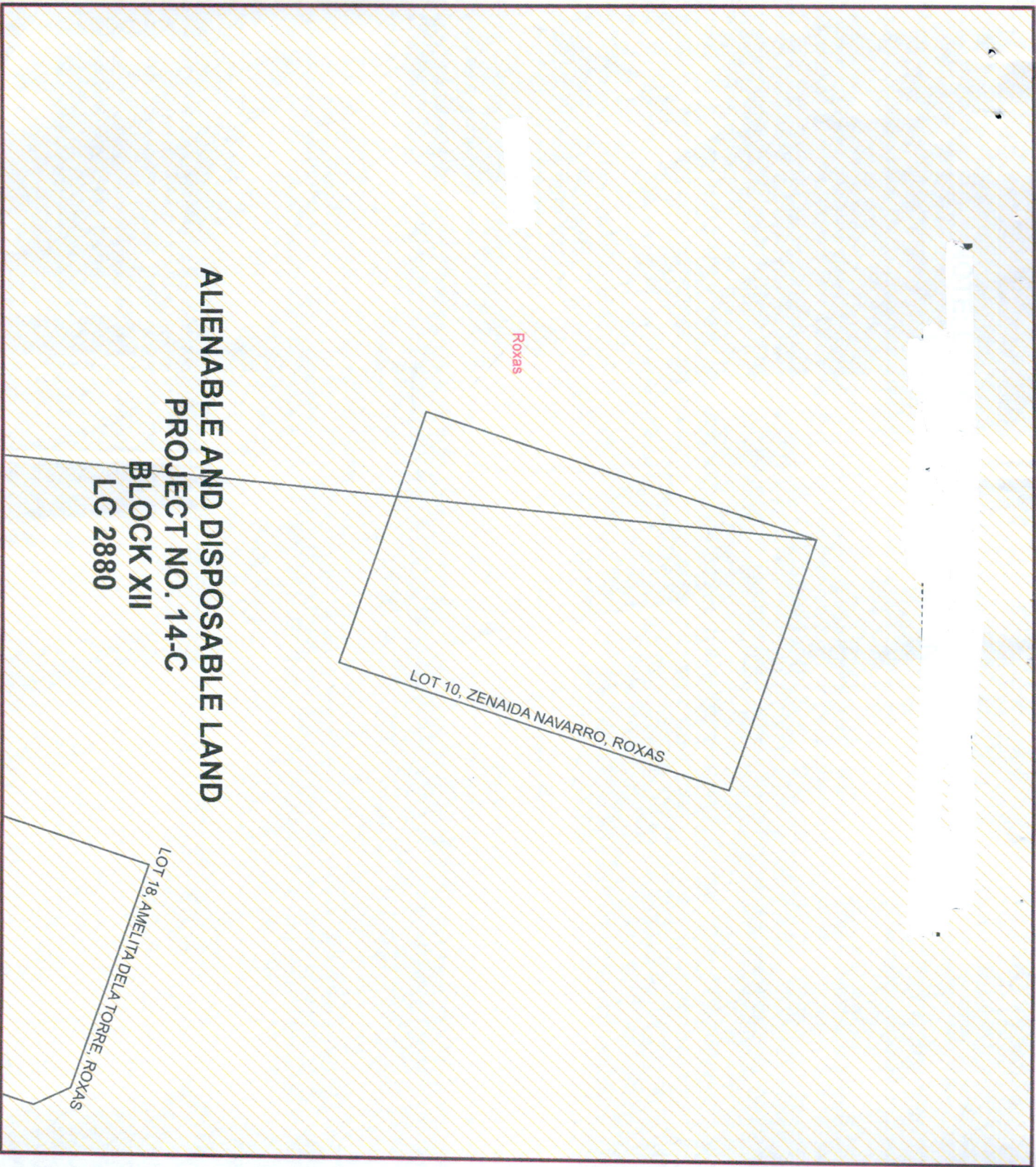

MAP SHOWING

THE RELATIVE LOCATION OF LOT 10
FOR LC CERTIFICATION APPLIED BY
ZENaida NAVARRO

Located at Brgy. Sto. Thomas
Municipality of Roxas
Province of Palawan
Coordinate System: Luzon 1911 UTM Zone 50
Projection: Transverse Mercator
Datum: Luzon 1911

SCALE 1:1000

- LEGEND**
- LOT 10
 - CADT_CADC
 - Alienable & Disposable 18,077.50 Hias.
 - Forestland 8,180.56 Hias.
 - UPF 62,350.16 Hias.
 - No Data 9.84 Hias.
 - PA_MIMAROPA_UTMZN50

Prepared by:

DAVE N. BALMORES
For III



Republic of the Philippines
Department of Environment and Natural Resources
MIMAROPA REGION
PROVINCIAL ENVIRONMENT AND NATURAL RESOURCES OFFICE
Bgy. Sta. Monica, Puerto Princesa City, Palawan
Telfax No. (048) 434-8791
Email Add: penropalawan@denr.gov.ph

(ANNEX I)

CERTIFICATION

TO WHOM IT MAY CONCERN:

THIS IS TO CERTIFY that based on available records, the tract of land in Barangay Sto. Tomas, Roxas, Palawan, containing an area of *SIX HUNDRED* (600) square meters, identified as **Lot No. 10, CSD-045318-012975** subject of application of Ms./Mr. ZENAIDA P. NAVARRO, Free Patent Application No. _____ was verified to be within **Alienable and Disposable Land** per LC Map No. 2880, Project No. 14-C, Block XII, certified on October 13, 1981.

Issued this 20th day of July 2022, at DENR Office, Sta. Monica, Puerto Princesa City.

Checked/Verified by:

Engr. Donna Belle E. Luengo
Engineer II
Unit Head, Surveys and Mapping Unit

CONCURRED:

For the PENRO

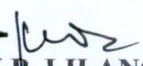
JOHNNY P. LILANG
Chief TSD/Officer In-Charge

Note:
Reference used was based on the rectified LC map
provided and projected by the Regional Office

DENR-PALAWAN
PENRO-RECORDS
RELEASED
By 2-7 JUL 2022
Date: _____ CN. _____



Republic of the Philippines
Department of Environment and Natural Resources
Region IV- MIMAROPA

COMMUNITY ENVIRONMENT AND NATURAL RESOURCES OFFICE

Barangay III (Poblacion), Roxas, Palawan
Contact No. 09171606578 / 09175028647
Email address: cenroxaspalawan@denr.gov.ph

CERTIFICATION

TO WHOM IT MAY CONCERN:

THIS IS TO CERTIFY that based on available records in our office, the tract of land in Barangay Sto. Tomas, Municipality of Roxas, Province of Palawan, containing an area of **six hundred (600) square meters**, identified as **Lot No. 10, Csd.-045318-012975**, as applied for by **Zenaida P. Navarro** was verified to be within Agricultural lands (alienable or disposable) per L.C. Map No. 2880, F.A.O. No. _____, Project No. 14-C certified on October 13, 1981.

Issued this 28th day of March 2022 at CENRO, Roxas, Palawan.

Checked by:

RONNIE P. LILANG
LMO III/ Chief, RPS

Approved:

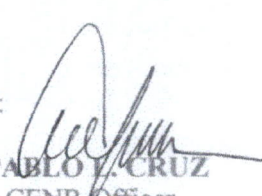
PABLO V. CRUZ
CENR Officer



Republic of the Philippines
Department of Environment and Natural Resources
Region IV
COMMUNITY ENVIRONMENT AND NATURAL RESOURCES OFFICE
Roxas, Palawan

No. _____ Applicant: ZENaida P. NAVARRO
Lot No. 10, Csd-045318-012975 Ident. To Lot No. 9261 CAD. 862-D
Portion of Lot No. 7742 CAD. 860-D Surveyed for: REPUBLIC OF THE PHILIPPINES
Date of Original Survey: JAN - JUNE 1987 Surveyed by: _____
Area (sq. m.) 600 Date of Survey: MAY 5 - 31, 1993
Location: STO. TOMAS (IRAN) ROXAS, PAL Date Approved: AUGUST 5, 1994

TECHNICAL DESCRIPTION

TIE LINE: N 05° 45' E 13,320.34 m. from BLM 1, CAD. 862-D, ROXAS CADACTRE

LINE	BEARINGS	DISTANCE	LINE	BEARINGS	DISTANCE
1-2	S 71° 35' E	20.00 m.			
2-3	S 18° 25' W	30.00 m			
3-4	N 71° 35' W	20.00 m			
4-1	N 18° 25' E	30.00 m			
NOTE: ALL corners are marked on the ground w/ 2" cyl. conc. mens 15x40 cm.					
All lots are within Csd-045318-012975					

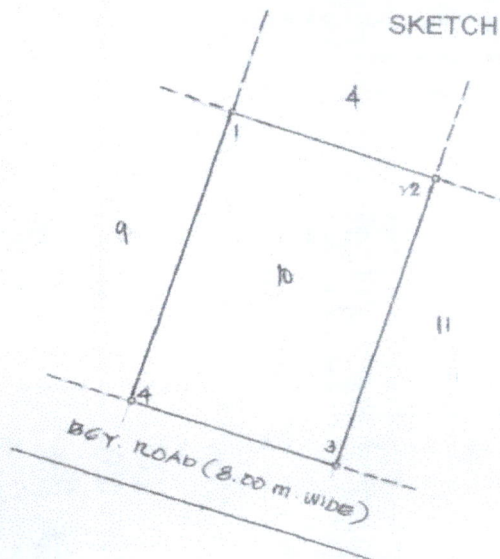

PROJ. NO. 14-C, BLK-XII
LC 2880 DATED OCT. 13, 1981



PROJECT No. 14-C

BLOCK - F

PROJECT No. 14-C

FOREST LANDS

AREA - 349 Hqs.

BLOCK - XII

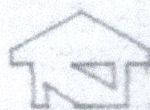

SCALE 1:20000

LC-2880

Oct. 13, 1981

ALIEN. OR DISP.

BLOCK - H

FOREST LANDS

AREA = 2,920 Hqs.

AREA - 858 Hqs.

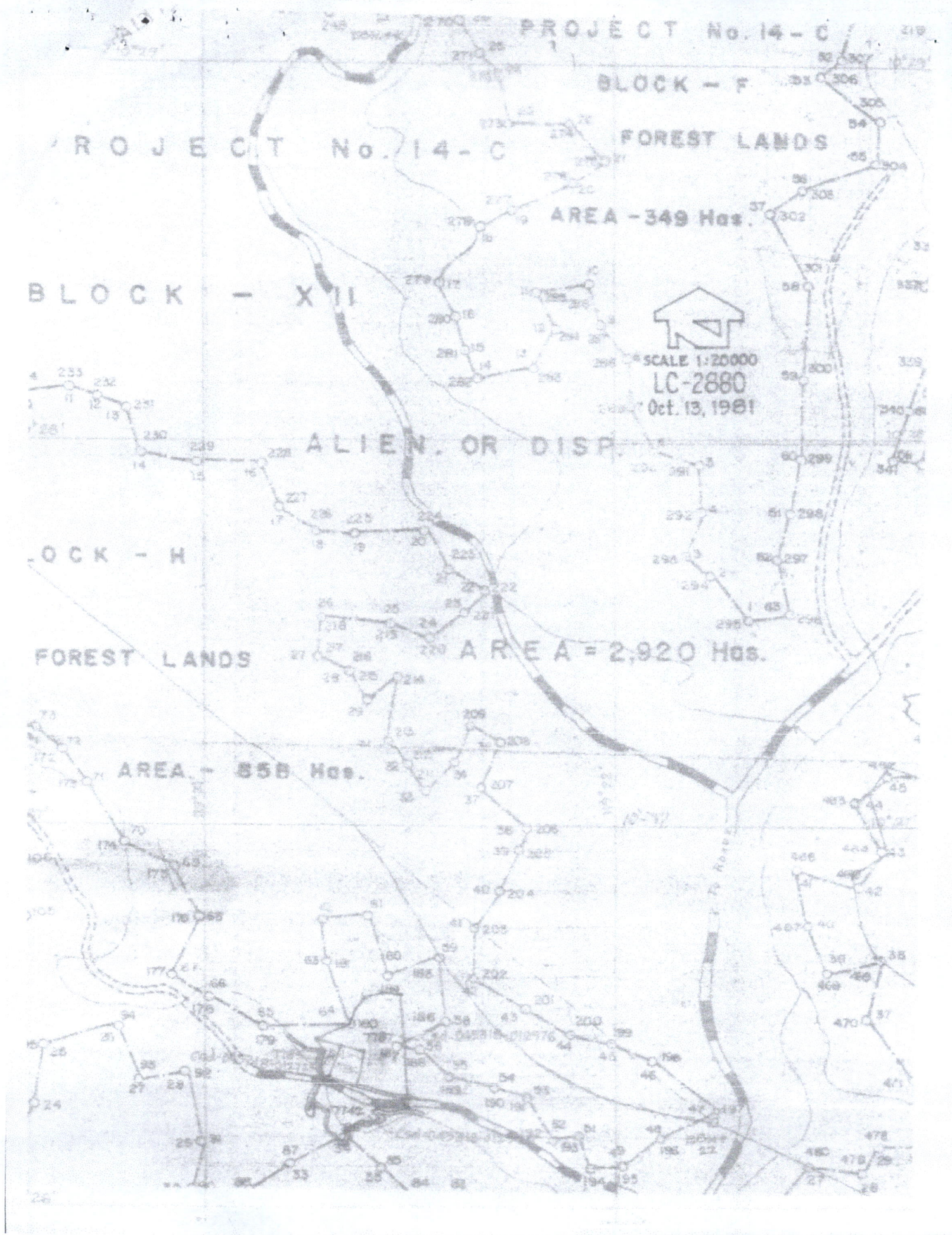

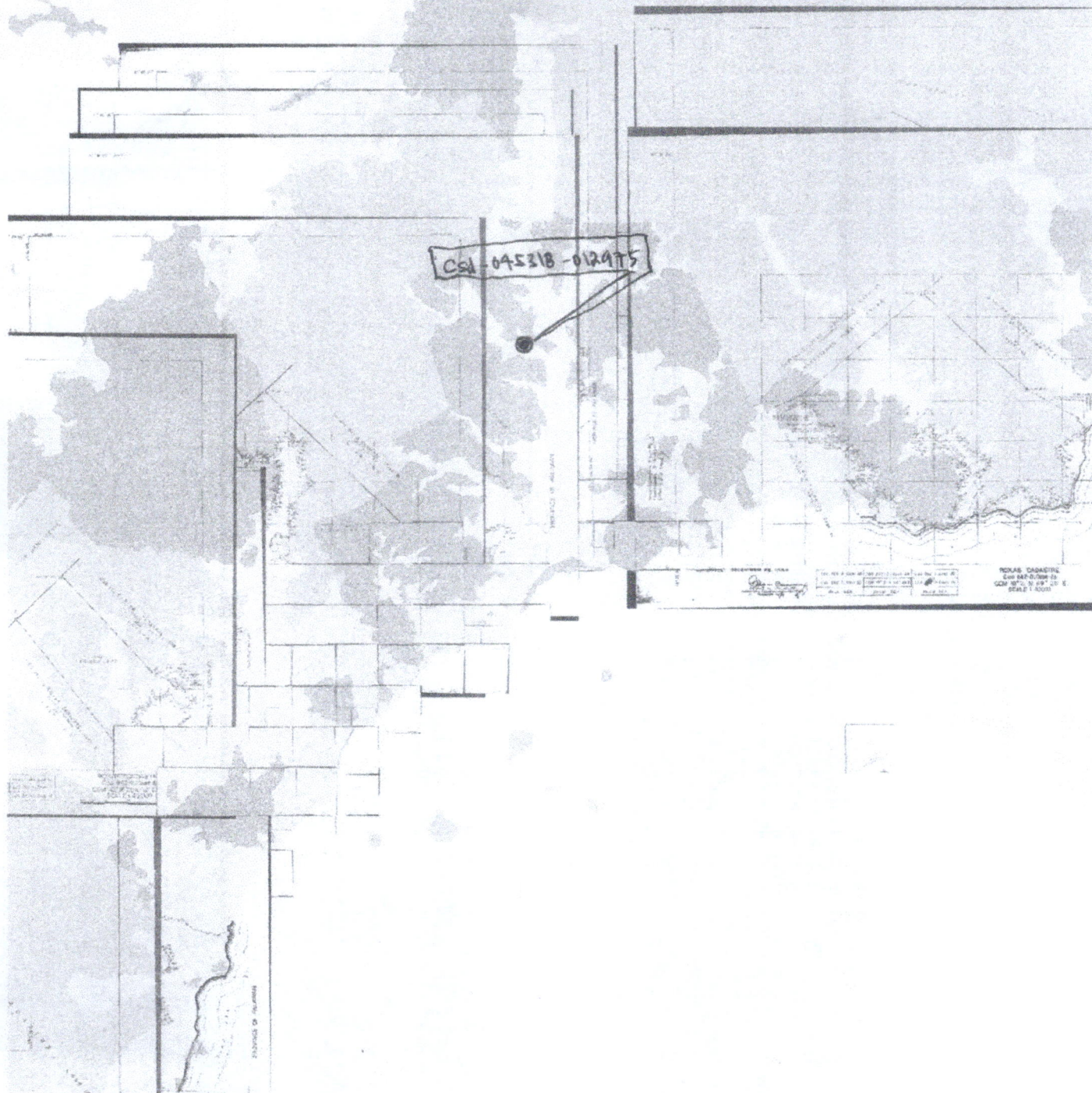



Republic of the Philippines
Department of Environment and Natural Resources
MIMAROPA REGION
PROVINCIAL ENVIRONMENT AND NATURAL RESOURCES OFFICE
Bgy. Sta. Monica, Puerto Princesa City, Palawan
Telfax No. (048) 434-8791
Email Add: penropalawan@denr.gov.ph

(ANNEX I)

CERTIFICATION

TO WHOM IT MAY CONCERN:

THIS IS TO CERTIFY that based on available records, the tract of land in Barangay Sto. Tomas, Roxas, Palawan, containing an area of *SIX HUNDRED THIRTY EIGHT* (638) square meters, identified as **Lot No. 62, CSD-045318-012975** subject of application of Ms./Mr. ELENITA VUELISA, Free Patent Application No. _____ was verified to be within **Alienable and Disposable Land** per LC Map No. 2880, Project No. 14-C, Block XII, certified on October 13, 1981.

Issued this 20th day of July 2022, at DENR Office, Sta. Monica, Puerto Princesa City.

Checked/Verified by:

Engr. Donna Belle E. Luengo
Engineer II
Unit Head, Surveys and Mapping Unit

CONCURRED:

For the PENRO

JOHNNY P. LILANG
Chief TSD/Officer In-Charge

Note:
Reference used was based on the rectified LC map
provided and projected by the Regional Office

DENR-PALAWAN
PENRO-RECORDS
RELEASED
By 27 JUL 2022
Date: CN



Republic of the Philippines
Department of Environment and Natural Resources
Region IV- MIMAROPA

COMMUNITY ENVIRONMENT AND NATURAL RESOURCES OFFICE

Barangay III (Poblacion), Roxas, Palawan
Contact No. 09171606578 / 09175028647
Email address: cenroroxaspalawan@denr.gov.ph

CERTIFICATION

TO WHOM IT MAY CONCERN:

THIS IS TO CERTIFY that based on available records in our office, the tract of land in Barangay Sto. Tomas, Municipality of Roxas, Province of Palawan, containing an area of **six hundred (600)** square meters, identified as **Lot No. 62, Csd.-045318-012975**, as applied for by **Elenita E. Vueba** was verified to be within Agricultural lands (alienable or disposable) per L.C. Map No. 2880, F.A.O. No. _____, Project No. 14-C certified on October 13, 1981.

Issued this 18th day of April 2022 at CENRO, Roxas, Palawan.

Checked by:

RONNIE P. LILANG
LMO III/ Chief, RPS

Approved:

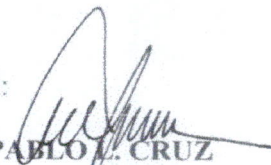
PABLO L. CRUZ
CENRO Officer



Republic of the Philippines
Department of Environment and Natural Resources
Region IV
COMMUNITY ENVIRONMENT AND NATURAL RESOURCES OFFICE
Roxas, Palawan

No. _____ Applicant ELENITA E. VUELKA
Lot No. 62, Csd-045318-012975 Ident. To Lot No. 9313 CAD. 862-D
Portion of Lot No. 7742, CAD. 862-D Surveyed for: REPUBLIC OF THE PHILIPPINES
Date of Original Survey: JAN. - JUNE 1987 Surveyed by: ENGR. JECUL C. PETULLA
Area (sq. m.) 638 Date of Survey: MAY 5 - 31, 1993
Location: STO. TOMAS, ROXAS, PALAWAN Date Approved: AUGUST 5, 1994

TECHNICAL DESCRIPTION

TIE LINE: N 06-18 E 13,292.87 m. from BLM #1 CAD. 862-D, ROXAS CHARISTUE

LINE	BEARINGS	DISTANCE	LINE	BEARINGS	DISTANCE
1-2	N 18-25 E	31.65 m.			
2-3	S 72-53 E	20.01 m			
3-4	S 18-25 W	32.13 m			
4-1	N 71-35 W	20.00 m.			
NOTE:					
All corners are marked on the ground with BL cyl. conc. nodal. 15x60 cm.					
All lots are within Csd-04-012975					

SKETCH

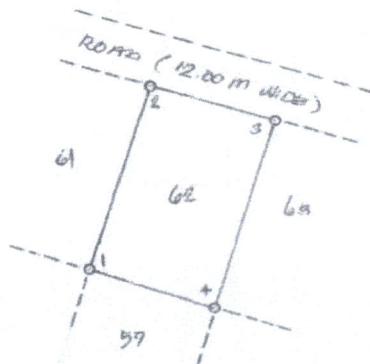

PROJECT NO. 14-C, BLK-XII
LC 2880 DATED OCT. 13, 1981

SCALE 1:1000
BEARINGS: GRID

PROJECT No. 14-C

BLOCK - F

PROJECT No. 14-C

FOREST LANDS

AREA - 349 Hqs.

BLOCK - XII

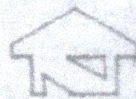

SCALE 1:20000

LC-2880

Oct. 13, 1961

ALIEN. OR DISP.

BLOCK - H

FOREST LANDS

AREA = 2,920 Hqs.

AREA - 858 Hqs.

