



Republic of the Philippines
Department of Environment and Natural Resources
PROVINCIAL ENVIRONMENT AND NATURAL RESOURCES OFFICE
PROVINCE OF PALAWAN

Bgy. Sta. Monica, Puerto Princesa City, Palawan

Email : penropalawan@denr.gov.ph

TelFax No. (048) 433-5638/ 434-8791

July 8, 2022

MEMORANDUM

FOR : THE REGIONAL EXECUTIVE DIRECTOR
DENR MIMAROPA Region

FROM : The Provincial Environment and
Natural Resources Officer

SUBJECT : **REQUEST FOR BUDGET ALLOCATION FOR THE
ENHANCEMENT OF EXISTING PERIMETER FENCE
MADE FROM BARBED WIRE TO CONCRETE PERIMETER
FENCING OF TEN (10) HECTARES LOCATED AT SITIO
LAMORO, BARANGAY PASADEÑA, EL NIDO, PALAWAN**



Furnished is the memorandum from CENRO – Taytay, Palawan dated July 05, 2022 with regards to the above-cited subject.

This request budget allocation is amounting to 28,269,830.85 to enhance the existing perimeter fence made from barbed wire into concrete fence with length of 2,114 meter in total, included here is the MOOE Expense Class.

Attached are the necessary documents needed for the project, to wit:

1. Proposed Work and Financial Plan;
2. Location Map;
3. Detailed Cost Estimates;
4. Copy of Title (Special Patent); and
5. Design.

For information and further instruction.

FOR THE PENRO:

FRANKLIN G. HERNANDEZ
Chief Administrative Officer
Management Services Division
Officer-in-Charge

DENR-PALAWAN
PENRO-RECORDS
RELEASED
By: 
Date: 08 JUL 2022 12:16 PM



Republic of the Philippines
Department of Environment and Natural Resources
MIMAROPA Region
COMMUNITY ENVIRONMENT AND NATURAL RESOURCES OFFICE
By the National Highway, Poblacion, Taytay, Palawan 5312
Mobile: 0926-505-9335 TM 0912-171-3889 TNT
Email: cenrotaytay@denr.gov.ph

July 5, 2022

MEMORANDUM

FOR : The Regional Executive Director
1515 L&S Building, Roxas Boulevard,
Ermita, Manila

THRU : The Provincial Environment and
Natural Resources Officer
Sta. Monica, Puerto Princesa City

FROM : The Community Environment and
Natural Resources Officer

SUBJECT : **REQUEST FOR BUDGET ALLOCATION FOR THE
ENHANCEMENT OF EXISTING PERIMETER FENCE MADE
FROM BARBED WIRE TO CONCRETE PERIMETER
FENCING OF TEN (10) HECTARES LOCATED AT SITIO
LAMORO, BARANGAY PASADEÑA, EL NIDO, PALAWAN**

DENR PENRO
PALAWAN RECORDS
RECEIVED

BY: *[Signature]*
DATE: 07-06-2022 22-6027

DENR CENRO
TAYTAY, PALAWAN
RELEASED

BY: *[Signature]*
DATE: JUL 05 2022 CM 1903

Please be informed that the DENR-CENRO TAYTAY recently acquired the ten (10) hectares property through a Special Patent No.SP-NGA-PLW-0001 covered with Original Certificate Title (OCT) No. 2021000036 located at Sitio Lamoro, Barangay Pasadeña, El Nido, Palawan.

In order to ensure the safety of the said property from possible encroachers and to serve as permanent boundary marks, this Office respectfully requests for budget allocation amounting to Php28,269,830.85 with MOOE Expense Class to be utilized for the Enhancement of the existing perimeter fence made from barbed wire to concrete fence with a total length of 2,114 meters length.

Attached are the necessary documents needed for the project, to wit:

1. Proposed Work and Financial Plan;
2. Location Map;
3. Detailed Cost Estimates;
4. Copy of Title (Special Patent); and
5. Design.

For information, review and approval.

[Signature]
ALAN L. VALLE

Department of Environment and Natural Resources
FY 2022 Physical and Financial Plan
(In Thousand Pesos)

Agency/Bureau: DENR MIMAROPA REGION

[illegible]

Prepared by:

Reviewed by:

Recommending Approval:

Approved by:

PREY M. EBRIQUE
Planning Designate

ALAN W. KILLE
CENTRO

FELIZARDO B. CAYATOC
PENRO

LORMELYN E. CLAUDIO, CESE IV
Regional Executive Director

**ENHANCEMENT OF THE EXISTING PERIMETER FENCE MADE FROM BARBED WIRE
 TO CONCRETE FENCE OF 10-HECTARES DENR LOT**

DETAILED ESTIMATE

ITEM OF WORKS:
ENHANCEMENT OF THE EXISTING PERIMETER FENCE MADE FROM BARBED WIRE TO CONCRETE FENCE OF DENR-CENRO TAYTAY, PALAWAN LOCATED IN BARANGAY PASADEÑA, EL NIDO, PALAWAN.
DATE:
TOTAL COST:
QTY.: 1LOT

ITEM NO.:

WORK DESCRIPTION: ENHANCEMENT OF THE EXISTING PERIMETER FENCE MADE FROM BARBED WIRE TO CONCRETE FENCE OF DENR-CENRO TAYTAY, PALAWAN LOCATED IN BARANGAY PASADEÑA, EL NIDO, PALAWAN.

A. MATERIALS

MASONRY

DESCRIPTION	QUANTITY	UNIT	UNIT COST	AMOUNT
CH Blocks 4"	47,816	pcs	25.00	1,195,400
12mm dia. x 6m RSB	2,608	pcs	240.00	625,920
10mm dia. x 6m RSB	6520	pcs	175.00	1,141,000
Tie Wire # 16	326	kg	90.00	29,340
Gravel & sand	652	Cu.m	1,800	1,173,600
Sand	3256	Cu.m	1,800	5,860,800
Portland Cement	5216	bags	320	1,669,120

CARPENTRY

DESCRIPTION	QUANTITY	UNIT	UNIT COST	AMOUNT
Ordinary plywood	50	pcs	970	48,500
2" x 2" x 8' lumber	100	bdf	35	3,500
Common nail 3"	40	pcs	90	3,600
Common nail 1 ½"	25	pcs	90	2,250
Common nail 4"	40	pcs	90	3,600

WELDING WORKS

DESCRIPTION	QUANTITY	UNIT	UNIT COST	AMOUNT
1 ½"x 3/16"x20m Steel angle bar	1140	pcs	920	1,048,800
Ordinary welding rod	95	kg	160	15,200
Hack saw blade	100	pcs	65	6,500
Cutting disc	50	pcs	60	3,000
Grinding disc	20	pcs	130	2,600
Cup brush	20	pcs	135	2,700

PAINTING WORKS

DESCRIPTION	QUANTITY	UNIT	UNIT COST	AMOUNT
Concrete neutralizer	50	gal	200	10,000
Masonry putty	50	gal	675	33,750
Sand paper No.80	200	ft	30	6,000
Sand paper No. 120	200	ft	30	6,000
Masonry primer paint (flat white)	326	gal	595	1,93,970

Masonry paint (semi gloss white)	562	gal	750	421,500
Tinting Color Raw Seina	100	can	65	6,500
Roller pan	20	pcs	65	1,300
Paint roller 8"	50	pcs	75	3,750
Putty knife	20	pcs	70	1,400
Spatula 4"	20	pcs	75	1,500
Rust converter (Turco)	20	liter	330	6,600
Metal primer	47	gal	570	26,790
Paint thinner	10	gal	320	3,200
Enamel paint black	47	gal	780	36,660
Paint brush 2"	50	pcs	45	2,250

SUB-TOTAL 13,596,600

B. LABOR

SUB-TOTAL 6,118,470
19,715,070

C. ESTIMATED DIRECT COST (EDC)= a+b

19,715,070

D. INDIRECT COST/MARK UP

OC as _ 15% of EDC 2,957,260.50
PROFIT as_10% of EDC 1,971,507.00
TOTAL OF (D) 4,928,767.50

E. VALUE ADDED TAX_5% OF C+D

1,232,191.88

F. TOTAL COST = C+D+E

G. UNIT COST/LOT

25,876,029.38

H. ENGINEER'S FEE

1,293,801.47

TOTAL APPROPRIATION	Php 27,169,830.85	100%
---------------------	-------------------	------

Prepared by:

IAN CRISTOPHER MAHINAY
Civil Engineer
Licensed Number : 0119025

Checked and verified by:

ALAN L. VALLE
CENRO

Approved by:

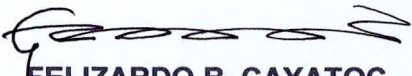
FELIZARDO B. CAYATOC
PENRO

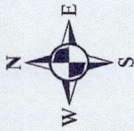

LOCATION PLAN

Lot 1265, CAD 1037-D, El Nido Cadastre

AS SURVEYED FOR

THE DEPARTMENT OF ENVIRONMENT
AND NATURAL RESOURCES

Located at

Sitio : Lamoro
Barangay : Pasadena
Municipality : El Nido
Province : Palawan

Containing an area of 108,107 sqm

Projection : Universal Transverse Mercator Z50N
Datum : World Geodetic System 1984



Republic of the Philippines
Department of Environment and Natural Resources
Region IV - MIMAROPA
Community Environment and Natural Resources Office
Taytay 5312, Palawan

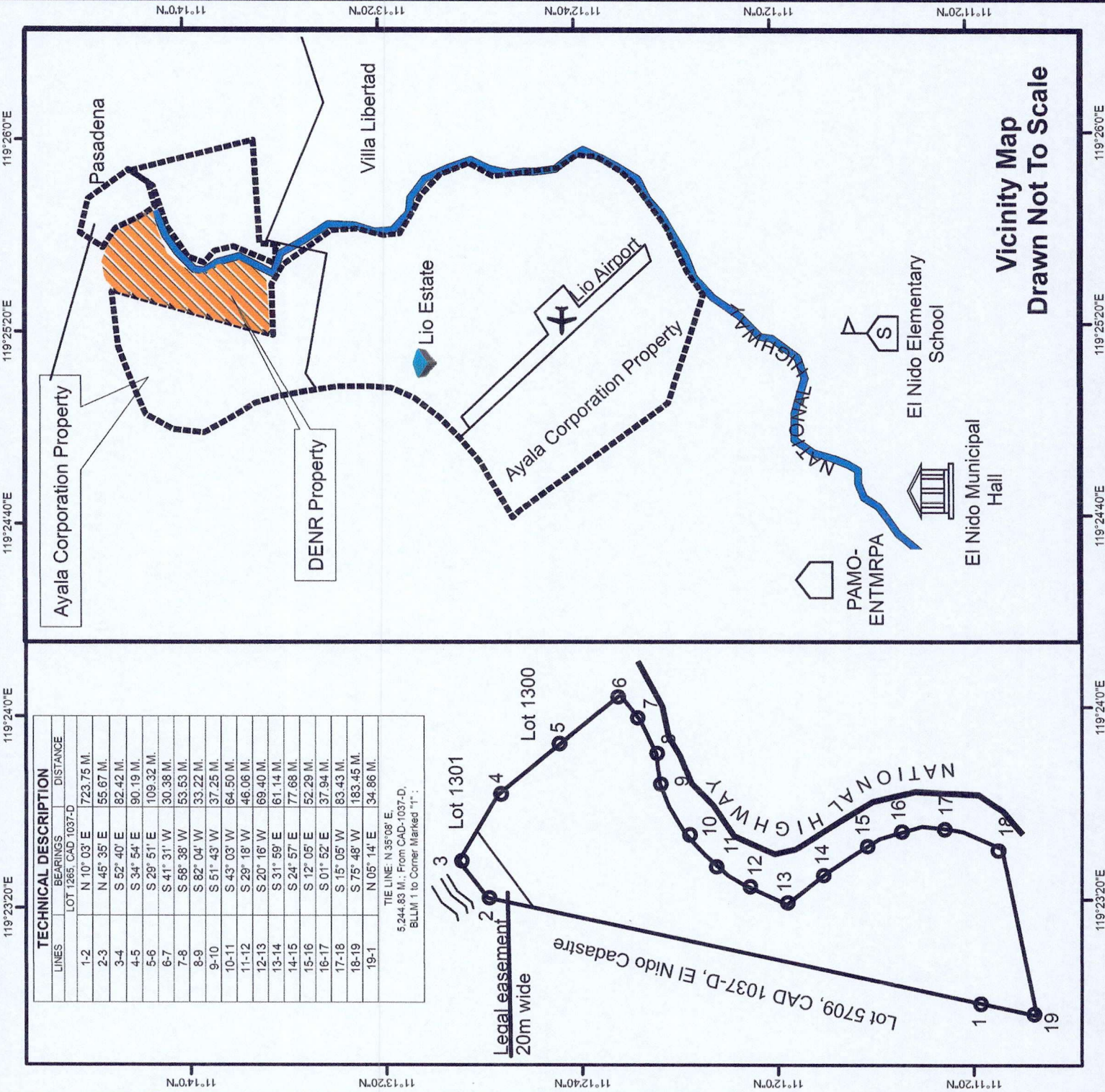
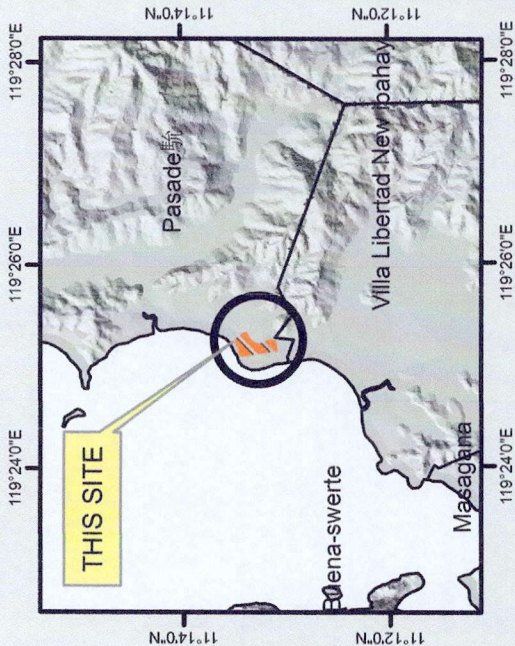

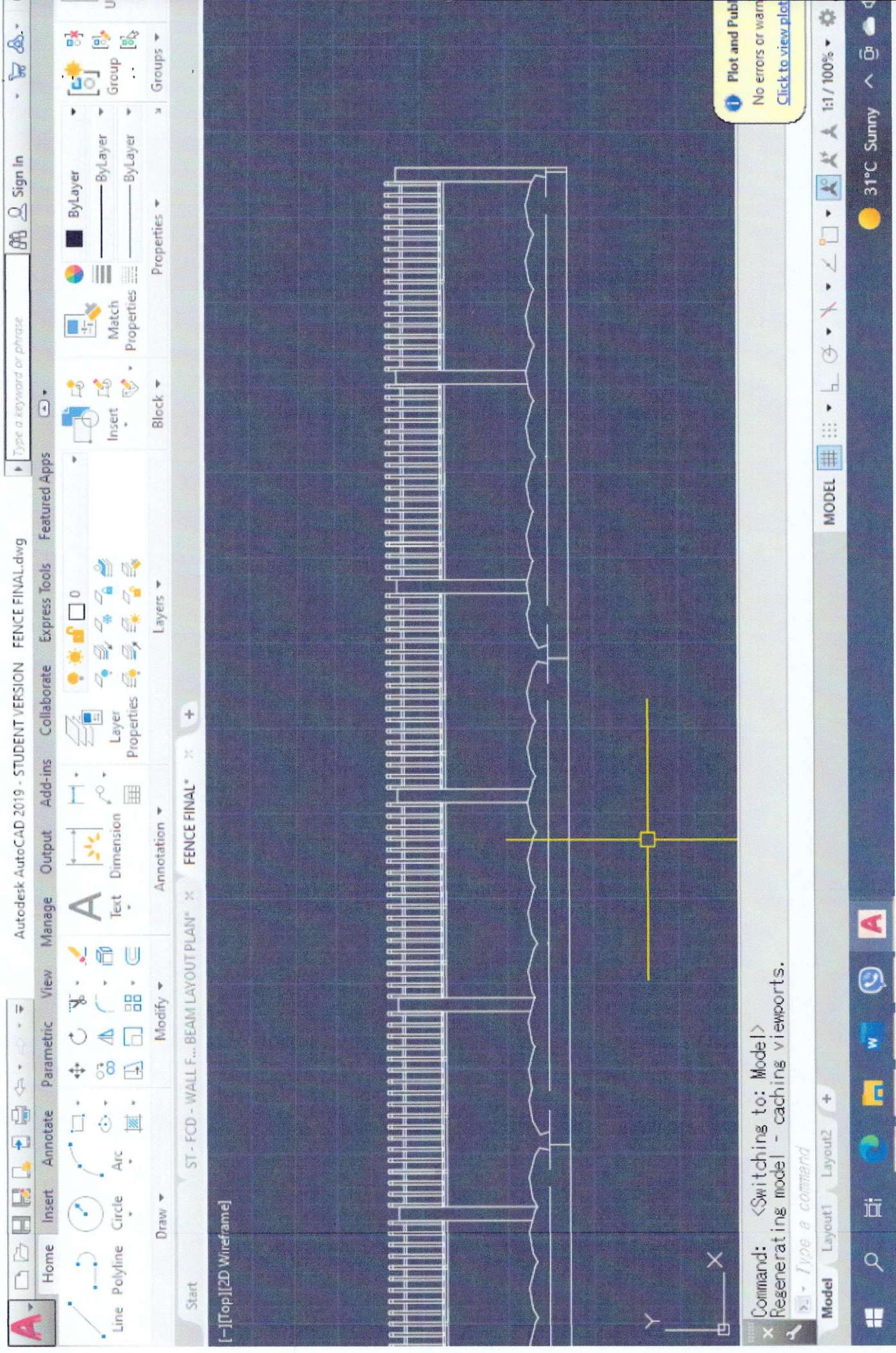

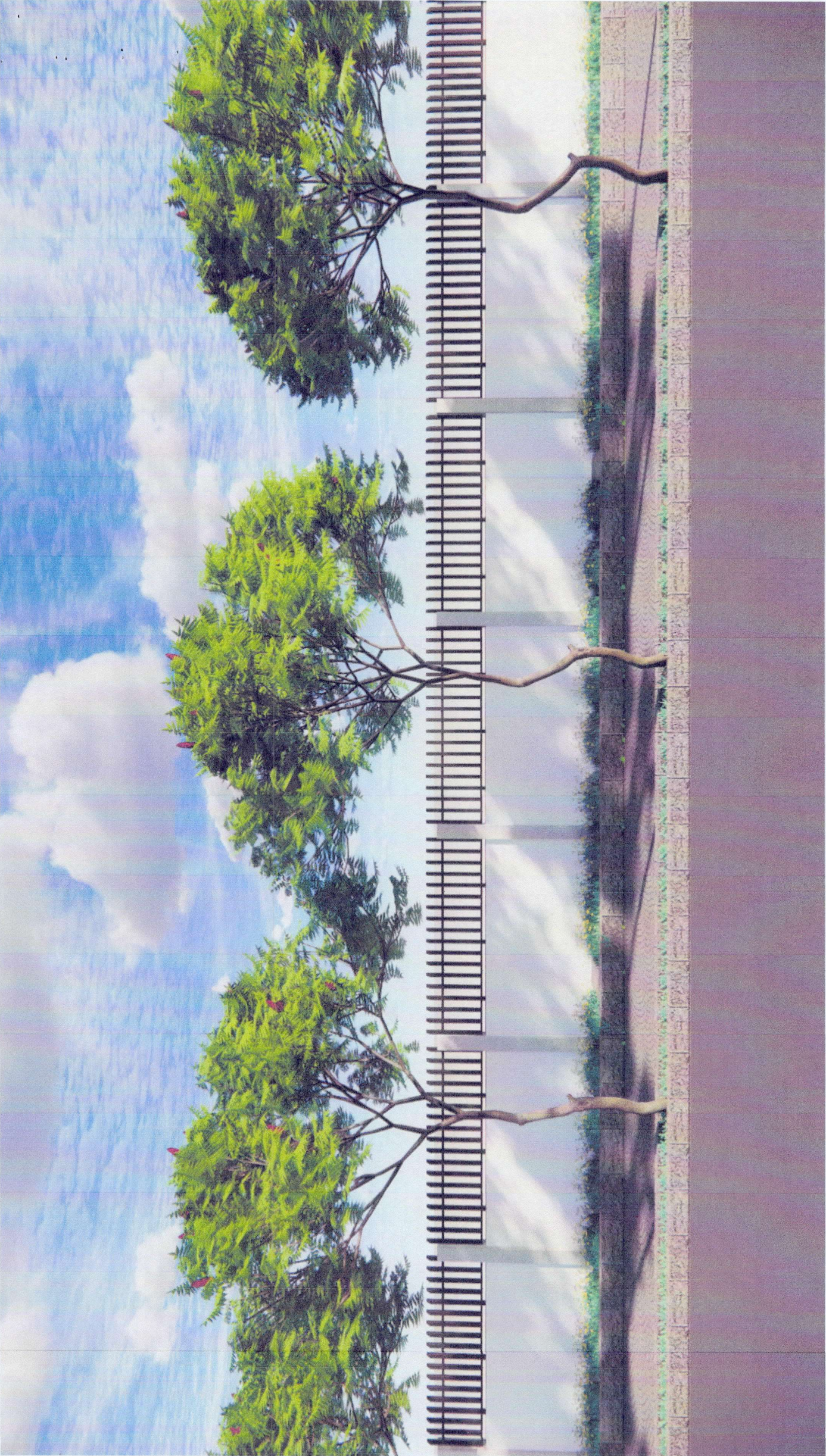

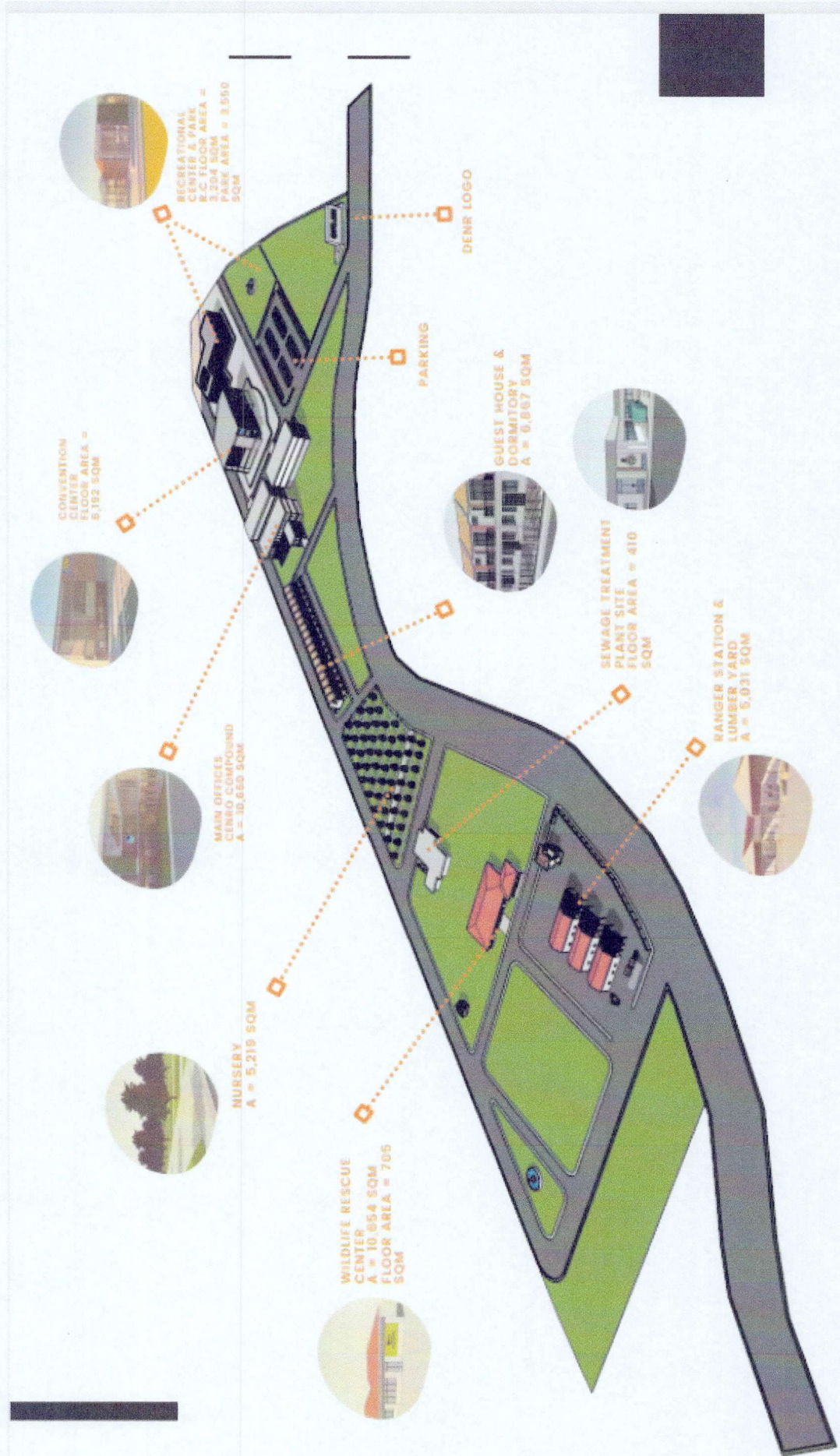

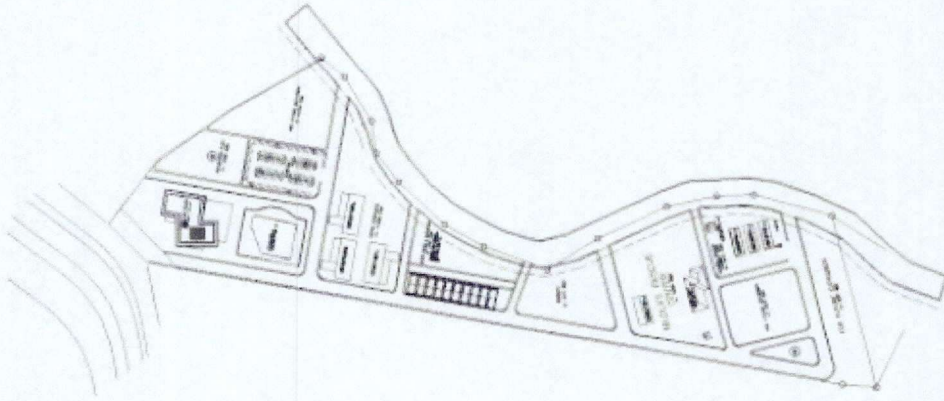

PROPOSED DENR COMPOUND SITE DEVELOPMENT PLAN

Prepared by: Engr. Alan Valle

TECHNICAL DESCRIPTION		
LINE	BEARINGS	DISTANCES
1-2	N 15° 03' E	72.3 154
2-3	N 45° 35' E	55.6 74
3-4	S 82° 40' E	82.4 24
4-5	S 54° 54' E	90.1 54
5-6	S 29° 51' E	106.3 24
6-7	S 41° 31' W	50.2 54
7-8	S 58° 26' W	53.5 54
8-9	S 82° 04' W	53.2 24
9-10	S 51° 43' W	57.2 24
10-11	S 43° 03' W	64.5 04
11-12	S 29° 18' W	46.0 04
12-13	S 20° 16' W	66.4 04
13-14	S 31° 39' E	61.1 44
14-15	S 24° 57' E	77.6 04
15-16	S 12° 09' E	92.2 54
16-17	S 01° 52' E	37.5 44
17-18	S 15° 16' W	83.4 34
18-19	S 75° 48' W	183.4 54
19-1	N 05° 14' E	34.8 64
TOTAL: N 35° 08' E, 5,244.03m, From C&D-1037-D, BLUM 1 to Corner Marked "1".		

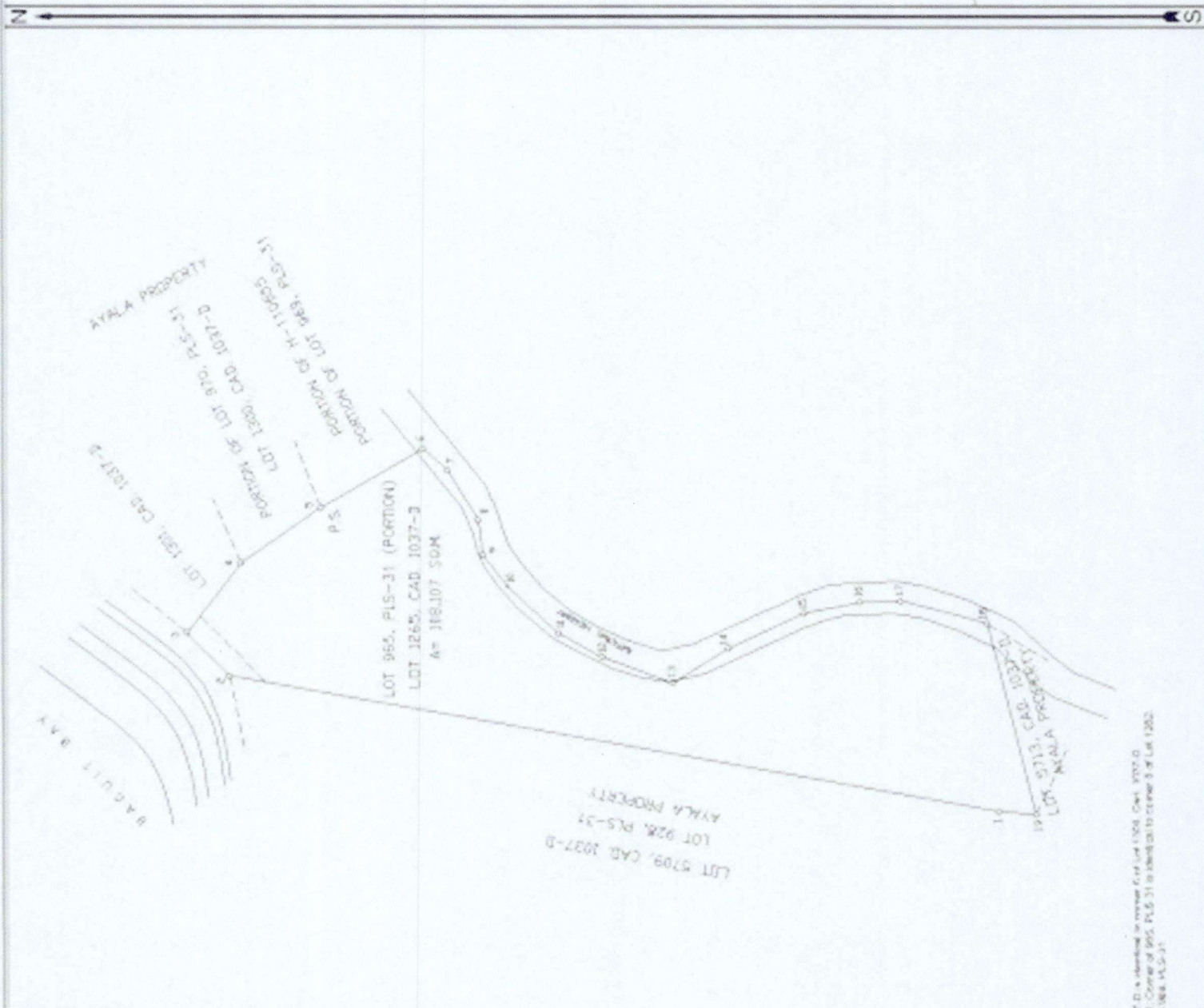

NOTE:
 Corner 5 of Lot 1265, CAD 1037-D is identified as corner 5 of Lot 1265, CAD 1037-D.
 and corner 1 of Lot 928, PLS-31. Corner of 928, PLS-31 is identified as corner 5 of Lot 1265.
 Lot 1265, CAD 1037-D and corner 7 of Lot 1265, CAD 1037-D.

RELOCATION SURVEY

PLAN

SHOWING THE RELATIVE POSITION OF

LOT 1265, CAD 1037-D BLNCO CADASTRE

AS PREPARED FOR

DEPARTMENT OF ENVIRONMENT

AND NATURAL RESOURCES

SITUATED IN THE

SUBDIVISION OF PALAWANA

MUNICIPALITY OF EL NIDO

PROVINCE OF PALAWAN

ISLAND OF PALAWAN

CORNER MARKED AS 1037-D

118 107

92.4

DATE: 10/10/2010

PROJECT: 1037-D

SCALE: 1:1000

CERTIFICATION

This document is hereby submitted with the

assurance of the truth and accuracy of the

data and the correctness of the

information.

SIGNATURE: JAC

DATE: 10/10/2010

MAJIBAB LACORCA

GEODETIC ENGINEER

Reg. Cert. No. 1001

By: 10/10/2010

License No. 1001

Signature of the President

Department of Environment and Natural Resources

REMARKS:

This survey plan is submitted with the

assurance of the truth and accuracy of the

data and the correctness of the

information.

UNIT:

FUNCTION:

CHIEF, REGIONAL SURVEYS DIVISION

Date: 10/10/2010

ALBINO LACORCA

SN 00002823-78

Republic of the Philippines
Department of Justice
Land Registration Authority
Registry of Deeds for the PROVINCE OF PALAWAN

Original Certificate of Title

No. 2021000036

SPECIAL PATENT

Entered in accordance with Section 4 of Republic Act 10023 and pursuant to a Special Patent issued by the Department of Environment and Natural Resources, at Quezon City, on _____ and spread in the records of the said Department as follows:

DEPARTMENT OF ENVIRONMENT AND NATURAL RESOURCES
REGION NO. MIMAROPA
SPECIAL PATENT NO. SP-NGA-PLW-0001

TO ALL WHOM THESE PRESENTS SHALL COME, GREETINGS:

The Republic of the Philippines- REPUBLIC OF THE PHILIPPINES - DEPARTMENT OF ENVIRONMENT AND NATURAL RESOURCES a public institution
situated at Barangay Pasadeña, El Nido, Palawan
Region MIMAROPA is hereby granted this Special Patent with an area of One Hundred Eight Thousand One Hundred Seven
(108,107) square meters, more or less and more particularly bounded and described at the back hereof.

This Special Patent shall not be disposed by the grantee without the authorization of Congress if owned by a National Agency, or authorized by the Sanggunian concerned through an approved ordinance, if owned by a Local Government Unit in accordance with Section 4 of Republic Act 10023.

WITNESS my hand and seal of the Republic of the Philippines this _____ day of _____ in the year Two Thousand and 18 JAN 2021.

By Authority of the President
of the Philippines

ERIBERTO B. SANOS, CSE

Transcribed in the "Registration Book" in the Province of Palawan pursuant to the provisions of Section 103 of P.D. No. 1529, on the 24th day of February, Two thousand and Twenty-one at 1:29 P.M.

ATTY. MARICAR D. MISA-TAN

REGISTER OF DEEDS II
Register of Deeds

PENRO, Sta. Monica, PPG City

Owner's Postal Address,

TECHNICAL DESCRIPTION

Survey Plan No. : Cad 1037-D
 Lot No. : 1265
 Land Owner/Claimant : REPUBLIC OF THE PHILIPPINES - DEPARTMENT OF ENVIRONMENT AND
 NATURAL RESOURCES
 Location : Barangay Pasadeña
 Municipality of El Nido
 Province of Palawan

Boundaries:

Line	Direction	Adjoining Lots/Features
1-2	West	Lot 5709, Cad 1037-D
2-3	North	Bacuit Bay
3-4	North	Lot 1301, Cad 1037-D
4-5	Northeast	Lot 1300, Cad 1037-D
5-6	Northeast	Lot 1267, Cad 1037-D
6-7-8-9-10-11-12-13-13-14-15-16-17-18	East to Southeast	Road
18-19	South	5713, Cad 1037-D
19-1	Southwest	5825, Cad 1037-D

Tie Point : BLLM No. 1, Municipality of El Nido

Lot Description	Line	Bearing	Distance
	Tie Point-1	N 35° 08' E	5,244.83 m.
	1-2	N 10° 03' E	723.75 m.
	2-3	N 45° 35' E	55.67 m.
	3-4	S 52° 40' E	82.42 m.
	4-5	S 34° 54' E	90.19 m.
	5-6	S 29° 51' E	109.32 m.
	6-7	S 41° 31' W	30.38 m.
	7-8	S 58° 38' W	53.53 m.
	8-9	S 82° 04' W	33.22 m.
	9-10	S 51° 43' W	37.25 m.
	10-11	S 43° 03' W	64.50 m.
	11-12	S 29° 18' W	46.06 m.
	12-13	S 20° 16' W	69.40 m.
	13-14	S 31° 59' E	61.14 m.
	14-15	S 24° 57' E	77.68 m.
	15-16	S 12° 05' E	52.29 m.
	16-17	S 01° 52' E	37.94 m.
	17-18	S 15° 05' W	83.43 m.
	18-19	S 75° 48' W	183.45 m.
	19-1	N 05° 14' E	34.86 m.

Area : One Hundred Eight Thousand One Hundred Seven (108,107) square meters, more or less

Description of Corners : All Corners are marked on the ground by P.S. Cyl. Conc Mons 15x40 cm
 Bearings : Grid
 Date of Survey : June 2, 1991 to August 6, 1991
 Date Approved : August 24, 1992
 Geodetic Engineer : Rolando C. Siccion

Prepared by :

ESTER T. BIONA
 Land Management Officer I

Certified Correct:

Marian B. Lachica
 MARIAN B. LACHICA
 Engineer II

(Continued on Additional Sheet Page Register of Deeds)