

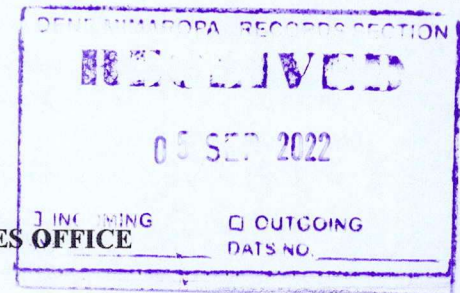

Republic of the Philippines  
Department of Environment and Natural Resources  
MIMAROPA Region  
**PROVINCIAL ENVIRONMENT AND NATURAL RESOURCES OFFICE**  
Province of Palawan  
Bgy. Sta. Monica, Puerto Princesa City  
Telfax No. (048) 434-8791; Email Add: [penropalawan@denr.gov.ph](mailto:penropalawan@denr.gov.ph)



August 19, 2022

**MEMORANDUM**

**FOR** : The Regional Executive Director  
DENR-MIMAROPA, 1515 L & S Bldg.  
Roxas Blvd., Ermita, Manila

**ATTENTION** : The OIC- Assistant Regional Director for Technical  
Services *The OIC-Chief, Surveys and Mapping Division*

**FROM** : The Provincial Environment and  
Natural Resources Officer

**SUBJECT** : **PUBLIC LAND APPLICATION COVERING LOT  
NO.1115-B, CSD-04-020971-D IN BARANGAY IV,  
ROXAS, PALAWAN**

Forwarded is the Memorandum of CENRO Puerto Princesa City dated August 15, 2022 along with the Land Classification Status of LC Lot No.1115-B, Csd.04-020971-D, identical lot no.1291, Pls-232 Cad.862-D.

For confirmation of the Land Classification Status by ARDTS pursuant to DMC-2019-10 dated December 11, 2019.

For information and consideration.

Reference No: 2022-7463  
SMU/IBP

CC:

1. CENRO PPC

DENR-PALAWAN  
PENRO-RECORDS  
**RELEASED**  
By \_\_\_\_\_  
Date 25 AUG 2022 CN 22-273

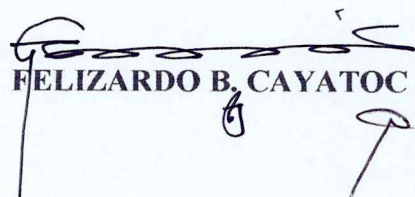
  
FELIZARDO B. CAYATOC

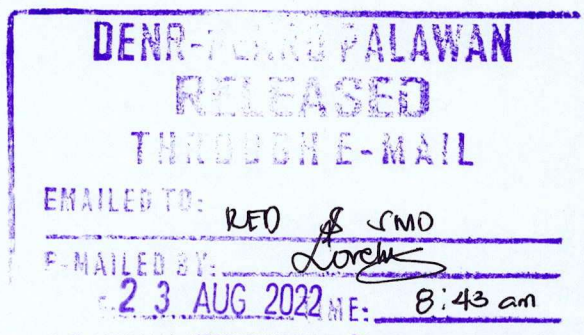



Republic of the Philippines  
Department of Environment and Natural Resources  
MIMAROPA Region

**PROVINCIAL ENVIRONMENT AND NATURAL RESOURCES OFFICE**

**Province of Palawan**

Bgy. Sta. Monica, Puerto Princesa City

Telfax No. (048) 434-8791; Email Add: [penropalawan@denr.gov.ph](mailto:penropalawan@denr.gov.ph)

(ANNEX I)

**CERTIFICATION**

**TO WHOM IT MAY CONCERN:**

THIS IS TO CERTIFY that based on available records, the tract of land in Barangay San Jose, Roxas, Palawan, containing an area of **FIVE HUNDRED FIFTEEN (515)** square meters, identified as **Lot No.1115-B, Csd-04-020971-D**, covered by Free Patent Application No. 045318-2493 of FLORENCIA PALARCA was verified to be within **AGRICULURAL, Alienable and Disposable Land** per LC Map No. 889, with FAO No.\_\_\_\_, Project No. 1-A, certified on May 29, 1931.

Issued this 19<sup>th</sup> day of August, 2022 at DENR Office, Sta. Monica, Puerto Princesa City.

**Checked/Verified by:**

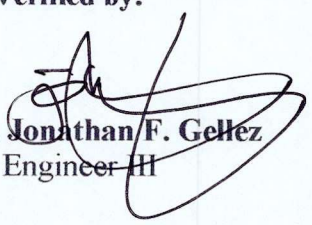
  
**Engr. Jonathan F. Gellez**  
Engineer III

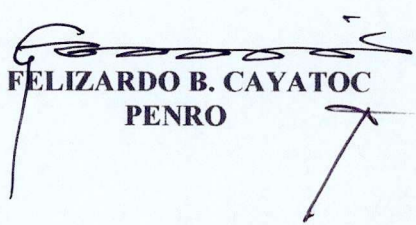
  
**FELIZARDO B. CAYATOC**  
PENRO

Note:  
Reference used was based on the rectified LC map  
provided and projected by the Regional Office



**ALIENABLE AND DISPOSABLE LAND**  
**PROJECT NO. 1-A**  
**BLOCK II**  
**LC 889**

Brig. IV

LOT 1115-B, FLORENCIA PALARCA

Roxas



Located at Brgy. IV  
Municipality of Roxas  
Province of Palawan

*Projection: Transverse Mercator*

SCALE 1:2000

PA_MIMAROPA_UTMZN50	LOT 1115-B	CADT_CADC	Available & Disposable	Forestland	UPF	No Data
			18,077.90 Has.	8,180.66 Has.	62,390.16 Has.	9.84 Has.

DAVE N. BALMORES  
For III

BELLE E. L  
Engr. II





Republic of the Philippines  
Department of Environment and Natural Resources  
**Region IV- MIMAROPA**  
**COMMUNITY ENVIRONMENT AND NATURAL RESOURCES OFFICE**  
Barangay III (Poblacion), Roxas, Palawan  
Contact No. 09171606578 / 09175028647  
Email address: [cenroroxaspalawan@denr.gov.ph](mailto:cenroroxaspalawan@denr.gov.ph)

**MEMORANDUM**

**FOR** : The Provincial Environment and Natural Resources Officer  
**FROM** : The CENR Officer  
**SUBJECT** : **PUBLIC LAND APPLICATION COVERING LOT NO. 1115-B, CSD-04-020971-D IN BARANGAY IV, ROXAS, PALAWAN.**  
**DATE** : 15 August 2022

DENR PENRO  
PALAWAN RECORDS  
**RECEIVED**

BY:   
DATE: 08-18-2022 22-7463

Herewith for clearance confirming LC findings as required in the processing and issuance of patent pursuant to DMC 2019-10, is land classification certification applied of Lot No. 1115-B, Csd-04-020971-D identical to Lot no. 1291, Pls-232 Cad. 862-D, which are found to be within the agricultural (alienable /disposable) land.

Attached in support hereof as required by the Surveys and Mapping Division (SMD) are the technical description thereof and a print of the corresponding projection map recently provided this Office also by the SMD.

Thank you for considering the matter soonest.

  
**PABLO L. CRUZ**  
CENRO

Copy: The RED  
File

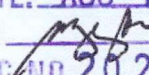
DENR-CENRO ROXAS  
**RELEASED**  
DATE: AUG 17 2022  
BY:   
DOC NO. 2022-08-1300





Republic of the Philippines  
Department of Environment and Natural Resources

**Region IV- MIMAROPA**  
**COMMUNITY ENVIRONMENT AND NATURAL RESOURCES OFFICE**

Barangay III (Poblacion), Roxas, Palawan  
Contact No. 09171606578 / 09175028647  
Email address: [cenroroxaspalawan@denr.gov.ph](mailto:cenroroxaspalawan@denr.gov.ph)

**CERTIFICATION**

**TO WHOM IT MAY CONCERN:**

THIS IS TO CERTIFY that based on available records in our office, the tracts of land in Barangay IV, Municipality of **Roxas** Province of **Palawan**, containing an area of **Five Hundred Fifteen (515)** square meters identified as Lot no. **1115-B,Csd-04-020971-D** as applied for by **FLORENCIA B. PALARCA** was verified to be within **AGRICULTURAL (Alienable or Disposable)** per L.C. Map No. **889**, F.A.O. No. **none** Project No. **1-A** certified on **May 29, 1931**.

Issued this 12<sup>th</sup> day of **August 2022** at CENRO, Roxas, Palawan.

Checked by:

  
**RONNIE B. LILANG**  
LMO III/Chief, RPS

Approved:

  
**PABLO I. CRUZ**  
CENRO



PROJ. NO. 14-C  
BLOCK - A  
TIMBER LAND  
LC - 2880  
OCT. 13, 1981

PROJ. NO. 14-C  
BLOCK - VII  
ALIEN, OR DISP.  
LC - 2880

PROJ. NO. 14-C  
BLOCK - V  
ALIEN, OR DISP.  
LC - 2880

PROJ. 1-A  
BLOCK - E  
TIMBERLAND  
LC - 889

PROJECT NO. I-A

BLOCK - II

ALIENABLE

AND

DISPOSABLE

AREA = 2,270.4 HAS.

PROJ. 14-C  
BLOCK - IV  
ALIEN, OR DISP.  
LC - 2880  
OCT. 13-81

PROJ. 14-B  
BLK - XI  
A & D  
LC - 2182  
OCT. 21-1958  
So. Omalad

A=83 HAS.



SCALE 1:20000  
LC - 889  
May 29, 1931

Csd-04-015766-D  
Barbacan Pt.

LOT 115-B  
Csd-04-020971-D

LOT 115, PIs-232  
ORIG. LOT 134, PIs-232  
THIS SITE

Del Pilar

So. Omalad

10°19'

119°20'

119°21'



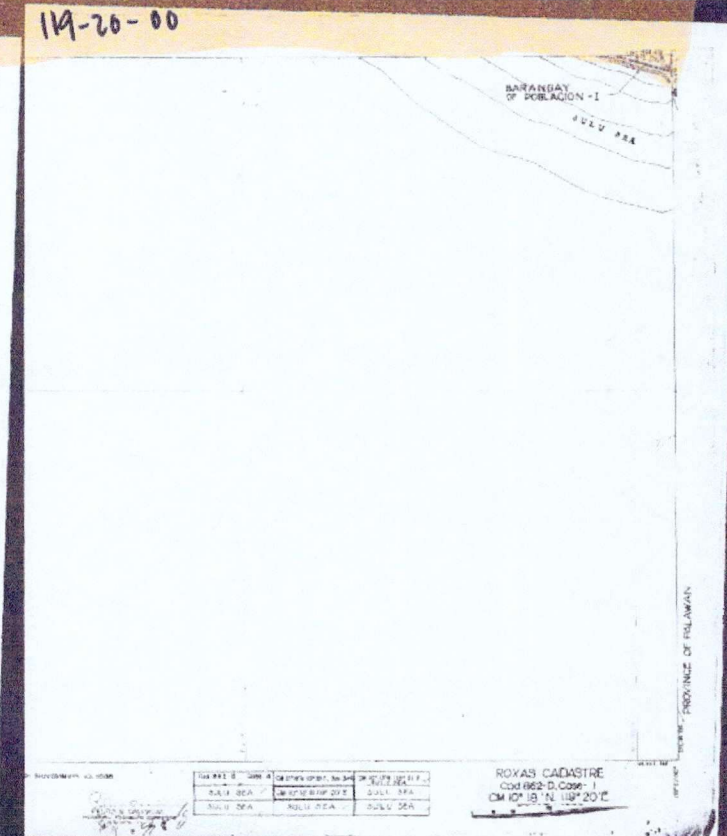
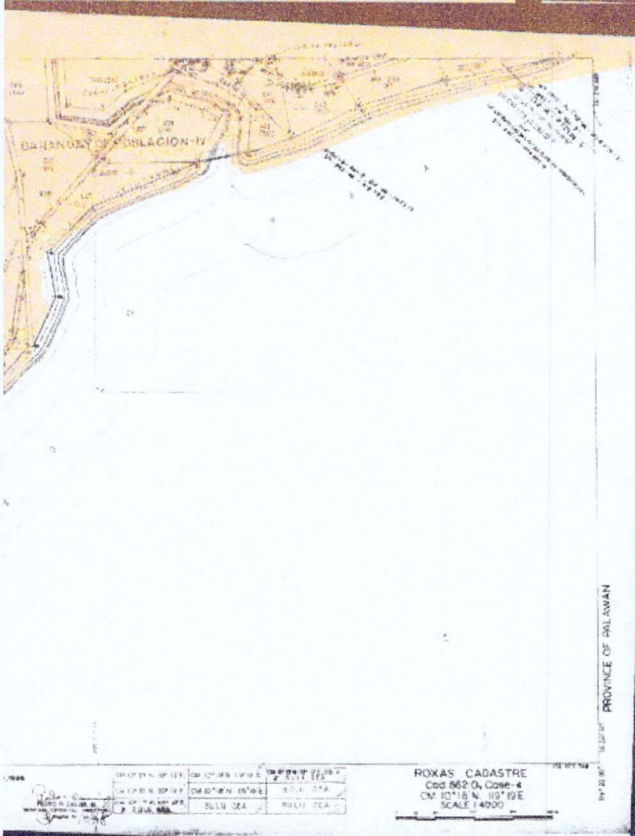
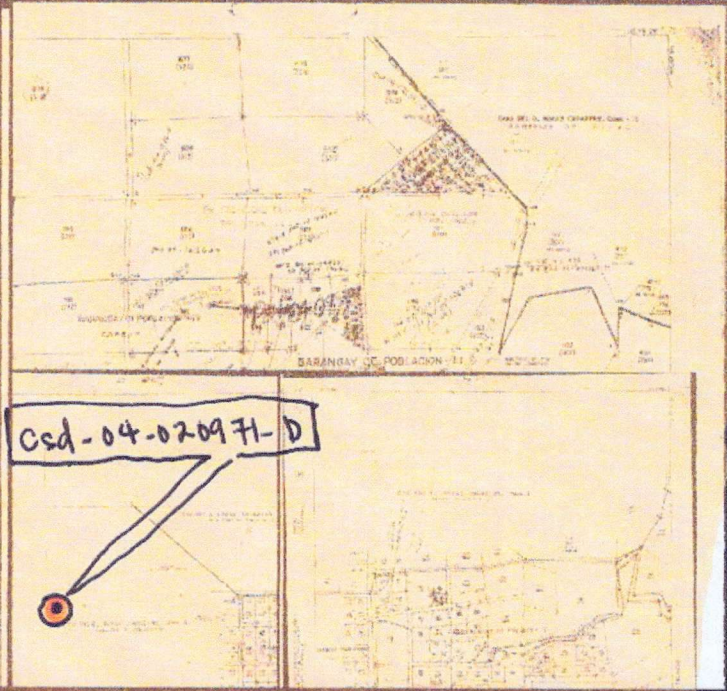
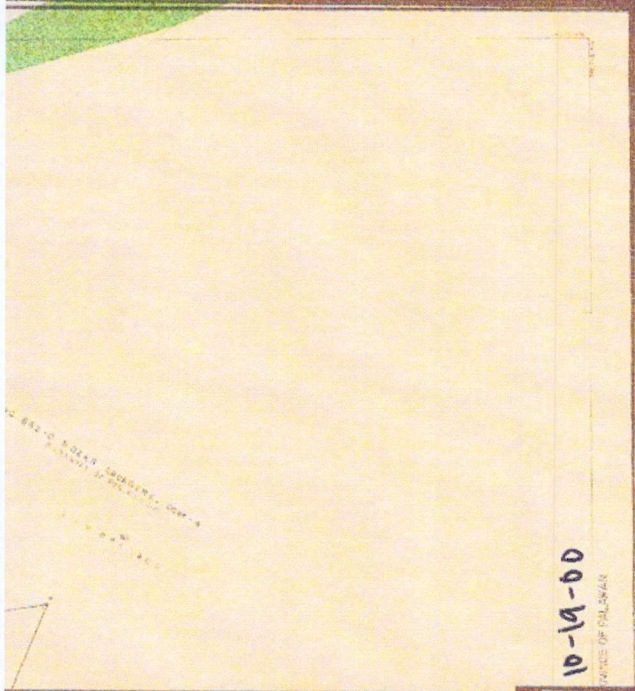
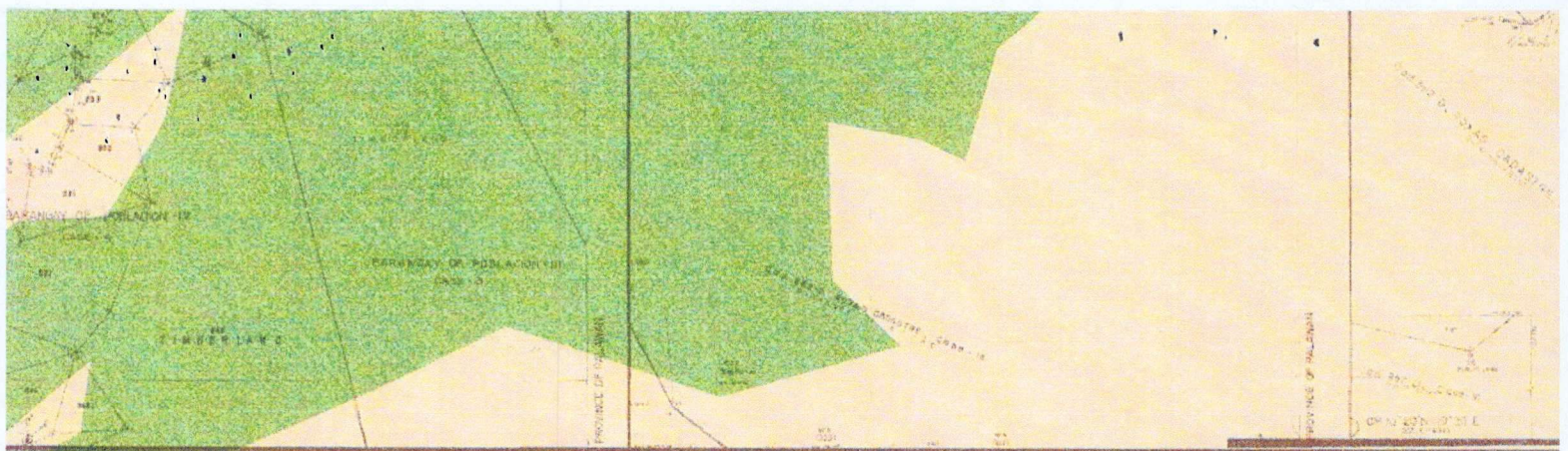





RPPA No. 0453/87 Applicant: FLORENCIA B. PALARCA  
Lot No. 1115-B, CDD-04-020971-D Ident. To Lot No. 1291, DLP-732  
Portion of Lot No. 1115, PLS-232 Surveyed for: FLORENCIA B. PALARCA  
Date of Original Survey: Feb. 1949-May 1951 Surveyed by: ROMULO U. MONDINEDO  
Area (sq. m.) YN SQ. M. Date of Survey: FEBRUARY 10, 2000  
Location: BARANGAY IV, ROXAS, PALAWAN Date Approved: FEBRUARY 1, 2001

#### TECHNICAL DESCRIPTION

THE LINE: S 80°-10' W 160.42 METERS FROM BLUM-1 PLS-232 TO CORNER-1

LINE	BEARINGS	DISTANCE	LINE	BEARINGS	DISTANCE
1-2	N 89°-12' E	21.19 METERS		+ 0.05	+ 21.19
2-3	S 01°-07' W	11.33 - 40 -		- 11.33	- 0.22
3-4	S 87°-41' W	7.20 - 40 -		- 0.29	- 7.19
4-5	DUE DEPT	1.57 - 40 -		0	- 1.57
5-6	S 00°-33' E	21.91 - 40 -		- 21.91	+ 0.21
6-7	S 88°-55' W	12.43 - 40 -		- 0.29	- 12.43
7-1	N 00°-01' E	33.77 - 40 -		+ 33.77	+ 0.01
NOTE: ALL CORNERS ARE MARKED BY WOODS, 15 X 60 CM.				+ 33.77	+ 21.41
				- 33.77	+ 21.41
				X .00	X .00

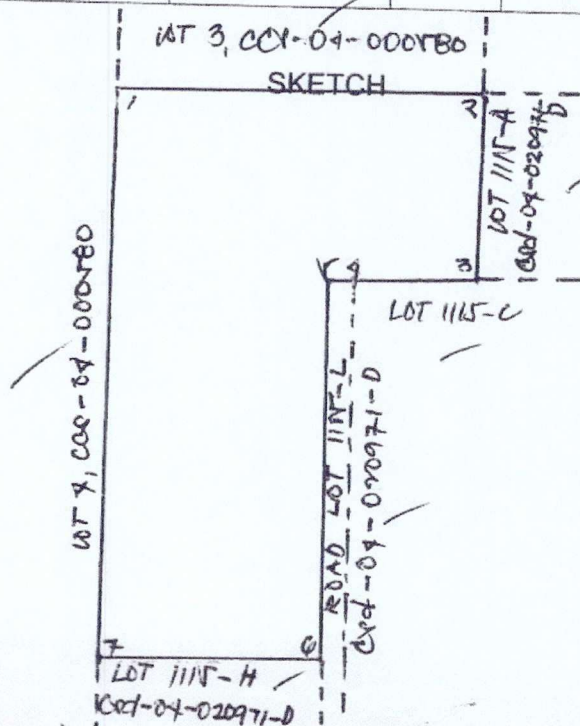

NTS  
Bearings: True