



Republic of the Philippines
Department of Environment and Natural Resources
MIMAROPA REGION

PROVINCIAL ENVIRONMENT AND NATURAL RESOURCES OFFICE

Bgy. Sta. Monica, Puerto Princesa City, Palawan

Telfax No. (048) 434-8791

Email Add: penropalawan@denr.gov.ph

DENR MIMAROPA
RECORDS SECTION
RECEIVED

FEB 13 2023

☐ INCOMING ☐ OUTGOING

BY: _____ DATE NO. _____

TIME: _____

MEMORANDUM

FOR : The OIC Assistant Regional Director for Technical Services

FROM : The Provincial of Environment and Natural Resources Officer

SUBJECT : **TRANSMITTAL OF THE REPORT**

DATE : February 2, 2023

Forwarded the memorandum dated December 1, 2022 of CENRO Puerto Princesa City, Palawan requesting for issuance of Survey Authority covering portion of Lot No. 15548, CAD 800-D in relation to the application for Special Patent of Ubaldo L Conde High School represented by Ms. Loida Adornado, Ph.D Ceso VI, Asst. School Division Superintendent (DEPED) located at Brgy. Manalo, Puerto Princesa City, Palawan in compliance of DMC 2019-10 and Technical Bulletin No. 2020-01.

After careful evaluation and projection conducted by this Office, the following are additional information to the above mentioned lot wit;

- That the area applied for segregation was identified as portion of Lot No. 15548, CAD 800-D, containing an area of 15,000 Square Meters more or less. Wherein, Lot No. 15548-A with an area of 13,148 Square meters will be intended for Ubaldo High School area while Lot No. 15548-D will be planned as Ubaldo High School Road lot with an area of 1,852 Square Meters, based on sketch illustrated in the investigation report.
- That the subject Lot falls within **ALIENABLE AND DISPOSABLE LAND** per Land Classification Map No.1246, Project No. 1-E, Block 1 certified on January 15, 1936.
- That subject tract of land was plotted and evaluated based on the attached technical description (V 37). Subject for issuance of clearance by the Regional Office.
- Attached are the geo-tagged photographs of the area and sketch map showing the relative position of the subject lot overlaid in land classification map for further reference.

In view hereof, this Office recommend the issuance of survey authority in favor of Ubaldo L. Conde High School.

FELIZARDO B. CAYATOC

DENR-PALAWAN
PENRO-RECORDS
RELEASED

By: _____
Date: 7 FEB 2023 CN 23-314



Republic of the Philippines
Department of Environment and Natural Resources
MIMAROPA REGION
PROVINCIAL ENVIRONMENT AND NATURAL RESOURCES OFFICE
Province of Palawan
Brgy. Santa Monica, Puerto Princesa City
Telfax No. (048) 434-8791; Email Add: penropalawan@denr.gov.ph

ANNEX "B"

CERTIFICATION

This is to certify that **LOT No. 15548, CAD 800-D** was verified falls within **ALIENABLE AND DISPOOSABLE LAND** per Land Classification Map No. 1246, Project No. 1-E, Block I certified on January 15, 1936.

Issued on the ^{2nd} day of February 2023 at DENR PENRO, Sta. Monica, Puerto Princesa City, subject for confirmatory verification of the Regional Office.

FELIZARDO B. CAYATOC
PENRO

Note:

Reference used was based on the rectified LC map provided and projected by the Regional Office

DENR-PALAWAN
PENRO-RECORDS
RELEASED
By 
Date: 07 FEB 2023 23-314



Republic of the Philippines
Department of Environment and Natural Resources
COMMUNITY ENVIRONMENT AND NATURAL RESOURCES OFFICE
PUERTO PRINCESA CITY
South National Highway, Bgy. Sta. Monica Puerto Princesa City
Email Address: cenropuertoprincesa@denr.gov.ph
Tel. Fax No.: (048) 717-0702

MEMORANDUM

FOR : The Provincial Environment and
Natural Resources Officer
Sta. Monica, Puerto Princesa City

FROM : The OIC – Community Environment and
Natural Resources Officer
Sta. Monica, Puerto Princesa City

SUBJECT : **TRANSMITTAL OF THE REPORT RE: THE REQUEST OF UBALDO L. CONDE HIGH SCHOOL FOR ISSUANCE OF SURVEY AUTHORITY OVER A PORTION OF LOT NO. 15548, CAD. 800-D LOCATED IN BGY. MANALO, PUERTO PRINCESA CITY**

DATE : December 1, 2022

**DENR PENRO
PALAWAN RECORDS
RECEIVED**
BY:
DATE: 12-12-2022 CN 22-1344

I am submitting the investigation report conducted by the representative of this Office on the request for Survey Authority over a portion of Lot No. 15548, Cad. 800-D, located in Barangay Manalo, Puerto Princesa City, with an area of 15,000 square meters more or less.

After the conduct of the evaluation, I found out the following:

- The subject lot is identified as a **portion of Lot No. 15548, Cad. 800-D** with an approximate area of **15,000 sq. m.** located in Bgy. Manalo, Puerto Princesa City wherein an area of **13,148 sq. m.** is intended for **Ubaldo L. Conde High School** while an area of **1,852 sq. m.** is intended for **High School road lot** which was requested to be named as **Ubaldo Conde Road**;
- The subject lot was verified to be within Alienable and Disposable Land per approved Land Classification Map No. 1246, Project No. 1-E, certified on January 15, 1936;
- The said lot is actually possessed and occupied by Ubaldo L. Conde High School and is free from claims and conflicts;
- The subject lot is devoid of mangroves;
- The applicant has complied all the necessary requirements in the issuance of Survey Authority and Land Classification Confirmation pursuant to DENR Memorandum Circular (DMC) No. 2019-10;
- The request for issuance of survey authority is suitable for the purpose it is devoted for.

Hence, I recommend for the approval of the application for Survey Authority. Attached are geo-tagged photographs of the subject lot.

PEDRO A. VELASCO

Cc: **Ms. Gina Ortega**
Officer-In-Charge, Ubaldo L. Conde High School (ULCHS)
Bgy. Manalo, Puerto Princesa City
Contact No. 0938-097-1708

Ms. Loida Palay-Adornado, Ph.D., CESO VI
Asst. Schools Division Superintendent
Officer-In-Charge, Office of the Schools Division Superintendent
Department of Education – Division of Puerto Princesa
Bgy. Sta. Monica, Puerto Princesa City

**DENR MIMAROPA REGION
CENTRO PUERTO PRINCESA
RECEIVED**
NO. 196
DATE: 12-12-22
BY:

Geo-tagged photographs over a portion of Lot No. 15548, Cad. 800-D
located in Bgy. Manalo, Puerto Princesa City





Republic of the Philippines
Department of Environment and Natural Resources
MIMAROPA REGION
PROVINCIAL ENVIRONMENT AND NATURAL RESOURCES OFFICE
Province of Palawan
Brgy. Santa Monica, Puerto Princesa City
Telfax No. (048) 434-8791; Email Add: penropalawan@denr.gov.ph

ANNEX "B"

CERTIFICATION

This is to certify that **LOT No. 15548, CAD 800-D** was verified falls within **ALIENABLE AND DISPOOSABLE LAND** per Land Classification Map No. 1246, Project No. 1-E, Block I certified on January 15, 1936.

Issued on the ^{2nd} day of February 2023 at DENR PENRO, Sta. Monica, Puerto Princesa City, subject for confirmatory verification of the Regional Office.

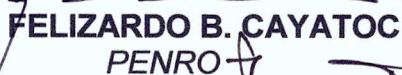
FELIZARDO B. CAYATOC
PENRO

Note:
Reference used was based on the rectified LC map
provided and projected by the Regional Office

118°49'30"E

118°49'40"E

118°49'50"E

9°58'10"N

9°58'0"N

9°57'50"N

FORESTLAND
PROJECT No. 1-E
BLOCK I
LC No. 1246

MAP SHOWING
OF LOT 15548, Cad Cad 800-D
Claimed by Ubaldo Conde



Situated at
Barangay Manalo
City of Puerto Princesa
Province of Palawan

Projection: UTM
Area: 15,000 sq.m.

Legend

15548

Land Classification Map_PRS92

LC STATUS

Alienable & Disposable

Communal Forest

Forestland

No Data

UFF



Republic of the Philippines
Department of Environment and Natural Resources
COMMUNITY ENVIRONMENT AND NATURAL RESOURCES OFFICE
PUERTO PRINCESA CITY
South National Highway, Bgy. Sta. Monica Puerto Princesa City
Email Address: cenropuertoprincesa@denr.gov.ph
Tel. Fax No.: (048) 717-0702

MEMORANDUM

FOR : The OIC-Community Environment and Natural Resources Officer
Sta. Monica, Puerto Princesa City

FROM : The Investigating Officer
SI I Christyl Pops B. Maningas

SUBJECT : **INVESTIGATION REPORT RE: THE REQUEST OF UBALDO L. CONDE HIGH SCHOOL FOR ISSUANCE OF SURVEY AUTHORITY OVER A PORTION OF LOT NO. 15548, CAD. 800-D LOCATED IN BGY. MANALO, PUERTO PRINCESA CITY**

DATE : November 29, 2022

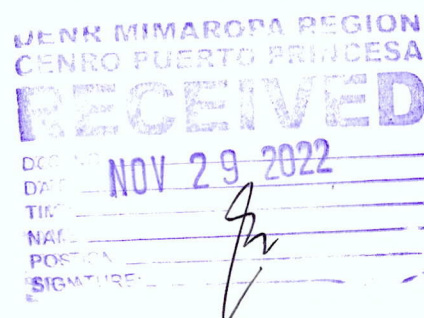

I am submitting this report in compliance with your instruction to conduct an investigation on this application for survey authority.

SUBJECT LOT

The subject of this investigation is a **portion of Lot No. 15548, Cad. 800-D**, located in **Barangay Manalo, Puerto Princesa City** with an area of **15,000 sq. m. more or less**.

CLAIMANT

The claimant is **Ubaldo L. Conde High School** located in **Bgy. Manalo, Puerto Princesa City**.

PROCEEDINGS/ACTIVITIES UNDERTAKEN

Upon receipt of your instruction, I immediately conducted the investigation. The following were undertaken:

1. Prepared a letter dated July 15, 2021 to Mr. Wayne A. Socrates, Head Teacher I of Ubaldo L. Conde High School in response to his letter of intent dated April 19, 2021, informing him as to the status of the subject lot and likewise the scheduled date of ocular inspection and letter dated September 2, 2021 informing him as to the documentary requirements in the issuance of survey authority pursuant to DMC 2019-10 ;
2. Prepared a letter dated February 9, 2022 to Asst. Schools Division Superintendent Loida Palay-Adornado informing her of the requirements pursuant to DMC 2019-10 in response to her letter dated January 31, 2022;
3. Conducted an ocular inspection/investigation and geo-tagged photos of the subject lot on September 16, 2021.

FINDINGS/RECOMMENDATION

After the conduct of the investigation, I found the following:

1. That per Certification issued by this Office dated September 27, 2022, Lot No. 15548, Cad. 800-D with an area of 42,564 sq. m. located in Bgy. Manalo, Puerto Princesa City has been verified to be Alienable and Disposable Land per approved Land Classification Map No. 1246, Project No. 1-E, certified on January 15, 1936;
2. That per Certification issued by this Office dated June 14, 2021, record shows that Lot No. 15548, Cad. 800-D containing an area of 42,564 square meters located in Bgy. Manalo, Puerto Princesa City has **no listed claimant/applicant** as of the said date;
3. That the undersigned together with LMO II/Chief, RPS Mildred A. Pascual, LMO I Valentin Gerald J. Aloria, II and Math Aide I Reynaldo V. Macola conducted an ocular inspection/investigation over the subject area on September 16, 2021 which were assisted by the Mr. Wayne A. Socrates, Bgy. Kgd. Jonathan C. Conde, Bgy. Tanod Bernado Cojamco, and Mrs. Mildred C. Conde in identifying the boundaries of the area being requested for survey authority. The team conducted Global Positioning System (GPS) Reading and geo-tagged photographs of the subject lot;
4. That it was found out that the school is in possession or actually **occupying a portion of the land** area being requested for issuance of survey with considerable improvements thereon such as school buildings made of concrete materials and is covered/surrounded with fence;
5. That according to the submitted "*Kasaysayan ng Ubaldo L. Conde High School*", the subject lot was actually owned by Spouses Mr. Domingo B. Conde and Mrs. Mildred C. Conde which was inherited by the aforementioned couple from the former's father namely Mr. Ubaldo L. Conde wherein by the kindness of the said family, they **donated a portion of the subject lot** for the establishment of the secondary school for the benefit of the students of the said barangay on April 20, 2015;
6. That **Domingo B. Conde**, legitimate son and heir of late Ubaldo L. Conde, waived a parcel of land identified as **Lot No. 15548-A with an area of 13,148 sq. m.** more or less and **Lot No. 15548-D with an area of 1,852 sq. m.** more or less in favor of the **Department of Education – City Schools Division of Puerto Princesa City** and further requesting that the said parcels of land be named to **Ubaldo Conde Barangay High School and Ubaldo Conde Road**, respectively, in honor of their late father Ubaldo L. Conde per executed Waiver of Rights dated April 20, 2015 which was subscribed and sworn to before Atty. Richander Golifardo Jagmis;
7. That per submitted copy of sketch plan, Lot No. 15548, Cad. 800-D was proposed to be subdivided into four (4) lots wherein **Lot No. 15548-A is intended as the Proposed High School Area** while **Lot No. 15548-D is intended for Proposed High School Area Road Lot** with a **total area of 15,000 sq. m.** more or less;
8. Other documents attached are the following:
 - 8.1. Court Clearance dated May 4, 2022 certifying that the Office of the Clerk of Court has no record of any pending registration case filed in Court involving Lot No. 15548, Cad. 800-D located at Bgy. Manalo, Puerto Princesa City;
 - 8.2. LRA Clearance dated December 19, 2016 certifying that no property can be located in the name of Ubaldo Conde;
 - 8.3. Joint Affidavit of Two Disinterested Persons dated June 17, 2022 executed by Romano Manlavi Pacdaan and Ivann George Paduga Polizon attesting that Ubaldo L. Conde High School (ULCHS) is the actual occupant of a portion of Lot No. 15548, Cad. 800-D;
 - 8.4. Barangay Certification dated October 25, 2021;
 - 8.5. Photocopy of Identification Card of Loida P. Adornado with Cedula;

- 8.6. Tax Declaration of Real Property dated October 11, 2016 and September 22, 2021 with TD No. 019-10509 and 019-11236, respectively, both of Property Identification No. 134-03-019-024 in the name of Ubaldo Conde over Lot No. 15548, Cad. 800-D located in Bgy. Manalo, Puerto Princesa City;
- 8.7. Tax Map showing the location of the subject lot; and
- 8.8. V-37, Technical Description and Map showing the subject lot;
9. That the subject area is identified to be within Alienable and Disposable Area is free from claims and conflicts and is devoid of mangroves;
10. That the requester, Ubaldo L. Conde High School intends to hire the services of Engr. Cristopher C. Caimoy to execute the subdivision survey over a portion of Lot No. 15548, Cad. 800-D located in Bgy. Manalo, Puerto Princesa City;
11. That shown below are the geo-tagged photographs taken during the conduct of ocular inspection over the subject area on September 16, 2021 located in Bgy. Manalo, Puerto Princesa City;

***Proposed survey of Lot No. 15548, Cad. 800-D as based on the attached sketch plan
(Only the proposed area for Ubaldo L. Conde High School and for High School road lot is
hereby requested for issuance of survey clearance/authority)***

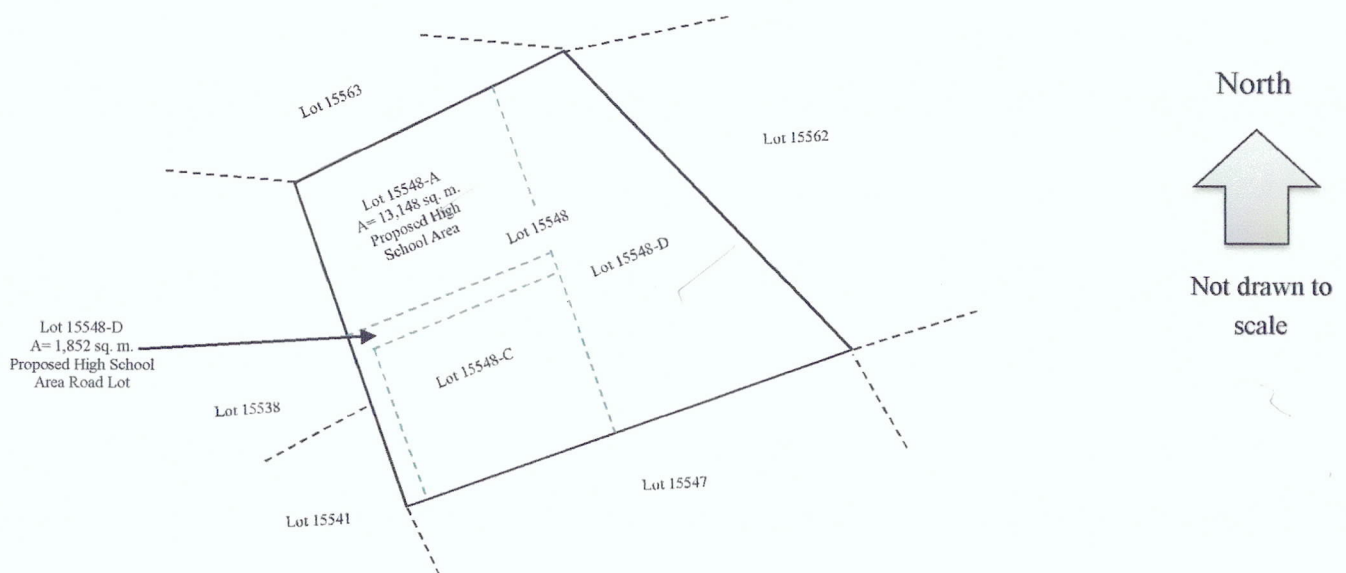

I recommend for the issuance of Survey Clearance and thereafter, the desired Survey Authority over a portion of Lot No. 15548, Cad. 800-D with an area of 15,000 sq. m. more or less located in Bgy. Manalo, Puerto Princesa City in favor of Ubaldo L. Conde High School upon land classification confirmation by the Regional Office wherein the area for **Ubaldo L. Conde High School contains an approximate area of 13,148 sq. m.** while the area for **High School road lot contains an approximate area of 1,852 sq. m.** which was requested to be named as **Ubaldo Conde Road**. Attached are the geo tagged photographs of the subject lot.

Christyl Pops B. Maningas
CHRISTYL POPPS B. MANINGAS
 Special Investigator I

SUBSCRIBED AND SWORN to before me on the above stated date at DENR-CENRO Puerto Princesa City.

Mildred A. Pascual
MILDRED A. PASCUAL
 LMO II/Chief, RPS

Geo-tagged photographs over a portion of Lot No. 15548, Cad. 800-D
located in Bgy. Manalo, Puerto Princesa City







Republic of the Philippines
Department of Environment and Natural Resources
COMMUNITY ENVIRONMENT AND NATURAL RESOURCES OFFICE
PUERTO PRINCESA CITY
South National Highway, Bgy. Sta. Monica Puerto Princesa City
Email Address: cenropuertoprincesa@denr.gov.ph
Tel. Fax No.: (048) 433-0660

July 15, 2021

SUBJECT: SPECIAL PATENT APPLICATION OF UBALDO L. CONDE HIGH SCHOOL

Mr. Wayne A. Socrates
Head Teacher I
Ubaldo L. Conde High School (ULCHS)
Bgy. Manalo, Puerto Princesa City
Contact No. 0945-447-5876 / 0963-514-5362

Received by:
SEP 16, 2021
Wayne A. Socrates
Head Teacher I

Dear Sir Socrates,

Environmental greetings!

This pertains to your letter dated April 19, 2021 which was received by this Office on May 19, 2021 regarding your intention to apply for a Special Patent in the name of Ubaldo L. Conde High School (ULCHS) involving a portion of Lot No. 15548, Cad. 800-D with an approximate area of 15,000 square meters located in Bgy. Manalo, Puerto Princesa City.

Per certification dated June 14, 2021, verification from the records of this Office show that Lot No. 15548, Cad. 800-D with an area of 42,564 square meters has no listed claimant/application as of the date of issuance of the said certification.

Furthermore, per certification dated June 28, 2021 issued by this Office, Lot No. 15548, Cad. 800-D has been verified to be within Alienable and Disposable Area per approved Land Classification Map No. 1246, Project No. 1-E, Block I, certified on January 11, 2019.

Relative thereto, this Office would like to conduct an **ocular inspection/investigation** over the subject area on September 16, 2021.

Should you have any concern, you may contact Special Investigator I – Christyl Pops B. Maningas at mobile no. 0917-770-0403 or this Office at landline no. 433-0660.

Thank you and we trust that you are properly informed.

We trust that you are properly informed.

Very truly yours,

PEDRO A. VELASCO
DMO-IV/In-charge, CENRO Puerto Princesa

cc: CENRO/File
DRN-2021-2309/RPS/*cpbm

DENR MIMAROPA REGION
CENRO PUERTO PRINCESA
RELEASED
NO. 0375
DATE: 7/26/21
BY: [Signature]

CERTIFIED PHOTOCOPY

[Signature]
NOVABILLE B. GARCELLANO-VITERBI
ADMINISTRATIVE OFFICER I/RECORDS OFFICER



Republic of the Philippines
Department of Education
DIVISION OF PUERTO PRINCESA CITY

Office of the School Head

April 19, 2021

FELIZARDO B. CAYATOC
OIC-CENRO
Puerto Princesa City

Sir:

Greetings in Christ's peerless name!

The undersigned would like to request for ocular inspection of **UBALDO L. CONDE HIGH SCHOOL** for the issuance of school site special patent at your most convenient time.

I am hoping for your utmost concern and appropriate action.

Thank you and God bless.

Respectfully yours,

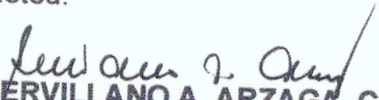

WAYNE A. SOCRATES
Head Teacher I

Noted:

SERVILLANO A. ARZAGA, CESO V
Schools Division Superintendent

UBALDO L. CONDE HIGH SCHOOL (ULCHS)
Bgy. Manalo, City of Puerto Princesa
LRN # 300400/09485699429

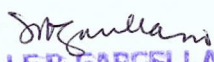
CERTIFIED PHOTOCOPI

NOVABELLE B. GARCELLANO-VITERBO
ADMINISTRATIVE OFFICER I/RECORDS OFFICER I





Republic of the Philippines
Department of Environment and Natural Resources
COMMUNITY ENVIRONMENT AND NATURAL RESOURCES OFFICE
PUERTO PRINCESA CITY
South National Highway, Bgy. Sta. Monica Puerto Princesa City
Email Address: cenropuertoprincesa@denr.gov.ph
Tel. Fax No.: (048) 433-0660

September 2, 2021

SUBJECT: REQUEST FOR SPECIAL PATENT OF UBALDO L. CONDE HIGH SCHOOL

Mr. Wayne A. Socrates

Head Teacher I, Ubaldo L. Conde High School (ULCHS)
Bgy. Manalo, Puerto Princesa City
Contact No. 0945-447-5876 / 0963-514-5362

Dear Sir Socrates,

Environmental greetings! This pertains to your letter dated April 19, 2021 which was received by this Office on May 19, 2021 regarding your intention to apply for a Special Patent in the name of Ubaldo L. Conde High School (ULCHS) involving a **portion of Lot No. 15548, Cad. 800-D** with an approximate area of 15,000 square meters located in Bgy. Manalo, Puerto Princesa City.

Verification from the records of this Office show that Lot No. 15548, Cad. 800-D with an area of 42,564 square meters has no listed claimant/application as of the date of issuance of the said certification. Furthermore, the subject lot has been verified to be within Alienable and Disposable Area per approved Land Classification Map No. 1246, Project No. 1-E, Block I, certified on January 11, 2019.

In order to segregate the said portion of the land which is occupied by the said School from Lot No. 15548, Cad. 800-D, a letter of intent requesting for issuance of Survey Authority (SA) subject for Special Patent Application indicating the name of your choice of Geodetic Engineer signed by the School Superintendent is necessary to be filed to this Office first.

Further, please comply the following required documents in support to the said request for issuance of Survey Authority, to wit:

1. Certified copy of the Deed of Donation from the donor;
2. Latest tax declaration duly certified by the City Assessor, if applicable;
3. Land Registration Authority and Regional Trial Court Clearances, (letter to be provided by this Office);
4. Notarized Barangay Certification of the school's actual residence, issued by the Barangay Chairperson;
5. Sworn Affidavit of two (2) disinterested persons (residents of the same barangay where the lot is located), attesting that the school is the actual occupant or possessor of the lot; and
6. Any government-issued identification card (requesting party).

Be informed that the aforementioned documents will be submitted to the DENR Regional Office for issuance of clearance to issue Survey Authority (SA) by this Office and confirmation of the land classification status of the said land pursuant to DMC 2019-10.

Thank you and we trust that you are properly informed.

Very truly yours,

CERTIFIED PHOTOCOPY

FELIZARDO B. CAYATOC
OIC-CENRO

cc: CENRO/File
DRN-2021-2309/RPS/*cpbm

DENR MIMAROPA REGION
CENRO PUERTO PRINCESA
RELEASED
NO. 5130
DATE: 9/10/21
BY: [Signature]

NOVA BILLE B. GARCELLANO-VITERBI
ADMINISTRATIVE OFFICER I/RECORDS OFFICE



Republic of the Philippines
Department of Environment and Natural Resources
COMMUNITY ENVIRONMENT AND NATURAL RESOURCES OFFICE
PUERTO PRINCESA CITY
South National Highway, Bgy. Sta. Monica Puerto Princesa City
Email Address: cenropuertoprincesa@denr.gov.ph
Tel. Fax No.: (048) 433-0660



February 9, 2022

SUBJECT: LETTER DATED JAN. 31, 2022 FROM ASST. SDS LOIDA PALAY-ADORNADO REQUESTING FOR SURVEY AUTHORITY OVER LOT NO. 15548, CAD. 800-D OCCUPIED BY UBALDO L. CONDE HIGH SCHOOL LOCATED IN BGY. MANALO, PUERTO PRINCESA CITY

Loida Palay-Adornado, Ph.D., CESO VI

Asst. Schools Division Superintendent
Officer-In-Charge, Office of the Schools Division Superintendent
Department of Education – Division of Puerto Princesa
Bgy. Sta. Monica, Puerto Princesa City

Dear Ma'am Adornado,

Environmental greetings! This pertains to your letter dated January 31, 2022 which was received by this Office on February 3, 2022 requesting for issuance of Survey Authority over a portion of Lot No. 15548, Cad. 800-D being occupied by Ubaldo L. Conde High School located in Bgy. Manalo, Puerto Princesa City subject for filing of Special Patent Application.

In order to segregate the said portion of the land which is occupied by the said School from Lot No. 15548, Cad. 800-D, please comply the following required documents in support to your letter request for issuance of Survey Authority, to wit:

1. Certified copy of the Deed of Donation from the donor, if applicable;
2. Latest tax declaration duly certified by the City Assessor, if applicable;
3. Land Registration Authority and Regional Trial Court Clearances, (letter to be provided by this Office);
4. Notarized Barangay Certification of the school's actual residence, issued by the Barangay Chairperson;
5. Sworn Affidavit of two (2) disinterested persons (residents of the same barangay where the lot is located), attesting that the school is the actual occupant or possessor of the lot; and
6. Any government-issued identification card (requesting party).

Be informed that the aforementioned documents will be submitted to the DENR Regional Office for issuance of clearance to issue Survey Authority (SA) by this Office and confirmation of the land classification status of the said land pursuant to DMC 2019-10.

Thank you and we trust that you are properly informed.

Very truly yours,

"For and in the absence of the CENRO:"

RODNEY G. VERIAN
Forester III/Chief, MES/ODMO
Office-In-Charge

cc: Mr. Wayne A. Socrates
Head Teacher I, Ubaldo L. Conde High School (ULCHS)
Bgy. Manalo, Puerto Princesa City
Contact No. 0945-447-5876 / 0963-514-5362

CENRO/File
DRN-2022-0362/RPS/*cpbm

2/15/22

DENR REGIONAL OFFICE
CE-150 PUERTO PRINCESA
RELEASED
JO:
DATE: 02-15-22
BY: [Signature]

CERTIFIED PHOTOCOPY

[Signature]
NOVA BILLE B. GARCELLANO-VITERBI
ADMINISTRATIVE OFFICER I/RECORDS OFFICE



Republic of the Philippines
Department of Education
MIMAROPA REGION
SCHOOLS DIVISION OF PUERTO PRINCESA CITY

Office of the Schools Division Superintendent
31 January 2022

Department of Environment and Natural Resources
City Environment and National Resources Office
Puerto Princesa City

Sir/Madam:

Good day and Blessed New Year!

This office respectfully requests that your good office issue a Survey Authority for the portion of land known as Lot 15548, Cad 800-D (portion thereof) that is currently occupied by **Ubaldo L. Conde High School** in Barangay Manalo, Puerto Princesa City.

Relative thereto, the undersigned would like to endorse a Geodetic Engineer, namely, **Engr. Cristopher C. Caimoy**, a private practitioner, to conduct a survey on the specified portion of lot.

Thank you and warm regards.

Very truly yours,

LOIDA PALAY-ADORNADO, Ph.D, CESO VI
Assistant Schools Division Superintendent
Officer In-Charge, Office of the Schools Division Superintendent
Department of Education – Division of Puerto Princesa

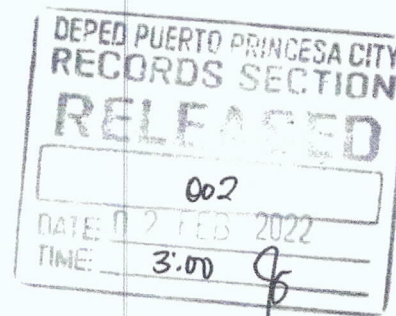
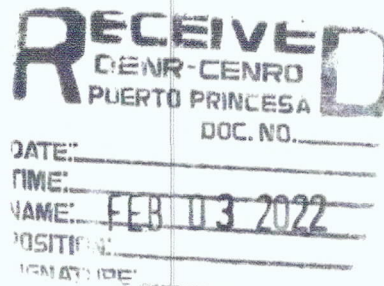

Gov't. Center, City DepEd Bdg., Rafols Rd., Brgy. Santa Monica, Puerto Princesa City
SDS +639171241790 | OSDS (048) 434-2189 | CID (048) 434-5343 | SGOD +639171347828 | HR (048) 716-1789
puertoprincesa@depd.gov.ph
DepEd Tayo Puerto Princesa City
<https://depdpuertoprincesa.ph>

CERTIFIED PHOTOCOPY

NOVABELLE B. GARCELLANO-VITERI
ADMINISTRATIVE OFFICER I/RECORDS OFFICER



CERTIFICATION

TO WHOM IT MAY CONCERN:

THIS IS TO CERTIFY that based on our records, the tract of land located in Barangay Manalo, Puerto Princesa City, Palawan containing an area of 42,564 square meters identified as **Lot No. 15548, Cad. 800-D** was verified to be within **Alienable and Disposable Land** per approved Land Classification Map No. 1246, Project No. 1-E, Block-I, certified on January 15, 1936.

This certification is subject to confirmation by DENR MIMAROPA Regional Office pursuant to DMC No. 2019-10 dated December 11, 2019.

Issued this 27th day of September 2022 at CENRO Puerto Princesa City.

Checked and verified by:

JASON D. MONTIMOR
Forester I
Unit Head, GIS
& Land Classification Verification

Approved by:

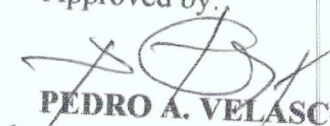

PEDRO A. VELASCO
Development Management Officer IV
OIC-CENRO

Certification fee: P50.00
Oath fee: P36.00
O.R. No. _____
Date: _____

South National Highway, Bgy. Sta. Monica, Puerto Princesa City
Email Address: cenroppchuc@yahoo.com
Tel Fax No.: (048) 433-0660

LC-DRN-2022/TPG

CERTIFIED PHOTOCOPY

NOVA BILLE B. GARCELLANO-VITERBO
ADMINISTRATIVE OFFICER I/RECORDS OFFICE



Republic of the Philippines
Department of Environment and Natural Resources
Region IV- B, MIMAROPA
COMMUNITY ENVIRONMENT AND NATURAL RESOURCES OFFICE

CERTIFICATION

TO WHOM IT MAY CONCERN

This is to certify that based on the allocation book of this Office, Lot No. 15548, Cad. 800-D containing an area of 42,564 square meters located in Barangay Manalo, Puerto Princesa City Palawan has no listed claimant/application filed in this Office as of this date.

Issued this 14th day of June 2021 at CENRO, Puerto Princesa City, Palawan.

CHELSEA A. DALINO
Administrative Aide VI / In-Charge, Records Section

Attested by:

RODNEY G. VERIAN
Forester III/Chief, MES
In-Charge, Office of the CENRO

DENR MIMAROPA REGION
CENRO PUERTO PRINCESA
RELEASED
NO: 3680
DATE: 6/14/2021
BY: [Signature]

South National Highway,
Bgy. Sta. Monica Puerto Princesa City
Email Address: cenropuertoprincesa@denr.gov.ph
Tel. Fax No.: (048) 433-0660

CERTIFIED PHOTOCOPY

NOVABILLE B. GARCELLANO-VITERO
ADMINISTRATIVE OFFICER I/RECORDS OFFICER I



Republic of the Philippines
Department of Environment and Natural Resources
COMMUNITY ENVIRONMENT AND NATURAL RESOURCES OFFICE
PUERTO PRINCESA CITY
South National Highway, Bgy. Sta. Monica Puerto Princesa City
Email Address: cenropuertoprincesa@denr.gov.ph
Tel. Fax No.: (048) 433-0660

APPLICATION FOR SPECIAL PATENT OF UBALDO L. CONDE HIGH SCHOOL

ATTENDANCE SHEET
Bgy. Manalo, Puerto Princesa City
September 16, 2021

No.	Name	Agency/Complete Address	Contact No.	Signature
1	Wayne A. Sorantes	UBALDO L. CONDE HIGH SCHOOL	09454475876	
2	JONATHAN C. CONDE	LGO MANALO	09294524164	
3	BERNARDO COJAMCO	BGY. TANOD MANALO		
4	Mildred C. Ampar	Bgy. Manalo		
5				
6				
7				
8				
9				
10				
11				
12				
13				
14				
15				
16				
17				
18				
19				
20				

CERTIFIED PHOTOCOPY

Signature
NOVA BILLE B. GARCELLANO-VITERBI
ADMINISTRATIVE OFFICER / RECORDS OFFICER



Republic of the Philippines
Department of Education
DIVISION OF PUERTO PRINCESA CITY

KASAYSAYAN NG UBALDO L. CONDE HIGH SCHOOL

Ang Ubaldo L. Conde High School ay matatagpuan sa Brgy. Manalo, Lungsod ng Puerto Princesa. Ito ay may sukat na labinlimang libong metro kwadrado (15,000sq.m). Ito ay pagmamay-ari nila Ginoong Domingo B. Conde at kanyang maybahay na si Ginang Mildred C. Conde mula sa kanilang bahaging lupang namana sa ama nitong si Ginoong Ubaldo L. Conde. Sa kagandahang-loob ng pamilya ay nagdesisyon silang ibahagi ito sa mga mamamayan ng Brgy. Manalo upang tayuan ng paaralang pang-sekondarya na makatutulong sa edukasyon ng mga mag-aaral sa naturang barangay noong Abril 20, 2015.

Ang pagtatayo ng paaralang ito ay napagkasunduan ng mga mamamayan nito sa pamamagitan ng pamumuno ni Hon. Emily B. Eleazar, punong barangay kasama ng konseho ng Bgy. Manalo. Kaugnay nito, ang lokal na pamahalaan ng lungsod ng Puerto Princesa ay malaki rin ang naiambag sa pagkakatatag ng paaralan kasabay ng isang resolusyon na magbibigay ng sapat na pondo upang makapagpagawa ng bagong gusali na mayroong tatlong silid aralan noong Abril 21, 2016. Ang pangunahing layuning ng pagtatayo ng nasabing gusali ay upang bigyan ng magandang edukasyon ang mga mag-aaral sa pamamagitan ng maganda at maayos na gusali. Noong taong 2019 Nagkaroon ng karagdagang gusali na mayroong dalawang silid aralan na nagmula sa proyekto ni Cong. Gil Acosta Jr.

Nagsimula ang paaralang ito na mayroon lamang animnapu't dalawang (62) mag-aaral sa ikapitong baitang (Grade 7) at limampu't dalawang (52) mag-aaral sa ikawalong baitang (Grade 8) noong Hunyo 2015. Si Ginoong Percival U. De Guzman ang nagsilbi bilang OIC (Officer in-Charge) at si Ginang Sherley C. Cabrana bilang bahagi ng lupon ng mga guro ng paaralan.

Sa unti-unting pagpapabuti sa paaralan ay unti-unti ring lumago ang bilang ng mga mag-aaral nito. Noong SY 2016-2017 ang kabuuang bilang ng mag-aaral ay isangdaan at siyam (109). Noong taong SY 2017-2018, ang kabuuang bilang ng mag-aaral ay umabot sa dalawang daan tatlumput talo (133). Noong namang SY 2018-2019 ay umabot sa dalawang daan talumpot tatlo, para naman sa SY 2019-2020 dalawang daan ta tatlumpo (230), para sa

CERTIFIED PHOTOCOPY

NOVA BILLE B. GARCELLANO-VITERBI
ADMINISTRATIVE OFFICER I/RECORDS OFFICER



Republic of the Philippines
Department of Education
DIVISION OF PUERTO PRINCESA CITY

Sy 2020-2021 ang kabuuang bilang ng mga mag-aaral sa Ubaldo L. Conde High School ay umabot sa dalawang daan at limanput tatlo (253).

Noong taong 2018-2020 si Ginang Merlinda A. Trance ang humalili bilang OIC (Officer In-Charge) kasama ang anim na guro. Noong taong 2020 naman ay may karagdagang dalawang guro sa paaralan. Noong November 9, 2020 ay si Ginoong Wayne A. Socrates ang humalili bilang Head Teacher I ng paaralan hanggang sa kasalukuyan.

Mula sa biyaya at pagpapala ng Panginoong Hesus, ang paaralan katuwang ang mga guro, konseho ng barangay sa pangunguna ni Hon. Lorna E. Delarosa at ng DepEd sa pamumuno ni Ginoong Servillano A. Arzaga CESO V, ay patuloy na nagsisikap upang maihatid ang kalidad at mahusay na edukasyon sa mga mag-aaral ng Ubaldo L. Conde High School.

Inihanda ni

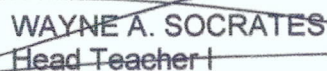
WAYNE A. SOCRATES
Head Teacher I

Pagpapatunay;

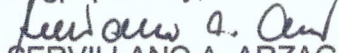
SERVILLANO A. ARZAGA CESO V
Schools Division Superintendent

CERTIFIED PHOTOCOPY

NOVA BILLE B. GARCELLANO-VITERBI
ADMINISTRATIVE OFFICER I / RECORDS OFFICER I

WAIVER OF RIGHTS

KNOW ALL MEN BY THESE PRESENTS:

This **WAIVER OF RIGHTS** was made and entered into by and between:

DOMINGO B. CONDE, of legal age, married to Mildred G. Conde, Filipino and a resident of Barangay Manalo, Puerto Princesa City, hereinafter referred to as the **WAIVOR**;

- and -

The **DEPARTMENT OF EDUCATION-CITY SCHOOLS DIVISION OF PUERTO PRINCESA CITY**, represented herein by its incumbent City Schools Division Superintendent, **DR. ELSIE T. BARRIOS**, of legal age, married, Filipino and with office address at City DepEd Bldg., Sta. Monica, Puerto Princesa City, hereinafter referred to as the **WAVEE**.

WITNESSETH:

That the **WAIVOR** is the lawful claimant, actual possessor, and the legitimate son and heir of late UBALDO L. CONDE of certain parcels of land to be waived in favor of the **DEPARTMENT OF EDUCATION-CITY SCHOOLS DIVISION OF PUERTO PRINCESA CITY**, out of his share from the NINETY THOUSAND (90,000) SQUARE METERS, more or less, real properties owned by his late father UBALDO L. CONDE, more particularly described below as follows:

Lot 15548-A, Psd-04-

A parcel of land (Lot 15548-A of the subdivision plan, Psd-04- ____, being a portion of Lot 15548-CAD-800-D), situated in the Barangay of Manalo, City of Puerto Princesa, Province of Palawan, Island of Palawan. Bounded on the SE., along line 1-2 by Lot 15548-D, Cad-800-D; on the SW., along line 2-3 by Lot 15538, CAD-800-D; on the NW., along line 3-4 by Lot 15563, CAD-800-D; and on the NE., along line 4-1 by Lot 15548-B, Cad-800-D. Beginning at a point marked "1" on plan, being S. 06 deg. 21'E., 75,482.27 m. from BLLM No. 1, CAD-800-D, Puerto Princesa Cadastre;

thence S. 58 deg. 55'W.,	107.84 m. to point 2;
thence N. 28 deg. 40'W.,	101.39 m. to point 3;
thence N. 38 deg. 18'E.,	117.08 m. to point 4;
thence S. 28 deg. 40'E.,	142.66 m. to point of the beginning.

Containing an area of **THIRTEEN THOUSAND ONE HUNDRED FORTY EIGHT (13,148) SQUARE METERS**, more or less.

CERTIFIED PHOTOCOPY

CERTIFIED TRUE COPY OF THE ORIGINAL

DATE: 26 Oct. 2021

OTTV RICHARD S. LIPARDO, 14/6/21

NOVABILLE B. GARCELLANO-VITERB
ADMINISTRATIVE OFFICER / RECORDS OFFICER

Waiver of Rights/page two (02)

Lot 15548-D, Psd-04-

A parcel of land (Lot 15548-D of the subdivision plan, Psd-04- ____, being a portion of Lot 15548-CAD-800-D), situated in the Barangay of Manalo, City of Puerto Princesa, Province of Palawan, Island of Palawan. Bounded on the SE., & NE., along lines 1-2-3 by Lot 15548-C, Cad-800-D; on the SE., along line 3-4 by Lot 165, Pls-597; on the SW., along line 4-5 by Lot 15907, Cad-800-D; on the SW., along line 5-6 by Lot 15538, CAD-800-D; on the NW., along line 6-7 by Lot 15548-A, CAD-800-D; and on the NE., along line 7-1 by Lot 15548-B, Cad-800-D. Beginning at a point marked "1" on plan, being S. 206 deg. 22'E., 75,491.53 m. from BLLM No. 1, CAD-800-D, Puerto Princesa Cadastre;

thence S. 58 deg. 55'W., 97.83 m. to point 2;
thence S. 28 deg. 40'E., 77.38 m. to point 3;
thence S. 58 deg. 55'E., 10.01 m. to point 4;
thence N. 28 deg. 40'W., 77.66 m. to point 2;
thence N. 28 deg. 40'W., 9.73 m. to point 3;
thence N. 58 deg. 55'E., 107.84 m. to point 4;
thence S. 28 deg. 40'E., 10.01 m. to point of the beginning.

Containing an area of **ONE THOUSAND EIGHT HUNDRED FIFTY TWO (1,852) SQUARE METERS, more or less.**

That in view of my strong desire to support the plans and projects of the Department of Education-City Schools Division of Puerto Princesa City, I am voluntarily waiving all my rights and interests over the above described real properties for the construction of barangay high school and its access road from the National Highway to the proposed barangay high school in Barangay Manalo, this City;

That WAIVOR hereby requests from the WAIVEE that the aforementioned real properties subject of this WAIVER OF RIGHTS be thereafter named **UBALDO CONDE BARANGAY HIGH SCHOOL** and **UBALDO CONDE ROAD** in honor of their late father, **UBALDO L. CONDE**.

That I hereby warrant unto the WAIVEE full ownership/rights over the above-described parcels of land free from lien and encumbrances of any kind whatsoever;

That I am voluntarily executing this Waiver of Rights to attest to the truthfulness and veracity of my above statements and to comply with the requirements of the law.

IN WITNESS WHEREOF, the **WAIVOR** and the **WAIVEE** have hereunto set their hands this _____ in the City of Puerto Princesa.

DOMINGO B. CONDE
WAIVOR

TIN NO. 141-175-040

Issued by: BIR, Puerto Princesa City

With my marital consent:

MILDRED C. CONDE
Wife

TIN No. 140-913-306

Issued By: BIR, PPCity

CERTIFIED TRUE COPY OF THE ORIGINAL
DATE: 24 OCT-2021

ATTY RICHARDER GOLFARDO, JRC

CERTIFIED PHOTOCOPY

NOVA BILLE E. GARCELLANO-VITERBO
ADMINISTRATIVE OFFICER I/RECORDS OFFICER I

Waiver of Rights/page three (03)

DEPARTMENT OF EDUCATION
CITY SCHOOLS DIVISION-PUERTO PRINCESA CITY
WAIVEE

Represented by:

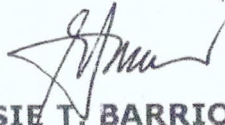

DR. ELSIE T. BARRIOS, Ph.D.
City Schools Division Superintendent

SIGNED IN THE PRESENCE OF:



CASTRO L. PACDAAN



PERCIVAL DE GUZMAN

ACKNOWLEDGMENT

REPUBLIC OF THE PHILIPPINES)
CITY OF PUERTO PRINCESA) S. S.

BEFORE ME, a Notary Public for and in the City of Puerto Princesa came and personally appeared **DOMINGO B. CONDE**, with his Tax Identification Card No. 141-175-040, issued at Puerto Princesa City, and **DR. ELSIE T. BARRIOS**, with her Office ID No. _____, issued on _____ by the Department of Education, Manila, both known to me and to me known to be the same persons who executed the foregoing WAIVER OF RIGHTS, and they acknowledged to me that the same is their free and voluntary act and deed.

IN WITNESS WHEREOF, we have hereunto set our hands this
APR 20 2015 in the City of Puerto Princesa.



ATTY. RICKANDER COLIFARDO JAGMIS

Notary Public
Until December 31, 2015

Bar No. 57498

ICR No. 095001

PTB No. 3556798

MCLE Compliance No. IV-0013255

COC. NO. 83
PAGE NO. 18
BOOK NO. 6
SERIES OF 2015

CERTIFIED TRUE COPY OF THE ORIGINAL
DATE: 26-04-2015



ATTY. RICKANDER COLIFARDO JAGMIS

CERTIFIED PHOTOCOPY



NOVA BILLE B. GARCELLANO-VITERBO
ADMINISTRATIVE OFFICER I/RECORDS OFFICER

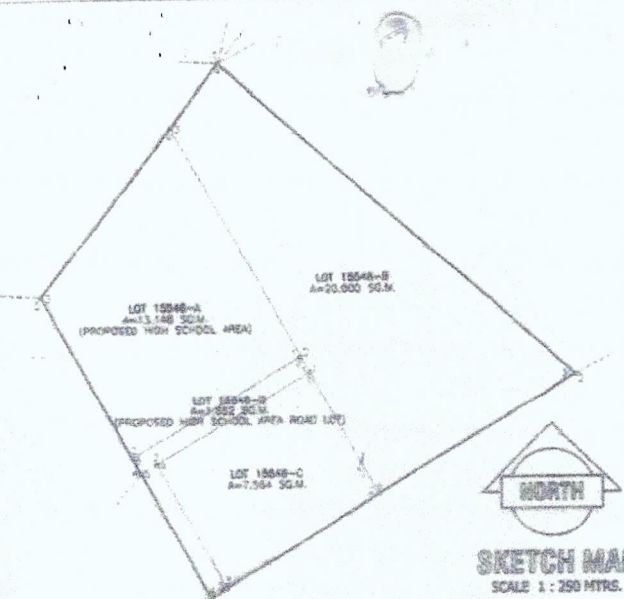

TECHNICAL DESCRIPTION		
LINES	BEARINGS	DISTANCES
Lot 15548		
1-2	S.48°18'E.	256.53M.
2-3	S.58°55'W.	233.83M.
3-4	N.28°40'W.	77.66M.
4-5	N.28°40'W.	111.12M.
5-1	N.38°18'E.	160.21M.
Lot 15548-A		
1-2	S.58°55'W.	107.84M.
2-3	N.28°40'W.	101.39M.
3-4	N.38°18'E.	117.08M.
4-1	S.28°40'E.	142.66M.

Lot 15548-B		
1-2	N.28°40'W.	10.01
2-3	N.28°40'W.	142.66
3-4	N.38°18'E.	43.13
4-5	S.48°18'E.	256.53
5-6	S.58°55'W.	125.98
6-1	N.28°40'W.	77.38
Lot 15548-C		
1-2	S.28°40'E.	77.38
2-3	S.58°55'W.	97.84
3-4	N.28°40'W.	77.38
4-1	N.58°55'E.	97.83

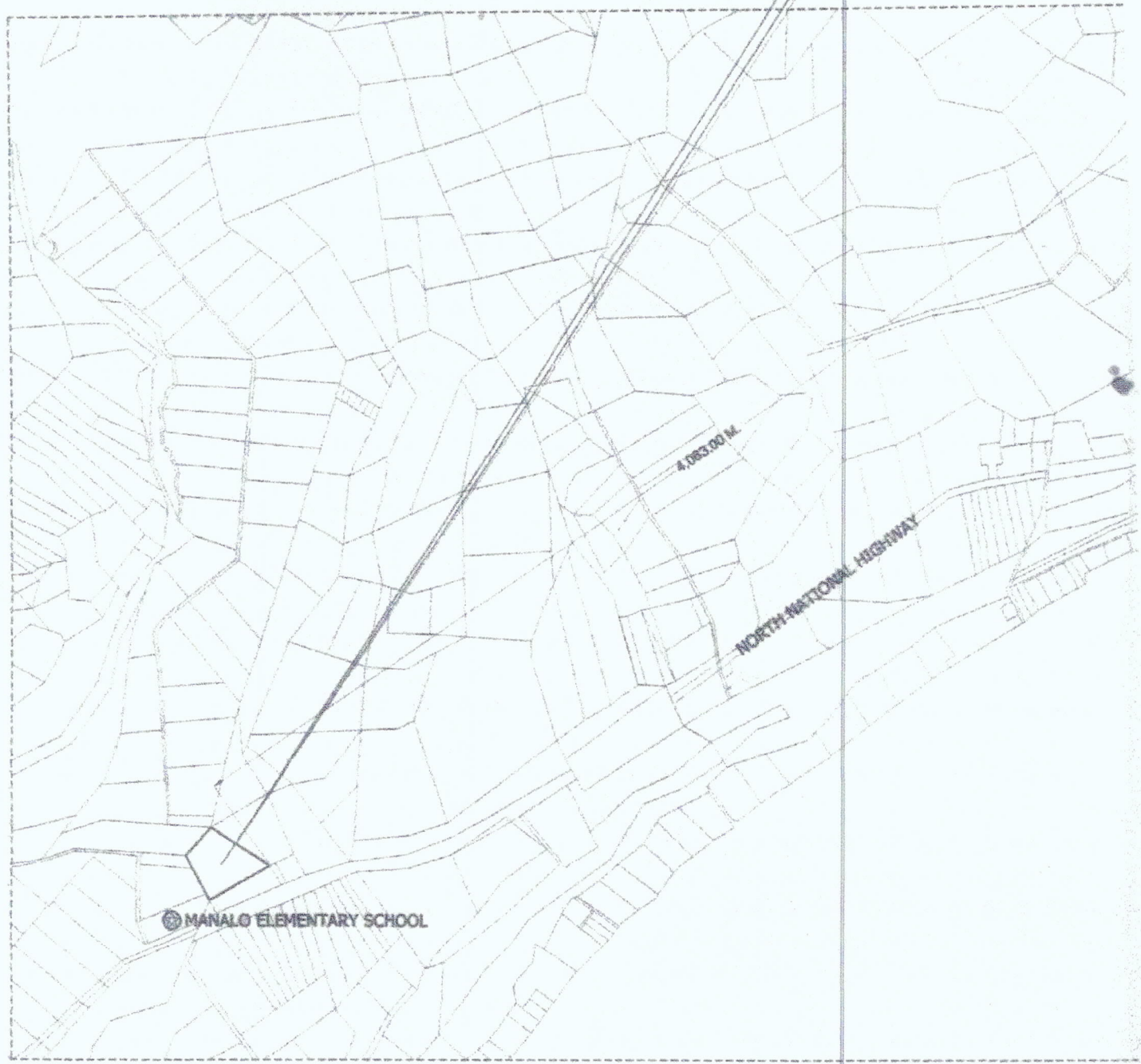

THIS SITE

CERTIFIED PHOTOCOPY

Signature
 NOVA BILLE B. GARCELLANO-VITERB
 ADMINISTRATIVE OFFICER I/RECORDS OFFICER

Republic of the Philippines
REGIONAL TRIAL COURT
Fourth Judicial Region
Puerto Princesa City

OFFICE OF THE CLERK OF COURT
Hall of Justice, Bgy. Sta. Monica, Puerto Princesa City

CERTIFICATION

TO WHOM IT MAY CONCERN:

THIS IS TO CERTIFY that this Office has no record of a pending land registration case before any branches of this court involving applicant Ubalde L. Conde High School covering Lot No. 15548, Cad 800-D located at Barangay Manalo, Puerto Princesa City, Palawan.

This Certification is being issued upon the request of Rodney G. Verian for survey authority.

At Puerto Princesa City, this 4th day of May 2022.

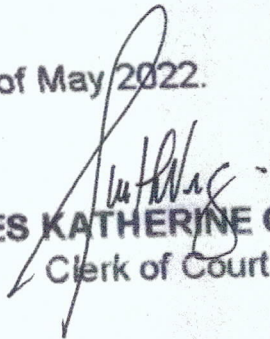
PRINCES KATHERINE C. VERGARA
Clerk of Court V

Cert. Fee: P15.00/35.00/10.00
O.R. No. 8779149/ 8779529/3298898
Dated: May 4, 2022

zm

CERTIFIED PHOTOCOPY

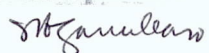
NOVA BILLE B. GARCELLANO-VITERBO
ADMINISTRATIVE OFFICER I/RECORDS OFFICER



REPUBLIKA NG PILIPINAS
KAGAWARAN NG KATARUNGAN
PANGASIWAAN SA PATALAAN NG LUPAIN
(LAND REGISTRATION AUTHORITY)

East Avenue cor. NIA Road
Quezon City
Registry of Deeds for Puerto Princesa City

CERTIFICATION

TO WHOM IT MAY CONCERN :

This is to certify that after research and verification of this Registry records as of this date, no property can be located in the name/s of the following:

UBALDO CONDE

This certification is being issued upon request of Mr/Ms. Mildred Conde for whatever legal purpose it may serve best.

Issued at Puerto Princesa City, this 19 December 2016.

Imelda Blanco Publico
Records Officer

CERTIFIED PHOTOCOPY

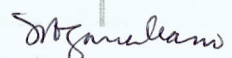
NOVA BILLE B. GARCELLANO-VITERBO
ADMINISTRATIVE OFFICER I/RECORDS OFFICER I

REPUBLIC OF THE PHILIPPINES)
PALAWAN, PUERTO PRINCESA CITY) S.S.

JOINT AFFIDAVIT OF TWO
DISINTERESTED PERSONS

WE, **ROMANO MANLAVI PACDAAN** and **IVANN GEORGE PADUGA POLIZON** both Filipinos, both of legal age, both residents of Brgy. Manalo, Puerto Princesa City, after having duly sworn on oath in accordance with law hereby depose and say that;

We are residents of Brgy. Manalo, Puerto Princesa City for more or less twenty (27) years to date.

We have personal knowledge that UBALDO L. CONDE HIGH SCHOOL (ULCHS), situated at Purok Centro, Brgy. Manalo, Puerto Princesa City is the actual occupant of a certain lot which where several structures such as classrooms and offices were located.

The lot is identified to be a portion of LOT NO. 15548, CAD-800-D with an approximate area of more or less 15,000 square meters.

We also know for a fact that UBALDO L. CONDE HIGH SCHOOL (ULCHS) is applying for the issuance of a Special Patent for that matter.

We attest to the veracity and truthfulness of the foregoing.

IN WITNESS WHEREOF, I have signed the foregoing this June 17, 2022 at Puerto Princesa City.

ROMANO MANLAVI PACDAAN

Affiant

UMID CRN 0113-0922386-2



IVANN GEORGE PADUGA POLIZON

Affiant

P.R.C. REG. NO. 1279425

SUBSCRIBED AND SWORN TO BEFORE ME this June 17, 2022 at Puerto Princesa City, Palawan by affiant who exhibited to me their i.d.'s as above appearing.

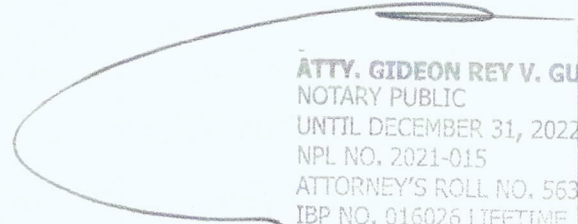
Doc. No. 428
Page No. 87
Book No. 22
Series of 2022

ATTY. GIDEON REY V. GUAYCŌ
NOTARY PUBLIC
UNTIL DECEMBER 31, 2022
NPL NO. 2021-015
ATTORNEY'S ROLL NO. 56394
IBP NO. 016026 LIFETIME
P.T.R. NO. 1630477 01/03/2022
M.C.L.E. Compliance No. VI-0030327

CERTIFIED PHOTOCOPY

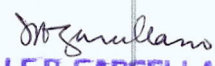
NOVA BILLE B. GARCELLANO-VITERO
ADMINISTRATIVE OFFICER / RECORDS OFFICER



Republic of the Philippines
City of Puerto Princesa
OFFICE OF THE PUNONG BARANGAY
Barangay Manalo



11 Puroks: Bagong Sikat, Baybay I, Baybay II, Cabaeran, Candes, Centro, Durokha, Masagana, Nagkakaisa, Nasidoc, Pinagpapanan

Barangay Manalo, Puerto
Princesa City, Palawan
Barangay Officials



HON. LORNA L. DELA ROSA
Punong Barangay

BARANGAY COUNCILORS:

HON. ANECIA L. NAZON

HON. REX P. BONDON

HON. JONATHAN C. CONDE

HON. BERNARDO P. MAGBANUA JR.

HON. ARTHUR A. FAVILA

HON. VELMOR N. DELA CRUZ

HON. REA M. CAMAYAN

Mr. FREDDIE L. LUCHAVEZ
IPMR

HON. ELAINE B. CONDESA
Sk Chairwoman

LEAH E. ANDOY
Bgy. Secretary

ROBELYN C. SARSADIAZ
Bgy. Treasurer

RECHAEL D. BUSTAMANTE
Bgy. Administrative Assistant

CERTIFICATION

TO WHOM IT MAY CONCERN:

THIS IS TO CERTIFY that **UBALDO L. CONDE**
HIGH SCHOOL owned portion of the land with a Lot
No. 15548, Cad. 800.

This certification is being issued upon
request of **Mr. Wayne A. Socrates (head teacher 1)**
to comply with the requirement of Special Patent of
CENRO or, for whatever legal purpose it may serve
him best.

Issued this 25th day October, 2021 at Barangay
Hall of Barangay Manalo Puerto Princesa City.

HON. LORNA L. DELA ROSA
Punong barangay

SUBSCRIBED AND SWORN to by
Affiant this JUN 17 2022
at Puerto Princesa City, Palawan

Doc. No. 439
Page No. 85
Book No. 202
Series of 2022

ATTY. GIDEON REY V. GUAYCO
NOTARY PUBLIC
UNTIL DECEMBER 31, 2022
NPL NO. 2021-015
ATTORNEY'S ROLL NO. 56394
IBP NO. 016026 LIFETIME
P.T.R. NO. 1630477 01/03/2022
M.C.L.E. Compliance No. VI-0030327

O.R. No. 2014895

Date issued: 10/25/2021

CERTIFIED TRUE COPY

by: **Atty. Gideon Rey V. Guayco**
JUN 17 2022 Puerto Princesa City,
Palawan, Philippines

CERTIFIED PHOTOCOPY

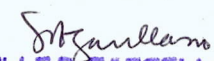
NOVA BILLE B. GARCELLANO-VITERBO
ADMINISTRATIVE OFFICER / RECORDS OFFICER



Republic of the Philippines
CITY OF PUERTO PRINCESA

OFFICE OF THE CITY ASSESSOR

TAX DECLARATION OF REAL PROPERTY



TD No. : **019-10509** Property Identification No. : **134-03-019-13-024**

Owner: **CONDE, UBALDO** TIN: _____

Address: **BGY. MANALO, PUERTO PRINCESA CITY** Telephone No. : _____

Administrator/Beneficial User: _____ TIN: _____

Address: _____ Telephone No. : _____

Location of Property: _____

(Number and Street) **MANALO** (Barangay/District) **PUERTO PRINCESA CITY** (Municipality & Province/City)

OCT/TCT/CLOA No. : _____ Survey No. : **GSS-597/CAD-800-D**

CCT : _____ Lot No. : **167 IDENT. TO 15548**

Date : _____ Blk. No. : _____

Boundaries: North: **001 (LOT 15563)**

East: **021 (LOT 15562)**

South: **023 (LOT 15547)**

West: **002 (LOT 15538), 026 (LOT 15541)**

KIND OF PROPERTY ASSESSED :

☒ LAND

☐ BUILDING

No. of Storeys : _____

Brief Description : _____

☐ MACHINERY Brief Description : _____

☐ OTHERS Brief Description : _____

Classification	Area	Area Type	Market Value	Actual Use	Assessment Level	Assessed Value
AGRICULTURAL	4.256900	HA	187,416.22	AGRICULTURAL	15%	28,112.43
AGRICULTURAL	0.000000	HA	44,200.00	AGRICULTURAL	15%	6,630.00
TOTAL:	4.256900	HA	231,616.22			34,742.43

Total Market Value : _____

P 231,616.22

Total Assessed Value : _____

P 34,740.00

Total Assessed Value

THIRTY FOUR THOUSAND SEVEN HUNDRED FORTY AND 00/100

Taxable ☒ Exempt ☐

Effectivity of Assessment : **2012**

Appraised By: _____

Recommended By: _____

Approved By: _____

(SGD.) ROMEO T. GAID

LAOO II

(SGD.) ENGR. JOVEN C.V. BALUYUT

ASST. CITY ASSESSOR

Date

This declaration cancels TD No. : **019-8065**

Previous Owner : _____

Previous A.V. Php : _____

23160.00

CONDE, UBALDO

CERTIFIED TRUE AND CORRECT
By Authority of the City Assessor

2012

ALMA O. ROMASANTA

LAOO III/ACTING RECORDS OFFICER

Paid Under OR # : 0980655

Date Issued : October 11, 2016

Amount Paid : P 60.00

MEMORANDA: REASSESSED PURSUANT TO CITY ORDINANCE NO. 501.

CERTIFIED TRUE COPY

OFFICE OF THE CITY ASSESSOR
CITY OF PUERTO PRINCESA
October 11, 2016

Requested by: **MILDRED C. CONDE**

Purpose : **whatever legal purposes it may serve him/her**

Note: This declaration is for real property taxation purposes only and the valuation indicated herein are based on the schedule of unit market values prepared for the purpose and duly enacted into an ordinance by the Sangguniang Panlungsod under Ordinance No. 501 dated 2011-11-02. It does not and cannot by itself alone confer any ownership or legal title to the property.

GENERATED BY : ETRACS v2.5 PRINTED BY : REX CYRUS GIMOTEA SALDEVIA PRINT DATE : 2016-10-11 09:13:08

CERTIFIED PHOTOCOPY

NOVABILLER GARCERANO VITERBI
ADMINISTRATIVE OFFICER I/RECORDS OFFICER

NOTE: Road Networks depicted on the map is not a basis for road claims, it is only shown as guide for TAXATION PURPOSES and NOT an ACTUAL SURVEY.

Day Site

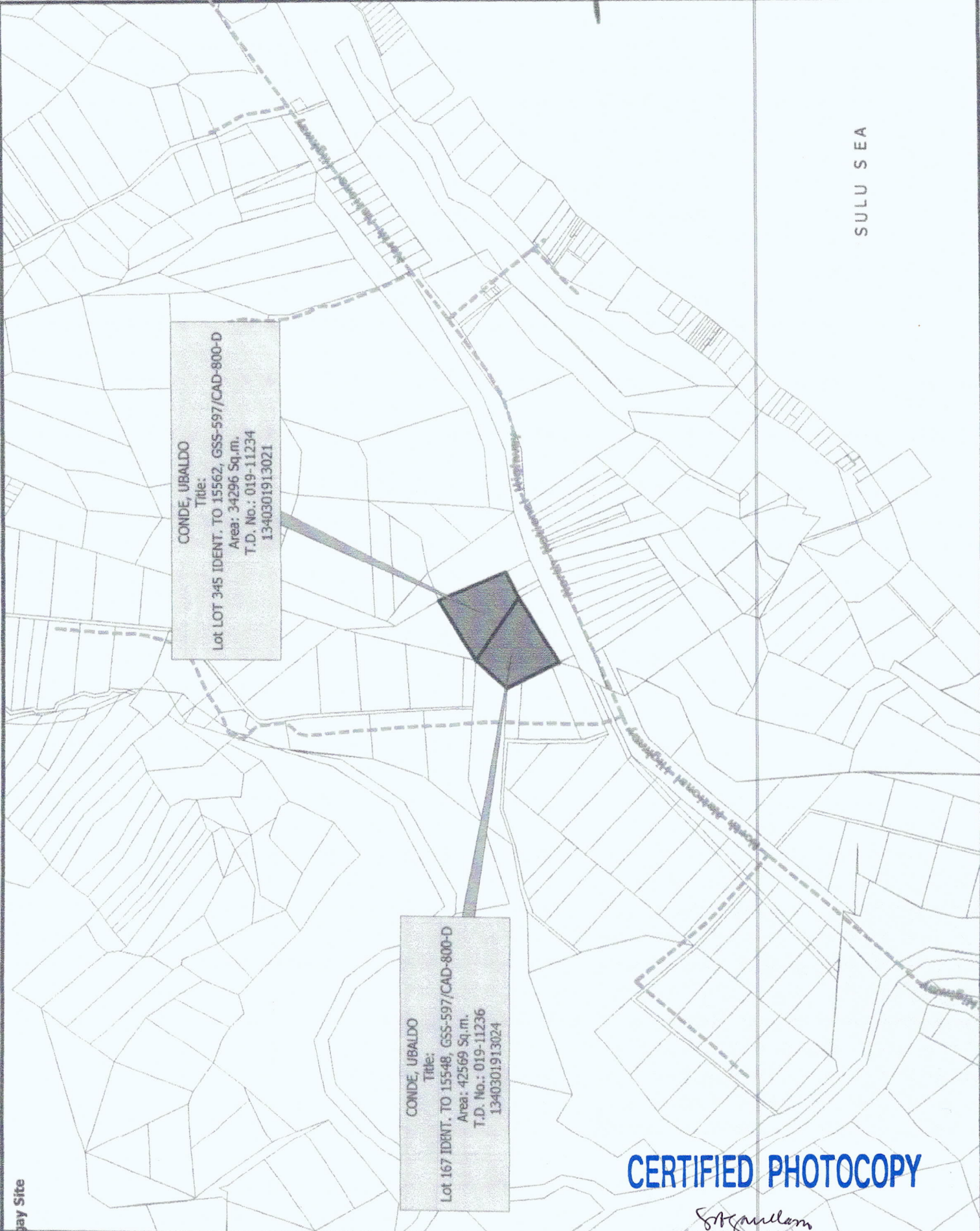

CONDE, UBALDO

Title:

Lot 167 IDENT. TO 15548, GSS-597/CAD-800-D
Area: 425.69 Sq.m.
T.D. No.: 019-11236
1340301913024

CONDE, UBALDO

Title:

Lot LOT 345 IDENT. TO 15562, GSS-597/CAD-800-D
Area: 342.96 Sq.m.
T.D. No.: 019-11234
1340301913021

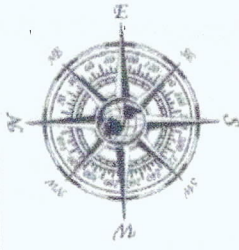

TAXMAP - LOCATION
BARANGAY MANALO
PUERTO PRINCESA CITY
SCALE: [Scale]



OFFICE OF THE ASSESSOR
TAXMAPPING DIVISION
CITY OF PUERTO PRINCESA
CERTIFIED TRUE & CORRECT

[Signature]
TENER JOVEN C.V. BALLYUT
City Assessor

Prepared By:

RYAN V. MACULA
ADMIN AIDE II (COS)

O.R. No.: FOC

Amount Paid: Php 0.00

Date: 9/28/2021

Time: 4:00:19 PM

1/1

FOR OFFICIAL USE PURPOSES

Documents Presented:

☐ SPA

☐ Proof of Interest

☐ Authorization

☐ NONE

REMARKS

This Map is for

TAXATION and ASSESSMENT

Purposes ONLY

SULU SEA

CERTIFIED PHOTOCOPY

[Signature]
JOVILLA B. GARCELLANO-VITERO
ADMINISTRATIVE OFFICER I/RECORDS OFFICE

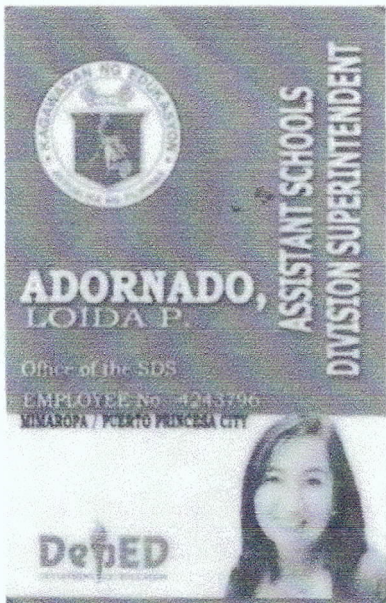

LOIDA PALAY-ADORNADO, PhD, CESO VI
Assistant Schools Division Superintendent
Officer-in-Charge
Office of the Schools Division Superintendent

FORM 0016 (REvised, 2014)

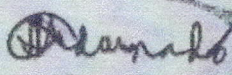
COMMUNITY TAX CERTIFICATE		INDIVIDUAL	CCI2019 13160366
YEAR 20 21	PLACE OF ISSUE (City/Municipality) Puerto Princesa City	DATE ISSUED 01 15 2021	
NAME (SURNAME) Adornado		(FIRST) Loida	(MIDDLE) P.
ADDRESS Bgy. San Miguel, PPC			
CITIZENSHIP Fil	ICR NO. (if an Alien)	PLACE OF BIRTH Roxas, Pal	SEX <input type="checkbox"/> MALE <input checked="" type="checkbox"/> FEMALE
CIVIL STATUS <input checked="" type="checkbox"/> Married	<input type="checkbox"/> Single <input type="checkbox"/> Widowed (Widower) <input type="checkbox"/> Legally Separated <input type="checkbox"/> Divorced	HEIGHT 5'1	WEIGHT 58 kgs
PROFESSION / OCCUPATION / BUSINESS		TAXPAYER'S AMOUNT P 5.00	COMMUNITY TAX DUE P 5.00
A. BASIC COMMUNITY TAX (P5.00) (Voluntary or Exempted (P1.00))			
B. ADDITIONAL COMMUNITY TAX (Tax not to exceed P5,000.00)			
1. GROSS PROFITS OR EARNINGS DERIVED FROM BUSINESS DURING PRECEDING YEAR (P1.00 for every P1,000.00)			
2. SALARIES OR GROSS RECEIPT OR EARNINGS DERIVED FROM EXERCISE OF PROFESSION OR PURSUIT OF ANY OCCUPATION (P1.00 for every P2,000.00)			1160.00
3. INCOME FROM REAL PROPERTY (P1.00 for every P1,000.00)			
Right Thumb Print	TAXPAYER'S SIGNATURE  MYLENE Q. HERRERA BGY. TREASURER MARIA LUNA L. ADAYAN CITY TREASURER	TOTAL P 1165.00	INTEREST
		TOTAL AMOUNT PAID P 1,165.00	

DOP: 05.08.2019

One thousand one hundred and sixty five pesos

CERTIFIED PHOTOCOPY

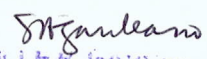
NOVABELLE B. GARCELLANO-VITERO
ADMINISTRATIVE OFFICER I/RECORDS OFFICER

Republic of the Philippines
Department of Environment and Natural Resources
Region IV- B, MIMAROPA
COMMUNITY ENVIRONMENT AND NATURAL RESOURCES OFFICE
South National Highway, Bgy. Sta. Monica Puerto Princesa City

Application No. _____
Applicant _____
Surveyed for _____
Surveyed by OLIVO C. ARDIA
Date of Survey May 30-Oct 16, 1984
Date Approved Jan. 4, 1985

Lot No. 15548 Survey No. CAD-800-D
Identical Lot No. 167, CSS-597
Portion of Lot No. _____
Area: 42,564 square meters
Location Bgy. Marabo, Pto. Prin City
Date of Original Survey : _____

TECHNICAL DESCRIPTION

TIE LINE S 06-20 E 75319.61 M. from BLN#1 CAD-800-D
Pto. Prin. Cadastre

LINE	BEARINGS	DISTANCE	LINE	BEARINGS	DISTANCE
1-2	S 48-18 E	256.52 M			
2-3	S 58-55 W	222.84			
3-4	N 28-40 W	77.67			
4-5	N 28-40 W	111.14			
5-1	N 38-18 E	168.21			

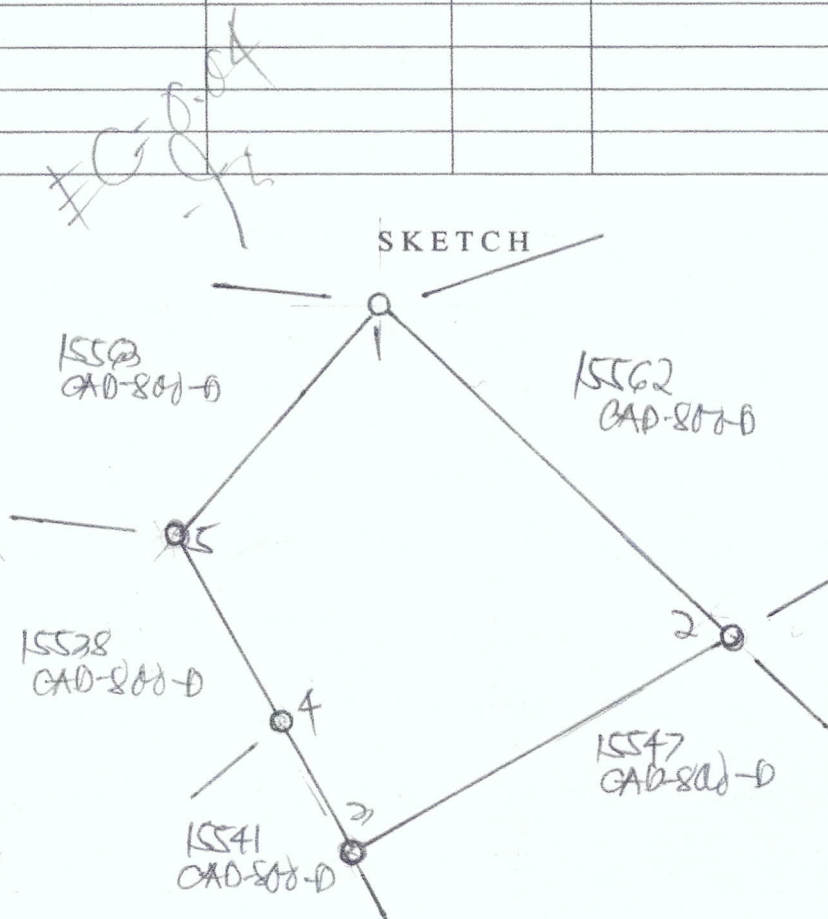

T. D. Research by: _____
T. D. Sketch by: REYNALDO V. MACOLA
T. D. Checked by: _____

Date: _____
Date: 12-06-22
Date: _____

CERTIFIED PHOTOCOPY

NOVA BILLE B. GARCELLANO-VITERBI
ADMINISTRATIVE OFFICER I/RECORDS OFFICER

LOT DESCRIPTIONS

Module 8
Survey No. Cad-800-0 Case No. 49 Mun. of Puerto Princesa Prov. of Palawan

Lot No.	Claimant	PLM No. Corner	BEARINGS AND DISTANCES					Area In Sq Meters
			Line 1-2	Line 2-3	Line 3-4	Line 4-5	Line 5-6	
<u>15539</u> (Cont.)			S. 56° 33' W 113.51					238143
<u>15540</u>			S. 05° 05' E 15555.731	N. 29° 55' W 243.86	N. 56° 40' E 56.65	N. 41° 27' W 21.87	N. 36° 23' E 103.73	232.94
			S. 57° 07' E 96.40	N. 19° 16' E 460.87	S. 23° 01' E 126.80	S. 15° 13' E 189.06	S. 13° 56' W 144.17	
			N. 40° 25' W 252.66	N. 45° 44' W 160.00	S. 25° 13' W 166.92	S. 55° 31' W 193.42	S. 33° 26' W 227.38	235279
<u>15541</u> Sch. Site			S. 05° 59' E 75261.526	S. 29° 29' W 34.39	S. 30° 29' W 160.21	S. 78° 50' W 139.17	S. 69° 55' W 70.84	S. 86° 45' W 200.61
			S. 79° 16' W 460.87	N. 12° 25' E 230.19	N. 24° 20' E 79.74	N. 21° 54' E 148.89	N. 79° 33' E 128.32	
			S. 76° 06' E 164.58	N. 36° 20' E 68.01	S. 72° 10' E 56.20	S. 44° 47' E 76.28	S. 16° 48' E 173.83	
			N. 76° 17' E 376.18					236179
<u>15542</u>			S. 06° 17' E 76253.616	N. 87° 57' W 129.10	N. 52° 04' W 22.60	N. 22° 38' E 78.55	N. 53° 18' E 172.78	S. 35° 45' E 246.10
			S. 16° 42' W 52.66	S. 73° 31' W 109.17				51150
<u>15543</u>			S. 06° 33' E 15619.273	S. 15° 04' E 416.55	S. 55° 06' W 325.01	N. 25° 45' W 246.10	N. 35° 45' W 175.70	N. 21° 35' E 82.18
			N. 65° 40' E 411.18					175006
<u>15544</u>			S. 05° 40' E 75946.159	S. 42° 09' E 162.70	S. 27° 59' W 249.73	S. 11° 20' W 184.23	N. 51° 43' W 106.36	N. 63° 51' W 127.10
			N. 61° 00' W 139.97	N. 16° 42' E 52.66	N. 59° 06' E 325.01	N. 40° 57' W 126.32		111810
<u>15545</u>			S. 06° 33' E 75619.28	N. 65° 40' E 197.94	S. 35° 39' E 270.04	S. 40° 58' W 104.09	S. 40° 57' W 119.36	S. 40° 57' W 126.32
			N. 15° 04' W 416.55					86618
<u>15546</u>			S. 06° 56' E 75532.254	S. 23° 24' E 230.36	S. 45° 33' W 158.25	S. 36° 40' W 112.24	N. 31° 39' W 149.10	N. 35° 35' W 270.04
			N. 85° 16' E 177.96	N. 70° 48' E 155.18				8587
<u>15547</u> Sch. Site			S. 05° 40' E 75946.16	N. 40° 57' E 119.36	S. 46° 08' E 163.36	S. 41° 40' W 130.60	N. 42° 09' W 162.70	2029
<u>15548</u>			S. 06° 20' E 75319.61	S. 48° 18' E 256.52	S. 38° 55' W 233.84	N. 28° 40' W 77.67	N. 28° 40' W 111.14	N. 38° 18' E 160.21
<u>15549</u>			S. 07° 38' E 75510.56	N. 60° 23' E 87.07	S. 27° 54' E 94.40	S. 70° 33' W 84.69	N. 20° 14' W 79.67	1423

CERTIFIED CORRECT:

January 4, 1985

Checked by [Signature] 19

Surveyed May 30 - Oct 16

Checked by [Signature] 19

By [Signature]

Checked by [Signature] 19

OLIVO C. ARRIA
GEODETIC ENGINEER

Verified by [Signature] 19

Sheet No. 2 of 26

ELEUTERIO R. FAZ
Chief, Surveys Division

JUAN J. TRAC

ic, Aggregate Survey Sec.

CERTIFIED PHOTOCOPY

GARCELLANO-VITERB

MANAGEMENT OFFICER / RECORDS OFFICER

Printed by: SICCION MARKETIN
1800 A. Mendoza St., Samp., M.
Tels. 20-62-54; 21-48-82
Authorized by the Bureau of Lands



Republic of the Philippines
CITY OF PUERTO PRINCESA
OFFICE OF THE CITY ASSESSOR



TAX DECLARATION OF REAL PROPERTY

TD No. : **019-11236** Property Identification No. : **134-03-019-13-024**

Owner: **CONDE, UBALDO** TIN: _____

Address: **BGY. MANALO, PUERTO PRINCESA CITY** Telephone No. : _____

Administrator/Beneficial User: _____ TIN: _____

Address: _____ Telephone No. : _____

Location of Property: _____ **MANALO** **PUERTO PRINCESA CITY**
(Number and Street) (Barangay/District) (Municipality & Province/City)

OCT/TCT/CLOA No. : _____ Survey No. : **GSS-597/CAD-800-D**

CCT : _____ Lot No. : **167 IDENT. TO 15548**

Date : _____ Blk. No. : _____

Boundaries: North: **001 (LOT 15563)**

East: **021 (LOT 15562)**

South: **023 (LOT 15547)**

West: **002 (LOT 15538), 026 (LOT 15541)**

KIND OF PROPERTY ASSESSED :

☒ LAND

☐ BUILDING No. of Storeys : _____
Brief Description : _____

☐ MACHINERY Brief Description : _____

☐ OTHERS Brief Description : _____

Classification	Sub-Class	Area	Area Type	Market Value	Actual Use	Assessment Level	Assessed Value
AGRICULTURAL	OMC2	4.256900	HA	1,280,032.81	AGRICULTURAL	10%	128,003.28
TOTAL:		4.256900	HA	1,280,032.81			128,003.28

Total Market Value : **P 1,280,032.81** Total Assessed Value : **P 128,000.00**

Total Assessed Value **ONE HUNDRED TWENTY EIGHT THOUSAND AND 00/100**

Taxable ☒ Exempt ☐

Effectivity of Assessment : **2021**

Appraised By:

Recommended By:

Approved By:

(SGD.) LOWELL I SALIDO
LAOO I

(SGD.) ENGR. JOVEN C. V. BALUYUT **09/25/2020**
CITY ASSESSOR Date

This declaration cancels TD No. : **019-10509**
Previous Owner : _____

Previous A.V. Php : **34,740.00**

CONDE, UBALDO

CERTIFIED TRUE AND CORRECT

ENGR. JOVEN C.V. BALUYUT
CITY ASSESSOR

Paid Under OR # : Official Use
Date Issued :
Amount Paid : P 0.00

MEMORANDA: REVISED PURSUANT TO SECTION 219 OF RA 7160 AND CITY ORDINANCE NO. 1027.

CERTIFIED TRUE COPY

OFFICE OF THE CITY ASSESSOR
CITY OF PUERTO PRINCESA
September 22, 2021

Requested by: **FELIZARDO B. CAYATOC, OIC-CENRO**

Purpose : **whatever legal purposes it may serve him/her**

Note: This declaration is for real property taxation purposes only and the valuation indicated herein are based on the schedule of unit market values prepared for the purpose and duly enacted into an ordinance by the Sangguniang Panlungsod under Ordinance No. 1027 dated 2020-01-20. It does not and cannot by itself alone confer any ownership or legal title to the property.

GENERATED BY : ETRACS v2.5 PRINTED BY : MERLA A. MACABALES PRINT DATE : 2021-09-22 02:33:17

CERTIFIED PHOTOCOPY

Signature
NOVA DILEN CARCELLANO-VITERBI
ADMINISTRATIVE OFFICER / RECORDS OFFICER