



Republic of the Philippines
Department of Environment and Natural Resources
MIMAROPA REGION
PROVINCIAL ENVIRONMENT AND NATURAL RESOURCES OFFICE
Bgy. Sta. Monica, Puerto Princesa City, Palawan
Telfax No. (048) 434-8791
Email Add: penropalawan@denr.gov.ph

DENR MIMAROPA
RECORDS SECTION
RECEIVED

FEB 15 2023

☐ INCOMING ☐ OUTGOING
BY: _____ DATE NO. _____
TIME: _____

February 3, 2023

MEMORANDUM

FOR : The Regional Executive Director
1515 DENR By the Bay Bldg., Roxas Blvd.
Barangay 668, Ermita, Manila

ATTENTION : The OIC-Assistant Regional Director for Technical Services
The OIC-Chief, Surveys and Mapping Division

FROM : The Provincial Environment and
Natural Resources Officer

SUBJECT : **REQUEST FOR LC CONFIRMATION OF LOT 4022,
CAD.860-D IN BRGY. KEMDENG, SAN VICENTE,
PALAWAN**

Forwarded is the Memorandum of CENRO Roxas, Palawan dated January 27, 2023 requesting for confirmation of land classification status for the issuance of patent.

Further, this Office evaluated the findings of the CENRO as to its land classification status aided with sketch map in compliance to DMC No. 2019-10 dated December 11, 2019 and same was projected which falls within Alienable and Disposable land.

For information, record and consideration.

Reference No: 2023-0712
TSD/RPS/SMU

FELIZARDO B. CAYATOC

DENR-PALAWAN
PENRO-RECORDS
RELEASED
By: Amc
Date: 7 FEB 2023 CN 23-342



Republic of the Philippines
Department of Environment and Natural Resources
MIMAROPA REGION
PROVINCIAL ENVIRONMENT AND NATURAL RESOURCES OFFICE
Bgy. Sta. Monica, Puerto Princesa City, Palawan
Telfax No. (048) 434-8791
Email Add: penropalawan@denr.gov.ph

(ANNEX I)

CERTIFICATION

TO WHOM IT MAY CONCERN:

THIS IS TO CERTIFY that based on available records, the tract of land in Barangay Kemdeng, San Vicente, Palawan, containing an area of *Two Thousand One* (2,001) square meters, identified as **Lot No. 4022, CAD.860-D** subject of application of Ms./Mr. JESSICA ANN P. LIM, Free Patent Application No. _____ was verified to be within **Alienable and Disposable Land** per LC Map No. 3309, Project No. 1-T, Block XXVI.

Issued this 3rd day of February 2023, at DENR Office, Sta. Monica, Puerto Princesa City, subject for confirmatory verification of the Regional Office.

Checked/Verified by:

Engr. Donna Belle E. Luengo
Engineer II
Unit Head, Surveys and Mapping Unit

CONCURRED:

FELIZARDO B. CAYATOC

Note:
Reference used was based on the rectified LC map
provided and projected by the Regional Office

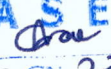
DENR-PALAWAN
PENRO-RECORDS
RELEASED
By 
Date: 7 FEB 2023 CN 23-342

ALIENABLE AND DISPOSABLE
PROJECT No. 1-T
BLOCK XXVI
LC No. 3309

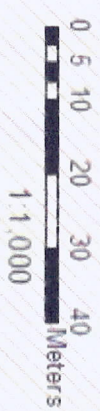
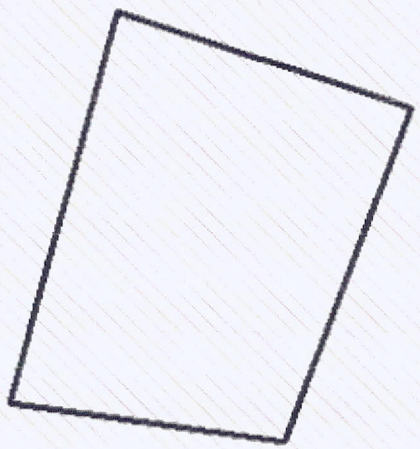

119°15'40" E



MAP SHOWING
LOT 4022, Cad 860-D
Claimed by Jessica Ann Lim

Situated at
Barangay Kemdeng
Municipality of San Vicente
Province of Palawan

PROJECTION UTM
AREA: 2,001 sq.m

- Legend**
- 4022
 - Land Classification Map_PRS92**
 - LC_STATUS**
 - Alienable & Disposable
 - Communal Forest
 - Forestland
 - No Data
 - UPF



Republic of the Philippines
Department of Environment and Natural Resources
Region IV- MIMAROPA
COMMUNITY ENVIRONMENT AND NATURAL RESOURCES OFFICE
Barangay III (Poblacion), Roxas, Palawan
Contact No. 09171606578 / 09175028647
Email address: cenroroxaspalawan@denr.gov.ph

MEMORANDUM

FOR : The PENR Officer
FROM : The CENR Officer
SUBJECT : **REQUEST FOR LC CONFIRMATION OF LOT 4022, CAD. 860-D
IN BGY. KEMDENG, SAN VICENTE, PALAWAN**
DATE : 27 January 2023

I am submitting LC findings on Lot 4022 of Cad. 860-D in Bgy. Kemdeng, San Vicente, Palawan for verification, approval, and endorsement for confirmation by the Regional Office should findings get affirmed pursuant to DMC No. 2019-10 as applied for patent by Jessica Ann P. Lim.

For consideration.

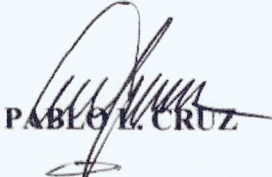
PABLO L. CRUZ

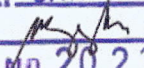
DENR-CENRO ROXAS
RELEASED
DATE: JAN 27 2023
BY: 
C. No. 2023-01-0157

Copy:

The ARD, Technical Services
C/O The Chief, SMD at surveys_mimaropa@yahoo.com

The Applicant

File



Republic of the Philippines
Department of Environment and Natural Resources
Region IV- MIMAROPA
COMMUNITY ENVIRONMENT AND NATURAL RESOURCES OFFICE
Barangay III (Poblacion), Roxas, Palawan
Contact No. 09171606578 / 09175028647
Email address: cenroroxaspalawan@denr.gov.ph

CERTIFICATION

TO WHOM IT MAY CONCERN:

THIS IS TO CERTIFY that based on available records in our Office, the tract of land in Barangay Kemdeng, Municipality of San Vicente, Province of Palawan containing an area of Two Thousand One (2001) square meters, identified as Lot 4022 of Cad. 860-D and applied for Patent by Jessica Ann P. Lim was verified to be within the agricultural (alienable/disposable) lands per LC Map No. 2598 under FAO No. 4-1116, Project No. 1-T/Block XXVI, certified on 01 July 1966.

Issued this 27th day of January 2023 at CENRO, Roxas, Palawan.

Checked by:

RONNIE P. LILANG
Chief, Regulation & Permitting Section

APPROVED:

PABLO L. CRUZ
CENR Officer

copy: file

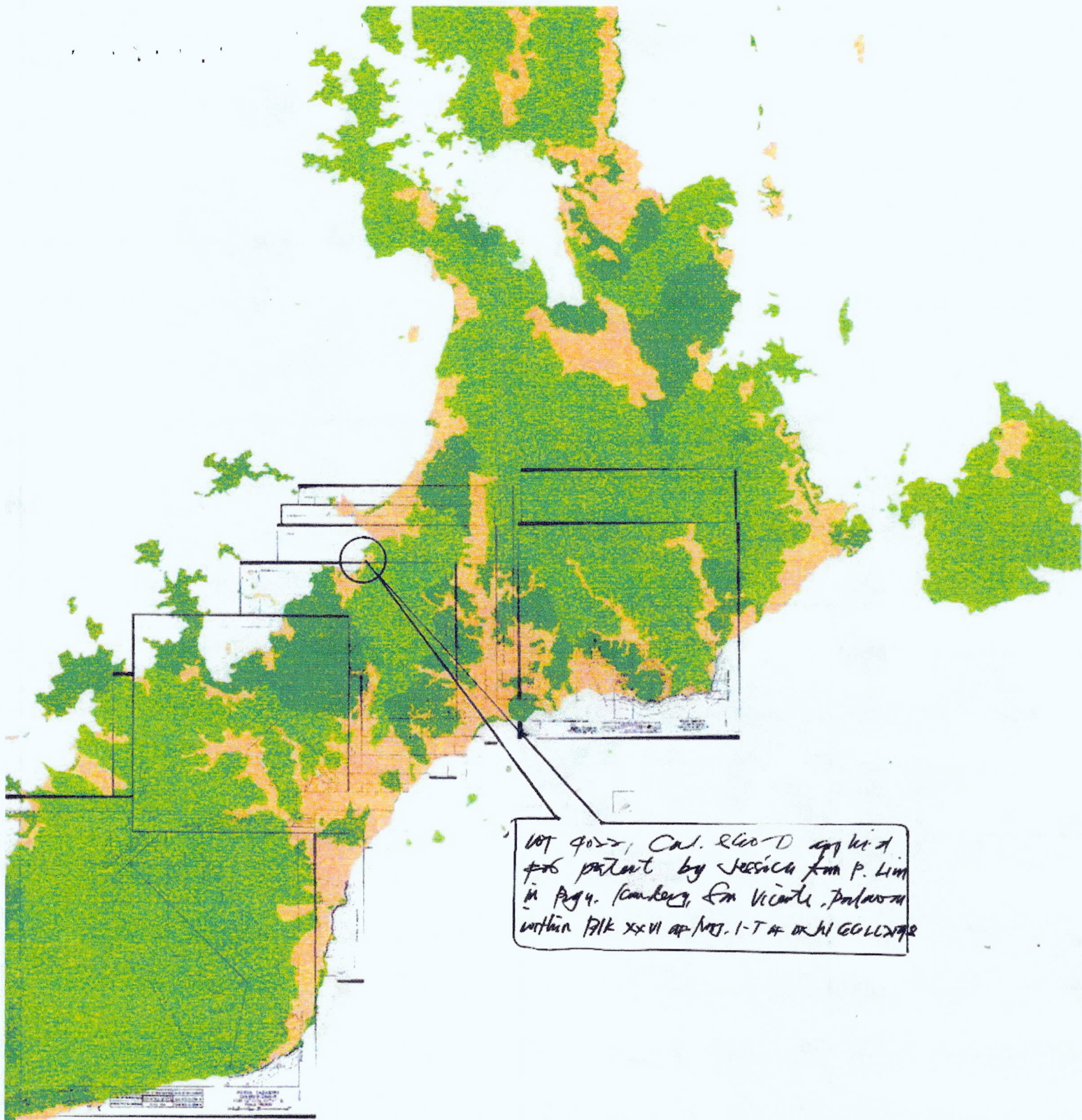

lot 4052, Cal. 260-D applied
for patent by Jessica Ann P. Lim
in Aug. 1994, San Vicente, Palawan
within BIK XXVI at MS. 1-T # on N COLLECTOR



Republic of the Philippines
Department of Environment and Natural Resources
Region IV
COMMUNITY ENVIRONMENT AND NATURAL RESOURCES OFFICE
Roxas, Palawan

FPA No. 045319 Applicant : LIM, Jessica Ann P.

Lot No. 4022, Cad. 860-D identical to Lot N/A

Portion of Lot No. N/A Surveyed for: unknown

Date of Original Survey: 10-21 June 1989 Surveyed by: Mariano V. Flotildes

Area (sq. m.) 2001 Date of Survey: 10-21 June 1989

Location : Bgy. Kemdeng, San Vicente, Palawan Date Approved: 23 September 1991

TECHNICAL DESCRIPTION

TIE LINE : S. 20-07 W., 2888.85 m. from BLLM No. 1, Cad. 860-D to cor. 1, thence;

LINE	BEARING	DISTANCE(M)	LINE	BEARING	DISTANCE(M)
1-2	N. 74-48 W.	54.68			
3	N. 17-54 E.	41.35			
4	S. 69-26 E	48.18			
4-1	S. 07-49 W.	37.12			

All corners are marked on the ground by PS Cyl. Conc. Mons. 15x60 cm in dimension.

SKETCH

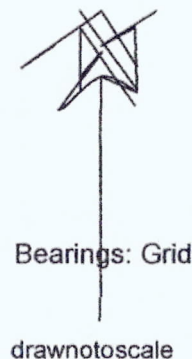
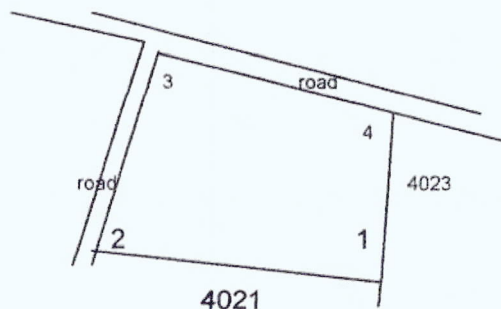

T. D. Researched by : _____ Date : _____
T.D. Sketched by : _____ R.Lilang _____ Date : 27 January 2023
T. D. Checked by : _____ Date : _____

- 8.1.1 Oversee the overall implementation of this Circular and ensure the elimination of illegal real estate practices such as selling of project units without certificates of registration and licenses to sell, and other fraudulent real estate practices covered by Presidential Decree No. 957, Republic Act No. 9646, and other relevant laws, rules and regulations;
 - 8.1.2 Promote public awareness campaigns on homebuyers' protection, as well as against acts of unscrupulous developers of housing, subdivision and condominium projects and other illegal real estate practitioners;
 - 8.1.3 Set up and implement development capacity building action plan for members of both the National, Regional, and Local Task Forces to synchronize programs and align implementation;
 - 8.1.4 Develop programs to provide legal, technical, and other forms of assistance to actual and potential victims of real estate-related illegal transactions under Presidential Decree No. 957 and other related laws;
 - 8.1.5 Review and resolve issues and concerns relative to the implementation of this Circular, including policy recommendations of the Regional Task Force;
 - 8.1.6 Render technical and other necessary assistance to the local government units (LGUs) and other agencies upon request; and
 - 8.1.7 Perform such other functions consistent with the provisions of this Circular or as may be directed by the President of the Philippines.
- 8.2 The **Regional Task Force** shall:
- 8.2.1 Ensure and monitor the implementation of plans, programs, and projects at the regional level;
 - 8.2.2 Coordinate with the LGUs within its jurisdiction to ensure the effective implementation of this Circular;
 - 8.2.3 Submit regular status reports on the progress of the implementation of the provisions of this Circular, as well as its policy recommendations, to the National Task Force;
 - 8.2.4 Develop and install a hotline where the public can raise queries and report complaints on real estate malpractices or illegal activities;

