



Republic of the Philippines
Department of Environment and Natural Resources
MIMAROPA REGION
PROVINCIAL ENVIRONMENT AND NATURAL RESOURCES OFFICE
Bgy. Sta. Monica, Puerto Princesa City, Palawan
Telfax No. (048) 434-8791
Email Add: penropalawan@denr.gov.ph

DENR MIMAROPA RECORDS SECTION RECEIVED	
FEB 06 2023	
<input type="checkbox"/> INCOMING	<input type="checkbox"/> OUTGOING
BY: <i>[Signature]</i>	DATS NO. _____
TIME: _____	

MEMORANDUM

FOR : The OIC Assistant Regional Director for Technical Services

FROM : The Provincial of Environment and Natural Resources Officer

SUBJECT : **TRANSMITTAL OF THE REPORT**

DATE : January 30, 2023

Forwarded is the application for issuance of Survey Authority covering Lots 4593 CAD 860-D applied by Mr. Jerome Butikofer et. al located at Brgy. Port Barton, San Vicente, Palawan in compliance of DMC 2019-10 and Technical Bulletin No. 2020-01.

After careful evaluation and projection conducted by this Office, the following are additional information to the above mentioned lot wit;

- That the subject area applied for subdivision was identified as portion of Lot No. 4593, CAD 860-D with an approximate area of 125,956.35 Square Meters.
- That portion of the area applied falls within **ALIENABLE AND DISPOSABLE LAND** per Land Classification Maps No.2598 and 3309 Project No. 1-T, Block XX, and 1-U Block VIII under FAOs No. 4-1116 and 4-1966 certified on July 1, 1966 and June 29, 1987 respectively.
- That subject tract of land was plotted and evaluated based on the attached technical description (V-37). Hence, subject for issuance of clearance by the Regional Office and actual ground survey to ascertained the meets and bounds of the aforementioned area.
- Attached are the geo-tagged photographs of the area and sketch map showing the relative position of the subject lot overlaid in land classification map for your information and reference.

Hence, issuance of survey authority is recommended to segregate the Alienable and Disposable Land in favor of Jerome Butikofer et. al.

Jim Flores

8

[Signature]
FELIZARDO B. CAYATOC

Copy Furnish: 3
Reference No. 2022-0097
CENRO Taytay
Surveys

**DENR-PALAWAN
PENRO-RECORDS
RELEASED**
By *[Signature]*
Date: 03 FEB 2023 CN 23-292



Republic of the Philippines
Department of Environment and Natural Resources
MIMAROPA REGION
PROVINCIAL ENVIRONMENT AND NATURAL RESOURCES OFFICE
Province of Palawan
Brgy. Santa Monica, Puerto Princesa City
Telfax No. (048) 434-8791; Email Add: penropalawan@denr.gov.ph

ANNEX "B"

CERTIFICATION

This is to certify that portion of **Lot No. 4593 CAD 860-D** falls within **ALIENABLE AND DISPOSABLE LAND** per Land Classification Maps No.2598 and 3309 Project No. 1-T, Block XX, and 1-U Block VIII under FAOs No. 4-1116 and 4-1966 certified on July 1, 1966 and June 29, 1987 respectively.

Issued on the ^{30th} day of January 2023 at DENR PENRO, Sta. Monica, Puerto Princesa City, subject for confirmatory verification of the Regional Office.

FELIZARDO B. CAYATOC
PENRO

Note:
Reference used was based on the rectified LC map
provided and projected by the Regional Office

DENR-PALAWAN
PENRO-RECORDS
RELEASED
By 
Date: **03 FEB 2023** CN **23-292**



Republic of the Philippines
Department of Environment and Natural Resources
MIMAROPA REGION
PROVINCIAL ENVIRONMENT AND NATURAL RESOURCES OFFICE
Province of Palawan
Brgy. Santa Monica, Puerto Princesa City
Telfax No. (048) 434-8791; Email Add: penropalawan@denr.gov.ph

ANNEX "B"

CERTIFICATION

This is to certify that portion of **Lot No. 4593 CAD 860-D** falls within **ALIENABLE AND DISPOSABLE LAND** per Land Classification Maps No.2598 and 3309 Project No. 1-T, Block XX, and 1-U Block VIII under FAOs No. 4-1116 and 4-1966 certified on July 1, 1966 and June 29, 1987 respectively.

Issued on the ^{30th} day of January 2023 at DENR PENRO, Sta. Monica, Puerto Princesa City, subject for confirmatory verification of the Regional Office.

FELIZARDO B. CAYATOC
PENRO

Note:
Reference used was based on the rectified LC map
provided and projected by the Regional Office

DENR-PALAWAN
PENRO-RECORDS
RELEASED
By 
Date: **03 FEB 2023** ^N **23-292**



MAP SHOWING
OF LOT 4593 Cad-860
Claimed by: Jerome D. Butikofer, et al.

Situated at
Barangay Port Barton
Municipality of San Vicente
Province of Palawan

Projection: UTM
Area: 4,989 sq.m.

Legend

4593

Land Classification Map_PR592

LC_STATUS

- Alienable & Disposable
- Communal Forest
- Forestland
- No Data
- UFF

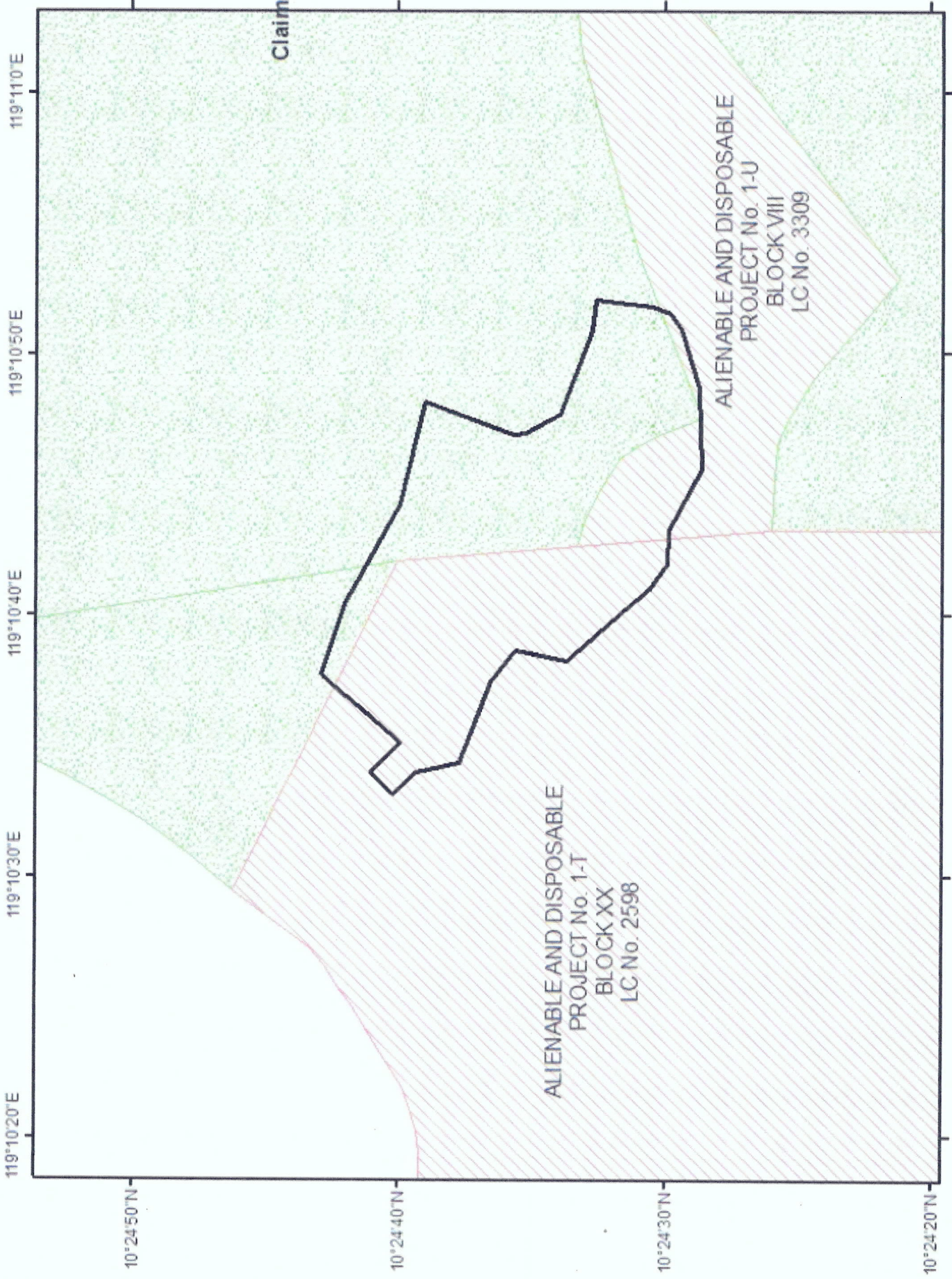



Republic of the Philippines
Department of Environment and Natural Resources
Region IV- MIMAROPA
COMMUNITY ENVIRONMENT AND NATURAL RESOURCES OFFICE
Barangay III (Poblacion), Roxas, Palawan
Contact No. 09171606578 / 09175028647
Email address: cenroroxaspalawan@denr.gov.ph

MEMORANDUM

FOR : The PENR Officer
FROM : The CENR Officer
SUBJECT : TRANSMITTAL OF REPORT
DATE : 14 November 2022

**DENR PENRO
PALAWAN RECORDS
RECEIVED**

BY: 
DATE: 01-12-2023 CN 23-0097

I am submitting the investigation report conducted on the request for survey authority involving subdivision of Lot 4593 of Cad. 860-D in Port Barton, San Vicente, Palawan.

Evaluating the same, it was ascertained that:

- a. Half of the subject lot on the southwest is within the agricultural (alienable/disposable) lands; and
- b. The same appears peacefully occupied/possessed by Jerome D. Butikofer, et al., the present claimant and occupant/possessor thereof to the exclusion of adverse others.

Hence, confirmation of the LC findings arrived at, is hereby recommended. Attached are geo-photographs showing improvements found introduced thereon.



RONNIE P. LILANG
Chief, Regulation and Permitting Section
Office-In-Charge

Copy: The ARD, Technical Services
C/O the SMD at surveys_mimaropa@yahoo.com

The Bgy. Council, Port Barton, San Vicente, Palawan

The Claimants

file

**DENR-CENRO ROXAS
RELEASED**

DATE: JAN 05 2023

BY: 

REG. NO. 2023-01-0036



Republic of the Philippines
Department of Environment and Natural Resources
Region IV- MIMAROPA
COMMUNITY ENVIRONMENT AND NATURAL RESOURCES OFFICE
Barangay III (Poblacion), Roxas, Palawan
Contact No. 09171606578 / 09175028647
Email address: cenroroxaspalawan@denr.gov.ph

CERTIFICATION

This is to certify that half southwest part of Lot 4593 of Cad. 860-D is within the agricultural (alienable/disposable) lands per LC Maps No. 2598 and 3309, Projects No. 1-T/Block XX and 1-U/Block VIII dated 01 July 1966 and 29 June 1987, under no FAOs No. 4-1116 and 4-1966.

Said land is not covered by GSS covering areas which are within timberland.

Issued this 19th day of September 2022.

PABLO L. CRUZ
CENRO

Copy: file

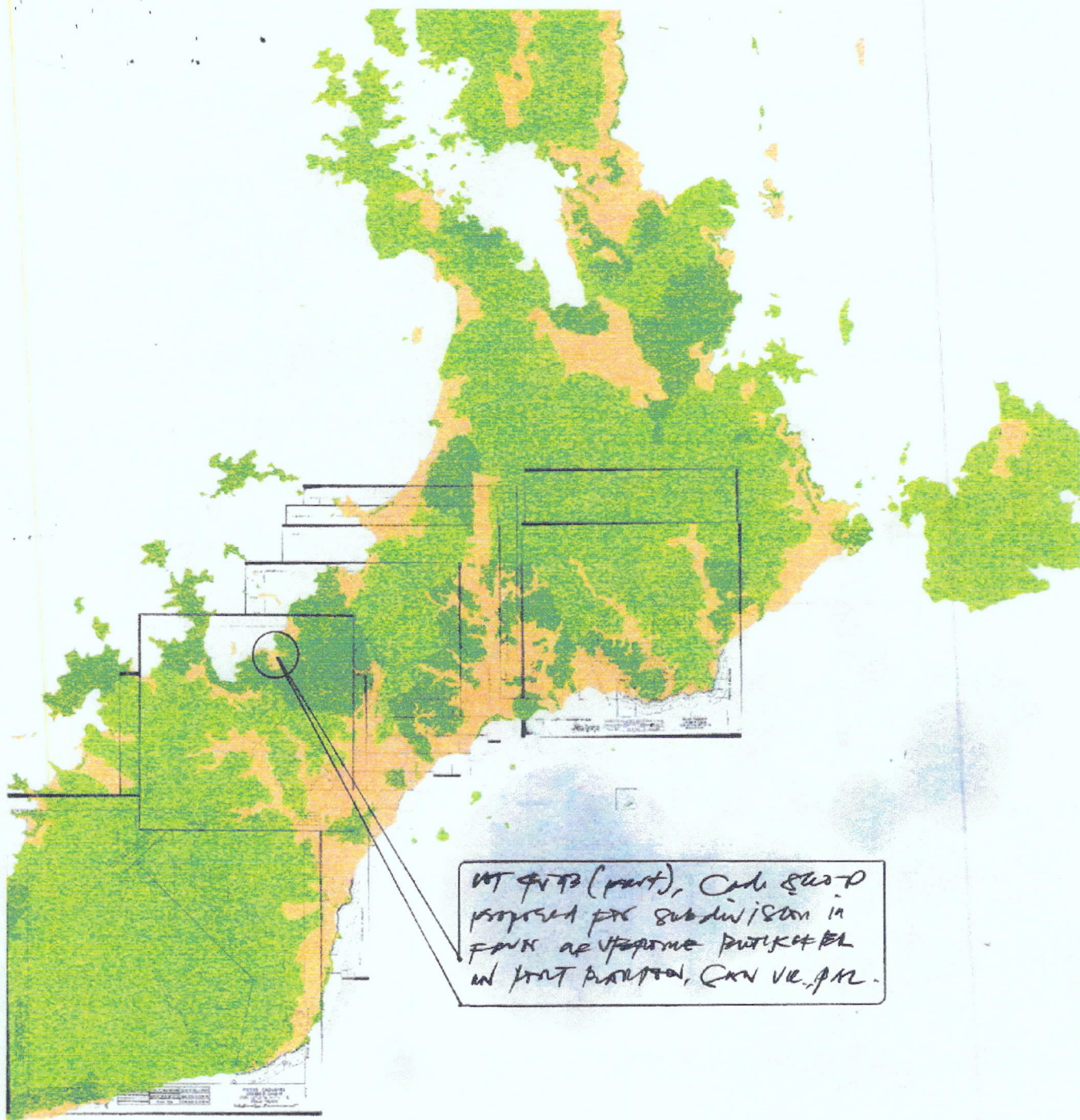

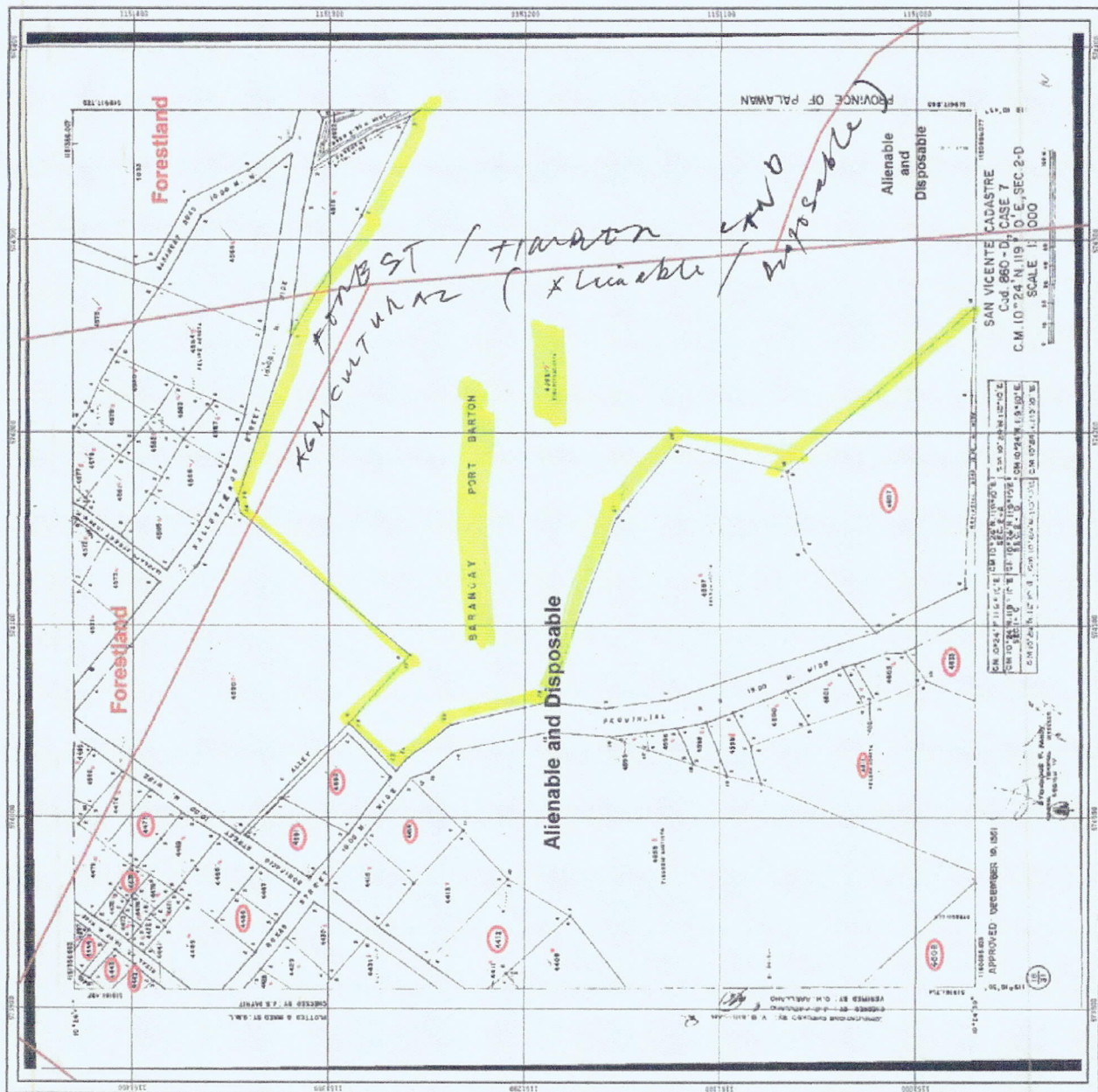



Republic of the Philippines
Department of Environment and Natural Resources
Region IV
COMMUNITY ENVIRONMENT AND NATURAL RESOURCES OFFICE
Roxas, Palawan

No. _____ Applicant: _____
Lot No. 4593, Cad-860-D Ident. to Lot No. _____
Portion of Lot No. _____ Surveyed for: BAUTISTA, TIBURCIO
Date of Original Survey: July 6-Aug. 8, 1988 Surveyed by: MARIANO V. FLOTILDES
Area (sq. m.) 125,956.35 Date of Survey: July 6-Aug. 8, 1988
Location: Port Barton, San Vicente, Pal. Date Approved: December 10, 1991

TECHNICAL DESCRIPTION

TIE LINE: S. 40-05 W., 15672.13 m. from BLLM-1, Cad. 860-D, San Vicente cadastre

LINE	BEARINGS	DISTANCE	LINE	BEARINGS	DISTANCE
1 - 2	S. 59 - 27 E.	73.11 m.	11 - 12	S. 21 - 25 W.	23.04 m.
2 - 3	S. 63 - 39 E.	56.36 m.	12 - 13	S. 57 - 27 W.	22.53 m.
3 - 4	S. 76 - 05 E.	122.54 m.	13 - 14	S. 72 - 24 W.	70.56 m.
4 - 5	S. 21 - 54 W.	51.65 m.	14 - 15	S. 88 - 24 W.	93.90 m.
5 - 6	S. 19 - 03 W.	58.83 m.	15 - 16	N. 61 - 59 W.	81.09 m.
6 - 7	S. 05 - 25 E.	12.18 m.	16 - 17	N. 88 - 23 W.	39.52 m.
7 - 8	S. 30 - 26 E.	45.55 m.	17 - 18	N. 54 - 30 W.	35.90 m.
8 - 9	S. 69 - 10 E.	103.33 m.	18 - 19	N. 41 - 14 W.	127.78 m.
9 - 10	S. 81 - 24 E.	37.42 m.	19 - 20	N. 12 - 45 E.	59.25 m.
10 - 11	S. 07 - 47 W.	64.55 m.	20 - 21	N. 51 - 53 W.	46.01 m.

LATITUDE and DEPARTURE FOR
SKETCH

1	-37.16 + 62.96	16	+ 1.11 -39.50
2	-25.02 +50.50	17	+20.85 -29.23
3	-29.46 +118.95	18	+96.10 -84.21
4	-47.92 -19.27	19	+57.79 +13.08
5	-55.61 -19.20	20	+28.40 -36.20
6	-12.13 + 1.15	21	+37.41 -95.96
7	-39.28 +23.07	22	+48.88 -10.78
8	-36.76 +96.57	23	+21.65 -18.40
9	-5.60 +37.00	24	+ 4.95 - 6.76
10	-63.96 - 8.74	25	+25.72 +25.80
11	-21.45 - 8.41	26	-32.50 +34.87
12	-12.12 -18.99	27	+87.24 +74.85
13	-21.34 -67.26	28	+ 2.25 + 6.27
14	- 2.61 -93.86	29	-27.52 +83.29
15	+38.09 -71.59		+470.44 +628.36
			-470.44 -628.36
			X X

T.D. Researched by: _____ Date: _____
T.D. Sketched by: _____ Date: _____
T.D. Checked by: _____ Date: _____

NOTE: Sketch on 2nd page

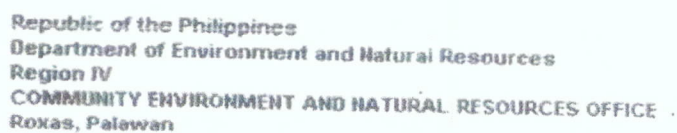

No. _____ Applicant: _____
Lot No. 4593, Cad - 860 - D Ident. to Lot No. _____
Portion of Lot No. _____ Surveyed for: BAUTISTA, TIBURCIO
Date of Original Survey: July 6 - Aug. 8, 1988 Surveyed by: MARIANO V. FLORES
Area (sq. m.) 125,956.35 Date of Survey: July 6 - Aug. 8, 1988
Location: Port Barton, San Vicente, Pal. Date Approved: December 10, 1991

TIE LINE: Please see page 1

LINE	BEARINGS	DISTANCE	LINE	BEARINGS	DISTANCE
21 - 22	N. 68 - 42 W.	102.99 m.			
22 - 23	N. 12 - 26 W.	50.05 m.			
23 - 24	N. 40 - 22 W.	28.41 m.			
24 - 25	N. 53 - 47 W.	8.38 m.			
25 - 26	N. 45 - 05 E.	36.43 m.			
26 - 27	S. 47 - 01 E.	47.67 m.			
27 - 28	N. 40 - 38 E.	114.95 m.	NOTE:	All corners are marked "PS" cyl. Conc. mons.	
28 - 29	N. 70 - 16 E.	6.66 m.			
29 - 1	S. 71 - 43 E.	87.72 m.			
			CM-10° 24' N. 119° 10' E.		

SKETCH

BALLETTEROS STREET

PROVINCIAL ROAD

CREEK

4590

4591

4607

4816

4817

1

2

3

4

5

6

7

8

9

10

11

12

13

14

15

16

17

18

19

20

21

22

23

24

25

26

27

A

B

C

D

E

F

G

H

I

J

K

L

M

N

O

P

Q

R

S

T

U

V

W

X

Y

Z

SCALE 1 : 6000
BEARINGS : GRID

NOTE: BOUNDARIES ARE ALL W/IN CAD-860-D, SAN VICENTE CADASTRE

T.D Researched by:

T.D. Sketched by:

T.D Checked by

Date:

Date: _____

Date: _____

01/05/2022



Republic of the Philippines
Department of Environment and Natural Resources
Region IV- MIMAROPA
COMMUNITY ENVIRONMENT AND NATURAL RESOURCES OFFICE
Barangay III (Poblacion), Roxas, Palawan
Contact No. 09171606578 / 09175028647
Email address: cenroroxaspalawan@denr.gov.ph

MEMORANDUM

For : The CENR Officer
From : The Investigating Officer
SUBJECT : INVESTIGATION REPORT
Date : 19 September 2022

I am submitting this report in compliance with your instruction to conduct investigation on the attached request for Survey Authority.

SUBJECT LAND

The land subject of this investigation is at least half of Lot 4593 of Cad. 860-D in Bgy. Port Barton, San Vicente, Palawan.

CLAIMANT

The claimants include Jerome D. Butikofer, occupant/possessor of the agricultural (A/D) subject hereof.

ACTIVITIES UNDERTAKEN

Upon receipt of the instruction, I immediately conducted the investigation. The following were undertaken:

1. First gathered GPS returns causing verification thereof by the Cartographer on the cadastral map over which the Surveys and Mapping Division (SMD) has overlaid the LC Maps, and prepared the LC Certification based on the findings.
2. The Bgy. Certification secured in support thereof, was validated on site and is evidenced by the geophotographs attached.

FINDINGS AND RECOMMENDATION

Verifications disclosed the following:

1. It is within the agricultural (alienable/disposable) lands subject for confirmation by the Regional Office pursuant to DMC No. 2019-10.
2. It is recommended that LC findings be confirmed and the Survey Authority desired be granted.

RONNIE P. LILANG
Chief, RPS

Copy: file



Portion of Lot 4593 of Cad. 860-D acquired by Jerome D. Butikofer in Bgy. Port Barton, San Vicente, Palawan and is proposed for survey.



Republic of the Philippines
REGIONAL TRIAL COURT

Fourth Judicial Region

Puerto Princesa City

Email Address: rtc1prpccc@judiciary.gov.ph

Hotline Number: 09289352669

OFFICE OF THE CLERK OF COURT

Hall of Justice, Bgy. Sta. Monica, Puerto Princesa City

CERTIFICATION

TO WHOM IT MAY CONCERN:

THIS IS TO CERTIFY that this Office has no record of any pending/decided land registration case before any branches of this court involving applicant Jerome D. Butikofer covering Lot No. 4593(part), Cad 860-D located at Barangay Port Barton, San Vicente, Palawan.

This Certification is being issued upon the request of Ronnie P. Lilang for the application of survey authority.

At Puerto Princesa City, this 6th day of September 2022.

PRINCES KATHERINE C. VERGARA
Clerk of Court V

Cert. Fee: P15.00/35.00/10.00
O.R. No. 8976957/8981156/3709750
Dated: September 6, 2022
z/n



Republic of the Philippines
Department of Environment and Natural Resources
Region IV
COMMUNITY ENVIRONMENT AND NATURAL RESOURCES OFFICE
Roxas, Palawan

REPUBLIC OF THE PHILIPPINES)
PROVINCE OF PALAWAN : S.S.
MUNICIPALITY OF ROXAS)

JOINT AFFIDAVIT

We, Enrico Lagrosa and Bernadette Uapal, both married residents of Bgy. Port Barton, San Vicente, Palawan after having been sworn, hereby depose and state:

1. That we personally know Jerome D. Butikofer who desires survey of Lot 4593(part), Cad. 860-D, in Bgy. Port Barton, San Vicente, Palawan.
2. That we are actual residents of the Barangay of Pot Barton in the Municipality of San Vicente, Palawan,
3. That we are aware of the fact that Mr. Butikofer is claimant and or occupant/possessor of the land described in item 1 hereof;
4. That we are not related to the claimant/representative either by consanguinity or affinity and not, in any way, interested in the land; and
5. That to the best of our knowledge, belief and information, the land is not claimed by adverse others.

IN WITNESS WHEREOF, we have hereunto set our hands this _____th day of August 2022 in the place above first written.

Bernadette C. Uapal
Affiant

CTC No. CC12018 19423097
Issued on 09-02-22
Issued at Roxas, Palawan

Enrico T. Lagrosa
Affiant

CTC No. CC12018 19423096
Issued on 09-02-22
Issued at Roxas, Palawan

SUBSCRIBED AND SWORN to be fore me on the date and place stated above.

Donna P. Lagrosa
Officer Authorized to Administer Oath
L. M. O. P. / Clerk, Reg. & Permitting
(Position/Designation)



Republic of the Philippines
Province of Palawan
Municipality of San Vicente
Barangay Government of Port Barton

OFFICE OF THE PUNONG BARANGAY

CERTIFICATION

TO WHOM IT MAY CONCERN:

This is to certify that based on the document submitted in this office, A waiver of rights from **ESPERANZA DELMO BUTIKOFER**, Filipino, of legal age, married and a resident of Barangay San Manuel, Puerto, Princesa, City waived, renounce, transfer and convey all her rights, claim, participation and interest including all the improvements of PART of Lot No. 4593 - V covered by TAX Declaration No. 21-008-0909 CAD 860-D consisting of three hundred forty (340) square meters to **JEROME DELMO BUTIKOFER**, Filipino, of legal age, single, and a resident of Sitio Albaguen, Barangay Port Barton, San Vicente, Palawan bonafide resident of Purok Pag-asa, Barangay Port Barton, San Vicente, Palawan.

Certifies Further that the above person is the actual claimant of the said lot area.

This Barangay certification is being issued upon request of the subject person above for her desire to apply of any **TENURIAL INSTRUMENT** from the Department of Environment and Natural Resources office.

Issued this 19th day of August 2022.

JEROME DELMO BUTIKOFER
Requesting Person

JANET E. PACAUL
Barangay Secretary

O.R. No. : 5942007
Issued on : 8/19/22
Issued at : PBSVP

Noted by:

Hon. ENRICO A. DE JESUS
Punong Barangay

SUBSCRIBED AND SWORN TO BEFORE ME THIS
SEP 05 2022 AT PUERTO PRINCESA CITY PALAWAN WITH
ESPERANZA D. BUTIKOFER with her Drivers License ID
with NO. D11-13-002287 with photo AS
HIS/HER PERSONAL COMPETENT IDENTITY.

PG. NO. 104
PAGE NO. 22
BOOK NO. XXXI
SERIES OF 2022

ATTY. ALBERT M. PEDROSA
NOTARY PUBLIC
UNTIL DECEMBER 31, 2022
PURSUANT TO BAR MATTER NO. 3793
PTR NO. 08S1097/01-04-2022
IBP NO. 184060/02/03/2022
ROLL NO. 53292
MCLE NO. VII-0018467/05-27-2022
NPL NO. 2019-19 / 01-09-2019

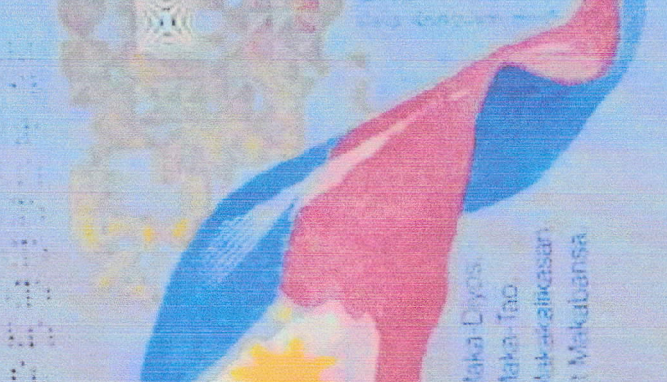

Maka-Diyos,
Maka-Tao
Makakagipasan
at Makabansa

Benito

3

[illegible]



Republic of the Philippines
Department of Environment and Natural Resources
Region IV- MIMAROPA
COMMUNITY ENVIRONMENT AND NATURAL RESOURCES OFFICE
Barangay III (Poblacion), Roxas, Palawan
Contact No. 09171606578 / 09175028647
Email address: cenroroxaspalawan@denr.gov.ph

MEMORANDUM

FOR : The PENR Officer
FROM : The CENR Officer
SUBJECT : **TRANSMITTAL OF REPORT**
DATE : 14 November 2022

**DENR PENRO
PALAWAN RECORDS
RECEIVED**

BY: [Signature]
DATE: 01-02-2023 DN 230097

I am submitting the investigation report conducted on the request for survey authority involving subdivision of Lot 4593 of Cad. 860-D in Port Barton, San Vicente, Palawan.

Evaluating the same, it was ascertained that:

- a. Half of the subject lot on the southwest is within the agricultural (alienable/disposable) lands; and
- b. The same appears peacefully occupied/possessed by Jerome D. Butikofer, et al., the present claimant and occupant/possessor thereof to the exclusion of adverse others.

Hence, confirmation of the LC findings arrived at, is hereby recommended. Attached are geo-photographs showing improvements found introduced thereon. //

RONNIE P. LILANG
Chief, Regulation and Permitting Section
Office-In-Charge

Copy: The ARD, Technical Services
C/O the SMD at surveys_mimaropa@yahoo.com

The Bgy. Council, Port Barton, San Vicente, Palawan

The Claimants

file

DENR-CENRO ROXAS

RELEASED

DATE: JAN 05 2023

BY: [Signature]

REG. NO. 2023-01-0036



Republic of the Philippines
Department of Environment and Natural Resources
Region IV- MIMAROPA
COMMUNITY ENVIRONMENT AND NATURAL RESOURCES OFFICE
Barangay III (Poblacion), Roxas, Palawan
Contact No. 09171606578 / 09175028647
Email address: cenroroxaspalawan@denr.gov.ph

CERTIFICATION

This is to certify that half southwest part of Lot 4593 of Cad. 860-D is within the agricultural (alienable/disposable) lands per LC Maps No. 2598 and 3309, Projects No. 1-T/Block XX and 1-U/Block VIII dated 01 July 1966 and 29 June 1987, under no FAOs No. 4-1116 and 4-1966.

Said land is not covered by GSS covering areas which are within timberland.

Issued this 19th day of September 2022.

PABLO L. CRUZ
CENRO

Copy: file



UT 9713 (part), Cadd & Co. D
proposed for subdivision in
Fork of Upperme Butte Rd
in Port Antonio, C.R. V. 12.

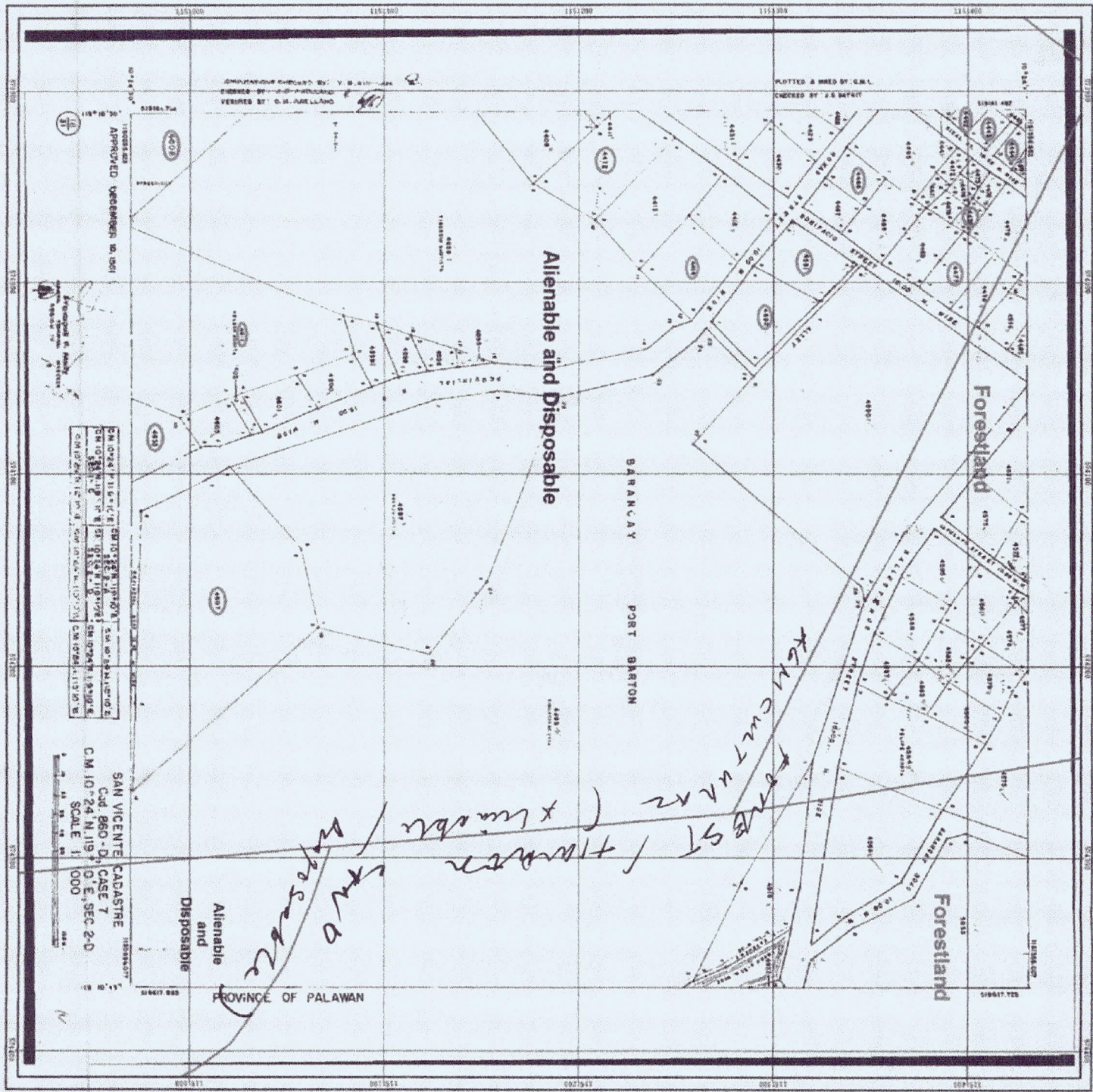

VERIFIED BY: G. M. MALLANA
CHECKED BY: J. S. BATALE
PLOTTER & INKED BY: G.M.L.

Approved: December 30, 1961
11:00 AM

CM 07541-113707-1
CM 07541-113707-2
CM 07541-113707-3
CM 07541-113707-4
CM 07541-113707-5
CM 07541-113707-6
CM 07541-113707-7
CM 07541-113707-8
CM 07541-113707-9
CM 07541-113707-10
CM 07541-113707-11
CM 07541-113707-12
CM 07541-113707-13
CM 07541-113707-14
CM 07541-113707-15
CM 07541-113707-16
CM 07541-113707-17
CM 07541-113707-18
CM 07541-113707-19
CM 07541-113707-20
CM 07541-113707-21
CM 07541-113707-22
CM 07541-113707-23
CM 07541-113707-24
CM 07541-113707-25
CM 07541-113707-26
CM 07541-113707-27
CM 07541-113707-28
CM 07541-113707-29
CM 07541-113707-30
CM 07541-113707-31
CM 07541-113707-32
CM 07541-113707-33
CM 07541-113707-34
CM 07541-113707-35
CM 07541-113707-36
CM 07541-113707-37
CM 07541-113707-38
CM 07541-113707-39
CM 07541-113707-40
CM 07541-113707-41
CM 07541-113707-42
CM 07541-113707-43
CM 07541-113707-44
CM 07541-113707-45
CM 07541-113707-46
CM 07541-113707-47
CM 07541-113707-48
CM 07541-113707-49
CM 07541-113707-50
CM 07541-113707-51
CM 07541-113707-52
CM 07541-113707-53
CM 07541-113707-54
CM 07541-113707-55
CM 07541-113707-56
CM 07541-113707-57
CM 07541-113707-58
CM 07541-113707-59
CM 07541-113707-60
CM 07541-113707-61
CM 07541-113707-62
CM 07541-113707-63
CM 07541-113707-64
CM 07541-113707-65
CM 07541-113707-66
CM 07541-113707-67
CM 07541-113707-68
CM 07541-113707-69
CM 07541-113707-70
CM 07541-113707-71
CM 07541-113707-72
CM 07541-113707-73
CM 07541-113707-74
CM 07541-113707-75
CM 07541-113707-76
CM 07541-113707-77
CM 07541-113707-78
CM 07541-113707-79
CM 07541-113707-80
CM 07541-113707-81
CM 07541-113707-82
CM 07541-113707-83
CM 07541-113707-84
CM 07541-113707-85
CM 07541-113707-86
CM 07541-113707-87
CM 07541-113707-88
CM 07541-113707-89
CM 07541-113707-90
CM 07541-113707-91
CM 07541-113707-92
CM 07541-113707-93
CM 07541-113707-94
CM 07541-113707-95
CM 07541-113707-96
CM 07541-113707-97
CM 07541-113707-98
CM 07541-113707-99
CM 07541-113707-100

SAN VICENTE CADASTRE
Csd. 860-D, CASE 7
CM 10724 N. 119° 10' E, SEC 2-0
SCALE 1:1000

PROVINCE OF PALAWAN



Republic of the Philippines
Department of Environment and Natural Resources
Region IV
COMMUNITY ENVIRONMENT AND NATURAL RESOURCES OFFICE
Roxas, Palawan

No. _____ Applicant: _____
Lot No. 4593, Cad-860-D Ident. to Lot No. _____
Portion of Lot No. _____ Surveyed for: BAUTISTA, TIBURCIO
Date of Original Survey: July 6-Aug. 8, 1988 Surveyed by: MARIANO Y. FLOTILDES
Area (sq. m.) 125,956.35 Date of Survey: July 6-Aug. 8, 1988
Location: Port Barton, San Vicente, Pal. Date Approved: December 10, 1991

TECHNICAL DESCRIPTION

TIE LINE: S. 40-05 W., 15672.13 m. from BLLM-1, Cad. 860-D, San Vicente cadastre

LINE	BEARINGS	DISTANCE	LINE	BEARINGS	DISTANCE
1 - 2	S. 59 - 27 E.	73.11 m.	11 - 12	S. 21 - 25 W.	23.04 m.
2 - 3	S. 63 - 39 E.	56.36 m.	12 - 13	S. 57 - 27 W.	22.53 m.
3 - 4	S. 76 - 05 E.	122.54 m.	13 - 14	S. 72 - 24 W.	70.56 m.
4 - 5	S. 21 - 54 W.	51.65 m.	14 - 15	S. 88 - 24 W.	93.90 m.
5 - 6	S. 19 - 03 W.	58.83 m.	15 - 16	N. 61 - 59 W.	81.09 m.
6 - 7	S. 05 - 25 E.	12.18 m.	16 - 17	N. 88 - 23 W.	39.52 m.
7 - 8	S. 30 - 26 E.	45.55 m.	17 - 18	N. 54 - 30 W.	35.90 m.
8 - 9	S. 69 - 10 E.	103.33 m.	18 - 19	N. 41 - 14 W.	127.78 m.
9 - 10	S. 81 - 24 E.	37.42 m.	19 - 20	N. 12 - 45 E.	59.25 m.
10 - 11	S. 07 - 47 W.	64.55 m.	20 - 21	N. 51 - 53 W.	46.01 m.

LATITUDE and DEPARTURE FOR
SKETCH

1	-37.16 + 62.96	16	+ 1.11 -39.50
2	-25.02 + 50.50	17	+20.85 -29.23
3	-29.46 + 118.95	18	+96.10 -84.21
4	-47.92 - 19.27	19	+57.79 + 13.08
5	-55.61 - 19.20	20	+28.40 -36.20
6	-12.13 + 1.15	21	+37.41 - 95.96
7	-39.28 +23.07	22	+48.88 - 10.78
8	-36.76 +96.57	23	+21.65 -18.40
9	-5.60 +37.00	24	+ 4.95 - 6.76
10	-63.96 - 8.74	25	+25.72 +25.80
11	-21.45 - 8.41	26	-32.50 +34.87
12	-12.12 -18.99	27	+87.24 + 74.85
13	-21.34 -67.26	28	+ 2.25 + 6.27
14	- 2.61 -93.86	29	-27.52 + 83.29
15	+38.09 -71.59		+470.44 +628.36
			-470.44 -628.36

T.D. Researched by: _____ Date: _____
T.D. Sketched by: _____ Date: _____
T.D. Checked by: _____ Date: _____

NOTE: Sketch on 2nd page

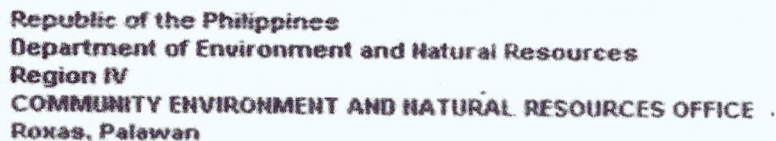

TECHNICAL DESCRIPTION

LINE	BEARINGS	DISTANCE	LINE	BEARINGS	DISTANCE
21 - 22	N.68 - 42 W.	102.99 m.			
22 - 23	N.12 - 26 W.	50.05m.			
23 - 24	N.40 - 22 W.	28.41 m.			
24 - 25	N.53 - 47 W.	8.38 m.			
25 - 26	N.45 - 05 E.	36.43 m.			
26 - 27	S.47 - 01 E.	47.67 m.			
27 - 28	N.40 - 38 E.	114.95 m.	NOTE:	All corners are marked "PS" cyl. Conc. mons.	
28 - 29	N.70 - 16 E.	6.66 m.			
29 - 1	S.71 - 43 E.	87.72 m.			
			CM-10°24'N. 119°10'E.		



SCALE 1 : 6000
BEARINGS : GRID

T.D. Researched by: _____ Date: _____
T.D. Sketched by: _____ Date: _____
T.D. Checked by: _____ Date: 01/05/2022



Republic of the Philippines
Department of Environment and Natural Resources
Region IV- MIMAROPA
COMMUNITY ENVIRONMENT AND NATURAL RESOURCES OFFICE
Barangay III (Poblacion), Roxas, Palawan
Contact No. 09171606578 / 09175028647
Email address: cenroroxaspalawan@denr.gov.ph

MEMORANDUM

For : The CENR Officer
From : The Investigating Officer
SUBJECT : INVESTIGATION REPORT
Date : 19 September 2022

I am submitting this report in compliance with your instruction to conduct investigation on the attached request for Survey Authority.

SUBJECT LAND

The land subject of this investigation is at least half of Lot 4593 of Cad. 860-D in Bgy. Port Barton, San Vicente, Palawan.

CLAIMANT

The claimants include Jerome D. Butikofer, occupant/possessor of the agricultural (A/D) subject hereof.

ACTIVITIES UNDERTAKEN

Upon receipt of the instruction, I immediately conducted the investigation. The following were undertaken:

1. First gathered GPS returns causing verification thereof by the Cartographer on the cadastral map over which the Surveys and Mapping Division (SMD) has overlaid the LC Maps, and prepared the LC Certification based on the findings.
2. The Bgy. Certification secured in support thereof, was validated on site and is evidenced by the geophotographs attached.

FINDINGS AND RECOMMENDATION

Verifications disclosed the following:

1. It is within the agricultural (alienable/disposable) lands subject for confirmation by the Regional Office pursuant to DMC No. 2019-10.
2. It is recommended that LC findings be confirmed and the Survey Authority desired be granted.

RONNIE P. LILANG
Chief, RPS

Copy: file



Portion of Lot 4593 of Cad. 860-D acquired by Jerome D. Butikofer in Bgy. Port Barton, San Vicente, Palawan and is proposed for survey.

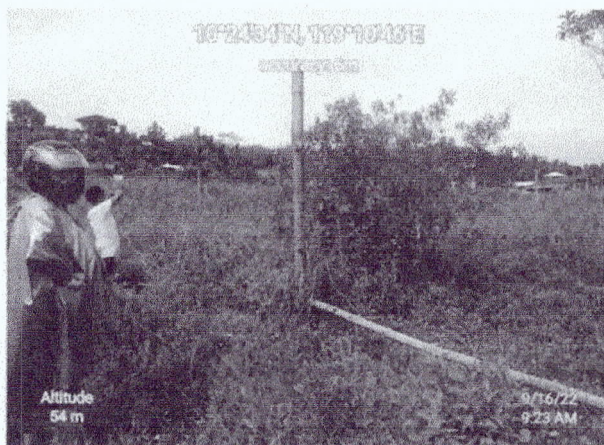

Republic of the Philippines
REGIONAL TRIAL COURT
Fourth Judicial Region
Puerto Princesa City
Email Address: rtc1prpocc@judiciary.gov.ph
Hotline Number: 09289352669

OFFICE OF THE CLERK OF COURT
Hall of Justice, Bgy. Sta. Monica, Puerto Princesa City

CERTIFICATION

TO WHOM IT MAY CONCERN:

THIS IS TO CERTIFY that this Office has no record of any pending/decided land registration case before any branches of this court involving applicant Jerome D. Butikofer covering Lot No. 4593(part), Cad 860-D located at Barangay Port Barton, San Vicente, Palawan.

This Certification is being issued upon the request of Ronnie P. Lilang for the application of survey authority.

At Puerto Princesa City, this 6th day of September 2022.

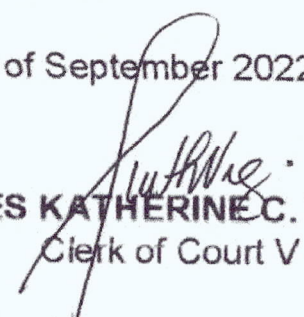
PRINCES KATHERINE C. VERGARA
Clerk of Court V

Cert. Fee: P15.00/35.00/10.00
O.R. No. 8976957/8981156/3709750
Dated: September 6, 2022
zrn



Republic of the Philippines
Department of Environment and Natural Resources
Region IV
COMMUNITY ENVIRONMENT AND NATURAL RESOURCES OFFICE
Roxas, Palawan

REPUBLIC OF THE PHILIPPINES)
PROVINCE OF PALAWAN : S.S.
MUNICIPALITY OF ROXAS)

JOINT AFFIDAVIT

We, Enrico Lagrosa and Bernadette Uapal; both married residents of Bgy. Port Barton, San Vicente, Palawan after having been sworn, hereby depose and state:

1. That we personally know Jerome D. Butikofer who desires survey of Lot 4593(part), Cad. 860-D, in Bgy. Port Barton, San Vicente, Palawan.
2. That we are actual residents of the Barangay of Pot Barton in the Municipality of San Vicente, Palawan;
3. That we are aware of the fact that Mr. Butikofer is claimant and or occupant/possessor of the land described in item 1 hereof;
4. That we are not related to the claimant/representative either by consanguinity or affinity and not, in any way, interested in the land; and
5. That to the best of our knowledge, belief and information, the land is not claimed by adverse others.

IN WITNESS WHEREOF, we have hereunto set our hands this _____th day of August 2022 in the place above first written.

Bernadette C. Uapal
Affiant

CTC No. CC12018 19423097
Issued on 09-02-22
Issued at Roxas, Palawan

Enrico T. Lagrosa
Affiant

CTC No. CC12018 19423096
Issued on 09-02-22
Issued at Roxas, Palawan

SUBSCRIBED AND SWORN to be fore me on the date and place stated above.

JOHN P. LUKANL
Officer Authorized to Administer Oath
Lmora / Chief, Reg. & Permitting
(Position/Designation)



Republic of the Philippines
Province of Palawan
Municipality of San Vicente
Barangay Government of Port Barton

OFFICE OF THE PUNONG BARANGAY

CERTIFICATION

TO WHOM IT MAY CONCERN:

This is to certify that based on the document submitted in this office, A waiver of rights from **ESPERANZA DELMO BUTIKOFER**, Filipino, of legal age, married and a resident of Barangay San Manuel, Puerto, Princesa, City waived, renounce, transfer and convey all her rights, claim, participation and interest including all the improvements of PART of Lot No. 4593 - V covered by TAX Declaration No. 21-008-0909 CAD 860-D consisting of three hundred forty (340) square meters to **JEROME DELMO BUTIKOFER**, Filipino, of legal age, single, and a resident of Sitio Albaguen, Barangay Port Barton, San Vicente, Palawan bonafide resident of Purok Pag-asa, Barangay Port Barton, San Vicente, Palawan.

Certifies Further that the above person is the actual claimant of the said lot area.

This Barangay certification is being issued upon request of the subject person above for her desire to apply of any **TENURIAL INSTRUMENT** from the Department of Environment and Natural Resources office.

Issued this 19th day of August 2022.

JEROME DELMO BUTIKOFER
Requesting Person

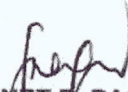
JANET B. PACAUL
Barangay Secretary

O.R. No. : 5912007
Issued on : 8/19/22
Issued at : PBSVP

Noted by:

Hon. ENRICO A. DE JESUS
Punong Barangay

SUBSCRIBED AND SWORN TO BEFORE ME THIS
SEP. 05 2022 AT PUERTO PRINCESA CITY PALAWAN WITH
ESPERANZA D. BUTIKOFER with her Driver's License ID
with NO. D11-13-002287 with photo AS
HIS/HER PERSONAL COMPETENT IDENTITY.

PG. NO. 104
PAGE NO. 22
BOOK NO. XXXI
SERIES OF 2022

ATTY. ALBERT M. PEDROSA
NOTARY PUBLIC
UNTIL DECEMBER 31, 2022
PURSUANT TO BAR MATTER NO. 3795
PTR NO. 0881097/01-04-2022
IBP NO. 184060/02/03/2022
ROLL NO. 53282
MCLE NO. VII-0019467/05-27-2022
NPL NO. 2019-19 / 01-09-2019

P<PHLBUETIKOFER<<JEROME<<<<<<<<<<<<<<<<<<
P5999543B2PHL91D8286M3012202<<<<<<<<<<<<<<<08