



Republic of the Philippines  
**Department of Environment and Natural Resources**  
MIMAROPA Region  
PROVINCIAL ENVIRONMENT AND NATURAL RESOURCES OFFICE  
Bgy. Sta. Monica, Puerto Princesa City, Palawan

Telfax No. (048) 434 - 8791

Email Add: [penropalawan@denr.gov.ph](mailto:penropalawan@denr.gov.ph)

**DENR MIMAROPA  
RECORDS SECTION**

**RECEIVED**

**FEB 07 2023**

☐ INCOMING ☐ OUTGOING

DATE: \_\_\_\_\_ TIME: \_\_\_\_\_

January 30, 2023

**MEMORANDUM**

**FOR :** The Regional Executive Director  
DENR - MIMAROPA Region  
1515 DENR by the Bay Building  
Bgy. 668, Roxas, Blvd., Ermita, Manila

**FROM :** The Provincial Environment and  
Natural Resources Officer

**SUBJECT :** **WATER PERMIT APPLICATION OF AQUATIC BLUE, INC.  
REPRESENTED BY JOAN L. NACIONALES LOCATED IN  
BARANGAY SICSICAN, PUERTO PRINCESA CITY**

Forwarded is the Memorandum from CENRO-Puerto Princesa City dated January 23, 2023 along with the duly accomplished water permit application of Aquatic Blue, Inc. represented by Ms. Joan L. Nacionales with attached enclosures.

Per review and evaluation of this office, the proponent has met/complied the all the requirements for Water Permit Application set by National Water Resource Board (NWRB).

For your information and record.

**FELIZARDO B. CAYATOC**

**DENR-PALAWAN  
PENRO-RECORDS  
RELEASED**  
By: *Ar*  
Date: **01 FEB 2023**  
CN **73-258**





Republic of the Philippines  
Department of Environment and Natural Resources  
MIMAROPA REGION  
PROVINCIAL ENVIRONMENT AND NATURAL RESOURCES OFFICE

WATER PERMIT APPLICATION  
Checklist of Requirements\*  
GROUNDWATER - EXISTING

Purpose: Recreation & Domestic use  
Name of Water Source: Groundwater / Deepwell  
Location of Diversion Point:  
Address: Barangay Sicsican, Puerto Princesa City  
Coordinates (Latitude) 9 - 47 - 58 (Longitude) 118 - 42 - 44  
Name of Applicant: AQUATIC BLUE, INC.  
Name of Representative: Joan L. Nacionales  
Contact Details:  
Mailing Address: Dimalanta Rd., Bgy. Sicsican, Puerto Princesa City  
Mobile/Landline Nos. 0929-471-8467  
Email Address: joannacionales@yahoo.com

REQUIREMENTS		REQUIRED	SUBMITTED	REMARKS
A.	Duly Accomplished Water Permit Application and Notices	✓	✓	
B.	Proof of land ownership, legal title, or right to use, the property where the water source is situated, or approved SLUP, FLAQT, PAMB, etc.	✓	✓	EC No. 074-2019-000024 Joan Labrador Nacionales
C.	Certificate of Registration from relevant agencies: <b>CORPORATION/PARTNERSHIP</b> - SEC Registration with Articles of Incorporation & By-Laws and certificate of latest Corporate Financial Structure issued by the Corporate Secretary <b>SINGLE PROPRIETORSHIP</b> - Certificate of Registration from DTI <b>COOPERATIVE</b> - Certificate of Registration from CDA <b>WATER DISTRICT</b> - Certificate of Conformance from LWUA <b>BARANGAY WATERWORKS ASSOCIATION</b> - Certificate of Registration (SEC)	✓		W/ Lease Agreement SEC Registration Company Reg. No. C6201210024
D.	Vicinity Map/Location Plan with scale 1:10,000 or 1:50,000 or Google Map showing the exact location of the point of diversion	✓	✓	
E.	<b>FOR DEEPWELL:</b> Well drilling data (Pumping Test, Well Log Data). If well data is not available, certification from the applicant on the depth, casing diameter of well, static water level and capacity of motor pump. <b>FOR SPRING SOURCE:</b> Spring discharge measurement	✓	✓	
F.	(1) Potability Test and Bacteriological Test (2) Physical and Chemical Water Analysis, Potability Test (if found negative, attached duly notarized manifestation letter stating water treatment process)	✓	✓	
G.	List of Beneficiaries with their corresponding area (in hectare) and tax declaration certified by Municipal/Provincial Assessor			
H.	General layout of the system, including delineation of area indicating area (in hectare) for which water will be used and adjoining lands and their corresponding owners duly indicated relative to the point of diversion			
I.	Brief Description of the project stating among others, how water will be used, amount of water needed, power to be generated, etc. (For Hydropower Generation - prefeasibility study with hydrology)	✓	✓	
J.	Certificate of Registration from DOE or Certificate of Indorsement and Hydropower Service Contract			
K.	An agreement, MOA/Joint Venture Agreement between private water supplier and the buyer with specific purpose on how water will be used			
L.	Application for Environmental Compliance Certificate or Certificate of Non-Coverage duly received by the DENR	✓	✓	EC-01-K45-2011-0003
M.	Payment for penalty for every well drilled without permit to drill	✓		
N.	Other documents submitted			

\*National Water Resource Board Resolution No. 24-0819 dated August 22, 2019 - 193rd Board Meeting  
(Guidelines on the Implementation of Policy on Streamlining and Process Improvement of NWRB's Frontline Services)

Assessed by:

KARLA KRISTINE V. ABALLA  
Special Investigator I (Name)  
DENR-PENRO Palawan

Noted by:

(Signature over Printed Name)





Repub of the Philippines  
DEPARTMENT OF ENVIRONMENT AND NATURAL RESOURCES  
**COMMUNITY ENVIRONMENT AND NATURAL RESOURCES**  
PUERTO PRINCESA CITY  
South National Highway, Bgy. Sta. Monica, Puerto Princesa City  
TEL Fax No. (048) 717-0702  
Email Address: cenrpuertoprincesa@denr.gov.ph

January 23, 2023

**MEMORANDUM**

FOR : The Regional Executive Director  
DENR-MIMAROPA Region

THRU : The Provincial Environment  
and Natural Resources Officer

FROM : The Community I Environment  
and Natural Resources Officer  
Puerto Princesa City

SUBJECT : **WATER PERMIT APPLICATION OF AQUATIC BLUE,  
INC. REPRESENTED BY JOAN L. NACIONALES LOCATED  
IN BGY. SICSICAN, PUERTO PRINCESA CITY**

**DENR PENRO  
PALAWAN RECORDS  
RECEIVED**

BY: [Signature]  
DATE: 01-25-2023 CN 23-0037

Respectfully forwarded is the Water Permit Application of Aquatic Blue, Inc. represented by Ms. Joan L. Nacionales located in Bgy. Sicscian, Perto Princesa City with the following attached documents:

1. Application Form
2. Proof of Land Ownership
3. Long Term Lease Agreement dated December 11, 2018
4. Site Development Plan/Location Map
5. Brief Description of the Existing Deep Well Project
6. Articles of Incorporation
7. Secretary's Certificate
8. General Information Sheet
9. Physico-Chemical Test Certificate
10. Environmental Compliance Certificate (ECC)
11. Notice of Water Permit Application
12. Map showing the area applied for water use permit with geotagged pictures

The merged shape file of the applied water use permit was forwarded to the GIS Focal Person for populating/updating of the One Control Map of this Office.

For his information, review and further evaluation.

**PEDRO A. VELASCO**

Copy Furnished:

Ms. Joan L. Nacionales  
Aquatic Blue, Inc.  
Bgy. Sicsican, Puerto Princesa City

RPS/eba

**DENR MIMAROPA REGION  
CENRO PUERTO PRINCESA  
RELEASED**  
NO. 390  
DATE: 1-25-23  
BY: [Signature]





**National Water Resources  
Board**

**WATER PERMIT  
APPLICATION  
INVESTIGATION REPORT**

**Water Permit Application  
No.**

**1. Name and Address of Applicant**

**AQUATIC BLUE INC.**

**2. Location of Source  
(Brgy./Municipality/Prov)**

Bgy. Sicsican, Puerto Princesa  
City

**2. Name of source and  
diversion point**

**Groundwater/deepwell**

**4. Purpose**

- ☐ Domestic  
☐ Municipal  
☐ Irrigation  
☐ Power Generation  
☐ Fisheries

- ☐ Livestock Raising  
☐ Industrial  
☐ Recreation -  
☒ Other Use (Specify) – Recreation and domestic

**5. GROUNDWATER SOURCE (Related Data)**

No. of persons to be served 50 persons/day  
Area to be served (hectares) N/A  
Depth of deepwell (meters) 36.6 meters  
Casing Diameter (mm) 50.8  
Pump Setting (m) 5  
Static Water Level (m) 24  
Pumping Water Level (m) 30.40  
Installed Pump (HP) Eurostar  
Deepwell Discharge Capacity 100 liters/minute  
Size/Capacity of Tank 528 gal.  
Pumping hours 8 hours/day

**Is the deepwell drilled?**

☒ YES ☐ NO

**Is the Driller registered?**

☐ YES ☒ NO

**If Yes, state the name of Driller**

**b. Month of low flow**

**March-May**

**8. Comment/Recommendation**

Existing//Recommended for issuance of Water Permit after evaluation and processing of Water Permit Application.

**Prepared by:**

*Eliza B. Aborot*  
**ELIZA B. ABOROT**  
Land Management Officer II /  
WARUS Focal Person

**Checked/Submitted by:**

*Mildred A. Pascual*  
**MILDRED A. PASCUAL**  
LMO II/Chief, Regulation and Permitting Section



Name and Address of NWRB <b>NATIONAL WATER RESOURCES BOARD          (NWRB)</b> 8 <sup>th</sup> Floor, NIA Building, EDSA, Diliman, Quezon	<b>NOTICE OF WATER PERMIT          APPLICATION</b>	
<p>This is to certify that an application of WATER PERMIT with pertinent information included herewith, has been filled with this Office.</p> <p>Any person who may be adversely affected by the proposed appropriation may file with this Office, a written and subscribed protest stating the reasons of his objection.</p>		
1. Name of Applicant  <b>AQUATIC BLUE, INC.</b>	2. Mailing Address  <b>Bgy. Sicsican, Puerto Princesa City</b>	
3. Name of Water Source  <b>Groundwater</b>	4. Method of Diversion  <b>Pump</b>	
5. Location of Diversion Point  <b>Bgy. Sicsican, Puerto Princesa City,          Palawan</b>	6. Water Needed in Liters per Second  <b>10.4 liters/second</b>	
7. Period of Water Use  <b>6 months</b>	8. Purpose  <b>Recreation/Domestic use</b>	



Name and Address of NWRB <b>NATIONAL WATER RESOURCES BOARD          (NWRB)</b> 8 <sup>th</sup> Floor, NIA Building, EDSA, Diliman, Quezon	<b>NOTICE OF WATER PERMIT          APPLICATION</b>
<p>This is to certify that an application of WATER PERMIT with pertinent information included herewith, has been filled with this Office.</p> <p>Any person who may be adversely affected by the proposed appropriation may file with this Office, a written and subscribed protest stating the reasons of his objection.</p>	
1. Name of Applicant  <b>AQUATIC BLUE, INC.</b>	2. Mailing Address  <b>Bgy. Sicsican, Puerto Princesa City</b>
3. Name of Water Source  <b>Groundwater</b>	4. Method of Diversion  <b>Pump</b>
5. Location of Diversion Point  <b>Bgy. Sicsican, Puerto Princesa City,          Palawan</b>	6. Water Needed in Liters per Second  <b>10.4 liters/second</b>
7. Period of Water Use  <b>6 months</b>	8. Purpose  <b>Recreation/Domestic use</b>



Name and Address of NWRB <b>NATIONAL WATER RESOURCES BOARD  (NWRB)</b> <b>8<sup>th</sup> Floor, NIA Building, EDSA, Diliman,  Quezon</b>	<b>NOTICE OF WATER PERMIT  APPLICATION</b>	
<p>This is to certify that an application of WATER PERMIT with pertinent information included herewith, has been filled with this Office.</p> <p>Any person who may be adversely affected by the proposed appropriation may file with this Office, a written and subscribed protest stating the reasons of his objection.</p>		
1. Name of Applicant  <b>AQUATIC BLUE, INC.</b>	2. Mailing Address  <b>Bgy. Sicsican, Puerto Princesa City</b>	
3. Name of Water Source  <b>Groundwater</b>	4. Method of Diversion  <b>Pump</b>	
5. Location of Diversion Point  <b>Bgy. Sicsican, Puerto Princesa City,  Palawan</b>	6. Water Needed in Liters per Second  <b>10.4 liters/second</b>	
7. Period of Water Use  <b>6 months</b>	8. Purpose  <b>Recreation/Domestic use</b>	

Name and Address of NWRB <b>NATIONAL WATER RESOURCES BOARD  (NWRB)</b> 8 <sup>th</sup> Floor, NIA Building, EDSA, Diliman, Quezon	<b>NOTICE OF WATER PERMIT  APPLICATION</b>	
<p>This is to certify that an application of WATER PERMIT with pertinent information included herewith, has been filled with this Office.</p> <p>Any person who may be adversely affected by the proposed appropriation may file with this Office, a written and subscribed protest stating the reasons of his objection.</p>		
1. Name of Applicant  <b>AQUATIC BLUE, INC.</b>	2. Mailing Address  <b>Bgy. Sicsican, Puerto Princesa City</b>	
3. Name of Water Source  <b>Groundwater</b>	4. Method of Diversion  <b>Pump</b>	
5. Location of Diversion Point  <b>Bgy. Sicsican, Puerto Princesa City,  Palawan</b>	6. Water Needed in Liters per Second  <b>10.4 liters/second</b>	
7. Period of Water Use  <b>6 months</b>	8. Purpose  <b>Recreation/Domestic use</b>	



Name and Address of NWRB <b>NATIONAL WATER RESOURCES BOARD (NWRB)</b> <b>8<sup>th</sup> Floor, NIA Building, EDSA, Diliman, Quezon</b>	<b>NOTICE OF WATER PERMIT APPLICATION</b>
<p>This is to certify that an application of WATER PERMIT with pertinent information included herewith, has been filled with this Office.</p> <p>Any person who may be adversely affected by the proposed appropriation may file with this Office, a written and subscribed protest stating the reasons of his objection.</p>	
1. Name of Applicant  <b>AQUATIC BLUE, INC.</b>	2. Mailing Address  <b>Bgy. Sicsican, Puerto Princesa City</b>
3. Name of Water Source  <b>Groundwater</b>	4. Method of Diversion  <b>Pump</b>
5. Location of Diversion Point  <b>Bgy. Sicsican, Puerto Princesa City, Palawan</b>	6. Water Needed in Liters per Second  <b>10.4 liters/second</b>
7. Period of Water Use  <b>6 months</b>	8. Purpose  <b>Recreation/Domestic use</b>

Name and Address of NWRB <b>NATIONAL WATER RESOURCES BOARD          (NWRB)</b> 8 <sup>th</sup> Floor, NIA Building, EDSA, Diliman, Quezon		<b>NOTICE OF WATER PERMIT          APPLICATION</b>
This is to certify that an application of WATER PERMIT with pertinent information included herewith, has been filled with this Office.		
Any person who may be adversely affected by the proposed appropriation may file with this Office, a written and subscribed protest stating the reasons of his objection.		
1. Name of Applicant  <b>AQUATIC BLUE, INC.</b>	2. Mailing Address  <b>Bgy. Sicsican, Puerto Princesa City</b>	
3. Name of Water Source  <b>Groundwater</b>	4. Method of Diversion  <b>Pump</b>	
5. Location of Diversion Point  <b>Bgy. Sicsican, Puerto Princesa City,          Palawan</b>	6. Water Needed in Liters per Second  <b>10.4 liters/second</b>	
7. Period of Water Use  <b>6 months</b>	8. Purpose  <b>Recreation/Domestic use</b>	



**PICTURES TAKEN DURING THE CONDUCT OF OCULAR INSPECTION ON  
NOVEMBER 17, 2022**





PICTURES TAKEN DURING THE CONDUCT OF OCULAR INSPECTION ON  
NOVEMBER 17, 2022





118°37'30"E

118°40'0"E

118°42'30"E

118°45'0"E

## TECHNICAL DESCRIPTION

LOCATION	LONGITUDE	LATITUDE
Brgy. Sicsican, Puerto Princesa City	118°42'43.92"	9°47'54.96"

9°55'0"N

9°52'30"N

9°50'0"N

9°47'30"N

9°45'0"N

9°42'30"N

0 750 500 3,600  
Meters

Scale: 1:150,000

Datum: D\_WGS\_1984

Projection: Transverse\_Mercator

Projected Coordinate System: WGS\_1984\_UTM\_Zone\_50N

Source: Esri, Max  
Geographics, Inc.

118°37'30"E

118°40'0"E

118°42'30"E

118°45'0"E





**AQUATIC BLUE INC.  
DIMALANTA RD. BRGY. SICSICAN  
PUERTO PRINCESA CITY  
PALAWAN, 5300**

Mr. Pedro A. Velasco  
DMO IV/OIC-CENRO  
Sta. Monica  
Puerto Princesa City  
Palawan, 5300



Dear Mr. Velasco,

Respectfully submitting the following documents as requirement for Water Permit application.

1. Application form
2. Proof of lease agreement with Certificate of no objection from the land owner
3. Vicinity map (Location Plan)
4. Brief description of the project
5. Well drilling data
6. SEC certificate
7. ECC

Thank you for your kind consideration.

Best regards,

*Joan L. Nacionales*  
Joan L. Nacionales  
Representative  
Aquatic Blue Inc.  
Contact # 09294798467



 <p>Republic of the Philippines  <b>NATIONAL WATER RESOURCES BOARD</b>        8th Floor, NIA Building, EDSA, Diliman, Quezon City</p>		<b>WATER PERMIT APPLICATION</b> No. _____ Filed in the Office of _____ Date _____	
BEFORE ACCOMPLISHING THIS FORM IN QUADRUPLICATE, READ THE ACCOMPANYING INSTRUCTIONS			
1. Name of Applicant <b>AQUATIC BLUE INC.</b> REPRESENTATIVE BY: <b>JOAN L. NACONALES</b>		5. Filing & Legal Research fee Payable to National Water Resources Board a. Phil. Postal Money Order Nos. _____ b. NWRB Official Receipt No. _____ Date _____	
2. Mailing Address <b>DIMALANTA RD. BRGY. SICSICAN, PUERTO PRINCESA CITY</b>			
2a. Telephone No. <b>09294798407</b>			
3. Tax Account No. <b>446-802-607-000</b>	4. Citizenship <b>FIL</b>	Email Address <b>joannacionales@yahoo.com</b>	
6. Name of Water Source <b>GROUND WATER</b>	7. Location of Diversion Point <b>DIMALANTA RD. BRGY. SICSICAN PPG</b>	8. Method of Diversion <b>DEEP WELL</b>	
9. Months of Low-Flow <b>MARCH - MAY</b>	10. Water Needed in Liters/Second <b>0.017 L/S</b>	11. Purpose <b>RECREATIONAL</b>	
12. If for Agriculture, Area of Land and Crops Raised _____		13. If for Domestic Water Supply, Population Served <b>50 persons/day</b>	
14. If for Industry, Brief Description on how Water will be Used <b>GARDENING, CLEANING, GUEST, FISH SPA</b>	15. If for Power, Rated Capacity in Kilowatts _____	16. Other Uses _____	
17. Name of Person/s Holding or Claiming Rights to the Use of Water including the Amount and Nature of Use Downstream and Upstream of Proposed Point of Diversion <b>AQUATIC BLUE INC.</b>			
I hereby certify that the information given above and in documents submitted are true and correct to the best of my knowledge and belief. Signature of Applicant <b>Joan L. Nacionales</b> PRC # <b>0694095</b> Series of <b>20 22</b>		Subscribed and sworn to before me on this date <b>SEP 05 2022</b> <b>ATTY. ZOILO C. CRUZAT</b> Notary Public Until December 31, 2023 PTR No. 1625821 01.03.22 PPG ATTORNEY'S Roll No. 28094 B.P. O.R. No. 184273 02/03/2022 TIN - 113-299-352 MCLE COMPLIANCE NO. <b>VL-0017951</b> May 13, 2022 - PASIG CITY indicating that the above-mentioned works are in accordance with the approved plans and specifications. E-mail address: <b>atty.zoi@yanhico.com</b> Cell Phone No. <b>09175435513</b>	
<b>TO BE FILLED BY NWRB AGENT</b>			
18. CHECKLIST on General Information and Description a. <input checked="" type="checkbox"/> Ownership/right to land established b. <input checked="" type="checkbox"/> Citizenship as a Filipino established c. <input checked="" type="checkbox"/> Brief description of proposed project/development d. <input checked="" type="checkbox"/> Location plan of water source and point of diversion using a scale of 1:50,000		e. <input checked="" type="checkbox"/> Location plan of water source and point of diversion indicating that the above-mentioned works are in accordance with the approved plans and specifications. f. <input checked="" type="checkbox"/> Certification of incorporation of the applicant as an association or corporation g. <input type="checkbox"/> Other information as specified under Sect. 4 Rules and Regulations implementing the Water Code	
19. Diversion Point Latitude: <b>9-47-55</b> Longitude: <b>118-42-44</b>		20. Possible adverse effect to public and/or private interest: _____	
Prepared by: <b>ELIZA B. ABOROT</b> LAND MANAGEMENT OFFICER II		Submitted by: <b>MILDRED A. PASCUAL</b> MD/1/CHIEF, REGULATION & PERMITTING SECTION	
Date: _____			
21. Water Discharge (To be filled by NWRB Hydrologist/Staff)			
a. 80% of time equalled or exceeded	b. Mean of monthly discharge L/S	c. Amount of Water recommended for approval	
22. Other comments and recommendations:			
Prepared by: Date:		Submitted by: Date:	



## LONG TERM LEASE AGREEMENT

KNOW ALL MEN BY THESE PRESENTS:

This Long Term Lease Agreement is entered into this December 11, 2018 between:

JOAN LABRADOR NACIONALES, Filipino, of legal age, single, with address at Lagan St., Bgy. Tanglaw, PPC (LESSOR); and

AQUATIC BLUE INCORPORATED, a corporation organized and existing under and by virtue of the laws of the Republic of the Philippines, with principal place of business at Barangay Sicsican, Puerto Princesa City, herein represented by its Corporate Secretary, SYDNEY U. COMIA, (LESSEE)

### WITNESSETH THAT:

LESSOR is lawful and legitimate owner of two (2) the parcels of raw land located at Barangay Sicsican, Puerto Princesa City;

LESSEE seeks to undertake the commencement of its business venture and has identified the lots owned by LESSOR as the most suitable;

NOW, THEREFORE, for and in consideration of the foregoing premises and the covenants hereinafter stipulated, the parties hereby agree as follows:

### ARTICLE I - PROPERTY FOR LEASE

1. The LESSOR hereby transfer and convey by way of LEASE in favor of the LESSEE the PROPERTY consisting of two (2) parcels of land located in Barangay Sicsican, Puerto Princesa City, thus: (a) 2,116 SQM of land covered by TCT 074-2018000624 identified as Lot 596-B-1, Psd-04-193629 registered in the name of Joan Nacionales; and (b) 435 SQM parcel of land which is a portion TCT No. 185648 (Lot F-PSD-04-206299) registered in the name of Lorena J. Española which was purchased by Joan Nacionales as per Deed of Absolute Sale dated March 6, 2018 recorded as Doc. No. 435; Page 88; Book II; Series 2018 in the notarial register of Atty. Winston T. Gonzales, hereafter the PROPERTY;
2. Inspection; No Warranty. - The lease is on "AS IS, WHERE IS" basis. The LESSEE hereby declares that it has inspected the PROPERTY prior to the execution of this Long Term Lease Agreement, and acknowledges that it is fully satisfied with the conditions thereof. The LESSOR makes no warranty as to the condition, operational or environmental suitability of the PROPERTY which the LESSEE warrants to know by virtue of the LESSEE's duty to inspect.

### ARTICLE II - CONSIDERATION

3. Rental Payment. - The rental payment shall be at the rate of Php10,000 per month for the first 10 years of this Agreement. Beginning the 11<sup>th</sup> year, the rent shall increase by 10% every five (5) years until the termination of this agreement. LESSEE shall tender to the LESSOR the full amount of the annual rental on or before the 10<sup>th</sup> day of January every year.



### ARTICLE III - TERM OF LEASE

4. Term. - This Long-Term Lease Agreement shall be for TWENTY-FIVE (25) YEARS, renewable upon mutual agreement of parties, and shall commence on January 10, 2019 upon payment of the full rental for 2019.
5. Pre-Termination. - The PARTIES may pre-terminate this Agreement at any time provided written notice thereof is given to the other party at least SIX (6) MONTHS before the effective date of pre-termination.

As regards the improvements at pre-termination, the rights and obligations of the parties shall be governed by the provisions of the New Civil Code and relevant jurisprudence.

### ARTICLE IV - PURPOSE OF THE LEASE

6. Use of the leased Premises - The LESSEES shall have full dominion over the PROPERTY and the use of the same shall be in accordance with their sound discretion.
7. Sub-Lease. - The LESSEE may sub-lease the PROPERTY or any portion thereof during the period of this Agreement but the sub-lease shall be co-terminus with this Agreement.

### ARTICLE V - MISCELLANEOUS

8. Fire Hazard and Noxious Substances. - The LESSEES shall not introduce, keep, deposit or store in the PROPERTY any noxious substance or inflammable material which are not reasonably connected with the herein stated purpose of the lease which might constitute a fire hazard.
9. Transfer of Rights. - The LESSEE may assign or transfer or encumber their rights under this lease even without the prior consent of the LESSORS. Likewise, with the LESSOR.

Should the LESSOR transfer, convey, assign and encumber their right, title or interest thereto or therein, the same shall not prejudice the rights of the LESSEE under this Agreement.

10. Indemnity. - The LESSEE shall hold LESSOR free and harmless from any loss, damage, injury suffered by the LESSEE, its agents or employees, clients, guests or customers or other third persons arising out of the use of the PROPERTY by LESSEES, its agents, employees, clients, guests, or customers including but not limited to, claims for property damage, personal injury or wrongful death, or losses or damages occasioned by reason of any event or cause which could not be foreseen, or which, though foreseen were inevitable such as but not limited to fire, earthquake, lightning, typhoons, flood, volcanic eruption, other calamities.
11. Binding Effect. - This Agreement shall be binding upon the parties' transferees, assigns, successors-in-interest.
12. Non-Waiver. - The failure of either the LESSOR or the LESSEE to insist upon a strict performance of any of the terms, conditions and covenants hereof shall not be deemed a relinquishment or waiver of any of the rights or remedies that they may have, nor shall it be construed as a waiver of any subsequent breach or default of its terms, conditions and covenants which shall continue to be in full force and effect. No waiver by the LESSOR or LESSEE of their rights under this Lease Agreement shall be deemed



to have been made unless expressed in writing and signed by the parties or their successors-in-interest.

IN WITNESS WHEREOF, the parties have set their hands and affixed their signatures this  
in the City of Puerto Princesa, Philippines.

LESSOR: *Joan Nacionales*  
JOAN LABRADOR NACIONALES  
TIN 183—096-172

LESSEE: AQUATIC BLUE INCORPORATED  
Represented By:

*Sydney Ustares Comia*  
SYDNEY USTARES COMIA

Witnesses: *Boris de Bernard de Fauconval de Deuken*  
BORIS DE BERNARD DE FAUCONVAL DE DEUKEN  
Belgian Passport No.EP631363

*Micha Hildner*  
MICHA HILDNER  
C4KCJTVXY

ACKNOWLEDGMENT

BEFORE ME, a Notary Public for and in the City of Puerto Princesa personally appeared Joan Nacionales with her competent evidence of identity mentioned below her name, whom I have identified to be the same persons who executed the foregoing Long-term Lease Agreement, and who represented to me her signature on the foregoing instrument is voluntarily affixed by them for the purpose stated in the instrument and who declared that they have executed the foregoing instrument as their free and voluntary act and deed.

This LONG TERM LEASE AGREEMENT consists of three (3) pages, including this page in which this acknowledgment is written, duly signed by the parties and their instrumental witnesses on each and every page hereof.

WITNESS MY HAND AND SEAL this **DEC 11 2018** at PPC, Philippines.

*[Signature]*  
DOC. NO. 424  
PAGE NO. 86  
BOOK NO. XV  
SERIES OF 2018



*[Signature]*  
ATTY. ANALISSA VALENCIA NAVARRO-PADON  
NOTARY PUBLIC FOR PALAWAN & PPC  
ROLL NO. 57502; IBP LIFE 09896  
2018-51; PTR 2788264  
UNTIL DEC. 31, 2019



**March 9, 2022**

I Joan L. Nacionales, 32 y.o., married, resident of Paduga rd. Brgy. San Jose, Puerto Princesa City, Palawan. Owner of 2 parcel land rented out by Aquatic Blue Inc. located in Dimalanta Rd. Brgy. Sicsican, Puerto Princesa City, Palawan with TCT # 074-2018000624 and TCT# 074-2019000434. I hereby declare, as the owner of the land I have no objection setting up deep well as one of their project situated in the said land area.

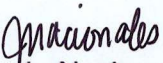
  
Joan L. Nacionales



TT44059709102

REPUBLIC OF THE PHILIPPINES  
DEPARTMENT OF JUSTICE  
**Land Registration Authority**  
QUEZON CITY

Registry of Deeds for Puerto Princesa City

**Transfer Certificate of Title**

OWNER'S DUPLICATE • OWNER'S DUPLICATE • OWNER'S DUPLICATE • OWNER'S DUPLICATE • OWNER'S DUPLICATE

**No. 074-2018000624**

IT IS HEREBY CERTIFIED that certain land situated in BRGY. OF SICSICAN, CITY OF PUERTO PRINCESA, PROVINCE OF PALAWAN; ISLAND OF PALAWAN, more particularly bounded and described as follows:  
LOT 596-B-1 PSD-04-193629 A PARCEL OF LAND (LOT 596-B-1 OF THE SUBD. PLAN PSD-04-193629 BEING A PORTION OF LOT 596-B, PSD-4A-012495; L.R.C. RECORD NO. ), SITUATED IN THE BRGY. OF SICSICAN, CITY OF PUERTO PRINCESA, PROVINCE OF PALAWAN; ISLAND OF PALAWAN. BOUNDED ON THE SE., (Continued on next page)

is registered in accordance with the provision of Section 103 of the Property Registration Decree in the name of

**Owner:** JOAN LABRADOR NACIONALES, OF LEGAL AGE, FILIPINO, SINGLE  
**Address:** 332 LAGAN ST., TANGLAW, PUERTO PRINCESA CITY, PALAWAN  
MIMAROPA

subject to the provisions of the said Property Registration Decree and the Public Land Act, as well as to those of the Mining Laws, if the land is mineral, and subject, further, to such conditions contained in the original title as may be subsisting.

IT IS FURTHER CERTIFIED that said land was originally registered as follows:

**Patent Type:** Homestead Patent

**Patent Date:** 09/09/1952

**Under Act No.:** 496

**Volume No.:** 3

**Original Owner:**

**Original RD:** PROVINCE OF PALAWAN

**OCT Date:** 10/16/1952

**OCT No.:** OCT-G-804

**Page No.:** 95

This certificate is a transfer from TRANSFER CERTIFICATE OF TITLE 185973 (TOTALLY CANCELLED) by virtue hereof in so far as the above-described land is concerned.

Entered at Puerto Princesa City, Philippines on  
the 8th day of MARCH 2018 at 10:54am.

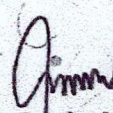
  
Atty. Ma. Rachel Fe Fabros-Dilig  
Register of Deeds

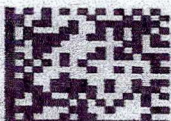



TCT No.: 074-2018000624

Page No.: 2

**TECHNICAL DESCRIPTION** (Continued from page 1)

ALONG LINE 1-2 BY LOT 596-B-2 OF THE SUBD. PLAN; ON THE SW., ALONG LINE 2-3 BY PROPERTY OF JOSE PUNGOL; ON THE NW., ALONG LINE 3-1 BY LOT 595, PLS 110, PUERTO PRINCESA PUBLIC LAND SUBDIVISION. BEGINNING AT A POINT MARKED "1" ON PLAN BEING S. 78 DEG. 54' E., 1,775.04 M. FROM BLBM NO. 1, PLS 110 PUERTO PRINCESA PUBLIC LAND SUBDIVISION THENCE S. 17 DEG. 13' W., 89.43 M. TO POINT 2; THENCE N. 20 DEG. 21' W., 77.63 M. TO POINT 3; THENCE N. 76 DEG. 39' E., 54.92 M. TO POINT OF; BEGINNING CONTAINING AN AREA OF TWO THOUSAND ONE HUNDRED SIXTEEN (2,116) SQ. M. ALL POINTS REFERRED TO ARE INDICATED ON PLAN MARKED ON THE GROUND BY P.S. CYL. CONC. MONS 15X60 CM; BEARING TRUE DATE OF ORIGINAL SURVEY; APRIL 5, 1941 AND THAT OF THE SUBDIVISION SURVEY; DECEMBER 1, 2005 AND WAS APPROVED ON; APRIL 18, 2008

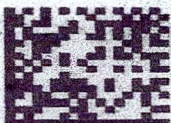



2018021682601

REPUBLIC OF THE PHILIPPINES  
DEPARTMENT OF JUSTICE  
**Land Registration Authority**  
QUEZON CITY

Registry of Deeds for Puerto Princesa City

**Transfer Certificate of Title**

OWNER'S DUPLICATE - OWNER'S DUPLICATE - OWNER'S DUPLICATE - OWNER'S DUPLICATE - OWNER'S DUPLICATE

**No. 074-2019000434**

IT IS HEREBY CERTIFIED that certain land situated in SICISICAN, PUERTO PRINCESA PALAWAN, more particularly bounded and described as follows:

LOT NO: F-1-F, PLAN NO: PSD-4B-009090

PORTION OF: LOT F-1 PSD-4B-002768

LOCATION: SICISICAN, PUERTO PRINCESA PALAWAN (Continued on next page)

is registered in accordance with the provision of Section 103 of the Property Registration Decree in the name of

Owner: JOAN L. NACIONALES, OF LEGAL AGE, FILIPINO, SINGLE

Address: NO. 332 LAGAN STREET, BRGY. TANGLAW, PUERTO PRINCESA CITY, PALAWAN MIMAROPA

subject to the provisions of the said Property Registration Decree and the Public Land Act, as well as to those of the Mining Laws, if the land is mineral, and subject, further, to such conditions contained in the original title as may be subsisting.

IT IS FURTHER CERTIFIED that said land was originally registered as follows:

Patent Type: Free Patent

Patent Date: 10/11/1983

Under Act No.: PD. 1529

Volume No.: 9

Original Owner:

Original RD: PUERTO PRINCESA CITY

OCT Date: 12/28/1983

OCT No.: OCT-894

Page No.: 94

This certificate is a transfer from TRANSFER CERTIFICATE OF TITLE 2018000607 (TOTALLY CANCELLED) by virtue hereof in so far as the above-described land is concerned.

Entered at Puerto Princesa City, Philippines on the 3rd day of JANUARY 2019 at 03:38pm.

Atty. Ma. Rachel Fe Fabros-Dilig  
Register of Deeds





TCT No.: 074-2019000434

Page No.: 2

2018021682602

**TECHNICAL DESCRIPTION** (Continued from page 1)

**BOUNDARIES:**

LINE	DIRECTION	ADJOINING LOT(S)
1-2	NE	LOT F-1-E, PSD-4B-009090
2-3	NE	STREET,
3-4	SW	LOT F-1-G, PSD-4B-009090
4-5-6-1	SW, NW, NE	LOT F-1-I, PSD-4B-009090 (ROAD 8.00M. WIDE),

**TIE POINT:** BLBM NO. 1, BO. OF IRAWAN, MUNICIPALITY OF PUERTO PRINCESA, PROVINCE OF PALAWAN

TO CORNER	LINE	BEARING	DISTANCE
1	1	S. 77° 31' E	1722.80 M.
1-2	1-2	S. 84° 18' E	14.88 M.
2-3	2-3	S. 20° 21' E	23.13 M.
3-4	3-4	N. 84° 18' W	23.12 M.
4-5	4-5	N. 10° 36' W	19.15 M.
5-6	5-6	N. 42° 33' E	3.00 M.
6-1	6-1	S. 84° 19' E	1.67 M.

**AREA:** FOUR HUNDRED THIRTY FIVE (435) SQUARE METERS, MORE OR LESS  
**DESCRIPTION OF CORNERS:** ALL CORNERS ARE PS CYL. CONC. MONS.

15X40 CMS,

**BEARINGS:** GRID

**DECLINATION:**

**DATE OF ORIGINAL SURVEY:** JAN. 13, 1937

**DATE OF SUBD/CONS SURVEY:** MARCH 4, 2016

**DATE APPROVED:** MARCH 19, 2017

**GEODETIC ENGINEER:** RONILO U. LIAO JR.

**NOTES:**

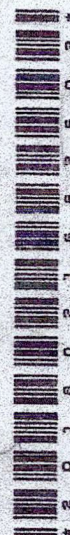





## **BRIEF DESCRIPTION OF OUR EXISTING DEEP WELL PROJECT**

Aquatic Blue Inc. applying for water permit for the purpose to use deep well as a water source for the establishment: guest, gardening, cleaning and fish spa.  
Regular annual/quarterly test to be done as recommended and regular maintenance of deep well equipments to prevent water contamination and water pollution.

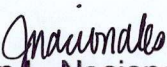
  
Joan L. Nacionales  
Representative  
Aquatic Blue Inc.



REPUBLIC OF THE PHILIPPINES )  
CITY OF PUERTO PRINCESA ) SS

SECRETARY'S CERTIFICATE

I, SYDNEY U. COMIA, Filipino, of legal age, the duly elected and qualified Corporate Secretary of AQUATIC BLUE INCORPORATED (hereinafter referred to as the Corporation), a corporation organized and existing under and by virtue of the laws of the Republic of the Philippines, with address at the Bgy. Sicsican, Puerto Princesa City, after being duly sworn in accordance with law, I hereby depose and certify that:

1. At the first meeting of the board of directors of the Corporation held on June 30, 2018, at 332 Lagan St., Barangay Tanglaw, Puerto Princesa City., Puerto Princesa City, during which meeting a quorum was present and acted throughout, an election of officers was held, the following were duly elected and qualified:  
JOAN L. NACIONALES - President, Chairman  
SYDNEY U. COMIA - Corporate Secretary  
BORIS DE BERNARD DE FAUCONVAL DE DEUKEN - Treasurer

2. It was also during said meeting that the following Board Resolutions were unanimously passed and approved, to wit:

Board Resolution No.1-2018

*A Resolution designating and appointing JOAN L. NACIONALES as the REPRESENTATIVE OF THE CORPORATION to negotiate transactions and to sign for and in-behalf of the corporation relative to the corporation's business venture/undertaking*

Board Resolution No. 2-2018

*A Resolution designating VANGIE DOMINGO RAMOS as the attorney-in-fact of the corporation to apply for the corporation's Mayor's Permit with the barangay and the City Government of Puerto Princesa, to secure the necessary registration and clearance from SSS, HDMF (Pag-ibig), PhilHealth and BIR.*

3. I hereby certify that the foregoing corporate acts are in full force and effect and that they have not been revoked, amended or cancelled.

At Puerto Princesa City. June 30, 2018

SYDNEY U. COMIA  
Corporate Secretary

SUBSCRIBED & SWORN TO before me on the date and place above-written by Sydney Comia with UMID CRN-0111-1029624-0.

JUC. NO. 36  
PAGE NO. 9  
BOOK NO. XV  
SERIES OF 2018



ANALISSA VALENCIA NAVARRO-PALMON  
NOTARY PUBLIC FOR PALAWAN & PPC  
ROLL NO. 57502; IBP LIFE 09896  
2018-51; PTR 2788264  
UNTIL DEC. 31, 2019



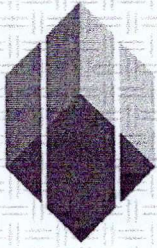

REPUBLIC OF THE PHILIPPINES  
SECURITIES AND EXCHANGE COMMISSION  
PICC Secretariat Bldg., PICC Complex  
Pasay City, Metro Manila

COMPANY REG NO. CS201810086

**CERTIFICATE OF INCORPORATION**

KNOW ALL PERSONS BY THESE PRESENTS:

This is to certify that the Articles of Incorporation and By Laws of:

**AQUATIC BLUE INCORPORATED**

were duly approved by the Commission on this date upon the issuance of this Certificate of Incorporation and By Laws in accordance with the Corporation Code of the Philippines (Batas Pambansa Blg. 68), and copies of said Articles and By Laws are hereto attached.

This Certificate grants juridical personality to the corporation but does not authorize it to issue, sell or offer for sale to the public, securities such as but not limited to, shares of stock, investment contracts, debt instruments and virtual currencies without a prior Registration Statement approved by the Securities and Exchange Commission; nor to undertake business activities requiring a Secondary License from this Commission such as but not limited to acting as: broker or dealer in securities, government securities eligible dealer (GSED), investment adviser of an investment company, close-end or open-end investment company, investment house, transfer agent, commodity/ financial futures exchange/broker/merchant, financing/lending company, and time shares/club shares/ membership certificate issuers or selling agents thereof; nor to operate a fiat money to virtual currency exchange. Neither does this Certificate constitute a permit to undertake activities for which other government agencies require a license or permit.

As a registered corporation, it shall submit annually to this Commission the reports indicated at the back of this Certificate. Failure to submit annual Financial Statements and General Information Sheets within two (2) years from date of incorporation shall be construed that the corporation has not been formally organized and has not commenced the transaction of its business, thus be subject of Suspension Order.

IN WITNESS WHEREOF, I have hereunto set my hand and caused the seal of this Commission to be affixed to this Certificate at PICC Secretariat Bldg., PICC Complex Pasay City, Metro Manila, Philippines, this day of 11, June, Twenty Eighteen.

  
FERDINAND B. SALES

Director

Company Registration and Monitoring Department





## **BRIEF DESCRIPTION OF OUR EXISTING DEEP WELL PROJECT**

Aquatic Blue Inc. applying for water permit for the purpose to use deep well as a water source for the establishment: guest, gardening, cleaning and fish spa.  
Regular annual/quarterly test to be done as recommended and regular maintenance of deep well equipments to prevent water contamination and water pollution.

*Joan L. Nacionales*  
Joan L. Nacionales  
Representative  
Aquatic Blue Inc.





# DEEP WELL WATER SYSTEM

SCALE: DNTS

**SECRETARY ACT 545**  
This drawing as an instrument of service is the property of THE AUTHOR, a registered architect and as such must not be reproduced or copied in part or in whole without the written consent of THE AUTHOR.  
**PROFESSIONAL DRAWING NO. 49**  
"Protection of Intellectual Property" works of Art Architecture, Models and Designs are creative works and considered as part of the intellectual property of the Author









Republic of the Philippines  
**PROFESSIONAL REGULATION COMMISSION**  
 PROFESSIONAL IDENTIFICATION CARD



LAST NAME	▶ MAZA
FIRST NAME	▶ JAMES BRAINERD
MIDDLE NAME	▶ RADAM
REGISTRATION NO.	▶ 0136338
REGISTRATION DATE	▶ 12/17/2014
VALID UNTIL	▶ 08/24/2024

CIVIL ENGINEER



Professional Regulation Commission  
[www.prc.gov.ph](http://www.prc.gov.ph)

CERTIFICATION

19-3232029

This is to certify that the person whose name, photograph, and signature appear herein is a duly registered professional, legally authorized to practice his/her profession with all the rights and privileges appurtenant thereto.

This is to certify further that he/she is a professional in good standing and that his/her certificate of registration/professional license has not been suspended, revoked or withdrawn.



Signature of Professional
 

TEOFILO S. PILANDO, JR.  
 Chairman

fzf  
 fzf  
 fzf





Republic of the Philippines  
Department of Environment and Natural Resource  
**ENVIRONMENTAL MANAGEMENT BUREAU**

1515 L and S Building, Roxas Boulevard, Pasay City  
Telephone No.(02) 400-5960 Fax No.(02) 400-5960  
mimaropa@emb.gov.ph and emb\_mimaropa@yahoo.com  
Visit us at <http://www.mimaropa.emb.gov.ph/>

May 14, 2019

ECC-OL-R4B-2019-0093

**MS. JOAN NACIONALES**

President

**AQUATIC BLUE INCORPORATED**

Brgy. Sicsican, Puerto Princesa City, Palawan

Subject: **ENVIRONMENTAL COMPLIANCE CERTIFICATE**

Dear Mr. *Nacionales*;

This refers to the Environmental Compliance Certificate (ECC) application for the **AQUATIC BLUE INCORPORATED - DOG CAFE AND SPA PROJECT** to be located at Brgy. Sicsican, Puerto Princesa City, Palawan.

After satisfying the requirements of the said application, this Bureau has decided to grant an ECC for the above-mentioned project.

With the issuance of this ECC, you are expected to implement the measures presented in the Initial Environmental Examination Checklist (IEEC), intended to protect and mitigate the project's adverse impacts on community health, welfare and the environment. Environmental considerations shall be incorporated in all phases and aspects of the project. You may proceed with the project implementation after securing all the necessary permits from other pertinent Government agencies. This Office will be monitoring the project periodically to ensure your compliance with stipulations cited in the attached ECC.

Please be guided accordingly.

**Atty. Michael Drake P. Matias**

Regional Director



REPUBLIC OF THE PHILIPPINES  
DEPARTMENT OF TRANSPORTATION  
LAND TRANSPORTATION OFFICE  
NON-PROFESSIONAL DRIVER'S LICENSE



Last Name, First Name, Middle Name  
**NACIONALES, JOAN LABRADOR**

Nationality	Sex	Date of Birth	Weight (kg)	Height(m)
PHL	F	1989/09/14	38	1.50

Address  
332 LAGAN ST TANGLAW PPCITY PALAWAN

License No.	Expiration Date	Agency Code
D11-18-004340	2022/09/14	D11

Blood Type	Eyes Color
O+	BLACK

Restrictions	Conditions
2	NONE

Signature of Licensee: *J. Nacionales*

EDGAR C. GALVANTE  
Assistant Secretary

*Nacionales*



<b>GENERAL INFORMATION SHEET (GIS)</b> <b>FOR THE YEAR 2022</b> <b>STOCK CORPORATION</b>			
<b>GENERAL INSTRUCTIONS:</b> 1. FOR USER CORPORATION: THIS GIS SHOULD BE SUBMITTED WITHIN THIRTY (30) CALENDAR DAYS FROM THE DATE OF THE ANNUAL STOCKHOLDERS' MEETING. DO NOT LEAVE ANY ITEM BLANK. WRITE "N.A." IF THE INFORMATION REQUIRED IS NOT APPLICABLE TO THE CORPORATION OR "NONE" IF THE INFORMATION IS NON-EXISTENT. IF THE ANNUAL STOCKHOLDERS' MEETING IS HELD ON A DATE OTHER THAN THAT STATED IN THE BY-LAWS, THE GIS SHALL BE SUBMITTED WITHIN THIRTY (30) CALENDAR DAYS AFTER THE ELECTION OF THE DIRECTORS, TRUSTEES AND OFFICERS OF THE CORPORATION AT THE ANNUAL MEMBERS' MEETING. 2. IF NO MEETING IS HELD, THE CORPORATION SHALL SUBMIT THE GIS NOT LATER THAN JANUARY 30 OF THE FOLLOWING YEAR. HOWEVER, SHOULD AN ANNUAL STOCKHOLDERS' MEETING BE HELD THEREAFTER, A NEW GIS SHALL BE SUBMITTED/FILED. 3. THIS GIS SHALL BE ACCOMPLISHED IN ENGLISH AND CERTIFIED AND SWORN TO BY THE CORPORATE SECRETARY OF THE CORPORATION. 4. THE SEC SHOULD BE TIMELY APPRISED OF RELEVANT CHANGES IN THE SUBMITTED INFORMATION AS THEY ARISE. FOR CHANGES RESULTING FROM ACTIONS THAT AROSE BETWEEN THE ANNUAL MEETINGS, THE CORPORATION SHALL SUBMIT AMENDED GIS CONTAINING THE NEW INFORMATION TOGETHER WITH A COVER LETTER SIGNED THE CORPORATE SECRETARY OF THE CORPORATION. THE AMENDED GIS AND COVER LETTER SHALL BE SUBMITTED WITHIN SEVEN (7) DAYS AFTER SUCH CHANGE OCCURED OR BECAME EFFECTIVE. 5. SUBMIT FOUR (4) COPIES OF THE GIS TO THE RECEIVING SECTION AT THE SEC MAIN OFFICE, OR TO SEC SATELLITE OFFICES OR EXTENSION OFFICES. ALL COPIES SHALL UNIFORMLY BE ON A4 OR LETTER-SIZED PAPER. THE PAGES OF ALL COPIES SHALL USE ONLY ONE SIDE 6. ONLY THE GIS ACCOMPLISHED IN ACCORDANCE WITH THESE INSTRUCTIONS SHALL BE CONSIDERED AS HAVING BEEN FILED. 7. THIS GIS MAY BE USED AS EVIDENCE AGAINST THE CORPORATION AND ITS RESPONSIBLE DIRECTORS/OFFICERS FOR ANY VIOLATION OF EXISTING LAWS, RULES AND REGULATIONS			
===== PLEASE PRINT LEGIBLY =====			
<b>CORPORATE NAME:</b> <div style="text-align: center;">AQUATIC BLUE INCORPORATED</div>		<b>DATE REGISTERED:</b> <div style="text-align: center;">06 11 2018</div>	
<b>BUSINESS/TRADE NAME:</b> <div style="text-align: center;">AQUATIC BLUE INCORPORATED</div>		<b>FISCAL YEAR END:</b> <div style="text-align: center;">JANUARY 30</div>	
<b>SEC REGISTRATION NUMBER:</b> <div style="text-align: center;">CS201810086</div>		<b>CORPORATE TAX IDENTIFICATION NUMBER (TIN):</b> <div style="text-align: center;">010-035-306</div>	
<b>DATE OF ANNUAL MEETING PER BY-LAWS:</b> <div style="text-align: center;">JUNE 15</div>		<b>WEBSITE/URL ADDRESS:</b> <div style="text-align: center;">15-Jun-22</div>	
<b>COMPLETE PRINCIPAL OFFICE ADDRESS:</b> <div style="text-align: center;">DIMALANTA ROAD, PUROK ANONANG, SICSICAN, PUERTO PRINCESA CITY, PALAWAN</div>		<b>E-MAIL ADDRESS:</b> <div style="text-align: center;">aquaticblueincorporated@gmail.com</div>	
<b>COMPLETE BUSINESS ADDRESS:</b> <div style="text-align: center;">DIMALANTA ROAD, PUROK ANONANG, SICSICAN, PUERTO PRINCESA CITY, PALAWAN</div>		<b>FAX NUMBER:</b> <div style="text-align: center;">ail.com</div>	
<b>OFFICIAL E-MAIL ADDRESS</b> <div style="text-align: center;">aquaticblueincorporated@gmail.com</div>	<b>ALTERNATE E-MAIL ADDRESS</b> <div style="text-align: center;">joannacionales@yahoo.com</div>	<b>OFFICIAL MOBILE NUMBER</b> <div style="text-align: center;">09294798467</div>	<b>ALTERNATE MOBILE NUMBER</b> <div style="text-align: center;">09473605764</div>
<b>NAME OF EXTERNAL AUDITOR &amp; ITS SIGNING PARTNER:</b> <div style="text-align: center;">ANNABELLE P. ONG</div>		<b>SEC ACCREDITATION NUMBER (if applicable):</b> <div style="text-align: center;">BOA 3884</div>	<b>TELEPHONE NUMBER(S):</b> <div style="text-align: center;">(048) 433-2260</div>
<b>PRIMARY PURPOSE/ACTIVITY/INDUSTRY PRESENTLY ENGAGED IN:</b> <div style="text-align: center;">TO OPERATE HOTEL WITH LAND, WATER, AIR SPORTS ACTIVITIES WITH RESTAURANT THAT WILL CATER ONLY TO HOTEL GUEST</div>		<b>INDUSTRY CLASSIFICATION:</b> <div style="text-align: center;">HOTEL</div>	<b>GEOGRAPHICAL CODE:</b>
===== INTERCOMPANY AFFILIATIONS =====			
<b>PARENT COMPANY</b>	<b>SEC REGISTRATION NO.</b>	<b>ADDRESS</b>	
<b>SUBSIDIARY/AFFILIATE</b>	<b>SEC REGISTRATION NO.</b>	<b>ADDRESS</b>	
NOTE: USE ADDITIONAL SHEET IF NECESSARY			



## GENERAL INFORMATION SHEET

## STOCK CORPORATION

PLEASE PRINT LEGIBLY

Corporate Name:

AQUATIC BLUE INCORPORATED

A. Is the Corporation a covered person under the Anti Money Laundering Act (AMLA), as amended? (Rep. Acts. 9160/9164/10167/10365)

☐ Yes ☒ No

Please check the appropriate box:

1.

- ☐ a. Banks  
☐ b. Offshore Banking Units  
☐ c. Quasi-Banks  
☐ d. Trust Entities  
☐ e. Non-Stock Savings and Loan Associations  
☐ f. Pawnshops  
☐ g. Foreign Exchange Dealers  
☐ h. Money Changers  
☐ i. Remittance Agents  
☐ j. Electronic Money Issuers  
☐ k. Financial Institutions which Under Special Laws are subject to Bangko Sentral ng Pilipinas' (BSP) supervision and/or regulation, including their subsidiaries and affiliates.

2.

- ☐ a. Insurance Companies  
☐ b. Insurance Agents  
☐ c. Insurance Brokers  
☐ d. Professional Reinsurers  
☐ e. Reinsurance Brokers  
☐ f. Holding Companies  
☐ g. Holding Company Systems  
☐ h. Pre-need Companies  
☐ i. Mutual Benefit Association  
☐ j. All Other Persons and entities supervised and/or regulated by the Insurance Commission (IC)

3.

- ☐ a. Securities Dealers  
☐ b. Securities Brokers  
☐ c. Securities Salesman  
☐ d. Investment Houses  
☐ e. Investment Agents and Consultants  
☐ f. Trading Advisors  
☐ g. Other entities managing Securities or rendering similar services  
☐ h. Mutual Funds or Open-end Investment Companies  
☐ i. Close-end Investment Companies  
☐ j. Common Trust Funds or Issuers and other similar entities  
☐ k. Transfer Companies and other similar entities  
☐ l. Other entities administering or otherwise dealing in currency, commodities or financial derivatives based there on  
☐ m. Entities administering or otherwise dealing in valuable objects  
☐ n. Entities administering or otherwise dealing in cash Substitutes and other similar monetary instruments or property supervised and/or regulated by the Securities and Exchange Commission (SEC)

4. ☐

Jewelry dealers in precious metals, who, as a business, trade in precious metals

5. ☐

Jewelry dealers in precious stones, who, as a business, trade in precious stone

6.

Company service providers which, as a business, provide any of the following services to third parties:

- ☐ a. acting as a formation agent of juridical persons  
☐ b. acting as (or arranging for another person to act as) a director or corporate secretary of a company, a partner of a partnership, or a similar position in relation to other juridical persons  
☐ c. providing a registered office, business address or accommodation, correspondence or administrative address for a company, a partnership or any other legal person or arrangement  
☐ d. acting as (or arranging for another person to act as) a nominee shareholder for another person

7. Persons who provide any of the following services:

- ☐ a. managing of client money, securities or other assets  
☐ b. management of bank, savings or securities accounts  
☐ c. organization of contributions for the creation, operation or management of companies  
☐ d. creation, operation or management of juridical persons or arrangements, and buying and selling business entities

8. ☐ None of the above

Describe nature of business:

B. Has the Corporation complied with the requirements on Customer Due Diligence (CDD) or Know Your Customer (KYC), record-keeping, and submission of reports under the AMLA, as amended, since the last filing of its GIS?

☐ Yes ☒ No



**GENERAL INFORMATION SHEET**  
STOCK CORPORATION

===== PLEASE PRINT LEGIBLY =====

<b>CORPORATE NAME:</b>		<b>AQUATIC BLUE INCORPORATED</b>					
<b>CAPITAL STRUCTURE</b>							
<b>AUTHORIZED CAPITAL STOCK</b>							
	<b>TYPE OF SHARES *</b>	<b>NUMBER OF SHARES</b>	<b>PAR/STATED VALUE</b>	<b>AMOUNT (PhP) (No. of shares X Par/Stated Value)</b>			
	COMMON	10,000	1,000.00	10,000,000.00			
<b>TOTAL</b>		<b>10,000</b>	<b>TOTAL P</b>	<b>10,000,000.00</b>			
<b>SUBSCRIBED CAPITAL</b>							
<b>FILIPINO</b>	<b>NO. OF STOCK-HOLDERS</b>	<b>TYPE OF SHARES *</b>	<b>NUMBER OF SHARES</b>	<b>NUMBER OF SHARES IN THE HANDS OF THE PUBLIC **</b>	<b>PAR/STATED VALUE</b>	<b>AMOUNT (PhP)</b>	<b>% OF OWNERSHIP</b>
	3	COMMON	1,500		1,000.00	1,500,000.00	
<b>TOTAL</b>		<b>1,500</b>	<b>TOTAL</b>	<b>TOTAL P</b>	<b>1,500,000.00</b>		
<b>FOREIGN (INDICATE BY NATIONALITY)</b>	<b>NO. OF STOCK-HOLDERS</b>	<b>TYPE OF SHARES *</b>	<b>NUMBER OF SHARES</b>	<b>NUMBER OF SHARES IN THE HANDS OF THE PUBLIC **</b>	<b>PAR/STATED VALUE</b>	<b>AMOUNT (PhP)</b>	<b>% OF OWNERSHIP</b>
BELGIAN	1	COMMON	825		1,000.00	825,000.00	
GERMANY	1	COMMON	175		1,000.00	175,000.00	
<b>Percentage of Foreign Equity :</b>		<b>TOTAL</b>	<b>1,000</b>	<b>TOTAL</b>	<b>TOTAL P</b>	<b>1,000,000.00</b>	
					<b>TOTAL SUBSCRIBED P</b>	<b>2,500,000.00</b>	
<b>PAID-UP CAPITAL</b>							
<b>FILIPINO</b>	<b>NO. OF STOCK-HOLDERS</b>	<b>TYPE OF SHARES *</b>	<b>NUMBER OF SHARES</b>	<b>PAR/STATED VALUE</b>	<b>AMOUNT (PhP)</b>	<b>% OF OWNERSHIP</b>	
	3	COMMON	375	1,000.00	375,000.00		
<b>TOTAL</b>		<b>375</b>	<b>TOTAL P</b>	<b>375,000.00</b>			
<b>FOREIGN (INDICATE BY NATIONALITY)</b>	<b>NO. OF STOCK-HOLDERS</b>	<b>TYPE OF SHARES *</b>	<b>NUMBER OF SHARES</b>	<b>PAR/STATED VALUE</b>	<b>AMOUNT (PhP)</b>	<b>% OF OWNERSHIP</b>	
BELGIAN	1	COMMON	206	1,000.00	206,250.00		
GERMANY	1	COMMON	43	1,000.00	43,750.00		
<b>40.00 %</b>		<b>TOTAL</b>	<b>249</b>	<b>TOTAL P</b>	<b>250,000.00</b>		
				<b>TOTAL PAID-UP P</b>	<b>625,000.00</b>		

NOTE: USE ADDITIONAL SHEET IF NECESSARY

\* Common, Preferred or other classification

\*\* Other than Directors, Officers, Shareholders owning 10% of outstanding shares.



# GENERAL INFORMATION SHEET

STOCK CORPORATION

PLEASE PRINT LEGIBLY

CORPORATE NAME: AQUATIC BLUE INCORPORATED								
DIRECTORS / OFFICERS								
NAME/CURRENT RESIDENTIAL ADDRESS	NATIONALITY	INC'R	BOARD	GENDER	STOCK HOLDER	OFFICER	EXEC. COMM.	TAX IDENTIFICATION NUMBER
1. JOAN LABRADOR NACIONALES PADUGA ROAD, PUROK MALIGAYA, BGY SAN JOSE, PUERTO PRINCESA CITY,	FILIPINO	Y	C	F	Y	PRESIDENT		446-802-007
2. BORIS DE BERNARD DE FAUCONVAL DE PADUGA ROAD, PUROK MALIGAYA, BGY SAN JOSE, PUERTO PRINCESA CITY,	BELGIAN	Y	M	M	Y	TREASURER		755-511-842
3. SYDNEY USTARES COMIA 332 LAGAN TANGLAW (POB.), PUERTO PRINCESA CITY, PALAWAN	FILIPINO	Y	M	F	Y	SECRETARY		183-096-172
4. MONDAY LABRADOR NACIONALES 35 SERVANDO SINGCANG-AIRPORT BACOLOD CITY, NEGROS OCCIDENTAL	FILIPINO	Y	M	F	Y	MEMBER		427-519-342
5. MICHA HILDNER 4 MITRA ROAD, STA. MONICA, PUERTO PRINCESA CITY, PALAWAN	GERMAN	Y	M	M	Y	MEMBER		484-211-890
6.								
7.								
8.								
9.								
10.								
11.								
12.								
13.								
14.								
15.								
INSTRUCTION: FOR SEX COLUMN, PUT "F" FOR FEMALE, "M" FOR MALE. FOR BOARD COLUMN, PUT "C" FOR CHAIRMAN, "M" FOR MEMBER, "I" FOR INDEPENDENT DIRECTOR. FOR INC'R COLUMN, PUT "Y" IF AN INCORPORATOR, "N" IF NOT. FOR STOCKHOLDER COLUMN, PUT "Y" IF A STOCKHOLDER, "N" IF NOT. FOR OFFICER COLUMN, INDICATE PARTICULAR POSITION IF AN OFFICER, FROM VP UP INCLUDING THE POSITION OF THE TREASURER, SECRETARY, COMPLIANCE OFFICER AND/OR ASSOCIATED PERSON. FOR EXECUTIVE COMMITTEE, INDICATE "C" IF MEMBER OF THE COMPENSATION COMMITTEE; "A" FOR AUDIT COMMITTEE; "N" FOR NOMINATION AND ELECTION COMMITTEE. ADDITIONALLY WRITE "C" AFTER SLASH IF CHAIRMAN AND "M" IF MEMBER.								



**GENERAL INFORMATION SHEET**  
**STOCK CORPORATION**

===== PLEASE PRINT LEGIBLY =====

<b>CORPORATE NAME:</b>	<b>AQUATIC BLUE INCORPORATED</b>		
<b>TOTAL NUMBER OF STOCKHOLDERS:</b>	<b>5</b>	<b>NO. OF STOCKHOLDERS WITH 100 OR MORE SHARES EACH:</b>	<b>5</b>
<b>TOTAL ASSETS BASED ON LATEST AUDITED FINANCIAL STATEMENTS:</b>	<b>991,793.24</b>		

**STOCKHOLDER'S INFORMATION**

NAME, NATIONALITY AND CURRENT RESIDENTIAL ADDRESS	SHARES SUBSCRIBED				AMOUNT PAID (PhP)	TAX IDENTIFICATION NUMBER
	TYPE	NUMBER	AMOUNT (PhP)	% OF OWNER-SHIP		
1. JOAN LABRADOR NACIONALES FILIPINO PADUGA ROAD, PUROK MALIGAYA, BGY SAN JOSE, PUERTO PRINCESA CITY, PALAWAN	C	1,250	1,250,000.00	50.00%	312,500.00	446-802-007
	<b>TOTAL</b>	<b>1,250</b>	<b>1,250,000.00</b>			
2. BORIS DE BERNARD DE FAUCONVAL DE DUEKEN BELGIAN PADUGA ROAD, PUROK MALIGAYA, BGY SAN JOSE, PUERTO PRINCESA CITY, PALAWAN	C	825	825,000.00	33.00%	206,250.00	755-511-842
	<b>TOTAL</b>	<b>825</b>	<b>825,000.00</b>			
3. SYDNEY USTARES COMIA FILIPINO 332 LAGAN TANGLAW (POB.), PUERTO PRINCESA CITY, PALAWAN	C	125	125,000.00	5.00%	31,250.00	183-096-172
	<b>TOTAL</b>	<b>125</b>	<b>125,000.00</b>			
4. MONDAY LABRADOR NACIONALES FILIPINO 35 SERVANDO SINGCANG-AIRPORT BACOLOD CITY, NEGROS OCCIDENTAL	C	125	125,000.00	5.00%	31,250.00	427-519-342
	<b>TOTAL</b>	<b>125</b>	<b>125,000.00</b>			
5. MICHA HILDNER GERMAN 4 MITRA ROAD, STA. MONICA, PUERTO PRINCESA CITY, PALAWAN	C	175	175,000.00	7.00%	43,750.00	484-211-890
	<b>TOTAL</b>	<b>175</b>	<b>175,000.00</b>			
6.						
	<b>TOTAL</b>					
7.						
	<b>TOTAL</b>					
<b>TOTAL AMOUNT OF SUBSCRIBED CAPITAL</b>			<b>2,500,000.00</b>	<b>100.00%</b>	<b>625,000.00</b>	
<b>TOTAL AMOUNT OF PAID-UP CAPITAL</b>						

**INSTRUCTION: SPECIFY THE TOP 20 STOCKHOLDERS AND INDICATE THE REST AS OTHERS**

*Note: For PDTC Nominee included in the list, please indicate further the beneficial owners owning more than 5% of any class of the company's voting securities. Attach separate sheet, if necessary.*



**GENERAL INFORMATION SHEET**  
**STOCK CORPORATION**

===== PLEASE PRINT LEGIBLY =====

<b>CORPORATE NAME:</b>		<b>AQUATIC BLUE INCORPORATED</b>				
<b>TOTAL NUMBER OF STOCKHOLDERS:</b>		<b>5</b>		<b>NO. OF STOCKHOLDERS WITH 100 OR MORE SHARES EACH:</b>		<b>5</b>
<b>TOTAL ASSETS BASED ON LATEST AUDITED FS:</b>		<b>991,793.24</b>				
<b>STOCKHOLDER'S INFORMATION</b>						
NAME, NATIONALITY AND CURRENT RESIDENTIAL ADDRESS	SHARES SUBSCRIBED				AMOUNT PAID (PhP)	TAX IDENTIFICATION NUMBER
	TYPE	NUMBER	AMOUNT (PhP)	% OF OWNER- SHIP		
8.						
	<b>TOTAL</b>					
9.						
	<b>TOTAL</b>					
10.						
	<b>TOTAL</b>					
11.						
	<b>TOTAL</b>					
12.						
	<b>TOTAL</b>					
13.						
	<b>TOTAL</b>					
14.						
	<b>TOTAL</b>					
<b>TOTAL AMOUNT OF SUBSCRIBED CAPITAL</b>				<b>0.00%</b>	<b>0.00</b>	
<b>TOTAL AMOUNT OF PAID-UP CAPITAL</b>						
<b>INSTRUCTION: SPECIFY THE TOP 20 STOCKHOLDERS AND INDICATE THE REST AS OTHERS</b>						
<i>Note: For PDTC Nominee included in the list, please indicate further the beneficial owners owning more than 5% of any class of the company's voting securities. Attach separate sheet, if necessary.</i>						



**GENERAL INFORMATION SHEET**  
STOCK CORPORATION

===== PLEASE PRINT LEGIBLY =====

<b>CORPORATE NAME:</b>		<b>AQUATIC BLUE INCORPORATED</b>				
<b>TOTAL NUMBER OF STOCKHOLDERS:</b>		<b>5</b>		<b>NO. OF STOCKHOLDERS WITH 100 OR MORE SHARES EACH:</b>		<b>5</b>
<b>TOTAL ASSETS BASED ON LATEST AUDITED FS:</b>		<b>991,793.24</b>				
STOCKHOLDER'S INFORMATION						
NAME, NATIONALITY AND CURRENT RESIDENTIAL ADDRESS	SHARES SUBSCRIBED				AMOUNT PAID (PhP)	TAX IDENTIFICATION NUMBER
	TYPE	NUMBER	AMOUNT (PhP)	% OF OWNER- SHIP		
15.						
	<b>TOTAL</b>					
16.						
	<b>TOTAL</b>					
17.						
	<b>TOTAL</b>					
18.						
	<b>TOTAL</b>					
19.						
	<b>TOTAL</b>					
20.						
	<b>TOTAL</b>					
21. OTHERS (Indicate the number of the remaining stockholders)						
	<b>TOTAL</b>					
<b>TOTAL AMOUNT OF SUBSCRIBED CAPITAL</b>				<b>0.00%</b>	<b>0.00</b>	
<b>TOTAL AMOUNT OF PAID-UP CAPITAL</b>						
INSTRUCTION: SPECIFY THE TOP 20 STOCKHOLDERS AND INDICATE THE REST AS OTHERS						
<small>Note: For PDTC Nominee included in the list, please indicate further the beneficial owners owning more than 5% of any class of the company's voting securities. Attach separate sheet, if necessary.</small>						



**GENERAL INFORMATION SHEET**  
**STOCK CORPORATION**

===== PLEASE PRINT LEGIBLY =====			
<b>CORPORATE NAME: AQUATIC BLUE INCORPORATED</b>			
<b>1. INVESTMENT OF CORPORATE FUNDS IN ANOTHER CORPORATION</b>	<b>AMOUNT (PhP)</b>	<b>DATE OF BOARD RESOLUTION</b>	
1.1 STOCKS	NA	NA	
1.2 BONDS/COMMERCIAL PAPER (Issued by Private Corporations)	NA	NA	
1.3 LOANS/ CREDITS/ ADVANCES	NA	NA	
1.4 GOVERNMENT TREASURY BILLS	NA	NA	
1.5 OTHERS	NA	NA	
<b>2. INVESTMENT OF CORPORATE FUNDS IN ACTIVITIES UNDER ITS SECONDARY PURPOSES (PLEASE SPECIFY:)</b>	<b>DATE OF BOARD RESOLUTION</b>	<b>DATE OF STOCKHOLDERS RATIFICATION</b>	
NA	NA	NA	
<b>3. TREASURY SHARES</b>	<b>NO. OF SHARES</b>	<b>% AS TO THE TOTAL NO. OF SHARES ISSUED</b>	
	NA		
<b>4. UNRESTRICTED/UNAPPROPRIATED RETAINED EARNINGS AS OF END OF LAST FISCAL YEAR: 0</b>			
<b>5. DIVIDENDS DECLARED DURING THE IMMEDIATELY PRECEDING YEAR: 0</b>			
<b>TYPE OF DIVIDEND</b>	<b>AMOUNT (PhP)</b>	<b>DATE DECLARED</b>	
5.1 CASH	NA		
5.2 STOCK	NA		
5.3 PROPERTY	NA		
<b>TOTAL</b>	<b>P</b>		
<b>6. ADDITIONAL SHARES ISSUED DURING THE PERIOD: NA</b>			
<b>DATE</b>	<b>NO. OF SHARES</b>	<b>AMOUNT</b>	
	NA		
	NA		
	NA		
	NA		
<b>SECONDARY LICENSE/REGISTRATION WITH SEC AND OTHER GOV'T AGENCY: NA</b>			
<b>NAME OF AGENCY:</b>	<b>SEC</b>	<b>BSP</b>	<b>IC</b>
<b>TYPE OF LICENSE/REGN.</b>	NA		
<b>DATE ISSUED:</b>	NA		
<b>DATE STARTED OPERATIONS:</b>	NA		
<b>TOTAL ANNUAL COMPENSATION OF DIRECTORS DURING THE PRECEDING FISCAL YEAR (in PhP)</b>	<b>TOTAL NO. OF OFFICERS</b>	<b>TOTAL NO. OF RANK &amp; FILE EMPLOYEES</b>	<b>TOTAL MANPOWER COMPLEMENT</b>

NOTE: USE ADDITIONAL SHEET IF NECESSARY



Page 9



# **☞ BENEFICIAL OWNERSHIP DECLARATION**

**SEC REGISTRATION NUMBER:**

**CS201810086**

**CORPORATE NAME:**

**AQUATIC BLUE INCORPORATED**

**Instructions:**

1. Identify the Beneficial Owner/s of the corporation as described in the Categories of Beneficial Ownership in items A to I below. List down as many as you can identify. You may use an additional sheet if necessary.
2. Fill in the required information on the beneficial owner in the fields provided for.
3. In the "Category of Beneficial Ownership" column, indicate the letter(s) corresponding thereto. In the event that the person identified as beneficial owner falls under several categories, indicate all the letters corresponding to such categories.
4. If the category is under letter "I", indicate the position held (i.e., Director/Trustee, President, Chief Executive Officer, Chief Operating Officer, Chief Financial Officer, etc.).
5. Do not leave any item blank. Write "N/A" if the information required is not applicable or "NONE" if non-existent.

"Beneficial Owner" refers to any natural person(s) who ultimately own(s) or control(s) or exercise(s) ultimate effective control over the corporation. This definition covers the natural person(s) who actually own or control the corporation as distinguished from the legal owners. Such beneficial ownership may be determined on the basis of the following:

**Category**

**Description**

- A** Natural person(s) owning, directly or indirectly or through a chain of ownership, at least twenty-five percent (25%) of the voting rights, voting shares or capital of the reporting corporation.
- B** Natural person(s) who exercise control over the reporting corporation, alone or together with others, through any contract, understanding, relationship, intermediary or tiered entity.
- C** Natural person(s) having the ability to elect a majority of the board of directors/trustees, or any similar body, of the corporation.
- D** Natural person(s) having the ability to exert a dominant influence over the management or policies of the corporation.
- E** Natural person(s) whose directions, instructions, or wishes in conducting the affairs of the corporation are carried out by majority of the members of the board of directors of such corporation who are accustomed or under an obligation to act in accordance with such person's directions, instructions or wishes.
- F** Natural person(s) acting as stewards of the properties of corporations, where such properties are under the care or administration of said natural person(s).
- G** Natural person(s) who actually own or control the reporting corporation through nominee shareholders or nominee directors acting for or on behalf of such natural persons.
- H** Natural person(s) ultimately owning or controlling or exercising ultimate effective control over the corporation through other means not falling under any of the foregoing categories.
- I** Natural person(s) exercising control through positions held within a corporation (i.e., responsible for strategic decisions that fundamentally affect the business practices or general direction of the corporation such as the members of the board of directors or trustees or similar body within the corporation; or exercising executive control over the daily or regular affairs of the corporation through a senior management position). This category is only applicable in exceptional cases where no natural person is identifiable who ultimately owns or exerts control over the corporation, the reporting corporation having exhausted all reasonable means of identification and provided there are no grounds for suspicion.

COMPLETE NAME (Surname, Given Name, Middle Name, Name Extension (i.e., Jr., Sr., III))	SPECIFIC RESIDENTIAL ADDRESS	NATIONALITY	DATE OF BIRTH	TAX IDENTIFICATION NO.	% OF OWNERSHIP <sup>1</sup> / % OF VOTING RIGHTS <sup>2</sup>	TYPE OF BENEFICIAL OWNER <sup>3</sup> Direct (D) or Indirect (I)	CATEGORY OF BENEFICIAL OWNERSHIP
JOAN LABRADOR NACIONALES	PADUGA ROAD, PUROK MALIGAYA, BGY SAN JOSE, PUERTO	FILIPINO	09/14/1989	446-802-007	50.00%	D	I - PRESIDENT

**Note: This page is not for uploading on the SEC iView.**

<sup>1</sup> For Stock Corporations.

<sup>2</sup> For Non-Stock Corporations.

<sup>3</sup> For Stock Corporations.





# WATERLAB WATER TESTING LABORATORY INC.

"We Exceed the Boundaries of Water Testing"

137 Quirino Hi-way, Baesa, Quezon City

Tel (02)8294-2345 / (0925)688-8801 / (0939)912-6854 / (0968)854-0757

Email: calocanwaterlab@yahoo.com | Website: <https://waterlablaboratory.com>

DEPARTMENT OF HEALTH ACCREDITATION NUMBER 13-0003-2022-LW-2

## Microbiological Test Certificate

Job Number : 147937D-PPC  
CRF No. : 369732  
NAME OF CLIENT : AQUATIC BLUE INC  
COMPANY : AQUATIC BLUE INC  
BUSINESS ADDRESS : Brgy. Sicsican, Puerto Princesa City, Palawan  
Contact Number :



### SAMPLE DESCRIPTION

Sample Submitted by : Julius Romasanta  
Date of Sampling : September 01, 2022  
Time Received : 1:00pm  
Sampling Location : Brgy. Sicsican, Puerto Princesa City, Palawan  
Source of Sample : Product Water

Date Released : September 06, 2022

Date Analyzed : September 02, 2022

Analysis	PNSDW Limit (MPN/100mL)	Method	Result (MPN /100ml)	Remarks
Total Coliform	Less than 1.1	Multiple Tube Fermentation Technique	Less than 1.1	Passed
Thermotolerant Coliform/E.coli	Less than 1.1	Multiple Tube Fermentation Technique	Less than 1.1	Passed
HPC	Less than 500 CFU / mL	Pour Plate	N / A	N / A

Test result is based on sample as received and is valid for a month (30 days).

\*\* Customer/s is/are given seven (7) days upon receipt of report to question any discrepancies (i.e. customer name & address, sample description, results, etc.)

MPN-Most Probable Number HPC-Heterotrophic Plate Count CFU-Colony Forming Unit

The MPN / 100ml as per positive tube are as follows: [0 tube-MPN/100ml <1.1 or 0]; [1tube-MPN / 100ml=1.1]; [2tubes-MPN / 100ml=2.6]; [3tubes-MPN / 100ml = 4.6]; [4tubes-MPN / 100ml = 8.0]; [5tubes / 100ml >8.0]

### REFERENCES:

All limits are taken from PNSDW, Department of Health, Manila, Philippines, 2017. Standard Methods for the Examination of Water and Waste(SMEWW 23rd edition) ALPHA, AWWA, WEF.

The results given in this report were obtained at the time of the test and refer only to the particular sample submitted. This may not be reproduced, published or used for marketing Purposes unless with written authorization from Waterlab Water Testing Laboratory Inc.

Not Valid Without Authorized Initial  
On Waterlab Seal

Analysis done by:

Gianne Noreen B. Llamado, RMT  
PRC No. 0094974  
WMLA-21-1042

Certified correct by:

Vivien J. Santos, RMT  
PRC No. 0027003  
WMLA-15-0374





# WATERLAB WATER TESTING LABORATORY, INC.

"We Exceed the Boundaries of Water Testing"

137 Quirino Hi-way, Baesa, Quezon City

Tel (02)8294-2345 / Cel. (0939)912-6854 / (0925)688-8801 / (0968)854-0757

Email: calocanwaterlab@yahoo.com | Website: <https://waterlablaboratory.com>

DEPARTMENT OF HEALTH ACCREDITATION NUMBER 13-0003-2022-LW-2

## Physico-Chemical Test Certificate

Job Number : 147937C-PPC  
CRF No. : 028190-369731  
NAME OF CLIENT : AQUATIC BLUE INC  
COMPANY : AQUATIC BLUE INC  
BUSINESS ADDRESS : Brgy. Sicsican, Puerto Princesa City, Palawan  
Contact Number :



### SAMPLE DESCRIPTION

Sample Submitted by : Julius Romasanta  
Date of Sampling : September 01, 2022  
Time Received : 1:00pm  
Sampling Location : Brgy. Sicsican, Puerto Princesa City, Palawan  
Source of Sample : Product Water

Date Released : September 08, 2022

Date Analyzed : September 03, 2022

Analysis	PNSDW Limit	Method	Result	Remarks
<u>Physical</u>				
Color	10 CU	Visual Comparison	1.0	Passed
Odor	Unobjectionable	Sensory	unobjectionable	Passed
Taste	Unobjectionable	Sensory	unobjectionable	Passed
Turbidity	5 NTU	Nephelometric	0.05	Passed
<u>Chemical</u>				
pH	6.5 - 8.5 5-7 Purified	Electrometric	7.50	Passed
Chloride	250.0 mg/L	Argentometric	14.18	Passed
Hardness	300 as CaCO <sub>3</sub> mg/L	EDTA Titrimetric	187.14	Passed
Iron	1.0 mg/L	Flame AAS	<0.02	Passed
Copper	1.0 mg/L	Flame AAS	<0.01	Passed
Manganese	0.4 mg/L	Flame AAS	<0.01	Passed
Chromium	0.05 mg/L	Flame AAS	<0.01	Passed
Lead	0.01 mg/L	Electrothermal AAS	< 0.00005	Passed
Nitrate	50.0 mg/L	Ion Selective	2.88	Passed
Fluoride	1.5 mg/L	Ion Selective	0.01	Passed
Sulfate	250.0 mg/L	Turbidimetric	<5.00	Passed
TDS	600.0 mg/L <10 mg/L Purified	Total Dissolved Solids Dried @ 180 °C	210.0	Passed

Test result is based on sample as received and is valid for 6 months.

\*\* Customer/s is/are given seven (7) days upon receipt of report to question any discrepancies (i.e. customer name & address, sample description, results, etc.)

MDL-Method Detection Limit ppb-parts per billion

The MDL are as follows: [Arsenic - <0.1ppb]; [Cadmium - <0.005 ppb]; [Lead - <0.05 ppb]

### REFERENCES:

All limits are taken from PNSDW, Department of Health, Manila, Philippines, 2017. Standard Methods for the Examination of Water and Waste(SMEWW 23rd edition) ALPHA, AWWA, WEF.

The results given in this report were obtained at the time of the test and refer only to the particular sample submitted. This may not be reproduced, published or used for marketing Purposes unless with written authorization from Waterlab Water Testing Laboratory Inc.

Not Valid Without Authorized Initial  
On Waterlab Seal

Analysis done by:

Isabel Nicole P. Crisostomo, RChT  
PRC No. 0002845

Certified correct by:

Elyssa Camille R. Lopez, RCh  
PRC No. 0013643





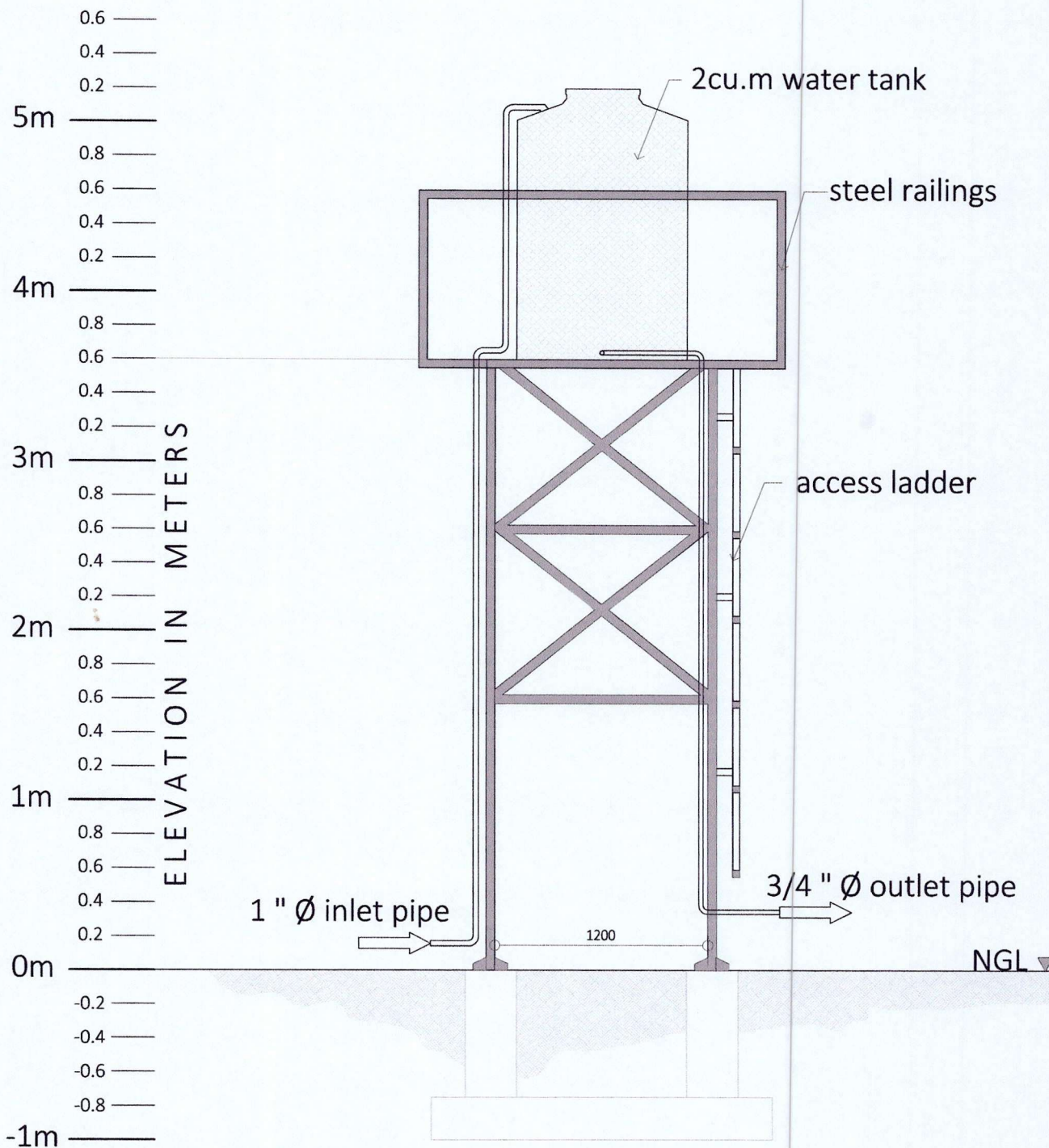

# WATER TANK ELEVATION DETAILS SCALE: DNTS

<p><b>JAMES BRAINERD R. MAZA</b> CIVIL ENGINEER</p>		PROJECT TITLE:	CONFORME:
		<p><b>AS-BUILT DEEP WELL WATER PUMP SYSTEM</b></p>	<p><b>AQUATIC BLUE INC</b></p>
<p>PRC NO.: 0136338</p>	<p>TIN NO.: 326-181-203-000</p>	<p><b>JOAN NACIONALES</b> OWNER'S REPRESENTATIVE</p>	
<p>PIR NO.: 0957716</p>	<p>DATE ISSUED: MARCH 23, 2022</p>	<p>LOCATION: BRGY. SICSICAN, PUERTO PRINCESA CITY, PALAWAN</p>	<p>ADDRESS: BRGY. SICSICAN, PUERTO PRINCESA CITY, PALAWAN</p>
<p>PLACE ISSUED: PUERTO PRINCESA CITY</p>			
<p>REPUBLIC ACT 545 This drawing as an instrument of service is the property of THE AUTHOR, a registered architect and as such must not be reproduced or copied in part or in whole without permission. All drawings must be returned when no longer in use. PRESIDENTIAL DECREE NO. 49 "Protection of Intellectual Property" works of Art Architecture, Models and Designs are creative works and considered as part of the intellectual property of the Author</p>			



# WELL DRILLING DATA REPORT

NAME OF OWNER: *JOAN L. NACIONALES*

NAME OF ESTABLISHMENT: *AQUATIC BLUE INCORPORATED*

ADDRESS OF ESTABLISHMENT: *DIMALANTA ROAD, BGY. SICSICAN, PUERTO PRINCESA CITY*

CONSTRUCTION DATE: *JUNE 26, 2019 TO AUGUST 2022*

MAXIMUM WATER TANK VOLUME: *2 CUBIC METERS*

ELEVATION OF WATER TANK VOLUME FROM NATURAL GRADE LINE: *3.6 METERS*

DEPTH OF DRILLED PIPE: 100FT

SIZE OF PIPE: 2"Ø

SIZE OF WATER PUMP: 1HP

# WELL DRILLING DATA FOR WATER PUMP

MAKE: *EURO STAR*

WELL CASING: 2"Ø

AVERAGE MONTHLY DISCHARGED VOLUME: *60 CUBIC METERS*

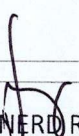
 <b>JAMES BRAINERD R. MAZA</b> CIVIL ENGINEER		PROJECT TITLE: <b>AS-BUILT DEEP WELL WATER PUMP SYSTEM</b>	CONFORME: <b>AQUATIC BLUE INC</b>  <b>JOAN NACIONALES</b> OWNER'S REPRESENTATIVE
PRC NO.: 0136338	PIN NO.: 326-181-203-000	DATE ISSUED: MARCH 23, 2022	ADDRESS: BRGY. SICSICAN, PUERTO PRINCESA CITY, PALAWAN
PLACE ISSUED: PUERTO PRINCESA CITY		LOCATION: BRGY. SICSICAN, PUERTO PRINCESA CITY, PALAWAN	

**REPUBLIC ACT 545**  
This drawing as an instrument of service is the property of THE AUTHOR, a registered architect and as such must not be reproduced or copied in part or in whole without permission. All drawings must be returned when no longer in use.  
**PROFESSIONAL DECREE NO. 49**  
"Protection of Intellectual Property" works of Art Architecture, Models and Designs are creative works and considered as part of the intellectual property of the Author



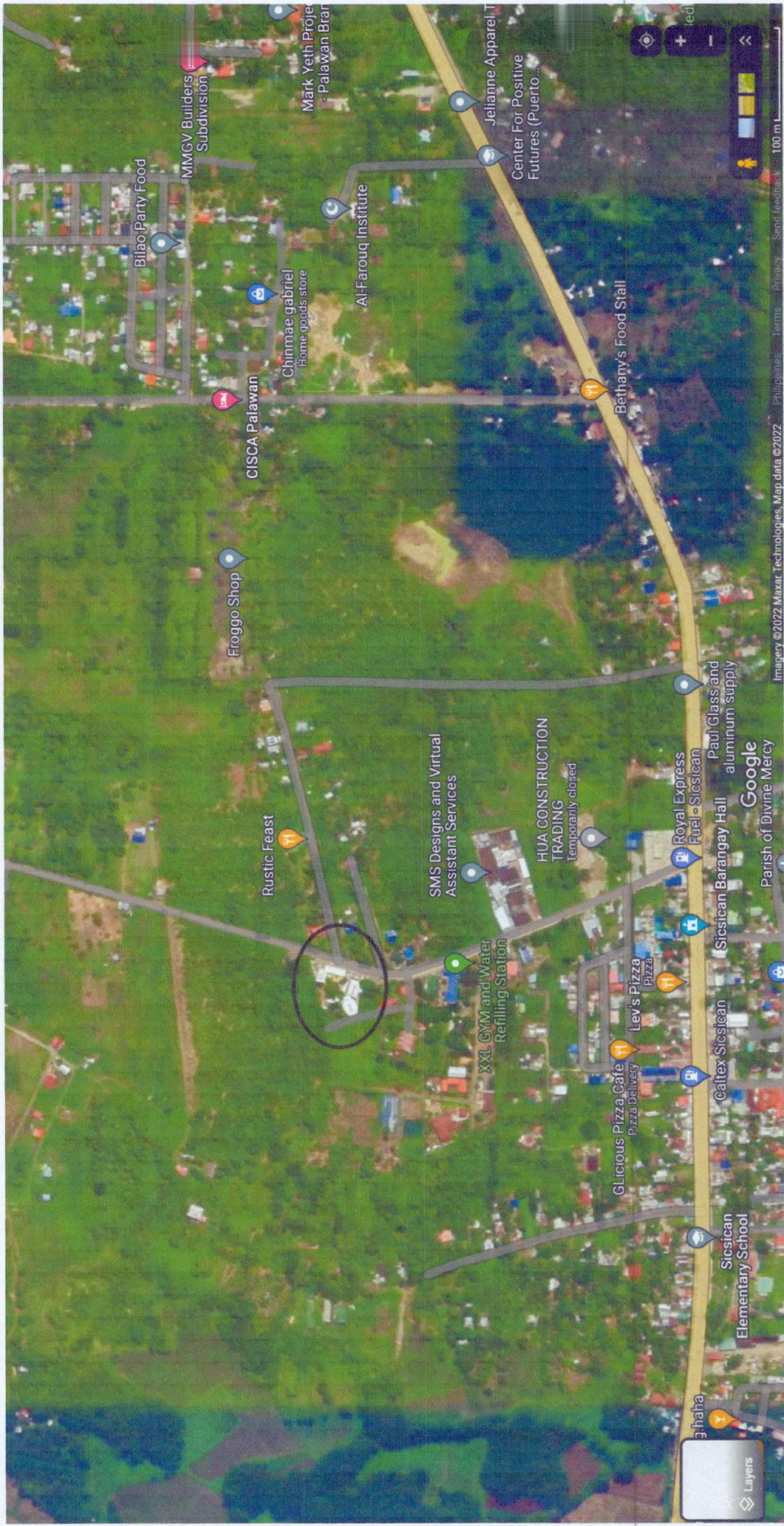



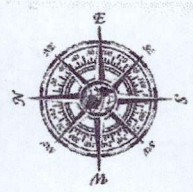

**TAXMAP - LOCATI  
BARANGAY SICSIC  
Puerto Princesa Ci**

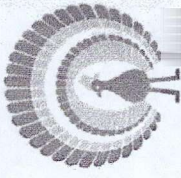

**OFFICE OF THE ASSES  
TAXMAPPING DIVISI  
CITY OF PUERTO PRIN**

**CERTIFIED TRUE & CO**



**ENGR. JOVEN C. V. BALT  
City Assessor**

Prepared By:

**ELMER G. GUINTO  
Draftsman II**

O.R. No 1289169  
Amount: Php. 250.00  
Dated: 1/30/2019, 4:01:33 P  
(Wednesday)  
Puerto Princesa City

**FOR VERIFICATION PURP**

**REMINDER  
This Map is for TAXATION and ASSES  
Purposes ONLY**

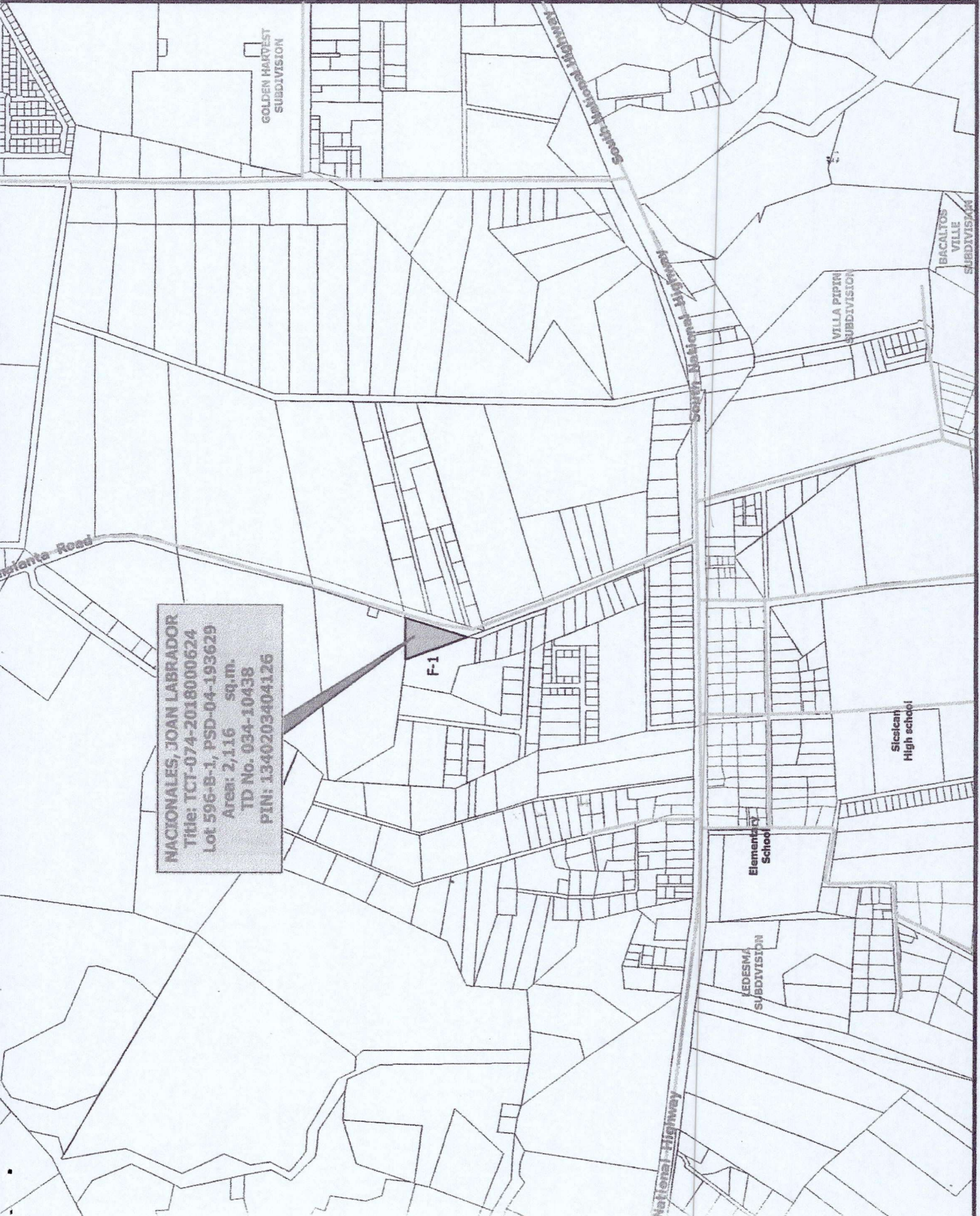

**NACIONALES, JOAN LABRADOR  
Title: TCT-074-2018000624  
Lot 596-B-1, PSD-04-193629  
Area: 2,116 sq.m.  
TD No. 034-10438  
PIN: 1340203404126**