



Republic of the Philippines
Department of Environment and Natural Resources
Provincial Environment and Natural Resources Office
MIMAROPA Region
Bgy. Sta. Monica, Puerto Princesa City, Palawan
E-mail: penropalawan@denr.gov.ph
Telfax No. (048) 433-5638 / (048) 433-5638

January 9, 2023

MEMORANDUM

FOR : The Regional Executive Director
DENR-MIMAROPA Region
1515 L&S Bldg., Roxas Blvd.
Ermita, Manila

THRU : The OIC, ARD for Technical Services

FROM : The Provincial Environment and
Natural Resources Officer

SUBJECT : **REPORT ON THE RE-SURVEYING AND MAPPING OF CBFM
AREAS OF SITIO-COMMUNAL MULTI-PURPOSE
COOPERATIVE LOCATED AT BARANGAY IRAAN,
ABORLAN, PALAWAN**





Respectfully forwarded is the Memorandum dated December 23, 2022 of CENRO Puerto Princesa City, Palawan relative on the above-cited subject.

Per report, the new CBFM area generated from 384.42 hectares before resurveying is 330.28 hectares. Attached herewith is the report on the said activity.

For information and record.

“For the PENRO”

RONIE B. GANDEZA
DMO IV / OIC-Chief TSD
In-Charge, Office of the PENRO

DENR-PALAWAN
PENRO-RECORDS
RELEASED
By 
Date: 11 JAN 2023 CN 23-84



Republic of the Philippines
Department of Environment and Natural Resources
Region IV - MIMAROPA
COMMUNITY ENVIRONMENT AND NATURAL RESOURCES OFFICE
PUERTO PRINCESA
South National Highway, Sta. Monica, Puerto Princesa City, Palawan
E-mail: cenropuertoprincesa@denr.gov.ph

December 23, 2022

MEMORANDUM

FOR : The Provincial Environment and
Natural Resources Officer
Puerto Princesa City

FROM : The OIC-Community Environment and
Natural Resources Officer
Puerto Princesa City

SUBJECT : **REPORT ON THE RE-SURVEYING AND MAPPING OF
CBFM AREAS OF SITIO-COMMUNAL MULTI-PURPOSE
COOPERATIVE LOCATED AT BARANGAY IRAAN,
ABORLAN, PALAWAN**

**DENR PENRO
PALAWAN RECORDS
RECEIVED**

BY: [Signature]
DATE: 22-2022 CN 22-11730

Forwarded is memorandum report from the Survey Team per PENRO Special Order No. 2022-089 dated September 29, 2022 on the conduct of re-surveying and mapping of Community-Based Forest Management (CBFM) area of Sitio Communal Multi-Purpose Cooperative. A total of one hundred one (101) hectares of Community-Based Forest Management (CBFM) was targeted for surveying this year.

This CBFM area was chosen as the target for Re-Surveying because it was found out that there was an overlap between the CBFM area and the Ancestral Domain of Tagbanua ICCs. Another overlap was between the CBFM area and approved Cadastral Survey of Barangay Iraan, Aborlan, Palawan.

The following were the activities and findings/observations for the CBFM area:

Activities undertaken:

1. Coordination through letter were undertaken with the Municipal Mayor of Aborlan and Chairperson of the CBFM-PO SCMPC of Iraan relative to the conduct of re-surveying and mapping within the CBFM area (see Annex III).
2. Meetings with the CBFM People's Organization (SCMPC), LGU Barangay of Iraan, NCIP and Tribe *Masikampo* were conducted.

The office encountered uncontrollable circumstances and issues when the Tribe *Masikampo* stated the need to secure a Free and Prior Informed Consent



Republic of the Philippines
Department of Environment and Natural Resources
Region IV - MIMAROPA
COMMUNITY ENVIRONMENT AND NATURAL RESOURCES OFFICE
PUERTO PRINCESA
South National Highway, Sta. Monica, Puerto Princesa City, Palawan
E-mail: cenropuertoprincesa@denr.gov.ph

(FPIC) before the conduct of the activity since the area is within their ancestral claims.

With the assistance provided by Hon. Arnel Ortega of Sangguniang Bayan of Aborlan in communicating and explaining with the Tribe *Masikampo* the purpose of the conduct of the activity, the Survey Team was allowed to conduct the field works.

It was also clarified that the FPIC is one of the documentary requirements for CBFM renewal as stated in FMB Technical Bulletin No. 38. Hence, the CBFM will apply for such prior to renewal.

3. Actual survey was conducted by the Survey Team with representatives from LGU Barangay Iraan, IP group and CBFM PO members gathering geographic observation on the existing structures, actual claim and known boundary corners of the CBFM area as identified and pointed on the ground by CBFM-PO representatives (see Annex IV).
4. Laying out and monumenting of seventeen (17) boundary corners served with PVC Pipe 2 inches in diameter and 1 meter in length (see Annex V)

Findings/Observations:

1. That there is an overlap between the CBFM area and the CADT area of Tagbanua ICC and Cadastral Survey of Barangay Iraan, Aborlan (see Annex VI);
2. That portion of the cadastral survey which overlaps the CBFM falls within timberland (see Annex VII);
3. A 50-meter setback from the boundary of cadastral survey were obtained to prevent overlapping of boundary since lay-out of CBFM corners were set through handheld GPS. The new CBFM area generated from 384.42 hectares before re-surveying is 330.28 hectares (see Annex II).

For information and further instruction.

PEDRO A. VELASCO

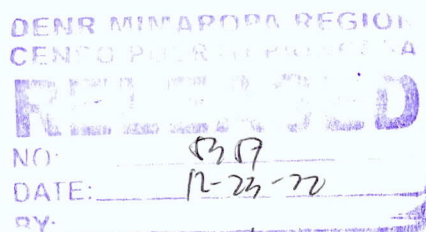



December 22, 2022

MEMORANDUM

FOR : The Provincial Environment and
Natural Resources Officer
Puerto Princesa City

THRU : The OIC-Community Environment and
Natural Resources Officer
Puerto Princesa City

FROM : The Survey Team

SUBJECT : **REPORT ON THE RE-SURVEYING AND MAPPING OF
CBFM AREAS OF SITIO-COMMUNAL MULTI-PURPOSE
COOPERATIVE LOCATED AT BARANGAY IRAAN,
ABORLAN, PALAWAN**

This is in connection to PENRO Special Order No. 2022-089 dated September 29, 2022 creating the survey team for the conduct of re-surveying and mapping of existing tenurial instrument within CENRO Puerto Princesa. A total of one hundred one (101) hectares of Community-Based Forest Management (CBFM) was targeted for this year.

The CBFMA No. RIV-PAL-CBFMA-99-05 was awarded to Sitio-Communal Multi-Purpose Cooperative (SCMPC) on September 23, 1999 which covered 384.42 hectares. This CBFM area was chosen as the target for Re-Surveying because it was found out that there was an overlap between the CBFM area and the Ancestral Domain of Tagbanua ICCs. Another overlap was between the CBFM area and approved Cadastral Survey of Barangay Iraan, Aborlan, Palawan.

The following references are gathered and reviewed:

1. Original Plan of Ancestral Domain as surveyed for Tagbanua ICCs located at Barangay Barake, Aborlan, Palawan containing an area of 2,795.1167 hectares (see Annex I).
2. Approved Cadastral Survey Map of Barangay Iraan, Aborlan, Palawan plotted in GIS generated map (see Annex II).
3. GIS Generated Map from One Control Map of the CENRO Puerto Princesa and PENRO Palawan (see Annex IV).



Republic of the Philippines
Department of Environment and Natural Resources
Region IV - MIMAROPA
COMMUNITY ENVIRONMENT AND NATURAL RESOURCES OFFICE
PUERTO PRINCESA
South National Highway, Sta. Monica, Puerto Princesa City, Palawan
E-mail: cenropuertoprincesa@denr.gov.ph

In compliance to the special order, the following are the activities which form part of the accomplishment of the survey scope of work:

1. Coordination through letter were undertaken with the Municipal Mayor of Aborlan and Chairperson of the CBFM-PO SCMPC of Iraan relative to the conduct of re-surveying and mapping within the CBFM area (see Annex III).
2. Meetings with the CBFM People's Organization (SCMPC), LGU Barangay of Iraan, NCIP and Tribe *Masikampo* were conducted.

The office encountered uncontrollable circumstances and issues when the Tribe *Masikampo* stated the need to secure a Free and Prior Informed Consent (FPIC) before the conduct of the activity since the area is within their ancestral claims.

With the assistance provided by Hon. Arnel Ortega of Sangguniang Bayan of Aborlan in communicating and explaining with the Tribe *Masikampo* the purpose of the conduct of the activity, the Survey Team was allowed to conduct the field works.

It was also clarified that the FPIC is one of the documentary requirements for CBFM renewal as stated in FMB Technical Bulletin No. 38. Hence, the CBFM will apply for such prior to renewal.

3. Actual survey was conducted by the Survey Team with representatives from LGU Barangay Iraan, IP group and CBFM PO members gathering geographic observation on the existing structures, actual claim and known boundary corners of the CBFM area as identified and pointed on the ground by CBFM-PO representatives (see Annex IV).
4. Laying out and monumenting of seventeen (17) boundary corners served with PVC Pipe 2 inches in diameter and 1 meter in length (see Annex V)

After plotting the data gathered, the following observations were noted:

1. That there is an overlap between the CBFM area and the CADT area of Tagbanua ICC and Cadastral Survey of Barangay Iraan, Aborlan (see Annex VI);
2. That portion of the cadastral survey which overlaps the CBFM falls within timberland (see Annex VII);
3. A 50-meter setback from the boundary of cadastral survey were obtained to prevent overlapping of boundary since lay-out of CBFM corners were set



Republic of the Philippines
Department of Environment and Natural Resources
Region IV - MIMAROPA
COMMUNITY ENVIRONMENT AND NATURAL RESOURCES OFFICE
PUERTO PRINCESA
South National Highway, Sta. Monica, Puerto Princesa City, Palawan
E-mail: cenropuertoprincesa@denr.gov.ph

through handheld GPS. The new CBFM area generated from 384.42 hectares before re-surveying is 330.28 hectares (see Annex II).

Attached are maps and photo documentation of the activities.

For information and further appropriate action.

DONNA BELLE E. LUENGO
Engineer II/Chief, SMU/GIS Unit
PENRO Palawan/Team Leader



JASON D. MONTIMOR
Forester I/Chief, GIS Unit

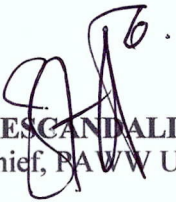

JESSIE M. ESCANDALIO
Forester I/Chief, PA/W Unit



PAULA MEI C. ATIENZA-GREGAS
Forester I/CBFM Desk Officer



MARIDOL M. ARDAIS, MES
Forest Technician I

Annex I

[illegible]

Annex II

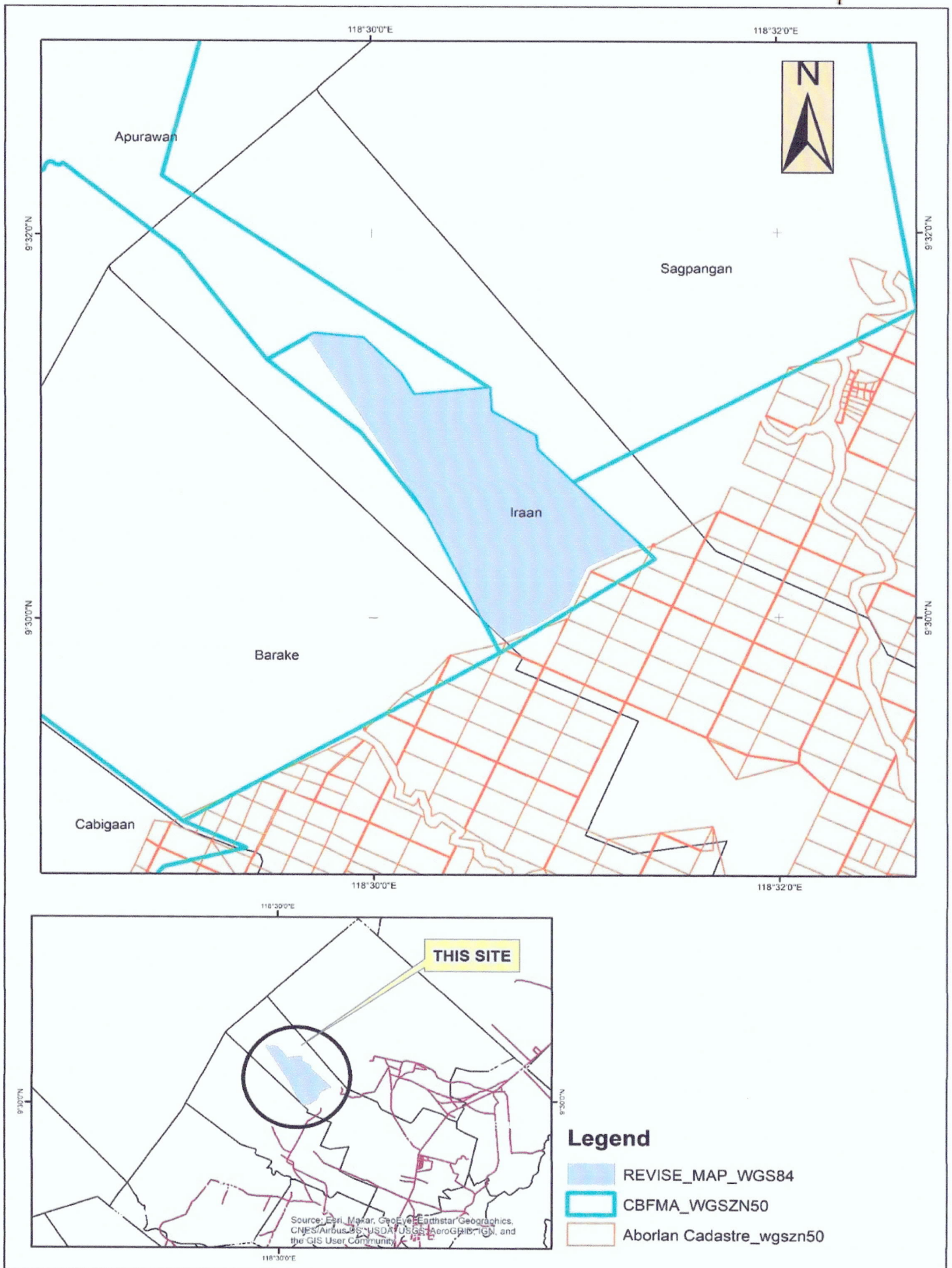

Annex III



Republic of the Philippines
Department of Environment and Natural Resources
MIMAROPA Region
Community Environment and Natural Resources Office
PUERTO PRINCESA
South National Highway, Sta. Monica, Puerto Princesa City, Palawan
E-mail: cenropuertoprincesa@denr.gov.ph

September 28, 2022

MS. MARIFE O. TITO

Chairperson

Sitio Communal Multi-Purpose Cooperative
Barangay Iraan, Aborlan, Palawan

Madam:

Environmental Greetings!

This has reference to the conduct of re-surveying and mapping of CBFM areas within the area of jurisdiction of CENRO Puerto Princesa. For this year, the CBFM area of Sitio Communal Multi-Purpose Cooperative located at Barangay Iraan, Aborlan is identified for the activity. The Survey Team shall conduct activities at the area in October 2022.

In this regard, may we request for representatives/members from your organization who are knowledgeable on the boundaries of the CBFM area to assist the Survey Team. Representative from this office shall coordinate with you on the details of the activities.

Hoping for your kind consideration on the request.

Thank you and best regards.

Very truly yours,

PEDRO A. VELASCO
OIC, CENR Officer

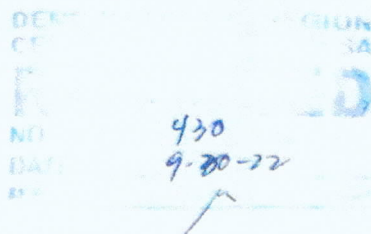



Republic of the Philippines
Department of Environment and Natural Resources
MIMAROPA Region
Community Environment and Natural Resources Office
PUERTO PRINCESA
South National Highway, Sta. Monica, Puerto Princesa City, Palawan
E-mail: cenropuertoprincesa@denr.gov.ph

September 28, 2022

HON. JAIME ORTEGA
Municipal Mayor
Municipality of Aborlan, Palawan

Dear Mayor Ortega:

Environmental Greetings!

This has reference to the conduct of re-surveying and mapping of CBFM areas within the area of jurisdiction of CENRO Puerto Princesa. For this year, the CBFM area of Sitio Communal Multi-Purpose Cooperative located at Barangay Iraan, Aborlan is identified for the activity. The Survey Team shall conduct activities at the area in October 2022.

In this regard, may we request for representative/s from the Municipal Environment and Natural Resources Office (MENRO) to join and assist the Survey Team. Representative from this office shall coordinate with you on the details of the activities.

Hoping for your kind consideration on the request.

Thank you and best regards.

Very truly yours,



PEDRO A. VELASCO
OIC, CENR Officer

RELEASED

DATE
BY

431
9-30-22

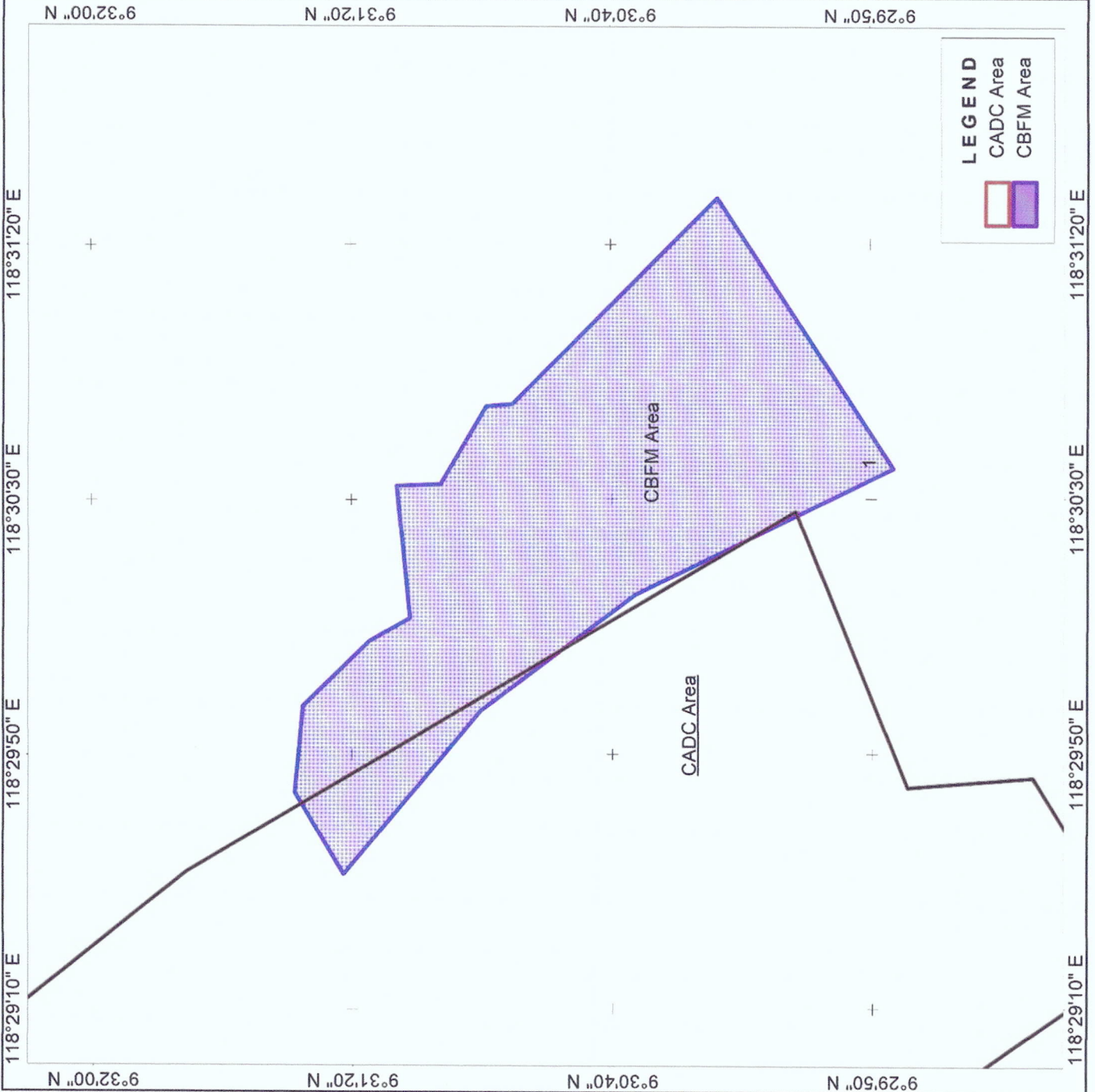
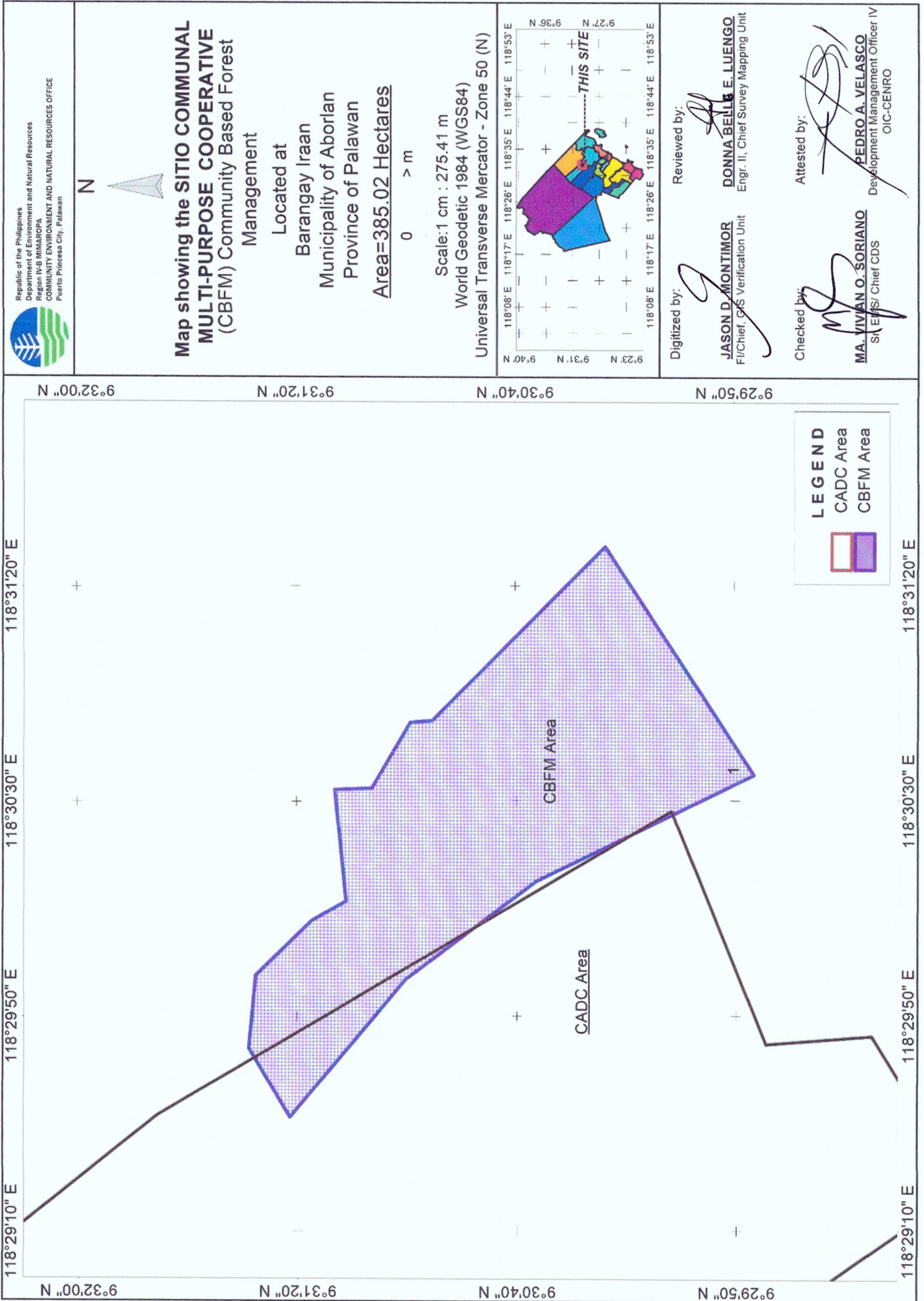
Annex IV



Annex V

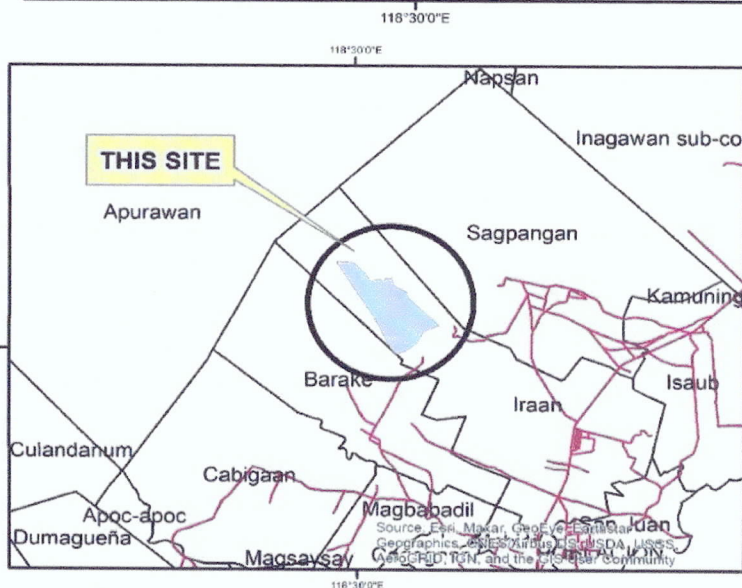
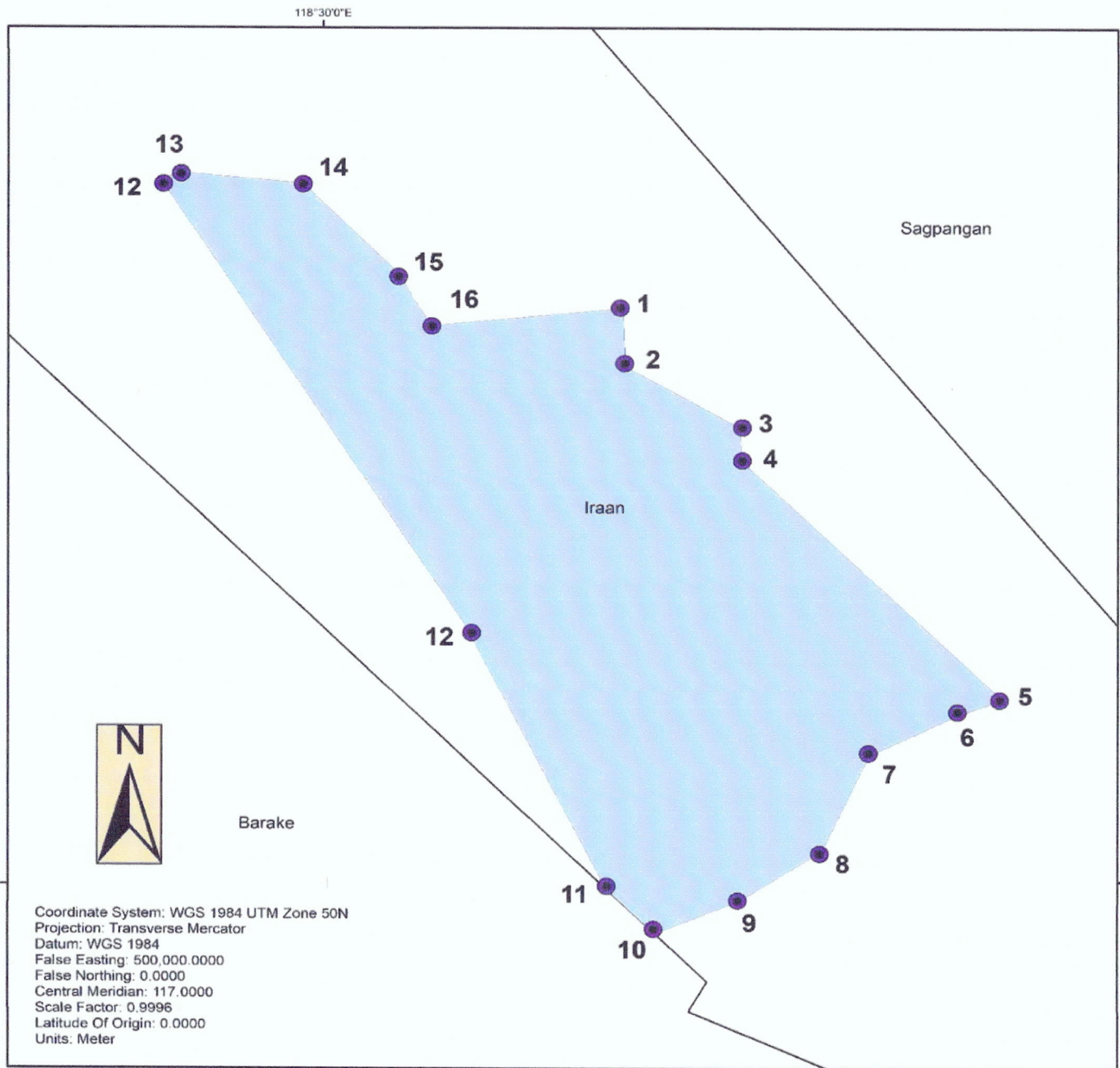

POINT	LATITUDE	LONGITUDE
1	9°31'11.662"N	118°30'34.717"E
2	9°31'4.37"N	118°30'34.985"E
3	9°30'56.704"N	118°30'48.241"E
4	9°30'52.433"N	118°30'48.553"E
5	9°30'22.753"N	118°31'18.86"E
6	9°30'20.949"N	118°31'13.851"E
7	9°30'15.794"N	118°31'3.258"E
8	9°30'3.819"N	118°30'57.676"E
9	9°29'57.506"N	118°30'47.779"E
10	9°29'53.548"N	118°30'38.169"E
11	9°29'59.178"N	118°30'32.514"E
12	9°30'32.062"N	118°30'16.217"E
13	9°31'27.693"N	118°29'40.957"E
14	9°31'28.777"N	118°29'42.777"E
15	9°31'27.383"N	118°29'57.403"E
16	9°31'16.265"N	118°30'8.41"E
17	9°31'9.548"N	118°30'12.286"E

Annex VI

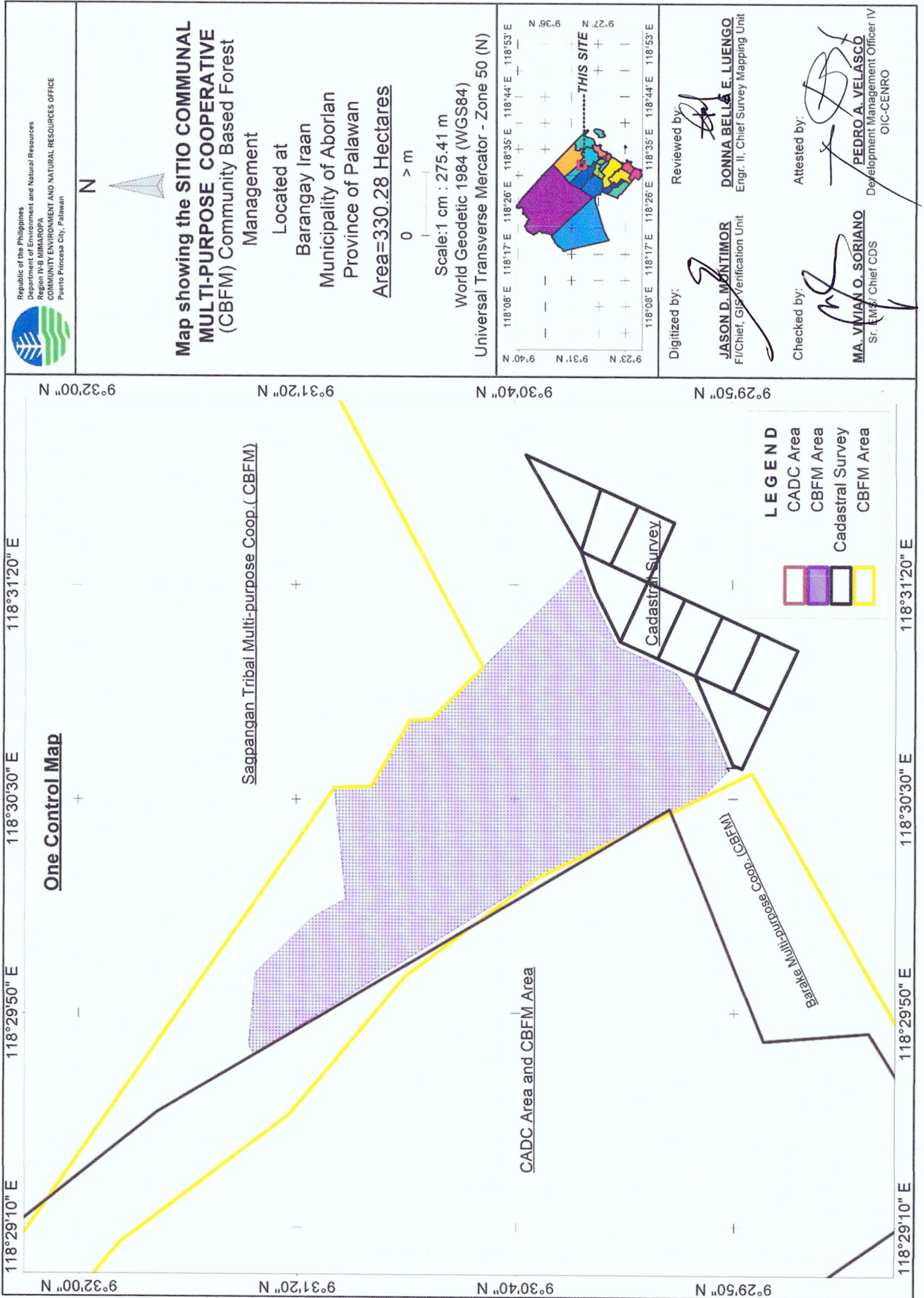

Annex VII

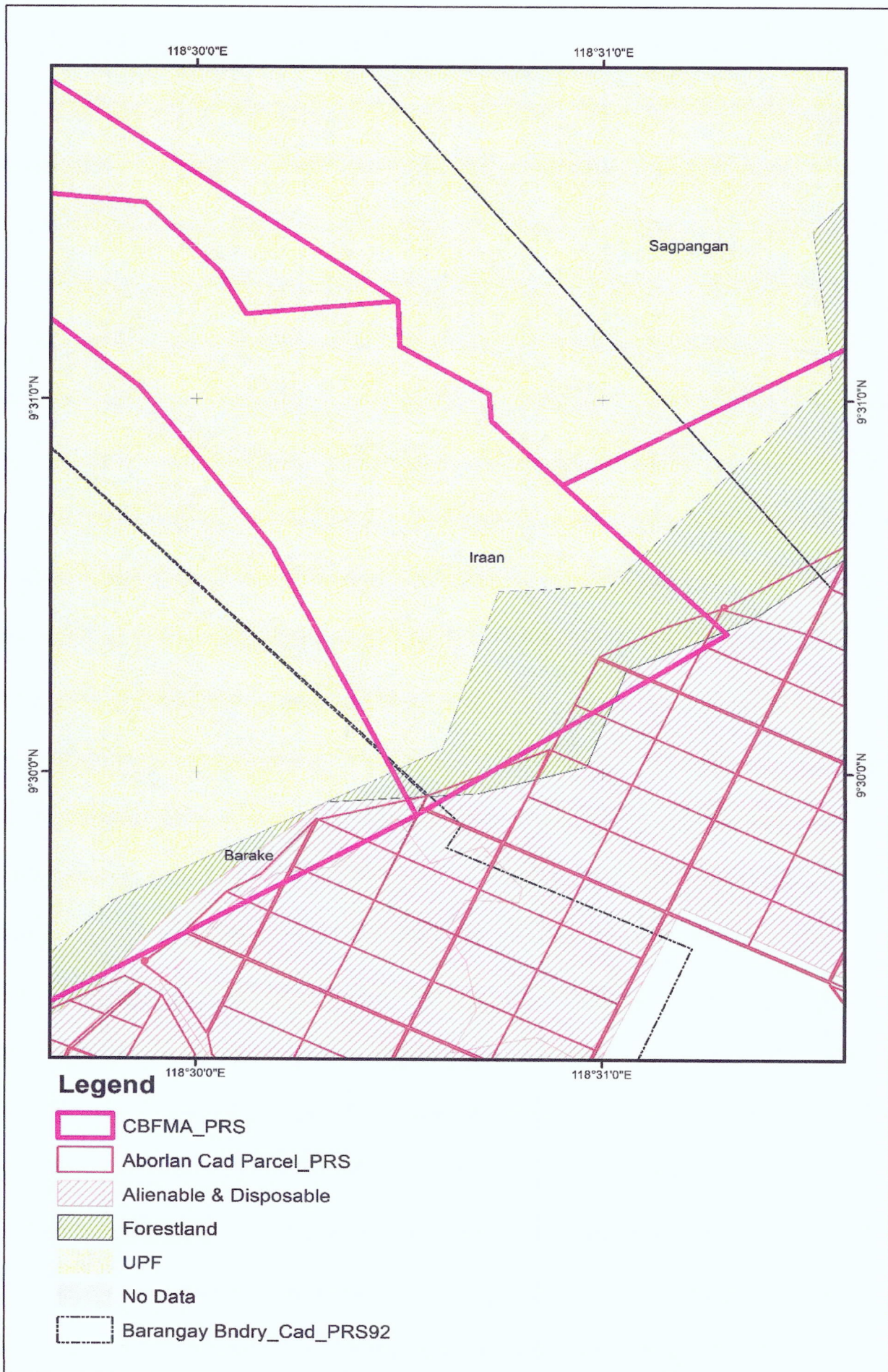



Republic of the Philippines
Department of Environment and Natural Resources
Region IV - MIMAROPA
COMMUNITY ENVIRONMENT AND NATURAL RESOURCES OFFICE
PUERTO PRINCESA
South National Highway, Sta. Monica, Puerto Princesa City, Palawan
E-mail: cenropuertoprincesa@denr.gov.ph

Photos taken during the verification of available data and documents by the Survey Team

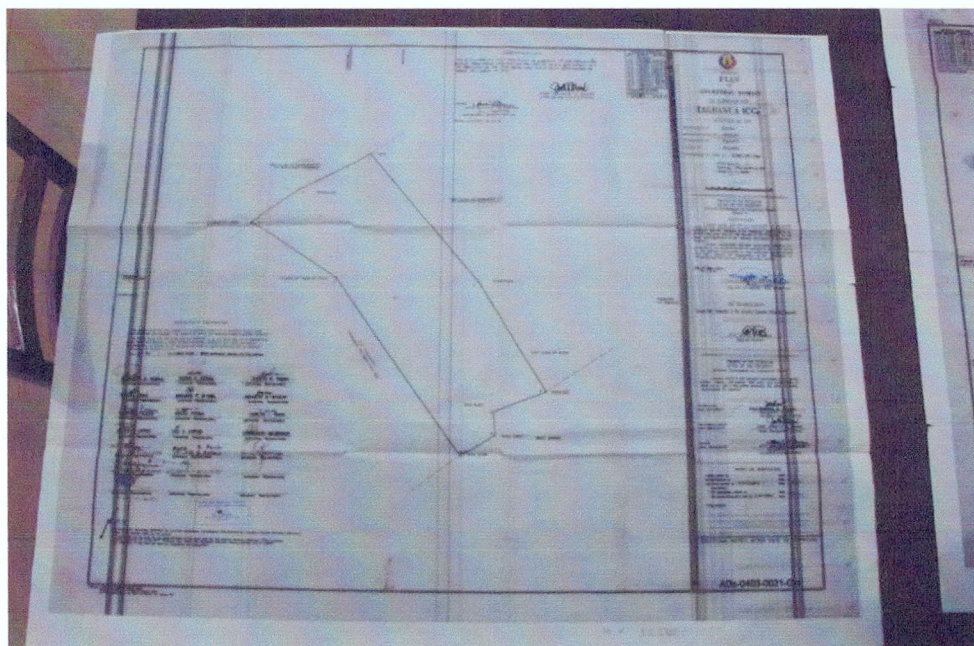



Republic of the Philippines
Department of Environment and Natural Resources
Region IV - MIMAROPA
COMMUNITY ENVIRONMENT AND NATURAL RESOURCES OFFICE
PUERTO PRINCESA
South National Highway, Sta. Monica, Puerto Princesa City, Palawan
E-mail: cenropuertoprincesa@denr.gov.ph

Photos taken during the conduct of the meeting with CBFM-PO SCMPC, LGU-Brgy. Iraan, and NCIP at the Cooperative Hall of SCMPC at Sitio Communal, Barangay Iraan, Aborlan, Palawan on October 27, 2022





Republic of the Philippines
Department of Environment and Natural Resources
Region IV - MIMAROPA
COMMUNITY ENVIRONMENT AND NATURAL RESOURCES OFFICE
PUERTO PRINCESA
South National Highway, Sta. Monica, Puerto Princesa City, Palawan
E-mail: cenropuertoprincesa@denr.gov.ph

Photos taken during the conduct of the meeting with CBFM-PO SCMPC, LGU-Brgy. Iraan, and NCIP at the Cooperative Hall of SCMPC at Sitio Communal, Barangay Iraan, Aborlan, Palawan on October 27, 2022





Republic of the Philippines
Department of Environment and Natural Resources
Region IV - MIMAROPA
COMMUNITY ENVIRONMENT AND NATURAL RESOURCES OFFICE
PUERTO PRINCESA
South National Highway, Sta. Monica, Puerto Princesa City, Palawan
E-mail: cenropuertoprincesa@denr.gov.ph

Photos taken during the conduct of the meeting with CBFM-PO SCMPC, LGU-Brgy. Iraan, and NCIP at the Cooperative Hall of SCMPC at Sitio Communal, Barangay Iraan, Aborlan, Palawan on October 27, 2022





Republic of the Philippines
Department of Environment and Natural Resources
Region IV - MIMAROPA
COMMUNITY ENVIRONMENT AND NATURAL RESOURCES OFFICE
PUERTO PRINCESA
South National Highway, Sta. Monica, Puerto Princesa City, Palawan
E-mail: cenropuertoprincesa@denr.gov.ph

Photos taken during the conduct of the meeting with CBFM-PO SCMPC, LGU-Brgy. Iraan, and NCIP at the Cooperative Hall of SCMPC at Sitio Communal, Barangay Iraan, Aborlan, Palawan on October 27, 2022





Republic of the Philippines
Department of Environment and Natural Resources
Region IV - MIMAROPA
COMMUNITY ENVIRONMENT AND NATURAL RESOURCES OFFICE
PUERTO PRINCESA
South National Highway, Sta. Monica, Puerto Princesa City, Palawan
E-mail: cenpuertoprincesa@denr.gov.ph

Photos taken during the conduct of the meeting with CBFM-PO SCMPC, LGU-Brgy. Iraan, and NCIP at the Cooperative Hall of SCMPC at Sitio Communal, Barangay Iraan, Aborlan, Palawan on October 27, 2022





Republic of the Philippines
Department of Environment and Natural Resources
Region IV - MIMAROPA
COMMUNITY ENVIRONMENT AND NATURAL RESOURCES OFFICE
PUERTO PRINCESA
South National Highway, Sta. Monica, Puerto Princesa City, Palawan
E-mail: cenropuertoprincesa@denr.gov.ph

*Photos taken during the consultative meeting at Barangay Iraan, Aborlan, Palawan
on December 6, 2022*





Republic of the Philippines
Department of Environment and Natural Resources
Region IV - MIMAROPA
COMMUNITY ENVIRONMENT AND NATURAL RESOURCES OFFICE
PUERTO PRINCESA
South National Highway, Sta. Monica, Puerto Princesa City, Palawan
E-mail: cenropuertoprincesa@denr.gov.ph

*Photos taken during the consultative meeting at Barangay Iraan, Aborlan, Palawan
on December 6, 2022*





Republic of the Philippines
Department of Environment and Natural Resources
Region IV - MIMAROPA
COMMUNITY ENVIRONMENT AND NATURAL RESOURCES OFFICE
PUERTO PRINCESA
South National Highway, Sta. Monica, Puerto Princesa City, Palawan
E-mail: cenropuertoprincesa@denr.gov.ph

*Photos taken during the consultative meeting at Barangay Iraan, Aborlan, Palawan
on December 6, 2022*





Republic of the Philippines
Department of Environment and Natural Resources
Region IV - MIMAROPA
COMMUNITY ENVIRONMENT AND NATURAL RESOURCES OFFICE
PUERTO PRINCESA
South National Highway, Sta. Monica, Puerto Princesa City, Palawan
E-mail: cenropuertoprincesa@denr.gov.ph

*Photos taken during the consultative meeting at Barangay Iraan, Aborlan, Palawan
on December 6, 2022*





Republic of the Philippines
Department of Environment and Natural Resources
Region IV - MIMAROPA
COMMUNITY ENVIRONMENT AND NATURAL RESOURCES OFFICE
PUERTO PRINCESA

South National Highway, Sta. Monica, Puerto Princesa City, Palawan
E-mail: cenropuertoprincesa@denr.gov.ph

Geotagged photos showing the conducted re-surveying, mapping and delineation of the portion of CBFM areas of So. Communal Multi-Purpose Cooperative located at Barangay Iraan, Aborlan, Palawan

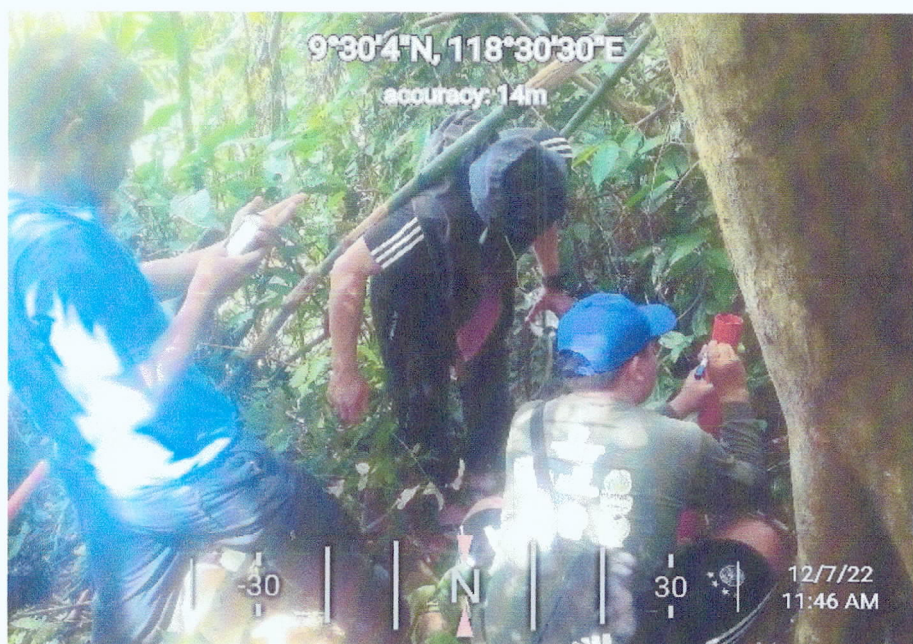



Republic of the Philippines
Department of Environment and Natural Resources
Region IV - MIMAROPA
COMMUNITY ENVIRONMENT AND NATURAL RESOURCES OFFICE
PUERTO PRINCESA
South National Highway, Sta. Monica, Puerto Princesa City, Palawan
E-mail: cenropuertoprincesa@denr.gov.ph

Geotagged photos showing the conducted re-surveying, mapping and delineation of the portion of CBFM areas of So. Communal Multi-Purpose Cooperative located at Barangay Iraan, Aborlan, Palawan

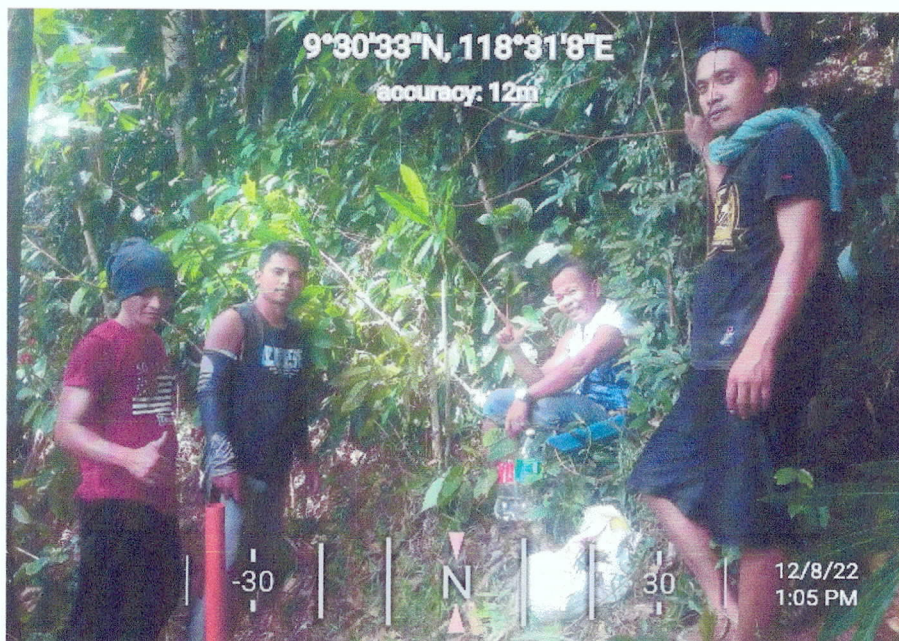



Geotagged photos showing the conducted re-surveying, mapping and delineation of the portion of CBFM areas of So. Communal Multi-Purpose Cooperative located at Barangay Iraan, Aborlan, Palawan





Geotagged photos showing the conducted re-surveying, mapping and delineation of the portion of CBFM areas of So. Communal Multi-Purpose Cooperative located at Barangay Iraan, Aborlan, Palawan

