



Republic of the Philippines  
**Department of Environment and Natural Resources**  
MIMAROPA REGION  
PROVINCIAL ENVIRONMENT AND NATURAL RESOURCES OFFICE  
Bgy. Sta. Monica, Puerto Princesa City, Palawan  
Telfax No. (048) 434-8791  
Email Add: [penropalawan@denr.gov.ph](mailto:penropalawan@denr.gov.ph)

DENR PALAWAN RECORDS SECTION	
RECEIVED	
23 JAN 2023	
<input checked="" type="checkbox"/> INCOMING	<input type="checkbox"/> OUTGOING
DATE NO.	

January 16, 2023

**MEMORANDUM**

**FOR** : The Regional Executive Director  
1515 DENR By the Bay Bldg., Roxas Blvd.  
Barangay 668, Ermita, Manila

**ATTENTION** : The OIC-Assistant Regional Director for Technical Services  
The OIC-Chief, Surveys and Mapping Division

**FROM** : The Provincial of Environment and  
Natural Resources Officer

**SUBJECT** : **REQUEST FOR CONFIRMATION OF LAND  
CLASSIFICATION STATUS OF LOT 10863-D, CSD-  
04032742-D FOR CARPETA WITH FPA NO. 045318-247-  
D**

This pertains to carpeta with FPA No. 045318-247-D applied by Mr. Eleuterio Bungalso covering Lot 10863-D, Csd-04032742-D requesting for confirmation of land classification status.

Per plotting and projection of this office using its tie line N 12-32 W, 2,637.70 m. from BLLM No. 1, Cad.862-D, Roxas Cadastre, the lot falls to Forestland per LC Map No. 2880, Project No. 14-C, Block A.

Attached is a map projection of this office for ready reference.

For further evaluation and consideration.

  
FELIZARDO B. CAYATOC

Reference No: 2021-2222  
TSD/RPS/SMU

DENR-PALAWAN  
PENRO-RECORDS  
**RELEASED**  
By   
Date: 19 JAN 2023 CN 23-180



FORESTLAND  
PROJECT NO. 14-C  
BLOCK A  
LC MAP NO. 2808

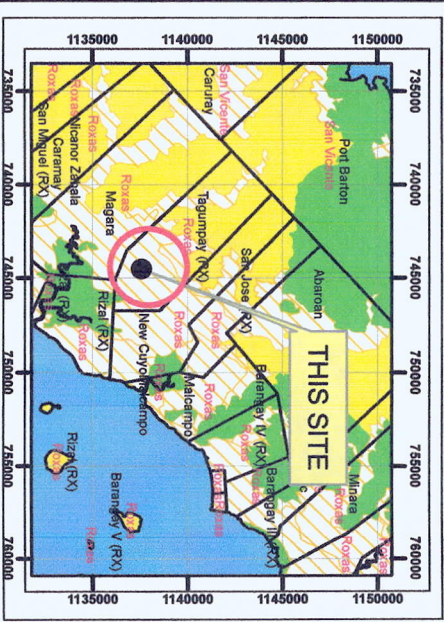
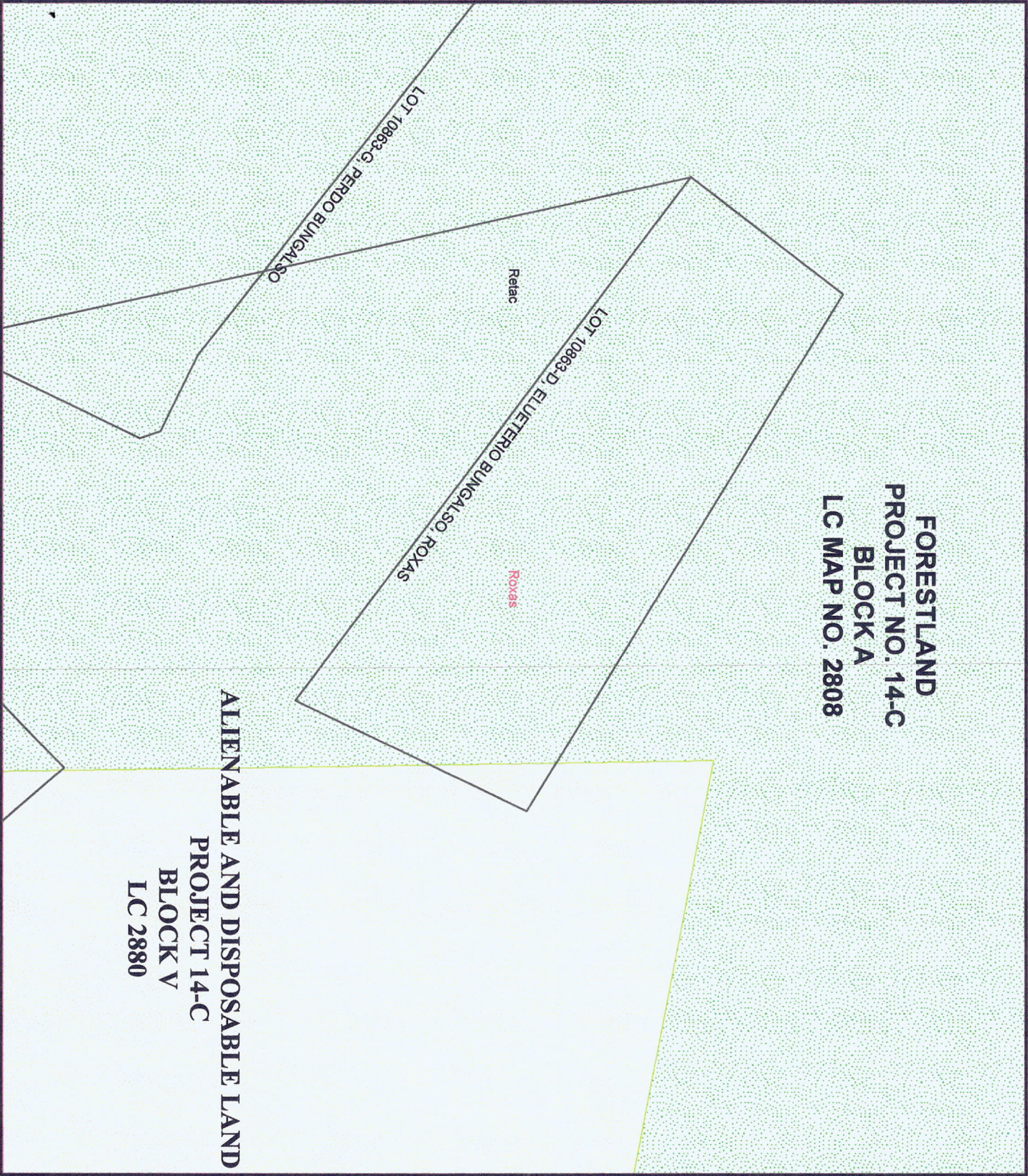

MAP SHOWING

THE RELATIVE LOCATION OF LOT 156  
FOR LC CERTIFICATION APPLIED BY  
DANTE DALABAN

Located at Brgy. Tagumpay Retac  
Municipality of Roxas  
Province of Palawan  
Coordinate System: Luzon 1911 UTM Zone 50N  
Projection: Transverse Mercator  
Datum: Luzon 1911

SCALE 1:2000

**Legend**

	Alienable & Disposable		Communal Forest
	No Data		Forestland
	UPF		

Prepared by:

DAVE N. BALMORES  
For III

DONNA BELLE E. LUENGO  
Chief, SML, Engr. II