



Republic of the Philippines  
**Department of Environment and Natural Resources**  
Provincial Environment and Natural Resources Office  
Sta. Monica, Puerto Princesa City, Palawan  
E-mail: [denrpenropalawan@gmail.com](mailto:denrpenropalawan@gmail.com)  
Telfax No. (048) 433-5638

DENR MIMAROPA RECORDS SECTION  
**RECEIVED**  
04 JAN 2023  
☐ INCOMING ☐ OUTGOING  
BY: \_\_\_\_\_ DATE NO. \_\_\_\_\_  
TIME: \_\_\_\_\_

December 19, 2022

**MEMORANDUM**

**FOR :** The Regional Executive Director  
DENR MIMAROPA Region  
1515 DENR By the Bay Building,  
Roxas Blvd., Bgy. 668, Ermita, Manila

**FROM :** The Provincial Environment and  
Natural Resources Officer

**SUBJECT :** **CLOSE-OUT REPORT RE: CONSTRUCTION OF SMALL  
WATER IMPOUNDING SYSTEM FOR THE PROVINCE OF  
PALAWAN**

Respectfully forwarded is the report of Conservation and Development Section of this office regarding the target activity for FY 2022 on Construction of Small Water Impounding System (SWIS) in the Province of Palawan.

Per report submitted, a total of three (3) impounding tanks were constructed located in Bgys. Caruray, San Vicente, Dumanguena, Narra and Bgy. Inogbong, Bataraza, Palawan. Attached are the supporting documents for the aforementioned activity. This report is being submitted to serve as MOV for the aforesaid activity.

For information and record.

For the PENRO:

*[Signature]*  
**RHODORA B. UBANI**  
Supervising ECOMS/Chief, CDS  
In-Charge, Office of the PENRO



DENR-PALAWAN  
PENRO-RECORDS  
**RELEASED**  
By: *[Signature]*  
Date: 20 DEC 2022 CN 22-3410





Republic of the Philippines  
**Department of Environment and Natural Resources**  
Provincial Environment and Natural Resources Office  
Sta. Monica, Puerto Princesa City, Palawan  
E-mail: [denrpenropalawan@gmail.com](mailto:denrpenropalawan@gmail.com)  
Telfax No. (048) 433-5638

December 15, 2022

**MEMORANDUM**

**FOR** : The PENR Officer  
PENRO Palawan

**FROM** : The Chief, Conservation and  
Development Section

**SUBJECT** : **CLOSE-OUT REPORT RE: CONSTRUCTION OF SMALL  
WATER IMPOUNDING SYSTEM FOR THE PROVINCE OF  
PALAWAN**

In line with our target for FY 2022 specifically under the Soil Conservation and Watershed Management – Construction of SWIS, respectfully submitted herewith is the close-out/final report of this office.

Please be informed that for this year, a total of three (3) structures were constructed – located at Bgy. Caruray, San Vicente; Bgy. Dumanguena, Narra; and in Bgy. Inogbong, Bataraza, Palawan. Further informed that prior to approval of funds, these areas have been approved by the FMB for establishment of SWIS. Please find their respective data/information below:

LOCATION	CAPACITY	CONTRACTOR	CONTRACT COST	DATE STARTED	DATE COMPLETED
1. Bgy. Caruray, San Vicente, Palawan	34 cu.m.	JDZDesign Construction Trading	Php 2,082,400.00	June 9, 2022	August 30, 2022
2. Bgy. Dumanguena, Narra, Palawan	34 cu.m	Hardshell Design and Construction	Php 2,154,251.60	July 7, 2022	December 10, 2022
3. Bgy. Inogbong, Bataraza, Palawan	34 cu.m	RABB Construction and Supply	Php 2,364,003.91	June 1, 2022	November 7, 2022

Attached are copies of Contract of Agreement, Program of Works and geotagged photos for the aforementioned project sites. This report serves as MOV for the aforesaid target activity.

For information and record.

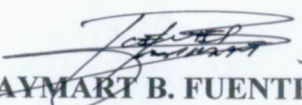
  
**RAYMART B. FUENTES**

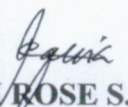
  
**LAURI ROSE S. COQUIA**

Noted by:

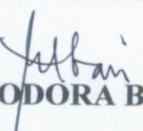
  
**RHODORA B. UBANI**

# Small Water Impounding System (SWIS)/Soil and Water Conservation (SWC) Monitoring Form (CY 2022-PENRO PALAWAN)

P/A/P Code/MFO	Province/ Municipality	Specific Location (Barangay/Sitio/Purok)	Geographic Coordinates	Creek/River/Spring Source	Water Utilization Purpose	Beneficiaries	Capacity/Materials (cu.m)/ Dimensions (LxWxH)	Contractor Name	Date Awarded	Project Start Date	Completion Date	Remarks
Ecosystem Management Services												
Soil and Water Conservation Measures (SWIS)												
Establishment of Structural Measures												
SWIS Impounding Tank w/ Spring Box	Palawan/San Vicente	Bgy. Caruray	10°17'18"N 119°3'22"E	spring	NGP Project/CBFM CARP/ Households	POs/Community	34 cu.m.	JDZDesign Construction Trading	June 9, 2022	June 9, 2022	August 30, 2022	
	Palawan/Narra	Bgy. Dumangueña	9°24'57"N 118°24'22"E	spring	NGP Project/CBFM CARP/ Households	POs/Community	34 cu.m.	Hardshell Design and Construction	July 7, 2022	July 7, 2022	December 10, 2022	
	Palawan/Bataraza	Bgy. Inogbong	8°43'24"N 117°38'47"E	spring	NGP Project/CBFM CARP/ Households	POs/Community	34 cu.m.	RABB Construction and Supply	June 1, 2022	June 1, 2022	November 7, 2022	

Prepared by:

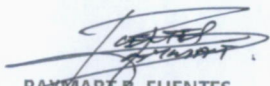
  
**RAYMART B. FUENTES**  
 Project Monitoring and Evaluation Officer

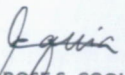
  
**LAUR ROSE S. COQUIA**  
 ECOMS I

Noted by:

  
**RHODORA B. UBANI**  
 Supervising ECOMS, Chief CDS





## PHOTODOCUMENTATION

### A. BGY. CARURAY, SAN VICENTE, PALAWAN







Republic of the Philippines  
**Department of Environment and Natural Resources**  
Provincial Environment and Natural Resources Office  
Sta. Monica, Puerto Princesa City, Palawan  
E-mail: [denrpenropalawan@gmail.com](mailto:denrpenropalawan@gmail.com)  
Telfax No. (048) 433-5638

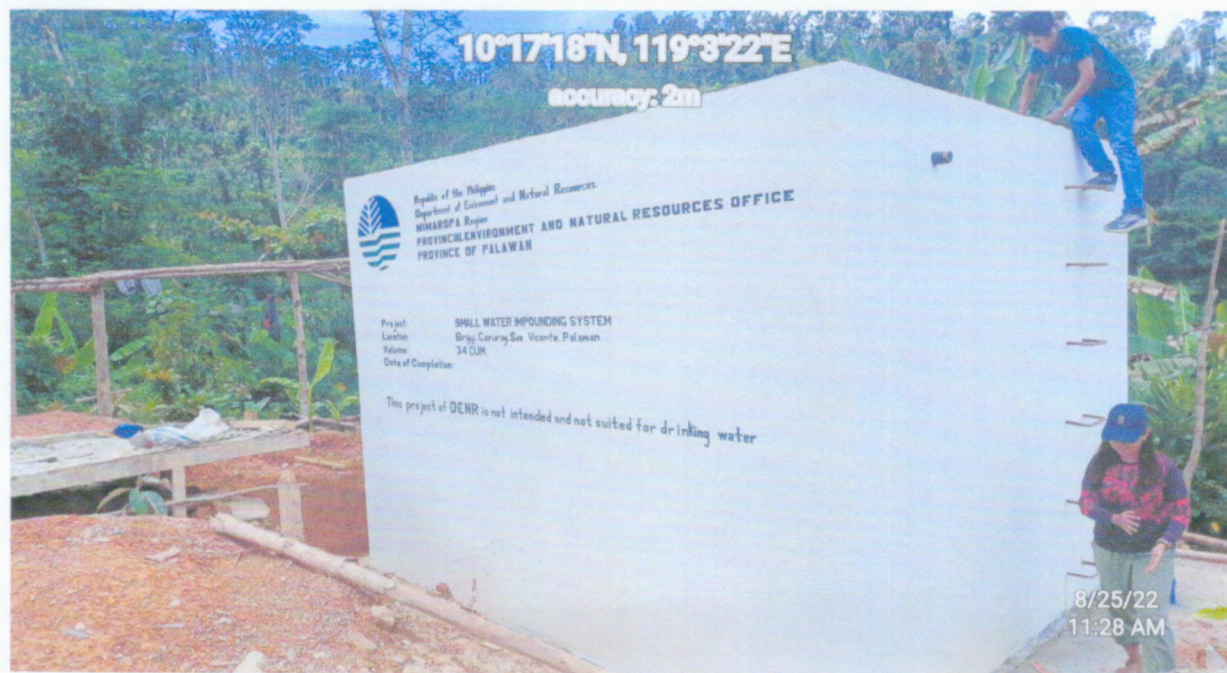





Republic of the Philippines  
**Department of Environment and Natural Resources**  
Provincial Environment and Natural Resources Office  
Sta. Monica, Puerto Princesa City, Palawan  
E-mail: [denrpenropalawan@gmail.com](mailto:denrpenropalawan@gmail.com)  
Telfax No. (048) 433-5638

## B. BGY. DUMANGUEÑA, NARRA, PALAWAN







Republic of the Philippines  
**Department of Environment and Natural Resources**  
Provincial Environment and Natural Resources Office  
Sta. Monica, Puerto Princesa City, Palawan  
E-mail: [denrpenropalawan@gmail.com](mailto:denrpenropalawan@gmail.com)  
Telfax No. (048) 433-5638







Republic of the Philippines  
**Department of Environment and Natural Resources**  
Provincial Environment and Natural Resources Office  
Sta. Monica, Puerto Princesa City, Palawan  
E-mail: [denrpenropalawan@gmail.com](mailto:denrpenropalawan@gmail.com)  
Telfax No. (048) 433-5638

### C. BGY. INOGBONG, BATARAZA, PALAWAN







Republic of the Philippines  
**Department of Environment and Natural Resources**  
Provincial Environment and Natural Resources Office  
Sta. Monica, Puerto Princesa City, Palawan  
E-mail: [denrpenropalawan@gmail.com](mailto:denrpenropalawan@gmail.com)  
Telfax No. (048) 433-5638







Republic of the Philippines  
**Department of Environment and Natural Resources**  
Provincial Environment and Natural Resources Office  
Sta. Monica, Puerto Princesa City, Palawan  
E-mail: [denrpenropalawan@gmail.com](mailto:denrpenropalawan@gmail.com)  
Telfax No. (048) 433-5638

December 19, 2022

**MEMORANDUM**

**FOR** : The Regional Executive Director  
DENR MIMAROPA Region  
1515 DENR By the Bay Building,  
Roxas Blvd., Bgy. 668, Ermita, Manila

**FROM** : The Provincial Environment and  
Natural Resources Officer

**SUBJECT** : **CLOSE-OUT REPORT RE: CONSTRUCTION OF SMALL  
WATER IMPOUNDING SYSTEM FOR THE PROVINCE OF  
PALAWAN**

Respectfully forwarded is the report of Conservation and Development Section of this office regarding the target activity for FY 2022 on Construction of Small Water Impounding System (SWIS) in the Province of Palawan.

Per report submitted, a total of three (3) impounding tanks were constructed located in Bgys. Caruray, San Vicente, Dumanguena, Narra and Bgy. Inogbong, Bataraza, Palawan. Attached are the supporting documents for the aforementioned activity. This report is being submitted to serve as MOV for the aforesaid activity.

For information and record.

For the PENRO:

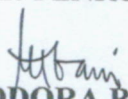
  
**RHODORA B. UBANI**  
Supervising ECOMS/Chief, CDS  
In-Charge, Office of the PENRO

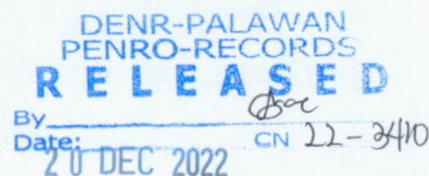
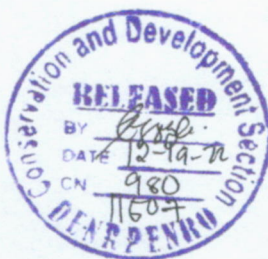





**NOTICE OF AWARD**

May 18, 2022

**MR. ZALDY A. LAGUISMA**  
**JDZDESIGN CONSTRUCTION TRADING**  
El Nido, Palawan

**SUBJECT: CONSTRUCTION OF SMALL WATER IMPOUNDING  
SYSTEM (SWIS) IN BGY. CARURAY, SAN VICENTE,  
PALAWAN**

Sir:

We are pleased to notify you that the contract for the *Construction of Small Water Impounding System (SWIS) in Bgy. Caruray, San Vicente, Palawan* which was subjected to bidding last March 21, 2022 is hereby awarded in your favor as the Bidder with the Single Calculated and Responsive Bid (SCRB) in the amount of **Two Million Eighty Two Thousand Four Hundred (Php 2,082,400.00)**.

You are therefore required, within ten (10) days from the receipt of this Award, to formally enter into Contract with us and to submit the required Performance Security in any of the following form/amount, to wit:

<b>Form of Security</b>	<b>Amount of Performance Security</b> <i>(Not less than the required percentage of total Contract Price)</i>
1. Cash, Certified Check, Cashier's Check, Manager's Check, Bank Draft or Irrevocable Letter of Credit	Five Percent (5%) of Contract Price
2. Bank Guarantee	Five Percent (5%) of Contract Price
3. Surety Bond	Thirty Percent (30%) of Contract Price

Failure to enter into said Contract or provide the Performance Security shall constitute a sufficient ground for cancellation of this Award.

Very truly yours,

**FELIZARDO B. CAYATOC**  
PENRO

Received by :

Date: 5-19-22



# CONTRACT AGREEMENT

2022-06-13-054

Name of Contract : **CONSTRUCTION OF SMALL WATER IMPOUNDING SYSTEM (SWIS) IN BGY. CARURAY, SAN VICENTE, PALAWAN**

THIS AGREEMENT made this JUN 09 2022 day of between **DENR-PENRO, Palawan** with office address at Bgy. Sta. Monica, Puerto Princesa City Palawan, represented by **PENRO FELIZARDO B. CAYATOC** herein called "**THE ENTITY**" of the one part; and **JDZDESIGN CONSTRUCTION TRADING** represented by **MR. ZALDY A. LAGUISMA** with office address at Bgy. Masagana, El Nido, Palawan herein called "**THE CONTRACTOR**" of the other part;

WHEREAS the Entity invited Bids for the **CONSTRUCTION OF SMALL WATER IMPOUNDING SYSTEM (SWIS) IN BGY. CARURAY, SAN VICENTE, PALAWAN** and has accepted the Bid by the Contractor for the supply of materials, labor and equipment of the aforementioned construction in the sum of **TWO MILLION EIGHTY-TWO THOUSAND FOUR HUNDRED PESOS (Php 2,082,400.00)** herein called "the Contract Price".

## NOW THIS AGREEMENT WITNESSETH AS FOLLOWS:

1. In this Agreement words and expressions shall have the same meanings as are respectively assigned to them in the Conditions of Contract referred to.
2. The following documents shall be deemed to form and be read and construed as part of this Agreement, to wit:
  - a. General and Special Conditions of Contract;
  - b. Drawings/Plans;
  - c. Specifications;
  - d. Invitation to Bid;
  - e. Instruction to Bidders;
  - f. Bid Data Sheet;
  - g. Addenda and/or Supplemental Bid/Bid Bulletins, if any;
  - h. Bid form, including all documents/statements contained in the Bidder's bidding envelopes, as annexes and all other documents submitted
  - i. Eligibility requirements, documents and/or statements;
  - j. Performance Security;
  - k. Notice of Award of Contract and the Bidder's conforme thereto;
  - l. Other Contract documents that may be required by existing laws and/or the Entity.
3. The Contractor shall undertake the following works:
  - a. Construction of Temporary Facilities;
  - b. Installation of Project Billboard/Signboard;
  - c. Occupational Safety and Health Program;
  - d. Mobilization/Demobilization;
  - e. Clearing and Grubbing;
  - f. Structure Excavation and Backfilling;
  - g. Structural Concrete Class A;
  - h. Structural Concrete, Painting Works;
  - i. Reinforcing Steel Bars, Grade 60;



- IN WITNESS whereof, the parties hereto have caused this Agreement to be executed in accordance with the laws of the Republic of the Philippines on the day and year first above written.

**ATTY. JOSEPH ALLEN P. QUINON**  
 Notary Public  
 UNTIL  
 COMMISSIONED UNTIL JUNE 30, 2022  
 Roll No. 47519/TIN No. 223-879-182  
 IBP No. 001917/PTR No. 0891062  
 NCLE No. VI-0027765





Republic of the Philippines  
Department of Environment and Natural Resources  
Region IV (MIMAROPA)  
**PROVINCIAL ENVIRONMENT AND NATURAL RESOURCES OFFICE**  
Sta. Monica, Puerto Princesa City, Palawan  
Email ad: [denrpalawan@yahoo.com](mailto:denrpalawan@yahoo.com)  
TeleFax #: (048) 433-5638

**Name of Contract : CONSTRUCTION OF SMALL WATER IMPOUNDING SYSTEM (SWIS)**

**Location of the Contract: Bgy. Caruray, San Vicente, Palawan**

-----

**NOTICE TO PROCEED**

\_\_\_\_\_  
**MR. ZALDY A. LAGUISMA**  
**JDZDESIGN CONSTRUCTION TRADING**  
Bgy. Masagana, El Nido, Palawan

Dear Sir;

With reference to the attached approved Contract Agreement with you for the above-stated contract, you are hereby advised to proceed with the implementation of the said Contract within seven (7) days upon receipt hereof. You shall execute the Contract works in accordance with the terms and conditions of the Contract Agreement.

Please acknowledge receipt and acceptance of this Notice by signing both copies in the space provided below. Keep one copy and return the other to us.

Very truly yours,

  
**FELIZARDO B. CAYATOC**  
PENRO

I acknowledge receipt of this Notice on 6-9-2022.

  
**ZALDY A. LAGUISMA**  
Contractor



**REPUBLIC OF THE PHILIPPINES**  
**DEPARTMENT OF ENVIRONMENT AND NATURAL RESOURCES**  
**REGION IV-B MIMAROPA**  
**PROVINCIAL ENVIRONMENT AND NATURAL RESOURCES OFFICE**

**PROGRAM OF WORKS FOR CONSTRUCTION OF SMALL WATER IMPOUNDING SYSTEM**

PROJECT: CONSTRUCTION OF SMALL WATER  
IMPOUNDING SYSTEM (SWIS)  
LOCATION: BGY. CARURAY, SAN VICENTE, PALAWAN  
APPROPRIATION: Php2,490,333.33  
CAL. DAYS TO COMPLETE: 150 DAYS

ITEM NO.	DESCRIPTION	QUANTITY	UNIT	UNIT COST	TOTAL COST
<b>GENERAL REQUIREMENTS</b>					
A.1.1(5)	CONSTRUCTION OF TEMP. FACILITIES	1	LOT	32,812.50	32,812.50
<b>OTHER GENERAL REQUIREMENTS</b>					
B.5	PROJECT BILLBOARD/SIGNBOARD	1	LOT	8,531.25	8,531.25
B.7	OCCUPATIONAL SAFETY AND HEALTH	1	LOT	6,930.00	6,930.00
B.9	PROGRAM	1	LOT	26,145.00	26,145.00
<b>EARTHWORKS</b>					
1700(1)	CLEARING & GRUBBING	1	LOT	39,375.00	39,375.00
803 (1) c	STRUCTURE EXCAVATION & BACKFILLING	25	CU.M.	767.81	19,195.31
<b>STRUCTURAL CONCRETE</b>					
405(1)	STRUCTURAL CONCRETE CLASS A	90	CU.M.	10,438.46	939,461.25
405 (6)	STRUCTURAL CONCRETE, PAINTING	195	SQM	128.66	25,089.33
<b>WORKS</b>					
<b>REINFORCING STEEL BARS</b>					
902.1.a2	REINFORCING STEEL BARS GRADE 60	2983.08	KLS	92.29	275,313.45
<b>FORMS AND FALSEWORKS</b>					
414	FORMS AND FALSEWORKS	1	LOT	162,827.44	162,827.44
<b>DRAIN PIPE</b>					
1001(1)	DRAIN PIPE	1800	LM.	476.63	857,940.82
<b>SUB-TOTAL</b>					<b>2,393,621.35</b>

**DIRECT COST**

1 MATERIALS	1,427,062.70	
2 LABOR	402,348.81	
<b>TOTAL DIRECT COST</b>	<b>1,829,411.51</b>	73.46%

OCM EXPENSES	269,776.73	10.83%
CONTRACTOR PROFIT	180,451.15	7.25%
VAT	113,981.97	4.58%
	<b>2,393,621.35</b>	

ESAO	71,808.64	2.88%
PLAN PREPARATION	24,903.33	1.00%
<b>TOTAL APPROPRIATION</b>	<b>2,490,333.33</b>	<b>100.00%</b>

Prepared by:

**FERNANDO BERNARD L. FUERTES**  
Civil Engineer  
PRC ID# 0168767

**RECOMMENDING APPROVAL:**

**PABLO L. CRUZ**  
CENRO ROXAS

Checked & Verified By:

**AUDRE ROSE S. OCAMPO**  
TWG, Chairman

Approved:

**ERIBERTO B. SANOS**  
PENRO



CONSTRUCTION OF SMALL WATER  
IMPOUNDING SYSTEM (SWIS)  
BGY. CARURAY, SAN VICENTE, PALAWAN  
DETAILED ESTIMATE

ITEM OF WORKS:	GENERAL REQUIREMENTS			DATE:	JAN. 04, 2022
ITEM NO.:	A.1.1(5)			TOTAL COST:	32,812.50
WORK DESCRIPTION:	CONSTRUCTION OF TEMP. FACILITIES			QTY.	1 LOT
A. MATERIALS					
DESCRIPTION		QUANTITY	UNIT	UNIT COST	AMOUNT
PROVISION OF FIELD OFFICE		1	L.S.	25,000.00	25,000.00
					-
					-
		SUB-TOTAL			25,000.00
B. LABOR					
					-
		SUB-TOTAL			0.00
C. ESTIMATED DIRECT COST (EDC)= a+b					25,000.00
D. INDIRECT COST/MARK-UP					
		OC as_15% of EDC			3,750.00
		PROFIT as_10% of EDC			2,500.00
		TOTAL OF (D)			6,250.00
E. VALUE ADDED TAX_5_% of C+D					1,562.50
F. TOTAL COST =C+D+E					32,812.50
G. UNIT COST/ LOT					32,812.50

ITEM OF WORKS:	OTHER GENERAL REQUIREMENTS			DATE:	JAN. 04, 2022
ITEM NO.:	B.5			TOTAL COST:	8,531.25
WORK DESCRIPTION:	PROJECT BILLBOARD/SIGNBOARD			QTY.	1 LOT
A. MATERIALS					
DESCRIPTION		QUANTITY	UNIT	UNIT COST	AMOUNT
PROJECT BILLBOARD/SIGNBOARD		1	L.S	5,000.00	5,000.00
					-
		SUB-TOTAL			5,000.00
B. LABOR					
					1,500.00
					-
		SUB-TOTAL			1,500.00
C. ESTIMATED DIRECT COST (EDC)= a+b					6,500.00
D. INDIRECT COST/MARK-UP					
		OC as_15% of EDC			975.00
		PROFIT as_10% of EDC			650.00
		TOTAL OF ( E )			1,625.00
E. VALUE ADDED TAX_5_% of C+D					406.25
F. TOTAL COST = C+D+E					8,531.25
G. UNIT COST/ LOT					8,531.25



CONSTRUCTION OF SMALL WATER  
IMPOUNDING SYSTEM (SWIS)  
BGY. CARURAY, SAN VICENTE, PALAWAN  
DETAILED ESTIMATE

ITEM OF WORKS:	OTHER GENERAL REQUIREMENTS			DATE:	JAN. 04, 2022
				TOTAL COST:	6,930.00
ITEM NO.:	B.7				
WORK DESCRIPTION:	OCCUPATIONAL SAFETY AND HEALTH PROGRAM QTY.				1 LOT
A. MATERIALS					
DESCRIPTION		QUANTITY	UNIT	UNIT COST	AMOUNT
PPE's		1	L.S	6,000.00	6,000.00
		SUB-TOTAL			6,000.00
B. LABOR					
		SUB-TOTAL			0.00
C. ESTIMATED DIRECT COST (EDC)= a+b					6,000.00
D. INDIRECT COST/MARK-UP					
		OC as_15% of EDC			
		PROFIT as_10% of EDC			600.00
		TOTAL OF ( E )			600.00
E. VALUE ADDED TAX_5_% of C+D					330.00
F. TOTAL COST = C+D+E					6,930.00
G. UNIT COST/ LOT					6,930.00

ITEM OF WORKS:	OTHER GENERAL REQUIREMENTS	DATE:	JAN. 04, 2022	
		TOTAL COST:	26,145.00	
ITEM NO.:	B.9			
WORK DESCRIPTION:	MOBILIZATION / DEMOBILIZATION	QTY.	1 LOT	
A. MATERIALS				
DESCRIPTION	QUANTITY	UNIT	UNIT COST	AMOUNT
MOBILIZATION / DEMOBILIZATION	1	L.S	24,900.00	24,900.00
	SUB-TOTAL			24,900.00
B. LABOR				
	SUB-TOTAL			0.00
C. ESTIMATED DIRECT COST (EDC)= a+b				24,900.00
D. INDIRECT COST/MARK-UP				
	OC as_15% of EDC			
	PROFIT as_10% of EDC			
	TOTAL OF ( E )			0.00
E. VALUE ADDED TAX_5_% of C+D				1,245.00
F. TOTAL COST = C+D+E				26,145.00
G. UNIT COST/ LOT				26,145.00



CONSTRUCTION OF SMALL WATER  
IMPOUNDING SYSTEM (SWIS)  
BGY. CARURAY, SAN VICENTE, PALAWAN  
DETAILED ESTIMATE

ITEM OF WORKS:	EARTHWORKS	DATE:	JAN. 04, 2022	
		TOTAL COST:	39,375.00	
ITEM NO.:	1700(1)			
WORK DESCRIPTION:	CLEARING & GRUBBING	QTY.	1 LOT	
A. MATERIALS				
DESCRIPTION	QUANTITY	UNIT	UNIT COST	AMOUNT
CLEARING & GRUBBING	1	L.S.	30,000.00	30,000.00
				-
	SUB-TOTAL			30,000.00
B. LABOR				-
	SUB-TOTAL			0.00
C. ESTIMATED DIRECT COST (EDC)= a+b				30,000.00
D. INDIRECT COST/MARK-UP				
	OC as_15% of EDC			4,500.00
	PROFIT as_10% of EDC			3,000.00
	TOTAL OF ( E )			7,500.00
E. VALUE ADDED TAX_5_% of C+D				1,875.00
F. TOTAL COST = C+D+E				39,375.00
G. UNIT COST/ LOT				39,375.00

ITEM OF WORKS:	EARTHWORKS	DATE:	JAN. 04, 2022	
ITEM NO.:	803 (1) c	TOTAL COST:	19,195.31	
WORK DESCRIPTION:	STRUCTURE EXCAVATION & BACKFILLING	QTY.	25 cu.m.	
A. MATERIALS				
DESCRIPTION	QUANTITY	UNIT	UNIT COST	AMOUNT
REMOVAL OF SEDIMENT	25	cu.m.	450	11,250.00
				-
				-
	SUB-TOTAL			11,250.00
B. LABOR				3,375.00
				-
	SUB-TOTAL			3,375.00
C. ESTIMATED DIRECT COST (EDC)= a+b				14,625.00
D. INDIRECT COST/MARK-UP				
	OC as_15% of EDC			2,193.75
	PROFIT as_10% of EDC			1,462.50
	TOTAL OF ( E )			3,656.25
E. VALUE ADDED TAX_5_% of D+E				914.06
F. TOTAL COST = D+E+F				19,195.31
G. UNIT COST/ LOT				767.81



CONSTRUCTION OF SMALL WATER  
IMPOUNDING SYSTEM (SWIS)  
BGY. CARURAY, SAN VICENTE, PALAWAN  
DETAILED ESTIMATE

ITEM OF WORKS:	STRUCTURAL CONCRETE			DATE:	JAN. 04, 2022
				TOTAL COST:	939,461.25
ITEM NO.:	405(1)				
WORK DESCRIPTION:	STRUCTURAL CONCRETE CLASS A (IMPOUNDING,RESERVOIR(1UNIT) )			QTY.	90 CU.M
A. MATERIALS					
	DESCRIPTION	QUANTITY	UNIT	UNIT COST	AMOUNT
	PORTLAND CEMENT	990.00	BAGS	380	376,200.00
	GRAVEL 3/4	60.00	CU.M.	1900	114,000.00
	SAND SCREENED	30.00	CU.M.	1900	57,000.00
	SAHARA CEMENT	40.00	PACK	85	3,400.00
					-
		SUB-TOTAL			550,600.00
B. LABOR					
					165,180.00
					-
		SUB-TOTAL			165,180.00
C. ESTIMATED DIRECT COST (EDC)= a+b					715,780.00
D. INDIRECT COST/MARK-UP					
		OC as_15% of EDC			107,367.00
		PROFIT as_10% of EDC			71,578.00
		TOTAL OF ( D )			178,945.00
E. VALUE ADDED TAX_5_% of C+D					44,736.25
F. TOTAL COST = C+D+E					939,461.25
G. UNIT COST/ LOT					10,438.46



CONSTRUCTION OF SMALL WATER  
IMPOUNDING SYSTEM (SWIS)  
BGY. CARURAY, SAN VICENTE, PALAWAN  
DETAILED ESTIMATE

ITEM OF WORKS:	STRUCTURAL CONCRETE	DATE:	JAN. 04, 2022	
		TOTAL COST:	25,089.33	
ITEM NO.:	405 (6)			
WORK DESCRIPTION:	STRUCTURAL CONCRETE,PAINTING WORKS (IMPOUNDING, RESERVOIR(1-UNIT) )	QTY.	1 LOT	
A. MATERIALS				
DESCRIPTION	QUANTITY	UNIT	UNIT COST	AMOUNT
PRIMER PAINT	9	GALS	655	5,895.00
SEMI LATEX PAINT (WHITE)	9	GALS	655	5,895.00
SEMI LATEX PAINT (GREEN)	2	GALS	680	1,360.00
SEMI LATEX PAINT (BLUE)	2	GALS	680	1,360.00
PAINT BRUSH (2")	3	PCS	24.79	74.37
PAINT BRUSH (1")	3	PCS	20	60.00
PAINT BRUSH (1/2")	3	PCS	20	60.00
				-
	SUB-TOTAL			14,704.37
B. LABOR				4,411.31
				-
	SUB-TOTAL			4,411.31
C. ESTIMATED DIRECT COST (EDC)= a+b				19,115.68
D. INDIRECT COST/MARK-UP				
	OC as_15% of EDC			2,867.35
	PROFIT as_10% of EDC			1,911.57
	TOTAL OF ( D )			4,778.92
E. VALUE ADDED TAX_5_% of C+D				1,194.73
F. TOTAL COST = C+D+E				25,089.33
G. UNIT COST/ LOT				128.66



CONSTRUCTION OF SMALL WATER  
IMPOUNDING SYSTEM (SWIS)  
BGY. CARURAY, SAN VICENTE, PALAWAN  
DETAILED ESTIMATE

ITEM OF WORKS:	<b>REINFORCING STEEL BARS</b>	DATE:	JAN. 04, 2022
		TOTAL COST:	275,313.45

ITEM NO.:	902.1.a2		
WORK DESCRIPTION:	REINFORCING STEEL BARS GRADE 60 (IMPOUNDING, FILTRATION, RESERVOIR(1-UNIT))	QTY.	2983.08 KLS

A. MATERIALS

DESCRIPTION	QUANTITY	UNIT	UNIT COST	AMOUNT
16mm Ø RSB	616.20	kls	47.46	29,244.85
12 mm Ø RSB	2,296.20	kls	52.44	120,412.73
10 mm Ø RSB	70.68	kls	57.63	4,073.29
#16 TIE WIRE	50.00	kls	85	4,250.00
HACKSAW BLADE	5.00	box	675	3,375.00

SUB-TOTAL

**161,355.87**

B. LABOR

48,406.76

SUB-TOTAL

**48,406.76**

C. ESTIMATED DIRECT COST (EDC)= a+b

**209,762.63**

D. INDIRECT COST/MARK-UP

OC as\_15% of EDC  
PROFIT as\_10% of EDC  
TOTAL OF ( D )

31,464.39

20,976.26

**52,440.66**

E. VALUE ADDED TAX\_5\_% of C+D

**13,110.16**

F. TOTAL COST = C+D+E

**275,313.45**

G. UNIT COST/ LOT

**92.29**



CONSTRUCTION OF SMALL WATER  
IMPOUNDING SYSTEM (SWIS)  
BGY. CARURAY, SAN VICENTE, PALAWAN  
DETAILED ESTIMATE

ITEM OF WORKS:	FORMS AND FALSEWORKS	DATE:	JAN. 04, 2022
ITEM NO.:	414	TOTAL COST:	162,827.44
WORK DESCRIPTION:	FORMS AND FALSEWORKS	QTY.	1LOT

A. MATERIALS

DESCRIPTION	QUANTITY	UNIT	UNIT COST	AMOUNT
3/4"THK. MARINE PLYWOOD	40.00	PCS.	1137	45,480.00
2'x2'x10' GOOD LUMBER	500.00	BDFT.	55	27,500.00
2'x3'x10' GOOD LUMBER	370.00	BDFT.	55	20,350.00
ASSTD. NAIL (1")	10.00	KGS	70	700.00
ASSTD. NAIL (2 1/2")	10.00	KGS	70	700.00
ASSTD. NAIL (3")	10.00	KGS	70	700.00
				-
SUB-TOTAL				95,430.00

B. LABOR

	28,629.00
	-
SUB-TOTAL	28,629.00

C. ESTIMATED DIRECT COST (EDC)= a+b

D. INDIRECT COST/MARK-UP

OC as_15% of EDC	18,608.85
PROFIT as_10% of EDC	12,405.90
TOTAL OF ( E )	31,014.75

E. VALUE ADDED TAX\_5\_% of C+D

F. TOTAL COST = C+D+E

G. UNIT COST/ LOT

7,753.69  
162,827.44  
162,827.44



CONSTRUCTION OF SMALL WATER  
IMPOUNDING SYSTEM (SWIS)  
BGY. CARURAY, SAN VICENTE, PALAWAN  
DETAILED ESTIMATE

ITEM OF WORKS: **DRAIN PIPE**

DATE: JAN. 04, 2022

TOTAL COST: 857,940.82

ITEM NO.: 1001(1)

WORK DESCRIPTION: DRAIN PIPE

QTY. 1800 LM.

**A. MATERIALS**

DESCRIPTION	QUANTITY	UNIT	UNIT COST	AMOUNT
2' Dia. G.I PIPE SCHEDULE 40	4	PCS	2,730.00	10,920.00
2' Dia. G.I ELBOW 90° SCHED 40	6	PCS	310.00	1,860.00
PE PIPES 2' Dia. (60m) SDR 17	30	ROLLS	14,500.00	435,000.00
2' Dia. dia. GATE VALVE	7	PCS	1,450.00	10,150.00
COMPRESSION COUPLING 2' Dia.	29	PCS	460.00	13,340.00
COMPRESSION TEE 2' Dia.	1	PCS	652.46	652.46
2' Dia.. End CAP	2	PCS	450.00	900.00
COMMUNAL FAUCET	12	PCS	2,500.00	30,000.00

SUB-TOTAL

502,822.46

**B. LABOR**

150,846.74

SUB-TOTAL

150,846.74

C. ESTIMATED DIRECT COST (EDC)= a+b

653,669.20

D. INDIRECT COST/MARK-UP

OC as\_15% of EDC

98,050.38

PROFIT as\_10% of EDC

65,366.92

TOTAL OF ( D )

163,417.30

E. VALUE ADDED TAX\_5\_% of C+D

40,854.32

F. TOTAL COST = C+D+E

857,940.82

G. UNIT COST/ LOT

476.63



# SUMMARY

ITEM NO.	SCOPE OF WORKS	COST		
		MATERIALS	LABOR	TOTAL COST
	<b>GENERAL REQUIREMENTS</b>			
A.1.1(5)	CONSTRUCTION OF TEMP. FACILITIES	25,000.00		25,000.00
	<b>OTHER GENERAL REQUIREMENTS</b>			
B.5	PROJECT BILLBOARD/SIGNBOARD	5,000.00	1,500.00	6,500.00
B.7	OCCUPATIONAL SAFETY AND HEALTH	6,000.00	0.00	6,000.00
B.9	MOBILIZATION / DEMOBILIZATION	24,900.00	0.00	24,900.00
	<b>EARTHWORKS</b>			
1700(1)	CLEARING & GRUBBING	30,000.00	0.00	30,000.00
803 (1) c	STRUCTURE EXCAVATION & BACKFILLING	11,250.00	3,375.00	14,625.00
	<b>STRUCTURAL CONCRETE</b>			
405(1)	STRUCTURAL CONCRETE CLASS A	550,600.00	165,180.00	715,780.00
405 (6)	STRUCTURAL CONCRETE, PAINTING WORKS	14,704.37	4,411.31	19,115.68
	<b>REINFORCING STEEL BARS</b>			
902.1.a2	REINFORCING STEEL BARS GRADE 60	161,355.87	48,406.76	209,762.63
	<b>FORMS AND FALSEWORKS</b>			
414	FORMS AND FALSEWORKS	95,430.00	28,629.00	124,059.00
	<b>DRAIN PIPE</b>			
1001(1)	DRAIN PIPE	502,822.46	150,846.74	653,669.20
				<b>1,829,411.51</b>

TOTAL MATERIALS COST	1,427,062.70	
TOTAL LABOR COST	402,348.81	
DIRECT COST		<b>1,829,411.51</b>
OC as_15% of DC		<b>269,776.73</b>
PROFIT as_10% of DC		<b>180,451.15</b>
VALUE ADDED TAX_5_% of MC+LABOR+OCM+PROFIT		<b>113,981.97</b>
TOTAL		<b>2,393,621.35</b>
ESAO, 3%(DC+PROFIT+OCM+VAT)		<b>71,808.64</b>
PLAN PREPARATION		<b>24,903.33</b>
<b>TOTAL ESTIMATE PROJECT COST</b>		<b>2,490,333.33</b>

Prepared by:

  
**FERNANDO BERNARDO L. FIERRES**  
 Civil Engineer  
 PRC ID# 0168767

RECOMMENDING APPROVAL:

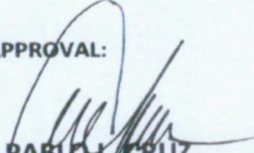
  
**PABLO L. CRUZ**  
 CENRO ROXAS

Checked and Verified by:

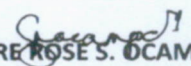

  
**AUDRE ROSE S. OCAMPO**  
 TWG, Chairman

Approved by:

  
**ERIBERTO B. SAÑOS**  
 PENRO



## CONSTRUCTION SCHEDULE AND S-CURVE

ITEM NO.	DESCRIPTION	%WEIGHT	COST	NO. OF DAYS	1ST MONTH	2ND MONTH	3RD MONTH	4TH MONTH	5TH MONTH	6TH MONTH	7TH MONTH	8TH MONTH
<b>GENERAL REQUIREMENTS</b>												
A.1.1(5)	CONSTRUCTION OF TEMP. FACILITIES	1.37%	32,812.50	150								
<b>OTHER GENERAL REQUIREMENTS</b>												
B.5	PROJECT BILLBOARD/SIGNBOARD	0.36%	8,531.25	1								
B.7	OCCUPATIONAL SAFETY AND	0.29%	6,930.00	150								
B.9	MOBILIZATION / DEMOBILIZATION	1.09%	26,145.00	6								
<b>EARTHWORKS</b>												
1700(1)	CLEARING & GRUBBING	1.64%	39,375.00	5								
803 (1) c	RUCTURE EXCAVATION & BACKFILLIN	0.80%	19,195.31	4								
<b>STRUCTURAL CONCRETE</b>												
405(1)	STRUCTURAL CONCRETE CLASS A	39.25%	939,461.25	95								
405 (6)	STRUCTURAL CONCRETE,PAINTING	1.05%	25,089.33	6								
<b>REINFORCING STEEL BARS</b>												
902.1.a2	REINFORCING STEEL BARS GRADE	11.50%	275,313.45	40								
<b>FORMS AND FALSEWORKS</b>												
414	FORMS AND FALSEWORKS	6.80%	162,827.44	14								
<b>DRAIN PIPE</b>												
1001(1)	DRAIN PIPE	35.84%	857,940.82	51								
ABC		100%	2,393,621.35									
MONTHLY CUMMULATIVE					18.30%	18.48%	12.73%	33.81%	16.69%			
					18.30%	36.78%	49.50%	83.31%	100.00%			
PROJECT TITLE:		LOCATIO:	PREPARED BY:		APPROVED BY:							
CONSTRUCTION FO SMALL WATER IMPOUNDING SYSTEM (SWIS)		BGY. CARURAY, SAN VICENTE, PALAWAN	 FERNANDO L. PUESTES Civil Engineer		 ERIBERTO B. SAÑOS PENRO							





NTS

REPUBLIC OF THE PHILIPPINES Region IV-B MIMAROPA Department of Environment and Natural Resources Office Community Environment and Natural Resources Office ROXAS, PALAWAN	PROJECT TITLE	DESIGNER/ENGINEER	CHECKED/VERIFIED BY	RECOMMENDATION/ APPROVAL	APPROVAL	SHEET NO.
	SMALL WATER IMPOUNDING SYSTEM (SWIS)	 <b>FERNANDO L. PARDO</b> CIVIL ENGINEER	 <b>AUDREIRUSE S. OCAMPO</b> TNG, CHAIRMAN	 <b>PABLO CRUZ</b> CENTRO ROXAS	 <b>ERIBERTO B. SAÑOS</b> PEÑO	$\frac{1}{8}$
	LOCATION	Bgy. Canury, San Vicente, Palawan PRG. REG. NO. <b>CE-008</b> DATE: <b>5-27-17</b> <b>16-00000</b>				



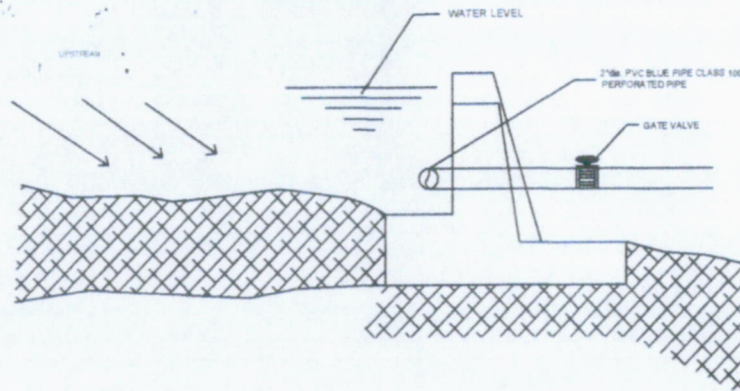

2  
AR-2  
**WEIR CROSS SECTION "a"**  
NTS

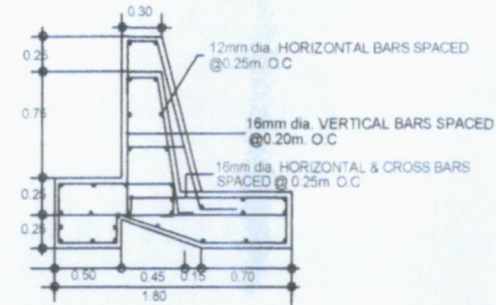

1  
ST-1  
**WEIR CROSS SECTION**  
NTS

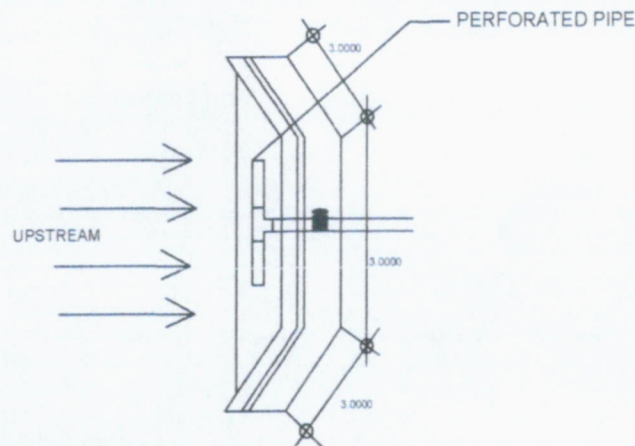

1  
AR-2  
**WEIR CROSS SECTION**  
NTS

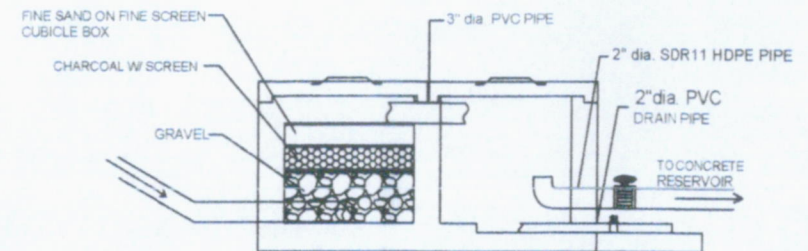

4  
AR-2  
**FILTRATION BOX ELEV. DETAILS "A"**  
NTS

REPUBLIC OF THE PHILIPPINES Region IV-B MIMAROPA Department of Environment and Natural Resources Office Community Environment and Natural Resources Office ROXAS, PALAWAN	<b>PROJECT TITLE</b> SMALL WATER IMPOUNDING SYSTEM (SWIS)	<b>DESIGNER/ENGINEER</b> PEARL D. DE VERA CIVIL ENGINEER PREP. BY: 1692019 DATE: 01-17-22	<b>CHECKED/VERIFIED BY:</b> AUDRE ROSE S. OCAMPO PWS CHAIRMAN	<b>RECOMMENDATION APPROVAL</b> PABLO L. CRUZ CENTRO ROXAS	<b>APPROVAL</b> ERIBERTO B. SAÑOS PENRO	<b>SHEET NO.</b> 2 8
---	--	---	---	---	---	----------------------------



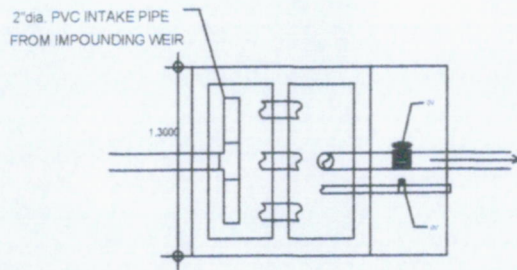

3

### FILTRATION BOX PLAN

AR-2

NTS

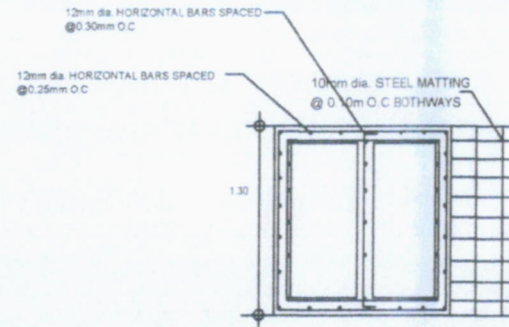

2

### FILTRATION REINFORCING DETAILS

ST-1

NTS

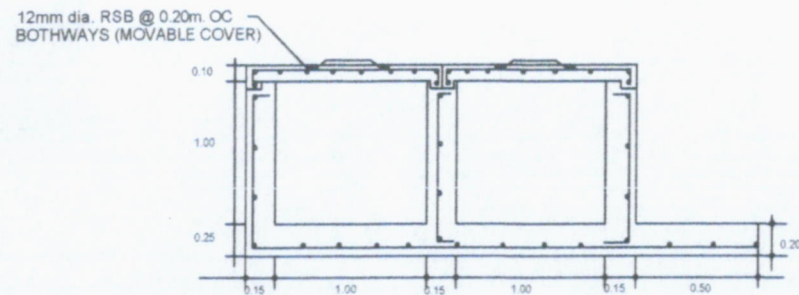

3

### FILTRATION BOX ELEV. REINF. DETAILS

ST-1

NTS

<p>REPUBLIC OF THE PHILIPPINES Region IV-B MIMAROPA Department of Environment and Natural Resources Office Community Environment and Natural Resources Office ROXAS, PALAWAN</p>	<p>PROJECT TITLE <b>SMALL WATER IMPOUNDING SYSTEM (SWIS)</b></p> <p>LOCATION Bgy. Canurey, San Vicente, Palawan</p>	<p>DESIGNER/ENGINEER <b>ERINNO OLAMPO L. REYES</b> CIVIL ENGINEER PRC RES. No. <b>01-0-19</b> PTR No. <b>16464</b> Exp. <b>9-12-22</b></p>	<p>CHECKED/VERIFIED BY: <b>AUDRE ROSE S. OLAMPO</b> PWS, CHAIRMAN</p>	<p>RECOMMENDATION/ APPROVAL <b>PABLO L. CRUZ</b> CENRO ROXAS</p>	<p>APPROVAL <b>ERIBERTO B. SAÑOS</b> PENRO</p>	<p>SHEET NO. <b>3</b> <b>8</b></p>
--	---	--	---	--	--	--



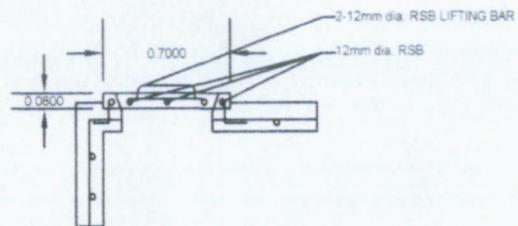

**DETAIL OF MANHOLE**  
SCALE 1:100

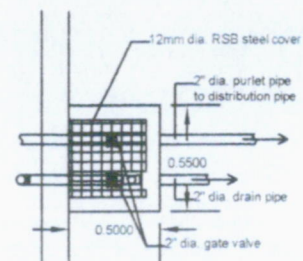

**DETAIL OF VALVE BOX**  
SCALE 1:100

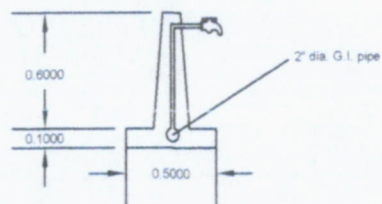
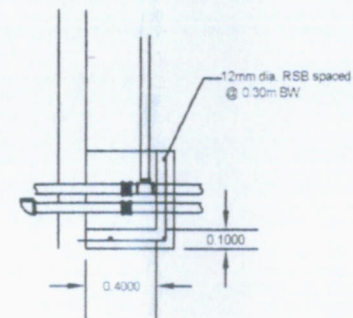

**COMMUNAL FAUCET**  
SCALE 1:100

REPUBLIC OF THE PHILIPPINES Region IV-B MIMAROPA Department of Environment and Natural Resources Office Community Environment and Natural Resources Office ROXAS, PALAWAN	PROJECT TITLE <b>SMALL WATER IMPOUNDING SYSTEM (SWIS)</b> LOCATION Bgy. Canaray, San Vicente, Palawan	DESIGNER/ENGINEER  CIVIL ENGINEER PROJECT NO. 01-001-01-17-19 DATE 11-19-19	CHECKED/VERIFIED BY  AUDRE ROSE S. OCAMPO CHAIRMAN	RECOMMENDATION APPROVAL  PABLO L. CRUZ CENRO ROXAS	APPROVAL  ERIBERTO B. SAÑOS PERRO	SHEET NO. 4 8
---	--	---	---	---	--	---------------------







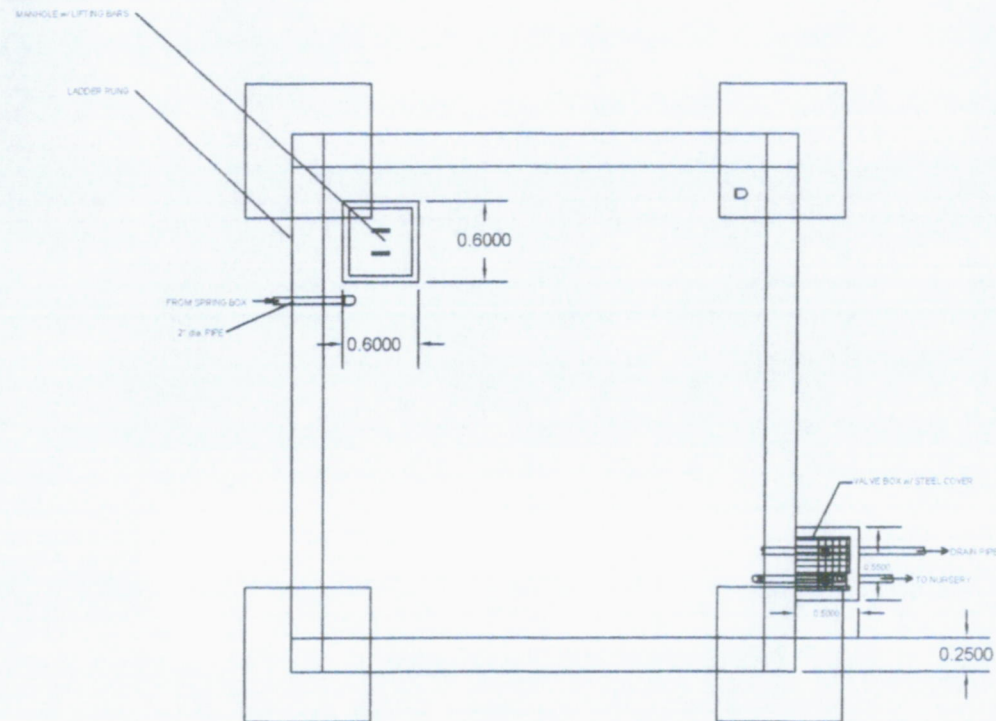





3 TOP ELEVATION  
S3 SCALE 1:100

REPUBLIC OF THE PHILIPPINES Region IV-B MIMAROPA Department of Environment and Natural Resources Office Community Environment and Natural Resources Office ROXAS, PALAWAN	PROJECT TITLE <b>SMALL WATER IMPOUNDING SYSTEM (SWIS)</b> LOCATION Bgy. Canury, San Vicente, Palawan	DESIGNER/ENGINEER <i>[Signature]</i> <b>REYNOLDO C. OCAÑO</b> CIVIL ENGINEER PRC REG. NO. 010002 05-12-19 01-1-2019	CHECKED/VERIFIED BY <i>[Signature]</i> <b>AUDRE ROSE S. OCAÑO</b> PRC CHAIRMAN	RECOMMENDATION APPROVAL <i>[Signature]</i> <b>PABLO L. CRUZ</b> CENTRO ROXAS	APPROVAL <i>[Signature]</i> <b>ERIBERTO B. SAÑOS</b> PENRO	SHEET NO. 6 8
---	---	--	---	---	---	---------------------



REPUBLIC OF THE PHILIPPINES Region IV-A MIMAROPA Department of Environment and Natural Resources Office Community Environment and Natural Resources Office ROXAS, PALAWAN		PROJECT TITLE SMALL WATER IMPOUNDING SYSTEM (SWIS)		DESIGNER/ENGINEER  CIVIL ENGINEER	CHECKED/VERIFIED BY  AUDREY ROSA ODAMPO CIVIL ENGINEER	RECOMMENDATION APPROVAL  PABLO L. CRUZ CIVIL ROXAS	APPROVAL  ERIBERTO B. SANOS PEANO	SHEET NO. 7 8
---	--	--	--	---	--	---	--	---------------------

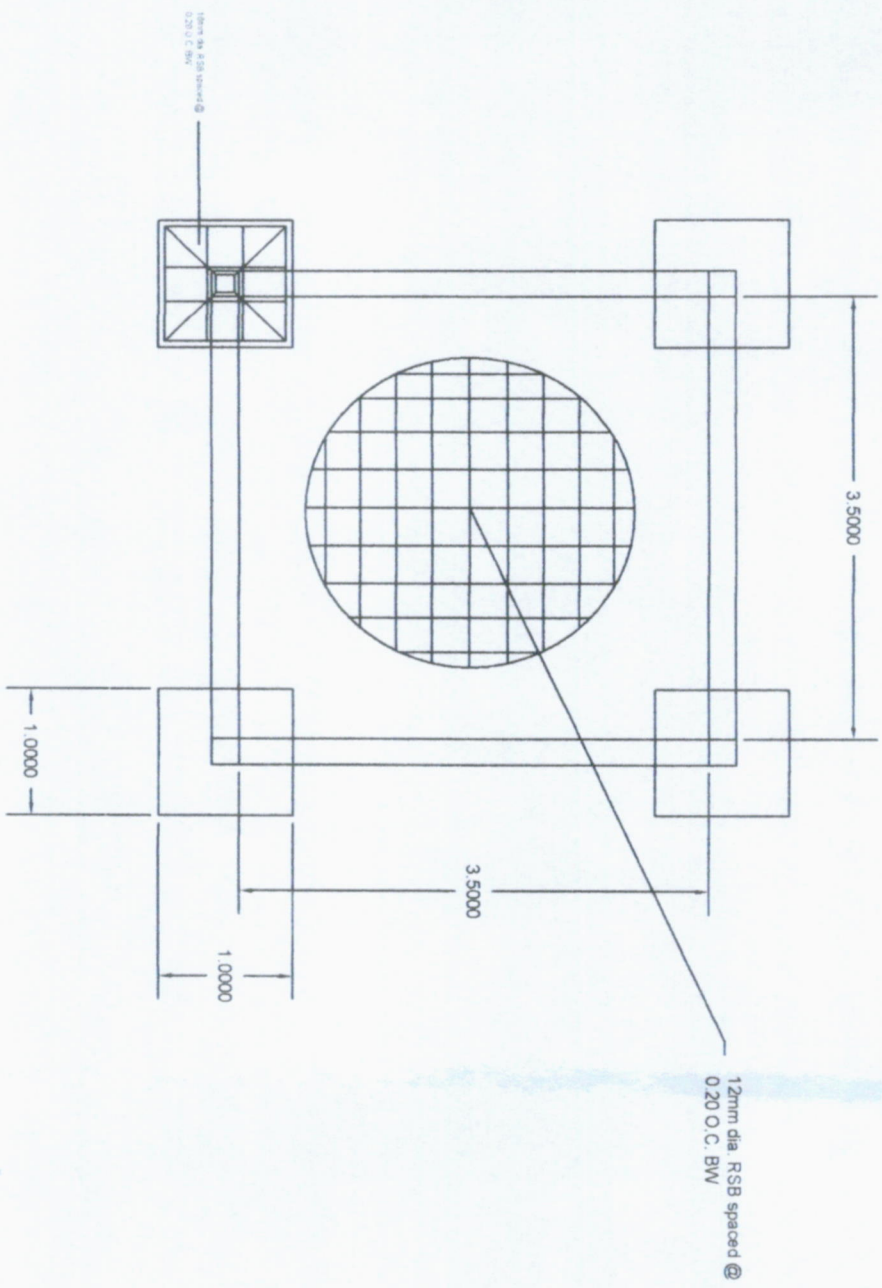

3 FOUNDATION PLAN  
S3 SCALE 1:100









```

graph LR
    START([START]) --> B5([B.5  
1 DAYS])
    B5 --> B9_1([B.9  
3 DAYS])
    B9_1 --> 1700_1([1700(1)  
5 DAYS])
    1700_1 --> 1703_1([1703(1)  
4 DAYS])
    1703_1 --> 902_1_a2([902.1.a2  
40 DAYS])
    902_1_a2 --> 405_1([405(1)  
95 DAYS])
    902_1_a2 --> 414([414  
14 DAYS])
    405_1 --> 1001_1([1001(1)  
51 DAYS])
    1001_1 --> 405_6([405(6)  
6 DAYS])
    405_6 --> B9_2([B.9  
3 DAYS])
    B9_2 --> START
    A11_1_5([A.1.1(5)  
150 DAYS]) --> B7([B.7])
    B7 --> B9_2
  
```

CRITICAL PATH

PROJECT TITLE:	LOCATIO:	PREPARED AND SUBMITTED BY:	APPROVED:
CONSTRUCTION FOR SMALL WATER IMPOUNDING SYSTEM (SWIS)	BGY. CARURAY, SAN VICENTE, PALAWAN	 FERNANDO BERNARD C. FUERTES Civil Engineer	 ERIBERTO B. SAÑOS PENRO