



Republic of the Philippines
Department of Environment and Natural Resources
MIMAROPA REGION
PROVINCIAL ENVIRONMENT AND NATURAL RESOURCES OFFICE

DENR MIMAROPA
RECORDS SECTION
JUN 01 2023
☐ INCOMING ☐ OUTGOING
TIME: _____ DATE NO. _____

May 18, 2023

MEMORANDUM

FOR : The ARD for Technical Services
1515 DENR By the Bay Building
Roxas Blvd., Barangay 668, Ermita, Manila

Attention : The Chief, Survey and Mapping Division

FROM : The Provincial Environment and
Natural Resources Officer

SUBJECT : **REPORT OF INSPECTION CONDUCTED RE: REQUEST FOR
ISSUANCE OF A CERTIFICATE DEEMED AS LAND
CONVERSION (LUC) FORM NO. 6, FOR PLAN H-174616**

Referred is the memorandum of the CENRO Puerto Princesa dated May 15, 2023 attached the Report of Inspection of May 8, 2023 relative the request for issuance of certificate deemed as Land Use Conversion (LUC) over a parcel of land covered by Plan H-174616 now TCT No. 074-2022001095 In favor of the City Government of Puerto Princesa.

The subject report informs the findings that led to their recommendations that the subject request be given due course in the provision of:

1. Securing ECC prior construction of development for housing purposes per Section 4 of PD 1586 and
2. Observance of the 3-meter salvage zone/easement zone per Article 51 of the PD No. 1067 dated December 31, 1976 and City Ordinance No. 960

The same report is submitted in compliance to that Office instruction of December 13, 2022.

For the PENRO:

RONIE B. GANDEZA
OIC Chief, TSD/Office-In-Charge

Copy furnished:
The CENRO Puerto Princesa
TSD RPS DRN 2023-4565lmo

DENR-PALAWAN
PENRO-RECORDS
RELEASED
By Rhea
Date 22 MAY 2023 CN 2023-1435



Republic of the Philippines
DEPARTMENT OF ENVIRONMENT AND NATURAL RESOURCES
COMMUNITY ENVIRONMENT AND NATURAL RESOURCES
PUERTO PRINCESA CITY
South National Highway, Bgy. Sta. Monica, Puerto Princesa City
TEL Fax No. (048) 433-717-0702
Email Address: cenropuertoprincesa@denr.gov.ph

May 8, 2023

MEMORANDUM

FOR : The OIC-Community Environment
and Natural Resources Officer
Puerto Princesa City

FROM : The Investigation Team

SUBJECT : **REPORT OF INSPECTION CONDUCTED
RE: REQUEST FOR ISSUANCE OF A CERTIFICATE
DEEMED AS LAND CONVERSION (LUC) FORM NO. 6
FOR PLAN H-174616 (E-2022-95086)**

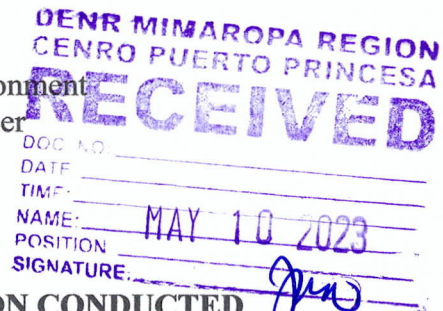

This has reference to the PENRO Memorandum dated March 23, 2023 anent to the Memorandum dated December 13, 2022 from the Regional Executive Director relative to the letter request dated September 19, 2022 of Atty. Arnel M. Pedrosa, City Administrator of the City Government of Puerto Princesa for issuance of certificate deemed as Land Use Conversion (LUC) over a parcel of land covered by Plan H-174616 now covered by Transfer Certificate of Title No. 074-2022001095 in the name of the City Government of Puerto Princesa containing an area of 221,791 square meters located in Barangay Irawan, Puerto Princesa City.

The subject area is intended for the relocation site of the informal settlers who were affected by Typhoon Odette from different barangays of Puerto Princesa City.

In compliance to the instruction from the Regional Executive Director, the undersigned conducted an ocular inspection and investigation in the area on April 19, 2022 at 2:00 o'clock in the afternoon. The Team was composed of the following:

1. Ms. Mildred A. Pascual - Chief, Regulation and Permitting Section
2. Ms. Mercedita B. Almorfe - Chief, EMS/Embedded
3. Ms. Eliza B. Aborot - Land Management Officer II
4. For. Marie Kris Q. Cutay - Forester I

The Team was assisted by three (3) personnel from the Office of the City Housing and Urban Poor of Puerto Princesa City.

A. FINDINGS

1. (x) within protected areas under the National Integrated Protected Area System (NIPAS)
2. (/) within environmentally critical area (ECA). Specify : river
3. (x) within mossy and virgin forest
4. (/) within riverbanks
5. (x) within swamp forests and marshlands
6. () none of the above

Further, the proposed project to be undertaken in the area applied for conversion is

1. (x) Environmentally critical project (ECP). Specify : housing project
2. (/) Non environmentally critical project (ECP).

B. OTHER FINDINGS

1. That Lot No. Plan H-174616 has been verified to be within **AGRICULTURAL LAND (ALIENABLE AND DISPOSABLE AREA)** per approved Land Classification Map Project No. 7277, Block A certified on December 29, 1923.
2. That the subject parcel of land was not occupied, no community resettlement yet and still no improvements during the time of inspection;
3. That the said area has secondary growth grass and naturally grown trees like acacia rain tree, bangkal and kupang trees. Some acacia trees were found within the 3 meters easement/salvage zone.
4. There is an existing river known as Iratag River situated at coordinates 9°49°5N° and 118°41° 55E°, that should be preserved and retained per DAO No. 97-05 (Procedures in the Retention of Areas Within Certain Distances Along the Banks of Rivers, Streams and Shores of Seas, Lakes and Oceans for Environmental Protection).

C. ATTACHMENTS

1. Certification dated April 26, 2023 as to land classification of the subject lot
2. Photocopy of TCT No. 07402022001095 in the name of the City Government of Puerto Princesa
3. Photocopy of Tax Declaration of Real Property No. 012-11956 - already converted to residential area
4. Photocopy of Vicinity Map
5. Schematic Subdivision Plan - Irawan Resettlement Project
6. Geotagged pictures taken during the conduct of inspection
7. Attendance of Ocular Inspection on April 19, 2023
8. CENRO Memorandum dated February 22, 2023 for the RED and its attachments Re; Request for Clearance to Cut (15) Various trees within the titled property of the City Government of Puerto Princesa

D. RECOMMENDATIONS

In view of the above-findings, the undersigned respectfully recommends that the request for land conversion by the City Government be given due course, subject to the following, to wit:

1. The City Government should secure an ECC prior to construction or development considering that the project is for housing purposes per Section 4 of PD 1586.
2. To strictly observe the 3-meter salvage/easement zone as per Article 51 of the PD No. 1067 dated December 31, 1976 and City Ordinance No. 960

For information and forward action.

MERCEDITA B. ALMORFE
Chief, EEMS/Embedded EMB

ELIZA B. ABOROT
Land Management Officer II

MARIE KRIS Q. CUTAY
Forester I

Attested by;



MILDRED A. PASCUAL

LMO II/Chief, Regulation and Permitting Section

SUBSCRIBED AND SWORN to before me this 8th day of May 2023 at DENR-CENRO, Puerto Princesa City.



PEDRO A. VELASCO

Development Management Officer IV
OIC-CENRO



Republic of the Philippines
Department of Environment and Natural Resources
MIMAROPA REGION
PROVINCIAL ENVIRONMENT AND NATURAL RESOURCES OFFICE

MEMORANDUM

TO : The Community Environment and
Natural Resources Officer
Puerto Princesa City

FROM : The Provincial Environment and
Natural Resources Officer

SUBJECT : ELECTRONIC MAIL DATED MARCH 17, 2023 RE: REQUEST FOR
ISSUANCE OF A CERTIFICATE DEEMED AS LAND
CONVERSION (LUC) FORM NO. 6, FOR PLAN H-174616

Referred is the electronic mail of the Surveys and Mapping Division dated March 17, 2023 attached the Land Conversion Form No. 6 for Plan H-174616.

Please for your compliance to the memorandum of the Regional Executive Director of December 13, 2022 relative the request of Atty. Arnel Pedrosa of September 19, 2022.

For the PENRO:

RHODORA B. UBANI
Chief, CDS/Office-In-Charge

Copy furnished:

The Surveys and Mapping Division
smdmimaropa@gmail.com
1515 DENR By the Bay Building
Roxas Blvd., Barangay 668, Ermita, Manila
TSD-RPS DRN 2023-2424/lmo

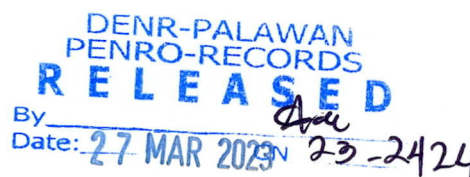
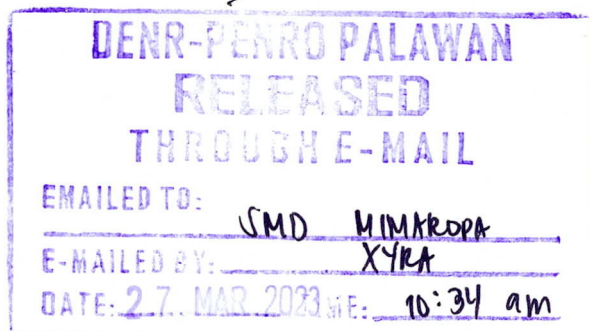



R4B PENRO Palawan <penropalawan@denr.gov.ph>

**REQUEST FOR ISSUANCE OF A CERTIFICATE DEEMED AS LAND CONVERSION
(LUC) FORM NO. 6 FOR PLAN H-174616****Surveys and Mapping MIMAROPA** <smdmimaropa@gmail.com>

Fri, Mar 17, 2023 at 2:09 PM

To: R4B PENRO Palawan <penropalawan@denr.gov.ph>, R4B CENRO Puerto Princesa
<cenropuertoprincesa@denr.gov.ph>

A pleasant day!

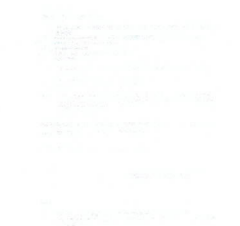
Please see the advance copy of LUC Form No. 6 for your ready reference.
Kindly acknowledge upon receipt of this email.**DENR PENRO
PALAWAN RECORDS
RECEIVED**BY: 
DATE: 03-17-2023 23:2424**SURVEYS AND MAPPING DIVISION****DENR MIMAROPA Region**1515 DENR By the Bay Bldg., Roxas Boulevard,
Barangay 668, Ermita, Manila
(02) 8248-3367/ 8249-3368 loc. 2713**6 attachments****LUC Form No. 6 p.1.jpg**
427K**LUC Form No. 6 p.2.jpg**
305K**Memo dated 02282023.jpg**
501K



Republic of the Philippines
Department of Environment and Natural Resources
MIMAROPA REGION
PROVINCIAL ENVIRONMENT AND NATURAL RESOURCES OFFICE



February 28, 2023

MEMORANDUM

FOR : The Regional Executive Director
DENR-R4, MIMAROPA, 1515 L & S Building
Roxas Blvd., Ermita, Manila

FROM : The Provincial Environment and
Natural Resources Officer

SUBJECT : **REQUEST FOR THE ISSUANCE OF A CERTIFICATE DEEMED
AS LAND CONVERSION (LUC) FORM NO. 6 FOR PLAN
H-174616(E-2022-95086)**

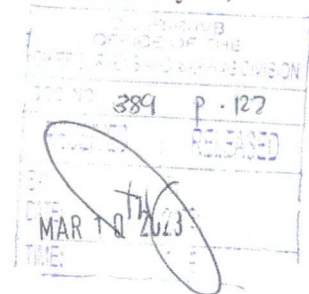

This pertains to the attached memorandum dated December 13, 2022 instructing the CENRO Puerto Princesa to conduct investigation and submit corresponding report relative the request of Atty. Arnel M. Pedrosa for issuance of certificate deemed as Land Use Conversion (LUC) per letter of September 19, 2022

Please be informed that the mentioned LUC Form No. 6 for reference is not attached. Thus, this request for the transmittal of the subject form leading to the consideration and or compliance.

For his information and consideration.

For the PENRO:

RONIE B. GANDEZA
OIC Chief, TSD/Office-In-Charge

The CENRO Puerto Princesa City
TSD RPS DRN 2023-1347/lmo

DENR-PALAWAN
PENRO-RECORDS
RELEASED
By 
Date: CN 23-557
06 MAR 2023



Republic of the Philippines
Department of Environment and Natural Resources
MIMAROPA Region

MEMORANDUM

TO : THE PENR OFFICER
Palawan

ATTENTION : THE CENR OFFICER
Puerto Princesa City

FROM : THE REGIONAL EXECUTIVE DIRECTOR

SUBJECT : REQUEST FOR THE ISSUANCE OF A CERTIFICATE DEEMED
AS LAND CONVERSION (LUC) FORM NO. 6 FOR PLAN H-
174616 [E-2022-95086]

**DENR PENRL
PALAWAN RECORDS
RECEIVED**

BY: 
DATE: 02-15-2023 EN 221347

DATE : DEC 13 2022

Referred is the letter dated September 19, 2022 of Atty. Arnel M. Pedrosa, City Administrator, Office of the Mayor of Puerto Princesa City requesting for the issuance of certificate deemed as Land Use Conversion (LUC) Form No. 6 for the location of their project intended as relocation site of the informal settlers along areas in different barangays who are affected by Typhoon Odette last December 2021 located at Irawan, Puerto Princesa City.

In this regard, you are hereby instructed to conduct investigation and submit report with categorical recommendation for the issuance of said certificate. Attached is a copy of the LUC Form No. 6 for your ready reference.

LORMELYN E. CLAUDIO, CESO IV

Cc:

ATTY. ARNEL M. PEDROSA
City Administrator
Office of the City Mayor
New City Hall Bldg., Brgy. Sta. Monica,
Puerto Princesa City



Department of Environment
and Natural Resources
MIMAROPA Region



Doc ID: 95086

SMD/SEG/10.05.2022

DENR By the Bay Building, 1515 Roxas Boulevard, Ermita, Manila
DENR VOIP (02) 8248-3367/8249-3367 loc. 2701
Website: <http://mimaropa.denr.gov.ph/>
Email: mimaroparegion@denr.gov.ph

NOTE: Road Networks depicted on this map is not a basis for road claims. It is only shown as guide for Taxation Purposes and not an actual survey.

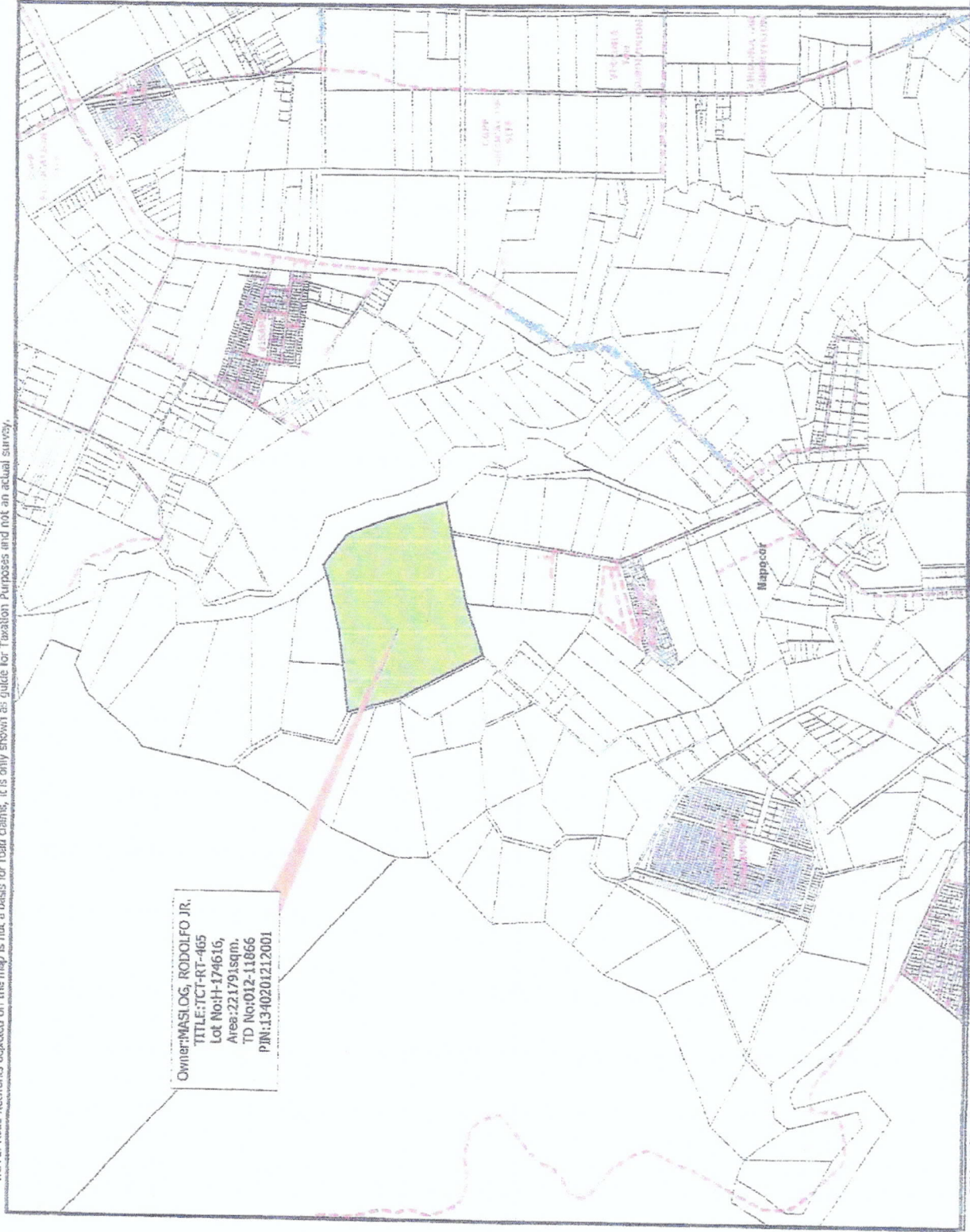

Owner: MASLOG, RODOLFO JR.
TITLE: TCT-RT-465
Lot No: H-174616,
Area: 221791sqm.
TD No: 012-11866
PIN: 1340201212001



TAXMAP LOCATION
BGY. IRAWAN
PUERTO PRINCESA CITY
SCALE: 1:15000



OFFICE OF THE ASSESSOR
TAXMAPPING DIVISION
CITY OF PUERTO PRINCESA
CERTIFIED TRUE & CORRECT

ENGR. JOVEN C.V. BALUYUT
City Assessor

Prepared by:

LEONILYN ANGELO
ALFARO (MBA) (PES)

Official Receipt No. 000

Amount: P94,000.00

Date: 7/30/2021 (Friday)

Time: 3:02:54 PM

Puerto Princesa City

1/1

FOR VERIFICATION PURPOSES

Document Presented:

☐ SPA

☐ Proof of Interest

☐ Authorization

☐ NONE

REMINDER

This Map is for TAXATION and ASSESSMENT
Purposes ONLY

SITE DEVELOPMENT PLAN

AS PREPARED FOR
CITY GOVERNMENT OF PUERTO PRINCESA

SITUATED IN THE
MUNICIPALITY OF: BAYAN
MUNICIPALITY OF: CITY OF PUERTO PRINCESA
PROVINCE OF: PALAWEAN
ISLAND OF: PALAWEAN
CONTAINED AREA OF: 271,400.00 SQ. M.

PROJECT NO.:
PREPARED BY:
SCALE: 1:500

CERTIFICATION

I hereby certify that this is a true and correct copy of the original plan as submitted and approved by the Department of Environment and Natural Resources, Republic of the Philippines, and that the same is being submitted for registration.

DATE: 12/27/2010
BY: ALAN M. ADOR
OFFICIAL POSITION: REGISTERED PROFESSIONAL SURVEYOR
License No.: 14112 Date: 12/27/2010

Republic of the Philippines
Department of Environment and Natural Resources

VERIFICATION

I hereby certify that the survey plan is verified and found to be correct and true as shown on this plan in this office.

DATE: 12/27/2010
PURPOSE: 70

CHIEF, REGIONAL SURVEYS DIVISION

DATE SUBMITTED: 12/27/2010
ADDITIONAL INFORMATION: LATEST DATE OF VERIFICATION

THIS SITE

SCHEMATIC SUBDIVISION PLAN

PROJECT DESCRIPTION

LAND USE	AREA (SQM)	NO.
RESIDENTIAL	100,000.00	1.00
COMMERCIAL	100,000.00	1.00
INDUSTRIAL	100,000.00	1.00
AGRICULTURAL	100,000.00	1.00
RECREATIONAL	100,000.00	1.00
OTHER	100,000.00	1.00
TOTAL	271,400.00	1.00

NOTE:
All contents are P.S. only, none more 15 x 60 cm.

Prepared For the Bureau of the City Engineer of the Philippines, Inc.
City Engineer, Palawan
Approved by the Local Government Bureau
Until December 31, 2010

LUC FORM NO. 6
SERIES OF 2002
(To be filled up by the DENR)

(Use separate sheet if necessary and attach as an Annex to this LUC Form)

is/are classified as: (Please check)

1. ☐ Within protected areas under the National Integrated Protected Area System (NIPAS)
2. ☐ Within environmentally critical area (ECA), specify _____
3. ☐ Within mossy and virgin forests
4. ☐ Within riverbanks
5. ☐ Within swamp forests and marshlands
6. ☐ None of the above

Further, the proposed project to be undertaken in the area applied for conversion is:

1. ☐ Environmentally critical project (ECP), specify _____
2. ☐ Not environmentally critical project (ECP)

(NOTE: If the subject property falls within ECA or the proposed project is an ECP, an ECC shall be secured and attached to this certification as additional documentary requirement.

This Certification is issued upon the request of Mr /Mrs /Ms _____
relative to his/her application for land use conversion.

Given this _____ day of _____, _____

Regional Executive Director

Note:

1. This Certification shall not be considered as development permit.
2. This Certification shall not be construed as an Environmental Compliance Certificate (ECC).

2020030751298

REPUBLIC OF THE PHILIPPINES
DEPARTMENT OF JUSTICE
Land Registration Authority
QUEZON CITY

Registry of Deeds for Puerto Princesa City

Transfer Certificate of Title

OWNER'S DUPLICATE • OWNER'S DUPLICATE • OWNER'S DUPLICATE • OWNER'S DUPLICATE • OWNER'S DUPLICATE

No. 074-2022001095

IT IS HEREBY CERTIFIED that certain land situated in BARRIO OF IRAWAN, CITY OF PUERTO PRINCESA, ISLAND OF PALAWAN, more particularly bounded and described as follows:

BEGINNING AT A POINT MARKED "1" ON PLAN H-174616, N. 0 DEG. 42'W., 1500.28 M. MORE OR LESS FROM B.L.L.M. NO. 2, BARRIO OF IRAWAN, MUNICIPALITY OF PUERTO PRINCESA, THENCE S. 72 DEG. 28'W., 200.34 M. TO POINT 2; N. 28 DEG. 52'W., 296.92 M. TO POINT 3; N. 14 DEG. 57'W., 159.25 (Continued on next page)

is registered in accordance with the provision of Section 103 of the Property Registration Decree in the name of

Owner: CITY GOVERNMENT OF PUERTO PRINCESA, A LOCAL GOVERNMENT UNIT CREATED UNDER THE LAWS OF THE PHILIPPINES

Address: NEW CITY HALL BUILDING, BGY. STA. MONICA PUERTO PRINCESA CITY PALAWAN MIMAROPA

subject to the provisions of the said Property Registration Decree and the Public Land Act, as well as to those of the Mining Laws, if the land is mineral, and subject, further, to such conditions contained in the original title as may be subsisting.

IT IS FURTHER CERTIFIED that said land was originally registered as follows:

Patent Type: Homestead Patent

Patent Date: 02/04/1935

Under Act No.: 496

Volume No.: 4

Original Owner:

Original RD: PUERTO PRINCESA CITY

OCT Date: 02/04/1935

OCT No.: OCT-G-430

Page No.: 430

This certificate is a transfer from TRANSFER CERTIFICATE OF TITLE 465 (TOTALLY CANCELLED) by virtue hereof in so far as the above-described land is concerned.

Entered at Puerto Princesa City, Philippines on the 14th day of JULY 2022 at 01:16pm.

Atty. Ma. Rachel Fe Fabros-Dilig
Register of Deeds III



MOSLOG

TCT No.: 074-2022001095

Page No.: 2

TECHNICAL DESCRIPTION (Continued from page 1)

M. TO POINT 4; N. 82 DEG. 40'E., 255.84 M. TO POINT 5; N. 78 DEG. 27'E., 182.68 M. TO POINT 6; N. 52 DEG. 43'E., 2.99 M. TO POINT 7; N. 74 DEG. 39'E., 36.23 M. TO POINT 8; S. 53 DEG. 17'E., 129.34 M. TO POINT 9; S. 22 DEG. 37'E., 137.55 M. TO POINT 10; S. 14 DEG. 51'E., 182.20 M. TO POINT 11; S. 79 DEG. 47'E., 302.65 M. TO POINT 1, POINT OF BEGINNING. CONTAINING AN AREA OF 22.1791 HECTARES. POINTS 7 AND 8, STAKES, POINTS 9 AND 10, CROSSES ON TREES. BOUNDED ON THE NORTHEAST, BY IRATAG RIVER; ON THE SOUTHEAST AND SOUTHWEST, BY PUBLIC LAND; AND ON THE NORTHWEST, BY PUBLIC LAND AND IRATAG RIVER. BEARINGS TRUE. DECLINATION 1 DEG. 21'E., POINTS REFERRED TO ARE MARKED ON PLAN H-174616. SURVEYED UNDER AUTHORITY OF SECTIONS 12-22 ACT NO. 2874 AND IN ACCORDANCE WITH EXISTING REGULATIONS OF THE BUREAU OF LANDS, BY JOSE L. ESPINO, PUBLIC LAND SURVEYOR, ON NOVEMBER 27, 1933 AND APPROVED ON NOVEMBER 19, 1934. NOTE: ALL CORNERS NOT OTHERWISE DESCRIBED ARE B.L. CONC. MONS. 15 X 60 CMS.

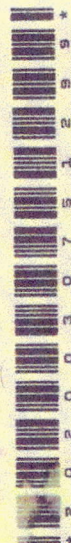

2020030751300

TCT No.: 074-2022001095

Page No.: 3

MEMORANDUM OF ENCUMBRANCES

Entry No.: 2022001859

Date: July 14, 2022 12:24:42PM

LIABILITIES UNDER SECTION 4 RULE 74 : TO CREDITORS, HEIRS, AND
OTHER PERSONS UNLAWFULLY DEPRIVED OF PARTICIPATION IN THE ESTATE
OF THE DECEASED RODOLFO M. MASLOG JR. AS EXTRAJUDICIALLY SETTLED
FOR A PERIOD OF TWO (2) YEARS PURSUANT TO SECTION 4 RULE 74 OF THE
RULES OF COURT. DATE OF INSTRUMENT: AUGUST 05, 2003.

(SGD.) ATTY. MA. RACHEL FE FABROS-DILIG
REGISTER OF DEEDS III

COPIED FROM TCT 465

Atty. Ma. Rachel Fe Fabros-Dilig
Register of Deeds III

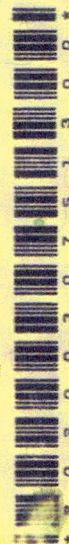

NOTE: Road Networks depicted on this map is not a basis for road design, it is only shown as guide for Taxation Purposes and not an actual survey.

Owner: MASI OG, RODOLFO JR.
 TITLE: TCT-RT-465
 Lot No: H-174616,
 Area: 221791sqm,
 TD No: 012-11866
 PIN: 1340201212001

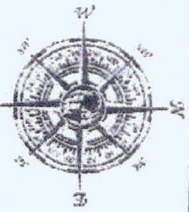
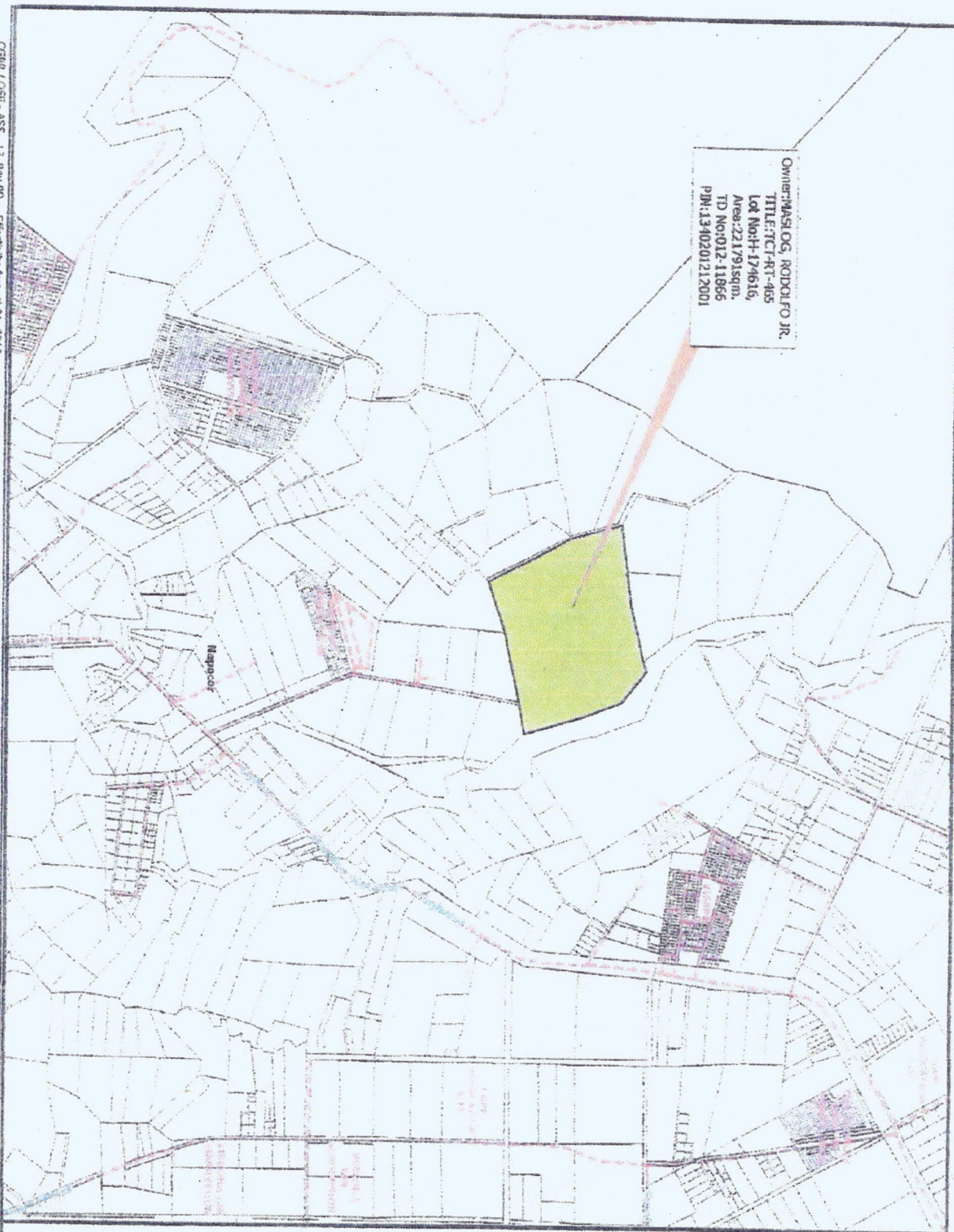

TAXMAP LOCATION
BGY, IRAWAN
PUERTO PRINCESA CITY
SCALE: 1:15000

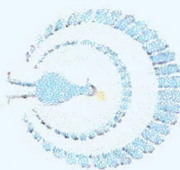

OFFICE OF THE ASSESSOR
TAXMAPPING DIVISION
CITY OF PUERTO PRINCESA
CERTIFIED TRUE & CORRECT

ENGR. JOVEN C.Y. BALWUT
CITY ASSESSOR

Prepared by:
LEONIL T. ANDRAGON
 Official Receipts No. POC
 Amount Paid: 00.00
 Date: 7/19/2021 (Fido)
 Time: 5:02:34 PM
 Puerto Princesa City
 LT

FOR VERIFICATION PURPOSES
 Document Presented:
☐ SMA
☐ Proof of Interest
☐ ACTIVITY REPORT
☐ NONE
REMARKS:
 This Map is for TAXATION and ASSESSMENT
 PURPOSES ONLY

-K-5D 10-1729



SCHEMATIC SUBDIVISION PLAN

PROJECT DESCRIPTION

LAND USE	AREA (SQ.M.)	(%)
TOTAL LOT AREA	221,808.82	100.00
RESIDENTIAL	100,963.00	45.52
ROADS	87,389.82	39.40
COMMUNITY FACILITIES	16,486.00	7.43
PARKS AND PLAYGROUNDS	16,970.00	7.76

NO. OF SALEABLE LOTS	
AVERAGE LOT AREA	
MINIMUM FRONTAGE	

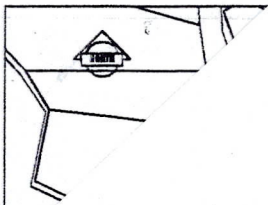
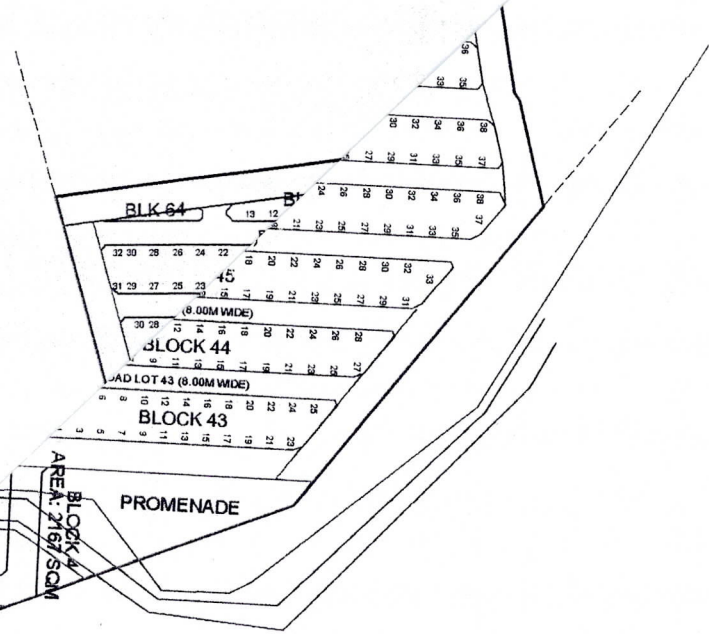



**Subject: Ocular Inspection on the request for issuance of
Certificate of Land Conversion (LUC) by the City
Government over a parcel of land situated in Bgy. Irawan,
Puerto Princesa City.**

ATTENDANCE

April 19, 2022 – 2:00 PM

Name	Position/Designation	Office	Signature
JANSON LAZO	ENUT - M&T	CITY HOUSING	
Mercedita Almonfe Sytems	ENB-Pal		
FELIPE PABLO DRAFGMAN III	CITY HOUSING		
ALEJANDRO MAFELIX ADMIN TI	"		



DEPARTMENT OF ENVIRONMENT AND NATURAL RESOURCES
COMMUNITY ENVIRONMENT AND NATURAL RESOURCES OFFICE
PUERTO PRINCESA CITY

South National Highway, Bgy. Sta. Monica, Puerto Princesa City

Tel Fax No.: (048) 717-0702

Email Address: cenropuertoprincesa@denr.gov.ph

February 22, 2023

MEMORANDUM

FOR : The Regional Executive Director
DENR IV-B, MIMAROPA, Region
1515 L&S Bldg. Roxas Boulevard, Ermita, Manila

THRU : The Provincial Environment and
Natural Resources Officer
Bgy. Sta. Monica, Puerto Princesa City

FROM : The Community Environment and
Natural Resources Officer

SUBJECT : **REQUEST FOR CLEARANCE TO CUT FIFTEEN (15) VARIOUS
TREES WITHIN TITLED PROPERTY OF CITY GOVERNMENT
OF PUERTO PRINCESA REPRESENTED BY MAE ANN B. JURI
LOCATED AT BGY. IRAWAN, PUERTO PRINCESA CITY,
PALAWAN**

DENR PENRCL
PALAWAN RECORDS
RECEIVED
BY: [Signature]
DATE: 02-28-2023

Respectfully forwarding herewith is the letter from Mae Ann B. Juri requesting for a cutting permit/clearance of Fifteen (15) various trees that will be affected by the proposed Irawan Resettlement Project (Maslog) within the Government property located at Bgy. Irawan, Puerto Princesa City, Palawan.

Based on the inspection and inventory conducted over the area by representative from this Office, fifteen (15) naturally grown trees with various species with a total volume of 3.777 m³ is requested to be cut.

Attached are the following documents in support to the said Application:

1. Inspection Report of FT I Rommel Adato et. Al.;
2. Geo-tagged photos taken during inspection;
3. Tally Sheet and Stand and Stock Table of inventoried trees;
4. Tree Charting Map;
5. Bgy. Certification of "NO OBJECTION" to cut trees;
6. Inspection Report of City ENRO;
7. Authenticated copy of Title from registry of deeds;
8. Tax Map from Assessor; and,
9. Letter request of Ms. Mae Ann B. Juri.

This Office recommends for the approval of the herein request to give way for the development and improvement on the subject area.

For your information and consideration.

[Signature]
PEDRO A. VELASCO



Republic of the Philippines
DEPARTMENT OF ENVIRONMENT AND NATURAL RESOURCES
MIMAROPA REGION
COMMUNITY ENVIRONMENT AND NATURAL RESOURCES OFFICE
PROVINCE OF PALAWAN
Email Address: centronpcheuc@yahoo.com
Tel Fax No.: (048) 433-0660

May 24, 2022

MEMORANDUM

FOR : The Community Environment and
Natural Resources Officer
THRU : Mildred A. Pascual
LMO II/ Chief RPS
FROM : Inspecting Officer
SUBJECT :

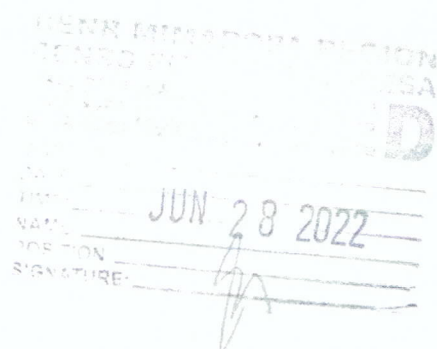

**INVENTORY REPORT RE: REQUEST FOR CUTTING
PERMIT OF NATURAL GROWN TREES THAT WILL BE
AFFECTED BY THE RELOCATION SITE PROJECT OF
THE CITY GOVERNMENT WITHIN TITLED PROPERTY
LOCATED IN BRGY. IRAWAN, PPCITY**

This is in connection to the letter request of Ms. Mae ann B. Juri, requesting for cutting permit affected by the relocation/resettlement project within the titled property situated in Brgy. Irawan, PPCity.

Please be informed that on May 11, 2022, the undersigned conducted tree inventory over the subject area. Based on actual tree inventory, a total of Fifteen (15) Natural grown trees of Acacia rain tree, Bangkal, Kupang, with a total volume of 3.777 cubic meters are requested to cut down for clearing purposes and affected by the relocation site project of the city. (Please see attached tally sheet of inventoried trees and geo-tagged picture).

The undersigned recommend cutting permit/clearance be granted to the applicant per existing laws, rules and regulation.

For your information, records and further instruction.

Prepared by:

ROMMEL D. ADATO
TL/Forest Technician

EDWIN GUILARAN
Forests Protection Officer

MICHAEL G. POLIDO
Inspecting Officer

TALLY SHEET

Name of Proponent: Jmae an B. Juri

Location: So. Magsasaka Bgy. Irawan, Puerto Princesa City, Palawan

Date of Inventory: May 11, 2022

Tree n	Species	DBH	MH	TH	Volume	Tree Location		Tree Category	Stem Quality
						Northing	Easting		
1	Kupang	47	8	15	0.861	9°49'5"	118°41'54"	Natural	1
2	Kupang	20	5	10	0.097	9°49'5"	118°41'48"	Natural	1
3	Bangkal	30	8	10	0.351	9°49'4"	118°41'47"	Natural	1
4	Bangkal	32	5	12	0.250	9°49'4"	118°41'47"	Natural	1
5	Bangkal	30	6	10	0.263	9°49'5"	118°41'46"	Natural	1
6	Bangkal	26	5	13	0.165	9°49'6"	118°41'48"	Natural	1
7	Bangkal	26	5	10	0.165	9°49'4"	118°41'47"	Natural	1
8	Bangkal	20	4	13	0.078	9°49'4"	118°41'47"	Natural	1
9	Bangkal	19	5	10	0.088	9°49'4"	118°41'47"	Natural	1
10	Bangkal	20	6	13	0.117	9°49'4"	118°41'47"	Natural	1
11	Acacia Rain tree	30	4	10	0.175	9°49'4"	118°41'47"	Natural	1
12	Acacia Rain tree	50	3	12	0.366	9°49'3"	118°41'43"	Natural	1
13	Acacia Rain tree	50	3	10	0.366	9°49'3"	118°41'43"	Natural	1
14	Acacia Rain tree	50	3	13	0.366	9°49'3"	118°41'43"	Natural	1
15	Acacia Rain tree	19	4	12	0.070	9°49'3"	118°41'43"	Natural	1
Total					3.777				

Prepared and inventoried by:

MICHAEL G. POLIDO

Forest Ranger

ROMMEL D. ADATO

TL/Forest Technician I

EDWIN GUILARAN

Inspecting Officer

Checked and Verified by:

ZENAIDA CALALIN

Forester II/Chief Utilization Unit

Attested by:

MILDRED A. PASCUAL

LMO II/Chief, RPS

SUBSCRIBED AND SWORN to before me this 18 day of May 2022 at DENR-CENR Office, Bgy. Sta. Monica, Puerto Princesa City, Palawan.

PEDRO A. VELASO

OIC-CENRO

	DIAMETER OF CI Data	
	20	
Species	T	V
Acacia Rain tree	1	0
Bangkal	3	0
Kupang	1	0
(blank)		
Grand Total	5	0.

Prepared and inventoried by:

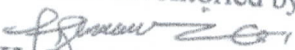
MICHAEL G. POLIDO
 Inspecting Officer

ROM

Checked and Verified by:

ZENAÍDA CAL
 Forester II/Chief Utiliz

SUBSCRIBED AND SWORN to before me

CITY GOVERNMENT OF PUERTO PRINCESA
CITY ENVIRONMENT AND NATURAL RESOURCES OFFICE
3rd Floor Puerto Princesa City Hall, Bgy. Sta. Monica
Puerto Princesa City, Philippines 5300



February 28, 2022

FOR : **ATTY. CARLO B. GOMEZ**
CG Department Head II
City Environment and Natural Resources Officer II

THRU : **ZORINA C. ARELLANO**
Senior Environmental Management Specialist

FROM : **SHERYL A. PAED**
EMS II

SUBJECT : **INSPECTION/INVENTORY REPORT ON THE TREES
THAT WILL BE AFFECTED BY THE RELOCATION
SITE PROJECT OF THE CITY GOVERNMENT OF
PUERTO PRINCESA LOCATED AT BARANGAY
IRAWAN, THIS CITY**

In response to the marginal note of City ENRO Atty. Carlo B. Gomez, thru SEMS Zorina C. Arellano, regarding cutting of trees that will be affected by the proposed Relocation Site project of City Government of Puerto Princesa located at Bgy. Irawan, this City.

Please be informed that the undersigned together with the representative from City Housing personnel, conducted tree inventory and geo-tagging of trees that will be affected. The inventory is necessary for the application of tree cutting permit/clearance.

Observations and Findings: Based on the ocular inspection conducted the following were observed;

1. A total of Fifteen (15) different naturally grown trees composed of Five (5) Acacia (*Samanea saman*), Eight (8) Bangkal (*Nauclea orientalis*) and Two (2) Kupang (*Parkia timoriana*) with an equivalent volume of 3.78 cu. m that will be affected by the project were measured. Attached are the Tally Sheet, Stand and Stock Table, Geo-tagged pictures. The coordinates of the first and last tree are as follows:

Kupang tree (1st tree) : 9° 49' 7" N, 118° 41' 47" E

Acacia (end last tree) : 9° 49' 5" N, 118° 41' 55" E

2. The area has flat to gently sloping terrain.

Recommendation

Based on the observations and findings, the undersigned recommends the proponent to secure necessary environmental permits (e.g ECC, tree cutting permit etc.) prior to implementation of the project.

For his information, records and further instruction.

Prepared by:

Smyth
SHERYL A. PAED
EMS II

Noted by:

Zorina C. Arellano
ZORINA C. ARELLANO
Senior Environmental Management Specialist

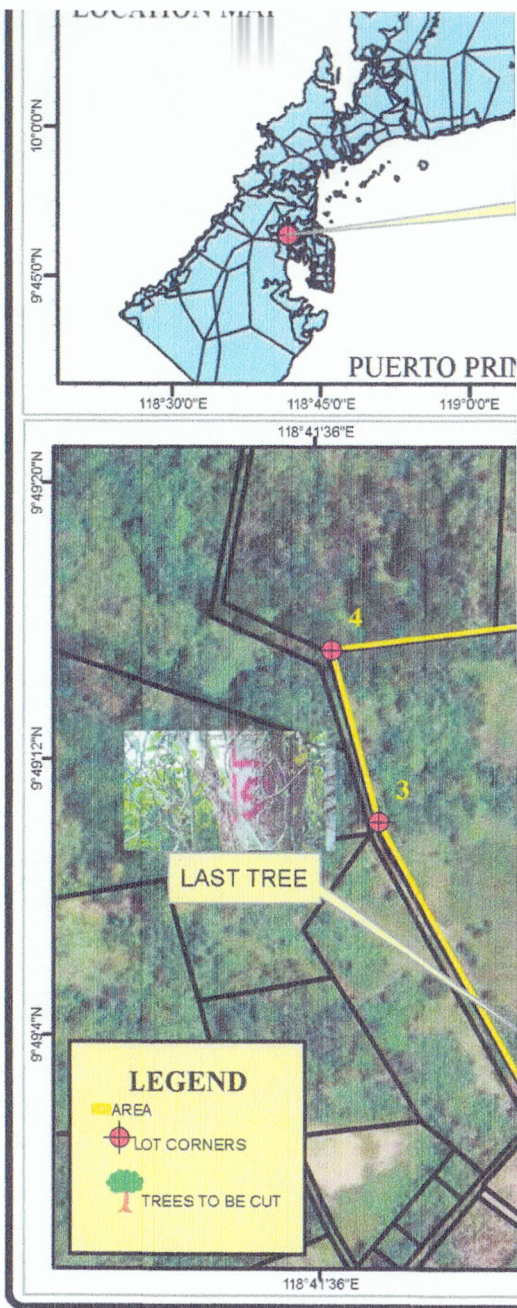



**COMMUNITY ENVIRONMENT AND NATURAL RESOURCES OFFICE
PUERTO PRINCESA CITY**

South National Highway, Bgy. Sta. Monica, Puerto Princesa City

Tel Fax No.: (048) 717-0702

Email Address: cenropuertoprincesa@denr.gov.ph

January 20, 2023

MS. MAE ANN B. JURI

HHRO I

City Urban Development & Housing Office

Brgy. Sta. Monica, Puerto Princesa City, Palawan

Cellphone No. 0945-790-2171

Dear Ms. Juri,

Environmental greetings!

This has reference to your indorsement letter requesting for the issuance of Tree Cutting Permit in Irawan Resettlement Project (Maslog) implemented by the City Government of Puerto Princesa City located at Bgy. Irawan, this City.

Please be informed that per inspection and inventory conducted by the representative of this Office within the area, it was found out that a total of fifteen (15) Naturally grown trees (comprised of 5 Acacia, 8 Bangkal and 2 kupang) with a total volume of 3.777 cubic meters will be affected the by the said project. However, upon verification and evaluation leading to the issuance of cutting permit you still have lacking documentary requirement that needs to be submitted to this Office, to wit:

1. Authenticated copy of TCT/OCT from Registry of Deeds or any proof of ownership;
2. Bgy. Certification interposing no objection to cut the said trees; and,
3. Vicinity map/ Tax map and/or Development Plan.

Be informed further that the request to cut naturally grown trees will be endorsed to the Regional Office for the issuance of corresponding permit.

Immediate submission/compliance of the above-mentioned requirements will facilitate the processing of your request.

We trust that you are properly informed.

Very truly yours,

PEDRO A. VELASCO
OIC-CENRO

**CITY URBAN DEVELOPMENT AND
HOUSING OFFICE**

RECEIVED

CONTROL NO. 029

BY: [Signature]

DATE: 01-26-23 TIME:

PICTURES TAKEN DURING THE CONDUCT OF OCULAR INSPECTION

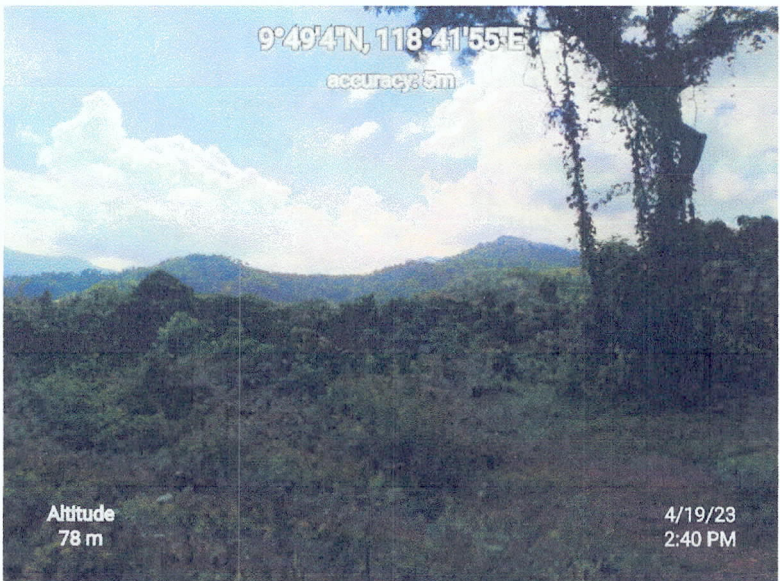





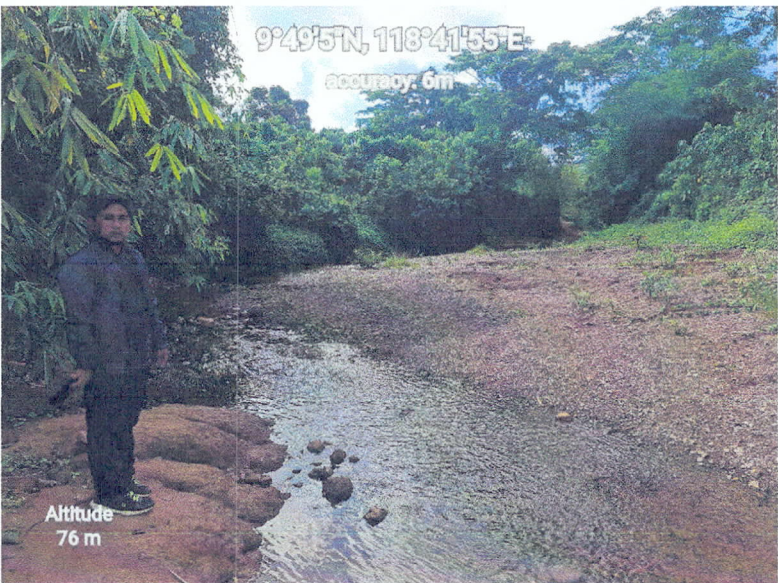



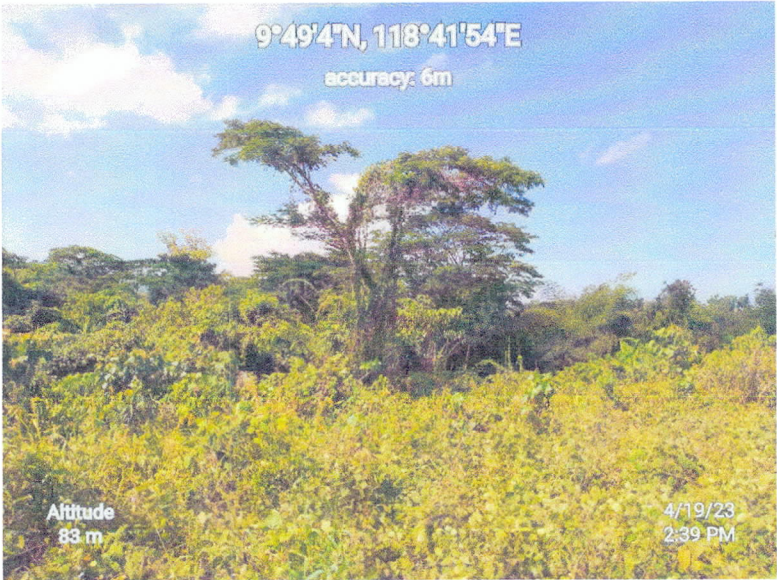



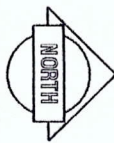

SCHEMATIC SUBDIVISION PLAN

PROJECT DESCRIPTION

LAND USE	AREA (SQ.M.)	(%)
TOTAL LOT AREA	221,808.82	100.00
RESIDENTIAL	100,963.00	45.52
ROADS	87,389.82	39.40
COMMUNITY FACILITIES	16,486.00	7.43
PARKS AND PLAYGROUNDS	16,970.00	7.65
NO. OF SALEABLE LOTS	1,663	
AVERAGE LOT AREA	50.00 SQ.M.	
MINIMUM FRONTAGE	7.50 M.	

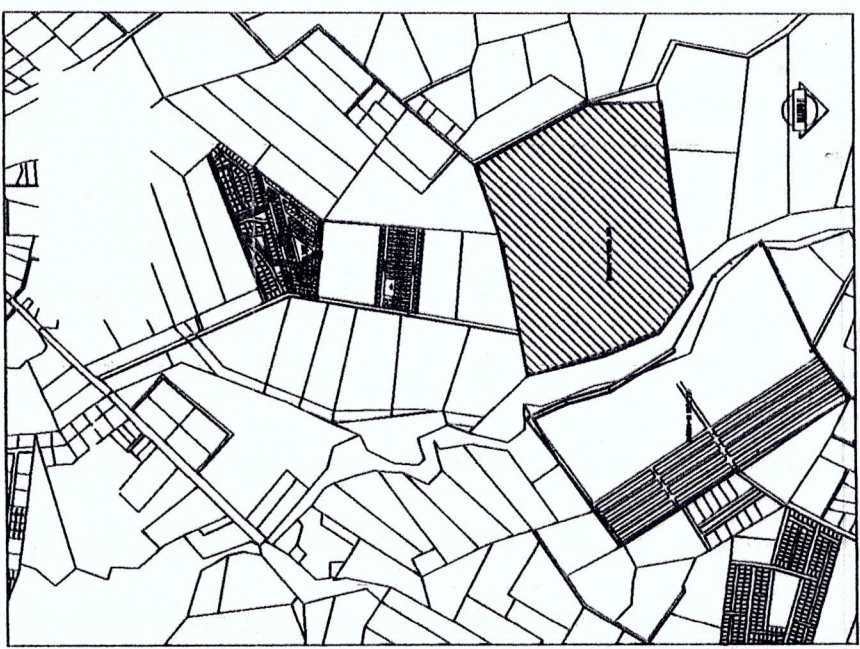

VICINITY MAP

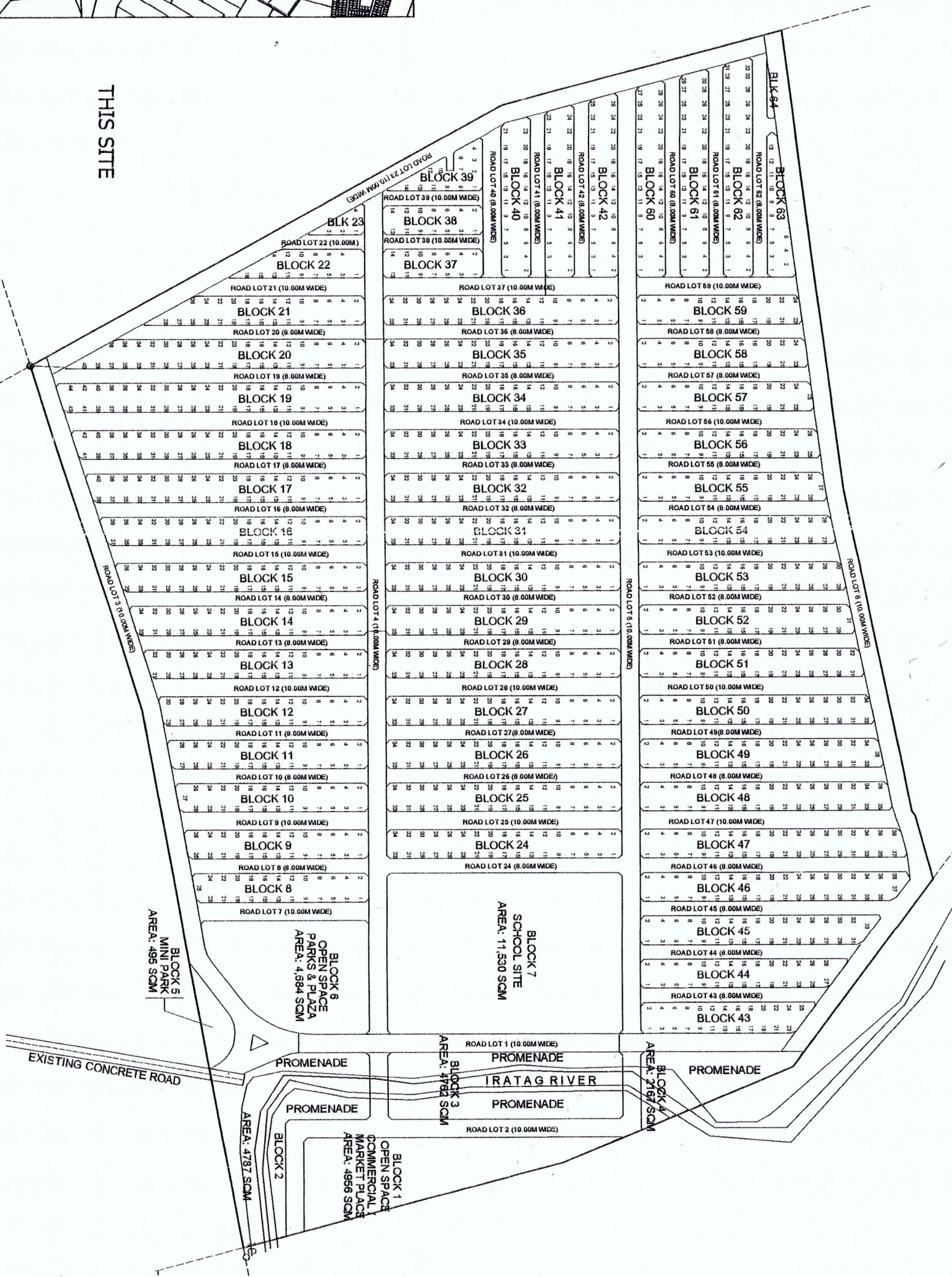

THIS SITE



PROJECT TITLE:

IRAWAN RESETTLEMENT PROJECT
SCHEMATIC SUBDIVISION PLAN
BARANGAY IRAWAN, PTO. PRINCESA CITY

PREPARED BY:
EMP. AMADO M. DADOR
ENGINEER IV

SUBMITTED BY:
EMP. ALBERTO S. JIMENEZ, JR.
CITY ENGINEER III

RECOMMENDING APPROVAL:
NANCY S. PEDROSA
HRO IV

APPROVED BY:
HON. MAURO R. MAYRON
CITY MAOR

SHEET NO.
11

STAND AND STACK TABLE

Species	DIAMETER OF CI Data									
	20		30		50		(blank)		Total T	Total V
	T	V	T	V	T	V	T	V		
Acacia Rain tree										
Bangkal	1	0.070	1	0.175	3	1.097			5	1.342
Kupang	3	0.283	5	1.193					8	1.476
(blank)	1	0.097			1	0.861			2	0.959
Grand Total	5	0.451	6	1.369	4	1.958			15	3.777

Prepared and inventoried by:

MICHAEL G. POLIDO
Inspecting Officer

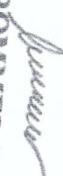

ROMMEL D. ADATO
TL/Forest Technician I

Checked and Verified by:

Attested by:



EDWIN GUILLARN
FPO

ZENAIDA CALALIN
Forester II/Chief Utilization Unit

MILDRED PASCUAL
LMO II/Chief, RPS

SUBSCRIBED AND SWORN to before me this 24day of May 2022 at DENR-CENR Office, Bgy. Sta. Monica, Puerto Princesa City, Palawan.

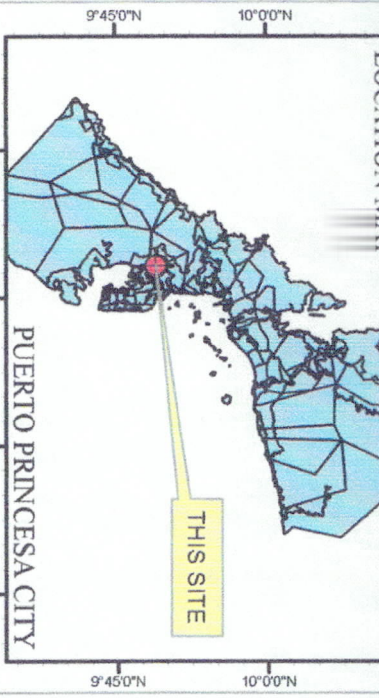
PEDRO A. VELASCO
DMO IV/OIC, CENRO



OF LOT CORNERS		
OT CORNERS	LATITUDE	LONGITUDE
1	9°49'03.52"	118°41'48.41"
2	9°49'01.65"	118°41'42.21"
3	9°49'10.13"	118°41'37.55"
4	9°49'15.15"	118°41'36.23"
5	9°49'16.17"	118°41'44.56"
6	9°49'17.33"	118°41'50.44"
7	9°49'17.39"	118°41'50.52"
8	9°49'17.64"	118°41'51.59"
9	9°49'15.10"	118°41'54.98"
10	9°49'10.96"	118°41'56.69"
11	9°49'05.22"	118°41'58.19"



TREE LOCATION MAP

PREPARED FOR
CITY GOVERNMENT OF PUERTO PRINCESA
FOR REQUEST TO CUT

NATURALLY GROWN TREES
WITHIN TITLED PROPERTY
COVERED WITH

TCT NO. 074-2022001095

LOCATED AT
BARANGAY IRAWAN,
PUERTO PRINCESA CITY,
PALAWAN



Projected Coordinate System:
WGS_1984_UTM_Zone_50N
WKID: 32650 Authority: EPSG
Projection: Transverse_Mercator

Digitized by:
MARIE KRIS Q. CUTAY
Forester I

Verified by:
JASON D. MONTIMOR
Forester II/Chief, GIS/LC Unit

Attested by:
PEDRO A. VELASCO
OIC-CENRO

LEGEND

- AREA
- LOT CORNERS
- TREES TO BE CUT

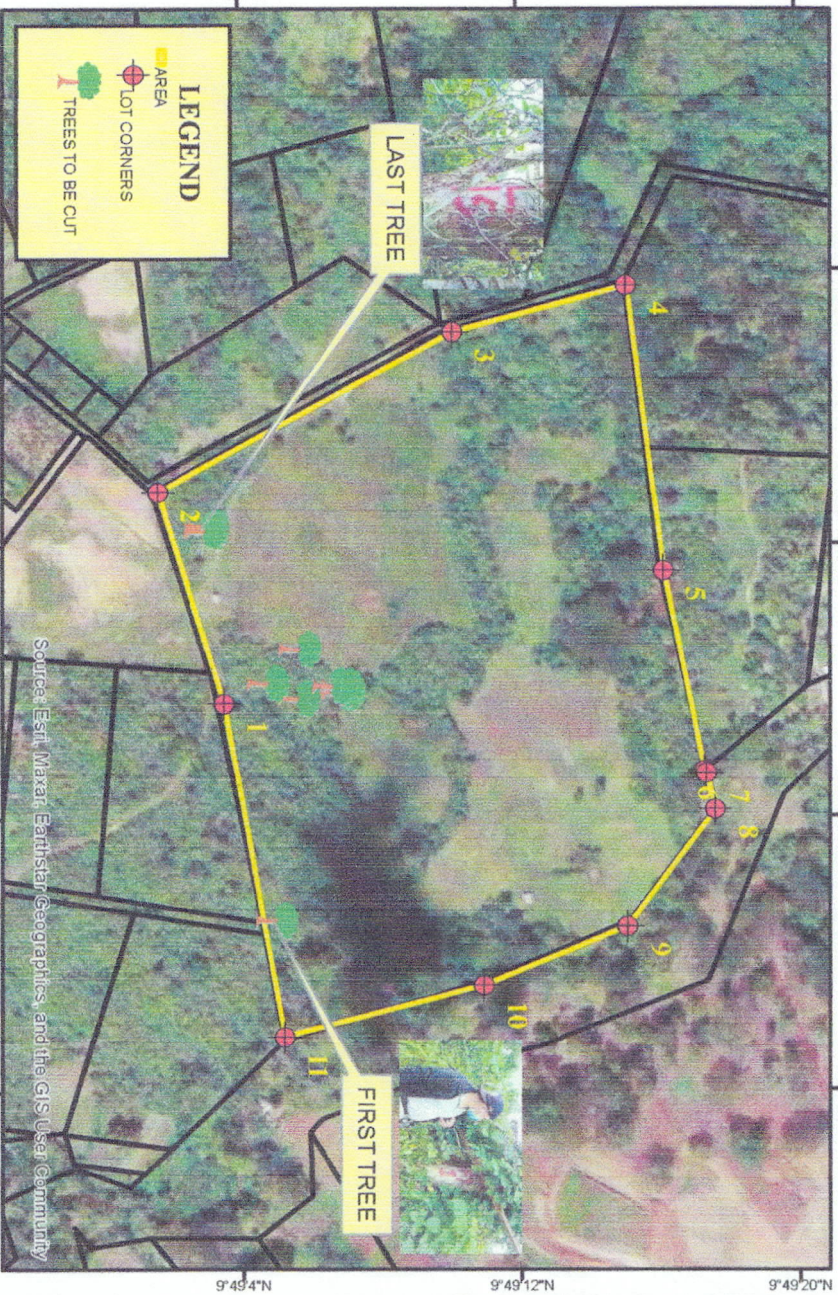

Source: Esri, Maxar, Earthstar Geographics, and the GIS User Community