



Republic of the Philippines
Department of Environment and Natural Resources
MIMAROPA Region
PROVINCIAL ENVIRONMENT AND NATURAL RESOURCES OFFICE
Brgy. Sta. Monica, Puerto Princesa City, Palawan
Telfax No. (048) 434 - 8791

Email Add: penropalawan@denr.gov.ph

DENR MIMAROPA
RECORDS SECTION
RECEIVED

JUN 02 2023

☐ INCOMING ☐ OUTGOING
BY: _____ DATE NO. _____
TIME: _____

May 5, 2023

MEMORANDUM

FOR : The Assistant Regional Director for Technical Services

FROM : The Provincial Environment and Natural Resources Officer

SUBJECT : **TRANSMITTAL OF THE REPORT**

Forwarded is the memorandum of CENRO Roxas, Palawan with the investigation report categorical recommendation on the application for Survey Authority of the subject Lot No. 104, Pls-232, situated at Brgy. IV (Poblacion), Roxas, Palawan, applied by Hilda C. Lagan, et. al.

After evaluation, this office found out the following:

- a. That Lot 104 falls within Alienable and Disposable Land per L.C Map No. 889, Project No. 1-A, Block II, duly certified on May 29, 1931.
- b. That subject lot was plotted and evaluated based on the attached technical description (V-37) from the Office of the CENRO Roxas.
- c. That the subject lot consist of four (4) corners covering an area of 1, 414 sq. meters.
- d. Attached are the geo-tagged photographs of the area and sketch map showing relative position of the subject lot overlaid in land classification map.

Relative hereto, issuance of survey authority is strongly recommended.

Reference No. 2023-3869
RPSFiles/Memo/RO/Lot104
AAP

FELIZARDO B. CAYATOC

DENR-PALAWAN
PENRO-RECORDS
RELEASED

By: _____
Date: _____ CN: 2023-1271
09 MAY 2023



Republic of the Philippines
Department of Environment and Natural Resources
MIMAROPA REGION
PROVINCIAL ENVIRONMENT AND NATURAL RESOURCES OFFICE
Bgy. Sta. Monica, Puerto Princesa City, Palawan
Telfax No. (048) 434-8791
Email Add: penropalawan@denr.gov.ph

ANNEX "B"

CERTIFICATION

This is to certify that **Lot 104, Pls-232** is within **Alienable and Disposable Land** per LC Map No. 889, Project No. 1-A, and Block No. II, duly certified May 29, 1931.

Said lot appears not covered by Group Settlement Survey (GSS).

Issued on 5th day of May 2023 for confirmatory verification of the Regional office.

FELIZARDO B. CAYATOC

Note:

Reference used was based on the rectified LC map provided and projected by the Regional Office

119°20'20"E

10°19'10"N

119°20'20"E

PROJECT NO. 1-A
BLOCK NO. II
LC STATUS ALIENABLE AND DISPOSABLE
LC NO. 889

Brgy. III

Brgy. IV

10°19'10"N



LOCATION MAP SCALE: 1:1,000,000



MAP SHOWING

THE RELATIVE LOCATION OF LOT 104, PLS-232
FOR LC CERTIFICATION APPLIED BY
HILDA C. LAGAN, ET. AL.

Located at Brgy. IV (Poblacion)
Municipality of Roxas
Province of Palawan
Coordinate System: UTM
Projection: Transverse Mercator
Datum: Luzon 1911

Legend SCALE: 1:800

LOT 3974

Land Classification

- Alienable & Disposable
- Communal Forest
- Forestland
- No Data
- UPF

Prepared by:

ALMA ALMONTA-PADILLA DONNA BELLE E. LUENGO
EAI Engineer II



Republic of the Philippines
Department of Environment and Natural Resources

Region IV- MIMAROPA

COMMUNITY ENVIRONMENT AND NATURAL RESOURCES OFFICE

Barangay III (Poblacion), Roxas, Palawan

Contact No. 09171606578 / 09175028647

Email address: cenroroxaspalawan@denr.gov.ph

MEMORANDUM

FOR : The Provincial Environment and
Natural Resources Officer

FROM : The CENR Officer

SUBJECT : **TRANSMITTAL OF REPORT**

DATE : April 20, 2023

**DENR PENRO
PALAWAN RECORDS
RECEIVED**

BY: 

DATE 01-27-2023 CN 23-3869

I am submitting the investigation report conducted on the request for survey authority involving subdivision of Lot 104, PLS-232 located in Bgy. IV (Poblacion), Roxas Palawan.

Evaluating the same, I found out that:

- a. The land subject hereof is within the agricultural (alienable/disposable lands; and
- b. The same appears peacefully occupied/possessed by Hilda C. Lagan, et al... to the exclusion of adverse others.

Hence, I recommend confirmation of the LC findings arrived at. Attached are photographs showing improvements found introduced thereon and are apt for geotagging.

PABLO L. CRUZ

Copy: The ARD, Technical Services
c/o The SMD at surveys_mimaropa@yahoo.com
The Claimant
File

DENR-CENRO ROXAS

RELEASED

DATE APR 26 2023

BY: 

DOC. NO. 2023-04-0635



Republic of the Philippines
Department of Environment and Natural Resources
Region IV- MIMAROPA

COMMUNITY ENVIRONMENT AND NATURAL RESOURCES OFFICE

Barangay III (Poblacion), Roxas, Palawan
Contact No. 09171606578 / 09175028647
Email address: cenroroxaspalawan@denr.gov.ph

CERTIFICATION

THIS IS TO CERTIFY that Lot 104, PLS-232 is within agricultural and disposable land per LC Map No. 889, Project No.1-A dated May 29, 1931, under FAO/DAO No. DMC-2019-10.

Said lot is not covered by GSS covering areas which are within agricultural and disposable land.

Issued on 20th day of April 2023.

PABLO L. CRUZ
CENRO



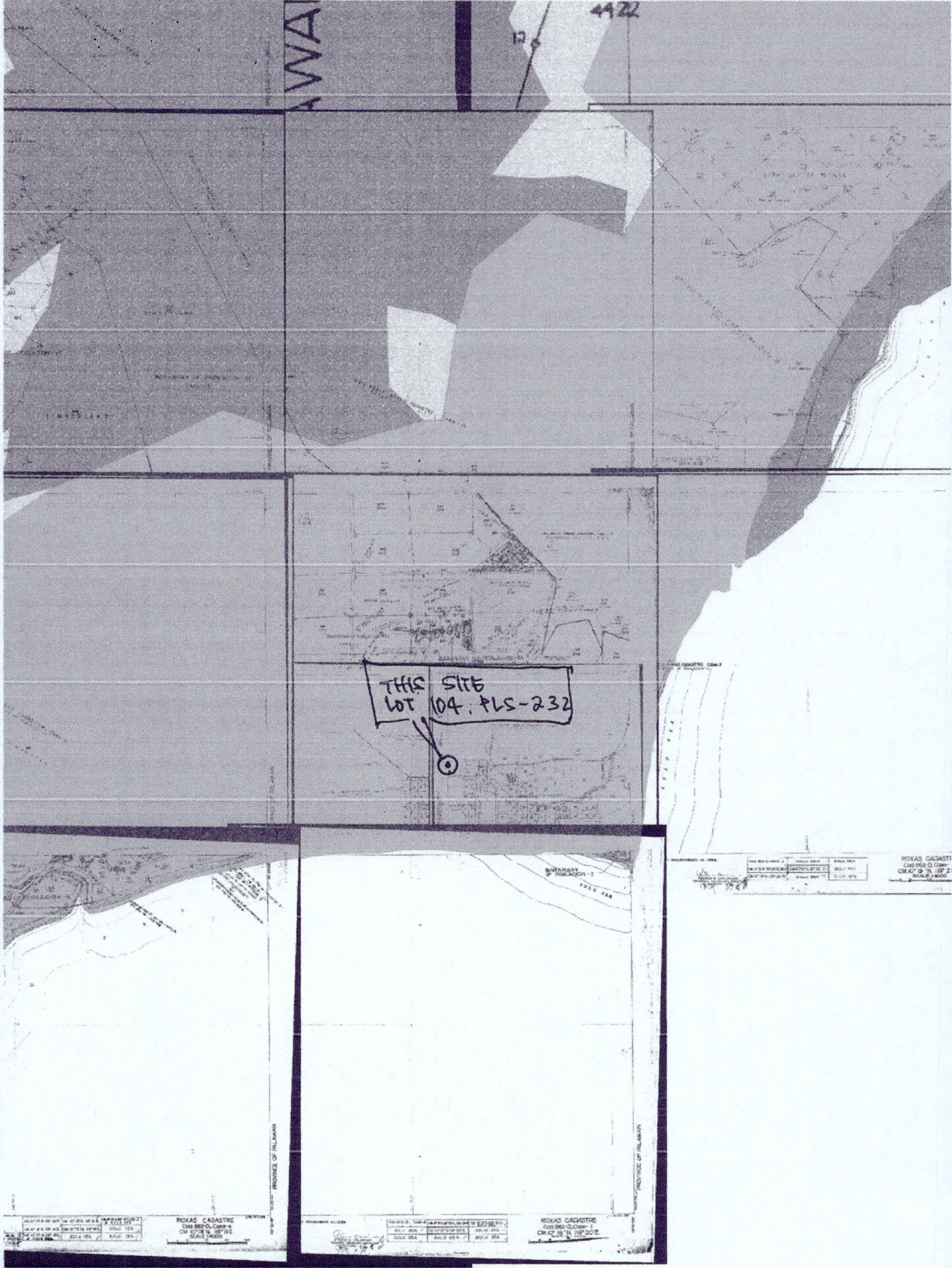

AWA

4422

12

THIS SITE
LOT 104, PLS-232



PROVINCE OF ILLANAN
ROKAS CADASTRE
COS 982-0, CODE-4
CM 10' N. 10' 51"
SCALE 1:5000

PROVINCE OF ILLANAN
ROKAS CADASTRE
COS 982-0, CODE-4
CM 10' N. 10' 51"
SCALE 1:5000

PROVINCE OF ILLANAN

PROVINCE OF ILLANAN
ROKAS CADASTRE
COS 982-0, CODE-4
CM 10' N. 10' 51"
SCALE 1:5000

PROVINCE OF ILLANAN
ROKAS CADASTRE
COS 982-0, CODE-4
CM 10' N. 10' 51"
SCALE 1:5000

PROVINCE OF ILLANAN
ROKAS CADASTRE
COS 982-0, CODE-4
CM 10' N. 10' 51"
SCALE 1:5000



Republic of the Philippines
Department of Environment and Natural Resources
Region IV
COMMUNITY ENVIRONMENT AND NATURAL RESOURCES OFFICE
Roxas, Palawan

Application No. _____ Applicant: HILDA C. LAGAN, ETAL...

Lot No. 104, PLS-232

Ident. To Lot No. 694, Cad 862-D

Surveyed for: _____ Area (sq. m.) 1,414

Date of Original Survey: _____ Date Approved: _____

Surveyed by: VALENTIN DELA CRUZ Location: BGY IV (POBLACION), Roxas, Palawan

C.M. _____

TECHNICAL DESCRIPTION

THE LINE: N 75-00 W, 407.04 meters from BLM#1 PLS-232 to
Corner 1.

LINE	BEARINGS	DISTANCE	LINE	BEARINGS	DISTANCE
1-2	S 0-21 E	38.56 meters			
2-3	S 89-36 W	37.15			
3-4	N 0-24 E	38.11			
4-1	N 88-53 E	36.65			

SKETCH

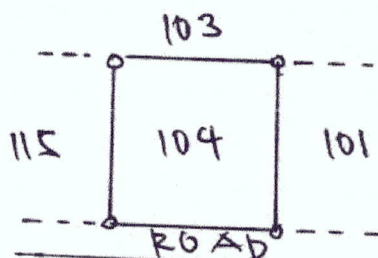

Note: All adjacent lots are within PLS-232

T. D. Researched by: _____ Date: _____

T.D. Sketched by: ARNOLD V. GONZALES Date: _____

T. D. Checked by: _____ Date: _____

BUREAU OF LANDS

LOT DESCRIPTIONS

BARBACAN PUBLIC LANDS SUBDIVISION

Survey No. *P15-232* Case No.Municipality of *Puerto Princesa* Province of *Palawan*

LOT NUMBER	MON. TO CORNER	LINE 1-2	LINE 2-3	LINE 3-4	LINE 4-5	LINE 5-6	LINE 6-7	LINE 7-8	Area Square Meter
82	BLLM 1 To Cor 1 S 53° 56' W 526.02	S 02° 18' W N 1° 28' E 53.02	N 89° 39' E S 0° 26' E 29.53	S 0° 26' E 43.29	S 0° 26' E 25.30				9.06
83	BLLM 1 To Cor 1 S 72° 31' W 293.07	South 45.02	N 89° 58' W N 0° 07' E 53.29	S 89° 29' E 45.30	S 89° 29' E 33.19				15.01
84	BLLM 1 To Cor 1 S 72° 31' W 293.07	N 89° 20' W N 0° 08' W 53.19	S 89° 41' E 44.86	S 89° 41' E 53.27	S 89° 41' E 44.92				14.99
85	BLLM 1 To Cor 1 N 81° 33' W 288.98	S 0° 55' E 45.02	N 89° 43' W N 0° 14' W 53.22	S 89° 55' E 45.00	S 89° 55' E 32.68				14.84
86	BLLM 1 To Cor 1 N 77° 33' W 280.59	N 89° 35' W N 0° 16' E 52.68	S 89° 48' E 44.71	S 89° 48' E 53.07	S 89° 48' E 44.83				14.72
87	BLLM 1 To Cor 1 S 62° 20' W 288.51	S 0° 22' W N 89° 43' W 52.59	N 0° 23' E 53.23	N 89° 15' E 37.91	N 89° 15' E 33.81				12.65
88	BLLM 1 To Cor 1 N 69° 25' W 298.51	S 88° 15' W N 0° 18' W 52.91	S 88° 11' E 22.52	S 0° 30' E 33.15	S 0° 30' E 31.75				14.65
89	BLLM 1 To Cor 1 N 71° 20' W 300.56	N 0° 10' E N 89° 46' E 35.45	S 0° 18' E 33.10	S 89° 59' W 53.82	S 89° 59' W 33.54				11.58
90	BLLM 1 To Cor 1 N 75° 20' W 300.96	N 86° 59' E S 0° 23' W 49.64	N 89° 56' W 37.91	N 0° 07' W 33.17	N 0° 07' W 35.60				12.13
91	BLLM 1 To Cor 1 N 89° 02' W 346.37	N 0° 02' E S 89° 58' E 45.10	S 0° 16' W 59.34	S 89° 02' W 44.71	S 89° 02' W 33.16				14.99
92	BLLM 1 To Cor 1 N 89° 02' W 346.37	N 89° 02' E S 0° 14' E 43.16	S 89° 48' W North 45.00	North 33.35	North 44.91				14.96
93	BLLM 1 To Cor 1 S 74° 45' W 357.15	N 0° 06' E N 89° 40' E 44.01	S 0° 03' E 33.26	S 89° 44' W 44.86	S 89° 44' W 33.43				14.97
94	BLLM 1 To Cor 1 S 75° 45' W 357.15	N 89° 44' E S 0° 07' W 43.45	S 89° 53' W North 45.30	North 33.39	North 45.21				15.11
95	BLLM 1 To Cor 1 S 65° 30' E 343.94	S 1° 28' E N 85° 01' W 22.53	N 2° 28' E 39.98	S 89° 54' E 26.56	S 89° 54' E 32.94				9.50
96	BLLM 1 To Cor 1 S 70° 30' W 408.20	S 88° 50' E S 3° 24' E 37.48	N 89° 23' W 29.66	S 0° 17' N 30.23	S 0° 17' N 26.53				10.72
97	BLLM 1 To Cor 1 S 77° 21' W 402.80	N 89° 35' E S 0° 07' W 36.97	West 45.08	N 0° 12' W 56.79	N 0° 12' W 44.81				16.56
98	BLLM 1 To Cor 1 S 77° 21' W 402.80	N 0° 07' W S 89° 44' E 46.10	S 0° 03' W 37.11	S 89° 35' W 45.01	S 89° 35' W 36.97				16.87
99	BLLM 1 To Cor 1 N 89° 17' W 393.26	N 89° 38' E S 0° 24' E 36.68	S 89° 39' W N 0° 02' E 45.05	S 0° 02' E 37.32	S 0° 02' E 45.04				16.60
100	BLLM 1 To Cor 1 N 89° 17' W 393.26	N 0° 07' E N 89° 40' E 45.03	S 0° 21' W 36.87	S 89° 38' W 44.81	S 89° 38' W 36.68				16.54
101	BLLM 1 To Cor 1 N 78° 00' W 407.04	S 84° 58' E South 37.51	S 89° 50' W N 0° 21' W 35.13	S 0° 21' W 36.02	S 0° 21' W 38.56				13.66
102	BLLM 1 To Cor 1 N 78° 00' W 407.04	N 0° 04' W East 32.99	S 0° 27' W 57.48	N 89° 58' W 36.26	N 89° 58' W 57.31				12.99
103	BLLM 1 To Cor 1 N 78° 00' W 407.04	S 88° 53' W N 1° 17' E 36.65	S 89° 40' E 33.84	S 0° 03' W 35.96	S 0° 03' W 32.90				12.13
104	BLLM 1 To Cor 1 N 78° 00' W 407.04	S 0° 21' E S 89° 36' W 39.66	N 0° 24' E 37.15	N 89° 52' E 38.11	N 89° 52' E 36.66				14.14
105	BLLM 1 To Cor 1 N 89° 17' W 394.24	S 89° 58' W N 0° 40' E 37.60	N 89° 35' E 44.13	S 0° 07' W 37.17	S 0° 07' W 45.03				16.70
106	BLLM 1 To Cor 1 N 89° 17' W 393.26	S 0° 02' E West 45.04	N 0° 32' W 37.16	N 89° 58' E 45.03	N 89° 58' E 31.60				16.83
107	BLLM 1 To Cor 1 S 77° 21' W 402.85	S 89° 43' W N 0° 03' W 36.99	N 89° 08' E 45.02	S 0° 07' E 37.02	S 0° 07' E 46.11				16.86
108	BLLM 1 To Cor 1 S 77° 21' W 402.86	S 0° 12' E S 89° 45' W 44.81	N 0° 13' W 36.97	N 89° 48' E 44.84	N 89° 48' E 36.99				16.58

CERTIFIED CORRECT:

August 22, 1955

NEANOR G. JORRE
Chief, Division of Surveys
Bureau of Lands

Copied by *[Signature]* Date Aug. 6, 1954Checked by *[Signature]* Date Dec. 8, 1955Checked by *[Signature]* Date Dec. 6, 1954Verified by *[Signature]* Date Jan. 4, 1955

Surveyed February 1940-1941, 1951

By VALENTIN DELA CRUZ

JOSE AGOTAYA
District Land Officer

38 Sheets

Sheet No. 4

BUREAU OF LANDS

LOT DESCRIPTIONS

BARBACAN PUBLIC LANDS SUBDIVISION

Survey No. *P13-232* Case No. Municipality of *Puerto Princesa* Province of *Palawan*

Lot Number	Area to Corner	Line 1-2	Line 2-3	Line 3-4	Line 4-5	Line 5-6	Line 6-7	Line 7-8	Area Square Meters
82	BLM 1 to Cor 1 S 52° 56' N 326.02	S 80° 18' W N 1° 28' N N 80° 30' E S 0° 26' E 33.02 29.53 83.29 25.30							2.06
83	BLM 1 to Cor 1 S 72° 31' W 293.07	South N 80° 58' N N 0° 07' E S 89° 20' E 45.02 83.29 45.30 89.19							16.01
84	BLM 1 to Cor 1 S 72° 31' N 293.07	N 80° 20' W N 0° 08' N S 89° 41' E S 0° 02' E 33.19 44.96 33.27 44.98							14.98
85	BLM 1 to Cor 1 N 87° 33' W 290.58	S 0° 55' E N 80° 43' N N 0° 14' W S 89° 35' E 45.02 33.22 45.00 32.68							14.94
86	BLM 1 to Cor 1 N 87° 33' W 280.88	N 90° 23' W N 0° 16' E S 80° 48' E S 0° 16' N 32.68 44.71 33.07 44.83							14.70
87	BLM 1 to Cor 1 N 89° 20' W 288.51	S 0° 23' W N 80° 43' W N 0° 23' E N 80° 15' E 38.89 33.29 37.41 33.51							12.65
88	BLM 1 to Cor 1 N 89° 20' W 256.51	S 80° 15' W N 0° 15' N S 80° 15' E S 0° 32' E 33.51 34.42 44.10 21.70							10.49
89	BLM 1 to Cor 1 N 73° 20' W 360.96	N 0° 00' E N 80° 46' E S 0° 18' E S 80° 59' W 35.45 33.10 33.82 33.54							11.53
90	BLM 1 to Cor 1 N 73° 20' W 360.96	N 80° 50' E S 0° 23' W N 80° 56' W N 0° 07' N 33.54 37.41 33.17 35.60							12.18
91	BLM 1 to Cor 1 N 80° 06' W 360.57	N 0° 02' E S 80° 58' E S 0° 16' W S 80° 22' W 46.10 33.54 44.71 33.16							14.93
92	BLM 1 to Cor 1 N 80° 06' W 346.37	N 80° 02' E S 0° 14' E S 80° 48' W N 0° 19' N 33.16 45.00 33.55 44.01							14.96
93	BLM 1 to Cor 1 S 75° 45' N 357.18	N 0° 06' E N 80° 40' E S 0° 40' S S 80° 44' N 44.01 33.26 44.84 33.43							14.57
94	BLM 1 to Cor 1 S 75° 45' W 357.18	N 80° 44' E S 0° 07' N S 80° 53' W North 43.41 45.30 33.35 45.21							15.11
95	BLM 1 to Cor 1 S 80° 50' W 345.24	S 1° 28' E N 80° 01' W N 0° 20' E S 80° 54' E 22.53 34.22 22.22 22.24							2.50
96	BLM 1 to Cor 1 S 70° 00' W 419.23	S 80° 50' E S 3° 24' E N 80° 23' W N 0° 17' N 37.48 22.66 36.29 26.53							10.72
97	BLM 1 to Cor 1 S 77° 21' W 402.89	N 80° 35' E S 0° 07' W West N 0° 12' W 36.07 45.08 36.73 44.81							16.50
98	BLM 1 to Cor 1 S 77° 21' W 402.89	N 0° 07' W S 80° 44' E S 0° 03' W S 80° 35' W 46.10 37.11 45.01 36.97							16.87
99	BLM 1 to Cor 1 N 80° 17' W 393.26	N 80° 30' E S 0° 29' E S 80° 39' N N 0° 02' E 36.68 45.08 37.52 45.04							14.60
100	BLM 1 to Cor 1 N 80° 17' W 393.26	N 0° 07' E N 80° 43' E S 0° 21' W S 3° 38' W 45.03 36.07 44.95 36.08							16.54
101	BLM 1 to Cor 1 N 15° 00' W 407.04	S 84° 53' E South S 60° 50' W N 0° 21' W 37.81 36.18 36.92 38.56							13.66
102	BLM 1 to Cor 1 N 78° 00' W 407.04	N 0° 08' W E 2° 57' S 0° 37' N N 80° 58' W 22.22 37.22 22.22 37.21							12.55
103	BLM 1 to Cor 1 S 78° 00' W 407.04	S 80° 53' W N 1° 17' E S 80° 48' E S 0° 03' W 36.65 33.84 36.06 32.90							12.19
104	BLM 1 to Cor 1 S 78° 00' W 407.04	S 0° 20' E S 80° 48' W N 0° 02' E N 80° 57' E 20.36 37.18 40.01 36.06							14.14
105	BLM 1 to Cor 1 N 80° 17' W 393.26	S 80° 58' W N 0° 40' E N 80° 35' E S 0° 37' W 37.00 44.18 37.17 45.03							16.79
106	BLM 1 to Cor 1 N 80° 17' W 393.26	S 0° 02' E West N 0° 35' W N 80° 08' E 45.04 37.16 44.03 37.00							16.89
107	BLM 1 to Cor 1 S 77° 21' W 402.85	S 80° 48' W N 0° 03' W N 80° 08' E S 0° 07' E 36.99 45.02 37.02 46.10							16.86
108	BLM 1 to Cor 1 S 77° 21' W 402.85	S 0° 12' E S 80° 45' W N 0° 13' W N 80° 48' E 44.81 36.97 44.84 36.03							16.58

CERTIFIED CORRECT:

August 22, 1955

NEANOR G. LOBOS
Chief, Division of Surveys
Bureau of Lands

Copied by *E. L. Lopez* Date *Aug 6, 1954*Checked by *Manfred Lopez* Date *Dec 3, 1955*Checked by *Manfred Lopez* Date *Dec 3, 1954*Verified by *Manfred Lopez* Date *Dec 3, 1954*Surveyed *February 1955*By *Valentin B. La Cruz*JOSÉ AGOSTA
City District Land Officer

38 Sheets

Sheet No. 4

BARANGAY OF POBLACION -IV

RCI -04- 001661

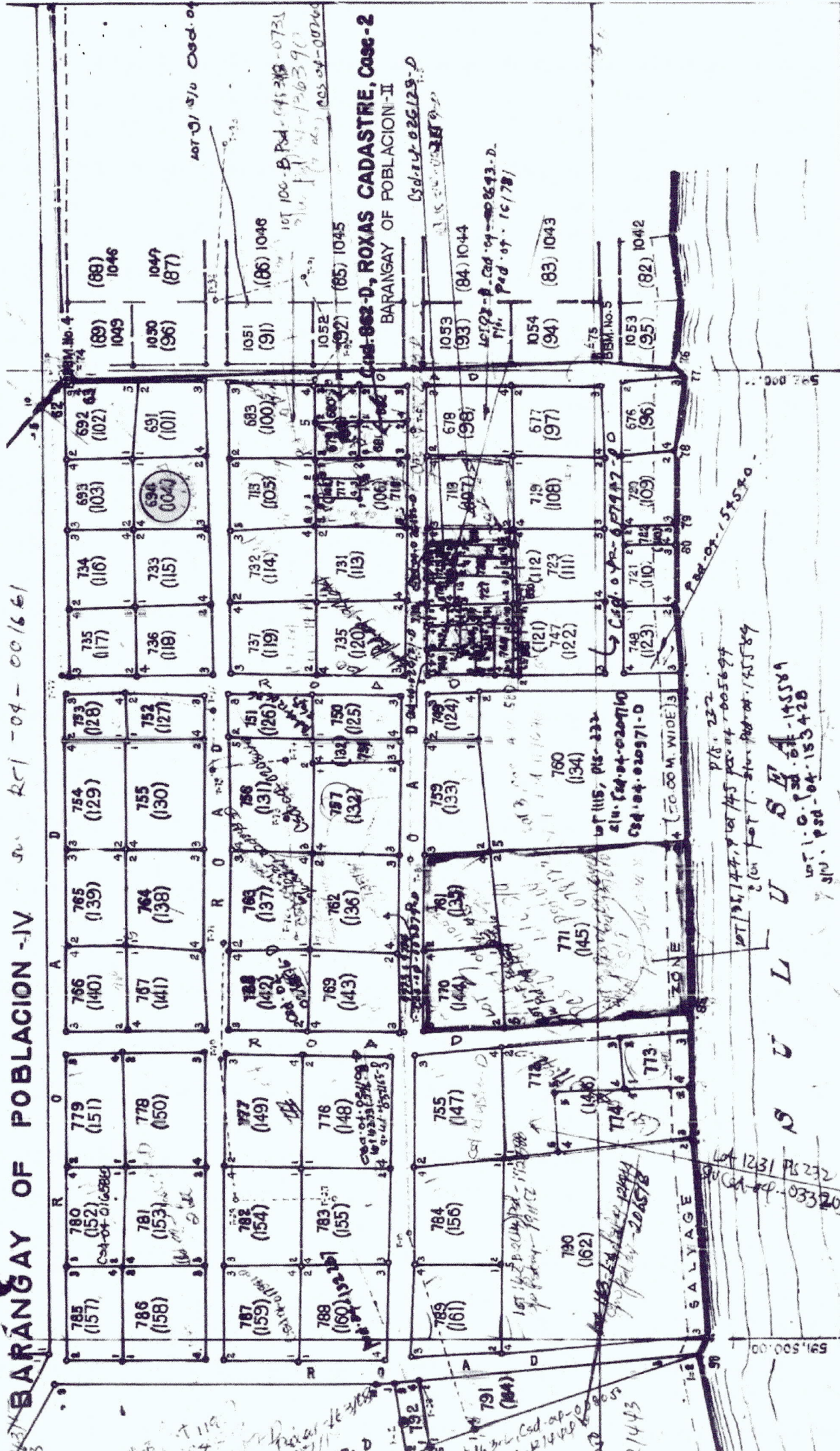

ROXAS CADASTRE
 Cad. 862-D, Case-3 & 4
 CM. 10° 19' N. 119° 20' E., Sec. 4
SCALE: 2000

CM. 10° 19' N. 119° 19' E.	CM. 10° 13' N. 119° 20' E.	CM. 10° 13' N. 119° 21' E.
CM. 10° 19' N. 119° 19' E.	CM. 10° 19' N. 119° 20' E., Sec. 4	CM. 10° 19' N. 119° 20' E., Sec. 3
CM. 10° 18' N. 119° 19' E.	SULU SEA	SULU SEA

PEDRO N. CALIMILIM

200 M.



**MUNICIPAL CIRCUIT TRIAL COURT FOR ROXAS
AND CAGAYANCILLO**

Mabini Street, Barangay 2

Roxas, Palawan

6thmctcroxascagayancillo@gmail.com

Telephone No.: (048)717-5563

MUNICIPAL CIRCUIT TRIAL COURT CLEARANCE

TO WHOM IT MAY CONCERN:

THIS IS TO CERTIFY that according to the records now available at this Court, there is no criminal or civil case filed, pending or disposed of against **HILDA C. LAGAN**, pertaining to Lot 104, PLS 232 situated at Barangay IV, Roxas, Palawan.

This Certification is issued upon request of Mr. Arnold V. Gonzales, Land Management Inspector of DENR-CENRO, Roxas, Palawan, for lawful purposes.

This 31st day of January, 2023 at Roxas, Palawan, Philippines.

ROGER M. SERATUBIAS
Clerk of Court II

Comm. Tax Cert.: 10666727

Issued on: 1/23/23

Issued at Roxas, Palawan

O.R. (local): 0935646

Issued on: 1/31/23

O.R. (JDF/SAJ): 0130014/0132012/2315852

Issued on: 01/31/23

Issued at: Roxas, Palawan



Republic of the Philippines
Department of Environment and Natural Resources
Region IV
COMMUNITY ENVIRONMENT AND NATURAL RESOURCES OFFICE
Roxas, Palawan

REPUBLIC OF THE PHILIPPINES)
PROVINCE OF PALAWAN : S.S.
MUNICIPALITY OF ROXAS)

JOINT AFFIDAVIT

We, ENRICO R. RAMILO, single/married/widow and RODRIGO ASUNCION,
single/married/widow both residents of Bgy. 4, ROXAS,
Palawan after having been sworn, hereby depose and state:

1. That we personally know HILDA C. LAGAN who desires for segregation/subdivision of Lot 104, PLS-232 in Bgy. IV, Roxas, Palawan;
2. That we are actual residents of Barangay IV, in the Municipality of Roxas, Palawan;
3. That we are aware of the fact that HILDA C. LAGAN is the actual occupant and or possessor of the subject lot;
4. That we are not related to the applicant either by consanguinity or affinity and not, in any way, interested in the land; and
5. That to the best of our knowledge, belief and information, the land is not claimed by adverse others.

IN WITNESS WHEREOF, we have hereunto set our hands this 17th day of
April 2023 in the place above first written.

ENRICO R. RAMILO
Affiant
OSCA ID/CTC No. 056813
Issued on MAY 5, 2021
Issued at ROXAS, PAL.

RODRIGO ASUNCION
Affiant
Driver's license/CTC No. D1190.012999
Issued on 2/15/2022
Issued at Puerto Princesa City

SUBSCRIBED AND SWORN to be fore me on the date and place stated above.

ARNOLD V. GONZALES
Officer Authorized to Administer Oath
Land Mgt. Inspector
(Designation)



Republic of the Philippines
Office for Senior Citizen Affairs (OSCA)
Municipality of Roxas

ID No. 056813

Name: ENRICO RADA RAMILO
Sex: Male **Age:** 72
Date of Birth: March 13, 1949
Address: Bgy. IV, Roxas, Palawan
Date Issued: May 5, 2021
Place of Issued: Roxas, Palawan





**RIGHT THUMB
PRINT**



Signature

This Card is non-transferrable & valid anywhere in the country

Benefits and Privileges under RA 9994

- Free Medical/dental, diagnostic & laboratory service in all government facilities
- 20% discount for medicines
- 20% discount in hotels, restaurants, recreation centers
- 20% discount in theaters, cinema houses & concert halls
- 20% discount in medical/dental, diagnostic & laboratory fees in private facilities
- 20% discount in fare for domestic air, sea travel & public land transportation
- 5% discount in basic necessities & prime commodities
- 12% VAT exemption on the purchase of goods & services which are entitled
- 5% discount for the monthly utilization of water & electricity, provided that the water and electricity meter bases are under the name of the senior citizen

Persons and Corporations violating RA 9994 shall be penalized. Only for the exclusive use of Senior Citizens; abuse of privileges is punishable by law.

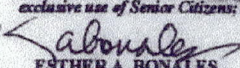

ESTHER A. BONALES
OSCA Head



DENNIS M. SABANDO
Municipal Mayor



REPUBLIC OF THE PHILIPPINES
DEPARTMENT OF TRANSPORTATION
LAND TRANSPORTATION OFFICE
DRIVER'S LICENSE





Last Name, First Name, Middle Name
ASUNCION, RODRIGO MIRANDA

Nationality Sex Date of Birth Weight (kg) Height(m)
PHL M 1965/02/15 67 1.77

Address
MANGA ST PPCITY PALAWAN

License No. Expiration Date Agency Code
D11-90-012999 2032/02/15 D56

Blood Type Eyes Color
A+ BLACK

DL Codes Conditions
A,A1,B,B1,B2 NONE

Signature of Licensee *[Signature]* **EDGAR C. SALVANTE**
Assistant Secretary



III. ORGAN DONATION
I WILL NOT DONATE ANY ORGAN

IV. IN CASE OF EMERGENCY NOTIFY:
NAME: REBECCA ASUNCION
ADDRESS: RUGAS PHL
TEL. NO.: 099641351190

I. DL CODES

A. MOTORCYCLE
A1. TWO-WHEELER
B. UP TO 3000 KGS GVW/9 SEATS
B1. UP TO 3000 KGS GVW/9 OR MORE SEATS
B2. UNDER 3000 KGS GVW
C. UNDER 3000 KGS GVW
D. BUS > 3000 KGS GVW
E. BUS > 3000 KGS GVW/9 OR MORE SEATS
F. TRAILERS 3000 KGS
G. UNLICENSED C > 3000 KGS COMBINED GVW

II. CONDITIONS:
1. WEAR CORRECTIVE LENSES
2. DRIVE ONLY W/ ORIGINAL RPT FOR UPPER/LOWER LIMBS
3. DRIVE CUSTOMIZED MOTOR VEHICLE ONLY
4. DAYLIGHT DRIVING ONLY
5. HEARING AID REQUIRED

Serial Number
177066354

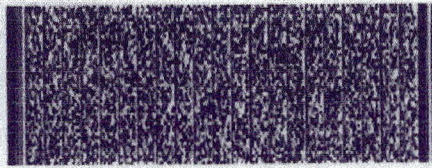



Republic of the Philippines
Department of Environment and Natural Resources
Region IV - MIMAROPA
COMMUNITY ENVIRONMENT AND NATURAL RESOURCES OFFICE
Bgy. III (Poblacion), Roxas, Palawan
Contact No. 09171606578/ 09175028647
Email address: cenroroxaspal@denr.gov.ph

MEMORANDUM

For : The Community Environment and
Natural Resources Officer

From : The Investigating Officer

Subject : **INVESTIGATION REPORT**

Date : April 17, 2023

I am submitting this report in compliance with your instruction to conduct investigation on the attached request for Survey Authority.

SUBJECT LOT

The subject of this investigation is respective portion of Lot 104, PLS-232 located at Bgy. IV (Poblacion), Roxas, Palawan.

CLAIMANT

The claimant is Mrs. Hilda C. Lagan, et al... actual occupant and possesor of the subject lot.

ACTIVITIES UNDERTAKEN

Upon receipt of your instruction, I immediately conducted the investigation. The following were ascertained:

1. Previously surveyed, part of the cadastral map over which the LC was overlayed by the Surveys and Mapping Division (SMD), was printed and hereto attached along the LC certification (annex "B" to DMC-2019-10) prepared and its technical description also required by the SMD.
2. The Bgy. Certification attached as required in support of the claimants claims, was validated on site as evidenced by the attached geotagged photographs showing improvements introduced thereon.

FINDINGS AND RECOMMENDATION

Verifications, disclosed the following:

1. The subject lot is within the agricultural (alienable/disposable) lands. Attached is its confirmation by the Regional Office.
2. Respective portion thereof are maintained by the herein claimant.

Thus, I recommend granting of the survey authority desired.



ARNOLD V. GONZALES
Land Management Inspector/Investigating Officer

Geophotos taken on portion of Lot 104, PLS-232 located at Bgy. IV, Roxas, Palawan requested for
issuance of survey authority by Hilda C. Lagan, et al...



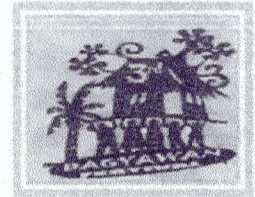

Republic of the Philippines
Province of Palawan
Municipality of Roxas
OFFICE OF THE PUNONG BARANGAY
Barangay IV-Poblacion



CERTIFICATION

TO WHOM IT MAY CONCERN:

THIS IS TO CERTIFY that **HILDA C. LAGAN** is a resident of Purok Mabuhay, Barangay IV-Poblacion, Roxas, Palawan.

THIS CERTIFIES FURTHER, that per records of this Office, **HILDA C. LAGAN** is the occupant/cultivator of certain parcel of land located at Purok Mabuhay Barangay IV-Poblacion, Roxas, Palawan described as follows.

Lot No./Tax Declaration No. : Lot No. 104 Part , RVS-232
Area : 600.00 sq.m.
Classification : Residential
Location : Purok Mabuhay, Barangay IV-Poblacion, Roxas, Palawan

ISSUED upon the request of **HILDA C. LAGAN** for whatever legal purpose it may serve her best.

CERTIFIED this **23rd** day of **January 2023**, at Barangay IV-Poblacion, Roxas, Palawan.

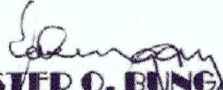
ESTER O. BUNGAY
Punong Barangay

Cert. fee: P 200.00

O.R. No.: 0930528

Issued on: January 23, 2023

Issued at: Roxas, Palawan

ID. NO. 056067



Republic of the Philippines
Office for Senior Citizens Affairs
Municipality of Roxas



NAME: HILDA C. LAGAN
ADDRESS: Bgy. IV, Roxas, Palawan

Dec. 13, 1952/60 Female March 13, 2013
Date of Birth/Age Sex Date of Issue

**THIS CARD IS NON-TRANSFERABLE AND
 VALID ANYWHERE IN THE COUNTRY**

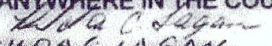

HILDA C. LAGAN
Printed Name and Signature/Thumbmark

Benefits and Privileges under Republic Act No. 9257

- Free medical and dental, diagnostic & laboratory services in all government facilities
- 20% discount in purchase of medicines
- 20% discount in hotels, restaurants, recreation centers, funeral parlors and similar establishments
- 20% discount on theaters, cinema houses and concert halls, etc.
- 20% discount on medical & dental services, diagnostic & laboratory fees in private facilities
- 20% discount in fare for domestic air, sea travel and public land transportation

Only for the exclusive use of Senior Citizens; abuse of privileges is punishable by law

Persons & Corporations violating RA 9257 shall be penalized

PTR. REYNALDO I. ABAD
 OSCA HEAD

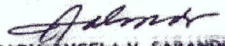
MARIA ANGELA V. SABANDO
 Municipal Mayor

COMMUNITY TAX CERTIFICATE		INDIVIDUAL		CCI202110666727	
YEAR 2023	PLACE OF ISSUE (City/Mun./Prov.) Roxas, Palawan	DATE ISSUED 1/23/23		TAXPAYER'S COPY	
NAME (SURNAME) Lagan		NAME (FIRST) Hilda		TIN (If Any)	
ADDRESS Bongoray IV, Roxas, Palawan		SEX <input type="checkbox"/> MALE <input checked="" type="checkbox"/> FEMALE		HEIGHT	
CITIZENSHIP Fil	ICR NO. (If an Alien)	PLACE OF BIRTH Sagada Mt. Province	DATE OF BIRTH 12-13-1952		WEIGHT
CIVIL STATUS <input checked="" type="checkbox"/> Married	<input type="checkbox"/> Single <input type="checkbox"/> Widow/Widower/Legally Separated <input type="checkbox"/> Divorced	PROFESSION/OCCUPATION/BUSINESS		TAXABLE AMOUNT	COMMUNITY TAX DUE
A. BASIC COMMUNITY TAX (P5.00) Voluntary or Exempted (P1.00)					P 1
B. ADDITIONAL COMMUNITY TAX (tax not to exceed P5,000.00)					
1. GROSS RECEIPTS OR EARNINGS DERIVED FROM BUSINESS DURING THE PRECEDING YEAR : P1.00 for every P1,000.00					
2. SALARIES OR GROSS RECEIPT OR EARNINGS DERIVED FROM EXERCISE OF PROFESSION OR PURSUIT OF ANY OCCUPATION : P1.00 for every P1,000					
3. INCOME FROM REAL PROPERTY : P1.00 for every P1,000					
Right Thumb Print	TAXPAYER'S SIGNATURE	TOTAL		P 1	
		INTEREST			
		TOTAL AMOUNT PAID		P 1	
MUNICIPAL CITY TREASURER		IN WORDS: one peso only			

DEED OF SALE WITH TRANSFER OF RIGHTS

KNOW ALL MEN BY THESE PRESENTS:

This INSTRUMENT, made and executed by and between:

ELSA ENOJAS JUNIO, of legal age, Filipino, widow to Antonio Junio (now deceased), and residence and postal address at Barangay Poblacion, Roxas, Palawan,

JOYLENE E. JUNIO-FOSTER, JOHN ANTHONY E. JUNIO & JAY ALAN E. JUNIO, all of legal ages, Filipino, married/single and residence and postal address at Barangay Poblacion, Roxas, Palawan (the heirs of Antonio Junio), being represented by JOSE LUIS E. JUNIO, also of legal age, Filipino, married/single and residence and postal address at Barangay Poblacion, Roxas, Palawan, per Special Power of Attorney respectively executed on 7 July 2010 and 18 June 2010, before Cipriano G. Robiclos III, notary public, and noted in his Notarial Register as Doc. No. 73, Page No. 15, Book No. XXVIII, Series of 2010, Doc. No. 362, Page No. 73, Book No. XXVII, Series of 2010, & Doc. No. 363, Page No. 73, Book No. XXVII, Series of 2010, hereinafter known as the VENDOR, - and -

HILDA C. LAGAN, of legal age, Filipino, married to Silverio C. Lagan and with residence and postal address at Barangay IV, Roxas, Palawan hereinafter known as the VENDEE,

WITNESSETH:

That the VENDOR is the lawful owner of that certain parcel of land, being the heirs of Antonio Junio (now deceased), embraced in Tax Declaration No. 20-004-0909, PIN: 066-20-004-19-008 and the said property is situated at Barangay IV, Roxas, Palawan, containing an area of SIX HUNDRED (600) SQUARE METERS, which is recorded in the name of the said Elsa Enojas Junio, particularly described as follows:

"Tax Declaration No. 20-004-0909

Containing an area of SIX HUNDRED (600) SQUARE METERS. Bounded on the North by: ALN 003; on the East by: ALN 007; on the South by: ALN 045; and on the West by: ALN 002."

That FOR AND IN CONSIDERATION of the sum of SIX HUNDRED THOUSAND (Php600,000.00) PESOS, Philippine Currency, in hand paid by the VENDEE unto the VENDOR, the latter by these presents do hereby SELL, CEDE, TRANSFER, and CONVEY by way of absolute sale unto the VENDEE, her heirs and assigns, and further WAIVE and RELINQUISH all their rights and interest, on the above-described parcel of land, together with all improvements found thereon to the said VENDEE.

That the VENDOR hereby warrants unto the said VENDEE full title and ownership over the said property, free from all liens and encumbrances.

IN WITNESS WHEREOF, both parties have hereunto set their hands this 22nd day of November 2016 at Roxas, Palawan, Philippines.

JAY ALAN E. JUNIO
Vendor

JOHN ANTHONY E. JUNIO
Vendor

JOYLENE E. JUNIO-FOSTER
Vendor

JOSE LUIS E. JUNIO
(Attorney-in-fact)
Driver Lic. No. NQ1/01 127253
Valid until 2018-09-17

ELSA ENOJAS JUNIO
Vendor
Senior Cit. ID No. 70351
09/20/2016/Paranaque City

TAX DECLARATION OF REAL PROPERTYT.D. No.: **18-20-004-2044**Property Identification No.: **066-20-004-19-008**Owner: **HILDA C. LAGAN Married to Silverio C. Lagan**

TIN: _____

Address: **BARANGAY IV, ROXAS, PALAWAN**

Telephone No.: _____

Administrator/Beneficial User: _____

TIN: _____

Address: _____

Telephone No.: _____

Location of Property: _____

BARANGAY IV**ROXAS, PALAWAN**

(Number and Street)

(Barangay/District)

(Municipality & Province)

OCT/TCT/CLOA No. _____

Survey No. **PLS-232**

CCT: _____

Lot No. **104 (PART)**

Date: _____

Block No. _____

Boundaries: North: **ALN 003**South: **ROAD**East: **ALN 045 (ROAD)**West: **ALN 009****KIND OF PROPERTY ASSESSED:****LAND****MACHINERY****BUILDING**

Brief Description: _____

No. of Storeys: _____

Others: _____

Brief Description: _____

Specify: _____

Classification	Area	Unit Value	Market Value	Actual Use	Assessment Level	Assessed Value	Taxability
RESIDENTIAL (R-1)	600.00 sq.m	850 Php	510,000.00	RESIDENTIAL	10 % Php	51,000.00	TAXABLE
Total	600.00 sq.m	Php	510,000.00			Php 51,000.00	
Total Assessed Value FIFTY-ONE THOUSAND PESOS							

Taxable ☒Exempt ☐

(Amount in Words)

Effectivity of Assessment/Reassessment: **2021**
YEAR

Approved by: _____

EUVICA M. COLBE, REA**12/29/2020****PROVINCIAL ASSESSOR**

Date

This declaration cancels TD No. **18-20-004-1128**Previous A.V. Php. **51,000.00**Previous PIN: **066-20-004-19-008**Previous Owner: **ELSA JUNIO**Previous Area: **600 sq.m.****Memoranda:**

TRANSFERRED PER DULY NOTARIZED DEED OF SALE WITH TRANSFER OF RIGHTS EXECUTED ON NOVEMBER 22, 2016, CENRO CERTIFICATION (A & D) ISSUED ON NOVEMBER 16, 2020 AND PER SUBMITTED FAAS. TAXES PAID UP TO 2020 PER ATTACHED CERTIFICATE OF REALTY TAX CLEARANCE. SWORN STATEMENT FILED. TRANSFER TAX: P3,000.00, O.R. NO. 5627090, ISSUED ON 01/30/2020 AT ROXAS, PALAWAN.

Note: This declaration is for real property taxation purposes only and the valuation indicated herein are based on the schedule of unit market values prepared for the purpose and duly enacted into an Ordinance by the Sangguniang Panlalawigan under Ordinance No. 1914-2018 dated March 26, 2018. It does not and cannot by itself alone confer any ownership or legal title to the property.

SWORN STATEMENT No.:**SWORN STATEMENT Date: 02-13-2020**

Republic of the Philippines.
Department of Environment and Natural Resources
COMMUNITY ENVIRONMENT AND NATURAL RESOURCES
Roxas, Palawan

Subject: Survey Authority for tract
Of Public Land in Brgy. _____

_____ Date

S.A. # _____ - _____

ALDRIC G. ECO
New Agutaya, San Vicente, Palawan

Sir/Madam:

Pursuant to DENR Adm. Order No. 38 and upon evaluation of the request of _____ claimants of the above described tract of Public Land, to avail of your services, authority is hereby granted to you to execute the survey thereof subject to the relevant provisions of the Manual for Land Surveys in the Philippines as amended and to the conditions stated at the back hereof.

Violations of the aforesaid conditions shall invalidate this authority, and damages that may result there from shall be your sole liability and professional responsibility.

Very truly yours,

For and by Authority of the Secretary of DENR

Accepted: _____

(4.) 
ALDRIC ECO
Geodetic Engineer

(3.) **PABLO L. CRUZ**
CENR Officer

License No. 5925729 Date:01/28/2022
PRC No. 8171 Date:10/17/07

Above stated request confirmed:

Issuance of Survey Order recommended:

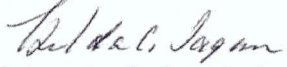
(1.) 
HILDA C. LAGAN
Claimant
BGV. IV ROXAS, PALAWAN
09085155055

(2.) **ARNOLD V. GONZALES**
Signature/Name
Land Management Inspector

Ref. _____
Cad Cost of P _____

Ref. Insp. /Invest./Report
Dated _____

Under O.R. No. _____
Dated _____

NOTE:

For this Survey Authority to be valid, the Four (4) required signature must be presented.



Republic of the Philippines
Department of Environment and Natural Resources
MIMAROPA Region
COMMUNITY ENVIRONMENT AND NATURAL RESOURCES OFFICE
Bgy. III, Poblacion, Roxas, Palawan
Contact No. 09171606578
Email Address: cenroroxaspalawan@denr.gov.ph

DOCUMENT ACTION INFORMATION FORM

Doc. Ref. No.: 2023-0486

Date and Time received:

01/31/2023 4:17:12 pm

From: HILDA C. LAGAN

Document Type: Letters

BGY.IV, ROXAS PAL.

Subject: REQUEST FOR THE ISSUANCE OF SURVEY AUTHORITY FOR LOT NO. 104 (PART) PLS 232 IN BGY.IV, ROXAS PAL

Attachment(s): BGY. CERT, WAIVER, TAX DEC

Earmarked As:

Date: 01/31/23	From: HCL	To: MRG/ LML/ Arula
Action Recommended/Required: <input checked="" type="checkbox"/> For Action <input type="checkbox"/> For Approval <input type="checkbox"/> For Disbursement/ Payment <input type="checkbox"/> For Official Release <input type="checkbox"/> For Signature <input type="checkbox"/> For Review/ Recommendation <input type="checkbox"/> For Information, Record and File <input type="checkbox"/> For Indorsement to concerned Party(ies) <input type="checkbox"/> Return to Payee/Sender		Processing Time: <input type="checkbox"/> Urgent (w/in the day) <input checked="" type="checkbox"/> Priority (w/in 3 days) <input type="checkbox"/> Complex w/in 7 days w/in 20 days or shorter W/in ___ days or shorter
Other Instruction(s): 		
Date:	From:	To:
Action Recommended/Required: <input type="checkbox"/> For Action <input type="checkbox"/> For Approval <input type="checkbox"/> For Disbursement/ Payment <input type="checkbox"/> For Official Release <input type="checkbox"/> For Signature <input type="checkbox"/> For Review/ Recommendation <input type="checkbox"/> For Information, Record and File <input type="checkbox"/> For Indorsement to concerned Party(ies) <input type="checkbox"/> Return to Payee/Sender		Processing Time: <input type="checkbox"/> Urgent (w/in the day) <input type="checkbox"/> Priority (w/in 3 days) <input type="checkbox"/> Complex w/in 7 days w/in 20 days or shorter W/in ___ days or shorter
Other Instruction(s):		
Date:	From:	To:
Action Recommended/Required: <input type="checkbox"/> For Action <input type="checkbox"/> For Approval <input type="checkbox"/> For Disbursement/ Payment <input type="checkbox"/> For Official Release <input type="checkbox"/> For Signature <input type="checkbox"/> For Review/ Recommendation <input type="checkbox"/> For Information, Record and File <input type="checkbox"/> For Indorsement to concerned Party(ies) <input type="checkbox"/> Return to Payee/Sender		Processing Time: <input type="checkbox"/> Urgent (w/in the day) <input type="checkbox"/> Priority (w/in 3 days) <input type="checkbox"/> Complex w/in 7 days w/in 20 days or shorter W/in ___ days or shorter
Other Instruction(s):		
Date:	From:	To:
Action Recommended/Required: <input type="checkbox"/> For Action <input type="checkbox"/> For Approval <input type="checkbox"/> For Disbursement/ Payment <input type="checkbox"/> For Official Release <input type="checkbox"/> For Signature <input type="checkbox"/> For Review/ Recommendation <input type="checkbox"/> For Information, Record and File <input type="checkbox"/> For Indorsement to concerned Party(ies) <input type="checkbox"/> Return to Payee/Sender		Processing Time: <input type="checkbox"/> Urgent (w/in the day) <input type="checkbox"/> Priority (w/in 3 days) <input type="checkbox"/> Complex w/in 7 days w/in 20 days or shorter W/in ___ days or shorter
Other Instruction(s):		

Printed on 01/31/2023 4:19:37pm Received at: INFORMATION DESK/R Received by: BALTAR, APRIL

1-31-23.
Date

The Community Environment and
Natural Resources Officer
Roxas, Palawan

Sir/Ma'am:

May I have the honor to request the following:

() Ocular inspection/investigation

() GPS Reading

Lot No.: [REDACTED]

Location: [REDACTED]

() Certification

() Land classification Status

() Land disposition status

Lot No. 104 (Part)

Location Brgy 14, Roxas Pal

Purpose: For Survey Authority

Very truly yours,

Hilda P. Sagan
HILDA C. LAGAN

Signature over Printed Name

Contact No.: 09085155055

Address: Brgy 14, Roxas Palawan

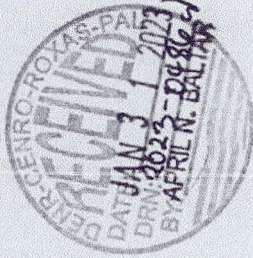

() Certified photo copy/copies

() Technical Description/Cad Map/Sketch Plan

Lot No.:

() Location:

() Others (please specify)

Requirements/Attachments
☒ Barangay Certification
☒ Waiver of Rights/Deed of Sale/Donation
☒ Tax Declaration
☒ SPA
☒ Others