

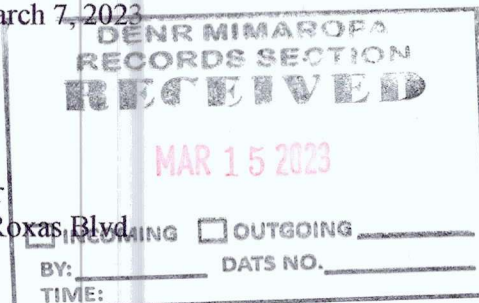

Republic of the Philippines
Department of Environment and Natural Resources
MIMAROPA REGION
PROVINCIAL ENVIRONMENT AND NATURAL RESOURCES OFFICE
Bgy. Sta. Monica, Puerto Princesa City, Palawan
Telfax No. (048) 434-8791
Email Add: penropalawan@denr.gov.ph

March 7, 2023



MEMORANDUM

FOR : The Regional Executive Director
1515 DENR By the Bay Bldg., Roxas Blvd.
Barangay 668, Ermita, Manila

ATTENTION : The OIC-Assistant Regional Director for Technical Services
The OIC-Chief, Surveys and Mapping Division

FROM : The Provincial Environment and
Natural Resources Officer

SUBJECT : **REQUEST FOR LC CONFIRMATION ON LOT 4616,
CAD.860-D IN BRGY. PORT BARTON, SAN VICENTE,
PALAWAN**

Forwarded is the Memorandum of CENRO Roxas, Palawan dated December 2, 2023 requesting for confirmation of land classification status for the issuance of patent.

Further, this Office evaluated the findings of the CENRO as to its land classification status aided with sketch map in compliance to DMC No. 2019-10 dated December 11, 2019 and same was projected which falls within Alienable and Disposable land.

For information, record and consideration.

FELIZARDO B. CAYATOC

Reference No: 2023-1770
TSD/RPS/SMU

**DENR-PALAWAN
PENRO-RECORDS
RELEASED**
By 
Date: 10 MAR 2023 23-622



Republic of the Philippines
Department of Environment and Natural Resources
MIMAROPA Region
PROVINCIAL ENVIRONMENT AND NATURAL RESOURCES OFFICE
Province of Palawan
Bgy. Sta. Monica, Puerto Princesa City
Telfax No. (048) 434-8791; Email Add: penropalawan@denr.gov.ph

CERTIFICATION

TO WHOM IT MAY CONCERN:

THIS IS TO CERTIFY that based on available records, the tract of land in Barangay Port Barton, Municipality of San Vicente, Province of Palawan, containing an area (1,647) Square Meters, identified as **Lot No. 4616, CAD 860-D** as applied by **Imelda Bulawan** was verified falls within **ALIENABLE AND DISPOSABLE LAND** per LC Map No. 2598, Project No. I-T, Block XX under FAO 4-1116 certified on July 1, 1966

Issued this 6th day of March, 2023 at DENR PENRO, Sta. Monica, Puerto Princesa City.

Checked/Verified by:

DONNA BELLE E. LUENGO
Engr. II/Chief, Surveys and Mapping Unit

FELIZARDO B. CAYATOC
PENRO

Note:
Reference used was based on the rectified LC map
provided and projected by the Regional Office

DENR-PALAWAN
PENRO-RECORDS
RELEASED
By 
Date: 10 MAR 2023 23-622



Republic of the Philippines
Department of Environment and Natural Resources
MIMAROPA Region
PROVINCIAL ENVIRONMENT AND NATURAL RESOURCES OFFICE
Province of Palawan
Bgy. Sta. Monica, Puerto Princesa City
Telfax No. (048) 434-8791; Email Add: penropalawan@denr.gov.ph

CERTIFICATION

TO WHOM IT MAY CONCERN:

THIS IS TO CERTIFY that based on available records, the tract of land in Barangay Port Barton, Municipality of San Vicente, Province of Palawan, containing an area (1,647) Square Meters, identified as **Lot No. 4616, CAD 860-D** as applied by **Imelda Bulawan** was verified falls within **ALIENABLE AND DISPOSABLE LAND** per LC Map No. 2598, Project No. I-T, Block XX under FAO 4-1116 certified on July 1, 1966

Issued this 6th day of March, 2023 at DENR PENRO, Sta. Monica, Puerto Princesa City.

Checked/Verified by:

DONNA BELLE E. LUENGO
Engr. II/Chief, Surveys and Mapping Unit

FELIZARDO B. CAYATOC
PENRO

Note:
Reference used was based on the rectified LC map
provided and projected by the Regional Office

DENR-PALAWAN
PENRO-RECORDS
RELEASED
By _____
Date: 10 MAR 2023 *23-622*

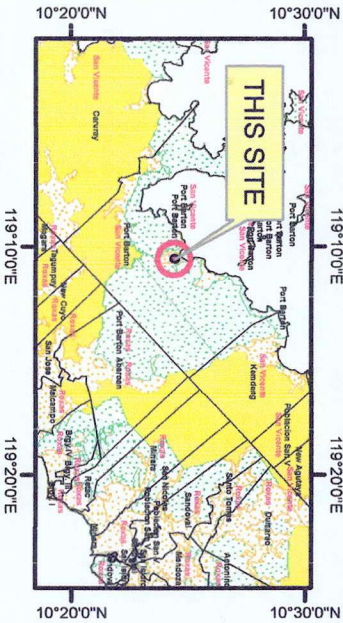
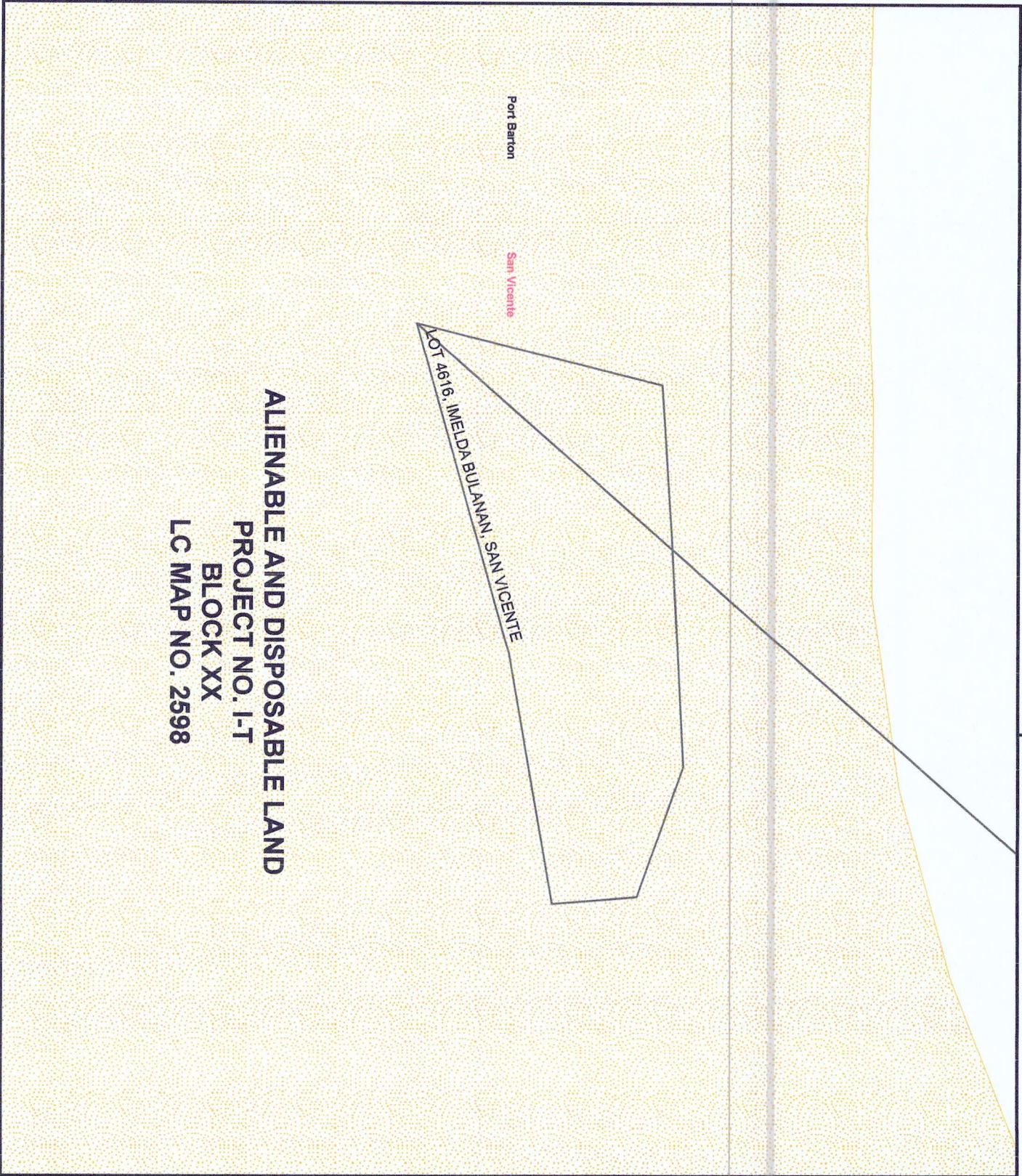

MAP SHOWING

THE RELATIVE LOCATION OF LOT 4616
FOR LC CERTIFICATION APPLIED BY
IMELDA BULANAN

Located at Brgy. Port Barton
Municipality of San Vicente
Province of Palawan

Coordinate System: UTM
Projection: Transverse Mercator
Datum: Luzon 1911

SCALE 1:2000

Legend

LC STATUS

 Alienable & Disposable

 No Data

 Communal Forestland

 UPF



Republic of the Philippines
Department of Environment and Natural Resources
MIMAROPA Region
COMMUNITY ENVIRONMENT AND NATURAL RESOURCES OFFICE
Barangay III, Roxas, Palawan
Tel. No. 717-0892
Email address: cenroroxaspalawan@denr.gov.ph

02 December 2022

MEMORANDUM

FOR : The PENR Officer
FROM : The CENR Officer
SUBJECT : REQUEST FOR LC CONFIRMATION ON LOT 4616,
CAD. 860-D IN PORT BARTON, SAN VICENTE, PALAWAN

This is to respectfully request for confirmation of LC findings pursuant to DMC 2019-10 involving Lot 4616, Cad. 860-D in Bgy. Port Barton, San Vicente, Palawan as applied for patent by Ms. Imelda C. Bulawan.

Attached for ready reference is its duly accomplished BL Form No. V-37 and its corresponding LC-overlaid cadastral map.

For the CENR Officer:

RONNIE P. LILANG
Chief, Regulation and Permitting Section
Office-In-Charge

Copy:
The Applicant
File

**DENR PENR
PALAWAN RECORDS
RECEIVED**

BY:
DATE: 03.01.2023 CN 23.1770

**DENR-CENRO ROXAS
RELEASED**

DATE: FEB 28 2023

BY:
DOC. NO. 2023-02-0324



Republic of the Philippines
Department of Environment and Natural Resources
MIMAROPA Region
COMMUNITY ENVIRONMENT AND NATURAL RESOURCES OFFICE
Barangay Poblacion 3, Roxas, Palawan
Tel. No. 717-0892
Email address: cenroroxaspalawan@denr.gov.ph

CERTIFICATION

TO WHOM IT MAY CONCERN:

THIS IS TO CERTIFY that based on available records in our Office, the tract of land in Barangay Port Barton, Municipality of San Vicente, Province of Palawan containing an area of One Thousand Six Hundred Forty-seven (1647) square meters, identified as Lot 4616 of Cad. 860-D and applied for Patent by Imelda C. Bulawan was verified to be within the agricultural (alienable/disposable) lands per LC Map No. 2598 under FAO No. 4-1116, Project No. 1-T/Block XX, certified on 01 July 1966.

Issued this 02nd day of December 2022 at CENRO, Roxas, Palawan.

Checked by:

RONNIE P. LULANG
Chief, Regulation & Permitting Section

APPROVED:

PABLO L. CRUZ
CENR Officer

copy: file

101 4016, Cad. 800 P or
applied for patent by
IMPIDA O. BULWAKA

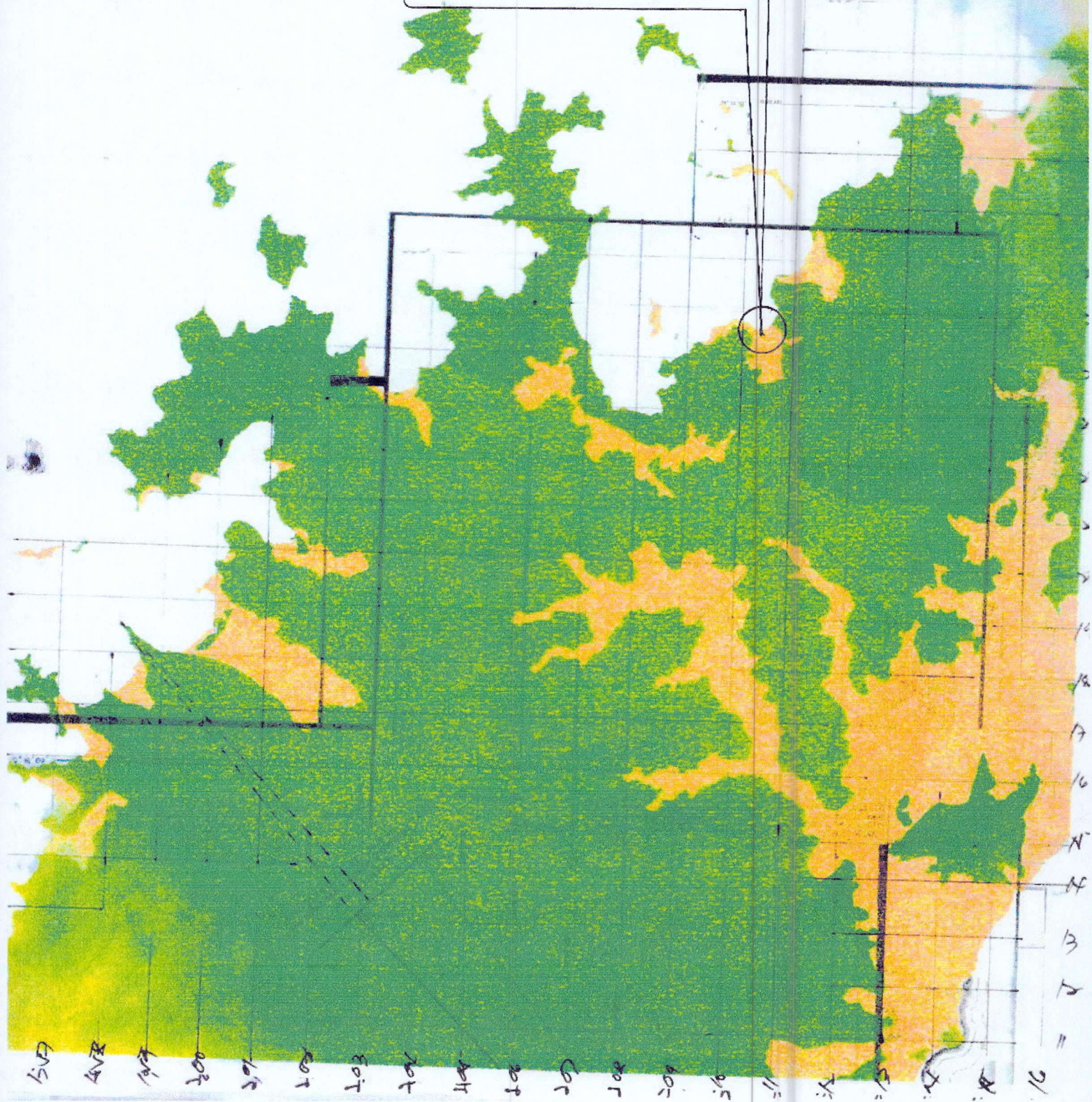



Republic of the Philippines
Department of Environment and Natural Resources
Region IV
COMMUNITY ENVIRONMENT AND NATURAL RESOURCES OFFICE
Roxas, Palawan

FPA No. 00579 Applicant: IMELDA C. BULAWAN
Lot No. 4616, Cal. 800-D Rent to Lot No. _____
Portion of Lot No. _____ Surveyed for: ESTRON VALDEZ
Date of Original Survey: _____ Surveyed by: MARIANO V. FLORES
Area (sq. m.) 1647 Date of Survey: 06 JUL - 17 AUG 1988
Location: Port Barton, San Vicente, Palawan Date Approved: 10 DEC 1991

TECHNICAL DESCRIPTION

TIE LINE: S 41-35 W, 16, 376.54 M. FROM RUM NO 1, Cal. 800-D & GR. 1,
thence,

LINE	BEARINGS	DISTANCE	LINE	BEARINGS	DISTANCE
1-2	N 41-03 E	33.28			
2	N 86-41 E	19.75			
3	N 87-07 E	30.87			
4	S 70-42 E	18.27			
5	S 04-40 E	11.17			
6	S 80-11 W	33.62			
7-1	S 74-21 W	45.38			

SKETCH
at 4432

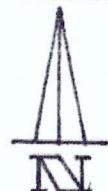

SCALE 1: 1000
BEARINGS: 1000

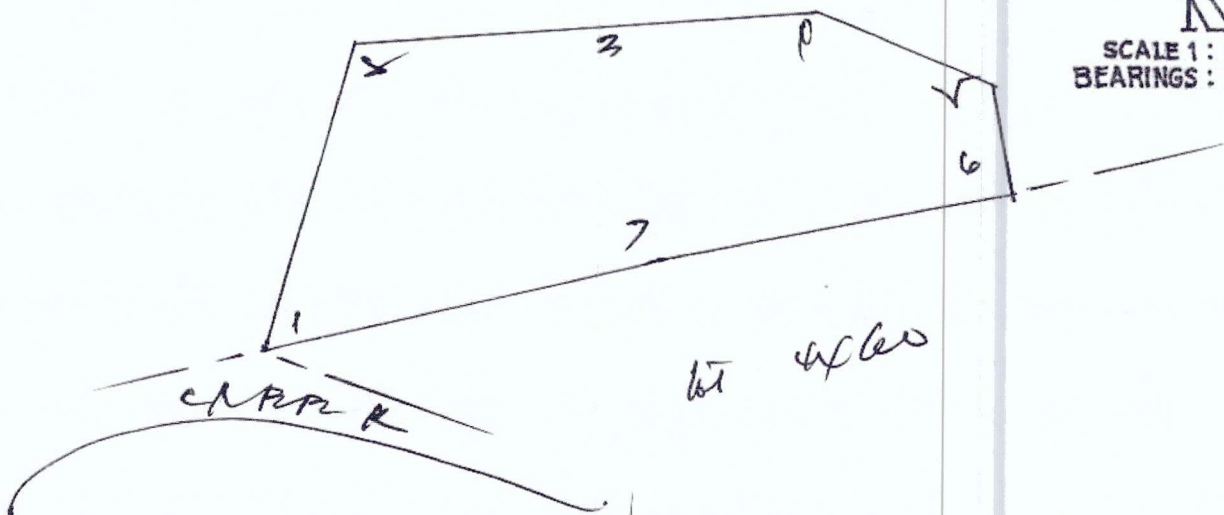

T.D. Researched by: _____

T.D. Sketched by: _____

T.D. Checked by: _____

Date: _____

Date: _____

Date: _____