



Republic of the Philippines  
**Department of Environment and Natural Resources**  
MIMAROPA REGION  
PROVINCIAL ENVIRONMENT AND NATURAL RESOURCES OFFICE  
Bgy. Sta. Monica, Puerto Princesa City, Palawan  
Telfax No. (048) 434-8791  
Email Add: [penropalawan@denr.gov.ph](mailto:penropalawan@denr.gov.ph)



May 5, 2023

**MEMORANDUM**

**FOR** : The Regional Executive Director  
1515 DENR By the Bay Bldg., Roxas Blvd.  
Barangay 668, Ermita, Manila

**ATTENTION** : The OIC-Assistant Regional Director for Technical Services  
The Chief, Surveys and Mapping Division

**FROM** : The Provincial of Environment and  
Natural Resources Officer

**SUBJECT** : **REQUEST FOR INDEPTH RE-VERIFICATION AND RE-  
CONFIRMATION OF LAND CLASSIFICATION  
STATUS RE: CLEARANCE TO ISSUE SURVEY  
AUTHORITY**

Forwarded is the memorandum of CENRO Puerto Princesa City dated April 17, 2023 requesting for in-depth re-verification on the issued clearance for survey authority for Lot 563, Cad.799-D to segregate the portion of Alienable and Disposable land.

Relative thereto, the CENRO is reiterating its findings that the whole lot is Alienable and Disposable land based on manual plotting overlaid in hard copy land classification map.

Attached are maps and documents pertaining to the projection and evaluation of the above subject lot.

For information, record and consideration.

  
**FELIZARDO B. CAYATOC**

Reference No: 2023-3841  
TSD/RPS/SMU

**DENR-PALAWAN  
PENRO-RECORDS  
RELEASED**  
By   
Date: **18 MAY 2023** CN 23-1261



Republic of the Philippines  
Department of Environment and Natural Resources  
MIMAROPA Region  
**PROVINCIAL ENVIRONMENT AND NATURAL RESOURCES OFFICE**  
PENRO Road, Sta. Monica, Puerto Princesa City, Palawan  
Contact No. (048) 433-5638/(048) 434-8791  
Email Address: penropalawan@denr.gov.ph

### DOCUMENT ACTION INFORMATION FORM

Doc. Ref. No.: 2023-3841

Date and Time received:

04/27/2023 08:04:02 am

From: PEDRO A. VELASCO

Document Type: Memorandums

CENRO PPC, PALAWAN

Subject: 921 REQUEST FOR INDEPTH RE-VERIFICATION AND RE-CONFIRMATION OF LAND CLASSIFICATION STATUS RE CLEARANCE RO ISSUE SURVEY AUTHORITY

Attachment(s): MEMO DATED 02-27-2023, MAPS AND PERT DOCS

Earmarked As :

Date: 4/27/23	From: TSD	To: Chief RPS
<b>Action Recommended/Required:</b> <input checked="" type="checkbox"/> For Action <input type="checkbox"/> For Approval <input type="checkbox"/> For Disbursement/ Payment <input type="checkbox"/> For Official Release <input type="checkbox"/> For Signature <input type="checkbox"/> For Review/ Recommendation <input type="checkbox"/> For Information, Record and File <input type="checkbox"/> For Indorsement to concerned Party(ies) <input type="checkbox"/> Return to Payee/Sender		<b>Processing Time:</b> <input type="checkbox"/> Urgent (w/in the day) <input type="checkbox"/> Priority (w/in 3 days) <input type="checkbox"/> Complex w/in 7 days w/in 20 days or shorter W/in ___ days or shorter
<b>Other Instruction(s):</b> PS - take forward action on the matter (and/or) lets refer or indorse to R.O.? ry		
Date: 4/27/23	From: Chief RPS	To: Engr. Danny
<b>Action Recommended/Required:</b> <input type="checkbox"/> For Action <input type="checkbox"/> For Approval <input type="checkbox"/> For Disbursement/ Payment <input type="checkbox"/> For Official Release <input type="checkbox"/> For Signature <input type="checkbox"/> For Review/ Recommendation <input type="checkbox"/> For Information, Record and File <input type="checkbox"/> For Indorsement to concerned Party(ies) <input type="checkbox"/> Return to Payee/Sender		<b>Processing Time:</b> <input type="checkbox"/> Urgent (w/in the day) <input type="checkbox"/> Priority (w/in 3 days) <input type="checkbox"/> Complex w/in 7 days w/in 20 days or shorter W/in ___ days or shorter
<b>Other Instruction(s):</b> for protection / return to owner if the findings is also the same with the findings of the one, BRO-13		
Date:	From:	To:
<b>Action Recommended/Required:</b> <input type="checkbox"/> For Action <input type="checkbox"/> For Approval <input type="checkbox"/> For Disbursement/ Payment <input type="checkbox"/> For Official Release <input type="checkbox"/> For Signature <input type="checkbox"/> For Review/ Recommendation <input type="checkbox"/> For Information, Record and File <input type="checkbox"/> For Indorsement to concerned Party(ies) <input type="checkbox"/> Return to Payee/Sender		<b>Processing Time:</b> <input type="checkbox"/> Urgent (w/in the day) <input type="checkbox"/> Priority (w/in 3 days) <input type="checkbox"/> Complex w/in 7 days w/in 20 days or shorter W/in ___ days or shorter
<b>Other Instruction(s):</b>		
Date:	From:	To:
<b>Action Recommended/Required:</b> <input type="checkbox"/> For Action <input type="checkbox"/> For Approval <input type="checkbox"/> For Disbursement/ Payment <input type="checkbox"/> For Official Release <input type="checkbox"/> For Signature <input type="checkbox"/> For Review/ Recommendation <input type="checkbox"/> For Information, Record and File <input type="checkbox"/> For Indorsement to concerned Party(ies) <input type="checkbox"/> Return to Payee/Sender		<b>Processing Time:</b> <input type="checkbox"/> Urgent (w/in the day) <input type="checkbox"/> Priority (w/in 3 days) <input type="checkbox"/> Complex w/in 7 days w/in 20 days or shorter W/in ___ days or shorter
<b>Other Instruction(s):</b>		





Republic of the Philippines  
DEPARTMENT OF ENVIRONMENT AND NATURAL RESOURCES  
**COMMUNITY ENVIRONMENT AND NATURAL RESOURCES**  
PUERTO PRINCESA CITY  
South National Highway, Bgy. Sta. Monica, Puerto Princesa City  
TEL Fax No. (048) 717-0702  
Email Address: cenropuertoprincesa@denr.gov.ph

TSD

April 17, 2023

**MEMORANDUM**

FOR : The Regional Executive Director  
DENR-MIMAROPA Region  
L & S Building, Roxas Blvd.  
Ermita, Manila

THRU : The Provincial Environment  
and Natural Resources Officer  
Puerto Princesa City

FROM : The Community Environment  
and Natural Resources Officer  
Puerto Princesa City

SUBJECT : **REQUEST FOR INDEPTH RE-VERIFICATION AND  
RE-CONFIRMATION OF LAND CLASSIFICATION  
STATUS RE: CLEARANCE TO ISSUE SURVEY AUTHORITY**

**DENR PENRO  
PALAWAN RECORDS  
RECEIVED**

BY:   
DATE: 04-27-2023 CN 33-3841

This has reference to the Memorandum dated February 27, 2023 from the OIC-Assistant Regional Executive Director giving this Office Clearance to Issue Survey Authority to segregate the portion of Alienable and Disposable Land from Unclassified Public Forest of Lot No. 563, Cad 799-D identical to Lot No. 112, Pls-111 now occupied by the Department of Education Isaub Elementary School and Isaub National High School both located in Barangay Isaub, Aborlan, Palawan. Copy of the said Memorandum and that Office projection are hereto attached.

Relative thereto, this Office is requesting an indepth re-verification of the above-findings considering that per projection/plotting by the representatives of this Office the whole lot is within AGRICULTURAL LAND (ALIENABLE AND DISPOABLE AREA as per Land Classification Map No. 748, Project 10, Block I certified on July 10, 1928.

Likewise, attached herewith are the following:

1. Map showing the area of Lot No. 112, Pls-111 prepared by CENRO GIS Unit (re-verification of the area indicating that **there is an error** between GIS generated and Manual Plotting).
2. Manual Plotting prepared by the representative of this Office. 7
3. V-37 of Lot 112, Pls-111
4. Photocopy of Certification dated January 11, 2022 that the said lot is within A and D.
5. Pictures from google earth (street view map) dated May 14, 2018

For information, evaluation and re-consideration.

  
**PEDRO A. VELASCO**

**Copy Furnished:**

1. **Ms. Elsie T. Barrios**  
Provincial Schools Division Superintendent  
PEO Road, Bgy. Bancao-Bancao, PPC
2. **Ms. Arlene V. Manalo**  
Principal I  
Isaub National High School  
Bgy. Isaub, Aborlan Palawan
3. **Ms. Eden D. Dimapilis**  
Principal II  
Isaub Elementary School  
Bgy. Isaub, Aborlan, Palawan

RPS/eba

DENR MIMAROPA REGION  
CENRO PUERTO PRINCESA  
**RECEIVED**  
NO 921  
DATE: 4-19-23  
BY: 



Republic of the Philippines  
Department of Environment and Natural Resources  
**MIMAROPA Region**

## MEMORANDUM

**TO :** THE PENR OFFICER  
Palawan

**ATTENTION :** THE CENR OFFICER  
Puerto Princesa City, Palawan

**FROM :** THE OIC, ASSISTANT REGIONAL DIRECTOR FOR  
TECHNICAL SERVICES

**SUBJECT :** CLEARANCE TO ISSUE SURVEY AUTHORITY  
(P-2023-102902)

**DATE :** FEB 17 2023

This refers to your Memorandum dated January 24, 2023 forwarding the requirements from CENRO Puerto Princesa City, Palawan which are needed for the issuance of Memorandum of Clearance to Issue Survey Authority for Lot No. 563, Cad-799-D (identical to Lot No. 112, Pls-111), located in Brgy. Isaub, Aborlan, Palawan pursuant to DENR Memorandum Circular No. 2019-10 dated December 11, 2019.

Relative hereto, this Office is forwarding you the approved Memorandum of **Clearance to Issue Survey Authority** to segregate the **portion** of a lot **Alienable and Disposable Land** from the **Unclassified Public Forest**, in favor of Roger P. Capa, School Division Superintendent (DEPED).

For information.

Department of Environment  
and Natural Resources  
MIMAROPA Region



Doc ID: 102902

  
MAXIMO C. LANDRITO

Cc:

The Regional Executive Director

SMD/LESS/CKAA/2-13-23



118°35'30"E

118°35'40"E

118°35'50"E

ALIENABLE AND DISPOSABLE

PROJECT No. 1D

BLOCK 1

LC No. 748

563



MAP SHOWING

OF LOT 563 Cad-799-D Iden. to Lot

112, Pls111

Claimed by Roger P. Capa of Dept. of

Education

Situated at  
Barangay Isaub  
Municipality Aborlan  
Province of Palawan

Projection: UTM,  
Area 74 926 sq.m

Legend



Barangay Boundary, Cad. No. 592

Land Classification Map\_PRS92

LC STATUS

Alienable & Disposable

Covered by Forest

Forested

No Data

Use



## REQUEST FOR ISSUANCE OF SCHOOL SITE SPECIAL PATENT

Entry No. \_\_\_\_\_  
Request No. \_\_\_\_\_

Name of School: Department of Education – Inagawan National High School

Location: Barangay Inagawan, Puerto Princesa City

Division of School Superintendent/  
Authorized Officer: Dr. Loida P. Adornado, CESO VI

Address: City DEPED Bldg., Ratols Road, Bgy. Sta. Monica, Puerto Princesa City

Contact No.: +639171241790 email: puertoprincesa@deped.gov.ph

Lot No.: Lot 1, Ccs-4B-000366-D

Area: 20,747 square meters

**DR. LOIDA P. ADORNADO, CESO VI**  
City Schools Superintendent  
Authorized Officer

Attachments:

\_\_\_\_\_  
Historical Background of possession/occupation  
\_\_\_\_\_  
Recent photographs with panoramic view and improvements  
\_\_\_\_\_  
Court certification of no pending land registration case

**SUBSCRIBED AND SWORN** to before me this \_\_\_\_\_ day of \_\_\_\_\_ 2023 at  
Puerto Princesa City.

**PEDRO A. VELASCO**  
OIC-CENRO



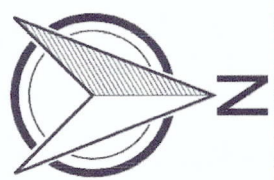
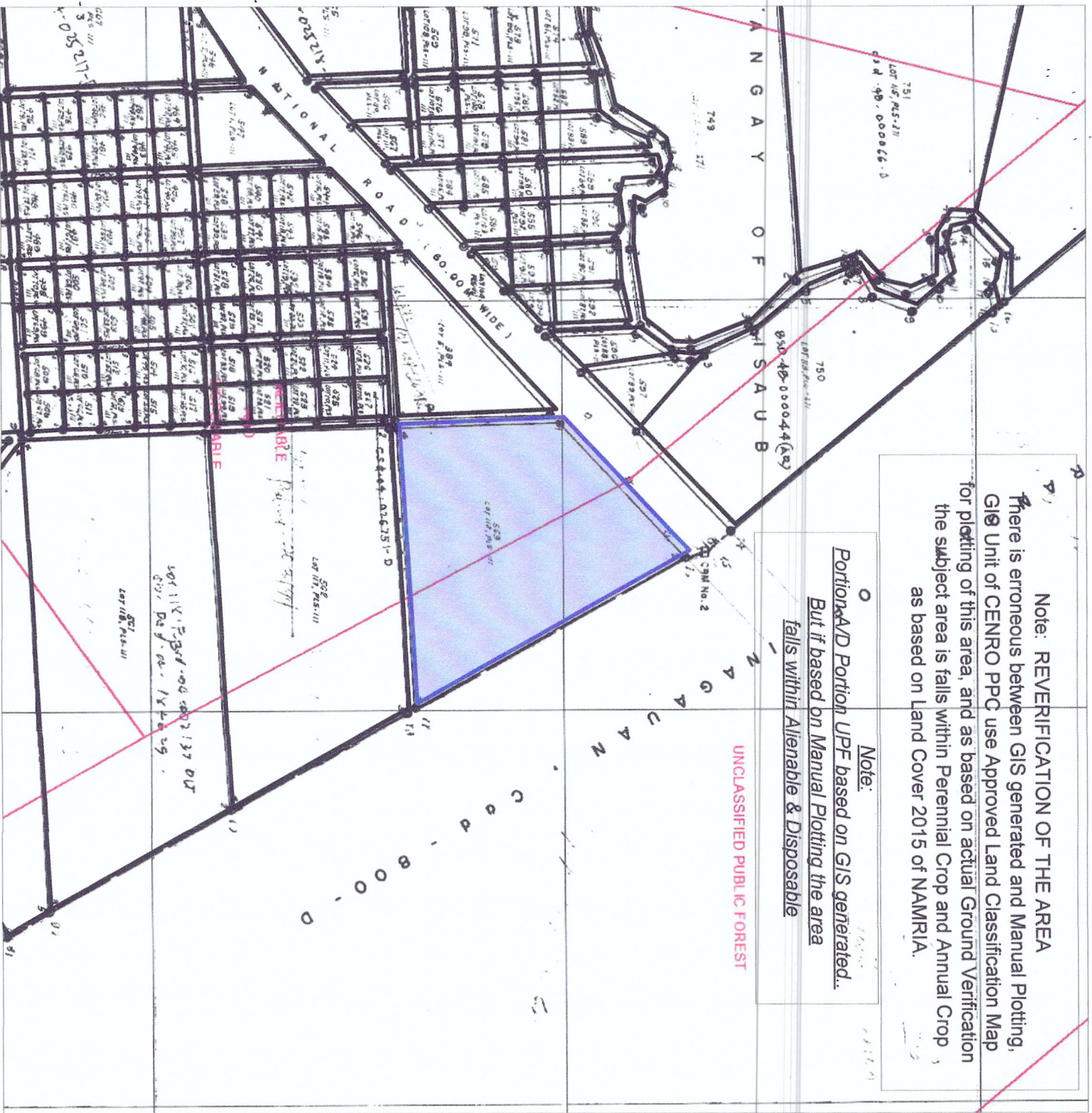

Map showing the Area of  
Lot Number. 112, PLS III  
Reverification of the Area

Located at

Barangay. Isaub  
Municipality of Aborlan  
Province of Palawan

**Area=74,9261 Square Meters**

0 >1 m

Scale:1:6800  
Philippines Zone I  
Luzon (Philippines excluding Mindanao)

Prepared by:

**JASON D. MONTIMOR**  
Forest Unit Head, GIS &  
Land Classification Verification

Attested by:

**PEDRO A. VELASCO**  
Development Management Officer IV  
OIC-CENRO

Note:  
This area is subject to survey in a future and  
this is GPS reading using Luzon Datum



Proclamation #97

Magnolia Sub  
Taganarog Elem. Sch

Scale  
1:20000

118-35-00

09-31-00

NATL HI-WAY

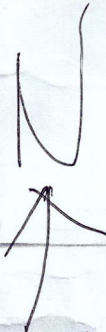

118-35-00

09-30-00

Taganarog Cr.

Taganarog

Isaub

BLOCK-I

ALIENABLE & DISPOSABLE

AREA 10,135,000 SQM

118-37





Republic of the Philippines  
Department of Environment and Natural Resources  
MIMAROPA Region  
**COMMUNITY ENVIRONMENT AND NATURAL RESOURCES OFFICE**

January 11, 2022

**CERTIFICATION**  
**(Status of Land Classification)**

*Annex C*

TO WHOM IT MAY CONCERN:

THIS IS TO CERTIFY that the tract of land identified as **Lot No. 563, Cad. 799-D identical to Lot No. 112, Pls-111** containing an area of 74,926 square meters located in Barangay Isaub, Aborlan, Palawan has been verified to be within **AGRICULTURAL LAND (ALIENABLE AND DISPOSABLE AREA)** per approved Land Classification Map No. 748, Project No. 10, Block-I, certified on July 10, 1928.

THIS IS TO FURTHER CERTIFY that the classification of the land stated above is still subject to confirmation by the DENR Regional Office pursuant to DMC No. 2019-10 dated December 11, 2019.

This certification is being issued upon the request of the Regulation and Permitting Section for whatever legal purpose it may serve.

Prepared and Projected by:

*Franklin P. Gadiano*  
**FRANKLIN P. GADIANO**  
Forest Technician I

Verified by:

*Jason D. Montimor*  
**JASON D. MONTIMOR**  
Forester I  
Unit Head, GIS  
& Land Classification Verification

Attested by:

*Felizardo B. Cayatoc*  
**FELIZARDO B. CAYATOC**  
OIC-CENRO

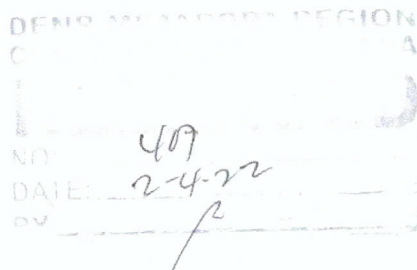

LC-DRN-2022

XACLETA SLITO  
April 1 - June 3, 1984  
Nov. 13, 1984

563

CAD-799-D

112 POK-111

74,926

Boy / Saub, Abarlan, Pal

N 38-49 E 9432.13 11. from BLLM#1 CAD-799-D  
Abartan Cadastre

1-2 N 47-12 E 323.24 M.  
 2-3 S 29-17 E 378.69  
 3-4 S 86-40 W 341.45  
 4-1 N 02-08 W 191.24

Alberta Catastre  
 P.S. Cyl Conc. Meas  
 15 X 60 cm's

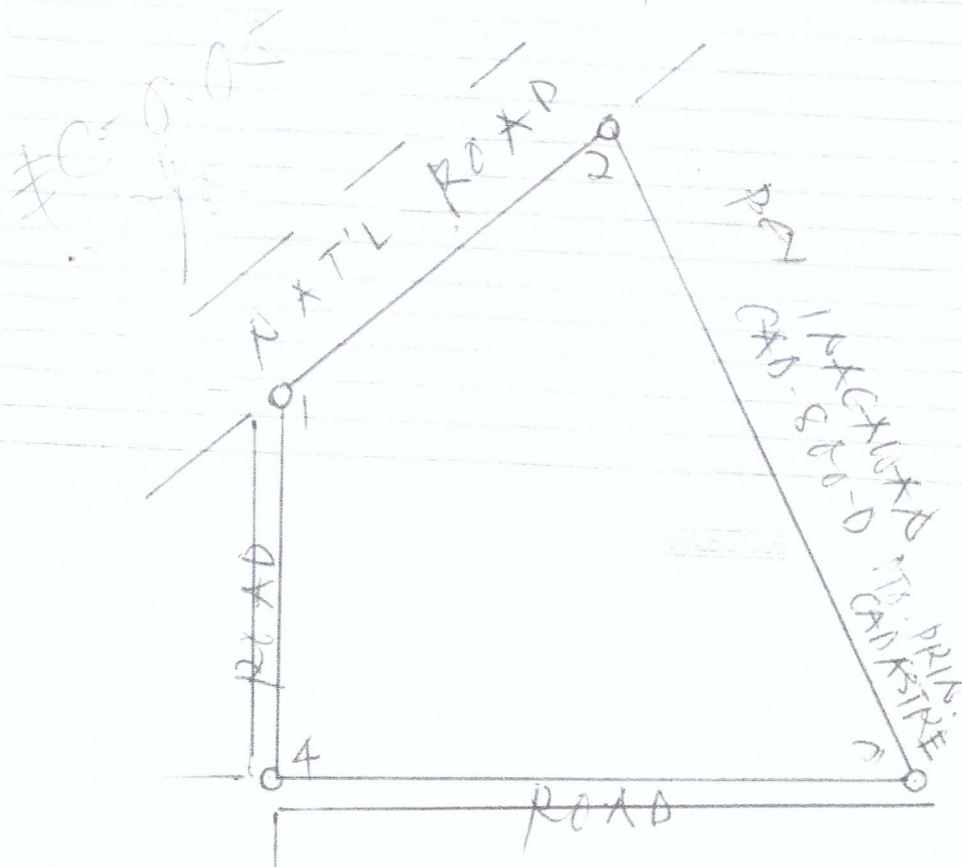

Scale 1:4280

R. V. MACALEX

✓ 01-78-72



# HIGH SCHOOL

Write a description for your map.

Legend





# HIGH SCHOOL

Write a description for your map.

Legend

