



Republic of the Philippines
Department of Environment and Natural Resources
MIMAROPA REGION
PROVINCIAL ENVIRONMENT AND NATURAL RESOURCES OFFICE
Bgy. Sta. Monica, Puerto Princesa City, Palawan
Telfax No. (048) 434-8791
Email Add: penropalawan@denr.gov.ph

| | |
|-----------------|--|
| DENR MIMAROPA | |
| RECORDS SECTION | |
| RECEIVED | |
| BY: | |
| DATE: | |
| TIME: | |

May 5, 2023

MEMORANDUM

FOR : The OIC-Assistant Regional Director for Technical Services

FROM : The Provincial of Environment and Natural Resources Officer

SUBJECT : **RESUBMISSION OF SURVEY AUTHORITY REQUEST OF RODOLFO PALMA**

Forwarded is the memorandum of CENRO Coron, Palawan dated March 1, 2023 resubmitting its request for clearance to issue survey authority for a parcel of land located at Barangay Quezon, Busuanga, Palawan.

Relatively, the said request was denied issuance of clearance since the subject area falls within Busuanga Pasture Reserve covered by SWO-04-000080.

However, the CENRO is requesting for consideration of the request since per memorandum dated January 25, 2023 of DENR Forest Management Bureau, they officially adopted the boundary surveyed on 2015 for the management and protection of the pasture reserve and the subject area of request is outside the BPR boundary.

Attached are map projections of the official BPR boundary and the area requested for clearance to issue for survey authority for reference.

For information, record and consideration.

For the PENRO:

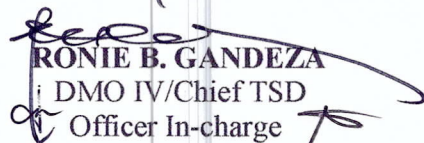
RONIE B. GANDEZA
DMO IV/Chief TSD
Officer In-charge

Reference No: 2023-3407
TSD/RPS/SMU

DENR-PALAWAN
PENRO-RECORDS
RELEASED
By: 
Date: 08 MAY 2023 23-1260



R4B PENRO Palawan <penropalawan@denr.gov.ph>

Fwd: Re submission of Survey Authority Request of Rodolfo Palma**ARIEL II DELIN** <delinii.ariel@gmail.com>

Fri, Apr 14, 2023 at 9:06 AM

To: R4B PENRO Palawan <penropalawan@denr.gov.ph>

----- Forwarded message -----

From: **ARIEL II DELIN** <delinii.ariel@gmail.com>

Date: Tue, Mar 28, 2023 at 11:43 AM

Subject: Re submission of Survey Authority Request of Rodolfo Palma

To: Donna Belle Luengo <surveysandmappingunit@gmail.com>

**DENR PENRO
PALAWAN RECORDS
RECEIVED**BY:
DATE: 04/14/2023 CN 23-3407 **1-25-23- Letter dated 04 October 2022 of the OI...**--
ARIEL C. DELIN II

DENR-CENRO Coron, Palawan

Barangay Poblacion V, Coron, Palawan

--
ARIEL C. DELIN II

DENR-CENRO Coron, Palawan

Barangay Poblacion V, Coron, Palawan

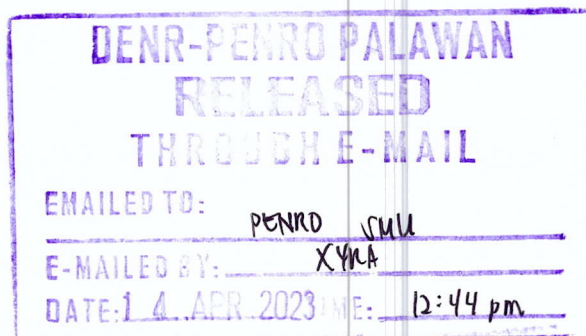

Virus-free.www.avast.com

2 attachments**20230320_133728_MEMO_resubmission_1.pdf**
1254K**20230320_134521_attachments_1.pdf**
18296K



March 1, 2023

FOR : The Regional Executive Director
MIMAROPA Region
1515 DENR by the Bay Building, Roxas Blvd.,
Barangay 668, Ermita, Manila

: Assistant Regional Director for
Technical Services

THRU : The Provincial Environment and
Natural Resources Officer
Sta. Monica, Puerto Princesa City

FROM : The OIC-Community Environment and
Natural Resources Officer
Coron, Palawan

SUBJECT : **REQUEST FOR CLEARANCE TO ISSUE SURVEY AUTHORITY OVER
A PARCEL OF LAND LOCATED AT BARANGAY QUEZON,
BUSUANGA, PALAWAN**

This pertains to the request for Clearance to Issue Survey Authority by Mr. Rodolfo Palma II over a parcel of land located in Barangay Quezon, Busuanga, Palawan.

Please be informed that previously, the said request was disapproved because it falls within the Busuanga Pasture Reserve covered by SWO-04-000080 in which pursuant to Presidential Proclamation No. 1387, Series of 1975, was withdrawn from "sale, settlement or any other form of disposition, exploration or exploitation and reserve as a pasture reserve."

However, a clarificatory memorandum from the DENR-Forest Management Bureau dated January 26, 2023 that was received by this Office pertaining to the official BPR Boundary used. This Office already observed the discrepancy between the original and 2015 relocation surveyed boundary. In the memo, it was disclosed that they officially adopted the boundary surveyed on 2015 for the management and protection of the Pasture Reserve. With all the findings thereto, this Office is resubmitting the request of Mr. Palma for consideration.

Attached herewith is the copy of the Memorandum from the FMB and other documents pertaining to the request.

For information, record and further instruction/s, if any.

For and in the Absence of the CENRO



[Signature]
EDWIN L. CAC
OIC-Assistant CENR Officer (DMO IV)



Republic of the Philippines
Department of Environment and Natural Resources
MIMAROPA Region

MEMORANDUM

TO : **THE PENR OFFICER**
Palawan

ATTENTION : **THE CENR OFFICER**
Coron, Palawan

FROM : **THE OIC, ASSISTANT REGIONAL DIRECTOR FOR**
TECHNICAL SERVICES

SUBJECT : **CLEARANCE TO ISSUE SURVEY AUTHORITY**
(C-2022-99590)

DATE : **JAN 16 2023**

This refers to the compliance with the lacking requirements dated December 1, 2022, relative to your previous Memorandum dated August 2, 2022 forwarding the requirements from CENRO, Coron, Palawan which are needed for the issuance of Memorandum of Clearance to Issue Survey Authority for the parcel of land within Lot 688, Cad-1150-D, bounded on its western and southern part by Lot 688, eastern part by Lots 1723 and 1710, Cad-1150-D, and northern part by Forestland, located in barangay Quezon, Busuanga, Palawan pursuant to DENR Memorandum Circular No. 2019-10 dated December 11, 2019.

Upon verification it was found the subject lot falls within Busuanga Pasture Reserve covered by SWO-04-000080, hence cannot be issued with the aforementioned certificate.

For information.

Cc:

The Regional Executive Director

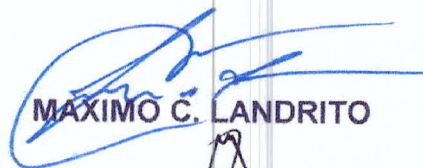
MAXIMO C. LANDRITO

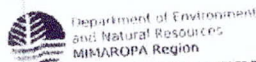

Doc ID: 99590

SMD/LESS/CKAA/1-10-23



Republic of the Philippines
Department of Environment and Natural Resources

FOREST MANAGEMENT BUREAU

Visayas Avenue, Diliman, 1100 Quezon City

Tel. No.: (632) 8925-2141 / (632) 8927-4788

E-mail Address: fmb@denr.gov.ph

Website: <https://www.forestry.denr.gov.ph>

MEMORANDUM

FOR : The Regional Executive Director
DENR MIMAROPA Region
1515 L&S Bldg., Roxas Blvd.
Ermita, Manila

ATT'N: The PENR Officer
PENRO Palawan
Brgy. Sta. Monica, Puerto Princesa City, Palawan

The CENR Officer
CENRO Calamianes Islands
Brgy. Poblacion 6, Coron, Palawan

FROM : The OIC, Forest Resources Management Division
In-Charge, Office of the Assistant Director

SUBJECT : **LETTER DATED 04 OCTOBER 2022 OF THE OIC CENRO
CORON PALAWAN REGARDING THE ONGOING RAPID
LAND TENURE APPRAISAL (RLTA) IN THE MUNICIPALITY
OF BUSUANGA**

DATE : **25 JAN 2023**

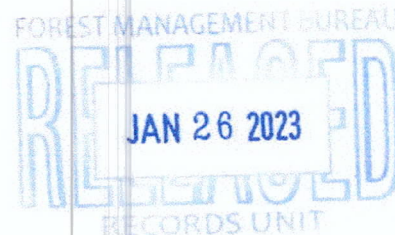

This has reference to the letter dated 04 October 2022 of the OIC CENRO Coron Palawan pertaining to the ongoing Rapid Land Tenure Appraisal (RLTA) activity in the municipality of Busuanga, Palawan. Based on the said letter, the conduct of RLTA aims to obtain a clear picture of the land tenure situation on the ground before the land titling activity operation and to further determine the approximate potential and workable lots within the Alienable and Disposable (A&D) lands for titling. Hence, the inquiry on the boundary of Busuanga Pasture Reserve (BPR) which is officially used by the Bureau.

In line with this, kindly be informed that pursuant to the ground survey verification conducted in 2015 by the Forest Management Bureau (FMB) in coordination with DENR Community Environment and Natural Resources (CENR) Office Calamianes Islands, and Local Government Units of Coron and Busuanga, the official area coverage adopted for BPR is 37,047.80 hectares (attached is a copy of report on the conduct of ground survey of BPR perimeter dated 14 December 2015). The metes and bounds of which are described as follows:

Tie Point: PLW-2, Luzon 1911, Zone 50N
Northing 1341927.55504 Easting 383964.656593

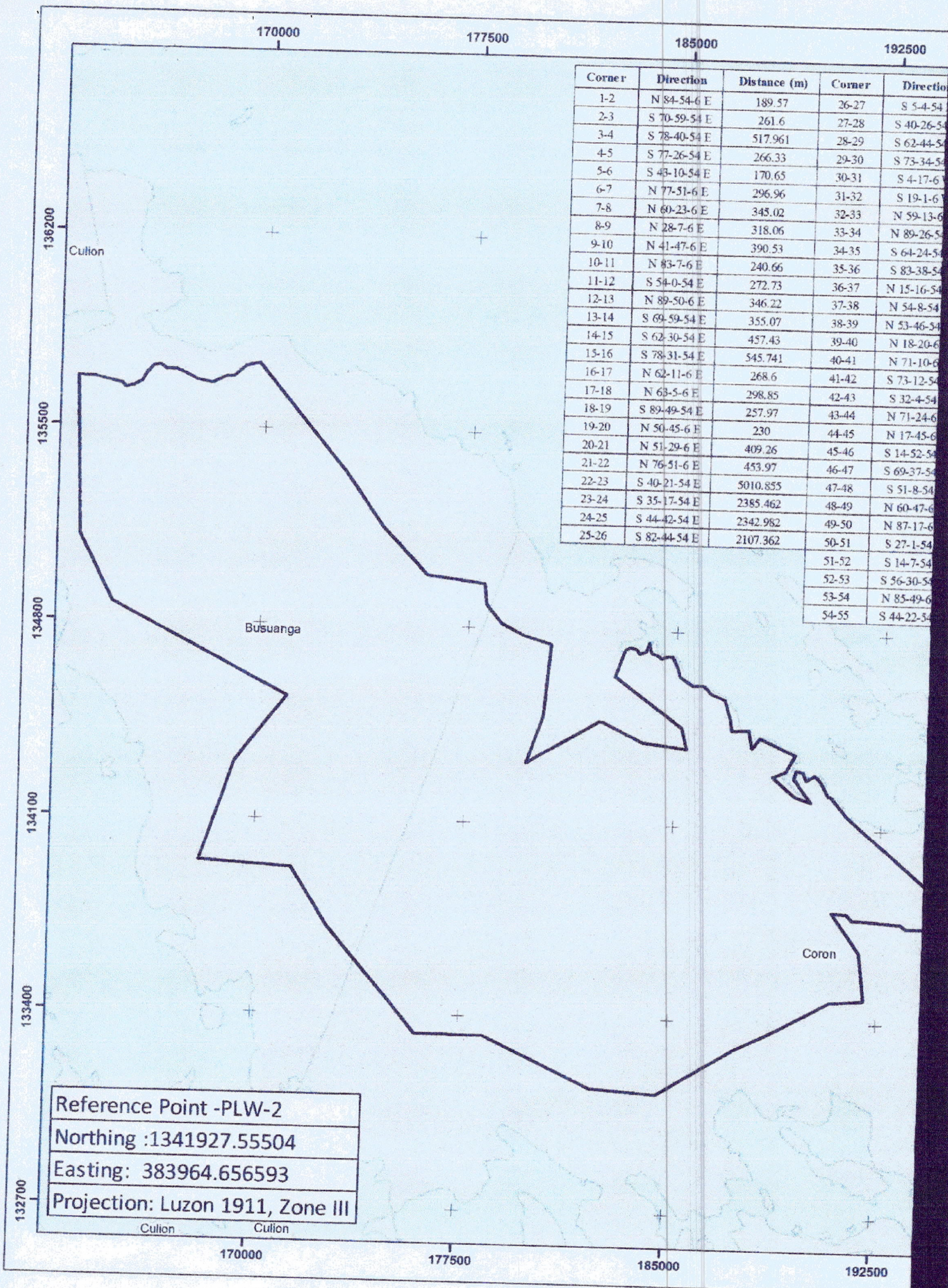

200000

| istance (m) | Corner | Direction | Distance (m) |
|-------------|---------|--------------|--------------|
| 728.991 | 55-56 | S 67-42-54 E | 552.611 |
| 864.921 | 56-57 | S 17-6-54 E | 719.821 |
| 906.341 | 57-58 | S 7-39-54 E | 423.91 |
| 1060.191 | 58-59 | N 85-40-6 E | 615.571 |
| 2590.513 | 59-60 | S 12-1-54 E | 662.181 |
| 1784.242 | 60-61 | N 36-42-6 E | 460.2 |
| 2995.523 | 61-62 | S 66-36-54 E | 1412.711 |
| 140.076 | 62-63 | S 28-15-6 W | 665.641 |
| 1600.002 | 63-64 | S 64-21-6 W | 514.021 |
| 1603.062 | 64-65 | S 50-28-54 E | 1067.951 |
| 785.191 | 65-66 | S 71-51-54 E | 589.531 |
| 1519.842 | 66-67 | N 37-10-54 W | 1037.271 |
| 1489.382 | 67-68 | N 12-1-6 E | 310.99 |
| 1037.771 | 68-69 | S 76-5-54 E | 245.43 |
| 219.17 | 69-70 | S 26-31-54 E | 323.65 |
| 229.4 | 70-71 | N 56-48-6 E | 345.88 |
| 166.05 | 71-72 | S 47-9-54 E | 313.62 |
| 248.94 | 72-73 | S 28-8-54 E | 597.591 |
| 343.33 | 73-74 | N 88-35-6 E | 72.24 |
| 388.85 | 74-75 | S 41-15-54 E | 1000.121 |
| 225.88 | 75-76 | S 49-38-54 E | 6103.546 |
| 191.78 | 76-77 | S 89-47-6 W | 2433.582 |
| 183.17 | 77-78 | N 53-46-54 W | 242.11 |
| 237.97 | 78-79 | N 86-41-54 W | 1384.971 |
| 439.42 | 79-80 | N 88-19-54 W | 388.06 |
| 334.71 | 80-81 | N 40-21-54 W | 261.77 |
| 573.651 | 81-82 | N 85-27-54 W | 347.68 |
| 380.68 | 82-83 | N 84-27-54 W | 214.66 |
| 400.98 | 83-84 | S 36-23-54 E | 1752.232 |
| | 84-85 | S 7-8-54 E | 1707.892 |
| | 85-86 | S 84-34-6 W | 1229.961 |
| | 86-87 | S 60-35-6 W | 2094.232 |
| | 87-88 | S 63-34-6 W | 1771.672 |
| | 88-89 | S 58-15-6 W | 3181.713 |
| | 89-90 | N 86-6-54 W | 2396.162 |
| | 90-91 | N 65-29-54 W | 4282.954 |
| | 91-92 | N 89-41-54 W | 2451.792 |
| | 92-93 | N 40-17-54 W | 1666.442 |
| | 93-94 | N 41-26-54 W | 3359.473 |
| | 94-95 | N 33-9-54 W | 2458.373 |
| | 95-96 | N 86-54-54 W | 3321.763 |
| | 96-97 | N 17-59-6 E | 3792.574 |
| | 97-98 | N 37-1-6 E | 2997.323 |
| | 98-99 | N 63-21-54 W | 7143.247 |
| | 99-100 | N 27-10-54 W | 2654.623 |
| | 100-101 | N 2-23-54 W | 5719.496 |
| | 101-1 | S 85-51-54 E | 358.95 |

Corner 1 is N 11-21-0 W, of about
13,853.387m
from PLW-2, PRS 92

200000

136200

135500

134800

134100

133400

132700

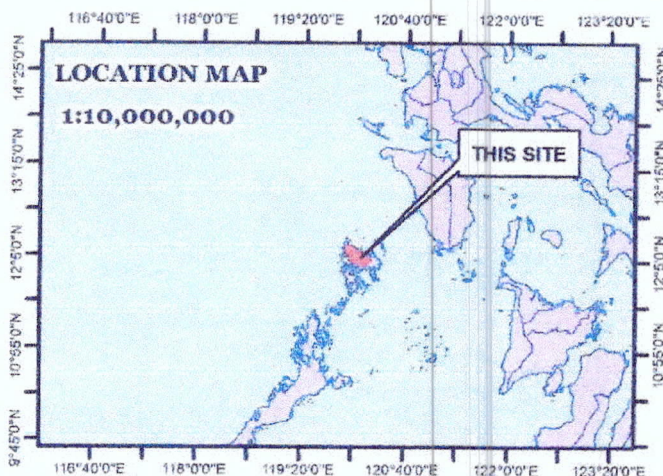

BUSUANGA PASTURE RESERVE

Location : Municipality : Busuanga & Coron
Province : Palawan

0 2.5 5 10 Kilometers

1:160,000

Projected Coordinate System:
Luzon 1911 Zone 50 N

Area = 37,047.8 hectares

Legend

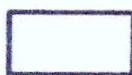

Busuanga Pasture Reserve

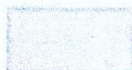

Municipal Boundary



Republic of the Philippines
DEPARTMENT OF ENVIRONMENT AND NATURAL RESOURCES
FOREST MANAGEMENT BUREAU
FGDIS- FPPKMD
Visayas Avenue, Diliman, Quezon City



CERTIFICATION

This is to certify that this is true and correct map of the area of Busuanga Pasture Reserve (Declared as pasture reserve in Presidential Proclamation No. 1387 s. 1967) as described hereon:

This map was prepared based on the actual Ground Survey conducted by virtue of Presidential Proclamation No. 663, s. 2013.

Recommending approval

LARLYN P. GABAO

Chief, FGDIS

Approved by:

TIRSO P. PARIAN JR., CESO IV

Director

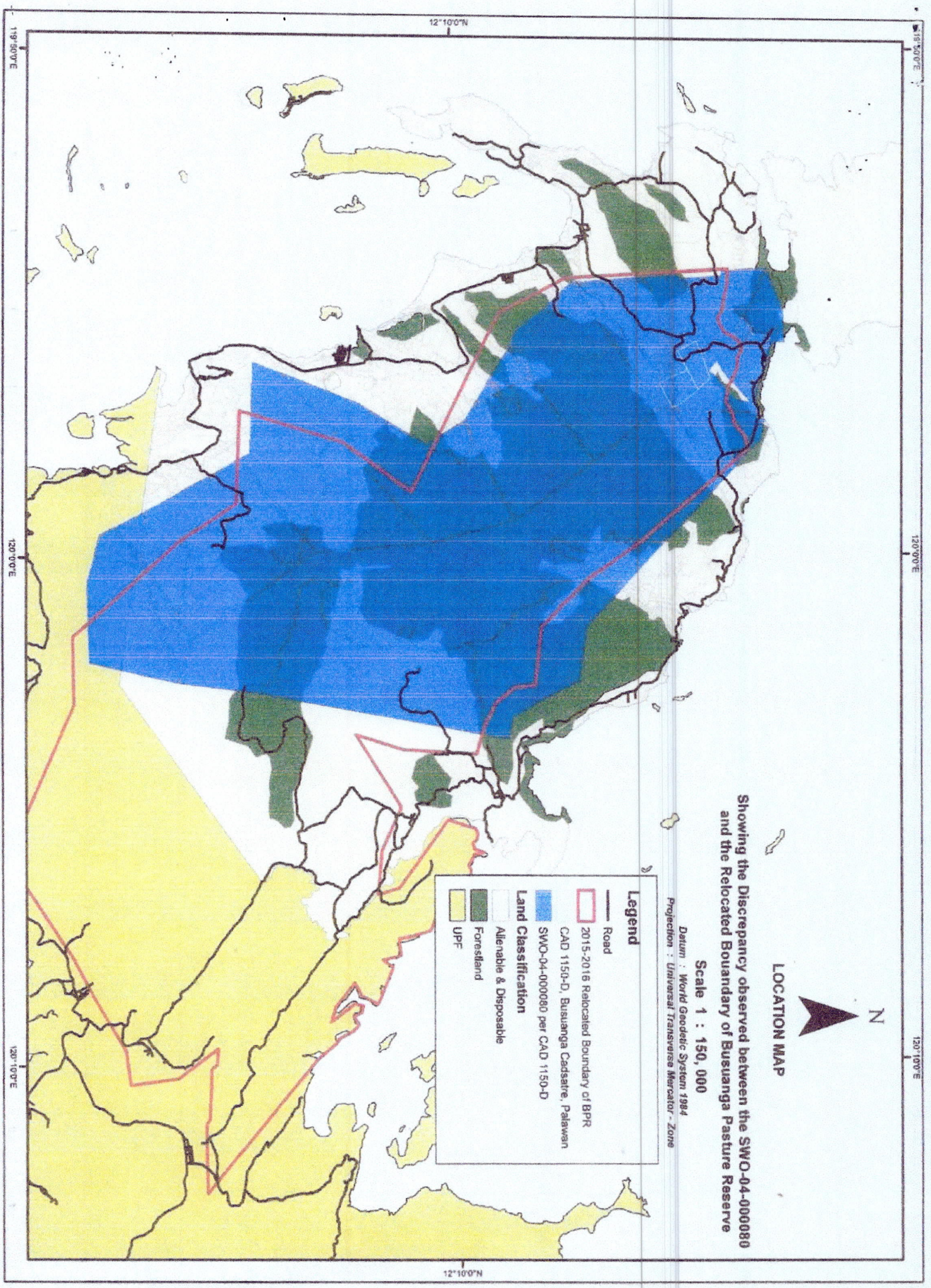

LOCATION MAP



Showing the Discrepancy observed between the SWO-04-000080
and the Relocated Boundary of Busuanga Pasture Reserve

Scale 1 : 150, 000

Datum : World Geodetic System 1984
Projection : Universal Transverse Mercator - Zone

Legend

Road

2015-2016 Relocated Boundary of BPR

CAD 1150-D, Busuanga Cadsaire, Palawan

SWO-04-000080 per CAD 1150-D

Land Classification

Alienable & Disposable

Forestland

UPF

| GEOGRAPHICAL COORDINATES | | | | | | |
|--------------------------|----------|---------|---------|-----------|---------|---------|
| Corner | Latitude | | | Longitude | | |
| | Degrees | Minutes | Seconds | Degrees | Minutes | Seconds |
| 1 | 12 | 15 | 52.89 | 119 | 57 | 7.47 |
| 2 | 12 | 15 | 52.151 | 119 | 57 | 6.657 |
| 3 | 12 | 15 | 50.466 | 119 | 57 | 3.624 |
| 4 | 12 | 15 | 52.32 | 119 | 57 | 2.729 |
| 5 | 12 | 15 | 53.786 | 119 | 57 | 5.204 |
| 6 | 12 | 15 | 55.12 | 119 | 57 | 6.01 |



GIS MAP showing the area requested for **STATUS OF LAND CLASSIFICATION** (Alienable and Disposable)

as per L.C. Map no. 839, Project 2-A
certified on December 09, 1929

as prepared by

RODOLFO A. PALMARI

Located at

Barangay : Quezon
Municipality : Busuanga
Province : Palawan

Scale 1 : 3,500



Projection: Universal Transverse Mercator-Zone 50 (N)

Datum: World Geodetic System 1984 (WGS84)

Approximate Total Area : 9, 814 Square Meters

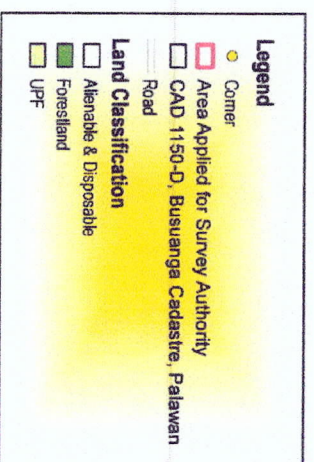

Attested by :

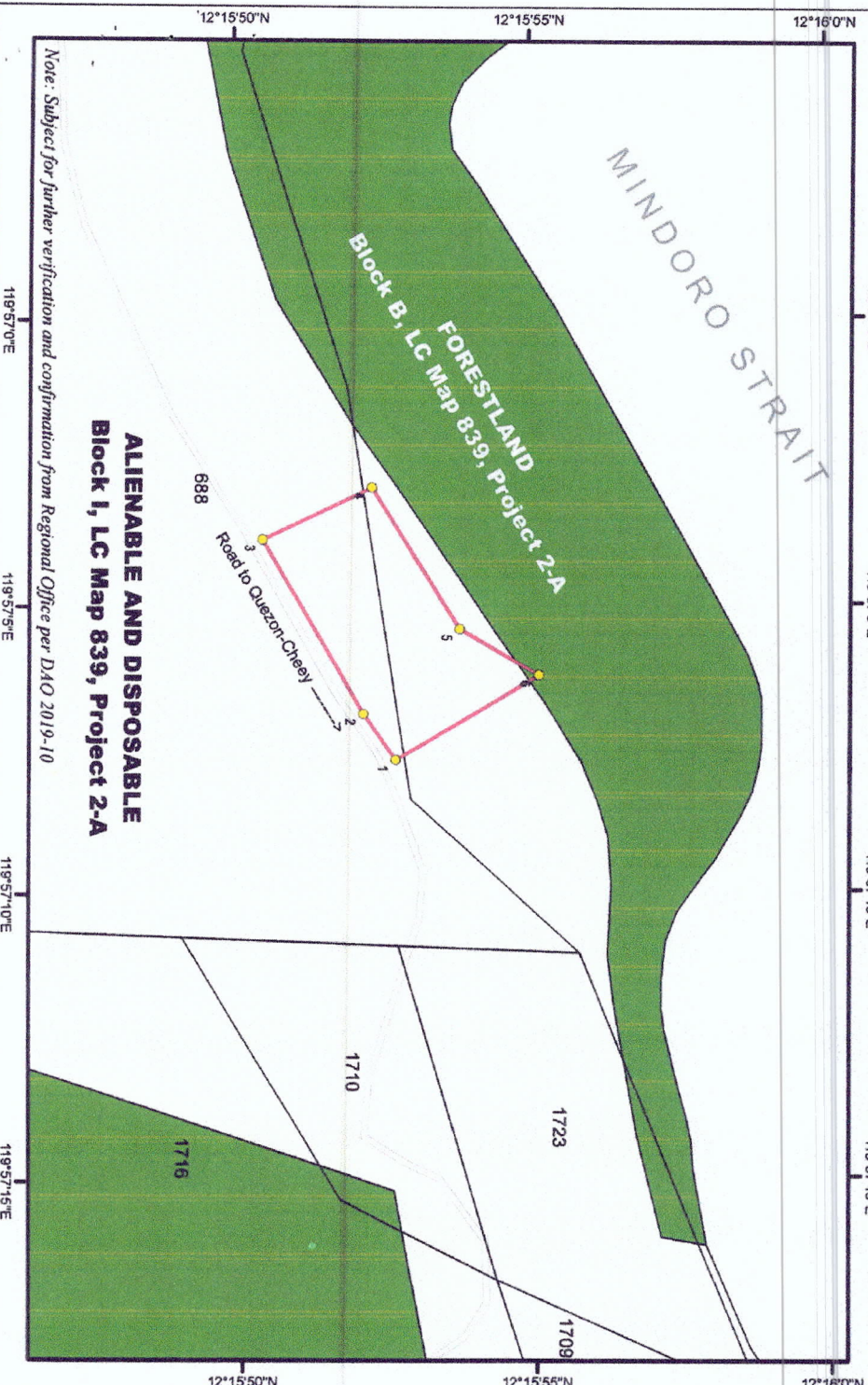

Note: Subject for further verification and confirmation from Regional Office per DAO 2019-10

Prepared by:

ARNEL C. CABANILLAS II
Forest Technician II

Checked & Verified by:

TIMOTHY JEROME T. PANILLIO
Land Mgt. Officer I

Attested by :

ARNEL C. CABANILLAS
Land Mgt. Officer II/In-Charge, RPS